

SUNFLOWER 24N-17HZ LOCATION DRAWING

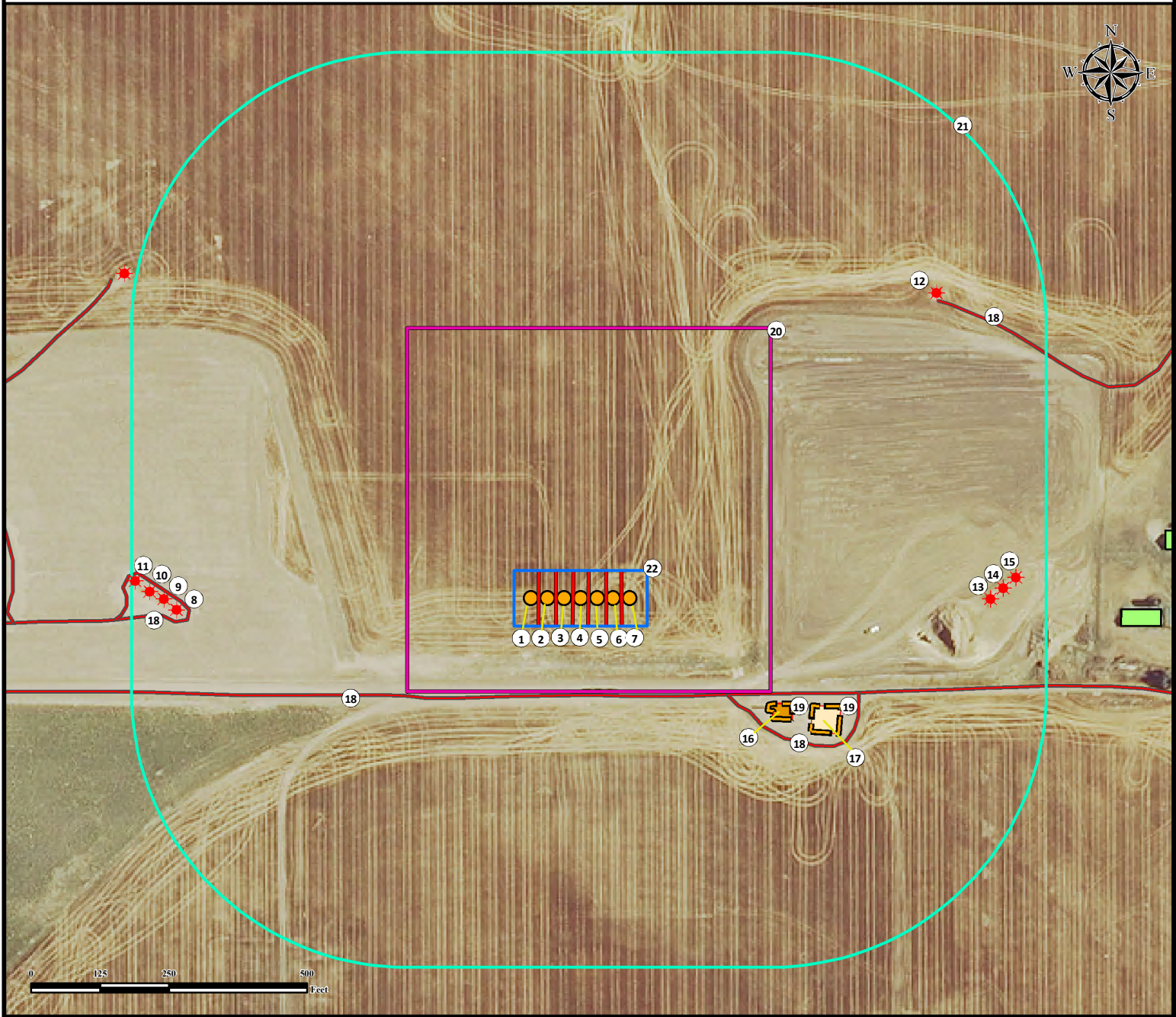

1. Proposed Well SUNFLOWER 25G-17HZ.
2. Proposed Well SUNFLOWER 7N-17HZ.
3. Proposed Well SUNFLOWER 7C-17HZ.
4. Proposed Well SUNFLOWER 24N-17HZ.
5. Proposed Well SUNFLOWER 8N-17HZ.
6. Proposed Well SUNFLOWER 40C-17HZ.
7. Proposed Well SUNFLOWER 40N-17HZ.
8. Existing Well NICHOLS 27N-5HZ is $\pm 733'$ W.
9. Existing Well NICHOLS 2N-5HZ is $\pm 756'$ W.
10. Existing Well NICHOLS 28C-5HZ is $\pm 782'$ W.
11. Existing Well NICHOLS 28N-5HZ is $\pm 809'$ W.
12. Existing Well NICHOLS 8-8 is $\pm 850'$ NE.
13. Existing Well NICHOLS 1N-5HZ is $\pm 743'$ E.
14. Existing Well NICHOLS 26C-5HZ is $\pm 767'$ E.
15. Existing Well NICHOLS 26N-5HZ is $\pm 790'$ E.
16. Existing Separator Pad is $\pm 391'$ SE.
17. Existing Tank Battery is $\pm 462'$ SE.
18. Private Roads are $\pm 176'$ S, $\pm 317'$ SE, $\pm 711'$ W, and $\pm 843'$ NE.
19. Fences are $\pm 391'$ SE and $\pm 462'$ SE.
20. Operational Disturbance Area.
21. 500' Radius.
22. Pump Jack Operations Area.

Legend

- Proposed Well
- ★ Existing Well
- Private Road
- Fence
- Existing Separator Pad
- Existing Tank Battery
- Building
- Disturbance Area
- 500' Radius
- Pump Jack Operations Area

Reference Location

All measurements are made from
Reference Well
SUNFLOWER 24N-17HZ
Lat: 40.153695° Long: -104.683034°
(NAD83)
Elevation: 4901 Feet

Surface Use: Dry Land Crop

Nearest Building Unit: $\pm 1204'$ NE.



FIELD DATE:
11-07-14

DRAWING DATE:
04-21-15

BY:
FMB

CHECKED BY:
CSG

SITE NAME:
SUNFLOWER 24N-17HZ PAD

SURFACE LOCATION:
S1/2 NE1/4, SEC. 8, T2N, R65W, 6TH P.M.
WELD COUNTY, COLORADO

PREPARED FOR:



**KERR-MCGEE OIL
& GAS ONSHORE LP**