

Proposed
Access Road

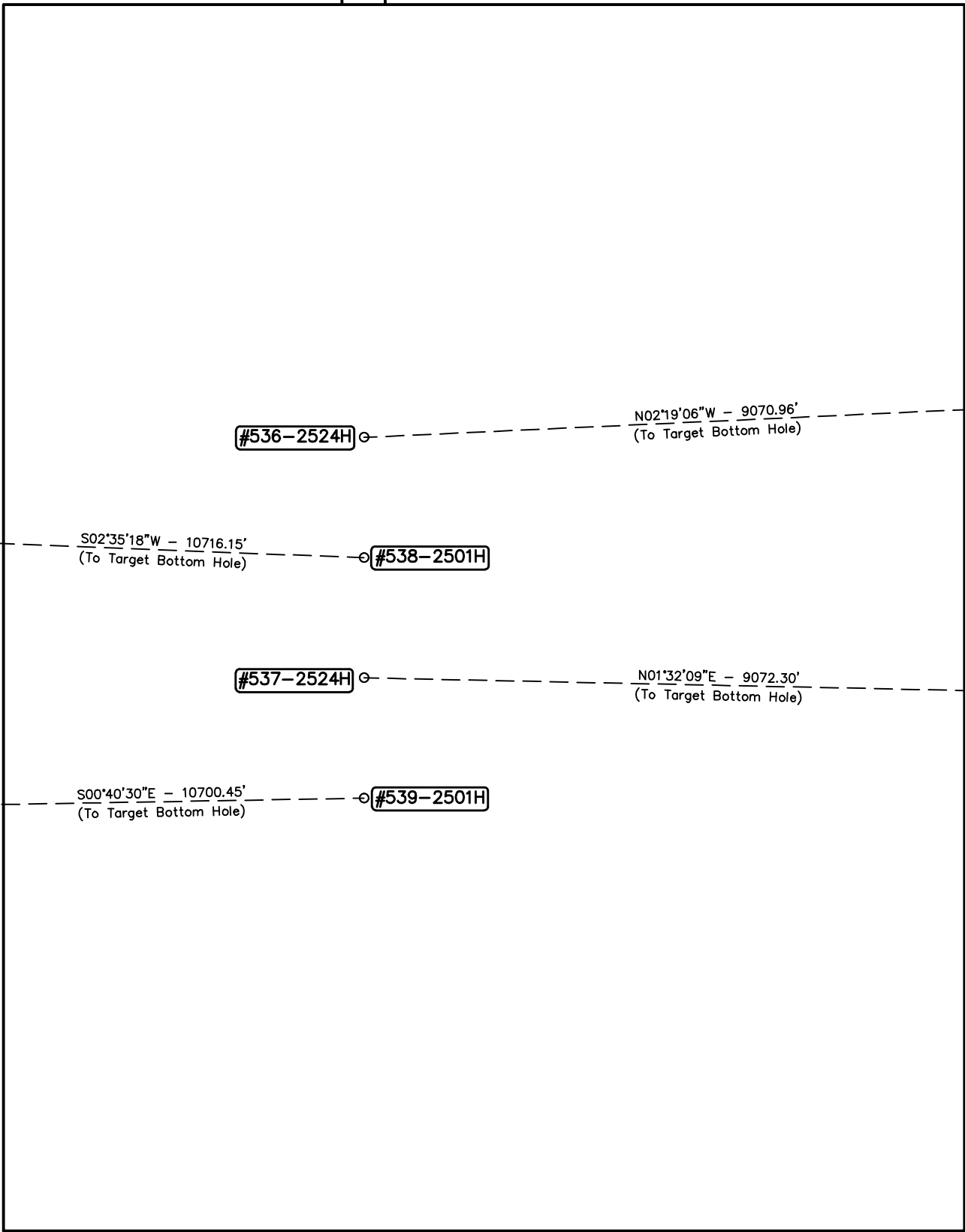

NOTES:

EOG RESOURCES, INC.

FOX CREEK 25 SESW
SE 1/4 SW 1/4, SECTION 25, T12N, R63W, 6th P.M.
WELD COUNTY, COLORADO



UELS, LLC
Corporate Office * 85 South 200 East
Vernal, UT 84078 * (435) 789-1017

DRAWN BY: C.D.L.	DATE DRAWN: 05-05-15
SCALE: 1" = 60'	REVISED: 00-00-00
MULTI-WELL PLAN	FIGURE #6