

Location:	COLORADO	Slot:	SLOT#03 DT-HABITAT J3-5-6 (382'FNL & 1684'FEL, SEC.05)
Field:	WELD COUNTY (NAD83/TRUE NORTH)	Well:	DT-HABITAT J3-5-6
Facility:	SEC.05-T05N-R65W	Wellbore:	DT-HABITAT J3-5-6 PWB

Location:	COLORADO	Slot:	SLOT#03 DT-HABITAT J3-5-6 (382'FNL & 1684'FEL, SEC.05)
Field:	WELD COUNTY (NAD83/TRUE NORTH)	Well:	DT-HABITAT J3-5-6
Facility:	SEC.05-T05N-R65W	Wellbore:	DT-HABITAT J3-5-6 PWB

True vertical depths are referenced to SAVANNA 802 (15KB) (RKB)	Grid System: NAD83 / Lambert Colorado SP, Northern Zone (501), US feet
Measured depths are referenced to SAVANNA 802 (15KB) (RKB)	North Reference: True north
SAVANNA 802 (15KB) (RKB) to Mean Sea Level: 4655 feet	Scale: True distance
Mean Sea Level to Mud line (At Slot: SLOT#03 DT-HABITAT J3-5-6 (3&2P&L & 16&4F&L, SEC.05)): 0 feet	Depths are in feet
Coordinates are in feet referenced to Slot	Created by: ingnjamr on 6/26/2015



BGGM (1945.0 to 2016.0) Dip: 66.95° Field: 52627.8 nT  
Magnetic North is 8.41 degrees East of True North (at 5/6/2015)

To correct azimuth from Magnetic to True add 8.41 degrees

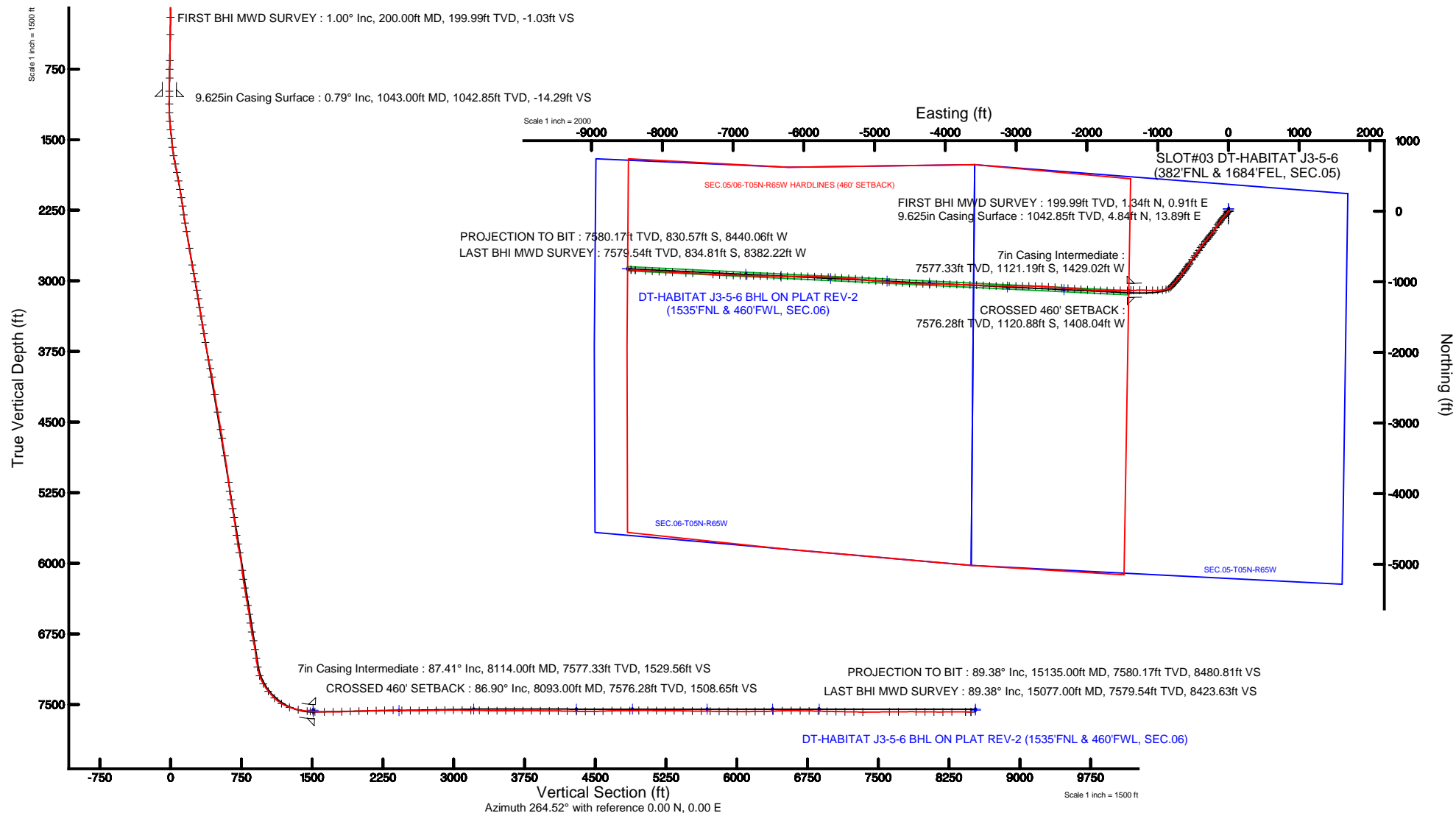



# Actual Wellpath Report

DT-HABITAT J3-5-6 AWP

Page 1 of 8



## REFERENCE WELLPATH IDENTIFICATION

Operator	EXTRACTION OIL & GAS	Slot	SLOT#03 DT-HABITAT J3-5-6 (382'FNL & 1684'FEL, SEC.05)
Area	COLORADO	Well	DT-HABITAT J3-5-6
Field	WELD COUNTY (NAD83/TRUE NORTH)	Wellbore	DT-HABITAT J3-5-6 AWB
Facility	SEC.05-T05N-R65W		

## REPORT SETUP INFORMATION

Projection System	NAD83 / Lambert Colorado SP, Northern Zone (501), US feet	Software System	WellArchitect® 4.1.1
North Reference	True	User	Ingmjmr
Scale	0.999962	Report Generated	6/26/2015 at 9:18:51 AM
Convergence at slot	0.53° East	Database/Source file	Denver/DT-HABITAT_J3-5-6_AWB.xml

## WELLPATH LOCATION

	Local coordinates		Grid coordinates		Geographic coordinates	
	North[ft]	East[ft]	Easting[US ft]	Northing[US ft]	Latitude	Longitude
Slot Location	-134.80	228.27	3227217.59	1402516.92	40°26'07.584"N	104°41'01.428"W
Facility Reference Pt			3226988.10	1402649.61	40°26'08.916"N	104°41'04.380"W
Field Reference Pt			3185481.27	1419166.81	40°28'55.560"N	104°49'59.556"W

## WELLPATH DATUM

Calculation method	Minimum curvature	SAVANNA 802 (15'KB) (RKB) to Facility Vertical Datum	4655.00ft
Horizontal Reference Pt	Slot	SAVANNA 802 (15'KB) (RKB) to Mean Sea Level	4655.00ft
Vertical Reference Pt	SAVANNA 802 (15'KB) (RKB)	SAVANNA 802 (15'KB) (RKB) to Mud Line at Slot (SLOT#03 DT-HABITAT J3-5-6 (382'FNL & 1684'FEL, SEC.05))	4655.00ft
MD Reference Pt	SAVANNA 802 (15'KB) (RKB)	Section Origin	N 0.00, E 0.00 ft
Field Vertical Reference	Mean Sea Level	Section Azimuth	264.52°



# Actual Wellpath Report

DT-HABITAT J3-5-6 AWP

Page 2 of 8



## REFERENCE WELLPATH IDENTIFICATION

Operator	EXTRACTION OIL & GAS	Slot	SLOT#03 DT-HABITAT J3-5-6 (382'FNL & 1684'FEL, SEC.05)
Area	COLORADO	Well	DT-HABITAT J3-5-6
Field	WELD COUNTY (NAD83/TRUE NORTH)	Wellbore	DT-HABITAT J3-5-6 AWB
Facility	SEC.05-T05N-R65W		

## WELLPATH DATA (145 stations) † = interpolated/extrapolated station

MD [ft]	Inclination [°]	Azimuth [°]	TVD [ft]	Vert Sect [ft]	North [ft]	East [ft]	DLS [°/100ft]	Comments
0.00†	0.000	34.100	0.00	0.00	0.00	0.00	0.00	
15.00	0.000	34.100	15.00	0.00	0.00	0.00	0.00	
200.00	1.000	34.100	199.99	-1.03	1.34	0.91	0.54	FIRST BHI MWD SURVEY
383.00	1.050	55.640	382.96	-3.51	3.61	3.18	0.21	
662.00	1.160	76.050	661.91	-8.55	5.73	8.04	0.15	
754.00	1.170	62.100	753.89	-10.34	6.39	9.77	0.31	
846.00	1.030	141.720	845.88	-11.65	6.18	11.11	1.54	
986.00	0.980	94.320	985.86	-13.51	5.11	13.09	0.58	
1122.00	1.020	169.570	1121.85	-14.76	3.83	14.46	0.90	
1214.00	1.750	248.640	1213.82	-13.48	2.51	13.30	2.01	
1306.00	5.020	236.070	1305.65	-8.59	-0.25	8.65	3.62	
1398.00	7.860	234.190	1397.06	0.38	-6.18	0.21	3.10	
1491.00	8.170	219.780	1489.16	10.56	-14.98	-9.17	2.18	
1583.00	9.630	213.710	1580.06	20.07	-26.40	-17.63	1.88	
1675.00	12.660	218.190	1670.31	31.90	-40.73	-28.13	3.42	
1767.00	15.020	224.770	1759.64	48.03	-57.12	-42.77	3.08	
1860.00	14.910	222.680	1849.49	66.21	-74.47	-59.36	0.59	
1952.00	13.940	222.220	1938.58	83.22	-91.38	-74.84	1.06	
2044.00	13.110	222.050	2028.03	99.11	-107.34	-89.27	0.90	
2136.00	13.480	215.340	2117.57	113.82	-123.83	-102.46	1.72	
2228.00	12.440	213.430	2207.23	127.05	-140.85	-114.12	1.22	
2321.00	12.050	213.650	2298.11	139.47	-157.29	-125.02	0.42	
2413.00	15.280	215.610	2387.50	153.50	-175.15	-137.40	3.55	
2505.00	15.080	213.960	2476.29	169.07	-194.93	-151.15	0.52	
2690.00	14.150	211.910	2655.30	198.09	-234.08	-176.55	0.58	
2874.00	16.240	216.450	2832.86	228.95	-273.88	-203.72	1.31	
2966.00	15.700	217.260	2921.31	245.99	-294.13	-218.90	0.63	
3058.00	15.360	217.310	3009.95	262.72	-313.73	-233.82	0.37	
3151.00	13.930	217.640	3099.93	278.74	-332.39	-248.13	1.54	
3242.00	12.720	218.010	3188.48	293.12	-348.96	-260.99	1.33	



# Actual Wellpath Report

DT-HABITAT J3-5-6 AWP

Page 3 of 8



## REFERENCE WELLPATH IDENTIFICATION

Operator	EXTRACTION OIL & GAS	Slot	SLOT#03 DT-HABITAT J3-5-6 (382'FNL & 1684'FEL, SEC.05)
Area	COLORADO	Well	DT-HABITAT J3-5-6
Field	WELD COUNTY (NAD83/TRUE NORTH)	Wellbore	DT-HABITAT J3-5-6 AWP
Facility	SEC.05-T05N-R65W		

## WELLPATH DATA (145 stations)

MD [ft]	Inclination [°]	Azimuth [°]	TVD [ft]	Vert Sect [ft]	North [ft]	East [ft]	DLS [°/100ft]	Comments
3338.00	13.150	218.040	3282.04	307.91	-365.89	-274.22	0.45	
3434.00	12.080	217.650	3375.72	322.30	-382.44	-287.09	1.12	
3529.00	13.790	221.000	3468.31	337.31	-398.86	-300.59	1.96	
3625.00	13.080	219.700	3561.68	353.31	-415.85	-315.04	0.80	
3721.00	13.660	218.740	3655.08	368.92	-433.05	-329.07	0.65	
3912.00	15.950	217.000	3839.73	402.38	-471.61	-358.98	1.22	
4008.00	16.630	217.440	3931.87	420.64	-493.05	-375.27	0.72	
4103.00	15.330	214.820	4023.20	438.02	-514.15	-390.71	1.56	
4295.00	13.480	213.000	4209.16	468.37	-553.76	-417.39	0.99	
4487.00	15.370	215.400	4395.10	498.95	-593.27	-444.32	1.03	
4678.00	14.000	215.410	4579.86	530.64	-632.74	-472.37	0.72	
4774.00	12.510	216.760	4673.30	545.23	-650.53	-485.32	1.59	
4966.00	14.160	217.840	4860.11	575.32	-685.74	-512.17	0.87	
5254.00	10.730	209.810	5141.32	615.00	-736.84	-547.13	1.33	
5350.00	12.390	213.170	5235.38	626.59	-753.22	-557.20	1.87	
5446.00	13.610	220.340	5328.92	641.13	-770.45	-570.15	2.10	
5542.00	14.860	215.160	5421.97	657.24	-789.13	-584.55	1.86	
5638.00	13.520	213.300	5515.04	672.29	-808.57	-597.80	1.47	
5734.00	11.510	212.380	5608.76	685.20	-826.04	-609.10	2.10	
5830.00	12.260	215.860	5702.70	697.81	-842.39	-620.20	1.08	
5926.00	14.320	216.530	5796.12	712.49	-860.19	-633.24	2.15	
6021.00	15.090	221.060	5888.01	729.33	-878.96	-648.35	1.46	
6213.00	10.170	213.120	6075.32	758.07	-912.02	-674.05	2.71	
6309.00	11.430	219.500	6169.63	770.08	-926.46	-684.73	1.81	
6405.00	12.970	221.320	6263.46	784.66	-941.89	-697.89	1.65	
6501.00	12.790	221.880	6357.04	800.33	-957.90	-712.10	0.23	
6596.00	14.130	221.920	6449.43	816.60	-974.35	-726.87	1.41	
6692.00	11.830	219.010	6542.97	832.12	-990.72	-740.89	2.49	
6788.00	12.340	216.620	6636.84	845.90	-1006.60	-753.21	0.74	
6883.00	12.250	224.270	6729.67	860.39	-1021.97	-766.30	1.72	



# Actual Wellpath Report

DT-HABITAT J3-5-6 AWP

Page 4 of 8



## REFERENCE WELLPATH IDENTIFICATION

Operator	EXTRACTION OIL & GAS	Slot	SLOT#03 DT-HABITAT J3-5-6 (382'FNL & 1684'FEL, SEC.05)
Area	COLORADO	Well	DT-HABITAT J3-5-6
Field	WELD COUNTY (NAD83/TRUE NORTH)	Wellbore	DT-HABITAT J3-5-6 AWB
Facility	SEC.05-T05N-R65W		

## WELLPATH DATA (145 stations) † = interpolated/extrapolated station

MD [ft]	Inclination [°]	Azimuth [°]	TVD [ft]	Vert Sect [ft]	North [ft]	East [ft]	DLS [°/100ft]	Comments
6979.00	14.470	225.010	6823.07	877.42	-1037.74	-781.89	2.32	
7075.00	12.770	220.750	6916.37	894.34	-1054.26	-797.30	2.06	
7170.00	10.560	218.730	7009.40	907.99	-1069.01	-809.60	2.37	
7266.00	11.330	224.240	7103.65	921.32	-1082.63	-821.69	1.35	
7361.00	19.390	244.800	7195.25	943.34	-1096.06	-842.51	10.12	
7456.00	30.420	257.170	7281.34	982.18	-1108.16	-880.38	12.78	
7552.00	37.500	262.630	7360.93	1035.57	-1117.32	-933.13	8.02	
7648.00	46.550	270.480	7432.22	1099.61	-1120.78	-997.13	10.89	
7744.00	58.520	269.440	7490.51	1175.33	-1120.89	-1073.19	12.50	
7839.00	71.310	270.990	7530.71	1260.76	-1120.51	-1159.05	13.54	
7935.00	77.710	269.670	7556.33	1352.75	-1119.99	-1251.51	6.80	
8031.00	83.860	269.770	7571.70	1447.08	-1120.45	-1346.22	6.41	
8063.00	86.180	269.670	7574.48	1478.82	-1120.61	-1378.10	7.26	
8093.00†	86.903	269.286	7576.28	1508.65	-1120.88	-1408.04	2.73	CROSSED 460' SETBACK
8214.00	89.820	267.740	7579.74	1629.29	-1124.02	-1528.94	2.73	
8307.00	90.610	268.900	7579.40	1722.09	-1126.75	-1621.89	1.51	
8399.00	91.720	271.760	7577.52	1813.58	-1126.22	-1713.86	3.33	
8491.00	92.520	271.250	7574.12	1904.84	-1123.81	-1805.77	1.03	
8583.00	92.000	273.460	7570.49	1995.90	-1120.03	-1897.61	2.47	
8676.00	90.980	274.130	7568.07	2087.65	-1113.87	-1990.37	1.31	
8768.00	91.840	275.040	7565.81	2178.21	-1106.52	-2082.05	1.36	
8860.00	91.690	274.880	7562.98	2268.64	-1098.57	-2173.66	0.24	
8952.00	89.850	274.200	7561.74	2359.23	-1091.29	-2265.36	2.13	
9044.00	88.330	274.170	7563.20	2449.91	-1084.58	-2357.10	1.65	
9137.00	89.560	274.230	7564.91	2541.56	-1077.77	-2449.83	1.32	
9229.00	89.870	273.540	7565.37	2632.34	-1071.54	-2541.62	0.82	
9321.00	91.070	273.390	7564.62	2723.21	-1065.98	-2633.45	1.31	
9413.00	90.950	272.100	7563.00	2814.25	-1061.57	-2725.33	1.41	
9506.00	90.490	270.490	7561.83	2906.59	-1059.47	-2818.29	1.80	
9598.00	90.920	270.050	7560.69	2998.12	-1059.04	-2910.28	0.67	



# Actual Wellpath Report

DT-HABITAT J3-5-6 AWP

Page 5 of 8



## REFERENCE WELLPATH IDENTIFICATION

Operator	EXTRACTION OIL & GAS	Slot	SLOT#03 DT-HABITAT J3-5-6 (382'FNL & 1684'FEL, SEC.05)
Area	COLORADO	Well	DT-HABITAT J3-5-6
Field	WELD COUNTY (NAD83/TRUE NORTH)	Wellbore	DT-HABITAT J3-5-6 AWB
Facility	SEC.05-T05N-R65W		

## WELLPATH DATA (145 stations)

MD [ft]	Inclination [°]	Azimuth [°]	TVD [ft]	Vert Sect [ft]	North [ft]	East [ft]	DLS [°/100ft]	Comments
9690.00	87.500	268.690	7561.96	3089.77	-1060.05	-3002.25	4.00	
9782.00	91.540	270.620	7562.73	3181.37	-1060.60	-3094.22	4.87	
9874.00	88.180	270.390	7562.96	3272.86	-1059.79	-3186.21	3.66	
9969.00	89.130	272.150	7565.19	3367.17	-1057.68	-3281.15	2.10	
10062.00	89.380	271.830	7566.40	3459.37	-1054.45	-3374.09	0.44	
10154.00	90.030	272.550	7566.87	3550.54	-1050.94	-3466.02	1.05	
10246.00	90.330	271.980	7566.58	3641.70	-1047.30	-3557.95	0.70	
10338.00	90.000	271.620	7566.32	3732.96	-1044.41	-3649.90	0.53	
10430.00	89.810	271.760	7566.47	3824.24	-1041.70	-3741.86	0.26	
10526.00	88.950	271.490	7567.51	3919.50	-1038.98	-3837.82	0.94	
10621.00	89.540	272.060	7568.76	4013.73	-1036.04	-3932.76	0.86	
10717.00	89.380	271.730	7569.67	4108.93	-1032.86	-4028.70	0.38	
10813.00	88.800	270.530	7571.19	4204.28	-1030.97	-4124.67	1.39	
10909.00	88.950	270.240	7573.08	4299.76	-1030.32	-4220.65	0.34	
11004.00	90.270	271.700	7573.72	4394.15	-1028.71	-4315.63	2.07	
11100.00	90.330	272.600	7573.22	4489.30	-1025.11	-4411.56	0.94	
11195.00	92.310	273.130	7571.03	4583.26	-1020.37	-4506.41	2.16	
11291.00	91.570	272.940	7567.78	4678.15	-1015.29	-4602.22	0.80	
11387.00	90.950	274.260	7565.67	4772.92	-1009.26	-4698.00	1.52	
11483.00	89.350	273.740	7565.42	4867.60	-1002.56	-4793.77	1.75	
11579.00	91.200	274.410	7564.96	4962.27	-995.74	-4889.52	2.05	
11674.00	89.450	274.600	7564.42	5055.82	-988.28	-4984.22	1.85	
11769.00	89.020	275.960	7565.69	5149.14	-979.54	-5078.81	1.50	
11865.00	90.090	275.660	7566.43	5243.28	-969.82	-5174.31	1.16	
11961.00	89.660	275.550	7566.64	5337.49	-960.45	-5269.85	0.46	
12057.00	88.760	275.260	7567.97	5431.75	-951.40	-5365.41	0.98	
12156.00	88.790	272.710	7570.08	5529.37	-944.53	-5464.14	2.58	
12252.00	89.290	273.440	7571.69	5624.29	-939.38	-5559.99	0.92	
12347.00	89.870	271.700	7572.39	5718.35	-935.12	-5654.89	1.93	
12443.00	89.260	272.380	7573.12	5813.52	-931.70	-5750.82	0.95	



# Actual Wellpath Report

DT-HABITAT J3-5-6 AWP

Page 6 of 8



## REFERENCE WELLPATH IDENTIFICATION

Operator	EXTRACTION OIL & GAS	Slot	SLOT#03 DT-HABITAT J3-5-6 (382'FNL & 1684'FEL, SEC.05)
Area	COLORADO	Well	DT-HABITAT J3-5-6
Field	WELD COUNTY (NAD83/TRUE NORTH)	Wellbore	DT-HABITAT J3-5-6 AWB
Facility	SEC.05-T05N-R65W		

## WELLPATH DATA (145 stations)

MD [ft]	Inclination [°]	Azimuth [°]	TVD [ft]	Vert Sect [ft]	North [ft]	East [ft]	DLS [°/100ft]	Comments
12539.00	89.060	271.430	7574.52	5908.71	-928.51	-5846.76	1.01	
12635.00	89.720	271.480	7575.55	6004.00	-926.07	-5942.72	0.69	
12731.00	90.400	271.230	7575.45	6099.32	-923.80	-6038.69	0.75	
12827.00	90.450	270.800	7574.73	6194.70	-922.10	-6134.68	0.45	
12923.00	90.920	270.240	7573.59	6290.16	-921.23	-6230.66	0.76	
13019.00	91.960	270.200	7571.17	6385.66	-920.86	-6326.63	1.08	
13115.00	92.070	270.290	7567.80	6481.12	-920.45	-6422.57	0.15	
13211.00	89.560	270.960	7566.43	6576.56	-919.40	-6518.55	2.71	
13307.00	89.130	271.240	7567.53	6671.92	-917.56	-6614.52	0.53	
13403.00	88.770	270.900	7569.29	6767.28	-915.77	-6710.49	0.52	
13497.00	88.760	272.050	7571.32	6860.56	-913.35	-6804.44	1.22	
13593.00	88.700	271.000	7573.44	6955.82	-910.80	-6900.38	1.10	
13689.00	88.700	272.180	7575.62	7051.06	-908.13	-6996.31	1.23	
13785.00	89.010	271.990	7577.54	7146.21	-904.64	-7092.23	0.38	
13881.00	88.920	272.840	7579.27	7241.28	-900.60	-7188.13	0.89	
13976.00	89.870	273.320	7580.28	7335.22	-895.49	-7282.99	1.12	
14263.00	90.520	273.090	7579.30	7618.92	-879.45	-7569.53	0.24	
14358.00	90.730	273.390	7578.26	7712.82	-874.08	-7664.38	0.39	
14548.00	89.660	273.170	7577.62	7900.60	-863.21	-7854.06	0.57	
14644.00	89.290	272.720	7578.50	7995.56	-858.28	-7949.93	0.61	
14740.00	89.260	271.990	7579.71	8090.65	-854.33	-8045.84	0.76	
14835.00	90.490	272.170	7579.92	8184.83	-850.88	-8140.77	1.31	
14931.00	90.360	274.230	7579.21	8279.72	-845.52	-8236.62	2.15	
15077.00	89.380	274.190	7579.54	8423.63	-834.81	-8382.22	0.67	LAST BHI MWD SURVEY
15135.00	89.380	274.190	7580.17	8480.81	-830.57	-8440.06	0.00	PROJECTION TO BIT



# Actual Wellpath Report

DT-HABITAT J3-5-6 AWP

Page 7 of 8



## REFERENCE WELLPATH IDENTIFICATION

Operator	EXTRACTION OIL & GAS	Slot	SLOT#03 DT-HABITAT J3-5-6 (382'FNL & 1684'FEL, SEC.05)
Area	COLORADO	Well	DT-HABITAT J3-5-6
Field	WELD COUNTY (NAD83/TRUE NORTH)	Wellbore	DT-HABITAT J3-5-6 AWB
Facility	SEC.05-T05N-R65W		

## HOLE & CASING SECTIONS - Ref Wellbore: DT-HABITAT J3-5-6 AWB Ref Wellpath: DT-HABITAT J3-5-6 AWP

String/Diameter	Start MD [ft]	End MD [ft]	Interval [ft]	Start TVD [ft]	End TVD [ft]	Start N/S [ft]	Start E/W [ft]	End N/S [ft]	End E/W [ft]
9.625in Casing Surface	15.00	1043.00	1028.00	15.00	1042.85	0.00	0.00	4.84	13.89
8.75in Open Hole	1043.00	8130.00	7087.00	1042.85	7578.00	4.84	13.89	-1121.50	-1445.00
7in Casing Intermediate	15.00	8114.00	8099.00	15.00	7577.33	0.00	0.00	-1121.19	-1429.02
6.125in Open Hole	8130.00	15135.00	7005.00	7578.00	7580.17	-1121.50	-1445.00	-830.57	-8440.06

## TARGETS

Name	TVD [ft]	North [ft]	East [ft]	Grid East [US ft]	Grid North [US ft]	Latitude	Longitude	Shape
SEC.05-T05N-R65W	0.00	32.79	0.00	3227217.29	1402549.71	40°26'07.908"N	104°41'01.428"W	polygon
SEC.06-T05N-R65W	0.00	32.79	0.00	3227217.29	1402549.71	40°26'07.908"N	104°41'01.428"W	polygon
SEC.05/06-T05N-R65W HARDLINES (460' SETBACK)	7090.00	32.79	0.00	3227217.29	1402549.71	40°26'07.908"N	104°41'01.428"W	polygon
DT-HABITAT J3-5-6 BHL ON PLAT REV-2 (1535'FNL & 460'FWL, SEC.06)	7550.00	-814.60	-8490.75	3218735.05	1401624.23	40°25'59.520"N	104°42'51.228"W	point
DT-HABITAT J3-5-6 TARGET 3	7550.00	-1073.08	-3123.81	3224103.92	1401415.18	40°25'56.978"N	104°41'41.824"W	point
DT-HABITAT J3-5-6 TARGET 4	7550.00	-1020.17	-4222.53	3223004.80	1401457.97	40°25'57.500"N	104°41'56.032"W	point
DT-HABITAT J3-5-6 TARGET 5	7550.00	-991.31	-4821.83	3222405.29	1401481.31	40°25'57.784"N	104°42'03.782"W	point
DT-HABITAT J3-5-6 TARGET 6	7550.00	-952.82	-5620.89	3221605.94	1401512.44	40°25'58.162"N	104°42'14.115"W	point
DT-HABITAT J3-5-6 TARGET 7	7550.00	-919.15	-6320.08	3220906.49	1401539.67	40°25'58.493"N	104°42'23.157"W	point
DT-HABITAT J3-5-6 TARGET 8	7550.00	-895.09	-6819.49	3220406.90	1401559.13	40°25'58.730"N	104°42'29.615"W	point
DT-HABITAT J3-5-6 BHL ON PLAT REV-1 (1535'FNL & 460'FWL, SEC.06)	7560.00	-814.60	-8490.75	3218735.05	1401624.23	40°25'59.520"N	104°42'51.228"W	point
DT-HABITAT J3-5-6 DRILLING CORRIDOR (60')	7560.00	0.00	0.00	3227217.59	1402516.92	40°26'07.584"N	104°41'01.428"W	polygon

## TARGETS

Name	TVD [ft]	North [ft]	East [ft]	Grid East [US ft]	Grid North [US ft]	Latitude	Longitude	Shape
DT-HABITAT J3-5-6 LANDING POINT	7560.00	-1125.69	-1408.65	3225819.42	1401378.36	40°25'56.460"N	104°41'19.644"W	point
DT-HABITAT J3-5-6 TARGET 2	7564.00	-1111.57	-2324.74	3224903.28	1401384.05	40°25'56.599"N	104°41'31.491"W	point

DT-HABITAT J3-5-6 LP REV-1	7580.00	-1155.69	-1408.65	3225819.70	1401348.36	40°25'56.164"N	104°41'19.644"W	point

WELLPATH COMPOSITION - Ref Wellbore: DT-HABITAT J3-5-6 AWB    Ref Wellpath: DT-HABITAT J3-5-6 AWP				
Start MD [ft]	End MD [ft]	Positional Uncertainty Model	Log Name/Comment	Wellbore
15.00	986.00	NaviTrak (Standard)	BHI MWD/NAVITRAK (STD) 13.5" HOLE <200-986>	DT-HABITAT J3-5-6 AWB
986.00	8063.00	NaviTrak (Standard)	BHI MWD/NAVITRAK (STD) 8.75" HOLE <1122-8063>	DT-HABITAT J3-5-6 AWB
8063.00	15077.00	NaviTrak (Standard)	BHI MWD/NAVITRAK (STD) 6.125" HOLE <8214-15077>	DT-HABITAT J3-5-6 AWB
15077.00	15135.00	Blind Drilling (std)	Projection to bit	DT-HABITAT J3-5-6 AWB



# Actual Wellpath Report

DT-HABITAT J3-5-6 AWP

Page 8 of 8



## REFERENCE WELLPATH IDENTIFICATION

Operator	EXTRACTION OIL & GAS	Slot	SLOT#03 DT-HABITAT J3-5-6 (382'FNL & 1684'FEL, SEC.05)
Area	COLORADO	Well	DT-HABITAT J3-5-6
Field	WELD COUNTY (NAD83/TRUE NORTH)	Wellbore	DT-HABITAT J3-5-6 AWB
Facility	SEC.05-T05N-R65W		

## WELLPATH COMMENTS

MD [ft]	Inclination [°]	Azimuth [°]	TVD [ft]	Comment
200.00	1.000	34.100	199.99	FIRST BHI MWD SURVEY
8093.00	86.903	269.286	7576.28	CROSSED 460' SETBACK
15077.00	89.380	274.190	7579.54	LAST BHI MWD SURVEY
15135.00	89.380	274.190	7580.17	PROJECTION TO BIT