

EXTRACTION OIL & GAS

Location: COLORADO Slot: SLOT#07 DT-MARTINEZ C5-5-6 (446'FNL & 1684'FEL, SEC.05)
Field: WELD COUNTY (NAD83/TRUE NORTH) Well: DT-MARTINEZ C5-5-6
Facility: SEC.05-T05N-R65W Wellbore: DT-MARTINEZ C5-5-6 PWB

Plot reference wellpath is DT-MARTINEZ C5-5-6 PWP (REV-B.0)

True vertical depths are referenced to SAVANNA 802 (15KB) (RKB)	Grid System: NAD83 / Lambert Colorado SP, Northern Zone (501), US feet
Measured depths are referenced to SAVANNA 802 (15KB) (RKB)	North Reference: True north
SAVANNA 802 (15KB) (RKB) to Mean Sea Level: 4655 feet	Scale: True distance
Mean Sea Level to Mud line (At Slot: SLOT#07 DT-MARTINEZ C5-5-6 (446'FNL & 1684'FEL, SEC.05)): 0 feet	Depths are in feet
Coordinates are in feet referenced to Slot	Created by: ingmjmr on 5/21/2015



BGGM (1945.0 to 2016.0) Dip: 66.95° Field: 52651.8 nT
Magnetic North is 8.43 degrees East of True North (at 3/2/2015)

To correct azimuth from Magnetic to True add 8.43 degrees

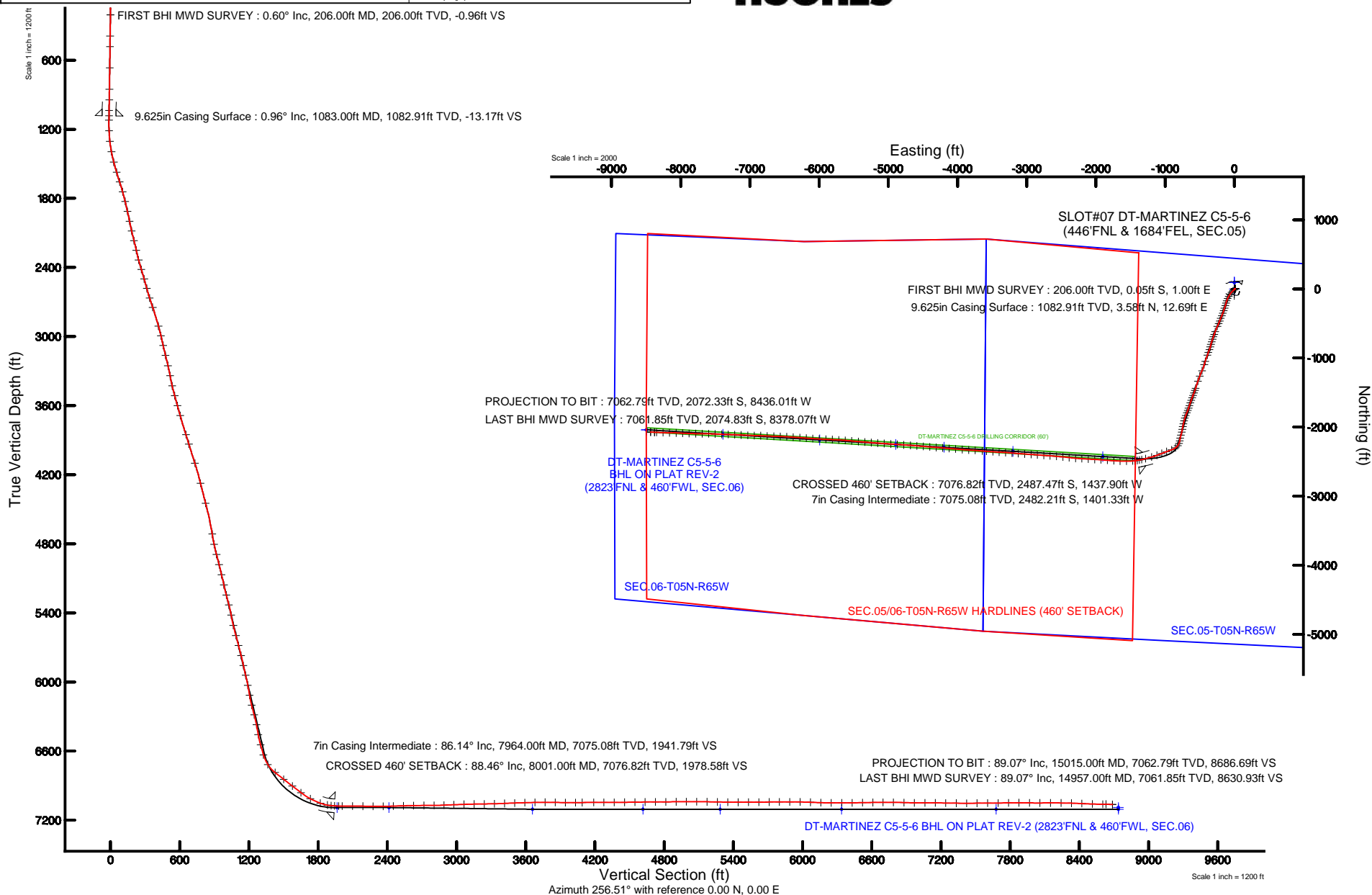



Actual Wellpath Report

DT-MARTINEZ C5-5-6 AWP

Page 1 of 9



REFERENCE WELLPATH IDENTIFICATION

Operator	EXTRACTION OIL & GAS	Slot	SLOT#07 DT-MARTINEZ C5-5-6 (446'FNL & 1684'FEL, SEC.05)
Area	COLORADO	Well	DT-MARTINEZ C5-5-6
Field	WELD COUNTY (NAD83/TRUE NORTH)	Wellbore	DT-MARTINEZ C5-5-6 AWB
Facility	SEC.05-T05N-R65W		

REPORT SETUP INFORMATION

Projection System	NAD83 / Lambert Colorado SP, Northern Zone (501), US feet	Software System	WellArchitect® 4.1.1
North Reference	True	User	Ingmjmr
Scale	0.999962	Report Generated	5/21/2015 at 2:22:36 PM
Convergence at slot	0.53° East	Database/Source file	Denver/DT-MARTINEZ_C5-5-6_AWB.xml

WELLPATH LOCATION

	Local coordinates		Grid coordinates		Geographic coordinates	
	North[ft]	East[ft]	Easting[US ft]	Northing[US ft]	Latitude	Longitude
Slot Location	-196.73	228.27	3227218.16	1402454.99	40°26'06.972"N	104°41'01.428"W
Facility Reference Pt			3226988.10	1402649.61	40°26'08.916"N	104°41'04.380"W
Field Reference Pt			3185481.27	1419166.81	40°28'55.560"N	104°49'59.556"W

WELLPATH DATUM

Calculation method	Minimum curvature	SAVANNA 802 (15'KB) (RKB) to Facility Vertical Datum	4655.00ft
Horizontal Reference Pt	Slot	SAVANNA 802 (15'KB) (RKB) to Mean Sea Level	4655.00ft
Vertical Reference Pt	SAVANNA 802 (15'KB) (RKB)	SAVANNA 802 (15'KB) (RKB) to Mud Line at Slot (SLOT#07 DT-MARTINEZ C5-5-6 (446'FNL & 1684'FEL, SEC.05))	4655.00ft
MD Reference Pt	SAVANNA 802 (15'KB) (RKB)	Section Origin	N 0.00, E 0.00 ft
Field Vertical Reference	Mean Sea Level	Section Azimuth	256.51°



Actual Wellpath Report

DT-MARTINEZ C5-5-6 AWP

Page 2 of 9



REFERENCE WELLPATH IDENTIFICATION

Operator	EXTRACTION OIL & GAS	Slot	SLOT#07 DT-MARTINEZ C5-5-6 (446'FNL & 1684'FEL, SEC.05)
Area	COLORADO	Well	DT-MARTINEZ C5-5-6
Field	WELD COUNTY (NAD83/TRUE NORTH)	Wellbore	DT-MARTINEZ C5-5-6 AWP
Facility	SEC.05-T05N-R65W		

WELLPATH DATA (154 stations) † = interpolated/extrapolated station

MD [ft]	Inclination [°]	Azimuth [°]	TVD [ft]	Vert Sect [ft]	North [ft]	East [ft]	DLS [°/100ft]	Comments
0.00†	0.000	92.960	0.00	0.00	0.00	0.00	0.00	
15.00	0.000	92.960	15.00	0.00	0.00	0.00	0.00	
206.00	0.600	92.960	206.00	-0.96	-0.05	1.00	0.31	FIRST BHI MWD SURVEY
390.00	1.060	59.320	389.98	-3.51	0.77	3.42	0.35	
482.00	0.640	48.990	481.97	-4.78	1.54	4.54	0.48	
667.00	0.730	82.660	666.95	-6.87	2.37	6.49	0.22	
852.00	0.990	87.460	851.93	-9.61	2.59	9.26	0.15	
944.00	0.920	67.630	943.92	-11.12	2.90	10.74	0.37	
1036.00	0.770	71.810	1035.91	-12.46	3.38	12.01	0.18	
1121.00	1.110	77.370	1120.90	-13.85	3.74	13.35	0.41	
1213.00	2.670	229.620	1212.87	-12.83	2.54	12.59	4.01	
1305.00	7.610	223.590	1304.48	-5.81	-3.26	6.75	5.39	
1397.00	12.400	228.770	1395.05	8.06	-14.19	-4.88	5.29	
1489.00	15.810	228.910	1484.26	27.92	-28.94	-21.76	3.71	
1582.00	20.240	222.840	1572.69	52.55	-49.08	-42.26	5.17	
1674.00	24.170	212.450	1657.88	79.35	-76.66	-63.20	6.02	
1766.00	22.560	208.320	1742.34	104.65	-108.09	-81.69	2.50	
1858.00	20.970	204.500	1827.78	126.55	-138.61	-96.89	2.31	
1951.00	23.750	199.090	1913.79	146.89	-171.46	-109.92	3.72	
2043.00	21.940	195.130	1998.57	165.10	-205.57	-120.46	2.58	
2135.00	24.330	197.100	2083.17	182.98	-240.28	-130.52	2.73	
2227.00	25.620	199.440	2166.57	203.44	-277.15	-142.72	1.77	
2319.00	23.460	196.680	2250.26	223.46	-313.46	-154.59	2.66	
2412.00	25.960	198.770	2334.74	243.63	-350.47	-166.46	2.85	
2504.00	27.320	203.550	2416.98	267.11	-388.89	-181.38	2.76	
2596.00	25.840	202.570	2499.25	291.63	-426.76	-197.51	1.68	
2688.00	25.060	200.210	2582.33	314.24	-463.56	-211.93	1.39	
2781.00	27.750	204.560	2665.62	338.52	-501.75	-227.74	3.56	
2873.00	28.900	204.560	2746.61	365.43	-541.45	-245.89	1.25	
3057.00	26.150	200.280	2909.78	415.39	-619.95	-278.43	1.84	



Actual Wellpath Report

DT-MARTINEZ C5-5-6 AWP

Page 3 of 9



REFERENCE WELLPATH IDENTIFICATION

Operator	EXTRACTION OIL & GAS	Slot	SLOT#07 DT-MARTINEZ C5-5-6 (446'FNL & 1684'FEL, SEC.05)
Area	COLORADO	Well	DT-MARTINEZ C5-5-6
Field	WELD COUNTY (NAD83/TRUE NORTH)	Wellbore	DT-MARTINEZ C5-5-6 AWP
Facility	SEC.05-T05N-R65W		

WELLPATH DATA (154 stations)

MD [ft]	Inclination [°]	Azimuth [°]	TVD [ft]	Vert Sect [ft]	North [ft]	East [ft]	DLS [°/100ft]	Comments
3149.00	24.950	199.210	2992.78	437.14	-657.29	-291.84	1.40	
3242.00	22.570	197.130	3077.90	456.83	-692.87	-303.55	2.71	
3335.00	24.000	200.010	3163.32	476.37	-727.70	-315.28	1.97	
3433.00	24.510	196.770	3252.67	497.61	-765.89	-327.97	1.45	
3529.00	22.960	195.010	3340.55	516.58	-803.05	-338.56	1.78	
3625.00	24.240	195.080	3428.52	534.95	-840.16	-348.54	1.33	
3720.00	26.340	201.010	3514.43	556.22	-878.68	-361.17	3.46	
3816.00	26.340	200.110	3600.46	580.07	-918.56	-376.13	0.42	
3912.00	27.750	199.440	3685.96	604.01	-959.64	-390.89	1.50	
4103.00	31.030	197.900	3852.36	653.84	-1048.44	-420.83	1.76	
4198.00	31.340	196.950	3933.63	679.11	-1095.37	-435.56	0.61	
4390.00	27.760	203.490	4100.67	731.34	-1184.19	-467.96	2.51	
4582.00	23.250	201.560	4273.92	780.03	-1260.49	-499.73	2.39	
4774.00	26.180	198.920	4448.32	824.50	-1335.82	-527.39	1.63	
5062.00	18.370	196.530	4714.63	881.35	-1439.58	-560.96	2.73	
5157.00	20.560	199.880	4804.19	898.02	-1469.63	-570.89	2.59	
5253.00	24.540	201.930	4892.84	918.86	-1503.99	-584.07	4.23	
5349.00	23.830	199.950	4980.41	941.10	-1540.71	-598.14	1.12	
5445.00	22.680	201.030	5068.61	962.28	-1576.22	-611.39	1.28	
5541.00	23.380	197.930	5156.96	982.70	-1611.62	-623.90	1.46	
5637.00	25.000	200.140	5244.53	1003.87	-1648.79	-636.75	1.93	
5733.00	25.800	199.200	5331.25	1026.39	-1687.56	-650.61	0.93	
5829.00	21.390	194.430	5419.21	1045.88	-1724.27	-661.85	5.00	
5925.00	22.230	201.760	5508.36	1064.56	-1758.09	-672.94	2.97	
6021.00	24.340	202.650	5596.53	1086.71	-1793.22	-687.29	2.23	
6117.00	25.490	201.070	5683.60	1110.10	-1830.76	-702.34	1.38	
6213.00	26.250	196.100	5769.99	1132.31	-1870.43	-715.66	2.39	
6309.00	25.230	193.680	5856.46	1152.14	-1910.71	-726.38	1.53	
6404.00	27.270	193.780	5941.66	1171.36	-1951.53	-736.36	2.15	
6500.00	24.840	190.240	6027.90	1189.55	-1992.74	-745.18	3.00	



Actual Wellpath Report

DT-MARTINEZ C5-5-6 AWP

Page 4 of 9



REFERENCE WELLPATH IDENTIFICATION

Operator	EXTRACTION OIL & GAS	Slot	SLOT#07 DT-MARTINEZ C5-5-6 (446'FNL & 1684'FEL, SEC.05)
Area	COLORADO	Well	DT-MARTINEZ C5-5-6
Field	WELD COUNTY (NAD83/TRUE NORTH)	Wellbore	DT-MARTINEZ C5-5-6 AWP
Facility	SEC.05-T05N-R65W		

WELLPATH DATA (154 stations) † = interpolated/extrapolated station

MD [ft]	Inclination [°]	Azimuth [°]	TVD [ft]	Vert Sect [ft]	North [ft]	East [ft]	DLS [°/100ft]	Comments
6596.00	24.630	189.690	6115.10	1205.54	-2032.30	-752.13	0.32	
6692.00	27.150	193.790	6201.46	1223.46	-2073.30	-760.72	3.22	
6787.00	29.930	196.670	6284.91	1245.31	-2117.07	-772.69	3.26	
6883.00	24.540	189.610	6370.26	1265.19	-2159.71	-782.90	6.54	
6978.00	24.030	189.890	6456.85	1280.60	-2198.22	-789.51	0.55	
7074.00	24.860	203.980	6544.32	1300.66	-2235.94	-801.08	6.12	
7170.00	21.620	212.440	6632.55	1325.65	-2269.32	-818.78	4.84	
7265.00	34.680	235.030	6716.36	1363.65	-2299.80	-850.54	17.53	
7360.00	51.290	249.790	6785.78	1426.20	-2328.37	-908.02	20.35	
7456.00	52.800	249.670	6844.83	1501.37	-2354.59	-979.02	1.58	
7551.00	52.160	249.230	6902.69	1576.14	-2381.04	-1049.58	0.77	
7647.00	52.580	249.300	6961.30	1651.57	-2407.96	-1120.68	0.44	
7743.00	61.760	253.850	7013.31	1731.83	-2433.26	-1197.15	10.35	
7839.00	70.190	255.500	7052.36	1819.39	-2456.37	-1281.65	8.92	
7902.00	80.450	258.090	7068.31	1880.24	-2470.24	-1340.90	16.76	
7934.00	84.260	258.330	7072.56	1911.94	-2476.72	-1371.94	11.93	
8001.00†	88.456	263.144	7076.82	1978.58	-2487.47	-1437.90	9.52	CROSSED 460' SETBACK
8031.00	90.340	265.290	7077.14	2008.31	-2490.49	-1467.74	9.52	
8123.00	89.690	270.690	7077.11	2098.43	-2493.72	-1559.65	5.91	
8215.00	89.140	272.030	7078.05	2187.35	-2491.53	-1651.62	1.57	
8307.00	90.180	273.890	7078.60	2275.58	-2486.78	-1743.49	2.32	
8400.00	89.600	274.150	7078.78	2364.27	-2480.26	-1836.26	0.68	
8492.00	91.940	274.120	7077.54	2451.93	-2473.63	-1928.01	2.54	
8584.00	91.510	273.560	7074.77	2539.72	-2467.47	-2019.76	0.77	
8676.00	90.770	273.060	7072.94	2627.77	-2462.16	-2111.59	0.97	
8769.00	90.400	273.260	7071.99	2716.86	-2457.03	-2204.44	0.45	
8861.00	90.270	274.870	7071.45	2804.57	-2450.51	-2296.20	1.76	
8953.00	92.650	277.170	7069.11	2891.25	-2440.87	-2387.65	3.60	
9045.00	91.950	274.790	7065.42	2977.91	-2431.29	-2479.07	2.69	
9137.00	91.720	274.770	7062.47	3065.23	-2423.63	-2570.71	0.25	



Actual Wellpath Report

DT-MARTINEZ C5-5-6 AWP

Page 5 of 9



REFERENCE WELLPATH IDENTIFICATION

Operator	EXTRACTION OIL & GAS	Slot	SLOT#07 DT-MARTINEZ C5-5-6 (446'FNL & 1684'FEL, SEC.05)
Area	COLORADO	Well	DT-MARTINEZ C5-5-6
Field	WELD COUNTY (NAD83/TRUE NORTH)	Wellbore	DT-MARTINEZ C5-5-6 AWB
Facility	SEC.05-T05N-R65W		

WELLPATH DATA (154 stations)

MD [ft]	Inclination [°]	Azimuth [°]	TVD [ft]	Vert Sect [ft]	North [ft]	East [ft]	DLS [°/100ft]	Comments
9230.00	91.270	274.530	7060.04	3153.57	-2416.10	-2663.37	0.55	
9322.00	90.550	273.970	7058.58	3241.19	-2409.28	-2755.10	0.99	
9414.00	91.390	275.010	7057.03	3328.68	-2402.08	-2846.80	1.45	
9506.00	92.310	273.910	7054.06	3416.15	-2394.93	-2938.48	1.56	
9599.00	91.840	273.840	7050.69	3504.85	-2388.65	-3031.20	0.51	
9691.00	91.570	274.490	7047.95	3592.48	-2381.97	-3122.92	0.76	
9783.00	91.410	275.070	7045.56	3679.81	-2374.30	-3214.57	0.65	
9875.00	89.900	273.430	7044.51	3767.42	-2367.49	-3306.30	2.42	
9967.00	88.730	272.740	7045.61	3855.59	-2362.54	-3398.16	1.48	
10060.00	88.950	274.070	7047.49	3944.56	-2357.01	-3490.97	1.45	
10152.00	91.060	274.490	7047.48	4032.16	-2350.15	-3582.71	2.34	
10213.00	90.860	274.850	7046.46	4090.11	-2345.18	-3643.50	0.68	
10317.00	90.430	274.120	7045.29	4189.03	-2337.05	-3747.17	0.81	
10409.00	89.820	273.220	7045.09	4276.93	-2331.16	-3838.98	1.18	
10504.00	90.590	274.930	7044.75	4367.49	-2324.41	-3933.74	1.97	
10598.00	89.970	274.620	7044.29	4456.76	-2316.59	-4027.41	0.74	
10692.00	91.030	274.830	7043.47	4546.04	-2308.84	-4121.09	1.15	
10786.00	90.620	274.540	7042.11	4635.34	-2301.17	-4214.76	0.53	
10880.00	89.880	274.090	7041.70	4724.83	-2294.09	-4308.49	0.92	
10974.00	90.950	274.540	7041.02	4814.33	-2287.02	-4402.22	1.23	
11068.00	90.310	274.600	7039.99	4903.69	-2279.53	-4495.92	0.68	
11161.00	90.400	275.060	7039.41	4991.97	-2271.70	-4588.59	0.50	
11255.00	89.970	274.230	7039.11	5081.30	-2264.09	-4682.28	0.99	
11350.00	88.950	273.970	7040.01	5171.85	-2257.30	-4777.03	1.11	
11444.00	88.990	273.950	7041.70	5261.51	-2250.81	-4870.79	0.05	
11539.00	89.200	273.970	7043.20	5352.12	-2244.25	-4965.55	0.22	
11633.00	89.840	274.000	7043.98	5441.78	-2237.72	-5059.32	0.68	
11727.00	90.490	274.060	7043.71	5531.42	-2231.11	-5153.09	0.69	
11821.00	90.400	274.410	7042.98	5620.95	-2224.17	-5246.83	0.38	
11915.00	90.700	274.820	7042.08	5710.29	-2216.61	-5340.52	0.54	



Actual Wellpath Report

DT-MARTINEZ C5-5-6 AWP

Page 6 of 9



REFERENCE WELLPATH IDENTIFICATION

Operator	EXTRACTION OIL & GAS	Slot	SLOT#07 DT-MARTINEZ C5-5-6 (446'FNL & 1684'FEL, SEC.05)
Area	COLORADO	Well	DT-MARTINEZ C5-5-6
Field	WELD COUNTY (NAD83/TRUE NORTH)	Wellbore	DT-MARTINEZ C5-5-6 AWP
Facility	SEC.05-T05N-R65W		

WELLPATH DATA (154 stations)

MD [ft]	Inclination [°]	Azimuth [°]	TVD [ft]	Vert Sect [ft]	North [ft]	East [ft]	DLS [°/100ft]	Comments
12009.00	90.240	275.040	7041.31	5799.47	-2208.53	-5434.17	0.54	
12104.00	90.150	275.050	7040.99	5889.54	-2200.17	-5528.80	0.10	
12198.00	88.880	274.800	7041.78	5978.72	-2192.10	-5622.44	1.38	
12292.00	88.180	273.250	7044.19	6068.33	-2185.51	-5716.18	1.81	
12386.00	87.710	272.300	7047.56	6158.51	-2180.96	-5810.01	1.13	
12480.00	90.210	273.100	7049.27	6248.76	-2176.53	-5903.88	2.79	
12575.00	89.560	272.940	7049.46	6339.84	-2171.53	-5998.75	0.70	
12669.00	90.950	274.020	7049.04	6429.74	-2165.82	-6092.57	1.87	
12763.00	90.890	274.180	7047.53	6519.33	-2159.10	-6186.31	0.18	
12857.00	90.950	274.290	7046.02	6608.86	-2152.16	-6280.05	0.13	
12951.00	90.520	274.090	7044.82	6698.41	-2145.29	-6373.79	0.50	
13045.00	89.350	273.090	7044.92	6788.26	-2139.41	-6467.60	1.64	
13139.00	88.300	272.000	7046.85	6878.58	-2135.24	-6561.48	1.61	
13233.00	89.130	272.060	7048.96	6969.13	-2131.91	-6655.40	0.89	
13328.00	90.250	272.480	7049.47	7060.55	-2128.14	-6750.32	1.26	
13421.00	89.660	272.040	7049.55	7150.06	-2124.48	-6843.25	0.79	
13515.00	89.020	271.350	7050.63	7240.77	-2121.70	-6937.20	1.00	
13610.00	89.230	272.470	7052.08	7332.34	-2118.53	-7032.14	1.20	
13704.00	90.030	273.040	7052.69	7422.59	-2114.01	-7126.02	1.04	
13798.00	90.770	272.330	7052.03	7512.86	-2109.61	-7219.92	1.09	
13892.00	89.750	271.010	7051.60	7603.58	-2106.87	-7313.87	1.77	
13987.00	91.090	272.340	7050.91	7695.27	-2104.09	-7408.83	1.99	
14081.00	91.080	272.550	7049.13	7785.64	-2100.08	-7502.72	0.22	
14175.00	89.940	271.390	7048.29	7876.23	-2096.85	-7596.66	1.73	
14269.00	88.470	269.870	7049.60	7967.38	-2095.82	-7690.64	2.25	
14363.00	90.470	271.670	7050.47	8058.47	-2094.56	-7784.62	2.86	
14458.00	90.030	271.680	7050.05	8150.16	-2091.78	-7879.58	0.46	
14552.00	89.690	273.150	7050.28	8240.55	-2087.82	-7973.49	1.61	
14646.00	88.150	271.510	7052.05	8330.97	-2084.00	-8067.39	2.39	
14740.00	87.320	270.600	7055.77	8421.88	-2082.27	-8161.30	1.31	



Actual Wellpath Report

DT-MARTINEZ C5-5-6 AWP

Page 7 of 9



REFERENCE WELLPATH IDENTIFICATION

Operator	EXTRACTION OIL & GAS	Slot	SLOT#07 DT-MARTINEZ C5-5-6 (446'FNL & 1684'FEL, SEC.05)
Area	COLORADO	Well	DT-MARTINEZ C5-5-6
Field	WELD COUNTY (NAD83/TRUE NORTH)	Wellbore	DT-MARTINEZ C5-5-6 AWB
Facility	SEC.05-T05N-R65W		

WELLPATH DATA (154 stations)

MD [ft]	Inclination [°]	Azimuth [°]	TVD [ft]	Vert Sect [ft]	North [ft]	East [ft]	DLS [°/100ft]	Comments
14834.00	88.390	272.390	7059.29	8512.62	-2079.82	-8255.20	2.22	
14928.00	89.060	272.240	7061.38	8603.04	-2076.02	-8349.10	0.73	
14957.00	89.070	272.470	7061.85	8630.93	-2074.83	-8378.07	0.79	LAST BHI MWD SURVEY
15015.00	89.070	272.470	7062.79	8686.69	-2072.33	-8436.01	0.00	PROJECTION TO BIT

HOLE & CASING SECTIONS - Ref Wellbore: DT-MARTINEZ C5-5-6 AWB Ref Wellpath: DT-MARTINEZ C5-5-6 AWP

String/Diameter	Start MD [ft]	End MD [ft]	Interval [ft]	Start TVD [ft]	End TVD [ft]	Start N/S [ft]	Start E/W [ft]	End N/S [ft]	End E/W [ft]
9.625in Casing Surface	15.00	1083.00	1068.00	15.00	1082.91	0.00	0.00	3.58	12.69
8.75in Open Hole	15.00	7999.00	7984.00	15.00	7076.77	0.00	0.00	-2487.23	-1435.92
7in Casing Intermediate	15.00	7964.00	7949.00	15.00	7075.08	0.00	0.00	-2482.21	-1401.33
6.125in Open Hole	7999.00	15015.00	7016.00	7076.77	7062.79	-2487.23	-1435.92	-2072.33	-8436.01

TARGETS

Name	TVD [ft]	North [ft]	East [ft]	Grid East [US ft]	Grid North [US ft]	Latitude	Longitude	Shape
SEC.05-T05N-R65W	0.00	94.72	0.00	3227217.29	1402549.71	40°26'07.908"N	104°41'01.428"W	polygon
SEC.06-T05N-R65W	0.00	94.72	0.00	3227217.29	1402549.71	40°26'07.908"N	104°41'01.428"W	polygon
DT-MARTINEZ C5-5-6 BHL ON PLAT REV-1 (2823'FNL & 460'FWL, SEC.06)	7090.00	-2038.70	-8496.76	3218740.87	1400338.25	40°25'46.812"N	104°42'51.300"W	point
DT-MARTINEZ C5-5-6 DRILLING CORRIDOR (60')	7090.00	0.00	0.00	3227218.16	1402454.99	40°26'06.972"N	104°41'01.428"W	polygon
DT-MARTINEZ C5-5-6 LANDING POINT	7090.00	-2455.44	-1431.00	3225809.88	1399986.59	40°25'42.708"N	104°41'19.932"W	point
DT-MARTINEZ C5-5-6 TARGET 2	7090.00	-2426.76	-1900.81	3225339.85	1400010.94	40°25'42.991"N	104°41'26.007"W	point
SEC.05/06-T05N-R65W HARDLINES (460' SETBACK)	7090.00	94.72	0.00	3227217.29	1402549.71	40°26'07.908"N	104°41'01.428"W	polygon
DT-MARTINEZ C5-5-6 BHL ON PLAT REV-2 (2823'FNL & 460'FWL, SEC.06)	7105.00	-2038.70	-8496.76	3218740.87	1400338.25	40°25'46.812"N	104°42'51.300"W	point
DT-MARTINEZ C5-5-6 TARGET 3	7105.00	-2350.41	-3198.56	3224041.50	1400075.34	40°25'43.744"N	104°41'42.788"W	point
DT-MARTINEZ C5-5-6 TARGET 4	7105.00	-2291.68	-4196.83	3223042.77	1400124.87	40°25'44.323"N	104°41'55.697"W	point
DT-MARTINEZ C5-5-6 TARGET 5	7105.00	-2250.56	-4895.62	3222343.66	1400159.56	40°25'44.728"N	104°42'04.733"W	point
DT-MARTINEZ C5-5-6 TARGET 6	7105.00	-2185.96	-5993.72	3221245.06	1400214.04	40°25'45.364"N	104°42'18.933"W	point

TARGETS

Name	TVD [ft]	North [ft]	East [ft]	Grid East [US ft]	Grid North [US ft]	Latitude	Longitude	Shape
DT-MARTINEZ C5-5-6 TARGET 7	7105.00	-2103.73	-7391.30	3219846.84	1400283.40	40°25'46.173"N	104°42'37.005"W	point



Actual Wellpath Report

DT-MARTINEZ C5-5-6 AWP

Page 8 of 9



REFERENCE WELLPATH IDENTIFICATION

Operator	EXTRACTION OIL & GAS	Slot	SLOT#07 DT-MARTINEZ C5-5-6 (446'FNL & 1684'FEL, SEC.05)
Area	COLORADO	Well	DT-MARTINEZ C5-5-6
Field	WELD COUNTY (NAD83/TRUE NORTH)	Wellbore	DT-MARTINEZ C5-5-6 AWB
Facility	SEC.05-T05N-R65W		

WELLPATH COMPOSITION - Ref Wellbore: DT-MARTINEZ C5-5-6 AWB Ref Wellpath: DT-MARTINEZ C5-5-6 AWP

Start MD [ft]	End MD [ft]	Positional Uncertainty Model	Log Name/Comment	Wellbore
15.00	1036.00	NaviTrak (Standard)	BHI MWD/NAVITRAK (STD) 13.5" HOLE <206-1036>	DT-MARTINEZ C5-5-6 AWB
1036.00	7934.00	NaviTrak (Standard)	BHI MWD/NAVITRAK (STD) 8.75" HOLE <1121-7934>	DT-MARTINEZ C5-5-6 AWB
7934.00	14957.00	OnTrak (Standard)	BHI MWD/ONTRAK (STD) 6.125" HOLE <8031-14957>	DT-MARTINEZ C5-5-6 AWB
14957.00	15015.00	Blind Drilling (std)	Projection to bit	DT-MARTINEZ C5-5-6 AWB



Actual Wellpath Report

DT-MARTINEZ C5-5-6 AWP

Page 9 of 9



REFERENCE WELLPATH IDENTIFICATION

Operator	EXTRACTION OIL & GAS	Slot	SLOT#07 DT-MARTINEZ C5-5-6 (446'FNL & 1684'FEL, SEC.05)
Area	COLORADO	Well	DT-MARTINEZ C5-5-6
Field	WELD COUNTY (NAD83/TRUE NORTH)	Wellbore	DT-MARTINEZ C5-5-6 AWB
Facility	SEC.05-T05N-R65W		

WELLPATH COMMENTS

MD [ft]	Inclination [°]	Azimuth [°]	TVD [ft]	Comment
206.00	0.600	92.960	206.00	FIRST BHI MWD SURVEY
8001.00	88.456	263.144	7076.82	CROSSED 460' SETBACK
14957.00	89.070	272.470	7061.85	LAST BHI MWD SURVEY
15015.00	89.070	272.470	7062.79	PROJECTION TO BIT