

Physical Address: 345 Comanche St.
Mail to: Box 384, Kiowa, CO 80117
Ph. 303-621-8672 - Fax 303-621-7749
www.highprairiesurvey.com

Job # 15256 RODWELL #14-31

Inv # 3991

High Prairie Surveying of Kiowa, Colorado, in accordance with a request from **Apollo Operating LLC**, has determined the location of **RODWELL #14-31** to be **600 feet FSL**, and **600 feet FWL**, (90° off Section lines) of **SECTION 31**, Township **4s**, Range **51w** of the 6th Principal Meridian, **Washington County**, Colorado.

Date: Staked on 06/03/15 drawn on 06/18/15.

Re: Staked by Elijah Frane
Drawn: Drawn by Dustin Cott

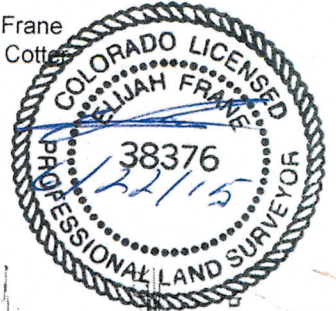

Access Road Map

