

KERR-MCGEE OIL & GAS ONSHORE LP (LAMBERT STATE PLANE COORD)

Location: COLORADO Slot: SLOT#21 GOODIN 37N-A6HZ (412°FSL & 1525°FEL, SEC.07)
 Field: WELD COUNTY (KERR MCGEE) Well: GOODIN 37N-A6HZ
 Facility: SEC.07-T1N-R65W Wellbore: GOODIN 37N-A6HZ PWB

| | |
|--|--|
| Plot reference wellpath is GOODIN 37N-A6HZ (REV-C.0) PWB | |
| True vertical depths are referenced to H&P 307 (25KB) (RKB) | Grid System: NAD83 / Lambert Colorado SP, Northern Zone (501), US feet |
| Measured depths are referenced to H&P 307 (25KB) (RKB) | North Reference: True north |
| H&P 307 (25KB) (RKB) to Mean Sea Level: 5004 feet | Scale: True distance |
| Mean Sea Level to Mud line (At Slot: SLOT#21 GOODIN 37N-A6HZ (412°FSL & 1525°FEL, SEC.07)): 0 feet | Depths are in feet |
| Coordinates are in feet referenced to Slot | |
| Created by: precain on 3/27/2015 | |

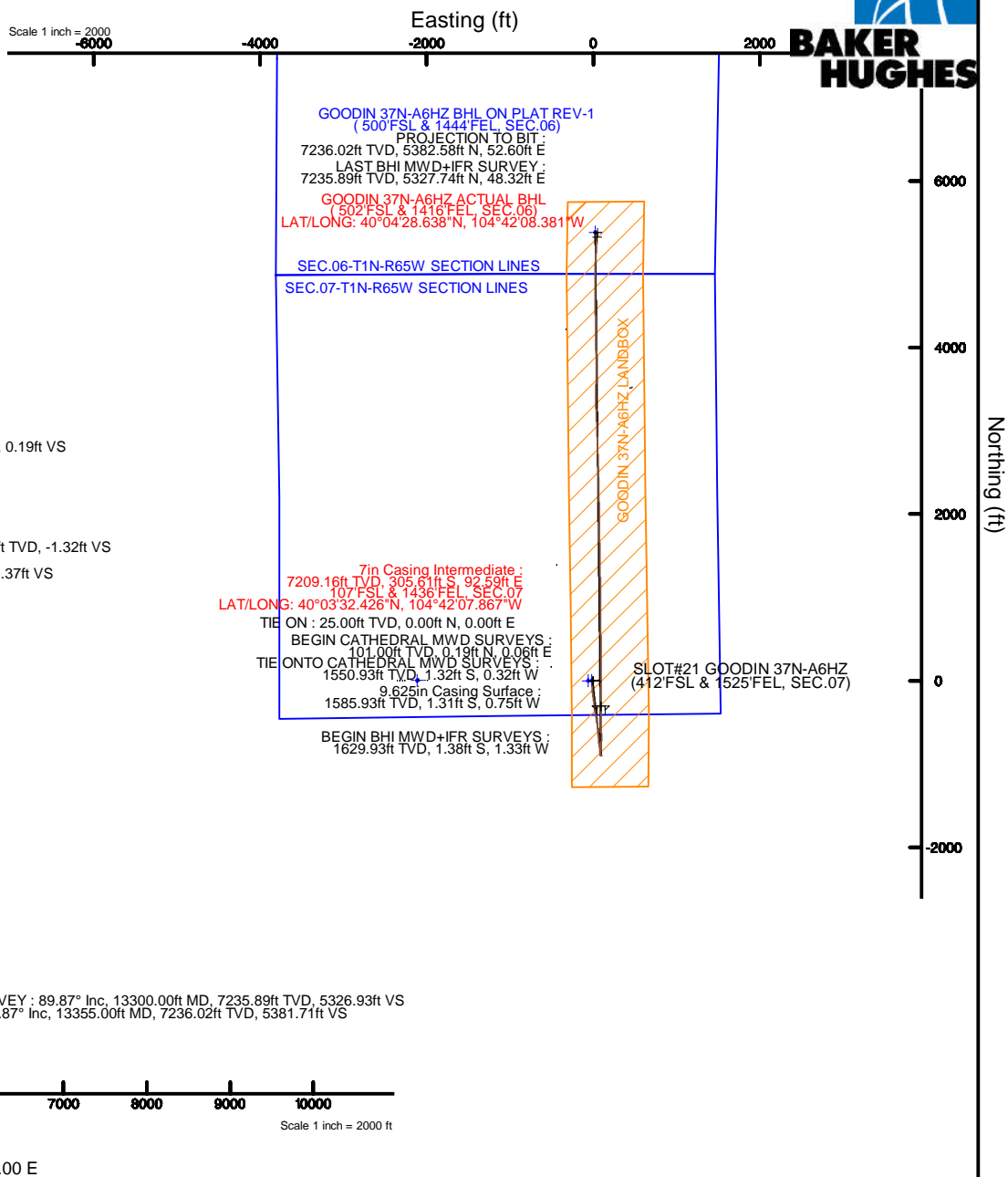

REFERENCE WELLPATH IDENTIFICATION

| | | | |
|----------|---|----------|--|
| Operator | KERR-MCGEE OIL & GAS ONSHORE LP (LAMBERT STATE PLANE COORD) | Slot | SLOT#21 GOODIN 37N-A6HZ (412'FSL & 1525'FEL, SEC.07) |
| Area | COLORADO | Well | GOODIN 37N-A6HZ |
| Field | WELD COUNTY (KERR MCGEE) | Wellbore | GOODIN 37N-A6HZ AWB <101-13355> |
| Facility | SEC.07-T1N-R65W | | |

REPORT SETUP INFORMATION

| | | | |
|---------------------|---|----------------------|---|
| Projection System | NAD83 / Lambert Colorado SP, Northern Zone (501), US feet | Software System | WellArchitect® 4.1.1 |
| North Reference | True | User | Precain |
| Scale | 0.999962 | Report Generated | 3/27/2015 at 1:48:29 PM |
| Convergence at slot | 0.52° East | Database/Source file | WellArchitectDC/GOODIN_37N-A6HZ_AWB__101-13355_.xml |

WELLPATH LOCATION

| | Local coordinates | | Grid coordinates | | Geographic coordinates | |
|-----------------------|-------------------|----------|------------------|-----------------|------------------------|-----------------|
| | North[ft] | East[ft] | Easting[US ft] | Northing[US ft] | Latitude | Longitude |
| Slot Location | -79.31 | -1043.55 | 3223218.91 | 1265651.02 | 40°03'35.446"N | 104°42'09.058"W |
| Facility Reference Pt | | | 3224261.66 | 1265739.76 | 40°03'36.230"N | 104°41'55.637"W |
| Field Reference Pt | | | 3197771.84 | 1268891.29 | 40°04'09.600"N | 104°47'36.000"W |

WELLPATH DATUM

| | | | |
|--------------------------|-----------------------|--|-------------------|
| Calculation method | Minimum curvature | H&P 307 (25'KB) (RKB) to Facility Vertical Datum | 5004.00ft |
| Horizontal Reference Pt | Slot | H&P 307 (25'KB) (RKB) to Mean Sea Level | 5004.00ft |
| Vertical Reference Pt | H&P 307 (25'KB) (RKB) | H&P 307 (25'KB) (RKB) to Mud Line at Slot (SLOT#21 GOODIN 37N-A6HZ (412'FSL & 1525'FEL, SEC.07)) | 5004.00ft |
| MD Reference Pt | H&P 307 (25'KB) (RKB) | Section Origin | N 0.00, E 0.00 ft |
| Field Vertical Reference | Mean Sea Level | Section Azimuth | 0.56° |

REFERENCE WELLPATH IDENTIFICATION

| | | | |
|----------|---|----------|--|
| Operator | KERR-MCGEE OIL & GAS ONSHORE LP (LAMBERT STATE PLANE COORD) | Slot | SLOT#21 GOODIN 37N-A6HZ (412'FSL & 1525'FEL, SEC.07) |
| Area | COLORADO | Well | GOODIN 37N-A6HZ |
| Field | WELD COUNTY (KERR MCGEE) | Wellbore | GOODIN 37N-A6HZ AWB <101-13355> |
| Facility | SEC.07-T1N-R65W | | |

WELLPATH DATA (149 stations) † = interpolated/extrapolated station

| MD [ft] | Inclination [°] | Azimuth [°] | TVD [ft] | Vert Sect [ft] | North [ft] | East [ft] | Latitude | Longitude | DLS [°/100ft] | Comments |
|------------|--------------------|----------------|-------------|-------------------|---------------|--------------|----------------|-----------------|------------------|--------------------------------|
| 0.00† | 0.000 | 16.200 | 0.00 | 0.00 | 0.00 | 0.00 | 40°03'35.446"N | 104°42'09.058"W | 0.00 | |
| 25.00 | 0.000 | 16.200 | 25.00 | 0.00 | 0.00 | 0.00 | 40°03'35.446"N | 104°42'09.058"W | 0.00 | TIE ON |
| 101.00 | 0.300 | 16.200 | 101.00 | 0.19 | 0.19 | 0.06 | 40°03'35.448"N | 104°42'09.057"W | 0.39 | BEGIN CATHEDRAL MWD SURVEYS |
| 179.00 | 0.400 | 347.500 | 179.00 | 0.65 | 0.65 | 0.05 | 40°03'35.452"N | 104°42'09.057"W | 0.25 | |
| 257.00 | 0.500 | 352.100 | 257.00 | 1.26 | 1.26 | -0.05 | 40°03'35.458"N | 104°42'09.059"W | 0.14 | |
| 338.00 | 0.500 | 338.500 | 337.99 | 1.93 | 1.93 | -0.23 | 40°03'35.465"N | 104°42'09.061"W | 0.15 | |
| 418.00 | 0.500 | 344.400 | 417.99 | 2.59 | 2.60 | -0.45 | 40°03'35.472"N | 104°42'09.064"W | 0.06 | |
| 498.00 | 0.600 | 354.400 | 497.99 | 3.34 | 3.35 | -0.59 | 40°03'35.479"N | 104°42'09.066"W | 0.17 | |
| 578.00 | 0.200 | 0.900 | 577.98 | 3.90 | 3.91 | -0.63 | 40°03'35.485"N | 104°42'09.066"W | 0.50 | |
| 658.00 | 0.200 | 118.500 | 657.98 | 3.97 | 3.98 | -0.50 | 40°03'35.485"N | 104°42'09.064"W | 0.43 | |
| 738.00 | 0.300 | 128.400 | 737.98 | 3.78 | 3.78 | -0.21 | 40°03'35.483"N | 104°42'09.061"W | 0.14 | |
| 818.00 | 0.300 | 120.100 | 817.98 | 3.55 | 3.55 | 0.13 | 40°03'35.481"N | 104°42'09.056"W | 0.05 | |
| 898.00 | 0.300 | 126.200 | 897.98 | 3.32 | 3.32 | 0.48 | 40°03'35.479"N | 104°42'09.052"W | 0.04 | |
| 978.00 | 0.600 | 145.000 | 977.98 | 2.86 | 2.85 | 0.89 | 40°03'35.474"N | 104°42'09.047"W | 0.41 | |
| 1058.00 | 0.600 | 148.300 | 1057.97 | 2.16 | 2.15 | 1.35 | 40°03'35.467"N | 104°42'09.041"W | 0.04 | |
| 1138.00 | 0.800 | 147.600 | 1137.97 | 1.34 | 1.32 | 1.87 | 40°03'35.459"N | 104°42'09.034"W | 0.25 | |
| 1218.00 | 0.900 | 146.600 | 1217.96 | 0.35 | 0.33 | 2.52 | 40°03'35.449"N | 104°42'09.026"W | 0.13 | |
| 1298.00 | 0.700 | 221.400 | 1297.95 | -0.54 | -0.56 | 2.54 | 40°03'35.440"N | 104°42'09.025"W | 1.23 | |
| 1378.00 | 0.700 | 249.100 | 1377.95 | -1.09 | -1.10 | 1.76 | 40°03'35.435"N | 104°42'09.035"W | 0.42 | |
| 1458.00 | 0.700 | 265.100 | 1457.94 | -1.31 | -1.32 | 0.82 | 40°03'35.433"N | 104°42'09.048"W | 0.24 | |
| 1551.00 | 0.700 | 274.900 | 1550.93 | -1.32 | -1.32 | -0.32 | 40°03'35.433"N | 104°42'09.062"W | 0.13 | TIE ONTO CATHEDRAL MWD SURVEYS |
| 1630.00 | 0.780 | 259.020 | 1629.93 | -1.39 | -1.38 | -1.33 | 40°03'35.432"N | 104°42'09.075"W | 0.28 | BEGIN BHI MWD+IFR SURVEYS |
| 1725.00 | 1.070 | 168.620 | 1724.92 | -2.39 | -2.37 | -1.79 | 40°03'35.423"N | 104°42'09.081"W | 1.40 | |
| 1820.00 | 1.980 | 187.680 | 1819.89 | -4.89 | -4.87 | -1.83 | 40°03'35.398"N | 104°42'09.082"W | 1.08 | |
| 1914.00 | 3.570 | 179.850 | 1913.77 | -9.43 | -9.41 | -2.04 | 40°03'35.353"N | 104°42'09.084"W | 1.73 | |
| 2009.00 | 5.110 | 180.430 | 2008.50 | -16.62 | -16.60 | -2.06 | 40°03'35.282"N | 104°42'09.085"W | 1.62 | |
| 2104.00 | 6.860 | 187.290 | 2102.98 | -26.48 | -26.45 | -2.81 | 40°03'35.185"N | 104°42'09.094"W | 1.99 | |
| 2199.00 | 8.570 | 187.960 | 2197.11 | -39.14 | -39.09 | -4.51 | 40°03'35.060"N | 104°42'09.116"W | 1.80 | |
| 2293.00 | 10.610 | 188.300 | 2289.80 | -54.66 | -54.59 | -6.73 | 40°03'34.906"N | 104°42'09.145"W | 2.17 | |
| 2388.00 | 12.830 | 183.960 | 2382.81 | -73.86 | -73.77 | -8.73 | 40°03'34.717"N | 104°42'09.170"W | 2.51 | |
| 2482.00 | 14.420 | 181.150 | 2474.16 | -95.98 | -95.89 | -9.68 | 40°03'34.498"N | 104°42'09.183"W | 1.83 | |
| 2577.00 | 16.330 | 175.980 | 2565.76 | -121.12 | -121.04 | -8.98 | 40°03'34.250"N | 104°42'09.174"W | 2.47 | |
| 2671.00 | 18.640 | 174.300 | 2655.41 | -149.23 | -149.18 | -6.56 | 40°03'33.972"N | 104°42'09.142"W | 2.52 | |
| 2765.00 | 19.900 | 172.800 | 2744.15 | -180.02 | -180.00 | -3.07 | 40°03'33.667"N | 104°42'09.097"W | 1.44 | |
| 2860.00 | 21.500 | 169.190 | 2833.02 | -213.11 | -213.14 | 2.23 | 40°03'33.340"N | 104°42'09.029"W | 2.15 | |
| 2954.00 | 22.650 | 174.120 | 2920.13 | -247.99 | -248.07 | 7.31 | 40°03'32.995"N | 104°42'08.964"W | 2.32 | |
| 3048.00 | 24.570 | 174.910 | 3006.26 | -285.42 | -285.54 | 10.90 | 40°03'32.624"N | 104°42'08.918"W | 2.07 | |
| 3143.00 | 26.190 | 172.510 | 3092.09 | -325.84 | -326.01 | 15.39 | 40°03'32.224"N | 104°42'08.860"W | 2.02 | |
| 3237.00 | 24.260 | 171.010 | 3177.12 | -365.43 | -365.65 | 21.11 | 40°03'31.833"N | 104°42'08.787"W | 2.16 | |
| 3425.00 | 18.500 | 167.090 | 3352.12 | -432.58 | -432.93 | 33.82 | 40°03'31.168"N | 104°42'08.623"W | 3.16 | |
| 3519.00 | 17.350 | 168.870 | 3441.56 | -460.81 | -461.22 | 39.86 | 40°03'30.888"N | 104°42'08.545"W | 1.35 | |
| 3613.00 | 14.400 | 173.130 | 3531.96 | -486.13 | -486.58 | 43.96 | 40°03'30.637"N | 104°42'08.493"W | 3.37 | |
| 3708.00 | 11.230 | 166.400 | 3624.59 | -506.82 | -507.31 | 47.55 | 40°03'30.433"N | 104°42'08.446"W | 3.68 | |
| 3802.00 | 10.170 | 170.300 | 3716.96 | -523.86 | -524.39 | 51.10 | 40°03'30.264"N | 104°42'08.401"W | 1.37 | |
| 3896.00 | 11.190 | 175.610 | 3809.33 | -541.12 | -541.66 | 53.20 | 40°03'30.093"N | 104°42'08.374"W | 1.51 | |

REFERENCE WELLPATH IDENTIFICATION

| | | | |
|----------|---|----------|--|
| Operator | KERR-MCGEE OIL & GAS ONSHORE LP (LAMBERT STATE PLANE COORD) | Slot | SLOT#21 GOODIN 37N-A6HZ (412'FSL & 1525'FEL, SEC.07) |
| Area | COLORADO | Well | GOODIN 37N-A6HZ |
| Field | WELD COUNTY (KERR MCGEE) | Wellbore | GOODIN 37N-A6HZ AWB <101-13355> |
| Facility | SEC.07-T1N-R65W | | |

WELLPATH DATA (149 stations) † = interpolated/extrapolated station

| MD [ft] | Inclination [°] | Azimuth [°] | TVD [ft] | Vert Sect [ft] | North [ft] | East [ft] | Latitude | Longitude | DLS [°/100ft] | Comments |
|----------|-----------------|-------------|----------|----------------|------------|-----------|----------------|-----------------|---------------|-----------------|
| 3990.00 | 11.370 | 177.410 | 3901.51 | -559.46 | -560.01 | 54.31 | 40°03'29.912"N | 104°42'08.359"W | 0.42 | |
| 4084.00 | 12.650 | 170.870 | 3993.46 | -578.86 | -579.43 | 56.37 | 40°03'29.720"N | 104°42'08.333"W | 1.99 | |
| 4179.00 | 11.560 | 173.400 | 4086.35 | -598.55 | -599.16 | 59.11 | 40°03'29.525"N | 104°42'08.298"W | 1.28 | |
| 4273.00 | 12.740 | 175.810 | 4178.24 | -618.23 | -618.85 | 60.95 | 40°03'29.330"N | 104°42'08.274"W | 1.37 | |
| 4367.00 | 14.240 | 177.920 | 4269.64 | -640.11 | -640.75 | 62.13 | 40°03'29.114"N | 104°42'08.259"W | 1.68 | |
| 4461.00 | 14.320 | 178.040 | 4360.74 | -663.27 | -663.92 | 62.94 | 40°03'28.885"N | 104°42'08.248"W | 0.09 | |
| 4555.00 | 12.360 | 175.300 | 4452.20 | -684.91 | -685.57 | 64.17 | 40°03'28.671"N | 104°42'08.233"W | 2.19 | |
| 4649.00 | 13.680 | 175.630 | 4543.78 | -706.00 | -706.68 | 65.84 | 40°03'28.462"N | 104°42'08.211"W | 1.41 | |
| 4743.00 | 13.730 | 178.700 | 4635.11 | -728.22 | -728.91 | 66.94 | 40°03'28.243"N | 104°42'08.197"W | 0.78 | |
| 4838.00 | 12.590 | 166.220 | 4727.63 | -749.53 | -750.24 | 69.66 | 40°03'28.032"N | 104°42'08.162"W | 3.21 | |
| 4932.00 | 11.760 | 165.350 | 4819.51 | -768.70 | -769.46 | 74.52 | 40°03'27.842"N | 104°42'08.100"W | 0.90 | |
| 5026.00 | 10.920 | 176.330 | 4911.69 | -786.82 | -787.62 | 77.52 | 40°03'27.663"N | 104°42'08.061"W | 2.46 | |
| 5120.00 | 10.980 | 180.350 | 5003.98 | -804.65 | -805.45 | 78.03 | 40°03'27.486"N | 104°42'08.054"W | 0.81 | |
| 5215.00 | 11.800 | 178.640 | 5097.11 | -823.41 | -824.21 | 78.21 | 40°03'27.301"N | 104°42'08.052"W | 0.93 | |
| 5309.00 | 10.860 | 173.560 | 5189.28 | -841.81 | -842.62 | 79.43 | 40°03'27.119"N | 104°42'08.037"W | 1.46 | |
| 5403.00 | 9.400 | 168.020 | 5281.81 | -858.09 | -858.93 | 82.02 | 40°03'26.958"N | 104°42'08.003"W | 1.87 | |
| 5497.00 | 8.570 | 166.280 | 5374.66 | -872.37 | -873.24 | 85.27 | 40°03'26.816"N | 104°42'07.961"W | 0.93 | |
| 5591.00 | 5.960 | 163.100 | 5467.89 | -883.81 | -884.72 | 88.35 | 40°03'26.703"N | 104°42'07.922"W | 2.81 | |
| 5685.00 | 4.450 | 155.130 | 5561.50 | -891.76 | -892.70 | 91.30 | 40°03'26.624"N | 104°42'07.884"W | 1.78 | |
| 5780.00 | 1.880 | 130.430 | 5656.36 | -896.09 | -897.05 | 94.04 | 40°03'26.581"N | 104°42'07.849"W | 3.00 | |
| 5874.00 | 1.360 | 122.510 | 5750.32 | -897.67 | -898.65 | 96.15 | 40°03'26.565"N | 104°42'07.821"W | 0.60 | |
| 5968.00 | 1.500 | 122.610 | 5844.29 | -898.91 | -899.92 | 98.13 | 40°03'26.553"N | 104°42'07.796"W | 0.15 | |
| 6062.00 | 0.620 | 332.840 | 5938.28 | -899.12 | -900.13 | 98.94 | 40°03'26.551"N | 104°42'07.786"W | 2.19 | |
| 6251.00 | 1.320 | 293.370 | 6127.25 | -897.37 | -898.35 | 96.47 | 40°03'26.568"N | 104°42'07.817"W | 0.49 | |
| 6346.00 | 0.890 | 221.360 | 6222.24 | -897.50 | -898.47 | 94.98 | 40°03'26.567"N | 104°42'07.837"W | 1.42 | |
| 6440.00 | 1.170 | 245.070 | 6316.22 | -898.47 | -899.43 | 93.63 | 40°03'26.558"N | 104°42'07.854"W | 0.54 | |
| 6534.00 | 0.500 | 304.430 | 6410.21 | -898.65 | -899.60 | 92.42 | 40°03'26.556"N | 104°42'07.869"W | 1.08 | |
| 6660.00 | 0.980 | 278.640 | 6536.20 | -898.19 | -899.13 | 90.90 | 40°03'26.561"N | 104°42'07.889"W | 0.45 | |
| 6723.00 | 2.280 | 329.790 | 6599.18 | -897.04 | -897.96 | 89.74 | 40°03'26.572"N | 104°42'07.904"W | 2.91 | |
| 6770.00 | 6.370 | 353.280 | 6646.04 | -893.65 | -894.56 | 88.96 | 40°03'26.606"N | 104°42'07.914"W | 9.31 | |
| 6817.00 | 10.070 | 2.230 | 6692.55 | -886.95 | -887.86 | 88.81 | 40°03'26.672"N | 104°42'07.916"W | 8.31 | |
| 6911.00 | 18.350 | 3.530 | 6783.59 | -863.92 | -864.84 | 90.05 | 40°03'26.899"N | 104°42'07.900"W | 8.81 | |
| 7006.00 | 25.000 | 4.100 | 6871.83 | -828.91 | -829.86 | 92.41 | 40°03'27.245"N | 104°42'07.870"W | 7.00 | |
| 7100.00 | 34.110 | 3.030 | 6953.51 | -782.66 | -783.63 | 95.22 | 40°03'27.702"N | 104°42'07.833"W | 9.71 | |
| 7194.00 | 43.340 | 2.590 | 7026.77 | -723.96 | -724.95 | 98.08 | 40°03'28.282"N | 104°42'07.797"W | 9.82 | |
| 7288.00 | 52.970 | 358.400 | 7089.42 | -654.05 | -655.04 | 98.49 | 40°03'28.973"N | 104°42'07.791"W | 10.77 | |
| 7382.00 | 61.350 | 356.410 | 7140.35 | -575.27 | -576.22 | 94.86 | 40°03'29.752"N | 104°42'07.838"W | 9.09 | |
| 7477.00 | 70.970 | 359.670 | 7178.71 | -488.57 | -489.50 | 91.98 | 40°03'30.609"N | 104°42'07.875"W | 10.60 | |
| 7524.00 | 76.950 | 0.560 | 7191.69 | -443.43 | -444.35 | 92.08 | 40°03'31.055"N | 104°42'07.874"W | 12.85 | |
| 7571.00 | 81.920 | 359.940 | 7200.31 | -397.24 | -398.16 | 92.28 | 40°03'31.511"N | 104°42'07.871"W | 10.65 | |
| 7634.00 | 85.650 | 0.340 | 7207.13 | -334.62 | -335.54 | 92.43 | 40°03'32.130"N | 104°42'07.869"W | 5.95 | |
| 7664.00† | 86.574 | 0.277 | 7209.16 | -304.69 | -305.61 | 92.59 | 40°03'32.426"N | 104°42'07.867"W | 3.09 | 7" CASING POINT |
| 7696.00 | 87.560 | 0.210 | 7210.80 | -272.73 | -273.65 | 92.73 | 40°03'32.742"N | 104°42'07.865"W | 3.09 | |
| 7728.00 | 87.960 | 0.120 | 7212.05 | -240.76 | -241.68 | 92.82 | 40°03'33.058"N | 104°42'07.864"W | 1.28 | |
| 7822.00 | 89.440 | 0.070 | 7214.18 | -146.79 | -147.70 | 92.97 | 40°03'33.986"N | 104°42'07.862"W | 1.58 | |

REFERENCE WELLPATH IDENTIFICATION

| | | | |
|----------|---|----------|--|
| Operator | KERR-MCGEE OIL & GAS ONSHORE LP (LAMBERT STATE PLANE COORD) | Slot | SLOT#21 GOODIN 37N-A6HZ (412'FSL & 1525'FEL, SEC.07) |
| Area | COLORADO | Well | GOODIN 37N-A6HZ |
| Field | WELD COUNTY (KERR MCGEE) | Wellbore | GOODIN 37N-A6HZ AWB <101-13355> |
| Facility | SEC.07-T1N-R65W | | |

WELLPATH DATA (149 stations)

| MD [ft] | Inclination [°] | Azimuth [°] | TVD [ft] | Vert Sect [ft] | North [ft] | East [ft] | Latitude | Longitude | DLS [°/100ft] | Comments |
|----------|-----------------|-------------|----------|----------------|------------|-----------|----------------|-----------------|---------------|----------|
| 7919.00 | 90.860 | 359.980 | 7213.93 | -49.80 | -50.71 | 93.02 | 40°03'34.945"N | 104°42'07.862"W | 1.47 | |
| 8012.00 | 89.930 | 359.250 | 7213.29 | 43.19 | 42.29 | 92.39 | 40°03'35.864"N | 104°42'07.870"W | 1.27 | |
| 8106.00 | 90.430 | 0.410 | 7212.99 | 137.18 | 136.28 | 92.11 | 40°03'36.793"N | 104°42'07.873"W | 1.34 | |
| 8201.00 | 89.750 | 359.470 | 7212.84 | 232.17 | 231.28 | 92.01 | 40°03'37.732"N | 104°42'07.875"W | 1.22 | |
| 8296.00 | 89.870 | 0.080 | 7213.16 | 327.16 | 326.28 | 91.64 | 40°03'38.670"N | 104°42'07.879"W | 0.65 | |
| 8390.00 | 89.070 | 359.780 | 7214.03 | 421.15 | 420.28 | 91.53 | 40°03'39.599"N | 104°42'07.881"W | 0.91 | |
| 8485.00 | 88.790 | 359.730 | 7215.80 | 516.12 | 515.26 | 91.12 | 40°03'40.538"N | 104°42'07.886"W | 0.30 | |
| 8579.00 | 88.110 | 359.110 | 7218.34 | 610.07 | 609.22 | 90.17 | 40°03'41.466"N | 104°42'07.898"W | 0.98 | |
| 8674.00 | 89.200 | 359.610 | 7220.57 | 705.02 | 704.18 | 89.11 | 40°03'42.405"N | 104°42'07.912"W | 1.26 | |
| 8768.00 | 90.430 | 359.090 | 7220.88 | 799.00 | 798.18 | 88.04 | 40°03'43.334"N | 104°42'07.926"W | 1.42 | |
| 8863.00 | 90.150 | 359.680 | 7220.40 | 893.98 | 893.17 | 87.02 | 40°03'44.272"N | 104°42'07.939"W | 0.69 | |
| 8958.00 | 89.900 | 359.820 | 7220.36 | 988.97 | 988.17 | 86.61 | 40°03'45.211"N | 104°42'07.944"W | 0.30 | |
| 9052.00 | 90.120 | 359.120 | 7220.34 | 1082.95 | 1082.16 | 85.74 | 40°03'46.140"N | 104°42'07.955"W | 0.78 | |
| 9146.00 | 91.380 | 359.470 | 7219.11 | 1176.92 | 1176.15 | 84.58 | 40°03'47.069"N | 104°42'07.970"W | 1.39 | |
| 9241.00 | 89.900 | 359.230 | 7218.05 | 1271.89 | 1271.13 | 83.50 | 40°03'48.008"N | 104°42'07.984"W | 1.58 | |
| 9336.00 | 89.960 | 358.470 | 7218.16 | 1366.84 | 1366.11 | 81.60 | 40°03'48.946"N | 104°42'08.009"W | 0.80 | |
| 9430.00 | 90.860 | 358.970 | 7217.49 | 1460.79 | 1460.08 | 79.50 | 40°03'49.875"N | 104°42'08.036"W | 1.10 | |
| 9525.00 | 91.010 | 359.600 | 7215.94 | 1555.75 | 1555.06 | 78.31 | 40°03'50.813"N | 104°42'08.051"W | 0.68 | |
| 9619.00 | 89.530 | 359.030 | 7215.50 | 1649.73 | 1649.05 | 77.19 | 40°03'51.742"N | 104°42'08.065"W | 1.69 | |
| 9713.00 | 90.370 | 358.980 | 7215.58 | 1743.69 | 1743.04 | 75.56 | 40°03'52.671"N | 104°42'08.086"W | 0.90 | |
| 9807.00 | 89.750 | 359.500 | 7215.48 | 1837.67 | 1837.03 | 74.31 | 40°03'53.600"N | 104°42'08.102"W | 0.86 | |
| 9901.00 | 89.290 | 358.560 | 7216.27 | 1931.63 | 1931.01 | 72.72 | 40°03'54.529"N | 104°42'08.123"W | 1.11 | |
| 9995.00 | 90.520 | 359.610 | 7216.42 | 2025.59 | 2024.99 | 71.22 | 40°03'55.457"N | 104°42'08.142"W | 1.72 | |
| 10089.00 | 89.440 | 359.090 | 7216.46 | 2119.57 | 2118.99 | 70.15 | 40°03'56.386"N | 104°42'08.156"W | 1.28 | |
| 10183.00 | 89.500 | 359.310 | 7217.33 | 2213.54 | 2212.97 | 68.84 | 40°03'57.315"N | 104°42'08.173"W | 0.24 | |
| 10278.00 | 89.070 | 358.460 | 7218.51 | 2308.49 | 2307.95 | 66.99 | 40°03'58.254"N | 104°42'08.196"W | 1.00 | |
| 10372.00 | 88.520 | 357.910 | 7220.49 | 2402.39 | 2401.88 | 64.01 | 40°03'59.182"N | 104°42'08.235"W | 0.83 | |
| 10466.00 | 90.000 | 359.420 | 7221.70 | 2496.32 | 2495.84 | 61.82 | 40°04'00.110"N | 104°42'08.263"W | 2.25 | |
| 10560.00 | 89.560 | 359.190 | 7222.06 | 2590.30 | 2589.83 | 60.68 | 40°04'01.039"N | 104°42'08.277"W | 0.53 | |
| 10655.00 | 87.560 | 357.430 | 7224.45 | 2685.19 | 2684.75 | 57.88 | 40°04'01.977"N | 104°42'08.313"W | 2.80 | |
| 10749.00 | 86.690 | 357.230 | 7229.17 | 2778.92 | 2778.53 | 53.51 | 40°04'02.904"N | 104°42'08.370"W | 0.95 | |
| 10843.00 | 88.240 | 358.450 | 7233.32 | 2872.72 | 2872.37 | 49.97 | 40°04'03.831"N | 104°42'08.415"W | 2.10 | |
| 10937.00 | 89.720 | 358.720 | 7235.00 | 2966.65 | 2966.32 | 47.65 | 40°04'04.760"N | 104°42'08.445"W | 1.60 | |
| 11032.00 | 88.180 | 357.070 | 7236.74 | 3061.52 | 3061.24 | 44.16 | 40°04'05.698"N | 104°42'08.490"W | 2.38 | |
| 11126.00 | 90.460 | 357.420 | 7237.85 | 3155.35 | 3155.11 | 39.64 | 40°04'06.626"N | 104°42'08.548"W | 2.45 | |
| 11221.00 | 90.980 | 357.400 | 7236.66 | 3250.20 | 3250.01 | 35.35 | 40°04'07.563"N | 104°42'08.603"W | 0.55 | |
| 11315.00 | 92.180 | 0.330 | 7234.07 | 3344.11 | 3343.94 | 33.49 | 40°04'08.492"N | 104°42'08.627"W | 3.37 | |
| 11410.00 | 90.550 | 359.850 | 7231.80 | 3439.08 | 3438.91 | 33.64 | 40°04'09.430"N | 104°42'08.625"W | 1.79 | |
| 11504.00 | 89.500 | 0.830 | 7231.76 | 3533.07 | 3532.91 | 34.20 | 40°04'10.359"N | 104°42'08.618"W | 1.53 | |
| 11598.00 | 89.530 | 0.910 | 7232.56 | 3627.07 | 3626.89 | 35.62 | 40°04'11.288"N | 104°42'08.600"W | 0.09 | |
| 11693.00 | 89.190 | 0.010 | 7233.62 | 3722.06 | 3721.88 | 36.39 | 40°04'12.226"N | 104°42'08.590"W | 1.01 | |
| 11787.00 | 89.190 | 359.840 | 7234.95 | 3816.05 | 3815.87 | 36.26 | 40°04'13.155"N | 104°42'08.592"W | 0.18 | |
| 11881.00 | 88.180 | 359.330 | 7237.11 | 3910.01 | 3909.85 | 35.58 | 40°04'14.084"N | 104°42'08.600"W | 1.20 | |
| 11975.00 | 88.120 | 358.850 | 7240.14 | 4003.93 | 4003.78 | 34.09 | 40°04'15.012"N | 104°42'08.619"W | 0.51 | |
| 12070.00 | 88.270 | 358.500 | 7243.13 | 4098.83 | 4098.71 | 31.90 | 40°04'15.950"N | 104°42'08.648"W | 0.40 | |

REFERENCE WELLPATH IDENTIFICATION

| | | | |
|----------|---|----------|--|
| Operator | KERR-MCGEE OIL & GAS ONSHORE LP (LAMBERT STATE PLANE COORD) | Slot | SLOT#21 GOODIN 37N-A6HZ (412'FSL & 1525'FEL, SEC.07) |
| Area | COLORADO | Well | GOODIN 37N-A6HZ |
| Field | WELD COUNTY (KERR MCGEE) | Wellbore | GOODIN 37N-A6HZ AWB <101-13355> |
| Facility | SEC.07-T1N-R65W | | |

WELLPATH DATA (149 stations)

| MD [ft] | Inclination [°] | Azimuth [°] | TVD [ft] | Vert Sect [ft] | North [ft] | East [ft] | Latitude | Longitude | DLS [°/100ft] | Comments |
|----------|-----------------|-------------|----------|----------------|------------|-----------|----------------|-----------------|---------------|-------------------------|
| 12164.00 | 88.670 | 359.310 | 7245.64 | 4192.75 | 4192.66 | 30.10 | 40°04'16.879"N | 104°42'08.671"W | 0.96 | |
| 12258.00 | 90.610 | 359.540 | 7246.23 | 4286.73 | 4286.65 | 29.16 | 40°04'17.808"N | 104°42'08.683"W | 2.08 | |
| 12353.00 | 90.790 | 358.840 | 7245.07 | 4381.69 | 4381.63 | 27.81 | 40°04'18.746"N | 104°42'08.700"W | 0.76 | |
| 12447.00 | 91.410 | 358.640 | 7243.27 | 4475.63 | 4475.59 | 25.75 | 40°04'19.675"N | 104°42'08.727"W | 0.69 | |
| 12541.00 | 90.740 | 359.430 | 7241.51 | 4569.58 | 4569.56 | 24.16 | 40°04'20.603"N | 104°42'08.747"W | 1.10 | |
| 12636.00 | 89.590 | 359.560 | 7241.23 | 4664.56 | 4664.55 | 23.33 | 40°04'21.542"N | 104°42'08.758"W | 1.22 | |
| 12730.00 | 90.370 | 0.110 | 7241.26 | 4758.55 | 4758.55 | 23.06 | 40°04'22.471"N | 104°42'08.761"W | 1.02 | |
| 12824.00 | 90.770 | 359.980 | 7240.33 | 4852.54 | 4852.55 | 23.13 | 40°04'23.400"N | 104°42'08.760"W | 0.45 | |
| 12919.00 | 90.330 | 1.760 | 7239.42 | 4947.53 | 4947.53 | 24.57 | 40°04'24.339"N | 104°42'08.742"W | 1.93 | |
| 13013.00 | 90.300 | 3.460 | 7238.90 | 5041.47 | 5041.43 | 28.85 | 40°04'25.266"N | 104°42'08.687"W | 1.81 | |
| 13108.00 | 90.430 | 3.880 | 7238.30 | 5136.33 | 5136.23 | 34.93 | 40°04'26.203"N | 104°42'08.609"W | 0.46 | |
| 13202.00 | 91.290 | 3.820 | 7236.88 | 5230.16 | 5230.01 | 41.24 | 40°04'27.130"N | 104°42'08.527"W | 0.92 | |
| 13300.00 | 89.870 | 4.460 | 7235.89 | 5327.96 | 5327.74 | 48.32 | 40°04'28.096"N | 104°42'08.436"W | 1.59 | LAST BHI MWD+IFR SURVEY |
| 13355.00 | 89.870 | 4.460 | 7236.02 | 5382.83 | 5382.58 | 52.60 | 40°04'28.638"N | 104°42'08.381"W | 0.00 | PROJECTION TO BIT |

HOLE & CASING SECTIONS - Ref Wellbore: GOODIN 37N-A6HZ AWB <101-13355> Ref Wellpath: GOODIN 37N-A6HZ AWP

| String/Diameter | Start MD [ft] | End MD [ft] | Interval [ft] | Start TVD [ft] | End TVD [ft] | Start N/S [ft] | Start E/W [ft] | End N/S [ft] | End E/W [ft] |
|-------------------------|---------------|-------------|---------------|----------------|--------------|----------------|----------------|--------------|--------------|
| 13.5in Open Hole | 25.00 | 1596.00 | 1571.00 | 25.00 | 1595.93 | 0.00 | 0.00 | -1.32 | -0.88 |
| 9.625in Casing Surface | 25.00 | 1586.00 | 1561.00 | 25.00 | 1585.93 | 0.00 | 0.00 | -1.31 | -0.75 |
| 8.75in Open Hole | 1596.00 | 7682.00 | 6086.00 | 1595.93 | 7210.15 | -1.32 | -0.88 | -287.64 | 92.67 |
| 7in Casing Intermediate | 25.00 | 7664.00 | 7639.00 | 25.00 | 7209.16 | 0.00 | 0.00 | -305.61 | 92.59 |
| 6.125in Open Hole | 7682.00 | 13355.00 | 5673.00 | 7210.15 | 7236.02 | -287.64 | 92.67 | 5382.58 | 52.60 |

TARGETS

| Name | TVD [ft] | North [ft] | East [ft] | Grid East [US ft] | Grid North [US ft] | Latitude | Longitude | Shape |
|---|----------|------------|-----------|-------------------|--------------------|----------------|-----------------|---------|
| SEC.06-T1N-R65W SECTION LINES | -14.00 | 4.44 | -2112.22 | 3221106.82 | 1265636.47 | 40°03'35.489"N | 104°42'36.223"W | polygon |
| SEC.07-T1N-R65W SECTION LINES | 0.00 | 0.30 | -60.18 | 3223158.73 | 1265650.78 | 40°03'35.449"N | 104°42'09.832"W | polygon |
| GOODIN 37N-A6HZ BHL ON PLAT REV-1 (500'FSL & 1444'FEL, SEC.06) | 7239.00 | 5383.45 | 26.06 | 3223196.55 | 1271034.28 | 40°04'28.646"N | 104°42'08.723"W | point |
| GOODIN 37N-A6HZ LANDBOX | 7239.00 | 0.00 | -15.08 | 3223203.82 | 1265650.89 | 40°03'35.446"N | 104°42'09.252"W | polygon |

REFERENCE WELLPATH IDENTIFICATION

| | | | |
|----------|---|----------|--|
| Operator | KERR-MCGEE OIL & GAS ONSHORE LP (LAMBERT STATE PLANE COORD) | Slot | SLOT#21 GOODIN 37N-A6HZ (412'FSL & 1525'FEL, SEC.07) |
| Area | COLORADO | Well | GOODIN 37N-A6HZ |
| Field | WELD COUNTY (KERR MCGEE) | Wellbore | GOODIN 37N-A6HZ AWB <101-13355> |
| Facility | SEC.07-T1N-R65W | | |

WELLPATH COMPOSITION - Ref Wellbore: GOODIN 37N-A6HZ AWB <101-13355> Ref Wellpath: GOODIN 37N-A6HZ AWP

| Start MD [ft] | End MD [ft] | Positional Uncertainty Model | Log Name/Comment | Wellbore |
|---------------|-------------|-------------------------------|---|---------------------------------|
| 25.00 | 1551.00 | ISCWSA MWD, Rev. 2 (Standard) | CATHEDRAL MWD SURVEYS <101-1551> | GOODIN 37N-A6HZ AWB <101-13355> |
| 1551.00 | 7634.00 | NaviTrak (MAGCORR,IFR) | BHI NAVITRAK MWD+IFR 8 3/4" <1630-7634> | GOODIN 37N-A6HZ AWB <101-13355> |
| 7634.00 | 13300.00 | NaviTrak (MAGCORR,IFR) | BHI NAVITRAK MWD+IFR 6 1/8" <7696-1300> | GOODIN 37N-A6HZ AWB <101-13355> |
| 13300.00 | 13355.00 | Blind Drilling (std) | Projection to bit | GOODIN 37N-A6HZ AWB <101-13355> |

Actual Wellpath Report

GOODIN 37N-A6HZ AWP

Page 7 of 7

REFERENCE WELLPATH IDENTIFICATION

| | | | |
|----------|---|----------|--|
| Operator | KERR-MCGEE OIL & GAS ONSHORE LP (LAMBERT STATE PLANE COORD) | Slot | SLOT#21 GOODIN 37N-A6HZ (412'FSL & 1525'FEL, SEC.07) |
| Area | COLORADO | Well | GOODIN 37N-A6HZ |
| Field | WELD COUNTY (KERR MCGEE) | Wellbore | GOODIN 37N-A6HZ AWB <101-13355> |
| Facility | SEC.07-T1N-R65W | | |

WELLPATH COMMENTS

| MD [ft] | Inclination [°] | Azimuth [°] | TVD [ft] | Comment |
|------------|--------------------|----------------|-------------|--------------------------------|
| 25.00 | 0.000 | 16.200 | 25.00 | TIE ON |
| 101.00 | 0.300 | 16.200 | 101.00 | BEGIN CATHEDRAL MWD SURVEYS |
| 1551.00 | 0.700 | 274.900 | 1550.93 | TIE ONTO CATHEDRAL MWD SURVEYS |
| 1630.00 | 0.780 | 259.020 | 1629.93 | BEGIN BHI MWD+IFR SURVEYS |
| 7664.00 | 86.574 | 0.277 | 7209.16 | 7" CASING POINT |
| 13300.00 | 89.870 | 4.460 | 7235.89 | LAST BHI MWD+IFR SURVEY |
| 13355.00 | 89.870 | 4.460 | 7236.02 | PROJECTION TO BIT |