



Lat40°, Inc. 6250 W. 10th Street, Unit 2, Greeley, CO 970-515-5294







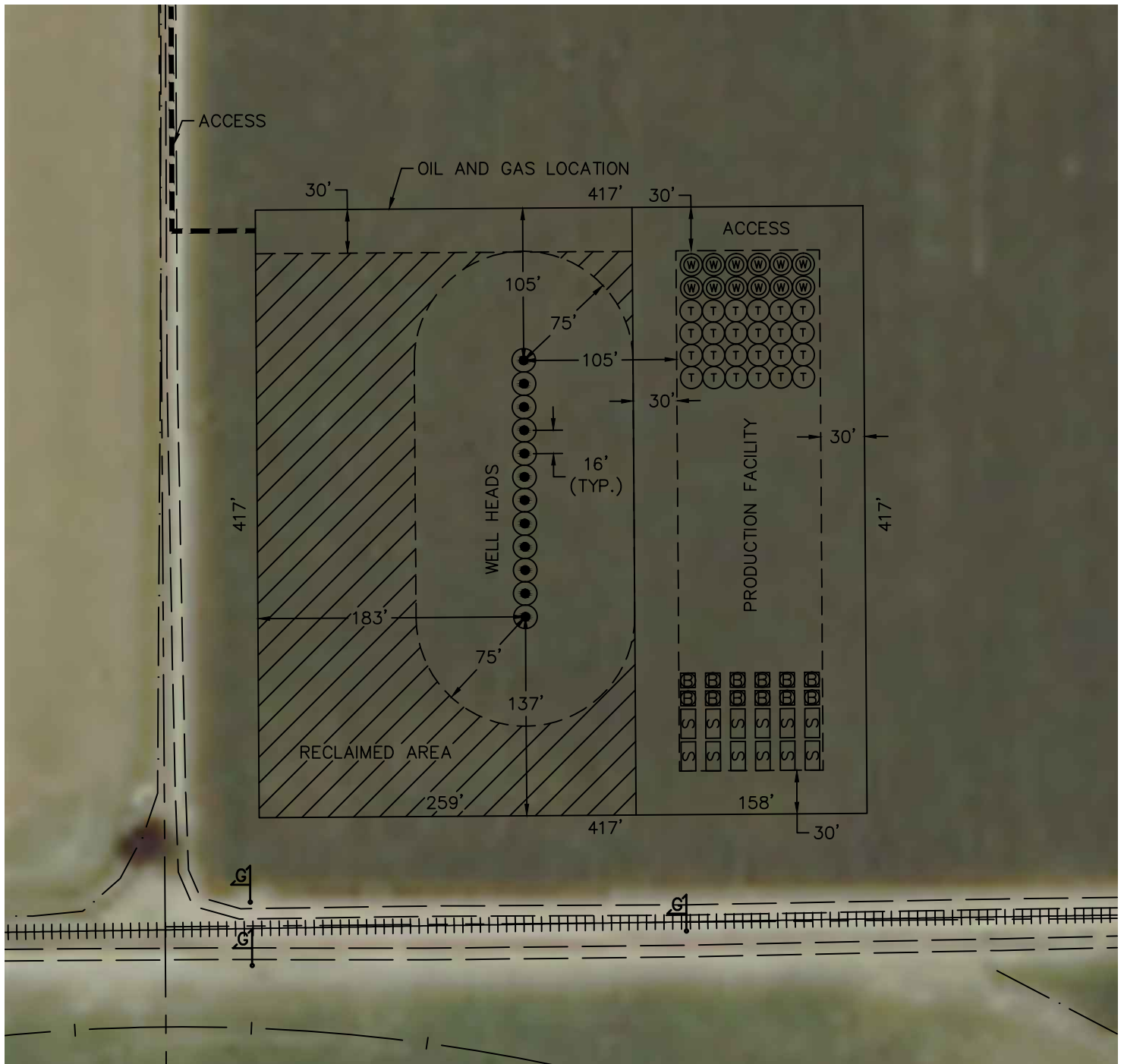

PROPOSED SCALED FACILITY DRAWING

VAIL PAD

SECTION: 12
TOWNSHIP: 4N
RANGE: 68W
6TH. P.M.
WELD COUNTY, CO



LEGEND

-  PROPOSED WELL HEAD
-  TANK BATTERY
-  WATER TANK
-  WATER VAULT
-  SEPARATOR
-  ECD
-  METER
-  -VRU-

TOTAL DISTURBED AREA OF LOCATION: ±4.0 ACRES
TOTAL SIZE OF LOCATION AFTER RECLAMATION: ±2.7 ACRES

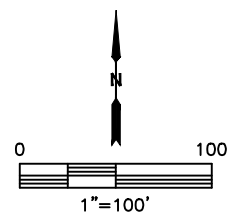

DATE: 1/27/2015
PROJECT#: 2014184