

PROPOSED PAD DISTURBANCE & RECLAMATION
PAYNE 23-41

SECTION: 23
TOWNSHIP: 13S
RANGE: 59W

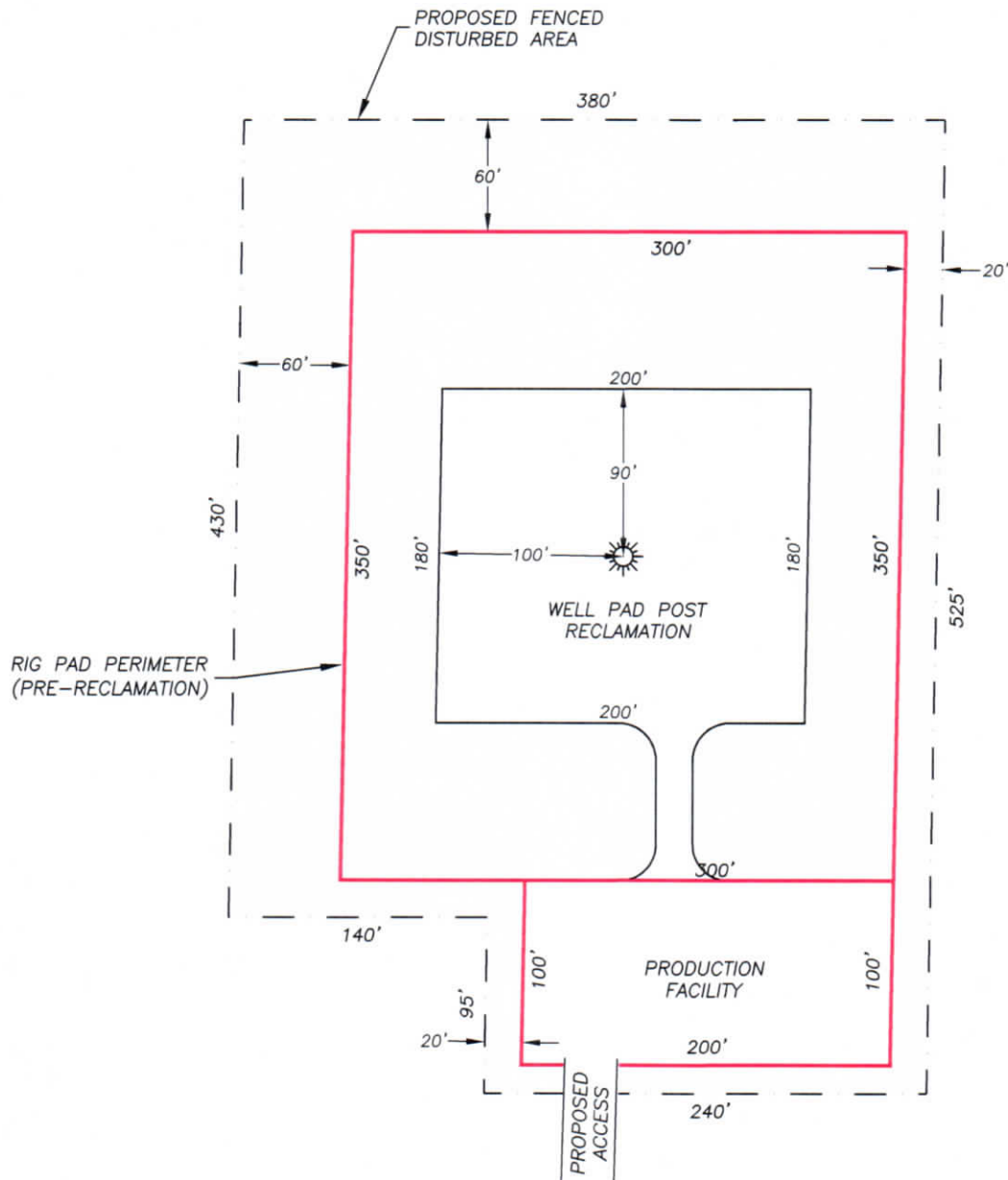

OPERATOR: MUSTANG CREEK OPERATING, LLC.
WELL LOCATION: 325' FSL, 317' FWL
EXISTING ELEVATION: 5810'
TOTAL DISTURBANCE: 4.3 Ac.
RIG PAD PRE REC.: 2.4 Ac.
RIG PAD POST REC.: 0.9 Ac.
PROD. FACILITY PRE REC.: 0.5
PROD. FACILITY POST REC.: 0.5

