

DISTURBED AREA = 3.09 ACRES
 CUT SLOPES: 2:1
 FILL SLOPES: 2:1
 PAD QUANTITIES:
 TOTAL CUT = 6431 CUBIC YARDS
 TOTAL FILL = 5828 CUBIC YARDS
 SPOIL = 603 (CUT) CUBIC YARDS
 SPOIL DOES NOT INCLUDE TOP SOIL

COMPACTION SHRINKAGE NOT ACCOUNTED
 FOR IN VOL. CALCS. ESTIMATED AT 10%

ROAD QUANTITIES:
 TOTAL CUT: 80 CUBIC YARDS
 TOTAL FILL: 33 CUBIC YARDS
 SPOIL = 47 (CUT) CUBIC YARDS

TOP SOIL QUANTITY FOR PAD AND
 ROAD BASED ON 6 INCH DEPTH:
 2170 CUBIC YARDS

Notes:

1. Contact utility line locators before digging. CALL 811
2. Earth work quantities are estimated and should be used at contractors own discretion.
3. Earth work is based on the removal of 6 inches of topsoil on all disturbed areas
4. ROAD SURFACES TO BE FINISHED WITH 6 INCHES OF CLASS 6 ROAD BASE AFTER INSTALLATION OF PIPELINE
5. Extra material is to be added to the fill slope of the pad.

GRAPHIC SCALE

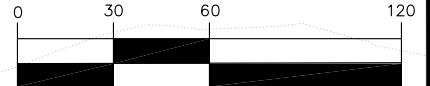

(IN FEET)

1 inch = 60 ft.

CUTTINGS PIT

Capacity with 2'
 freeboard = 2843 Bbls
 Total Pit Volume = 928 CY

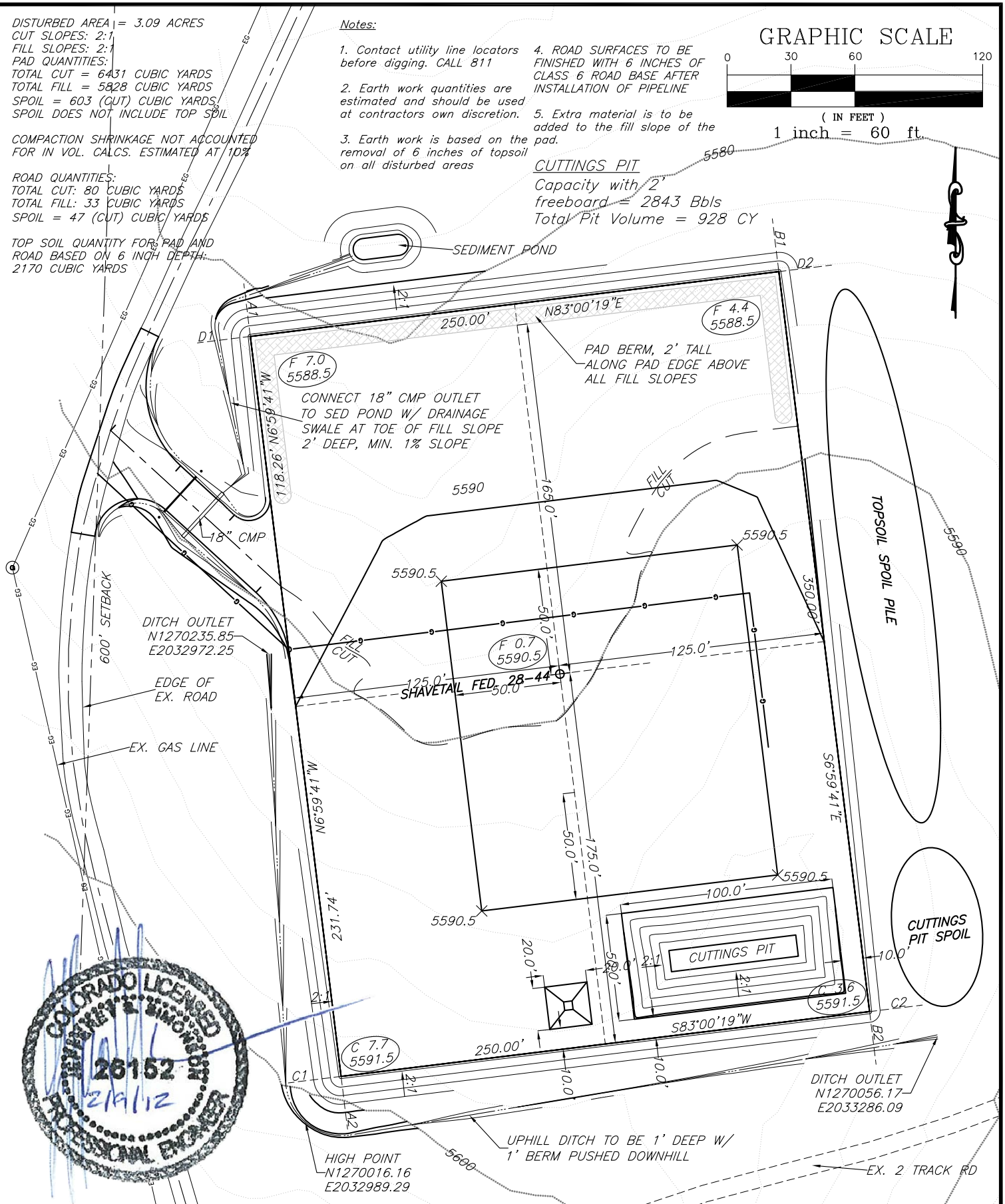

SGM INC.

118 W. 6th Street, Suite 200
 Glenwood Springs, Colorado 81601
 (970) 945-1004 (FAX 945-5948)
 Aspen, Colorado (970) 925-6727

Scale: 1" = 60

Sheet 2A of 8

Pad 28-44

Shavetail 28 Construction Layout

NE1/4SE1/4, Section 28, T.1N, R.103W., 6TH P.M.

Job# 2010-112.005

Date: 2.7.2012

By: DCS

File: 28-44BM