



VIA EFORMS

Mr. Matt Lepore
Colorado Oil & Gas Conservation Commission
1120 Lincoln Street, Suite 801
Denver, CO 80203

June 12, 2015

RE: Application for Permit to Drill - Proposed Wellbore Spacing Unit
Synergy Resources Corporation
Ivey M-11-12HC
SHL: 1,077' FSL 1,730' FEL (SW/4 SE/4)
Sec. 11 T1S R68W
BHL: $\pm 1,015'$ FSL $\pm 2,175'$ FWL (SE/4 SW/4)
Sec. 12 T1S R68W
Adams County, Colorado
Surface: Fee
Mineral Lease: Fee

Dear Mr. Lepore:

Synergy Resources Corporation (Synergy) intends to permit, drill and operate the above referenced Codell formation Horizontal Well. As defined by Colorado Oil and Gas Conservation Commission (COGCC) Rule 318A.a.(4)D., Synergy proposes the following wellbore spacing unit:

Description of the Wellbore Orientation and Wellbore Spacing Unit: The proposed horizontal wellbore paths will run west to east. The Proposed Spacing Unit is as follows:

Well Name	Proposed Spacing Unit	Acreage
Ivey M-11-12HC	T1S R68W Sec. 11: NWSE, NESE, SWSE, SESE; T1S R68W Sec. 12: NWSW, NESW, SWSW, SESW	320

Description of Wellbore Orientation & Proposed Surface, Bottom, and Productive Interval Locations and Target Formation:

The proposed wellbore will run west to east, beginning in Sec. 11 T1S R68W and ending in Sec. 12 T1S R68W. Please see the enclosed PSU. The proposed location is as follows:

Well Name	Surface Hole	Productive Interval	Bottom Hole	Formation
Ivey M-11-12HC	1,077' FSL 1,730' FEL	1,015' FSL 2,175' FEL	1,015' FSL 2,175' FWL	Codell

Synergy requests the Director approve the proposed wellbore spacing unit.

This letter hereby certifies that Synergy complied with Rule 318A.e.(5) on November 18, 2014 for the above referenced oil and gas well. All mineral interest owners were sent letters notifying them of the proposed spacing unit. The Mineral Interest Owner letters were sent by Bayswater Exploration & Production who was the original operator of the proposed well. Synergy bought the prospect and no changes were made to either the surface, landing point, or bottom-hole locations since the Mineral Interest owners were notified. No disputes were received.

Your Assets / Our Expertise

- Regulatory
- Storm-water Management Plans
- Project Coordination
- Permitting
- Government Relations
- EA/EIS Assistance

Mr. Matt Lepore
June 12, 2015
Page 2

Please send a copy of all correspondence to Upstream Petroleum Management, Inc. at 7000 S. Yosemite St., Suite 290B, Englewood, CO 80112. Please contact me at 303-942-0506 or at acallaway@upstreampm.com if you have any questions.

Sincerely,



Angela G. Callaway
Permit Agent for Synergy Resources Corporation

IVEY 11-N NORTH PAD PROPOSED 318A.e. SPACING UNIT

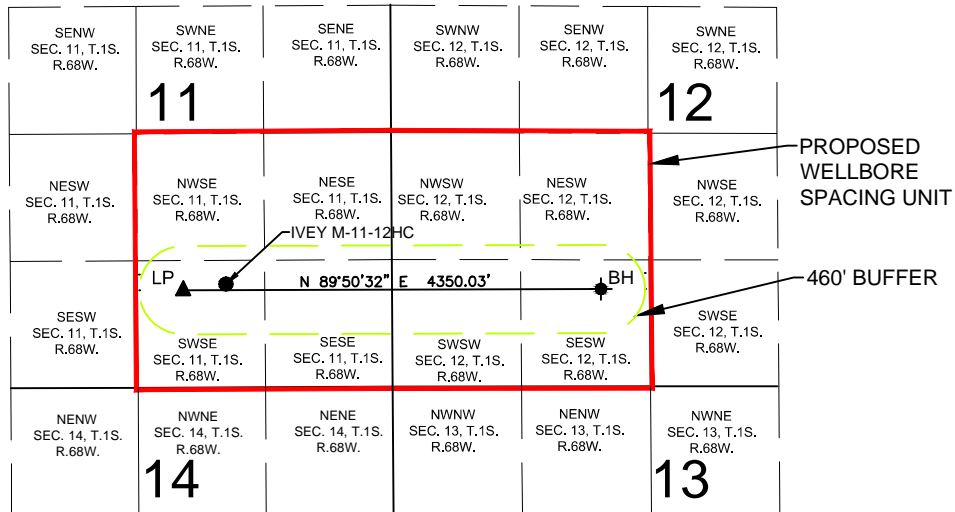

WELL **IVEY M-11-12HC** TO BE LOCATED 1077' FSL AND 1730' FEL, SEC. 11, T1S, R68W

SURFACE LOCATION

NAD83
LATITUDE= 39.974981°
LONGITUDE= 104.965594°

LANDING POINT LOCATION

NAD83
LATITUDE= 39.974812°
LONGITUDE= 104.967182°

BOTTOM HOLE LOCATION

NAD83
LATITUDE= 39.974772°
LONGITUDE= 104.951661°

LEGEND

- = PROPOSED WELL
- ▲ = LANDING POINT
- ◆ = BOTTOM HOLE
- LP = LANDING POINT
- BH = BOTTOM HOLE

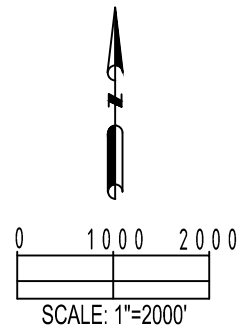

PREPARED BY:



FIELD DATE:

06-03-14

DRAWING DATE:

03-02-15

BY:

DRF

CHECKED BY:

MDCA

SITE NAME:

IVEY 11-N NORTH PAD

SURFACE LOCATION:

SW 1/4 SE 1/4, SEC. 11, T1S, R68W, 6TH P.M.
ADAMS COUNTY, COLORADO

PREPARED FOR:

