

Pad Report: (irregular size)

Top of pad elevation: 7373.0'
Cut Slope: 2.00:1
Fill Slope: 2.00:1

Total cut : 11,081.04 C.Y.
Total fill: 8,690.98 C.Y.
Balance Export: 2,390.06 C.Y.

Area: 3.406 ± acres

Post Interim
Reclamation
Area: 3.192 ± acres

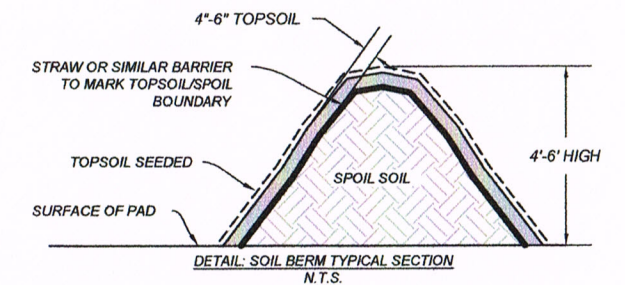

Note: See page 2 for cross sections.

LEGEND:

- ~ Pre-Construction Contour
- ~ Pre-Construction Index Contour
- ~ Post Construction Contour
- ~ Post Construction Index Contour
- - - Centerline Ditch (proposed)
- - - Centerline Soil Berm (proposed)
- BMP's (proposed)

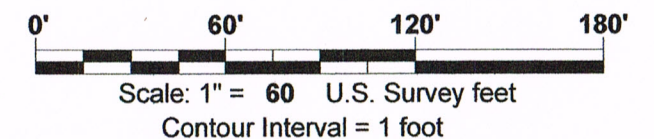

GAS WELL LAYOUT

FEDERAL 12-89-07 #1
Located in the SE 1/4 Section 7,
Township 12 South, Range 89 West, 6th P.M.,
Gunnison County, Colorado

SURVEYED BY: DGN	DWG DATE: 06/08/2015	Mickey L. Denison, PLS cell: (720) 390-2654 mickey.denison@aecom.com AECOM 804 Colorado Ave, Suite 20 Glenwood Springs Co 81616
DRAFTED BY: MLD	SCALE: 1" = 60'	
JOB NO.: 22244264.70300		
		SHEET NO. 1 of 2

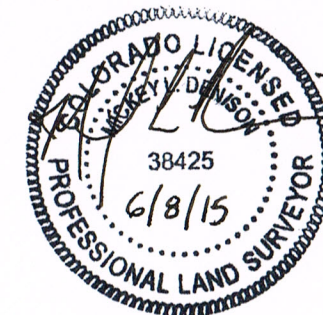

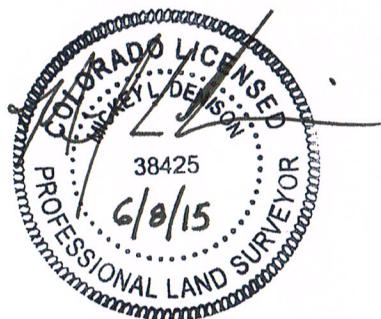
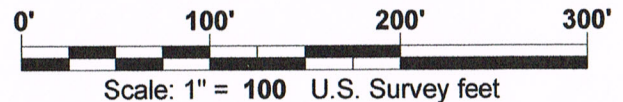
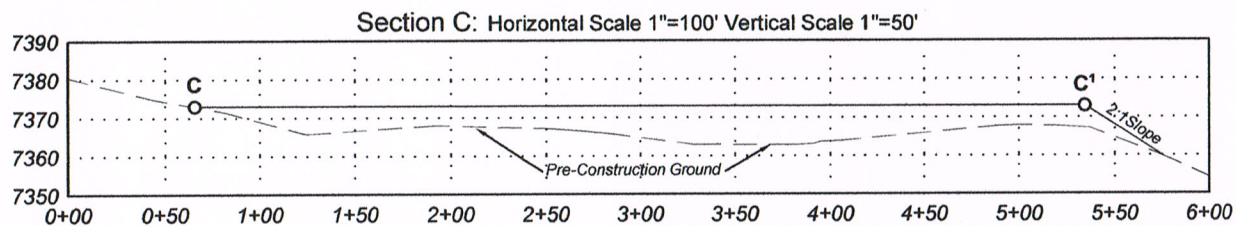
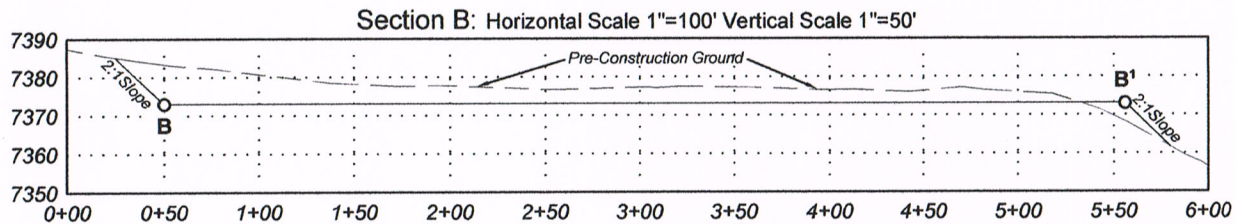
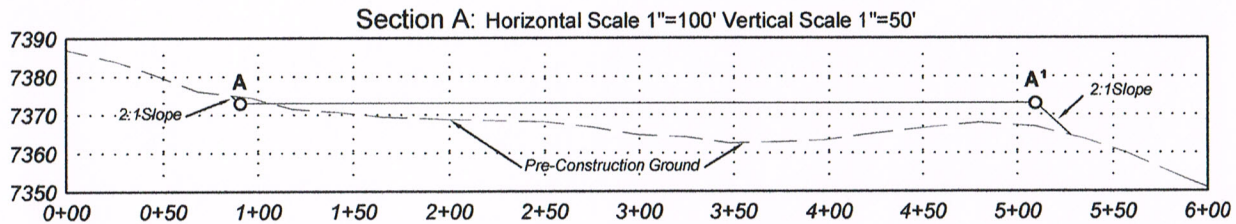

GAS WELL LAYOUT CROSS SECTIONS

FEDERAL 12-89-07 #1

Located in the SE 1/4 Section 7,
Township 12 South, Range 89 West, 6th P.M.,
Gunnison County, Colorado

SURVEYED BY: DGN	DWG DATE: 06/08/2015	Mickey L. Denison, PLS cell: (720) 390-0854 mickey.denison@aecom.com AECOM 804 Colorado Ave, Suite 201 Glenwood Springs Co 81610	
DRAFTED BY: MLD	SCALE: 1" = 100'		
JOB NO.: 22244264.70300		SHEET NO. 2 of 2	