

# KERR-MCGEE OIL & GAS ONSHORE LP

Location: COLORADO Slot: SLOT#02 BARCLAY 15C-26HZ (577'FSL & 2193'FEL, SEC.14)  
 Field: WELD COUNTY (KERR MCGEE) Well: BARCLAY 15C-26HZ  
 Facility: SEC.14-T2N-R67W Wellbore: BARCLAY 15C-26HZ PWB

Plot reference wellpath is BARCLAY 15C-26HZ (REV-A.0) PWP	
True vertical depths are referenced to XTREME 23 (16KB) (RKB)	Grid System: NAD83 / Lambert Colorado SP, Northern Zone (501), US feet
Measured depths are referenced to XTREME 23 (16KB) (RKB)	North Reference: True north
XTREME 23 (16KB) (RKB) to Mean Sea Level: 4948 feet	Scale: True distance
Mean Sea Level to Mud line (At Slot: SLOT#02 BARCLAY 15C-26HZ (577'FSL & 2193'FEL, SEC.14)): 0 feet	Depths are in feet
Coordinates are in feet referenced to Slot	Created by: preccain on 4/27/2015

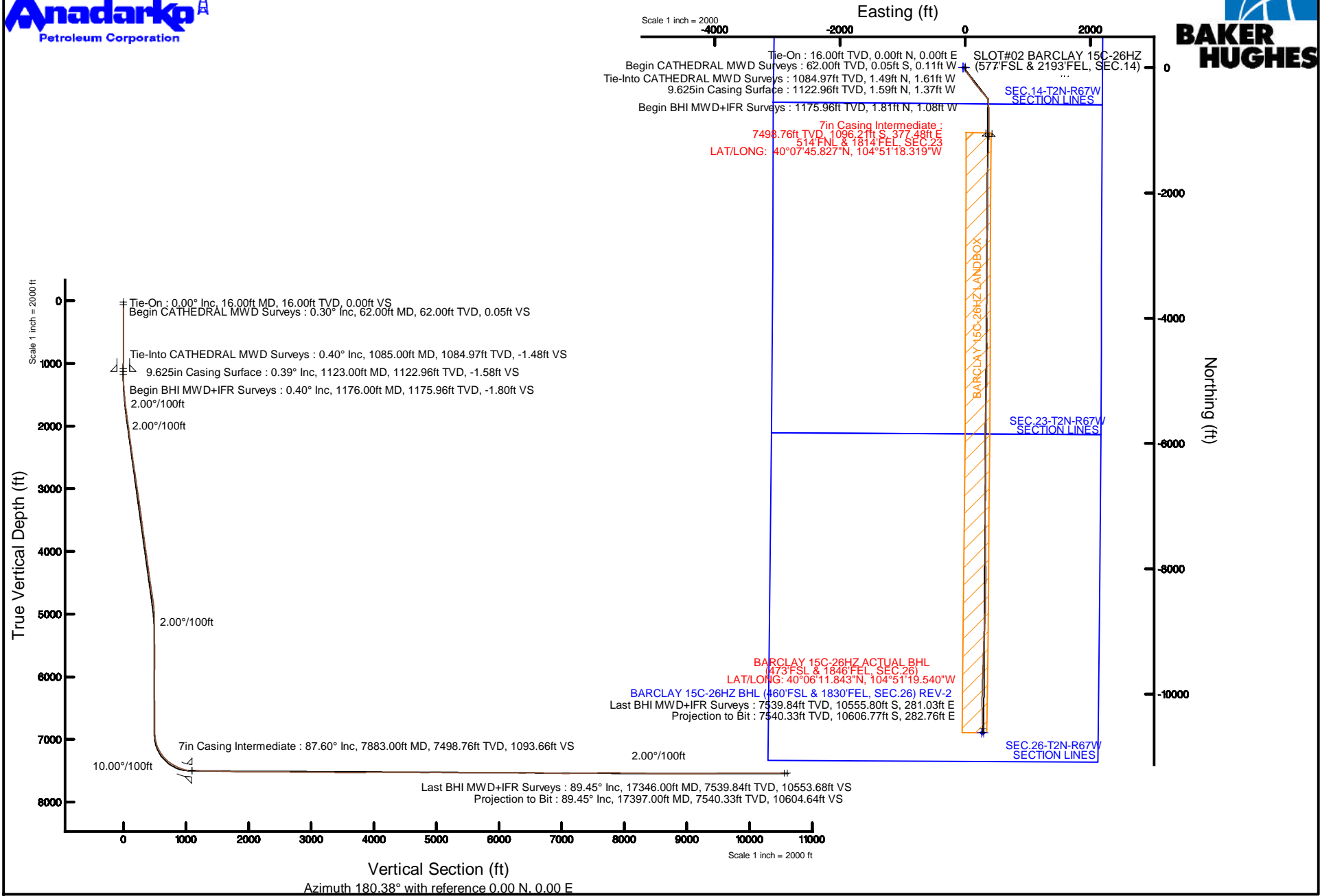

REFERENCE WELLPATH IDENTIFICATION			
Operator	KERR-MCGEE OIL & GAS ONSHORE LP	Slot	SLOT#02 BARCLAY 15C-26HZ (577'FSL & 2193'FEL, SEC.14)
Area	COLORADO	Well	BARCLAY 15C-26HZ
Field	WELD COUNTY (KERR MCGEE)	Wellbore	BARCLAY 15C-26HZ AWB <62-16520>
Facility	SEC.14-T2N-R67W		

REPORT SETUP INFORMATION			
Projection System	NAD83 / Lambert Colorado SP, Northern Zone (501), US feet	Software System	WellArchitect® 4.1.1
North Reference	True	User	Precain
Scale	0.999959	Report Generated	4/21/2015 at 11:41:04 AM
Convergence at slot	0.42° East	Database/Source file	WellArchitectDB/BARCLAY_15C-26HZ_AWB__62-16520_.xml

WELLPATH LOCATION						
	Local coordinates		Grid coordinates		Geographic coordinates	
	North[ft]	East[ft]	Easting[US ft]	Northing[US ft]	Latitude	Longitude
Slot Location	-0.20	29.98	3179944.41	1291732.05	40°07'56.660"N	104°51'23.179"W
Facility Reference Pt			3179914.43	1291732.03	40°07'56.662"N	104°51'23.565"W
Field Reference Pt			3197771.84	1268891.29	40°04'09.600"N	104°47'36.000"W

WELLPATH DATUM			
Calculation method	Minimum curvature	XTREME 23 (16'KB) (RKB) to Facility Vertical Datum	4948.00ft
Horizontal Reference Pt	Slot	XTREME 23 (16'KB) (RKB) to Mean Sea Level	4948.00ft
Vertical Reference Pt	XTREME 23 (16'KB) (RKB)	XTREME 23 (16'KB) (RKB) to Mud Line at Slot (SLOT#02 BARCLAY 15C-26HZ (577'FSL & 2193'FEL, SEC.14))	4948.00ft
MD Reference Pt	XTREME 23 (16'KB) (RKB)	Section Origin	N 0.00, E 0.00 ft
Field Vertical Reference	Mean Sea Level	Section Azimuth	180.38°

REFERENCE WELLPATH IDENTIFICATION			
Operator	KERR-MCGEE OIL & GAS ONSHORE LP	Slot	SLOT#02 BARCLAY 15C-26HZ (577'FSL & 2193'FEL, SEC.14)
Area	COLORADO	Well	BARCLAY 15C-26HZ
Field	WELD COUNTY (KERR MCGEE)	Wellbore	BARCLAY 15C-26HZ AWB <62-16520>
Facility	SEC.14-T2N-R67W		

WELLPATH DATA (171 stations) † = interpolated/extrapolated station											
MD [ft]	Inclination [°]	Azimuth [°]	TVD [ft]	Vert Sect [ft]	North [ft]	East [ft]	Latitude	Longitude	DLS [°/100ft]	Comments	
0.00†	0.000	246.000	0.00	0.00	0.00	0.00	40°07'56.660"N	104°51'23.179"W	0.00		
16.00	0.000	246.000	16.00	0.00	0.00	0.00	40°07'56.660"N	104°51'23.179"W	0.00	Tie-On	
62.00	0.300	246.000	62.00	0.05	-0.05	-0.11	40°07'56.660"N	104°51'23.180"W	0.65	Begin CATHEDRAL MWD Surveys	
172.00	0.300	265.600	172.00	0.19	-0.19	-0.66	40°07'56.658"N	104°51'23.188"W	0.09		
250.00	0.200	278.400	250.00	0.19	-0.18	-1.00	40°07'56.658"N	104°51'23.192"W	0.15		
331.00	0.400	256.200	331.00	0.24	-0.23	-1.41	40°07'56.658"N	104°51'23.197"W	0.28		
411.00	0.300	264.500	410.99	0.33	-0.32	-1.89	40°07'56.657"N	104°51'23.203"W	0.14		
491.00	0.500	288.800	490.99	0.24	-0.23	-2.43	40°07'56.658"N	104°51'23.210"W	0.32		
571.00	0.300	305.900	570.99	0.01	0.01	-2.93	40°07'56.660"N	104°51'23.217"W	0.29		
651.00	0.100	311.600	650.99	-0.16	0.18	-3.15	40°07'56.662"N	104°51'23.220"W	0.25		
731.00	0.500	264.800	730.99	-0.17	0.19	-3.55	40°07'56.662"N	104°51'23.225"W	0.55		
811.00	0.400	265.700	810.99	-0.11	0.14	-4.18	40°07'56.661"N	104°51'23.233"W	0.13		
891.00	0.800	59.000	890.98	-0.38	0.41	-3.98	40°07'56.664"N	104°51'23.230"W	1.46		
971.00	1.100	67.000	970.97	-0.98	1.00	-2.79	40°07'56.670"N	104°51'23.215"W	0.41		
1051.00	0.400	66.700	1050.97	-1.39	1.41	-1.83	40°07'56.674"N	104°51'23.203"W	0.88		
1085.00	0.400	72.600	1084.97	-1.48	1.49	-1.61	40°07'56.675"N	104°51'23.200"W	0.12	Tie-Into CATHEDRAL MWD Surveys	
1176.00	0.400	45.260	1175.96	-1.80	1.81	-1.08	40°07'56.678"N	104°51'23.193"W	0.21	Begin BHI MWD+IFR Surveys	
1268.00	2.600	193.440	1267.94	0.01	0.00	-1.34	40°07'56.660"N	104°51'23.196"W	3.20		
1360.00	4.850	180.570	1359.74	5.93	-5.92	-1.86	40°07'56.602"N	104°51'23.203"W	2.59		
1452.00	4.900	180.130	1451.40	13.75	-13.73	-1.91	40°07'56.524"N	104°51'23.204"W	0.07		
1545.00	4.950	180.220	1544.06	21.73	-21.72	-1.93	40°07'56.445"N	104°51'23.204"W	0.05		
1636.00	6.570	171.700	1634.60	30.80	-30.80	-1.20	40°07'56.356"N	104°51'23.194"W	2.01		
1729.00	7.880	161.190	1726.86	42.08	-42.10	1.63	40°07'56.244"N	104°51'23.158"W	2.00		
1821.00	8.930	148.260	1817.88	54.09	-54.14	7.42	40°07'56.125"N	104°51'23.083"W	2.34		
1913.00	10.320	140.900	1908.59	66.50	-66.61	16.37	40°07'56.002"N	104°51'22.968"W	2.02		
2097.00	9.700	138.520	2089.79	90.76	-91.01	37.04	40°07'55.761"N	104°51'22.702"W	0.41		
2190.00	10.000	137.640	2181.42	102.53	-102.85	47.67	40°07'55.644"N	104°51'22.565"W	0.36		
2282.00	10.330	145.430	2271.98	115.16	-115.54	57.73	40°07'55.518"N	104°51'22.436"W	1.54		
2461.00	9.440	143.070	2448.32	139.98	-140.49	75.65	40°07'55.272"N	104°51'22.205"W	0.55		
2549.00	9.640	147.600	2535.10	151.92	-152.48	83.94	40°07'55.153"N	104°51'22.098"W	0.88		
2634.00	10.980	145.420	2618.73	164.54	-165.16	92.35	40°07'55.028"N	104°51'21.990"W	1.64		
2804.00	10.330	143.360	2785.80	189.97	-190.72	110.63	40°07'54.775"N	104°51'21.755"W	0.44		
2977.00	9.700	141.670	2956.16	213.73	-214.60	128.93	40°07'54.539"N	104°51'21.519"W	0.40		
3062.00	11.250	144.770	3039.74	226.06	-226.99	138.15	40°07'54.417"N	104°51'21.400"W	1.94		
3233.00	10.540	143.570	3207.66	252.14	-253.20	157.06	40°07'54.158"N	104°51'21.157"W	0.44		
3320.00	9.940	141.590	3293.27	264.36	-265.48	166.45	40°07'54.036"N	104°51'21.036"W	0.80		
3405.00	10.540	142.420	3376.92	276.21	-277.39	175.75	40°07'53.919"N	104°51'20.916"W	0.73		
3577.00	8.710	136.760	3546.49	298.04	-299.35	194.27	40°07'53.702"N	104°51'20.678"W	1.20		
3664.00	10.160	141.020	3632.32	308.74	-310.12	203.61	40°07'53.595"N	104°51'20.558"W	1.85		
3836.00	10.100	139.940	3801.63	331.95	-333.45	222.86	40°07'53.365"N	104°51'20.310"W	0.12		
4007.00	9.840	145.620	3970.06	355.37	-356.99	240.76	40°07'53.132"N	104°51'20.079"W	0.59		
4179.00	11.900	136.430	4138.97	380.21	-381.97	261.29	40°07'52.885"N	104°51'19.815"W	1.56		
4353.00	10.470	133.540	4309.67	403.94	-405.86	285.11	40°07'52.649"N	104°51'19.508"W	0.88		
4436.00	10.690	137.700	4391.26	414.76	-416.75	295.76	40°07'52.542"N	104°51'19.371"W	0.96		
4611.00	11.930	140.750	4562.86	440.62	-442.76	318.13	40°07'52.285"N	104°51'19.083"W	0.79		

REFERENCE WELLPATH IDENTIFICATION			
Operator	KERR-MCGEE OIL & GAS ONSHORE LP	Slot	SLOT#02 BARCLAY 15C-26HZ (577'FSL & 2193'FEL, SEC.14)
Area	COLORADO	Well	BARCLAY 15C-26HZ
Field	WELD COUNTY (KERR MCGEE)	Wellbore	BARCLAY 15C-26HZ AWB <62-16520>
Facility	SEC.14-T2N-R67W		

WELLPATH DATA (171 stations) † = interpolated/extrapolated station										
MD [ft]	Inclination [°]	Azimuth [°]	TVD [ft]	Vert Sect [ft]	North [ft]	East [ft]	Latitude	Longitude	DLS [°/100ft]	Comments
4696.00	11.650	140.170	4646.06	453.94	-456.16	329.18	40°07'52.152"N	104°51'18.941"W	0.36	
4781.00	10.660	142.370	4729.46	466.69	-468.97	339.48	40°07'52.026"N	104°51'18.808"W	1.27	
4866.00	8.790	138.890	4813.23	477.75	-480.09	348.55	40°07'51.916"N	104°51'18.692"W	2.31	
4954.00	6.140	141.750	4900.48	486.46	-488.86	355.89	40°07'51.829"N	104°51'18.597"W	3.04	
5041.00	3.470	145.540	4987.16	492.26	-494.68	360.26	40°07'51.771"N	104°51'18.541"W	3.09	
5126.00	1.270	106.260	5072.09	494.63	-497.07	362.62	40°07'51.748"N	104°51'18.511"W	3.07	
5296.00	0.770	108.620	5242.06	495.50	-497.96	365.51	40°07'51.739"N	104°51'18.473"W	0.30	
5726.00	0.860	133.900	5672.02	498.63	-501.12	370.57	40°07'51.708"N	104°51'18.408"W	0.09	
5811.00	1.270	308.630	5757.02	498.48	-500.97	370.30	40°07'51.709"N	104°51'18.412"W	2.50	
5983.00	1.060	296.950	5928.98	496.59	-499.06	367.39	40°07'51.728"N	104°51'18.449"W	0.18	
6325.00	0.710	241.400	6270.94	496.20	-498.64	362.71	40°07'51.732"N	104°51'18.509"W	0.26	
6666.00	0.570	192.660	6611.93	498.88	-501.31	360.48	40°07'51.706"N	104°51'18.538"W	0.16	
6837.00	0.650	171.500	6782.92	500.67	-503.10	360.44	40°07'51.688"N	104°51'18.539"W	0.14	
6922.00	0.620	188.230	6867.91	501.60	-504.03	360.45	40°07'51.679"N	104°51'18.539"W	0.22	
7007.00	5.860	165.960	6952.75	506.27	-508.70	361.43	40°07'51.633"N	104°51'18.526"W	6.23	
7094.00	12.900	169.500	7038.53	520.12	-522.57	364.28	40°07'51.496"N	104°51'18.489"W	8.12	
7179.00	22.830	172.210	7119.33	545.83	-548.31	368.26	40°07'51.242"N	104°51'18.438"W	11.72	
7266.00	30.280	174.370	7197.10	584.40	-586.91	372.70	40°07'50.860"N	104°51'18.381"W	8.63	
7352.00	38.340	175.200	7268.08	632.61	-635.15	377.07	40°07'50.383"N	104°51'18.325"W	9.39	
7437.00	47.020	177.610	7330.51	690.03	-692.60	380.58	40°07'49.816"N	104°51'18.279"W	10.39	
7524.00	57.370	179.700	7383.77	758.64	-761.22	382.10	40°07'49.138"N	104°51'18.260"W	12.05	
7609.00	62.480	180.250	7426.35	832.17	-834.75	382.13	40°07'48.411"N	104°51'18.259"W	6.04	
7697.00	68.350	180.450	7462.95	912.16	-914.74	381.64	40°07'47.620"N	104°51'18.266"W	6.67	
7782.00	78.110	181.530	7487.45	993.44	-996.01	380.21	40°07'46.817"N	104°51'18.284"W	11.55	
7843.00	85.250	181.590	7496.27	1053.75	-1056.31	378.57	40°07'46.221"N	104°51'18.305"W	11.71	
7883.00†	87.603	181.543	7498.76	1093.66	-1096.21	377.48	40°07'45.827"N	104°51'18.319"W	5.88	7" Casing Point
7928.00	90.250	181.490	7499.60	1138.64	-1141.19	376.29	40°07'45.383"N	104°51'18.335"W	5.88	
8013.00	89.540	181.540	7499.76	1223.62	-1226.16	374.04	40°07'44.543"N	104°51'18.364"W	0.84	
8098.00	89.110	181.770	7500.76	1308.59	-1311.11	371.58	40°07'43.703"N	104°51'18.395"W	0.57	
8186.00	89.450	181.220	7501.87	1396.57	-1399.08	369.29	40°07'42.834"N	104°51'18.425"W	0.73	
8271.00	88.520	182.270	7503.37	1481.53	-1484.02	366.70	40°07'41.995"N	104°51'18.458"W	1.65	
8356.00	86.770	181.700	7506.86	1566.42	-1568.89	363.76	40°07'41.156"N	104°51'18.496"W	2.17	
8441.00	87.630	180.590	7511.02	1651.31	-1653.77	362.06	40°07'40.317"N	104°51'18.518"W	1.65	
8527.00	89.380	180.550	7513.26	1737.28	-1739.74	361.21	40°07'39.468"N	104°51'18.529"W	2.04	
8614.00	89.320	180.220	7514.25	1824.27	-1826.73	360.62	40°07'38.608"N	104°51'18.536"W	0.39	
8699.00	90.310	179.850	7514.52	1909.27	-1911.73	360.57	40°07'37.768"N	104°51'18.537"W	1.24	
8784.00	88.860	179.730	7515.14	1994.26	-1996.72	360.88	40°07'36.928"N	104°51'18.533"W	1.71	
8871.00	88.920	179.420	7516.82	2081.23	-2083.70	361.53	40°07'36.069"N	104°51'18.525"W	0.36	
8958.00	89.780	180.640	7517.81	2168.22	-2170.70	361.48	40°07'35.209"N	104°51'18.525"W	1.72	
9046.00	89.480	181.400	7518.38	2256.22	-2258.68	359.92	40°07'34.339"N	104°51'18.546"W	0.93	
9216.00	89.480	180.140	7519.92	2426.20	-2428.65	357.63	40°07'32.660"N	104°51'18.575"W	0.74	
9301.00	90.400	180.500	7520.01	2511.20	-2513.65	357.16	40°07'31.820"N	104°51'18.581"W	1.16	
9388.00	89.350	181.010	7520.20	2598.20	-2600.64	356.01	40°07'30.960"N	104°51'18.596"W	1.34	
9561.00	89.660	180.080	7521.69	2771.19	-2773.63	354.37	40°07'29.251"N	104°51'18.617"W	0.57	
9732.00	89.690	180.980	7522.66	2942.18	-2944.61	352.78	40°07'27.561"N	104°51'18.638"W	0.53	

REFERENCE WELLPATH IDENTIFICATION				
Operator	KERR-MCGEE OIL & GAS ONSHORE LP		Slot	SLOT#02 BARCLAY 15C-26HZ (577'FSL & 2193'FEL, SEC.14)
Area	COLORADO		Well	BARCLAY 15C-26HZ
Field	WELD COUNTY (KERR MCGEE)		Wellbore	BARCLAY 15C-26HZ AWB <62-16520>
Facility	SEC.14-T2N-R67W			

WELLPATH DATA (171 stations)										
MD [ft]	Inclination [°]	Azimuth [°]	TVD [ft]	Vert Sect [ft]	North [ft]	East [ft]	Latitude	Longitude	DLS [°/100ft]	Comments
9905.00	89.850	180.860	7523.36	3115.17	-3117.59	350.01	40°07'25.852"N	104°51'18.673"W	0.12	
10075.00	88.480	180.520	7525.84	3285.15	-3287.56	347.96	40°07'24.172"N	104°51'18.700"W	0.83	
10260.00	89.850	180.510	7528.53	3470.13	-3472.52	346.30	40°07'22.344"N	104°51'18.721"W	0.74	
10352.00	89.600	179.980	7528.97	3562.12	-3564.52	345.90	40°07'21.435"N	104°51'18.726"W	0.64	
10536.00	90.220	179.680	7529.26	3746.11	-3748.52	346.45	40°07'19.617"N	104°51'18.719"W	0.37	
10721.00	91.600	179.150	7526.32	3931.06	-3933.48	348.34	40°07'17.789"N	104°51'18.695"W	0.80	
10812.00	91.140	179.610	7524.15	4022.02	-4024.45	349.32	40°07'16.890"N	104°51'18.682"W	0.71	
10905.00	90.430	180.020	7522.87	4115.00	-4117.44	349.62	40°07'15.971"N	104°51'18.679"W	0.88	
10997.00	88.860	180.610	7523.44	4207.00	-4209.43	349.12	40°07'15.062"N	104°51'18.685"W	1.82	
11089.00	89.050	180.290	7525.12	4298.98	-4301.41	348.39	40°07'14.153"N	104°51'18.694"W	0.40	
11182.00	89.690	178.930	7526.14	4391.97	-4394.40	349.03	40°07'13.234"N	104°51'18.686"W	1.62	
11274.00	89.480	180.890	7526.81	4483.96	-4486.40	349.17	40°07'12.325"N	104°51'18.684"W	2.14	
11451.00	90.090	179.630	7527.48	4660.95	-4663.39	348.37	40°07'10.576"N	104°51'18.695"W	0.79	
11538.00	89.380	180.720	7527.88	4747.95	-4750.39	348.10	40°07'09.716"N	104°51'18.698"W	1.50	
11623.00	90.220	180.710	7528.17	4832.94	-4835.38	347.04	40°07'08.876"N	104°51'18.712"W	0.99	
11709.00	90.590	180.490	7527.57	4918.94	-4921.37	346.14	40°07'08.026"N	104°51'18.723"W	0.50	
11794.00	90.250	181.430	7526.94	5003.93	-5006.36	344.72	40°07'07.187"N	104°51'18.742"W	1.18	
11879.00	88.460	182.030	7527.90	5088.90	-5091.31	342.15	40°07'06.347"N	104°51'18.775"W	2.22	
12051.00	90.740	181.610	7529.10	5260.83	-5263.21	336.69	40°07'04.648"N	104°51'18.845"W	1.35	
12137.00	90.060	182.260	7528.50	5346.80	-5349.15	333.79	40°07'03.799"N	104°51'18.883"W	1.09	
12222.00	88.830	182.400	7529.32	5431.74	-5434.08	330.33	40°07'02.960"N	104°51'18.927"W	1.46	
12309.00	89.380	182.280	7530.68	5518.68	-5520.99	326.78	40°07'02.101"N	104°51'18.973"W	0.65	
12396.00	89.690	182.170	7531.39	5605.63	-5607.93	323.40	40°07'01.242"N	104°51'19.016"W	0.38	
12483.00	90.920	182.210	7530.93	5692.59	-5694.86	320.08	40°07'00.383"N	104°51'19.059"W	1.41	
12568.00	88.950	180.660	7531.02	5777.57	-5779.83	317.95	40°06'59.543"N	104°51'19.087"W	2.95	
12653.00	89.500	180.230	7532.17	5862.56	-5864.81	317.29	40°06'58.703"N	104°51'19.095"W	0.82	
12741.00	90.710	180.260	7532.01	5950.55	-5952.81	316.91	40°06'57.834"N	104°51'19.100"W	1.38	
12826.00	88.680	179.460	7532.46	6035.54	-6037.81	317.12	40°06'56.994"N	104°51'19.097"W	2.57	
12998.00	90.150	178.560	7534.22	6207.48	-6209.76	320.09	40°06'55.294"N	104°51'19.059"W	1.00	
13087.00	89.320	179.210	7534.63	6296.45	-6298.75	321.82	40°06'54.415"N	104°51'19.037"W	1.18	
13172.00	90.030	178.670	7535.11	6381.42	-6383.73	323.40	40°06'53.575"N	104°51'19.017"W	1.05	
13257.00	91.140	181.190	7534.24	6466.40	-6468.72	323.50	40°06'52.735"N	104°51'19.015"W	3.24	
13342.00	90.430	180.430	7533.08	6551.39	-6553.70	322.30	40°06'51.896"N	104°51'19.031"W	1.22	
13427.00	89.630	181.000	7533.04	6636.39	-6638.69	321.24	40°06'51.056"N	104°51'19.044"W	1.16	
13512.00	88.000	180.530	7534.79	6721.37	-6723.66	320.10	40°06'50.216"N	104°51'19.059"W	2.00	
13600.00	88.770	180.740	7537.27	6809.33	-6811.62	319.13	40°06'49.347"N	104°51'19.072"W	0.91	
13685.00	88.610	180.030	7539.22	6894.31	-6896.60	318.56	40°06'48.507"N	104°51'19.079"W	0.86	
13772.00	88.400	179.760	7541.49	6981.27	-6983.57	318.72	40°06'47.648"N	104°51'19.077"W	0.39	
13858.00	90.370	179.720	7542.41	7067.26	-7069.56	319.11	40°06'46.798"N	104°51'19.072"W	2.29	
13945.00	90.990	179.570	7541.38	7154.24	-7156.55	319.64	40°06'45.938"N	104°51'19.065"W	0.73	
14030.00	91.070	179.500	7539.85	7239.22	-7241.53	320.33	40°06'45.098"N	104°51'19.056"W	0.13	
14116.00	90.730	178.800	7538.50	7325.19	-7327.51	321.61	40°06'44.249"N	104°51'19.040"W	0.90	
14201.00	90.990	178.290	7537.22	7410.14	-7412.47	323.77	40°06'43.409"N	104°51'19.012"W	0.67	
14286.00	90.400	179.250	7536.19	7495.10	-7497.45	325.59	40°06'42.569"N	104°51'18.988"W	1.33	
14374.00	91.660	179.160	7534.61	7583.06	-7585.42	326.81	40°06'41.700"N	104°51'18.973"W	1.44	

REFERENCE WELLPATH IDENTIFICATION			
Operator	KERR-MCGEE OIL & GAS ONSHORE LP	Slot	SLOT#02 BARCLAY 15C-26HZ (577'FSL & 2193'FEL, SEC.14)
Area	COLORADO	Well	BARCLAY 15C-26HZ
Field	WELD COUNTY (KERR MCGEE)	Wellbore	BARCLAY 15C-26HZ AWB <62-16520>
Facility	SEC.14-T2N-R67W		

WELLPATH DATA (171 stations)										
MD [ft]	Inclination [°]	Azimuth [°]	TVD [ft]	Vert Sect [ft]	North [ft]	East [ft]	Latitude	Longitude	DLS [°/100ft]	Comments
14459.00	89.970	180.610	7533.40	7668.04	-7670.41	326.98	40°06'40.860"N	104°51'18.971"W	2.62	
14544.00	90.370	180.180	7533.15	7753.04	-7755.40	326.40	40°06'40.020"N	104°51'18.978"W	0.69	
14631.00	90.220	179.670	7532.70	7840.04	-7842.40	326.51	40°06'39.160"N	104°51'18.977"W	0.61	
14718.00	87.690	179.030	7534.29	7927.00	-7929.38	327.50	40°06'38.301"N	104°51'18.964"W	3.00	
14803.00	88.830	179.430	7536.87	8011.94	-8014.33	328.64	40°06'37.462"N	104°51'18.949"W	1.42	
14888.00	89.750	179.790	7537.92	8096.93	-8099.32	329.22	40°06'36.622"N	104°51'18.942"W	1.16	
14973.00	89.510	180.670	7538.47	8181.93	-8184.31	328.88	40°06'35.782"N	104°51'18.946"W	1.07	
15059.00	88.950	181.330	7539.63	8267.91	-8270.29	327.38	40°06'34.932"N	104°51'18.966"W	1.01	
15144.00	88.060	180.730	7541.84	8352.88	-8355.25	325.85	40°06'34.092"N	104°51'18.985"W	1.26	
15229.00	88.340	180.050	7544.51	8437.83	-8440.20	325.27	40°06'33.253"N	104°51'18.993"W	0.86	
15315.00	89.720	180.610	7545.97	8523.82	-8526.19	324.78	40°06'32.403"N	104°51'18.999"W	1.73	
15401.00	89.780	181.430	7546.34	8609.81	-8612.17	323.24	40°06'31.554"N	104°51'19.019"W	0.96	
15487.00	90.650	181.110	7546.02	8695.80	-8698.15	321.34	40°06'30.704"N	104°51'19.043"W	1.08	
15572.00	90.980	182.270	7544.81	8780.77	-8783.10	318.83	40°06'29.864"N	104°51'19.076"W	1.42	
15659.00	90.120	183.160	7543.98	8867.69	-8870.00	314.71	40°06'29.006"N	104°51'19.129"W	1.42	
15744.00	91.170	182.980	7543.02	8952.59	-8954.87	310.16	40°06'28.167"N	104°51'19.187"W	1.25	
15829.00	90.250	182.560	7541.97	9037.51	-9039.76	306.05	40°06'27.328"N	104°51'19.240"W	1.19	
15916.00	89.540	183.320	7542.13	9124.42	-9126.65	301.59	40°06'26.469"N	104°51'19.298"W	1.20	
16002.00	88.760	182.310	7543.40	9210.33	-9212.53	297.37	40°06'25.621"N	104°51'19.352"W	1.48	
16087.00	90.120	182.110	7544.23	9295.28	-9297.46	294.09	40°06'24.781"N	104°51'19.394"W	1.62	
16174.00	91.320	181.910	7543.14	9382.24	-9384.40	291.04	40°06'23.922"N	104°51'19.433"W	1.40	
16261.00	90.370	182.530	7541.86	9469.19	-9471.33	287.67	40°06'23.063"N	104°51'19.477"W	1.30	
16346.00	91.870	180.180	7540.20	9554.15	-9556.28	285.66	40°06'22.224"N	104°51'19.503"W	3.28	
16433.00	90.800	182.540	7538.17	9641.10	-9643.22	283.59	40°06'21.365"N	104°51'19.529"W	2.98	
16520.00	90.430	182.090	7537.23	9728.05	-9730.15	280.08	40°06'20.506"N	104°51'19.575"W	0.67	
16605.00	91.480	181.960	7535.82	9813.00	-9815.08	277.08	40°06'19.666"N	104°51'19.613"W	1.24	
16691.00	89.140	181.410	7535.35	9898.97	-9901.03	274.55	40°06'18.817"N	104°51'19.646"W	2.80	
16776.00	89.780	181.000	7536.15	9983.96	-9986.01	272.76	40°06'17.977"N	104°51'19.669"W	0.89	
16862.00	90.830	180.790	7535.70	10069.95	-10072.00	271.42	40°06'17.127"N	104°51'19.686"W	1.25	
16949.00	88.980	179.370	7535.84	10156.95	-10158.99	271.30	40°06'16.268"N	104°51'19.688"W	2.68	
17036.00	90.180	179.010	7536.48	10243.92	-10245.98	272.53	40°06'15.408"N	104°51'19.672"W	1.44	
17123.00	90.800	178.620	7535.73	10330.89	-10332.96	274.32	40°06'14.549"N	104°51'19.649"W	0.84	
17210.00	87.850	178.200	7536.76	10417.82	-10419.91	276.74	40°06'13.689"N	104°51'19.618"W	3.42	
17295.00	88.950	178.240	7539.13	10502.72	-10504.83	279.38	40°06'12.850"N	104°51'19.584"W	1.29	
17346.00	89.450	178.050	7539.84	10553.68	-10555.80	281.03	40°06'12.346"N	104°51'19.562"W	1.05	Last BHI MWD+IFR Surveys
17397.00	89.450	178.050	7540.33	10604.64	-10606.77	282.76	40°06'11.843"N	104°51'19.540"W	0.00	Projection to Bit

REFERENCE WELLPATH IDENTIFICATION			
Operator	KERR-MCGEE OIL & GAS ONSHORE LP	Slot	SLOT#02 BARCLAY 15C-26HZ (577'FSL & 2193'FEL, SEC.14)
Area	COLORADO	Well	BARCLAY 15C-26HZ
Field	WELD COUNTY (KERR MCGEE)	Wellbore	BARCLAY 15C-26HZ AWB <62-16520>
Facility	SEC.14-T2N-R67W		

HOLE & CASING SECTIONS									
- Ref Wellbore: BARCLAY 15C-26HZ AWB <62-16520>					Ref Wellpath: BARCLAY 15C-26HZ AWP				
String/Diameter	Start MD [ft]	End MD [ft]	Interval [ft]	Start TVD [ft]	End TVD [ft]	Start N/S [ft]	Start E/W [ft]	End N/S [ft]	End E/W [ft]
13.5in Open Hole	16.00	1133.00	1117.00	16.00	1132.96	0.00	0.00	1.62	-1.31
9.625in Casing Surface	16.00	1123.00	1107.00	16.00	1122.96	0.00	0.00	1.59	-1.37
8.75in Open Hole	1133.00	7893.00	6760.00	1132.96	7499.13	1.62	-1.31	-1106.20	377.21
7in Casing Intermediate	16.00	7883.00	7867.00	16.00	7498.76	0.00	0.00	-1096.21	377.48
6.125in Open Hole	7893.00	17397.00	9504.00	7499.13	7540.33	-1106.20	377.21	-10606.77	282.76

TARGETS								
Name	TVD [ft]	North [ft]	East [ft]	Grid East [US ft]	Grid North [US ft]	Latitude	Longitude	Shape
SEC.14-T2N-R67W SECTION LINES	-1.00	0.20	-29.98	3179914.43	1291732.03	40°07'56.662"N	104°51'23.565"W	polygon
SEC.23-T2N-R67W SECTION LINES	-1.00	0.20	-29.98	3179914.43	1291732.03	40°07'56.662"N	104°51'23.565"W	polygon
SEC.26-T2N-R67W SECTION LINES	-1.00	0.20	-29.98	3179914.43	1291732.03	40°07'56.662"N	104°51'23.565"W	polygon
BARCLAY 15C-26HZ BHL (460'FSL & 1830'FEL, SEC.26) REV-2	7543.00	-10617.20	296.17	3180317.61	1281117.73	40°06'11.740"N	104°51'19.368"W	point
BARCLAY 15C-26HZ BHL ON PLAT (460'FSL & 1865'FEL, SEC.26) REV-1	7543.00	-10617.20	261.17	3180282.61	1281117.48	40°06'11.740"N	104°51'19.818"W	point
BARCLAY 15C-26HZ LANDBOX	7568.00	0.00	0.00	3179944.41	1291732.05	40°07'56.660"N	104°51'23.179"W	polygon

WELLPATH COMPOSITION - Ref Wellbore: BARCLAY 15C-26HZ AWB <62-16520>					Ref Wellpath: BARCLAY 15C-26HZ AWP
Start MD [ft]	End MD [ft]	Positional Uncertainty Model	Log Name/Comment	Wellbore	
16.00	1085.00	ISCWSA MWD, Rev. 2 (Standard)	CATHEDRAL MWD SURVEYS <62-1085>	BARCLAY 15C-26HZ AWB <62-16520>	
1085.00	7843.00	NaviTrak (MAGCORR,IFR)	BHI MWD+IFR SURVEYS 8 3/4" HOLE <1176-7843>	BARCLAY 15C-26HZ AWB <62-16520>	
7843.00	17346.00	NaviTrak (MAGCORR,IFR)	BHI MWD+IFR SURVEYS 6 1/8" HOLE <7928-16520>	BARCLAY 15C-26HZ AWB <62-16520>	
17346.00	17397.00	Blind Drilling (std)	Projection to bit	BARCLAY 15C-26HZ AWB <62-16520>	

REFERENCE WELLPATH IDENTIFICATION			
Operator	KERR-MCGEE OIL & GAS ONSHORE LP	Slot	SLOT#02 BARCLAY 15C-26HZ (577'FSL & 2193'FEL, SEC.14)
Area	COLORADO	Well	BARCLAY 15C-26HZ
Field	WELD COUNTY (KERR MCGEE)	Wellbore	BARCLAY 15C-26HZ AWB <62-16520>
Facility	SEC.14-T2N-R67W		

WELLPATH COMMENTS				
MD [ft]	Inclination [°]	Azimuth [°]	TVD [ft]	Comment
16.00	0.000	246.000	16.00	Tie-On
62.00	0.300	246.000	62.00	Begin CATHEDRAL MWD Surveys
1085.00	0.400	72.600	1084.97	Tie-Into CATHEDRAL MWD Surveys
1176.00	0.400	45.260	1175.96	Begin BHI MWD+IFR Surveys
7883.00	87.603	181.543	7498.76	7" Casing Point
17346.00	89.450	178.050	7539.84	Last BHI MWD+IFR Surveys
17397.00	89.450	178.050	7540.33	Projection to Bit