

# Great Western Operating Company, LLC

Created by admin  
Date plotted 17-Feb-2015

**Location** Colorado  
**Field** Wattenberg  
**Installation** Kortum

**Slot** Slot W09 - Kortum LD 21-376HN  
**Well** Kortum LD 21-376HN  
**Wellbore** Kortum LD 21-376HN (PWB)

Plot reference is Kortum LD 21-376HN (PWB).  
Ref wellpath is Kortum LD 21-376HN (PWP#1).  
Coordinates are in Feet reference Slot W09 - Kortum LD 21-376HN.  
True Vertical Depths are reference Rig Datum.  
Measured Depths are reference Rig Datum.  
Rig Datum: Planned Datum #1  
Rig Datum to Mean Sea Level: 5208.00 ft.  
Plot North is aligned to GRID North.

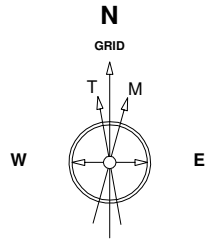

16-Feb-2015  
IGRF Model [1900.0-2020.0] Dip: 66.54 deg Field: 52410.6 nT  
Lat: N39 57 25.5816 Long: W104 53 34.5840 Elev: 5191.80 ft  
Magnetic North is 8.49 deg East of True North  
GRID North is 0.39 deg East of True North  
To correct azimuth from True to GRID subtract 0.39 deg  
To correct azimuth from Magnetic to GRID add 8.09 deg

Scale 1 cm = 350 ft

East (Feet) ->

-4200 -3500 -2800 -2100 -1400 -700 0 700 1400 2100 2800 3500 4200 4900

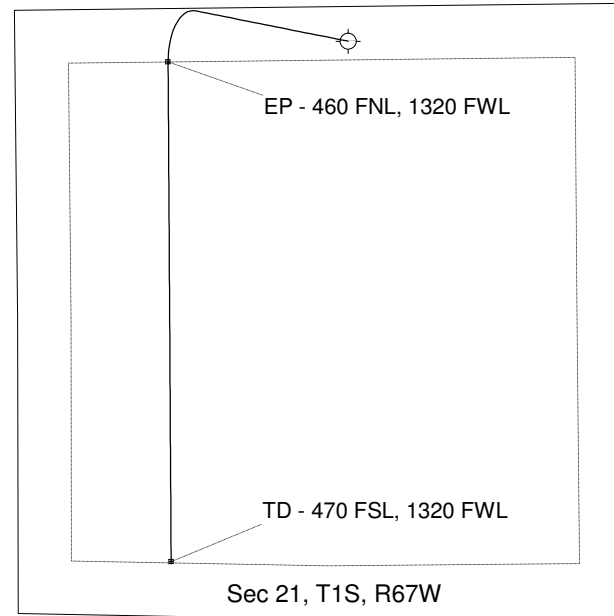
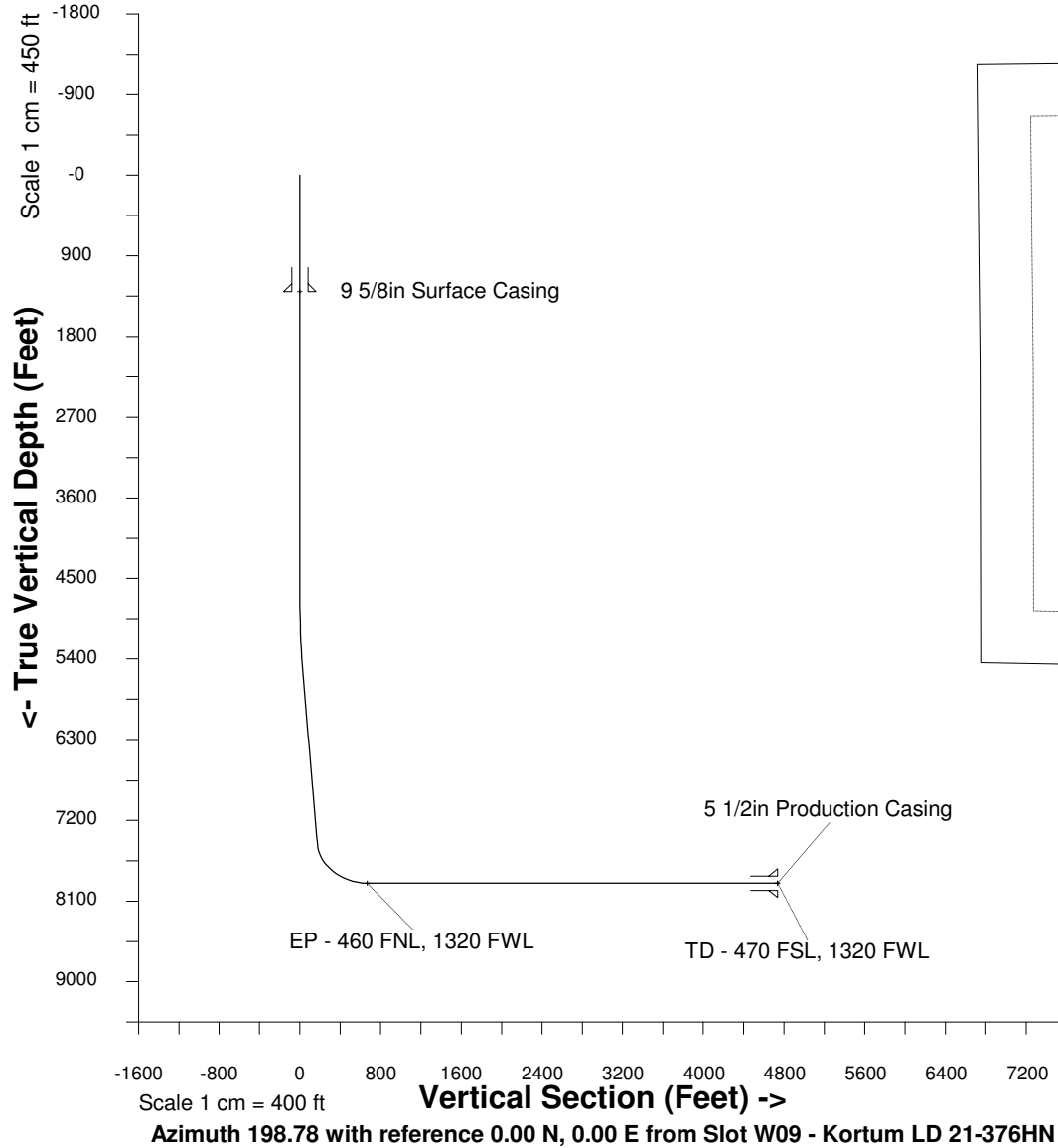

## WELL PROFILE DATA

Point	MD	Inc	Azi	TVD	North	East	deg/100ft	V. Sect
Tie on	16.20	0.00	0.00	16.20	S 0.00	W 0.00		-0.00
KOP	4650.00	0.00	281.26	4650.00	S 0.00	W 0.00	0.00	-0.00
End of Build	5652.43	30.07	281.26	5607.03	N 50.21	W 252.14	9.84	33.64
End of Hold	7814.40	30.07	281.26	7477.98	N 261.79	W 1314.64	0.00	175.39
Target EP - 4...20 FWL	8551.23	90.00	179.65	7900.00	S 178.15	W 1551.35	42.65	668.10
T.D. & Target TD ...FWL	12858.52	90.00	179.65	7900.00	S 4485.36	W 1525.22	0.00	4737.59