



VIA EFORMS

Mr. Matt Lepore
Colorado Oil & Gas Conservation Commission
1120 Lincoln Street, Suite 801
Denver, CO 80203

May 11, 2015

RE: Application for Permit to Drill - Proposed Wellbore Spacing Unit
Synergy Resources Corporation
Ivey P-11-12HN
SHL: 1,035' FSL 1,746' FEL (SW/4 SE/4)
Sec. 11 T1S R68W
BHL: ±190' FSL ±2,175' FWL (SE/4 SW/4)
Sec. 12 T1S R68W
Adams County, Colorado
Surface: Fee
Mineral Lease: Fee

Dear Mr. Lepore:

Synergy Resources Corporation (Synergy) respectfully requests that the Director approve the Proposed Spacing Unit (PSU) for the above referenced well.

In compliance with COGCC Rule 318A.e.(5), Synergy provides the following information:

Description of the Wellbore Orientation and Wellbore Spacing Unit: The proposed horizontal wellbore path will run west to east. The Proposed Spacing Unit is as follows:

Well Name	Proposed Spacing Unit	Acreage
Ivey P-11-12HN	T1S R68W Sec. 11:SWSE, SESE; T1S R68W Sec. 12: SWSW, SESW T1S R68W Sec. 13: NWNW, NENW; T1S R68W Sec. 14: NWNE, NENE	320

Description of Wellbore Orientation & Proposed Surface, Bottom, and Productive Interval Locations and Target Formation:

The proposed wellbore will run west to east, beginning in Sec. 11 T1S R68W and ending in Sec. 12 T1S R68W. Please see the enclosed PSU. The proposed locations is as follows:

Well Name	Surface Hole	Productive Interval	Bottom Hole	Formation
Ivey P-11-12HN	1,035' FSL 1,746' FEL	190' FSL 2,175' FEL	190' FSL 2,175' FWL	Niobrara

Synergy requests the Director approve the proposed wellbore spacing unit.

This letter hereby certifies that Synergy complied with Rule 318A.e.(5) on December 16, 2014 for the above referenced oil and gas well. All mineral interest owners were sent letters notifying them of the proposed spacing unit. The Mineral Interest Owner letters were sent by Bayswater Exploration & Production who was

Your Assets / Our Expertise

- Regulatory
- Storm-water Management Plans
- Project Coordination
- Permitting
- Government Relations
- EA/EIS Assistance

Mr. Matt Lepore
May 11, 2015
Page 2

the original operator of the proposed well. Synergy bought the prospect and no changes were made to either the surface, landing point, or bottom-hole locations since the Mineral Interest owners were notified. No disputes were received.

Please send a copy of all correspondence to Upstream Petroleum Management, Inc. at 7000 S. Yosemite St., Suite 290B, Englewood, CO 80112. Please contact me at 303-942-0506 or at acallaway@upstreampm.com if you have any questions.

Sincerely,



Angela G. Callaway
Permit Agent for Synergy Resources Corporation

Your Assets / Our Expertise

- Regulatory
- Storm-water Management Plans
- Project Coordination
- Permitting
- Government Relations
- EA/EIS Assistance

IVEY 11-N NORTH PAD PROPOSED 318A.e. SPACING UNIT

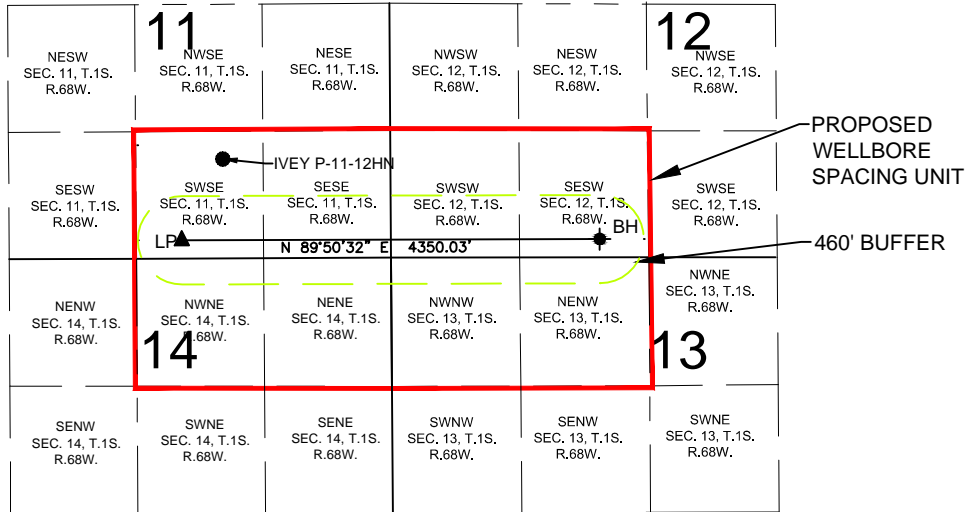

WELL **IVEY P-11-12HN** TO BE LOCATED 1035' FSL AND 1746' FEL, SEC. 11, T1S, R68W

LEGEND

- = PROPOSED WELL LP = LANDING POINT
- ▲ = LANDING POINT BH = BOTTOM HOLE
- ◆ = BOTTOM HOLE

SURFACE LOCATION

NAD83
LATITUDE= 39.974865°
LONGITUDE= 104.965650°

LANDING POINT LOCATION

NAD83
LATITUDE= 39.972547°
LONGITUDE= 104.967181°

BOTTOM HOLE LOCATION

NAD83
LATITUDE= 39.972507°
LONGITUDE= 104.951660°

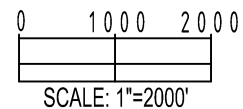

PREPARED BY:



FIELD DATE:
06-03-14

DRAWING DATE:
03-02-15

BY:
DRF

CHECKED BY:
MDCA

SITE NAME:
IVEY 11-N NORTH PAD

SURFACE LOCATION:
SW 1/4 SE 1/4, SEC. 11, T1S, R68W, 6TH P.M.
ADAMS COUNTY, COLORADO

PREPARED FOR:

