



Lat40°, Inc. 1635 Foxtrail Drive, Suite 325 Loveland, CO 970-776-3321

NOTIFICATION ZONE DRAWING

R&R FARMS 5N63W29Q PAD

SECTION: 29
TOWNSHIP: 5N
RANGE: 63W

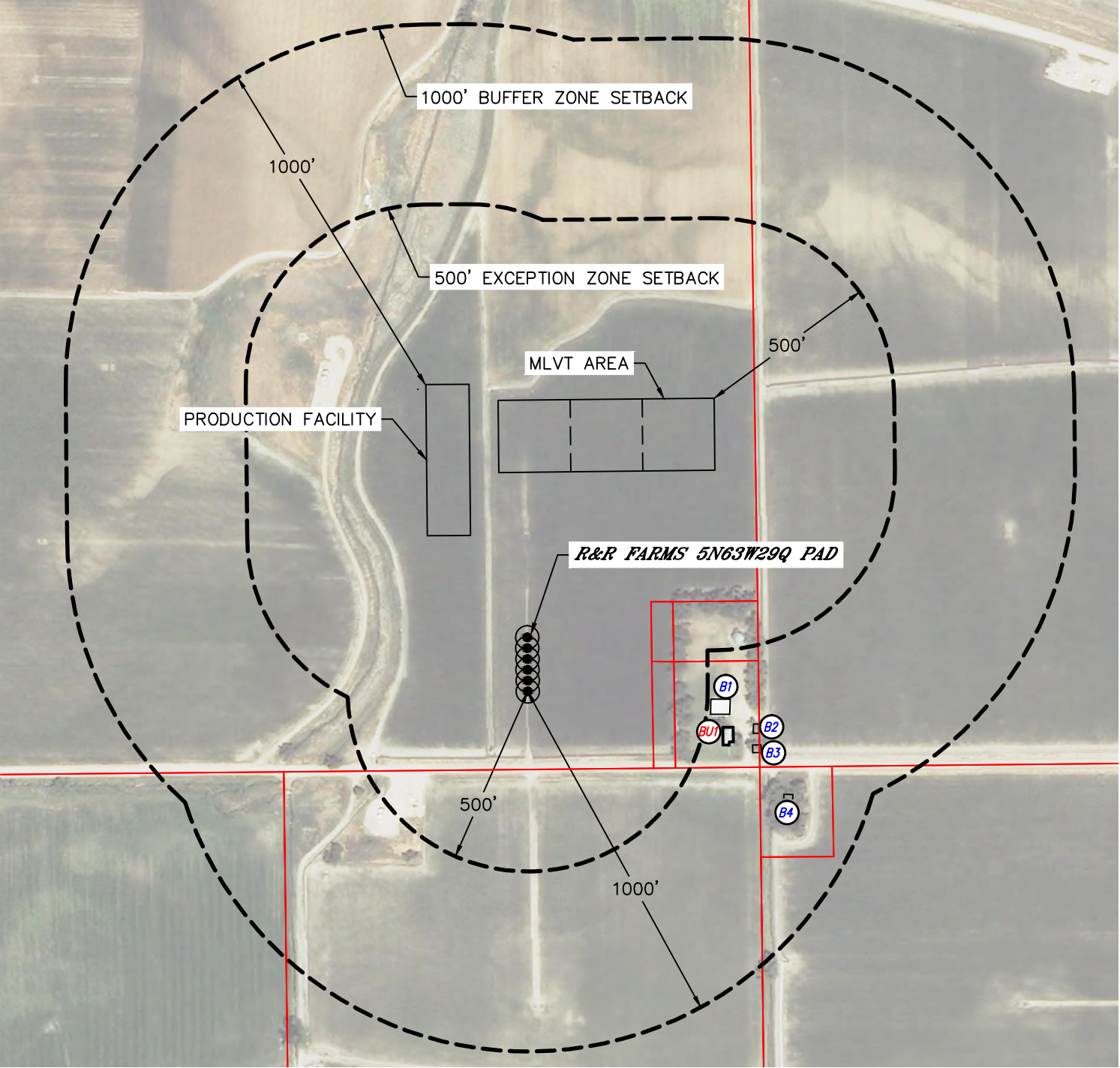



EXCEPTION ZONE:

NO EXISTING BUILDING UNITS WITHIN EXCEPTION ZONE

BUFFER ZONE:

 BUILDING UNIT BU1 ±551' SE

LEGEND

-  PROPERTY LINE
-  BUILDING
-  BUILDING UNIT

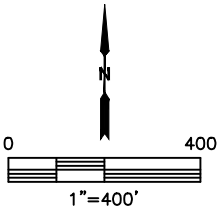

DATE: 3/30/2015
PROJECT#: 2014131