

2013 ANNUAL PROJECT SUMMARY TABLE

| Incident Date | Remediation No. | Well Name | API | Status | NFA Submitted | NFA Approved Date | 2013 Site Summary (monitoring/remediation/ wells installed or destroyed) | Wells Sampled (Last Quarter) 2013 | Wells Exceeding 5 ug/L Benzene (Last Quarter Sampled 2013) | Benzene Range (ug/L) (Last Quarter 2013) | POC Established | 2014 Recommendations | Well Reduction Request |
|---------------|-----------------|----------------|--------------|-------------|---------------|-------------------|---|---|--|--|-----------------|--|------------------------|
| 9/28/2009 | 4891 | HSR-Dreyer 5-5 | 05-001-09223 | Remediation | NO | N/A | Quarterly groundwater monitoring since Dec-2009. Free product was purged bi-monthly from MW01, MW07, MW09, MW10, MW16, MW19, and MW20. MW16 destroyed Sept-2013. MW07 and MW20 destroyed Dec-2013. | MW01-MW06, MW08-MW15, MW17-MW19, MW21-MW28 | MW01, MW02, MW09, MW10, MW19 | ND - Product | YES | MW07, MW16, and MW20 will be replaced. Quarterly groundwater monitoring will continue. Free product will continue to be purged bi-monthly from wells MW01, MW07, MW09, MW10, MW16, MW19, and MW20. | MW13, MW14 |

Notes:

N/A - Not Applicable

ND - Non-Detect

NFA - No Further Action

POC - Point of Compliance

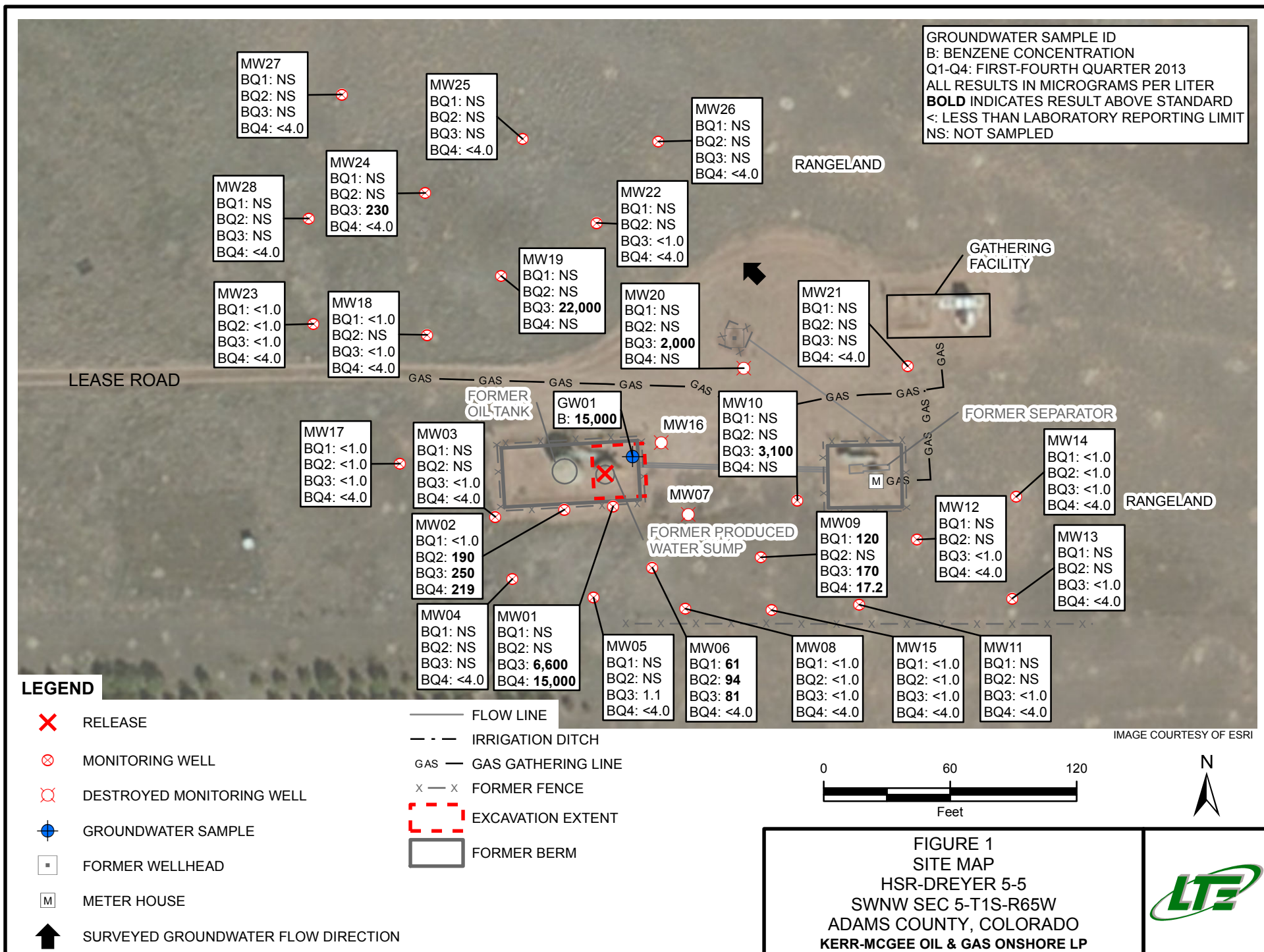

TABLE 1
GROUNDWATER ANALYTICAL AND FIELD RESULTS
HSR-DREYER 5-5
WELD COUNTY, COLORADO
KERR-MCGEE OIL & GAS ONSHORE LP

| Well Name | Date | Benzene (ug/L) | Toluene (ug/L) | Ethylbenzene (ug/L) | Xylenes (ug/L) | Depth Water/ (Product Thickness) (ft bgs) |
|------------------|-------------|-----------------------|-----------------------|----------------------------|-----------------------|--|
| GW01 | 09/25/2009 | 15000 | 21000 | 290 | 7200 | NM |
| MW01 | 12/17/2009 | 19000 | 23000 | 570 | 7600 | 8.38 |
| | 03/12/2010 | 34000 | 44000 | 460 | 5100 | 10.83 |
| | 06/15/2010 | 40000 | 67000 | 410 | 5200 | 9.08 |
| | 09/16/2010 | 22000 | 34000 | 830 | 8900 | 8.83 |
| | 12/07/2010 | 20000 | 31000 | 670 | 7900 | 9.84 |
| | 03/15/2011 | 34000 | 47000 | 390 | 5200 | 11.24 |
| | 06/27/2011 | Product - Not Sampled | | | | 11.47 (0.50) |
| | 09/14/2011 | 27000 | 42000 | 1000 | 12000 | 9.17 |
| | 12/16/2011 | 21000 | 36000 | 880 | 12000 | 9.68 |
| | 03/07/2012 | 19000 | 38000 | 600 | 10000 | 10.68 |
| | 06/25/2012 | 6400 | 16000 | 390 | 5100 | 11.44 |
| | 09/24/2012 | 11000 | 17000 | 330 | 4800 | 11.78 |
| | 12/28/2012 | Product - Not Sampled | | | | 14.33 (2.10) |
| | 03/28/2013 | Product - Not Sampled | | | | 15.73 (1.90) |
| | 06/05/2013 | Product - Not Sampled | | | | 13.37 (0.16) |
| | 09/05/2013 | 6600 | 16000 | 340 | 6400 | 11.68 |
| | 12/17/2013 | 15000 | 31000 | 325 | 9430 | 10.04 |
| MW02 | 12/17/2009 | 2100 | 3100 | 150 | 1400 | 8.99 |
| | 03/12/2010 | 160 | 160 | 57 | 100 | 10.61 |
| | 06/15/2010 | 390 | 900 | 24 | 170 | 8.97 |
| | 09/16/2010 | 23 | 1.5 | 38 | 4.4 | 8.56 |
| | 12/07/2010 | 89 | 70 | 13 | 24 | 9.60 |
| | 03/15/2011 | 77 | 23 | 100 | 11 | 11.04 |
| | 06/27/2011 | 1700 | 5700 | 560 | 2800 | 11.06 |
| | 09/14/2011 | 17 | 2.9 | 29 | 46 | 9.06 |
| | 12/16/2011 | 160 | 200 | 39 | 150 | 9.63 |
| | 03/07/2012 | 180 | 450 | 39 | 190 | 10.56 |
| | 06/25/2012 | 14 | <1.0 | 27 | 12 | 11.06 |
| | 09/24/2012 | 17 | 2.9 | 7.2 | <1.0 | 11.26 |
| | 12/28/2012 | 14 | 1.2 | 5.5 | <1.0 | 12.91 |
| | 03/28/2013 | <1.0 | <1.0 | <1.0 | 25 | 13.96 |
| | 06/05/2013 | 190 | 64 | 43 | 270 | 12.95 |
| | 09/05/2013 | 250 | 5.8 | 18 | 210 | 11.52 |
| | 12/17/2013 | 219 | 41.9 | 16.8 | 397 | 9.84 |



TABLE 1 (Continued)
GROUNDWATER ANALYTICAL AND FIELD RESULTS
HSR-DREYER 5-5
WELD COUNTY, COLORADO
KERR-MCGEE OIL & GAS ONSHORE LP

| Well Name | Date | Benzene (ug/L) | Toluene (ug/L) | Ethylbenzene (ug/L) | Xylenes (ug/L) | Depth Water/ (Product Thickness) (ft bgs) |
|-----------|------------|----------------------------------|----------------|---------------------|----------------|---|
| MW03 | 12/17/2009 | <1.0 | 3.4 | <1.0 | 1.3 | 8.72 |
| | 03/12/2010 | <1.0 | <1.0 | <1.0 | <1.0 | 10.36 |
| | 06/15/2010 | <1.0 | <1.0 | <1.0 | <1.0 | 8.76 |
| | 09/16/2010 | <1.0 | <1.0 | <1.0 | <1.0 | 8.36 |
| | 12/07/2010 | <1.0 | <1.0 | <1.0 | <1.0 | 9.36 |
| | 03/15/2011 | <1.0 | <1.0 | <1.0 | <1.0 | 10.80 |
| | 06/27/2011 | 2.5 | 14 | 1.0 | 8.1 | 10.86 |
| | 09/14/2011 | <1.0 | <1.0 | <1.0 | <1.0 | 8.82 |
| | 12/16/2011 | 1.3 | 3.8 | <1.0 | 2.3 | 9.36 |
| | 03/07/2012 | <1.0 | 1.8 | <1.0 | <1.0 | 10.36 |
| | 06/25/2012 | <1.0 | <1.0 | <1.0 | <1.0 | 10.74 |
| | 09/24/2012 | <1.0 | 1.3 | <1.0 | <1.0 | 10.99 |
| | 12/28/2012 | Insufficient Water - Not Sampled | | | | 12.71 |
| | 03/28/2013 | Dry - Not Sampled | | | | Dry |
| | 06/05/2013 | Insufficient Water - Not Sampled | | | | 12.73 |
| | 09/05/2013 | <1.0 | <1.0 | <1.0 | <1.0 | 11.20 |
| | 12/17/2013 | <4.0 | <4.0 | <4.0 | <4.0 | 9.53 |
| MW04 | 12/17/2009 | 1.1 | 6.8 | <1.0 | 7.4 | 8.14 |
| | 03/12/2010 | <1.0 | <1.0 | <1.0 | <1.0 | 10.29 |
| | 06/15/2010 | <1.0 | <1.0 | <1.0 | <1.0 | 8.19 |
| | 09/16/2010 | <1.0 | <1.0 | <1.0 | <1.0 | 7.94 |
| | 12/07/2010 | <1.0 | <1.0 | <1.0 | <1.0 | 8.96 |
| | 03/15/2011 | <1.0 | <1.0 | <1.0 | <1.0 | 10.38 |
| | 06/27/2011 | 2.6 | 8.2 | <1.0 | 2.8 | 10.37 |
| | 09/14/2011 | 1.8 | 11 | <1.0 | 6.9 | 8.45 |
| | 12/16/2011 | <1.0 | <1.0 | <1.0 | <1.0 | 10.16 |
| | 03/07/2012 | <1.0 | <1.0 | <1.0 | <1.0 | 9.94 |
| | 06/25/2012 | Dry - Not Sampled | | | | Dry |
| | 09/24/2012 | <1.0 | <1.0 | <1.0 | <1.0 | 10.95 |
| | 12/28/2012 | Dry - Not Sampled | | | | Dry |
| | 03/28/2013 | Dry - Not Sampled | | | | Dry |
| | 06/05/2013 | Dry - Not Sampled | | | | Dry |
| | 09/05/2013 | Insufficient Water - Not Sampled | | | | 10.77 |
| | 12/17/2013 | <4.0 | <4.0 | <4.0 | <4.0 | 9.07 |



TABLE 1 (Continued)
GROUNDWATER ANALYTICAL AND FIELD RESULTS
HSR-DREYER 5-5
WELD COUNTY, COLORADO
KERR-MCGEE OIL & GAS ONSHORE LP

| Well Name | Date | Benzene (ug/L) | Toluene (ug/L) | Ethylbenzene (ug/L) | Xylenes (ug/L) | Depth Water/ (Product Thickness) (ft bgs) |
|------------------|-------------|-----------------------|-----------------------|----------------------------|-----------------------|--|
| MW05 | 12/17/2009 | <1.0 | 5.4 | <1.0 | 5.4 | 7.93 |
| | 03/12/2010 | <1.0 | <1.0 | <1.0 | <1.0 | 9.60 |
| | 06/15/2010 | <1.0 | <1.0 | <1.0 | <1.0 | 8.00 |
| | 09/16/2010 | <1.0 | <1.0 | <1.0 | <1.0 | 8.90 |
| | 12/07/2010 | <1.0 | <1.0 | <1.0 | <1.0 | 8.88 |
| | 03/15/2011 | <1.0 | <1.0 | <1.0 | <1.0 | 10.36 |
| | 06/27/2011 | 11 | 69 | 3.7 | 49 | 10.30 |
| | 09/14/2011 | <1.0 | 8.3 | <1.0 | 11 | 8.42 |
| | 12/16/2011 | <1.0 | <1.0 | <1.0 | <1.0 | 8.91 |
| | 03/07/2012 | <1.0 | <1.0 | <1.0 | <1.0 | 9.90 |
| | 06/25/2012 | <1.0 | <1.0 | <1.0 | <1.0 | 9.96 |
| | 09/24/2012 | <1.0 | 2.2 | <1.0 | <1.0 | 10.40 |
| | 12/28/2012 | Dry - Not Sampled | | | | Dry |
| | 03/28/2013 | Dry - Not Sampled | | | | Dry |
| | 06/05/2013 | Dry - Not Sampled | | | | Dry |
| | 09/05/2013 | 1.1 | 16 | <1.0 | 14 | 10.76 |
| | 12/17/2013 | <4.0 | <4.0 | <4.0 | <4.0 | 9.08 |
| MW06 | 03/12/2010 | 1500 | 13000 | <1.0 | <1.0 | 9.95 |
| | 06/15/2010 | 1700 | 28000 | 550 | 7300 | 8.60 |
| | 09/16/2010 | 680 | 15000 | 680 | 7800 | 8.50 |
| | 12/07/2010 | 1200 | 23000 | 690 | 9000 | 9.51 |
| | 03/15/2011 | 920 | 26000 | 500 | 7100 | 10.99 |
| | 06/27/2011 | 220 | 7600 | 310 | 3500 | 10.95 |
| | 09/14/2011 | 120 | 15000 | 570 | 6900 | 9.07 |
| | 12/16/2011 | 14 | 18000 | 700 | 8400 | 9.97 |
| | 03/07/2012 | 190 | 19000 | 430 | 6900 | 10.45 |
| | 06/25/2012 | 8.6 | 3200 | 240 | 4000 | 10.80 |
| | 09/24/2012 | 20 | 7100 | 310 | 3900 | 10.73 |
| | 12/28/2012 | 8.9 | 38 | 97 | 1500 | 12.40 |
| | 03/28/2013 | 61 | 200 | 57 | 1600 | 13.43 |
| | 06/05/2013 | 94 | 280 | 170 | 2200 | 12.91 |
| | 09/05/2013 | 81 | 350 | 230 | 2600 | 11.35 |
| | 12/17/2013 | <4.0 | 400 | 112 | 4700 | 9.76 |



TABLE 1 (Continued)
GROUNDWATER ANALYTICAL AND FIELD RESULTS
HSR-DREYER 5-5
WELD COUNTY, COLORADO
KERR-MCGEE OIL & GAS ONSHORE LP

| Well Name | Date | Benzene (ug/L) | Toluene (ug/L) | Ethylbenzene (ug/L) | Xylenes (ug/L) | Depth Water/ (Product Thickness) (ft bgs) |
|-----------|---------------------------------|-----------------------|----------------|---------------------|----------------|---|
| MW07 | 03/12/2010 | 9900 | 17000 | 600 | 8100 | PVC Blocked |
| | 06/15/2010 | 28000 | 48000 | 450 | 5500 | 9.22 |
| | 09/16/2010 | 21000 | 34000 | 1100 | 12000 | 9.05 |
| | 12/07/2010 | 23000 | 40000 | 980 | 12000 | 10.03 |
| | 03/15/2011 | 23000 | 44000 | 600 | 4700 | 10.29 |
| | 06/27/2011 | Product - Not Sampled | | | | PVC Blocked |
| | 09/14/2011 | 24000 | 34000 | 640 | 15000 | 9.60 |
| | 12/16/2011 | 20000 | 31000 | 920 | 16000 | 10.02 |
| | 03/07/2012 | 15000 | 27000 | 510 | 12000 | PVC Blocked |
| | 06/25/2012 | 12000 | 22000 | 490 | 10000 | PVC Blocked |
| | 09/24/2012 | Dry - Not Sampled | | | | Dry |
| | 12/28/2012 | Dry - Not Sampled | | | | Dry |
| | 03/28/2013 | Dry - Not Sampled | | | | Dry |
| | 06/05/2013 | Dry - Not Sampled | | | | Dry |
| | 09/05/2013 | Dry - Not Sampled | | | | Dry |
| | MW07 destroyed as of 12/17/2013 | | | | | |
| MW08 | 04/27/2010 | 5.9 | 23 | 2.4 | 8.1 | 9.43 |
| | 06/15/2010 | <1.0 | <1.0 | <1.0 | <1.0 | 8.31 |
| | 09/16/2010 | <1.0 | <1.0 | <1.0 | <1.0 | 8.29 |
| | 12/07/2010 | <1.0 | <1.0 | 18 | 1.6 | 9.32 |
| | 03/15/2011 | <1.0 | <1.0 | 38 | 12 | 10.77 |
| | 06/27/2011 | 1.4 | 11 | 1.2 | 9.2 | 10.62 |
| | 09/14/2011 | <1.0 | <1.0 | <1.0 | <1.0 | 8.84 |
| | 12/16/2011 | 1.9 | 6.3 | 1.7 | 4.2 | 9.29 |
| | 03/07/2012 | 1.4 | 3.6 | <1.0 | 2.0 | 10.49 |
| | 06/25/2012 | <1.0 | <1.0 | <1.0 | <1.0 | 10.74 |
| | 09/24/2012 | <1.0 | <1.0 | <1.0 | <1.0 | 10.79 |
| | 12/28/2012 | <1.0 | 3.0 | <1.0 | <1.0 | 12.33 |
| | 03/28/2013 | <1.0 | <1.0 | <1.0 | <1.0 | 13.46 |
| | 06/05/2013 | <1.0 | 64 | 6.2 | 86 | 12.85 |
| | 09/05/2013 | <1.0 | <1.0 | <1.0 | <1.0 | 11.33 |
| | 12/17/2013 | <4.0 | <4.0 | <4.0 | <4.0 | 9.72 |



TABLE 1 (Continued)
GROUNDWATER ANALYTICAL AND FIELD RESULTS
HSR-DREYER 5-5
WELD COUNTY, COLORADO
KERR-MCGEE OIL & GAS ONSHORE LP

| Well Name | Date | Benzene (ug/L) | Toluene (ug/L) | Ethylbenzene (ug/L) | Xylenes (ug/L) | Depth Water/ (Product Thickness) (ft bgs) |
|------------------|-------------|-----------------------|-----------------------|----------------------------|-----------------------|--|
| MW09 | 04/27/2010 | 5100 | 20000 | 790 | 7200 | 9.80 |
| | 06/15/2010 | 3200 | 57000 | 450 | 5600 | 8.55 |
| | 09/16/2010 | 2800 | 34000 | 900 | 11000 | 8.49 |
| | 12/07/2010 | 2000 | 37000 | 740 | 8900 | 9.56 |
| | 03/15/2011 | 1300 | 49000 | 620 | 8700 | 11.01 |
| | 06/27/2011 | 740 | 52000 | 760 | 9200 | 10.92 |
| | 09/14/2011 | 540 | 40000 | 860 | 11000 | 9.15 |
| | 12/16/2011 | 15 | 25000 | 560 | 6400 | 9.55 |
| | 03/07/2012 | 150 | 35000 | 610 | 8700 | 10.49 |
| | 06/25/2012 | 49 | 16000 | 370 | 4600 | 10.72 |
| | 09/24/2012 | 34 | 20000 | 400 | 4800 | 10.94 |
| | 12/28/2012 | 5.6 | 4200 | 200 | 3300 | 12.39 |
| | 03/28/2013 | 120 | 7200 | <1.0 | 2900 | 13.49 |
| | 06/05/2013 | Product - Not Sampled | | | | 13.69 (1.05) |
| | 09/05/2013 | 170 | 17000 | 360 | 7700 | 11.32 |
| | 12/17/2013 | 17.2 | 8020 | 221 | 4290 | 9.72 |
| MW10 | 04/27/2010 | 11000 | 18000 | 1000 | 8700 | 10.03 |
| | 06/15/2010 | 27000 | 51000 | 360 | 4400 | 9.07 |
| | 09/16/2010 | 9600 | 35000 | 880 | 10000 | 8.95 |
| | 12/07/2010 | 10000 | 33000 | 700 | 9700 | 9.92 |
| | 03/15/2011 | 9300 | 48000 | 450 | 7000 | 11.42 |
| | 06/27/2011 | 12000 | 44000 | 710 | 11000 | 11.35 |
| | 09/14/2011 | 3200 | 18000 | 460 | 7200 | 9.65 |
| | 12/16/2011 | 3200 | 15000 | 1700 | 5400 | 10.00 |
| | 03/07/2012 | 2500 | 18000 | 370 | 5500 | 11.00 |
| | 06/25/2012 | 2700 | 17000 | 400 | 4900 | 11.11 |
| | 09/24/2012 | 2400 | 11000 | 270 | 3800 | 11.30 |
| | 12/28/2012 | Product - Not Sampled | | | | 14.00 (0.35) |
| | 03/28/2013 | Product - Not Sampled | | | | 14.90 (1.55) |
| | 06/05/2013 | Product - Not Sampled | | | | 14.60 (1.70) |
| | 09/05/2013 | 3100 | 17000 | 290 | 4800 | 12.42 (0.77) |
| | 12/17/2013 | Product - Not Sampled | | | | 10.29 (0.08) |



TABLE 1 (Continued)
GROUNDWATER ANALYTICAL AND FIELD RESULTS
HSR-DREYER 5-5
WELD COUNTY, COLORADO
KERR-MCGEE OIL & GAS ONSHORE LP

| Well Name | Date | Benzene (ug/L) | Toluene (ug/L) | Ethylbenzene (ug/L) | Xylenes (ug/L) | Depth Water/ (Product Thickness) (ft bgs) |
|-----------|------------|----------------------------------|----------------|---------------------|----------------|---|
| MW11 | 05/25/2010 | <1.0 | 1.2 | <1.0 | 2.8 | NM |
| | 06/15/2010 | <1.0 | <1.0 | <1.0 | <1.0 | 7.54 |
| | 09/16/2010 | <1.0 | <1.0 | <1.0 | <1.0 | 7.75 |
| | 12/07/2010 | <1.0 | <1.0 | <1.0 | <1.0 | 8.84 |
| | 03/15/2011 | <1.0 | <1.0 | <1.0 | <1.0 | 10.31 |
| | 06/27/2011 | <1.0 | <1.0 | <1.0 | <1.0 | 10.16 |
| | 09/14/2011 | <1.0 | <1.0 | <1.0 | <1.0 | 8.41 |
| | 12/16/2011 | <1.0 | <1.0 | <1.0 | <1.0 | 8.82 |
| | 03/07/2012 | <1.0 | <1.0 | <1.0 | <1.0 | 9.80 |
| | 06/25/2012 | <1.0 | <1.0 | <1.0 | <1.0 | 9.94 |
| | 09/24/2012 | <1.0 | <1.0 | <1.0 | <1.0 | 10.25 |
| | 12/28/2012 | 1.0 | 6.1 | <1.0 | 2.0 | 11.73 |
| | 06/05/2013 | Dry - Not Sampled | | | | Dry |
| | 09/05/2013 | <1.0 | 2.8 | <1.0 | 2.3 | 11.00 |
| | 12/17/2013 | <4.0 | <4.0 | <4.0 | <4.0 | 9.46 |
| MW12 | 05/25/2010 | <1.0 | 2000 | 250 | 4100 | NM |
| | 06/15/2010 | <1.0 | 810 | 120 | 1400 | 10.21 |
| | 09/16/2010 | <1.0 | 140 | 130 | 1400 | 10.20 |
| | 12/07/2010 | <1.0 | 56 | 130 | 370 | 11.25 |
| | 03/15/2011 | <1.0 | 340 | 290 | 650 | 12.68 |
| | 06/27/2011 | <1.0 | 530 | 250 | 3400 | 12.60 |
| | 09/14/2011 | <1.0 | 90 | 170 | 900 | 10.87 |
| | 12/16/2011 | <1.0 | 4.4 | 23 | 90 | 10.23 |
| | 03/07/2012 | <1.0 | 110 | 190 | 1500 | 12.20 |
| | 06/25/2012 | <1.0 | 51 | 110 | 840 | 12.20 |
| | 09/24/2012 | <1.0 | 46 | 130 | 1100 | 12.72 |
| | 12/28/2012 | Insufficient Water - Not Sampled | | | | 13.60 |
| | 03/28/2013 | Dry - Not Sampled | | | | Dry |
| | 06/05/2013 | Dry - Not Sampled | | | | Dry |
| | 09/05/2013 | <1.0 | 3.6 | 10 | 3300 | 13.08 |
| | 12/17/2013 | <4.0 | <4.0 | <4.0 | 1030 | 11.51 |



TABLE 1 (Continued)
GROUNDWATER ANALYTICAL AND FIELD RESULTS
HSR-DREYER 5-5
WELD COUNTY, COLORADO
KERR-MCGEE OIL & GAS ONSHORE LP

| Well Name | Date | Benzene (ug/L) | Toluene (ug/L) | Ethylbenzene (ug/L) | Xylenes (ug/L) | Depth Water/ (Product Thickness) (ft bgs) |
|------------------|-------------|----------------------------------|-----------------------|----------------------------|-----------------------|--|
| MW13 | 06/15/2010 | <1.0 | <1.0 | <1.0 | <1.0 | 6.66 |
| | 09/16/2010 | <1.0 | <1.0 | <1.0 | <1.0 | 6.92 |
| | 12/07/2010 | <1.0 | <1.0 | <1.0 | <1.0 | 8.10 |
| | 03/15/2011 | <1.0 | <1.0 | <1.0 | <1.0 | 9.54 |
| | 06/27/2011 | <1.0 | <1.0 | <1.0 | <1.0 | 9.39 |
| | 09/14/2011 | <1.0 | <1.0 | <1.0 | <1.0 | 7.66 |
| | 12/16/2011 | <1.0 | <1.0 | <1.0 | <1.0 | 7.78 |
| | 03/07/2012 | <1.0 | <1.0 | <1.0 | <1.0 | 9.10 |
| | 06/25/2012 | <1.0 | <1.0 | <1.0 | <1.0 | 8.48 |
| | 09/24/2012 | <1.0 | <1.0 | <1.0 | <1.0 | 9.60 |
| | 12/28/2012 | <1.0 | <1.0 | <1.0 | <1.0 | 11.00 |
| | 03/28/2013 | Insufficient Water - Not Sampled | | | | 12.02 |
| | 06/05/2013 | Insufficient Water - Not Sampled | | | | PVC Blocked |
| | 09/05/2013 | <1.0 | <1.0 | <1.0 | <1.0 | 8.80 |
| | 12/17/2013 | <4.0 | <4.0 | <4.0 | <4.0 | 8.34 |
| MW14 | 06/15/2010 | <1.0 | <1.0 | <1.0 | <1.0 | 10.59 |
| | 09/16/2010 | <1.0 | <1.0 | <1.0 | <1.0 | 10.52 |
| | 12/07/2010 | <1.0 | <1.0 | <1.0 | <1.0 | 11.61 |
| | 03/15/2011 | <1.0 | <1.0 | <1.0 | <1.0 | 13.07 |
| | 06/27/2011 | <1.0 | <1.0 | <1.0 | <1.0 | 12.94 |
| | 09/14/2011 | <1.0 | <1.0 | <1.0 | 2.3 | 11.28 |
| | 12/16/2011 | <1.0 | <1.0 | <1.0 | <1.0 | 11.30 |
| | 03/07/2012 | <1.0 | <1.0 | <1.0 | <1.0 | 12.70 |
| | 06/25/2012 | <1.0 | <1.0 | <1.0 | <1.0 | 12.61 |
| | 09/24/2012 | <1.0 | <1.0 | <1.0 | <1.0 | 13.18 |
| | 12/28/2012 | <1.0 | 1.0 | <1.0 | <1.0 | 14.50 |
| | 03/28/2013 | <1.0 | <1.0 | <1.0 | <1.0 | 15.55 |
| | 06/05/2013 | <1.0 | <1.0 | <1.0 | <1.0 | 14.90 |
| | 09/05/2013 | <1.0 | <1.0 | <1.0 | <1.0 | 13.42 |
| | 12/17/2013 | <4.0 | <4.0 | <4.0 | <4.0 | 11.89 |



TABLE 1 (Continued)
GROUNDWATER ANALYTICAL AND FIELD RESULTS
HSR-DREYER 5-5
WELD COUNTY, COLORADO
KERR-MCGEE OIL & GAS ONSHORE LP

| Well Name | Date | Benzene (ug/L) | Toluene (ug/L) | Ethylbenzene (ug/L) | Xylenes (ug/L) | Depth Water/ (Product Thickness) (ft bgs) |
|-------------------------------|------------|-----------------------|----------------|---------------------|----------------|---|
| MW15 | 06/29/2010 | 4.6 | 50 | 130 | 1400 | 8.76 |
| | 09/16/2010 | <1.0 | 1.3 | 16 | 230 | 8.78 |
| | 12/07/2010 | <1.0 | <1.0 | 16 | 210 | 9.86 |
| | 03/15/2011 | <1.0 | <1.0 | 17 | 280 | 11.18 |
| | 06/27/2011 | <1.0 | <1.0 | 8.9 | 39 | 11.15 |
| | 09/14/2011 | <1.0 | <1.0 | 5.9 | 3.1 | 9.37 |
| | 12/16/2011 | <1.0 | <1.0 | 6.0 | 2.6 | 9.83 |
| | 03/07/2012 | <1.0 | <1.0 | <1.0 | <1.0 | 10.83 |
| | 06/25/2012 | <1.0 | <1.0 | <1.0 | <1.0 | 11.69 |
| | 09/24/2012 | <1.0 | <1.0 | <1.0 | <1.0 | 12.85 |
| | 12/28/2012 | 1.1 | 2.8 | <1.0 | <1.0 | 12.87 |
| | 03/28/2013 | <1.0 | <1.0 | <1.0 | <1.0 | 13.78 |
| | 06/05/2013 | <1.0 | <1.0 | 2.8 | 4.2 | 13.18 |
| | 09/05/2013 | <1.0 | 2.1 | 2.2 | 7.5 | 11.63 |
| | 12/17/2013 | <4.0 | <4.0 | <4.0 | <4.0 | 10.01 |
| MW16 | 06/29/2010 | 48000 | 68000 | 410 | 4800 | 9.61 |
| | 09/16/2010 | 13000 | 16000 | 660 | 6400 | 9.33 |
| | 12/07/2010 | 9200 | 15000 | 440 | 6400 | 10.32 |
| | 03/15/2011 | 20000 | 18000 | 170 | 8000 | 11.77 |
| | 06/27/2011 | 26000 | 39000 | 680 | 17000 | 11.78 |
| | 09/14/2011 | 7900 | 12000 | 360 | 6500 | 9.97 |
| | 12/16/2011 | 6700 | 6500 | 1700 | 5100 | 10.43 |
| | 03/07/2012 | 7500 | 7700 | 150 | 5000 | 11.33 |
| | 06/25/2012 | 20000 | 21000 | 240 | 3300 | 11.38 |
| | 09/24/2012 | 4300 | 6800 | 170 | 5500 | 11.55 |
| | 12/28/2012 | Product - Not Sampled | | | | 13.96 (1.43) |
| | 03/28/2013 | Damaged - Not Sampled | | | | Damaged |
| | 06/05/2013 | Damaged - Not Sampled | | | | Damaged |
| MW16 destroyed as of 9/5/2013 | | | | | | |



TABLE 1 (Continued)
GROUNDWATER ANALYTICAL AND FIELD RESULTS
HSR-DREYER 5-5
WELD COUNTY, COLORADO
KERR-MCGEE OIL & GAS ONSHORE LP

| Well Name | Date | Benzene (ug/L) | Toluene (ug/L) | Ethylbenzene (ug/L) | Xylenes (ug/L) | Depth Water/ (Product Thickness) (ft bgs) |
|-----------|------------|-----------------------|----------------|---------------------|----------------|---|
| MW17 | 09/16/2010 | <1.0 | <1.0 | 1.2 | 4.4 | 8.37 |
| | 12/07/2010 | <1.0 | 1.8 | <1.0 | <1.0 | 9.37 |
| | 03/15/2011 | <1.0 | <1.0 | <1.0 | <1.0 | 10.86 |
| | 06/27/2011 | 1.3 | 7.4 | <1.0 | <1.0 | 10.84 |
| | 09/14/2011 | <1.0 | 4.1 | <1.0 | 2.8 | 8.87 |
| | 12/16/2011 | <1.0 | <1.0 | <1.0 | <1.0 | 9.31 |
| | 03/07/2012 | <1.0 | <1.0 | <1.0 | <1.0 | 10.39 |
| | 06/25/2012 | 1.1 | 1.9 | <1.0 | <1.0 | 10.74 |
| | 09/24/2012 | <1.0 | <1.0 | <1.0 | <1.0 | 10.49 |
| | 12/28/2012 | <1.0 | <1.0 | <1.0 | <1.0 | 12.26 |
| | 03/28/2013 | <1.0 | <1.0 | <1.0 | <1.0 | 13.29 |
| | 06/05/2013 | <1.0 | <1.0 | <1.0 | <1.0 | 12.81 |
| | 09/05/2013 | <1.0 | <1.0 | <1.0 | <1.0 | 11.29 |
| | 12/17/2013 | <4.0 | <4.0 | <4.0 | <4.0 | 9.57 |
| MW18 | 09/16/2010 | 75 | <1.0 | 10 | 37 | 9.25 |
| | 12/07/2010 | <1.0 | <1.0 | <1.0 | <1.0 | 10.34 |
| | 03/15/2011 | 2.4 | <1.0 | <1.0 | <1.0 | 10.86 |
| | 06/27/2011 | 23 | <1.0 | <1.0 | <1.0 | 11.85 |
| | 09/14/2011 | 3.8 | <1.0 | <1.0 | 3.1 | 9.83 |
| | 12/16/2011 | 6.8 | <1.0 | 16 | 4.9 | 10.30 |
| | 03/07/2012 | <1.0 | <1.0 | <1.0 | <1.0 | 11.50 |
| | 06/25/2012 | <1.0 | <1.0 | <1.0 | <1.0 | 11.60 |
| | 09/24/2012 | <1.0 | <1.0 | <1.0 | <1.0 | 11.53 |
| | 12/28/2012 | 1.1 | 2.5 | <1.0 | <1.0 | 13.10 |
| | 03/28/2013 | <1.0 | <1.0 | <1.0 | <1.0 | 14.10 |
| | 06/05/2013 | Dry - Not Sampled | | | | Dry |
| | 09/05/2013 | <1.0 | <1.0 | <1.0 | <1.0 | 12.16 |
| | 12/17/2013 | <4.0 | <4.0 | <4.0 | <4.0 | 10.60 |
| MW19 | 09/16/2010 | 2100 | 2900 | 390 | 3900 | 10.85 |
| | 12/07/2010 | 5000 | 5600 | 270 | 2500 | 11.78 |
| | 03/15/2011 | 7300 | 15000 | 380 | 4400 | 13.33 |
| | 06/27/2011 | Product - Not Sampled | | | | 13.46 (0.60) |
| | 09/14/2011 | 8600 | 25000 | 860 | 14000 | 11.35 |
| | 12/16/2011 | 2900 | 13000 | 560 | 7000 | 11.72 |
| | 03/07/2012 | 4200 | 30000 | 1700 | 44000 | 12.75 |
| | 06/25/2012 | 3800 | 9000 | 430 | 12000 | 12.55 |
| | 09/24/2012 | 1300 | 4200 | 170 | 8000 | 12.90 |
| | 12/28/2012 | Product - Not Sampled | | | | 14.85 (0.70) |
| | 03/28/2013 | Dry - Not Sampled | | | | Dry |
| | 06/05/2013 | Dry - Not Sampled | | | | Dry |
| | 09/05/2013 | 22000 | 32000 | 960 | 14000 | 13.42 (0.03) |
| | 12/17/2013 | Product - Not Sampled | | | | 12.61 (0.01) |



TABLE 1 (Continued)
GROUNDWATER ANALYTICAL AND FIELD RESULTS
HSR-DREYER 5-5
WELD COUNTY, COLORADO
KERR-MCGEE OIL & GAS ONSHORE LP

| Well Name | Date | Benzene (ug/L) | Toluene (ug/L) | Ethylbenzene (ug/L) | Xylenes (ug/L) | Depth Water/ (Product Thickness) (ft bgs) |
|-----------|---------------------------------|----------------------------------|----------------|---------------------|----------------|---|
| MW20 | 09/16/2010 | 16000 | 13000 | 200 | 4800 | 11.32 |
| | 12/07/2010 | 35000 | 32000 | 400 | 5200 | 11.25 |
| | 03/15/2011 | 46000 | 42000 | 250 | 4500 | 12.75 |
| | 06/27/2011 | 29000 | 32000 | 280 | 4300 | 12.88 |
| | 09/14/2011 | 21000 | 22000 | 320 | 5500 | 11.30 |
| | 12/16/2011 | 28000 | 27000 | 350 | 4600 | 11.29 |
| | 03/07/2012 | 21000 | 26000 | 580 | 16000 | 12.42 |
| | 06/25/2012 | 22000 | 22000 | 280 | 3800 | 12.48 |
| | 09/24/2012 | 24000 | 22000 | 220 | 3400 | 13.57 |
| | 12/28/2012 | 22000 | 19000 | 250 | 3400 | 14.22 |
| | 03/28/2013 | Insufficient Water - Not Sampled | | | | PVC Blocked |
| | 06/05/2013 | Insufficient Water - Not Sampled | | | | PVC Blocked |
| | 09/05/2013 | 2000 | 2700 | 13 | 210 | PVC Blocked |
| | MW20 destroyed as of 12/17/2013 | | | | | |
| MW21 | 09/16/2010 | <1.0 | <1.0 | <1.0 | <1.0 | 10.75 |
| | 12/07/2010 | <1.0 | <1.0 | <1.0 | <1.0 | 11.52 |
| | 03/15/2011 | <1.0 | <1.0 | <1.0 | <1.0 | 12.98 |
| | 06/27/2011 | <1.0 | <1.0 | <1.0 | <1.0 | 13.00 |
| | 09/14/2011 | <1.0 | 2.8 | <1.0 | <1.0 | 11.41 |
| | 12/16/2011 | 2.6 | 4.7 | <1.0 | <1.0 | 11.51 |
| | 03/07/2012 | 1.3 | 4.0 | <1.0 | 14 | 12.60 |
| | 06/25/2012 | Dry - Not Sampled | | | | Dry |
| | 09/24/2012 | <1.0 | <1.0 | <1.0 | <1.0 | 12.90 |
| | 12/28/2012 | Dry - Not Sampled | | | | Dry |
| | 03/28/2013 | Dry - Not Sampled | | | | Dry |
| | 06/05/2013 | Dry - Not Sampled | | | | Dry |
| | 09/05/2013 | Dry - Not Sampled | | | | Dry |
| | 12/17/2013 | <4.0 | <4.0 | <4.0 | <4.0 | 11.95 |
| MW22 | 09/16/2010 | 110 | <1.0 | <1.0 | <1.0 | 11.40 |
| | 12/07/2010 | 20 | 1.4 | <1.0 | <1.0 | 12.33 |
| | 03/15/2011 | 3.2 | <1.0 | <1.0 | <1.0 | 13.88 |
| | 06/27/2011 | 2.6 | 19 | 1.1 | 11 | 13.95 |
| | 09/14/2011 | 150 | 2.9 | <1.0 | 1.5 | 12.06 |
| | 12/16/2011 | 130 | 2.3 | <1.0 | 2.7 | 12.12 |
| | 03/07/2012 | <1.0 | 2.0 | <1.0 | 7.7 | 13.40 |
| | 06/25/2012 | 1.4 | 2.2 | <1.0 | <1.0 | 12.76 |
| | 09/24/2012 | <1.0 | <1.0 | <1.0 | <1.0 | 13.48 |
| | 12/28/2012 | Dry - Not Sampled | | | | Dry |
| | 03/28/2013 | Dry - Not Sampled | | | | Dry |
| | 06/05/2013 | Dry - Not Sampled | | | | Dry |
| | 09/05/2013 | <1.0 | 1.4 | <1.0 | 1.0 | 14.31 |
| | 12/17/2013 | <4.0 | <4.0 | <4.0 | <4.0 | 12.73 |



TABLE 1 (Continued)
GROUNDWATER ANALYTICAL AND FIELD RESULTS
HSR-DREYER 5-5
WELD COUNTY, COLORADO
KERR-MCGEE OIL & GAS ONSHORE LP

| Well Name | Date | Benzene (ug/L) | Toluene (ug/L) | Ethylbenzene (ug/L) | Xylenes (ug/L) | Depth Water/ (Product Thickness) (ft bgs) |
|-----------|------------|----------------------------------|----------------|---------------------|----------------|---|
| MW23 | 10/15/2010 | <1.0 | <1.0 | <1.0 | <1.0 | 8.80 |
| | 12/07/2010 | <1.0 | <1.0 | <1.0 | <1.0 | 9.62 |
| | 03/15/2011 | <1.0 | <1.0 | <1.0 | <1.0 | 11.15 |
| | 06/27/2011 | <1.0 | <1.0 | <1.0 | <1.0 | 11.10 |
| | 09/14/2011 | <1.0 | 1.9 | <1.0 | <1.0 | 9.00 |
| | 12/16/2011 | <1.0 | <1.0 | <1.0 | <1.0 | 9.60 |
| | 03/07/2012 | <1.0 | <1.0 | <1.0 | <1.0 | 10.75 |
| | 06/25/2012 | 9.7 | <1.0 | <1.0 | <1.0 | 10.85 |
| | 09/24/2012 | <1.0 | <1.0 | <1.0 | <1.0 | 10.70 |
| | 12/28/2012 | 4.5 | 28 | 1.0 | 12 | 12.45 |
| | 03/28/2013 | <1.0 | <1.0 | <1.0 | <1.0 | 13.55 |
| | 06/05/2013 | <1.0 | <1.0 | <1.0 | <1.0 | 13.04 |
| | 09/05/2013 | <1.0 | <1.0 | <1.0 | <1.0 | 11.36 |
| | 12/17/2013 | <4.0 | <4.0 | <4.0 | <4.0 | 9.81 |
| MW24 | 10/15/2010 | 2000 | <1.0 | <1.0 | 5.6 | 11.28 |
| | 12/07/2010 | 3200 | <1.0 | <1.0 | 2.8 | 12.11 |
| | 03/15/2011 | Insufficient Water - Not Sampled | | | | 13.61 |
| | 06/27/2011 | 48 | 230 | 19 | 240 | 13.68 |
| | 09/14/2011 | 5500 | 1.7 | <1.0 | 1.5 | 11.57 |
| | 12/16/2011 | 1600 | <1.0 | <1.0 | <1.0 | 12.09 |
| | 03/07/2012 | <1.0 | <1.0 | <1.0 | <1.0 | 13.17 |
| | 06/25/2012 | <1.0 | <1.0 | <1.0 | <1.0 | 13.09 |
| | 09/24/2012 | <1.0 | <1.0 | <1.0 | <1.0 | 13.27 |
| | 12/28/2012 | Dry - Not Sampled | | | | Dry |
| | 03/28/2013 | Dry - Not Sampled | | | | Dry |
| | 06/05/2013 | Dry - Not Sampled | | | | Dry |
| | 09/05/2013 | 230 | 37 | <1.0 | 5.3 | 13.98 |
| | 12/17/2013 | <4.0 | <4.0 | <4.0 | <4.0 | 12.47 |
| MW25 | 10/15/2010 | <1.0 | <1.0 | <1.0 | <1.0 | 11.69 |
| | 12/07/2010 | <1.0 | <1.0 | <1.0 | <1.0 | 12.52 |
| | 03/15/2011 | <1.0 | <1.0 | <1.0 | <1.0 | 13.98 |
| | 06/27/2011 | <1.0 | <1.0 | <1.0 | <1.0 | 14.14 |
| | 09/14/2011 | <1.0 | <1.0 | <1.0 | <1.0 | 12.19 |
| | 12/16/2011 | <1.0 | <1.0 | <1.0 | <1.0 | 10.57 |
| | 03/07/2012 | <1.0 | <1.0 | <1.0 | <1.0 | 13.58 |
| | 06/25/2012 | <1.0 | <1.0 | <1.0 | <1.0 | 13.48 |
| | 09/24/2012 | <1.0 | <1.0 | <1.0 | <1.0 | 13.48 |
| | 12/28/2012 | Dry - Not Sampled | | | | Dry |
| | 03/28/2013 | Dry - Not Sampled | | | | Dry |
| | 06/05/2013 | Dry - Not Sampled | | | | Dry |
| | 12/17/2013 | <4.0 | <4.0 | <4.0 | <4.0 | 12.91 |



TABLE 1 (Continued)
GROUNDWATER ANALYTICAL AND FIELD RESULTS
HSR-DREYER 5-5
WELD COUNTY, COLORADO
KERR-MCGEE OIL & GAS ONSHORE LP

| Well Name | Date | Benzene (ug/L) | Toluene (ug/L) | Ethylbenzene (ug/L) | Xylenes (ug/L) | Depth Water/ (Product Thickness) (ft bgs) |
|------------------|-------------|----------------------------------|-----------------------|----------------------------|-----------------------|--|
| MW26 | 10/15/2010 | <1.0 | <1.0 | <1.0 | <1.0 | 12.27 |
| | 12/07/2010 | <1.0 | <1.0 | <1.0 | <1.0 | 12.89 |
| | 03/15/2011 | Insufficient Water - Not Sampled | | | | 14.21 |
| | 06/27/2011 | Insufficient Water - Not Sampled | | | | 14.35 |
| | 09/14/2011 | <1.0 | <1.0 | <1.0 | <1.0 | 12.88 |
| | 12/16/2011 | <1.0 | <1.0 | <1.0 | <1.0 | 10.92 |
| | 03/07/2012 | Insufficient Water - Not Sampled | | | | 14.02 |
| | 06/25/2012 | Dry - Not Sampled | | | | Dry |
| | 09/24/2012 | <1.0 | <1.0 | <1.0 | <1.0 | 14.07 |
| | 12/28/2012 | Dry - Not Sampled | | | | Dry |
| | 03/28/2013 | Dry - Not Sampled | | | | Dry |
| | 06/05/2013 | Dry - Not Sampled | | | | Dry |
| | 09/05/2013 | Dry - Not Sampled | | | | Dry |
| | 12/17/2013 | <4.0 | <4.0 | <4.0 | <4.0 | 13.47 |
| MW27 | 12/07/2010 | <1.0 | 1.6 | <1.0 | <1.0 | 12.88 |
| | 03/15/2011 | Insufficient Water - Not Sampled | | | | 13.83 |
| | 06/27/2011 | Insufficient Water - Not Sampled | | | | 13.86 |
| | 09/14/2011 | <1.0 | <1.0 | <1.0 | <1.0 | 11.87 |
| | 12/16/2011 | <1.0 | <1.0 | <1.0 | <1.0 | 11.09 |
| | 03/07/2012 | <1.0 | <1.0 | <1.0 | <1.0 | 13.41 |
| | 06/25/2012 | Dry - Not Sampled | | | | Dry |
| | 09/24/2012 | <1.0 | <1.0 | <1.0 | <1.0 | 14.01 |
| | 12/28/2012 | Dry - Not Sampled | | | | Dry |
| | 03/28/2013 | Dry - Not Sampled | | | | Dry |
| | 06/05/2013 | Dry - Not Sampled | | | | Dry |
| | 09/05/2013 | Dry - Not Sampled | | | | Dry |
| | 12/17/2013 | <4.0 | <4.0 | <4.0 | <4.0 | 12.73 |
| MW28 | 12/07/2010 | <1.0 | <1.0 | <1.0 | <1.0 | 11.75 |
| | 03/15/2011 | <1.0 | <1.0 | <1.0 | <1.0 | 12.10 |
| | 06/27/2011 | <1.0 | <1.0 | <1.0 | <1.0 | 12.14 |
| | 09/14/2011 | <1.0 | <1.0 | <1.0 | <1.0 | 9.98 |
| | 12/16/2011 | 1.2 | <1.0 | <1.0 | <1.0 | 10.66 |
| | 03/07/2012 | Insufficient Water - Not Sampled | | | | 11.76 |
| | 06/25/2012 | 1.1 | <1.0 | <1.0 | <1.0 | 11.72 |
| | 09/24/2012 | <1.0 | <1.0 | <1.0 | <1.0 | 11.70 |
| | 12/28/2012 | Dry - Not Sampled | | | | Dry |
| | 03/28/2013 | Dry - Not Sampled | | | | Dry |
| | 06/05/2013 | Dry - Not Sampled | | | | Dry |
| | 09/05/2013 | Dry - Not Sampled | | | | Dry |
| | 12/17/2013 | <4.0 | <4.0 | <4.0 | <4.0 | 10.58 |



TABLE 1 (Continued)
GROUNDWATER ANALYTICAL AND FIELD RESULTS
HSR-DREYER 5-5
WELD COUNTY, COLORADO
KERR-MCGEE OIL & GAS ONSHORE LP

| Well Name | Date | Benzene (ug/L) | Toluene (ug/L) | Ethylbenzene (ug/L) | Xylenes (ug/L) | Depth Water/ (Product Thickness) (ft bgs) |
|---------------------------|------|----------------|----------------|---------------------|----------------|---|
| Colo GW Quality Standards | | 5 | 1000 | 700 | 1400 | |

Notes: NM - Not Measured

ug/L - micrograms per Liter

NA - Not Analyzed/Not Available

GW - Groundwater

ft bgs - feet below ground surface

< - less than laboratory reporting limit

Bold numbers indicate result equaled or exceeded standard.

