

Wellstar Corporation  
Silver Spur Minerals 35-2H  
Jackson County, CO

Geodetic System: US State Plane 1983  
Zone: Colorado Northern Zone

WELL @ 8549.0usft (Evergreen @ 21 (15' KB))

Ground Level: 8533.0

Latitude: 40° 37' 5.550 N

Longitude: 106° 6' 23.610 W

Magnetic North is 9.43° East of True North (Magnetic Declination)



Azimuths to True North  
Magnetic North: 9.43°

Magnetic Field  
Strength: 52944.9snT  
Dip Angle: 66.96°  
Date: 8/9/2012  
Model: IGRF2010

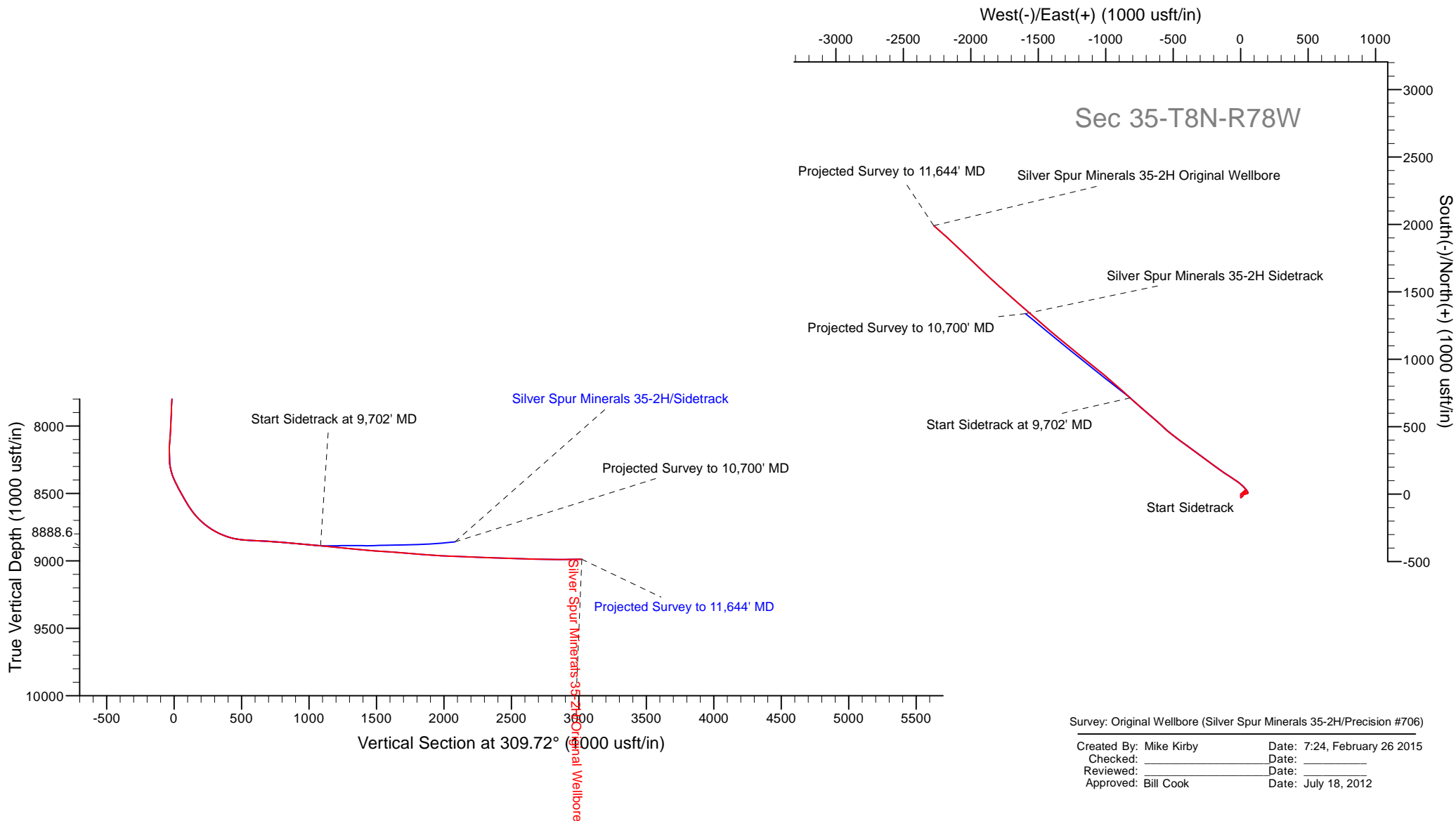

# **Wellstar Corporation**

**Jackson County, CO**

**Sec 35-T8N-R78W**

**Silver Spur Minerals 35-2H**

**Precision #706**

**Survey: Original Wellbore**

## **Standard Survey Report**

**26 February, 2015**

## Survey Report

<b>Company:</b>	Wellstar Corporation	<b>Local Co-ordinate Reference:</b>	Site Sec 35-T8N-R78W
<b>Project:</b>	Jackson County, CO	<b>TVD Reference:</b>	WELL @ 8549.0usft (Evergreen @ 21 (15' KB))
<b>Site:</b>	Sec 35-T8N-R78W	<b>MD Reference:</b>	WELL @ 8549.0usft (Evergreen @ 21 (15' KB))
<b>Well:</b>	Silver Spur Minerals 35-2H	<b>North Reference:</b>	True
<b>Wellbore:</b>	Precision #706	<b>Survey Calculation Method:</b>	Minimum Curvature
<b>Design:</b>	Wellbore #1	<b>Database:</b>	Rocky Mountain R5000 Database

<b>Project</b>	Jackson County, CO		
<b>Map System:</b>	US State Plane 1983	<b>System Datum:</b>	Mean Sea Level
<b>Geo Datum:</b>	North American Datum 1983		
<b>Map Zone:</b>	Colorado Northern Zone		

Site	Sec 35-T8N-R78W				
Site Position:		Northing:	1,468,631.01 usft	Latitude:	40° 37' 5.550 N
From:	Lat/Long	Easting:	2,831,612.30 usft	Longitude:	106° 6' 23.610 W
Position Uncertainty:	0.0 usft	Slot Radius:	13-3/16 "	Grid Convergence:	-0.39 °

Well	Silver Spur Minerals 35-2H					
Well Position	+N/-S	0.0 usft	Northing:	1,468,631.01 usft	Latitude:	40° 37' 5.550 N
	+E/-W	0.0 usft	Easting:	2,831,612.30 usft	Longitude:	106° 6' 23.610 W
Position Uncertainty		0.0 usft	Wellhead Elevation:	8,556.0 usft	Ground Level:	8,533.0 usft

<b>Wellbore</b>	Precision #706				
<b>Magnetics</b>	<b>Model Name</b>	<b>Sample Date</b>	<b>Declination (°)</b>	<b>Dip Angle (°)</b>	<b>Field Strength (nT)</b>
	IGRF2010	8/9/2012	9.43	66.96	52,945

<b>Design</b>	Wellbore #1				
<b>Audit Notes:</b>					
<b>Version:</b>	1.0	<b>Phase:</b>	ACTUAL	<b>Tie On Depth:</b>	0.0
<b>Vertical Section:</b>	<b>Depth From (TVD) (usft)</b>	<b>+N/-S (usft)</b>	<b>+E/-W (usft)</b>	<b>Direction (°)</b>	
	0.0	0.0	0.0	309.72	

<b>Survey Program</b>	<b>Date</b>	2/24/2015			
<b>From (usft)</b>	<b>To (usft)</b>	<b>Survey (Wellbore)</b>	<b>Tool Name</b>	<b>Description</b>	
185.0	8,164.0	Final Survey Report 11/17/2010 (Precision	MWD		
8,279.0	11,644.0	Original Well Surveys (Precision #706)	MWD		

<b>Survey</b>										
<b>Measured Depth (usft)</b>	<b>Inclination (°)</b>	<b>Azimuth (°)</b>	<b>Vertical Depth (usft)</b>	<b>+N/-S (usft)</b>	<b>+E/-W (usft)</b>	<b>Vertical Section (usft)</b>	<b>Dogleg Rate (°/100usft)</b>	<b>Build Rate (°/100usft)</b>	<b>Turn Rate (°/100usft)</b>	
0.0	0.00	0.00	0.0	0.0	0.0	0.0	0.00	0.00	0.00	
185.0	0.50	49.80	185.0	0.5	0.6	-0.1	0.27	0.27	0.00	
404.0	1.00	49.80	404.0	2.4	2.8	-0.6	0.23	0.23	0.00	
660.0	2.50	49.80	659.9	7.4	8.8	-2.0	0.59	0.59	0.00	
714.0	1.75	49.80	713.8	8.7	10.3	-2.4	1.39	-1.39	0.00	
1,014.0	5.10	49.80	1,013.2	20.3	24.0	-5.5	1.12	1.12	0.00	
1,077.0	4.40	50.50	1,076.0	23.6	28.0	-6.4	1.11	-1.11	1.11	
1,139.0	3.70	48.30	1,137.9	26.5	31.3	-7.2	1.16	-1.13	-3.55	
1,201.0	3.40	42.00	1,199.7	29.2	34.0	-7.6	0.79	-0.48	-10.16	
1,263.0	3.00	51.60	1,261.6	31.5	36.6	-8.0	1.08	-0.65	15.48	

# Survey Report

<b>Company:</b>	Wellstar Corporation	<b>Local Co-ordinate Reference:</b>	Site Sec 35-T8N-R78W
<b>Project:</b>	Jackson County, CO	<b>TVD Reference:</b>	WELL @ 8549.0usft (Evergreen @ 21 (15' KB))
<b>Site:</b>	Sec 35-T8N-R78W	<b>MD Reference:</b>	WELL @ 8549.0usft (Evergreen @ 21 (15' KB))
<b>Well:</b>	Silver Spur Minerals 35-2H	<b>North Reference:</b>	True
<b>Wellbore:</b>	Precision #706	<b>Survey Calculation Method:</b>	Minimum Curvature
<b>Design:</b>	Wellbore #1	<b>Database:</b>	Rocky Mountain R5000 Database

Survey									
Measured Depth (usft)	Inclination (°)	Azimuth (°)	Vertical Depth (usft)	+N/-S (usft)	+E/-W (usft)	Vertical Section (usft)	Dogleg Rate (°/100usft)	Build Rate (°/100usft)	Turn Rate (°/100usft)
1,325.0	2.40	57.40	1,323.6	33.2	38.9	-8.7	1.06	-0.97	9.35
1,385.0	1.60	62.70	1,383.5	34.3	40.7	-9.4	1.37	-1.33	8.83
1,447.0	0.60	80.90	1,445.5	34.8	41.8	-10.0	1.69	-1.61	29.35
1,508.0	0.50	178.20	1,506.5	34.5	42.1	-10.3	1.36	-0.16	159.51
1,570.0	0.90	205.70	1,568.5	33.8	41.9	-10.6	0.83	0.65	44.35
1,632.0	1.20	204.10	1,630.5	32.8	41.5	-10.9	0.49	0.48	-2.58
1,694.0	1.70	207.70	1,692.5	31.4	40.8	-11.3	0.82	0.81	5.81
1,757.0	2.20	206.80	1,755.5	29.5	39.8	-11.8	0.80	0.79	-1.43
1,818.0	2.30	201.70	1,816.4	27.3	38.8	-12.4	0.37	0.16	-8.36
1,880.0	2.10	196.40	1,878.4	25.1	38.0	-13.2	0.46	-0.32	-8.55
1,943.0	2.00	192.00	1,941.3	22.9	37.5	-14.2	0.30	-0.16	-6.98
2,006.0	2.10	198.60	2,004.3	20.7	36.9	-15.1	0.41	0.16	10.48
2,066.0	2.20	220.40	2,064.2	18.8	35.8	-15.5	1.36	0.17	36.33
2,191.0	2.00	226.00	2,189.2	15.4	32.6	-15.2	0.23	-0.16	4.48
2,285.0	1.60	223.20	2,283.1	13.3	30.6	-15.0	0.44	-0.43	-2.98
2,348.0	1.80	223.00	2,346.1	12.0	29.3	-14.9	0.32	0.32	-0.32
2,410.0	2.30	223.00	2,408.0	10.4	27.8	-14.7	0.81	0.81	0.00
2,471.0	2.50	220.40	2,469.0	8.5	26.1	-14.7	0.37	0.33	-4.26
2,532.0	2.40	218.50	2,529.9	6.4	24.4	-14.7	0.21	-0.16	-3.11
2,595.0	2.20	216.20	2,592.9	4.4	22.9	-14.8	0.35	-0.32	-3.65
2,657.0	1.80	204.80	2,654.8	2.6	21.8	-15.1	0.91	-0.65	-18.39
2,719.0	1.80	209.80	2,716.8	0.9	20.9	-15.5	0.25	0.00	8.06
2,782.0	2.00	205.80	2,779.8	-1.0	19.9	-16.0	0.38	0.32	-6.35
2,844.0	1.70	193.50	2,841.7	-2.9	19.2	-16.6	0.80	-0.48	-19.84
2,907.0	1.80	181.80	2,904.7	-4.8	19.0	-17.6	0.59	0.16	-18.57
2,969.0	1.90	187.70	2,966.7	-6.7	18.8	-18.8	0.35	0.16	9.52
3,032.0	2.20	195.70	3,029.6	-8.9	18.3	-19.8	0.66	0.48	12.70
3,094.0	2.50	202.20	3,091.6	-11.3	17.5	-20.7	0.65	0.48	10.48
3,156.0	2.90	221.60	3,153.5	-13.8	16.0	-21.1	1.60	0.65	31.29
3,219.0	3.00	222.10	3,216.4	-16.2	13.8	-21.0	0.16	0.16	0.79
3,281.0	2.60	230.20	3,278.4	-18.3	11.6	-20.6	0.91	-0.65	13.06
3,344.0	2.30	244.10	3,341.3	-19.8	9.4	-19.9	1.05	-0.48	22.06
3,405.0	1.90	238.30	3,402.3	-20.8	7.4	-19.0	0.74	-0.66	-9.51
3,466.0	1.50	231.10	3,463.2	-21.9	6.0	-18.5	0.74	-0.66	-11.80
3,529.0	1.00	230.50	3,526.2	-22.7	4.9	-18.3	0.79	-0.79	-0.95
3,591.0	1.00	207.20	3,588.2	-23.5	4.2	-18.3	0.65	0.00	-37.58
3,623.0	0.80	188.30	3,620.2	-24.0	4.1	-18.5	1.11	-0.63	-59.06
3,684.0	1.00	190.60	3,681.2	-25.0	3.9	-19.0	0.33	0.33	3.77
3,746.0	1.10	227.40	3,743.2	-25.9	3.4	-19.1	1.08	0.16	59.35
3,809.0	1.10	246.90	3,806.2	-26.5	2.4	-18.8	0.59	0.00	30.95
3,902.0	0.70	274.30	3,899.2	-26.9	1.0	-17.9	0.62	-0.43	29.46
3,963.0	0.20	53.80	3,960.2	-26.8	0.7	-17.6	1.41	-0.82	228.69
4,026.0	0.70	34.10	4,023.2	-26.4	1.0	-17.6	0.82	0.79	-31.27

# Survey Report

<b>Company:</b>	Wellstar Corporation	<b>Local Co-ordinate Reference:</b>	Site Sec 35-T8N-R78W
<b>Project:</b>	Jackson County, CO	<b>TVD Reference:</b>	WELL @ 8549.0usft (Evergreen @ 21 (15' KB))
<b>Site:</b>	Sec 35-T8N-R78W	<b>MD Reference:</b>	WELL @ 8549.0usft (Evergreen @ 21 (15' KB))
<b>Well:</b>	Silver Spur Minerals 35-2H	<b>North Reference:</b>	True
<b>Wellbore:</b>	Precision #706	<b>Survey Calculation Method:</b>	Minimum Curvature
<b>Design:</b>	Wellbore #1	<b>Database:</b>	Rocky Mountain R5000 Database

Survey										
Measured Depth (usft)	Inclination (°)	Azimuth (°)	Vertical Depth (usft)	+N/-S (usft)	+E/-W (usft)	Vertical Section (usft)	Dogleg Rate (°/100usft)	Build Rate (°/100usft)	Turn Rate (°/100usft)	
4,088.0	0.70	350.70	4,085.2	-25.7	1.1	-17.3	0.83	0.00	-70.00	
4,151.0	0.70	2.60	4,148.2	-24.9	1.1	-16.8	0.23	0.00	18.89	
4,181.0	0.60	19.30	4,178.2	-24.6	1.2	-16.6	0.71	-0.33	55.67	
4,213.0	0.90	13.80	4,210.2	-24.2	1.3	-16.4	0.96	0.94	-17.19	
4,243.0	1.00	8.00	4,240.2	-23.7	1.4	-16.2	0.46	0.33	-19.33	
4,275.0	1.40	7.30	4,272.1	-23.0	1.5	-15.8	1.25	1.25	-2.19	
4,305.0	1.60	13.40	4,302.1	-22.3	1.6	-15.5	0.85	0.67	20.33	
4,367.0	1.90	1.50	4,364.1	-20.4	1.8	-14.4	0.76	0.48	-19.19	
4,430.0	2.30	354.50	4,427.1	-18.1	1.7	-12.9	0.75	0.63	-11.11	
4,485.0	2.40	351.40	4,482.0	-15.9	1.5	-11.3	0.29	0.18	-5.64	
4,552.0	2.20	348.10	4,549.0	-13.2	1.0	-9.2	0.36	-0.30	-4.93	
4,614.0	2.20	352.70	4,610.9	-10.9	0.6	-7.4	0.28	0.00	7.42	
4,677.0	1.90	16.60	4,673.9	-8.7	0.7	-6.1	1.43	-0.48	37.94	
4,739.0	1.60	27.90	4,735.9	-6.9	1.4	-5.5	0.74	-0.48	18.23	
4,801.0	1.90	40.60	4,797.8	-5.4	2.5	-5.4	0.79	0.48	20.48	
4,863.0	2.00	52.40	4,859.8	-3.9	4.0	-5.6	0.67	0.16	19.03	
4,925.0	2.00	67.20	4,921.8	-2.9	5.9	-6.3	0.83	0.00	23.87	
4,987.0	2.00	84.10	4,983.7	-2.3	8.0	-7.6	0.95	0.00	27.26	
5,048.0	2.10	84.70	5,044.7	-2.1	10.1	-9.1	0.17	0.16	0.98	
5,111.0	2.20	94.40	5,107.6	-2.1	12.5	-10.9	0.60	0.16	15.40	
5,172.0	2.50	96.80	5,168.6	-2.3	15.0	-13.0	0.52	0.49	3.93	
5,234.0	2.50	97.70	5,230.5	-2.7	17.7	-15.3	0.06	0.00	1.45	
5,266.0	2.70	91.90	5,262.5	-2.8	19.1	-16.5	1.03	0.63	-18.13	
5,329.0	2.50	89.00	5,325.4	-2.8	22.0	-18.7	0.38	-0.32	-4.60	
5,392.0	1.90	70.40	5,388.4	-2.5	24.3	-20.3	1.47	-0.95	-29.52	
5,454.0	1.70	66.00	5,450.3	-1.7	26.1	-21.2	0.39	-0.32	-7.10	
5,517.0	1.00	68.60	5,513.3	-1.2	27.5	-21.9	1.12	-1.11	4.13	
5,579.0	0.90	39.20	5,575.3	-0.6	28.3	-22.1	0.79	-0.16	-47.42	
5,641.0	0.50	30.20	5,637.3	0.0	28.7	-22.1	0.67	-0.65	-14.52	
5,703.0	0.30	176.30	5,699.3	0.1	28.9	-22.2	1.24	-0.32	235.65	
5,765.0	0.70	176.70	5,761.3	-0.4	28.9	-22.5	0.65	0.65	0.65	
5,828.0	1.30	118.00	5,824.3	-1.2	29.6	-23.5	1.76	0.95	-93.17	
5,890.0	1.60	85.40	5,886.3	-1.4	31.1	-24.8	1.39	0.48	-52.58	
5,951.0	1.20	63.30	5,947.3	-1.1	32.5	-25.7	1.09	-0.66	-36.23	
5,988.0	1.10	49.50	5,984.3	-0.7	33.1	-25.9	0.79	-0.27	-37.30	
6,050.0	0.80	30.20	6,046.3	0.1	33.8	-25.9	0.70	-0.48	-31.13	
6,112.0	0.50	115.10	6,108.2	0.4	34.2	-26.1	1.46	-0.48	136.94	
6,174.0	1.10	97.60	6,170.2	0.2	35.1	-26.9	1.03	0.97	-28.23	
6,237.0	1.10	48.70	6,233.2	0.5	36.1	-27.5	1.45	0.00	-77.62	
6,300.0	1.90	37.40	6,296.2	1.7	37.2	-27.5	1.35	1.27	-17.94	
6,362.0	1.50	53.40	6,358.2	3.0	38.5	-27.7	1.00	-0.65	25.81	
6,425.0	1.90	76.60	6,421.2	3.7	40.2	-28.5	1.25	0.63	36.83	
6,487.0	2.60	88.90	6,483.1	4.0	42.6	-30.2	1.37	1.13	19.84	

# Survey Report

<b>Company:</b>	Wellstar Corporation	<b>Local Co-ordinate Reference:</b>	Site Sec 35-T8N-R78W
<b>Project:</b>	Jackson County, CO	<b>TVD Reference:</b>	WELL @ 8549.0usft (Evergreen @ 21 (15' KB))
<b>Site:</b>	Sec 35-T8N-R78W	<b>MD Reference:</b>	WELL @ 8549.0usft (Evergreen @ 21 (15' KB))
<b>Well:</b>	Silver Spur Minerals 35-2H	<b>North Reference:</b>	True
<b>Wellbore:</b>	Precision #706	<b>Survey Calculation Method:</b>	Minimum Curvature
<b>Design:</b>	Wellbore #1	<b>Database:</b>	Rocky Mountain R5000 Database

Survey									
Measured Depth (usft)	Inclination (°)	Azimuth (°)	Vertical Depth (usft)	+N/-S (usft)	+E/-W (usft)	Vertical Section (usft)	Dogleg Rate (°/100usft)	Build Rate (°/100usft)	Turn Rate (°/100usft)
6,550.0	1.90	83.50	6,546.1	4.2	45.0	-32.0	1.16	-1.11	-8.57
6,609.0	1.70	64.70	6,605.0	4.6	46.8	-33.0	1.05	-0.34	-31.86
6,672.0	1.50	51.30	6,668.0	5.6	48.3	-33.6	0.67	-0.32	-21.27
6,732.0	1.10	329.90	6,728.0	6.5	48.6	-33.2	2.87	-0.67	-135.67
6,794.0	1.90	281.30	6,790.0	7.3	47.3	-31.7	2.31	1.29	-78.39
6,856.0	2.40	269.40	6,851.9	7.5	45.0	-29.8	1.08	0.81	-19.19
6,919.0	2.20	253.40	6,914.9	7.1	42.5	-28.2	1.06	-0.32	-25.40
6,981.0	1.80	262.90	6,976.8	6.6	40.4	-26.8	0.84	-0.65	15.32
7,043.0	1.60	280.30	7,038.8	6.7	38.6	-25.4	0.89	-0.32	28.06
7,105.0	1.70	281.70	7,100.8	7.0	36.8	-23.9	0.17	0.16	2.26
7,167.0	2.60	286.20	7,162.7	7.6	34.6	-21.8	1.48	1.45	7.26
7,230.0	2.40	297.70	7,225.7	8.6	32.0	-19.2	0.86	-0.32	18.25
7,292.0	2.60	288.40	7,287.6	9.6	29.6	-16.6	0.73	0.32	-15.00
7,355.0	2.40	279.40	7,350.6	10.3	26.9	-14.1	0.70	-0.32	-14.29
7,418.0	1.30	284.60	7,413.5	10.7	24.9	-12.3	1.76	-1.75	8.25
7,480.0	0.40	343.80	7,475.5	11.1	24.2	-11.5	1.85	-1.45	95.48
7,542.0	0.80	40.80	7,537.5	11.6	24.4	-11.3	1.08	0.65	91.94
7,604.0	1.00	49.50	7,599.5	12.3	25.1	-11.4	0.39	0.32	14.03
7,666.0	1.50	108.90	7,661.5	12.4	26.3	-12.3	2.12	0.81	95.81
7,729.0	2.40	81.00	7,724.5	12.3	28.4	-13.9	2.04	1.43	-44.29
7,791.0	2.70	92.40	7,786.4	12.5	31.1	-15.9	0.95	0.48	18.39
7,854.0	2.40	111.50	7,849.3	11.9	33.8	-18.4	1.42	-0.48	30.32
7,917.0	2.40	123.80	7,912.3	10.7	36.1	-20.9	0.82	0.00	19.52
7,979.0	2.90	110.80	7,974.2	9.4	38.7	-23.7	1.26	0.81	-20.97
8,041.0	3.70	102.50	8,036.1	8.4	42.1	-27.0	1.50	1.29	-13.39
8,103.0	4.60	97.40	8,098.0	7.7	46.5	-30.9	1.57	1.45	-8.23
8,164.0	4.90	97.90	8,158.8	7.0	51.5	-35.1	0.50	0.49	0.82
8,279.0	7.50	339.90	8,273.4	13.4	53.8	-32.8	9.31	2.26	-102.61
8,310.0	11.30	326.40	8,304.0	17.8	51.4	-28.2	14.09	12.26	-43.55
8,342.0	15.70	328.20	8,335.1	24.1	47.4	-21.0	13.81	13.75	5.63
8,373.0	19.40	325.10	8,364.6	31.9	42.3	-12.1	12.31	11.94	-10.00
8,404.0	23.70	321.50	8,393.5	41.0	35.4	-1.0	14.51	13.87	-11.61
8,436.0	25.90	313.60	8,422.5	50.9	26.4	12.2	12.42	6.88	-24.69
8,467.0	27.10	310.10	8,450.3	60.1	16.1	26.1	6.35	3.87	-11.29
8,496.0	28.70	309.40	8,475.9	68.8	5.6	39.6	5.63	5.52	-2.41
8,528.0	29.50	310.10	8,503.8	78.7	-6.3	55.2	2.72	2.50	2.19
8,559.0	29.40	309.10	8,530.8	88.4	-18.1	70.4	1.62	-0.32	-3.23
8,599.0	30.00	306.40	8,565.6	100.6	-33.8	90.2	3.66	1.50	-6.75
8,621.0	32.70	303.50	8,584.4	107.1	-43.1	101.6	14.06	12.27	-13.18
8,652.0	34.40	302.00	8,610.2	116.4	-57.6	118.6	6.10	5.48	-4.84
8,683.0	37.60	302.00	8,635.3	126.0	-73.0	136.7	10.32	10.32	0.00
8,714.0	40.90	302.80	8,659.3	136.6	-89.6	156.1	10.77	10.65	2.58
8,745.0	43.30	303.60	8,682.3	147.9	-106.9	176.8	7.93	7.74	2.58
8,777.0	46.50	305.40	8,704.9	160.7	-125.6	199.3	10.76	10.00	5.63

# Survey Report

<b>Company:</b>	Wellstar Corporation	<b>Local Co-ordinate Reference:</b>	Site Sec 35-T8N-R78W
<b>Project:</b>	Jackson County, CO	<b>TVD Reference:</b>	WELL @ 8549.0usft (Evergreen @ 21 (15' KB))
<b>Site:</b>	Sec 35-T8N-R78W	<b>MD Reference:</b>	WELL @ 8549.0usft (Evergreen @ 21 (15' KB))
<b>Well:</b>	Silver Spur Minerals 35-2H	<b>North Reference:</b>	True
<b>Wellbore:</b>	Precision #706	<b>Survey Calculation Method:</b>	Minimum Curvature
<b>Design:</b>	Wellbore #1	<b>Database:</b>	Rocky Mountain R5000 Database

Survey									
Measured Depth (usft)	Inclination (°)	Azimuth (°)	Vertical Depth (usft)	+N/-S (usft)	+E/-W (usft)	Vertical Section (usft)	Dogleg Rate (°/100usft)	Build Rate (°/100usft)	Turn Rate (°/100usft)
8,808.0	50.40	305.30	8,725.5	174.2	-144.5	222.4	12.58	12.58	-0.32
8,840.0	53.70	304.80	8,745.2	188.6	-165.1	247.6	10.39	10.31	-1.56
8,871.0	57.70	304.80	8,762.6	203.3	-186.2	273.1	12.90	12.90	0.00
8,902.0	60.30	305.80	8,778.6	218.6	-207.8	299.6	8.83	8.39	3.23
8,934.0	63.60	306.30	8,793.7	235.2	-230.7	327.7	10.40	10.31	1.56
8,965.0	67.10	306.90	8,806.6	252.0	-253.3	355.9	11.43	11.29	1.94
8,996.0	70.30	308.90	8,817.8	269.8	-276.1	384.7	11.94	10.32	6.45
9,026.0	73.70	307.50	8,827.1	287.4	-298.5	413.2	12.17	11.33	-4.67
9,057.0	77.40	306.50	8,834.9	305.5	-322.5	443.2	12.34	11.94	-3.23
9,087.0	81.50	305.80	8,840.3	322.9	-346.3	472.7	13.86	13.67	-2.33
9,119.0	84.60	305.60	8,844.2	341.4	-372.1	504.3	9.71	9.69	-0.63
9,150.0	86.60	305.60	8,846.6	359.4	-397.2	535.2	6.45	6.45	0.00
9,181.0	86.40	305.10	8,848.5	377.3	-422.4	566.0	1.73	-0.65	-1.61
9,212.0	86.60	305.80	8,850.4	395.2	-447.6	596.9	2.34	0.65	2.26
9,243.0	86.80	307.70	8,852.2	413.7	-472.4	627.8	6.15	0.65	6.13
9,274.0	87.30	309.00	8,853.8	433.0	-496.7	658.7	4.49	1.61	4.19
9,305.0	87.10	308.40	8,855.3	452.3	-520.9	689.7	2.04	-0.65	-1.94
9,337.0	86.40	311.20	8,857.1	472.8	-545.4	721.6	9.01	-2.19	8.75
9,368.0	85.30	312.10	8,859.3	493.3	-568.5	752.5	4.58	-3.55	2.90
9,400.0	85.20	312.00	8,862.0	514.7	-592.2	784.4	0.44	-0.31	-0.31
9,431.0	85.20	311.90	8,864.6	535.3	-615.2	815.3	0.32	0.00	-0.32
9,462.0	85.20	311.50	8,867.2	555.9	-638.2	846.1	1.29	0.00	-1.29
9,493.0	85.00	311.30	8,869.8	576.3	-661.4	877.0	0.91	-0.65	-0.65
9,525.0	84.90	310.50	8,872.6	597.2	-685.5	908.9	2.51	-0.31	-2.50
9,556.0	84.80	310.80	8,875.4	617.3	-708.9	939.7	1.02	-0.32	0.97
9,587.0	84.90	310.00	8,878.2	637.3	-732.4	970.6	2.59	0.32	-2.58
9,681.0	84.80	313.10	8,886.6	699.4	-802.5	1,064.2	3.29	-0.11	3.30
9,702.0	84.73	312.74	8,888.6	713.6	-817.8	1,085.1	1.72	-0.32	-1.70
Start Sidetrack at 9,702' MD									
9,775.0	84.50	311.50	8,895.4	762.4	-871.7	1,157.7	1.72	-0.32	-1.70
9,867.0	84.30	310.90	8,904.4	822.7	-940.6	1,249.2	0.68	-0.22	-0.65
9,961.0	84.60	310.20	8,913.5	883.5	-1,011.7	1,342.8	0.81	0.32	-0.74
10,053.0	84.40	308.70	8,922.3	941.7	-1,082.4	1,434.3	1.64	-0.22	-1.63
10,147.0	85.80	308.70	8,930.3	1,000.2	-1,155.5	1,528.0	1.49	1.49	0.00
10,241.0	86.50	309.10	8,936.6	1,059.1	-1,228.5	1,621.7	0.86	0.74	0.43
10,273.0	86.40	308.60	8,938.6	1,079.2	-1,253.4	1,653.7	1.59	-0.31	-1.56
10,304.0	86.40	308.90	8,940.6	1,098.5	-1,277.5	1,684.6	0.97	0.00	0.97
10,335.0	85.40	310.40	8,942.8	1,118.3	-1,301.3	1,715.5	5.81	-3.23	4.84
10,398.0	85.30	309.30	8,947.9	1,158.5	-1,349.5	1,778.3	1.75	-0.16	-1.75
10,430.0	84.80	309.30	8,950.6	1,178.7	-1,374.2	1,810.2	1.56	-1.56	0.00
10,461.0	84.90	310.40	8,953.4	1,198.5	-1,397.9	1,841.1	3.55	0.32	3.55
10,492.0	85.80	310.80	8,955.9	1,218.6	-1,421.3	1,872.0	3.18	2.90	1.29
10,523.0	86.40	311.40	8,958.0	1,238.9	-1,444.6	1,902.9	2.73	1.94	1.94

## Survey Report

<b>Company:</b>	Wellstar Corporation	<b>Local Co-ordinate Reference:</b>	Site Sec 35-T8N-R78W
<b>Project:</b>	Jackson County, CO	<b>TVD Reference:</b>	WELL @ 8549.0usft (Evergreen @ 21 (15' KB))
<b>Site:</b>	Sec 35-T8N-R78W	<b>MD Reference:</b>	WELL @ 8549.0usft (Evergreen @ 21 (15' KB))
<b>Well:</b>	Silver Spur Minerals 35-2H	<b>North Reference:</b>	True
<b>Wellbore:</b>	Precision #706	<b>Survey Calculation Method:</b>	Minimum Curvature
<b>Design:</b>	Wellbore #1	<b>Database:</b>	Rocky Mountain R5000 Database

Survey										
Measured Depth (usft)	Inclination (°)	Azimuth (°)	Vertical Depth (usft)	+N/-S (usft)	+E/-W (usft)	Vertical Section (usft)	Dogleg Rate (°/100usft)	Build Rate (°/100usft)	Turn Rate (°/100usft)	
10,585.0	86.30	311.30	8,962.0	1,279.8	-1,491.1	1,964.7	0.23	-0.16	-0.16	
10,617.0	86.90	310.60	8,963.9	1,300.7	-1,515.2	1,996.7	2.88	1.88	-2.19	
10,680.0	88.20	310.80	8,966.6	1,341.8	-1,562.9	2,059.6	2.09	2.06	0.32	
10,711.0	87.90	311.20	8,967.6	1,362.1	-1,586.3	2,090.6	1.61	-0.97	1.29	
10,773.0	87.80	310.90	8,970.0	1,402.8	-1,633.0	2,152.5	0.51	-0.16	-0.48	
10,805.0	87.90	310.90	8,971.2	1,423.7	-1,657.2	2,184.5	0.31	0.31	0.00	
10,866.0	88.10	312.00	8,973.3	1,464.1	-1,702.9	2,245.4	1.83	0.33	1.80	
10,898.0	87.90	312.20	8,974.4	1,485.5	-1,726.6	2,277.4	0.88	-0.63	0.63	
10,959.0	87.70	311.50	8,976.8	1,526.2	-1,772.0	2,338.3	1.19	-0.33	-1.15	
10,991.0	87.40	312.60	8,978.1	1,547.6	-1,795.8	2,370.2	3.56	-0.94	3.44	
11,052.0	88.50	312.40	8,980.3	1,588.8	-1,840.7	2,431.1	1.83	1.80	-0.33	
11,083.0	88.30	312.30	8,981.2	1,609.7	-1,863.6	2,462.1	0.72	-0.65	-0.32	
11,146.0	88.30	312.70	8,983.0	1,652.2	-1,910.0	2,525.0	0.63	0.00	0.63	
11,177.0	88.20	313.40	8,984.0	1,673.4	-1,932.7	2,555.9	2.28	-0.32	2.26	
11,270.0	88.30	314.00	8,986.8	1,737.6	-1,999.9	2,648.6	0.65	0.11	0.65	
11,301.0	88.30	313.50	8,987.7	1,759.0	-2,022.3	2,679.6	1.61	0.00	-1.61	
11,363.0	88.40	313.60	8,989.5	1,801.7	-2,067.2	2,741.4	0.23	0.16	0.16	
11,394.0	89.30	313.50	8,990.2	1,823.1	-2,089.7	2,772.3	2.92	2.90	-0.32	
11,457.0	90.00	312.70	8,990.5	1,866.1	-2,135.6	2,835.2	1.69	1.11	-1.27	
11,519.0	90.60	312.60	8,990.2	1,908.1	-2,181.3	2,897.1	0.98	0.97	-0.16	
11,550.0	90.80	311.80	8,989.8	1,928.9	-2,204.2	2,928.1	2.66	0.65	-2.58	
11,613.0	90.80	311.50	8,989.0	1,970.8	-2,251.3	2,991.0	0.48	0.00	-0.48	
11,644.0	90.90	311.80	8,988.5	1,991.4	-2,274.4	3,022.0	1.02	0.32	0.97	
Projected Survey to 11,644' MD - SS PBHL										

Design Targets										
Target Name	Dip Angle (°)	Dip Dir. (°)	TVD (usft)	+N/-S (usft)	+E/-W (usft)	Northing (usft)	Easting (usft)	Latitude	Longitude	
SS PBHL	0.00	0.00	8,893.0	2,790.4	-3,358.6	1,471,444.32	2,828,272.87	40° 37' 33.121 N	106° 7' 7.168 W	
- hit/miss target										
- Shape										
- survey misses target center by 1350.2usft at 11644.0usft MD (8988.5 TVD, 1991.4 N, -2274.4 E)										
- Rectangle (sides W55.0 H55.0 D0.0)										

Survey Annotations					
Measured Depth (usft)	Vertical Depth (usft)	Local Coordinates			
		+N/-S (usft)	+E/-W (usft)	Comment	
9,702.0	8,888.6	713.6	-817.8	Start Sidetrack at 9,702' MD	
11,644.0	8,988.5	1,991.4	-2,274.4	Projected Survey to 11,644' MD	

Checked By: _____	Approved By: _____	Date: _____
-------------------	--------------------	-------------