

**PROPOSED LOCATION:
EASTERN HILLS #4-65 17-18
1DH, 1CH, 1BH & 1AH**

LEGEND:

 **PROPOSED LOCATION**

ConocoPhillips Company

**EASTERN HILLS #4-65 17-18 1DH, 1CH, 1BH & 1AH
SECTION 17, T4S, R65W, 6th P.M.
E 1/4 NE 1/4**



DRAWN BY: J.C.	DATE DRAWN: 02-20-14
SCALE: 1:100,000	REVISED: 4-23-15 J.L.G.

ACCESS ROAD MAP

TOPO A



UELS, LLC
Corporate Office * 85 South 200 East
Vernal, UT 84078 * (435) 789-1017

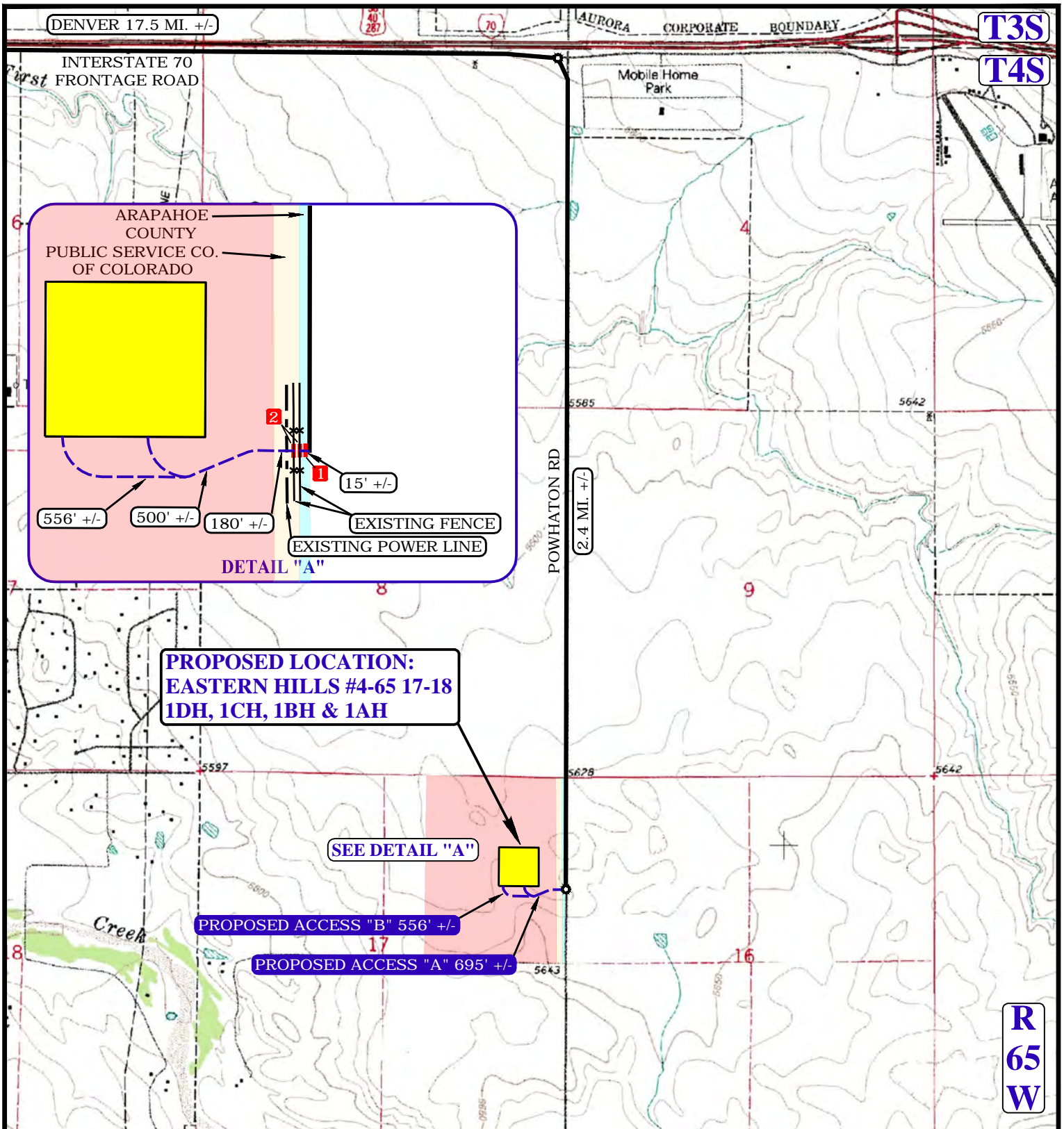

**PROPOSED LOCATION:
EASTERN HILLS #4-65 17-18
1DH, 1CH, 1BH & 1AH**

SEE DETAIL "A"

PROPOSED ACCESS "B" 556' +/-

PROPOSED ACCESS "A" 695' +/-

NOTE: PARCEL DATA SHOWN HAS BEEN OBTAINED FROM VARIOUS SOURCES AND SHOULD BE USED FOR MAPPING, GRAPHIC AND PLANNING PURPOSES ONLY. NO WARRANTY IS MADE BY UINTAH ENGINEERING AND LAND SURVEYING (UELS) FOR ACCURACY OF THE PARCEL DATA.

LEGEND:

- EXISTING ROAD
- PROPOSED ROAD
- EXISTING FENCE
- EXISTING POWER LINE
- 18" CMP REQUIRED
- CATTLE GUARD REQUIRED

ConocoPhillips Company

**EASTERN HILLS #4-65 17-18 1DH, 1CH, 1BH & 1AH
SECTION 17, T4S, R65W, 6th P.M.
E 1/4 NE 1/4**



DRAWN BY: J.C.	DATE DRAWN: 02-20-14
SCALE: 1" = 2000'	REVISED: 4-23-15 J.L.G.

ACCESS ROAD MAP

TOPO B



UELS, LLC
Corporate Office * 85 South 200 East
Vernal, UT 84078 * (435) 789-1017