

Location:	COLORADO	Slot:	SLOT#13 VOLLMAR 3N-11HZ (1223'FNL & 1892'FWL, SEC.14)
Field:	WELD COUNTY (KERR MCGEE)	Well:	VOLLMAR 3N-11HZ
Facility:	SEC.14-T2N-R67W	Wellbore:	VOLLMAR 3N-11HZ PWB

Plot reference wellpath is VOLLMAR 3N-11HZ (REV-B.0) PWP	
True vertical depths are referenced to XTREME 6 (16KB) (RKB)	Grid System: NAD83 / Lambert Colorado SP, Northern Zone (501), US feet
Measured depths are referenced to XTREME 6 (16KB) (RKB)	North Reference: True north
XTREME 6 (16KB) (RKB) to Mean Sea Level: 4961 feet	Scale: True distance
Mean Sea Level to Mud line (At Slot: SLOTT#13 VOLLMAR 3N-11HZ (1223FNL & 1892FWL, SEC.14)): 0 feet	Depths are in feet
Coordinates are in feet referenced to Slot	Created by: amarcn on 06/Mar/2015

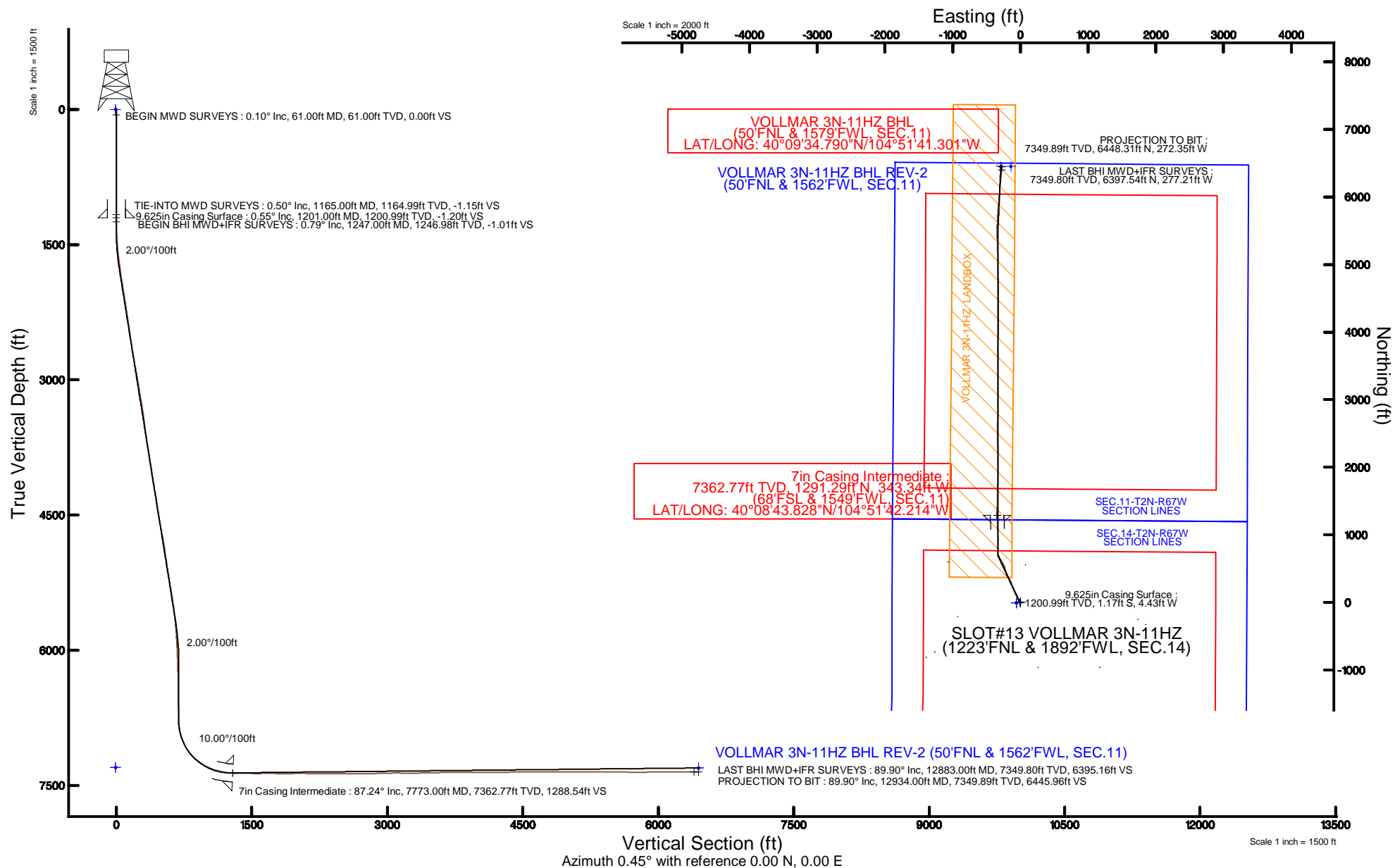

## REFERENCE WELLPATH IDENTIFICATION

Operator	KERR-MCGEE OIL & GAS ONSHORE LP (LAMBERT STATE PLANE COORD)	Slot	SLOT#13 VOLLMAR 3N-11HZ (1223'FNL & 1892'FWL, SEC.14)
Area	COLORADO	Well	VOLLMAR 3N-11HZ
Field	WELD COUNTY (KERR MCGEE)	Wellbore	VOLLMAR 3N-11HZ AWB <12934>
Facility	SEC.14-T2N-R67W		

## REPORT SETUP INFORMATION

Projection System	NAD83 / Lambert Colorado SP, Northern Zone (501), US feet	Software System	WellArchitect® 4.1.1
North Reference	True	User	Amarcar
Scale	0.999959	Report Generated	11/Mar/2015 at 11:18
Convergence at slot	0.41° East	Database/Source file	WellArchitectDB/VOLLMAR_3N-11HZ_AWB__12934_.xml

## WELLPATH LOCATION

	Local coordinates		Grid coordinates		Geographic coordinates	
	North[ft]	East[ft]	Easting[US ft]	Northing[US ft]	Latitude	Longitude
Slot Location	3481.58	-1104.97	3178784.27	1295205.35	40°08'31.067"N	104°51'37.793"W
Facility Reference Pt			3179914.43	1291732.03	40°07'56.662"N	104°51'23.565"W
Field Reference Pt			3197771.84	1268891.29	40°04'09.600"N	104°47'36.000"W

## WELLPATH DATUM

Calculation method	Minimum curvature	XTREME 6 (16'KB) (RKB) to Facility Vertical Datum	4961.00ft
Horizontal Reference Pt	Slot	XTREME 6 (16'KB) (RKB) to Mean Sea Level	4961.00ft
Vertical Reference Pt	XTREME 6 (16'KB) (RKB)	XTREME 6 (16'KB) (RKB) to Mud Line at Slot (SLOT#13 VOLLMAR 3N-11HZ (1223'FNL & 1892'FWL, SEC.14))	4961.00ft
MD Reference Pt	XTREME 6 (16'KB) (RKB)	Section Origin	N 0.00, E 0.00 ft
Field Vertical Reference	Mean Sea Level	Section Azimuth	0.45°

### REFERENCE WELLPATH IDENTIFICATION

Operator	KERR-MCGEE OIL & GAS ONSHORE LP (LAMBERT STATE PLANE COORD)	Slot	SLOT#13 VOLLMAR 3N-11HZ (1223'FNL & 1892'FWL, SEC.14)
Area	COLORADO	Well	VOLLMAR 3N-11HZ
Field	WELD COUNTY (KERR MCGEE)	Wellbore	VOLLMAR 3N-11HZ AWB <12934>
Facility	SEC.14-T2N-R67W		

### WELLPATH DATA (111 stations) † = interpolated/extrapolated station

MD [ft]	Inclination [°]	Azimuth [°]	TVD [ft]	Vert Sect [ft]	North [ft]	East [ft]	Latitude	Longitude	DLS [°/100ft]	Comments
0.00†	0.000	267.800	0.00	0.00	0.00	0.00	40°08'31.067"N	104°51'37.793"W	0.00	
16.00	0.000	267.800	16.00	0.00	0.00	0.00	40°08'31.067"N	104°51'37.793"W	0.00	
61.00	0.100	267.800	61.00	0.00	0.00	-0.04	40°08'31.067"N	104°51'37.794"W	0.22	BEGIN MWD SURVEYS
171.00	0.100	74.000	171.00	0.02	0.02	-0.04	40°08'31.067"N	104°51'37.794"W	0.18	
249.00	0.100	204.300	249.00	-0.02	-0.02	-0.01	40°08'31.067"N	104°51'37.793"W	0.23	
329.00	0.100	234.300	329.00	-0.13	-0.13	-0.09	40°08'31.066"N	104°51'37.794"W	0.06	
409.00	0.300	303.300	409.00	-0.05	-0.05	-0.32	40°08'31.066"N	104°51'37.797"W	0.35	
489.00	0.200	244.200	489.00	0.00	0.00	-0.62	40°08'31.067"N	104°51'37.801"W	0.33	
569.00	0.300	263.800	569.00	-0.09	-0.08	-0.96	40°08'31.066"N	104°51'37.805"W	0.16	
649.00	0.400	265.700	649.00	-0.14	-0.12	-1.44	40°08'31.066"N	104°51'37.812"W	0.13	
729.00	0.100	260.100	729.00	-0.17	-0.16	-1.79	40°08'31.065"N	104°51'37.816"W	0.38	
809.00	0.200	232.500	809.00	-0.27	-0.25	-1.97	40°08'31.064"N	104°51'37.818"W	0.15	
889.00	0.200	228.900	888.99	-0.45	-0.43	-2.19	40°08'31.063"N	104°51'37.821"W	0.02	
969.00	0.400	237.700	968.99	-0.69	-0.67	-2.53	40°08'31.060"N	104°51'37.826"W	0.26	
1049.00	0.600	257.100	1048.99	-0.94	-0.92	-3.17	40°08'31.058"N	104°51'37.834"W	0.32	
1129.00	0.400	264.500	1128.99	-1.07	-1.04	-3.86	40°08'31.057"N	104°51'37.843"W	0.26	
1165.00	0.500	243.400	1164.99	-1.15	-1.12	-4.12	40°08'31.056"N	104°51'37.846"W	0.53	TIE-INTO MWD SURVEYS
1247.00	0.790	302.980	1246.98	-1.01	-0.97	-4.92	40°08'31.057"N	104°51'37.856"W	0.84	BEGIN BHI MWD+HFR SURVEYS
1339.00	2.500	324.240	1338.94	0.95	1.00	-6.62	40°08'31.077"N	104°51'37.878"W	1.94	
1430.00	3.780	339.480	1429.80	5.35	5.42	-8.83	40°08'31.121"N	104°51'37.907"W	1.67	
1520.00	5.610	340.350	1519.50	12.26	12.35	-11.35	40°08'31.189"N	104°51'37.939"W	2.03	
1612.00	6.620	334.020	1610.97	21.23	21.35	-15.19	40°08'31.278"N	104°51'37.989"W	1.32	
1703.00	7.760	334.110	1701.26	31.43	31.59	-20.17	40°08'31.379"N	104°51'38.053"W	1.25	
1793.00	9.150	333.830	1790.28	43.27	43.48	-25.98	40°08'31.497"N	104°51'38.128"W	1.55	
1884.00	10.390	335.380	1879.96	57.17	57.43	-32.59	40°08'31.635"N	104°51'38.213"W	1.39	
1975.00	9.330	334.160	1969.61	71.22	71.53	-39.22	40°08'31.774"N	104°51'38.298"W	1.19	
2157.00	10.260	332.540	2148.96	98.77	99.19	-53.13	40°08'32.047"N	104°51'38.477"W	0.53	
2338.00	9.530	330.130	2327.26	125.95	126.49	-68.02	40°08'32.317"N	104°51'38.669"W	0.46	
2513.00	9.230	335.280	2499.93	151.16	151.80	-81.11	40°08'32.567"N	104°51'38.837"W	0.51	
2682.00	9.710	335.690	2666.62	176.37	177.10	-92.64	40°08'32.817"N	104°51'38.986"W	0.29	
2854.00	11.830	337.790	2835.58	205.81	206.65	-105.28	40°08'33.109"N	104°51'39.149"W	1.25	
3028.00	9.820	337.990	3006.48	235.99	236.92	-117.58	40°08'33.408"N	104°51'39.307"W	1.16	
3206.00	10.980	337.550	3181.55	265.63	266.66	-129.75	40°08'33.702"N	104°51'39.464"W	0.65	
3384.00	8.410	338.690	3356.99	293.34	294.46	-140.95	40°08'33.977"N	104°51'39.608"W	1.45	
3562.00	8.160	328.680	3533.15	316.17	317.38	-152.25	40°08'34.203"N	104°51'39.753"W	0.82	
3740.00	10.280	331.010	3708.84	340.74	342.07	-166.52	40°08'34.447"N	104°51'39.937"W	1.21	
3918.00	9.620	335.130	3884.16	368.02	369.45	-180.47	40°08'34.718"N	104°51'40.117"W	0.55	
4094.00	9.640	332.750	4057.68	394.36	395.90	-193.40	40°08'34.979"N	104°51'40.283"W	0.23	
4272.00	11.330	342.280	4232.72	424.17	425.80	-205.55	40°08'35.275"N	104°51'40.440"W	1.36	
4448.00	7.880	337.860	4406.23	451.75	453.46	-215.36	40°08'35.548"N	104°51'40.566"W	2.00	
4626.00	11.600	345.760	4581.64	480.33	482.12	-224.36	40°08'35.831"N	104°51'40.682"W	2.22	
4804.00	10.740	346.650	4756.26	513.75	515.60	-232.60	40°08'36.162"N	104°51'40.788"W	0.49	
4982.00	8.790	333.580	4931.70	542.00	543.92	-242.48	40°08'36.442"N	104°51'40.915"W	1.65	
5158.00	10.790	329.910	5105.13	568.18	570.22	-256.72	40°08'36.702"N	104°51'41.099"W	1.19	
5334.00	10.820	325.360	5278.01	595.89	598.07	-274.37	40°08'36.977"N	104°51'41.326"W	0.48	

## REFERENCE WELLPATH IDENTIFICATION

Operator	KERR-MCGEE OIL & GAS ONSHORE LP (LAMBERT STATE PLANE COORD)	Slot	SLOT#13 VOLLMAR 3N-11HZ (1223'FNL & 1892'FWL, SEC.14)
Area	COLORADO	Well	VOLLMAR 3N-11HZ
Field	WELD COUNTY (KERR MCGEE)	Wellbore	VOLLMAR 3N-11HZ AWP <12934>
Facility	SEC.14-T2N-R67W		

## WELLPATH DATA (111 stations) † = interpolated/extrapolated station

MD [ft]	Inclination [°]	Azimuth [°]	TVD [ft]	Vert Sect [ft]	North [ft]	East [ft]	Latitude	Longitude	DLS [°/100ft]	Comments
5509.00	10.100	331.980	5450.11	622.82	625.13	-290.92	40°08'37.245"N	104°51'41.539"W	0.80	
5681.00	7.250	331.200	5620.12	645.55	647.96	-303.24	40°08'37.470"N	104°51'41.698"W	1.66	
5766.00	6.000	331.490	5704.55	654.12	656.56	-307.94	40°08'37.555"N	104°51'41.758"W	1.47	
5855.00	4.820	331.860	5793.15	661.47	663.95	-311.93	40°08'37.628"N	104°51'41.810"W	1.33	
5941.00	3.830	331.040	5878.91	667.15	669.65	-315.02	40°08'37.685"N	104°51'41.849"W	1.15	
6027.00	3.070	330.090	5964.75	671.63	674.16	-317.56	40°08'37.729"N	104°51'41.882"W	0.89	
6110.00	2.610	330.040	6047.65	675.18	677.72	-319.61	40°08'37.764"N	104°51'41.909"W	0.55	
6196.00	2.460	327.150	6133.57	678.41	680.97	-321.59	40°08'37.796"N	104°51'41.934"W	0.23	
6281.00	1.880	324.120	6218.50	681.06	683.63	-323.40	40°08'37.823"N	104°51'41.957"W	0.70	
6451.00	1.030	322.250	6388.45	684.51	687.10	-325.97	40°08'37.857"N	104°51'41.990"W	0.50	
6621.00	0.590	314.270	6558.43	686.32	688.92	-327.53	40°08'37.875"N	104°51'42.010"W	0.27	
6834.00	0.630	299.630	6771.42	687.65	690.26	-329.33	40°08'37.888"N	104°51'42.034"W	0.08	
6877.00	4.010	346.260	6814.38	689.22	691.84	-329.89	40°08'37.904"N	104°51'42.041"W	8.39	
6919.00	8.090	358.100	6856.14	693.60	696.22	-330.34	40°08'37.947"N	104°51'42.047"W	10.11	
6962.00	12.620	356.270	6898.43	701.31	703.94	-330.75	40°08'38.023"N	104°51'42.052"W	10.56	
7005.00	16.930	357.830	6940.00	712.25	714.89	-331.29	40°08'38.132"N	104°51'42.059"W	10.06	
7047.00	20.880	358.580	6979.72	725.85	728.49	-331.71	40°08'38.266"N	104°51'42.064"W	9.42	
7090.00	24.200	0.770	7019.43	742.33	744.96	-331.78	40°08'38.429"N	104°51'42.065"W	7.96	
7133.00	26.140	0.170	7058.35	760.61	763.25	-331.63	40°08'38.609"N	104°51'42.063"W	4.55	
7175.00	30.870	359.960	7095.25	780.65	783.29	-331.61	40°08'38.807"N	104°51'42.063"W	11.26	
7217.00	36.280	0.710	7130.23	803.87	806.51	-331.47	40°08'39.037"N	104°51'42.061"W	12.92	
7259.00	42.420	1.070	7162.69	830.49	833.12	-331.05	40°08'39.300"N	104°51'42.056"W	14.63	
7302.00	46.920	2.290	7193.26	860.70	863.33	-330.15	40°08'39.598"N	104°51'42.044"W	10.65	
7345.00	51.290	2.300	7221.41	893.18	895.80	-328.85	40°08'39.919"N	104°51'42.028"W	10.16	
7387.00	54.270	0.350	7246.81	926.61	929.23	-328.09	40°08'40.250"N	104°51'42.018"W	8.00	
7430.00	57.860	358.660	7270.81	962.28	964.89	-328.40	40°08'40.602"N	104°51'42.022"W	8.96	
7472.00	62.300	357.330	7291.76	998.63	1001.26	-329.69	40°08'40.962"N	104°51'42.038"W	10.92	
7515.00	67.780	355.860	7309.89	1037.51	1040.16	-332.01	40°08'41.346"N	104°51'42.068"W	13.12	
7558.00	71.960	356.000	7324.69	1077.75	1080.42	-334.88	40°08'41.744"N	104°51'42.105"W	9.73	
7600.00	76.180	356.640	7336.22	1118.03	1120.72	-337.47	40°08'42.142"N	104°51'42.139"W	10.15	
7642.00	78.490	357.230	7345.42	1158.92	1161.64	-339.66	40°08'42.546"N	104°51'42.167"W	5.67	
7685.00	80.560	358.220	7353.24	1201.16	1203.88	-341.33	40°08'42.964"N	104°51'42.188"W	5.32	
7736.00	84.190	358.360	7360.01	1251.66	1254.40	-342.84	40°08'43.463"N	104°51'42.208"W	7.12	
7773.00†	87.238	0.096	7362.77	1288.54	1291.29	-343.34	40°08'43.828"N	104°51'42.214"W	9.47	7" CASING POINT
7790.00	88.640	0.890	7363.38	1305.53	1308.28	-343.19	40°08'43.995"N	104°51'42.212"W	9.47	
7922.00	88.670	0.950	7366.48	1437.49	1440.22	-341.07	40°08'45.299"N	104°51'42.185"W	0.05	
8092.00	90.680	1.320	7367.45	1607.47	1610.18	-337.70	40°08'46.979"N	104°51'42.142"W	1.20	
8262.00	89.130	1.230	7367.73	1777.44	1780.13	-333.92	40°08'48.658"N	104°51'42.093"W	0.91	
8433.00	90.890	1.410	7367.70	1948.42	1951.08	-329.98	40°08'50.348"N	104°51'42.042"W	1.03	
8603.00	89.040	359.850	7367.80	2118.40	2121.06	-328.11	40°08'52.027"N	104°51'42.018"W	1.42	
8774.00	89.440	356.910	7370.07	2289.26	2291.95	-332.95	40°08'53.716"N	104°51'42.081"W	1.73	
8944.00	90.310	0.000	7370.44	2459.13	2461.87	-337.53	40°08'55.395"N	104°51'42.140"W	1.89	
9114.00	89.930	1.190	7370.08	2629.13	2631.86	-335.77	40°08'57.075"N	104°51'42.117"W	0.73	
9285.00	90.670	0.740	7369.19	2800.12	2802.83	-332.89	40°08'58.765"N	104°51'42.080"W	0.51	
9455.00	92.180	0.910	7364.96	2970.06	2972.75	-330.44	40°09'00.444"N	104°51'42.048"W	0.89	

## REFERENCE WELLPATH IDENTIFICATION

Operator	KERR-MCGEE OIL & GAS ONSHORE LP (LAMBERT STATE PLANE COORD)	Slot	SLOT#13 VOLLMAR 3N-11HZ (1223'FNL & 1892'FWL, SEC.14)
Area	COLORADO	Well	VOLLMAR 3N-11HZ
Field	WELD COUNTY (KERR MCGEE)	Wellbore	VOLLMAR 3N-11HZ AWB <12934>
Facility	SEC.14-T2N-R67W		

## WELLPATH DATA (111 stations)

MD [ft]	Inclination [°]	Azimuth [°]	TVD [ft]	Vert Sect [ft]	North [ft]	East [ft]	Latitude	Longitude	DLS [°/100ft]	Comments
9626.00	89.440	0.240	7362.54	3141.02	3143.71	-328.72	40°09'02.133"N	104°51'42.026"W	1.65	
9796.00	90.300	359.170	7362.93	3311.00	3313.70	-329.60	40°09'03.813"N	104°51'42.038"W	0.81	
9966.00	91.480	0.280	7360.29	3480.96	3483.67	-330.41	40°09'05.493"N	104°51'42.048"W	0.95	
10136.00	91.940	359.880	7355.22	3650.88	3653.60	-330.18	40°09'07.172"N	104°51'42.045"W	0.36	
10307.00	89.690	0.790	7352.78	3821.85	3824.56	-329.18	40°09'08.862"N	104°51'42.032"W	1.42	
10479.00	90.060	0.690	7353.16	3993.85	3996.55	-326.96	40°09'10.561"N	104°51'42.004"W	0.22	
10649.00	90.090	0.400	7352.94	4163.85	4166.54	-325.34	40°09'12.241"N	104°51'41.983"W	0.17	
10819.00	90.120	0.050	7352.63	4333.85	4336.54	-324.67	40°09'13.921"N	104°51'41.974"W	0.21	
10992.00	90.360	359.830	7351.90	4506.84	4509.54	-324.85	40°09'15.631"N	104°51'41.977"W	0.19	
11162.00	90.150	359.260	7351.14	4676.81	4679.53	-326.20	40°09'17.310"N	104°51'41.994"W	0.36	
11333.00	90.210	359.010	7350.61	4847.77	4850.51	-328.78	40°09'19.000"N	104°51'42.027"W	0.15	
11503.00	90.150	359.060	7350.07	5017.72	5020.48	-331.65	40°09'20.680"N	104°51'42.064"W	0.05	
11673.00	90.180	358.650	7349.58	5187.65	5190.45	-335.04	40°09'22.359"N	104°51'42.108"W	0.24	
11843.00	90.060	357.740	7349.23	5357.51	5360.36	-340.40	40°09'24.038"N	104°51'42.177"W	0.54	
12012.00	89.000	0.480	7350.61	5526.44	5529.32	-343.02	40°09'25.708"N	104°51'42.211"W	1.74	
12183.00	89.350	3.220	7353.08	5697.36	5700.20	-337.50	40°09'27.397"N	104°51'42.140"W	1.62	
12353.00	90.920	5.510	7352.68	5866.94	5869.69	-324.57	40°09'29.072"N	104°51'41.973"W	1.63	
12524.00	90.400	4.470	7350.71	6037.39	6040.02	-309.69	40°09'30.755"N	104°51'41.782"W	0.68	
12695.00	90.150	5.390	7349.89	6207.87	6210.39	-295.00	40°09'32.438"N	104°51'41.592"W	0.56	
12883.00	89.900	5.470	7349.80	6395.16	6397.54	-277.21	40°09'34.288"N	104°51'41.363"W	0.14	LAST BHI MWD+IFR SURVEYS
12934.00	89.900	5.470	7349.89	6445.96	6448.31	-272.35	40°09'34.790"N	104°51'41.301"W	0.00	PROJECTION TO BIT

## HOLE & CASING SECTIONS - Ref Wellbore: VOLLMAR 3N-11HZ AWB <12934> Ref Wellpath: VOLLMAR 3N-11HZ AWP

String/Diameter	Start MD [ft]	End MD [ft]	Interval [ft]	Start TVD [ft]	End TVD [ft]	Start N/S [ft]	Start E/W [ft]	End N/S [ft]	End E/W [ft]
13.5in Open Hole	16.00	1211.00	1195.00	16.00	1210.98	0.00	0.00	-1.15	-4.53
9.625in Casing Surface	16.00	1201.00	1185.00	16.00	1200.99	0.00	0.00	-1.17	-4.43
8.75in Open Hole	1211.00	7783.00	6572.00	1210.98	7363.18	-1.15	-4.53	1301.28	-343.28
7in Casing Intermediate	16.00	7773.00	7757.00	16.00	7362.77	0.00	0.00	1291.29	-343.34
6.125in Open Hole	7783.00	12934.00	5151.00	7363.18	7349.89	1301.28	-343.28	6448.31	-272.35

REFERENCE WELLPATH IDENTIFICATION			
Operator	KERR-MCGEE OIL & GAS ONSHORE LP (LAMBERT STATE PLANE COORD)	Slot	SLOT#13 VOLLMAR 3N-11HZ (1223'FNL & 1892'FWL, SEC.14)
Area	COLORADO	Well	VOLLMAR 3N-11HZ
Field	WELD COUNTY (KERR MCGEE)	Wellbore	VOLLMAR 3N-11HZ AWB <12934>
Facility	SEC.14-T2N-R67W		

TARGETS								
Name	TVD [ft]	North [ft]	East [ft]	Grid East [US ft]	Grid North [US ft]	Latitude	Longitude	Shape
SEC.11-T2N-R67W SECTION LINES	0.00	-7.99	-59.57	3178724.76	1295196.93	40°08'30.988"N	104°51'38.560"W	polygon
SEC.14-T2N-R67W SECTION LINES	0.00	-7.99	-59.57	3178724.76	1295196.93	40°08'30.988"N	104°51'38.560"W	polygon
SEC.11-T2N-R67W HARDLINES (460' SETBACKS)	7301.00	-7.99	-59.57	3178724.76	1295196.93	40°08'30.988"N	104°51'38.560"W	polygon
SEC.14-T2N-R67W HARDLINES (460' SETBACKS)	7301.00	-7.99	-59.57	3178724.76	1295196.93	40°08'30.988"N	104°51'38.560"W	polygon
VOLLMAR 3N-11HZ LANDBOX	7306.00	0.00	0.00	3178784.27	1295205.35	40°08'31.067"N	104°51'37.793"W	polygon
VOLLMAR 3N-11HZ BHL ON PLAT (50'FNL & 1712'FWL, SEC.11)	7306.00	6448.75	-139.21	3178598.56	1301652.65	40°09'34.794"N	104°51'39.586"W	point
VOLLMAR 3N-11HZ BHL REV-2 (50'FNL & 1562'FWL, SEC.11)	7306.00	6448.75	-289.21	3178448.57	1301651.57	40°09'34.794"N	104°51'41.518"W	point

WELLPATH COMPOSITION - Ref Wellbore: VOLLMAR 3N-11HZ AWB <12934>					Ref Wellpath: VOLLMAR 3N-11HZ AWP	
Start MD [ft]	End MD [ft]	Positional Uncertainty Model	Log Name/Comment		Wellbore	
16.00	1165.00	ISCWSA MWD, Rev. 2 (Standard)	CATHEDRAL MWD SURVEYS 13.5" <61-1165>		VOLLMAR 3N-11HZ AWB <12934>	
1165.00	7736.00	NaviTrak (MAGCORR,IFR)	BHI MWD+IFR SURVEYS 8.75" <1247-7736>		VOLLMAR 3N-11HZ AWB <12934>	
7736.00	12883.00	NaviTrak (MAGCORR,IFR)	BHI MWD+IFR SURVEYS 6.125" <7790-12883>		VOLLMAR 3N-11HZ AWB <12934>	
12883.00	12934.00	Blind Drilling (std)	Projection to bit		VOLLMAR 3N-11HZ AWB <12934>	

REFERENCE WELLPATH IDENTIFICATION			
Operator	KERR-MCGEE OIL & GAS ONSHORE LP (LAMBERT STATE PLANE COORD)	Slot	SLOT#13 VOLLMAR 3N-11HZ (1223'FNL & 1892'FWL, SEC.14)
Area	COLORADO	Well	VOLLMAR 3N-11HZ
Field	WELD COUNTY (KERR MCGEE)	Wellbore	VOLLMAR 3N-11HZ AWB <12934>
Facility	SEC.14-T2N-R67W		

WELLPATH COMMENTS				
MD [ft]	Inclination [°]	Azimuth [°]	TVD [ft]	Comment
61.00	0.100	267.800	61.00	BEGIN MWD SURVEYS
1165.00	0.500	243.400	1164.99	TIE-INTO MWD SURVEYS
1247.00	0.790	302.980	1246.98	BEGIN BHI MWD+IFR SURVEYS
7773.00	87.238	0.096	7362.77	7" CASING POINT
12883.00	89.900	5.470	7349.80	LAST BHI MWD+IFR SURVEYS
12934.00	89.900	5.470	7349.89	PROJECTION TO BIT