

Location:	COLORADO	Slot:	SLOT#12 VOLLMAR 29C-11HZ (1227'FNL & 1862'FWL, SEC.14)
Field:	WELD COUNTY (KERR MCGEE)	Well:	VOLLMAR 29C-11HZ
Facility:	SEC.14-T2N-R67W	Wellbore:	VOLLMAR 29C-11HZ PWB

Plot reference wellpath is VOLLMAR 29C-11HZ (REV-A.0)	
True vertical depths are referenced to XTREME 6 (16KB) (RKB)	Grid System: NAD83 / Lambert Colorado SP, Northern Zone (501), US feet
Measured depths are referenced to XTREME 6 (16KB) (RKB)	North Reference: True north
XTREME 6 (16KB) (RKB) to Mean Sea Level: 4961 feet	Scale: True distance
Mean Sea Level to Mud line (At Slot: SLOT#12 VOLLMAR 29C-11HZ (1227FNL & 1862FWL, SEC.14)): 0 feet	Depths are in feet
Coordinates are in feet referenced to Slot2	Created by: amarcar on 06/Mar/2015

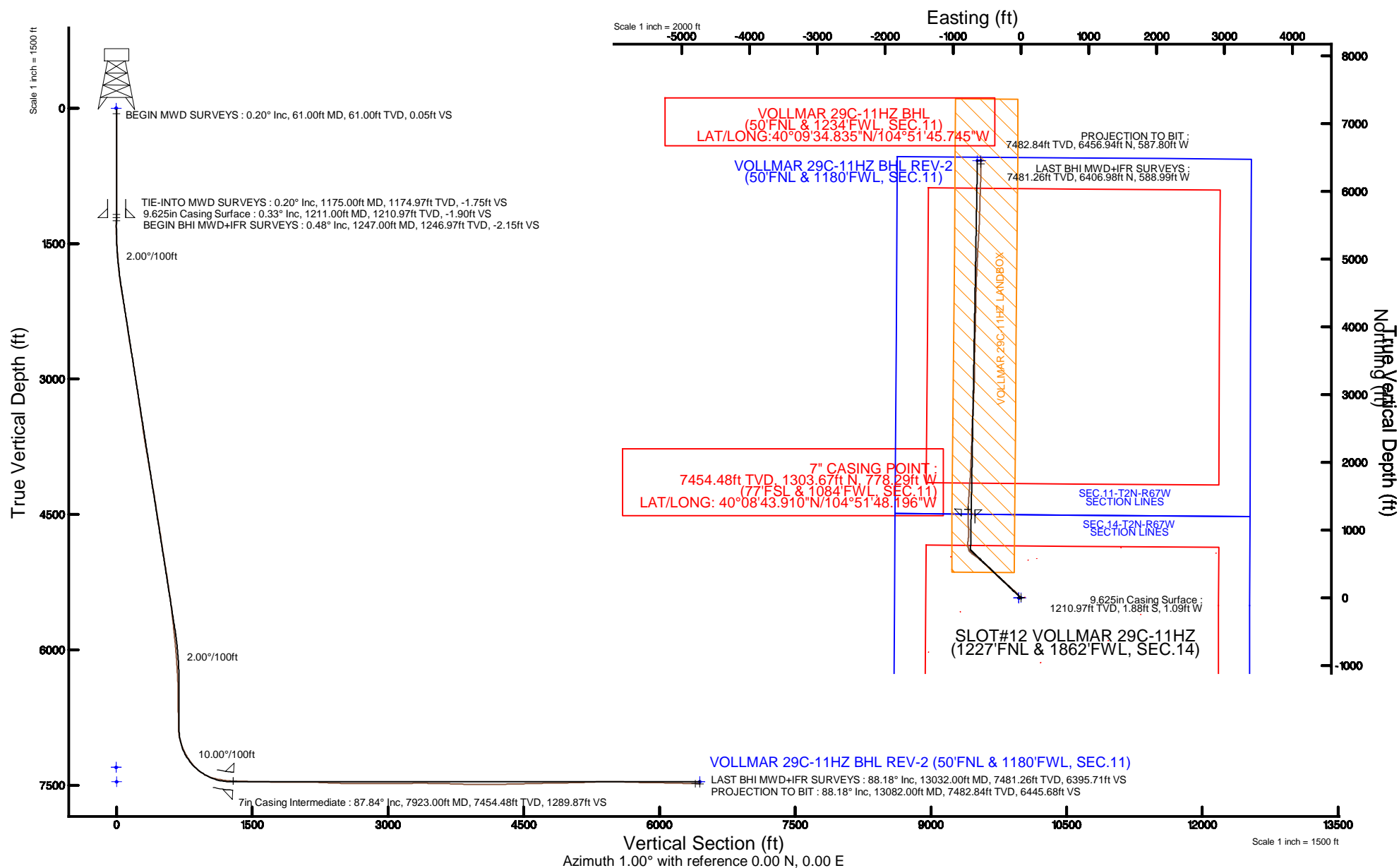

REFERENCE WELLPATH IDENTIFICATION

Operator	KERR-MCGEE OIL & GAS ONSHORE LP (LAMBERT STATE PLANE COORD)	Slot	SLOT#12 VOLLMAR 29C-11HZ (1227'FNL & 1862'FWL, SEC.14)
Area	COLORADO	Well	VOLLMAR 29C-11HZ
Field	WELD COUNTY (KERR MCGEE)	Wellbore	VOLLMAR 29C-11HZ AWB <13082>
Facility	SEC.14-T2N-R67W		

REPORT SETUP INFORMATION

Projection System	NAD83 / Lambert Colorado SP, Northern Zone (501), US feet	Software System	WellArchitect® 4.1.1
North Reference	True	User	Amarcar
Scale	0.999959	Report Generated	06/Mar/2015 at 13:33
Convergence at slot	0.41° East	Database/Source file	WellArchitectDB/VOLLMAR_29C-11HZ_AWB_13082_.xml

WELLPATH LOCATION

	Local coordinates		Grid coordinates		Geographic coordinates	
	North[ft]	East[ft]	Easting[US ft]	Northing[US ft]	Latitude	Longitude
Slot Location	3477.53	-1134.56	3178754.71	1295201.09	40°08'31.027"N	104°51'38.174"W
Facility Reference Pt			3179914.43	1291732.03	40°07'56.662"N	104°51'23.565"W
Field Reference Pt			3197771.84	1268891.29	40°04'09.600"N	104°47'36.000"W

WELLPATH DATUM

Calculation method	Minimum curvature	XTREME 6 (16'KB) (RKB) to Facility Vertical Datum	4961.00ft
Horizontal Reference Pt	Slot	XTREME 6 (16'KB) (RKB) to Mean Sea Level	4961.00ft
Vertical Reference Pt	XTREME 6 (16'KB) (RKB)	XTREME 6 (16'KB) (RKB) to Mud Line at Slot (SLOT#12 VOLLMAR 29C-11HZ (1227'FNL & 1862'FWL, SEC.14))	4961.00ft
MD Reference Pt	XTREME 6 (16'KB) (RKB)	Section Origin	N 0.00, E 0.00 ft
Field Vertical Reference	Mean Sea Level	Section Azimuth	1.00°

REFERENCE WELLPATH IDENTIFICATION

Operator	KERR-MCGEE OIL & GAS ONSHORE LP (LAMBERT STATE PLANE COORD)	Slot	SLOT#12 VOLLMAR 29C-11HZ (1227'FNL & 1862'FWL, SEC.14)
Area	COLORADO	Well	VOLLMAR 29C-11HZ
Field	WELD COUNTY (KERR MCGEE)	Wellbore	VOLLMAR 29C-11HZ AWB <13082>
Facility	SEC.14-T2N-R67W		

WELLPATH DATA (145 stations) † = interpolated/extrapolated station

MD [ft]	Inclination [°]	Azimuth [°]	TVD [ft]	Vert Sect [ft]	North [ft]	East [ft]	Latitude	Longitude	DLS [°/100ft]	Comments
0.00†	0.000	310.200	0.00	0.00	0.00	0.00	40°08'31.027"N	104°51'38.174"W	0.00	
16.00	0.000	310.200	16.00	0.00	0.00	0.00	40°08'31.027"N	104°51'38.174"W	0.00	
61.00	0.200	310.200	61.00	0.05	0.05	-0.06	40°08'31.028"N	104°51'38.175"W	0.44	BEGIN MWD SURVEYS
172.00	0.200	292.900	172.00	0.24	0.25	-0.39	40°08'31.029"N	104°51'38.179"W	0.05	
250.00	0.500	276.300	250.00	0.33	0.34	-0.85	40°08'31.030"N	104°51'38.185"W	0.40	
331.00	0.300	285.900	331.00	0.41	0.44	-1.41	40°08'31.031"N	104°51'38.192"W	0.26	
411.00	0.500	285.100	410.99	0.55	0.59	-1.94	40°08'31.033"N	104°51'38.199"W	0.25	
491.00	0.600	293.500	490.99	0.80	0.84	-2.66	40°08'31.035"N	104°51'38.208"W	0.16	
571.00	0.700	292.800	570.98	1.14	1.20	-3.50	40°08'31.039"N	104°51'38.219"W	0.13	
651.00	0.600	126.800	650.98	1.08	1.14	-3.61	40°08'31.038"N	104°51'38.221"W	1.61	
731.00	0.600	125.800	730.98	0.59	0.64	-2.94	40°08'31.033"N	104°51'38.212"W	0.01	
811.00	0.300	150.000	810.98	0.17	0.22	-2.50	40°08'31.029"N	104°51'38.206"W	0.44	
891.00	0.400	138.100	890.97	-0.21	-0.17	-2.20	40°08'31.025"N	104°51'38.202"W	0.15	
971.00	0.300	131.100	970.97	-0.55	-0.52	-1.86	40°08'31.022"N	104°51'38.198"W	0.14	
1051.00	0.500	150.800	1050.97	-0.99	-0.96	-1.53	40°08'31.018"N	104°51'38.194"W	0.30	
1131.00	0.400	157.700	1130.97	-1.54	-1.52	-1.26	40°08'31.012"N	104°51'38.190"W	0.14	
1175.00	0.200	145.900	1174.97	-1.75	-1.73	-1.15	40°08'31.010"N	104°51'38.189"W	0.47	TIE-INTO MWD SURVEYS
1247.00	0.480	168.160	1246.97	-2.15	-2.13	-1.02	40°08'31.006"N	104°51'38.187"W	0.42	BEGIN BHI MWD+IFR SURVEYS
1339.00	0.390	248.080	1338.96	-2.64	-2.62	-1.23	40°08'31.001"N	104°51'38.190"W	0.61	
1430.00	2.710	317.040	1429.93	-1.22	-1.16	-2.99	40°08'31.016"N	104°51'38.212"W	2.85	
1521.00	4.410	328.290	1520.75	3.28	3.39	-6.29	40°08'31.060"N	104°51'38.255"W	2.01	
1612.00	5.700	322.150	1611.40	9.74	9.93	-10.90	40°08'31.125"N	104°51'38.314"W	1.54	
1703.00	7.070	312.990	1701.83	17.01	17.32	-17.77	40°08'31.198"N	104°51'38.403"W	1.87	
1794.00	8.400	311.130	1792.00	25.04	25.51	-26.88	40°08'31.279"N	104°51'38.520"W	1.49	
1885.00	10.140	317.360	1881.81	35.12	35.78	-37.31	40°08'31.381"N	104°51'38.654"W	2.20	
1975.00	10.940	321.330	1970.29	47.43	48.27	-48.01	40°08'31.504"N	104°51'38.792"W	1.20	
2067.00	12.890	318.000	2060.31	61.65	62.72	-60.34	40°08'31.647"N	104°51'38.951"W	2.25	
2157.00	13.760	316.060	2147.88	76.57	77.88	-74.48	40°08'31.797"N	104°51'39.133"W	1.09	
2248.00	12.700	313.810	2236.47	91.03	92.60	-89.21	40°08'31.942"N	104°51'39.323"W	1.29	
2338.00	14.190	310.410	2324.00	104.76	106.60	-104.75	40°08'32.080"N	104°51'39.523"W	1.87	
2429.00	12.800	309.310	2412.49	118.09	120.22	-121.04	40°08'32.215"N	104°51'39.733"W	1.55	
2512.00	12.930	308.290	2493.40	129.41	131.80	-135.45	40°08'32.329"N	104°51'39.918"W	0.32	
2597.00	13.630	317.540	2576.14	142.45	145.08	-149.67	40°08'32.461"N	104°51'40.101"W	2.63	
2682.00	12.730	317.630	2658.90	156.52	159.39	-162.74	40°08'32.602"N	104°51'40.270"W	1.06	
2767.00	14.250	311.890	2741.56	170.18	173.30	-176.85	40°08'32.740"N	104°51'40.451"W	2.38	
2853.00	13.420	311.890	2825.06	183.64	187.03	-192.15	40°08'32.875"N	104°51'40.648"W	0.97	
3028.00	13.370	312.580	2995.30	210.36	214.28	-222.17	40°08'33.144"N	104°51'41.035"W	0.10	
3206.00	12.810	311.330	3168.67	236.79	241.23	-252.14	40°08'33.411"N	104°51'41.421"W	0.35	
3384.00	13.070	309.870	3342.15	262.19	267.17	-282.41	40°08'33.667"N	104°51'41.810"W	0.23	
3559.00	12.530	309.450	3512.80	286.42	291.91	-312.25	40°08'33.912"N	104°51'42.195"W	0.31	
3737.00	12.970	313.200	3686.42	311.84	317.86	-341.72	40°08'34.168"N	104°51'42.574"W	0.53	
3911.00	14.020	319.520	3855.62	340.75	347.26	-369.64	40°08'34.459"N	104°51'42.934"W	1.04	
4089.00	12.800	314.870	4028.77	370.57	377.57	-397.62	40°08'34.758"N	104°51'43.294"W	0.91	
4267.00	15.040	315.320	4201.53	400.37	407.91	-427.83	40°08'35.058"N	104°51'43.683"W	1.26	
4445.00	12.600	309.590	4374.37	428.62	436.71	-459.04	40°08'35.343"N	104°51'44.085"W	1.57	

REFERENCE WELLPATH IDENTIFICATION

Operator	KERR-MCGEE OIL & GAS ONSHORE LP (LAMBERT STATE PLANE COORD)	Slot	SLOT#12 VOLLMAR 29C-11HZ (1227'FNL & 1862'FWL, SEC.14)
Area	COLORADO	Well	VOLLMAR 29C-11HZ
Field	WELD COUNTY (KERR MCGEE)	Wellbore	VOLLMAR 29C-11HZ AWB <13082>
Facility	SEC.14-T2N-R67W		

WELLPATH DATA (145 stations) † = interpolated/extrapolated station

MD [ft]	Inclination [°]	Azimuth [°]	TVD [ft]	Vert Sect [ft]	North [ft]	East [ft]	Latitude	Longitude	DLS [°/100ft]	Comments
4621.00	14.520	311.480	4545.46	454.92	463.56	-490.37	40°08'35.608"N	104°51'44.488"W	1.12	
4795.00	13.810	310.000	4714.17	482.15	491.36	-522.62	40°08'35.883"N	104°51'44.904"W	0.46	
4971.00	13.220	309.110	4885.29	507.79	517.55	-554.32	40°08'36.141"N	104°51'45.312"W	0.36	
5149.00	14.300	313.400	5058.19	535.18	545.50	-586.09	40°08'36.418"N	104°51'45.721"W	0.83	
5327.00	12.940	310.780	5231.18	562.75	573.62	-617.16	40°08'36.695"N	104°51'46.121"W	0.84	
5501.00	13.740	307.170	5400.49	587.41	598.83	-648.38	40°08'36.945"N	104°51'46.523"W	0.66	
5677.00	11.860	303.780	5572.11	609.54	621.52	-680.07	40°08'37.169"N	104°51'46.931"W	1.15	
5849.00	10.020	309.470	5740.98	628.42	640.86	-706.31	40°08'37.360"N	104°51'47.269"W	1.24	
6019.00	7.800	316.640	5908.92	645.87	658.65	-725.65	40°08'37.536"N	104°51'47.518"W	1.46	
6193.00	6.640	309.180	6081.54	660.53	673.59	-741.56	40°08'37.683"N	104°51'47.723"W	0.86	
6363.00	4.400	322.010	6250.75	671.68	684.94	-753.19	40°08'37.796"N	104°51'47.873"W	1.50	
6534.00	1.600	320.590	6421.50	678.60	691.96	-758.75	40°08'37.865"N	104°51'47.944"W	1.64	
6704.00	1.140	297.430	6591.45	681.16	694.57	-761.75	40°08'37.891"N	104°51'47.983"W	0.42	
6875.00	0.850	283.860	6762.43	682.20	695.66	-764.50	40°08'37.901"N	104°51'48.018"W	0.22	
6960.00	0.750	318.040	6847.42	682.74	696.22	-765.48	40°08'37.907"N	104°51'48.031"W	0.56	
7003.00	3.940	341.970	6890.38	684.35	697.84	-766.13	40°08'37.923"N	104°51'48.039"W	7.60	
7045.00	7.660	346.100	6932.16	688.42	701.93	-767.25	40°08'37.963"N	104°51'48.054"W	8.91	
7087.00	12.410	349.770	6973.50	695.55	709.09	-768.72	40°08'38.034"N	104°51'48.073"W	11.41	
7130.00	16.390	347.110	7015.14	705.98	719.56	-770.89	40°08'38.138"N	104°51'48.101"W	9.38	
7172.00	19.770	347.400	7055.06	718.64	732.27	-773.77	40°08'38.263"N	104°51'48.138"W	8.05	
7215.00	23.590	348.350	7095.01	734.11	747.80	-777.09	40°08'38.417"N	104°51'48.180"W	8.92	
7257.00	27.530	351.800	7132.90	751.90	765.64	-780.17	40°08'38.593"N	104°51'48.220"W	10.02	
7300.00	29.630	355.820	7170.66	772.30	786.08	-782.37	40°08'38.795"N	104°51'48.248"W	6.62	
7343.00	32.910	2.580	7207.42	794.57	808.37	-782.62	40°08'39.015"N	104°51'48.252"W	11.16	
7385.00	37.220	7.020	7241.80	818.63	832.39	-780.55	40°08'39.253"N	104°51'48.225"W	11.92	
7428.00	42.740	7.770	7274.73	846.07	859.78	-776.98	40°08'39.523"N	104°51'48.179"W	12.89	
7470.00	45.100	5.570	7304.98	875.06	888.71	-773.61	40°08'39.809"N	104°51'48.136"W	6.69	
7513.00	48.700	1.770	7334.37	906.40	920.03	-771.63	40°08'40.119"N	104°51'48.110"W	10.57	
7555.00	54.360	359.750	7360.49	939.27	952.89	-771.22	40°08'40.443"N	104°51'48.105"W	13.99	
7598.00	60.100	358.740	7383.75	975.39	989.03	-771.71	40°08'40.801"N	104°51'48.111"W	13.49	
7640.00	67.540	357.710	7402.27	1013.01	1026.67	-772.89	40°08'41.173"N	104°51'48.126"W	17.85	
7683.00	74.150	357.690	7416.37	1053.54	1067.24	-774.52	40°08'41.573"N	104°51'48.147"W	15.37	
7725.00	77.290	358.640	7426.73	1094.19	1107.91	-775.82	40°08'41.975"N	104°51'48.164"W	7.79	
7768.00	79.200	358.910	7435.49	1136.25	1150.00	-776.72	40°08'42.391"N	104°51'48.176"W	4.48	
7810.00	80.900	359.010	7442.75	1177.60	1191.36	-777.47	40°08'42.800"N	104°51'48.185"W	4.05	
7853.00	83.370	358.990	7448.63	1220.16	1233.95	-778.21	40°08'43.221"N	104°51'48.195"W	5.74	
7886.00	84.680	359.120	7452.06	1252.96	1266.76	-778.75	40°08'43.545"N	104°51'48.202"W	3.99	
7923.00†	87.843	2.295	7454.48	1289.87	1303.67	-778.29	40°08'43.910"N	104°51'48.196"W	12.10	7" CASING POINT
7933.00	88.700	3.150	7454.78	1299.86	1313.65	-777.82	40°08'44.009"N	104°51'48.190"W	12.10	
7999.00	89.040	3.220	7456.08	1365.80	1379.54	-774.15	40°08'44.660"N	104°51'48.143"W	0.53	
8087.00	88.850	3.660	7457.70	1453.71	1467.36	-768.87	40°08'45.527"N	104°51'48.075"W	0.54	
8176.00	88.980	3.490	7459.39	1542.60	1556.18	-763.32	40°08'46.405"N	104°51'48.003"W	0.24	
8265.00	88.760	4.380	7461.14	1631.47	1644.95	-757.22	40°08'47.282"N	104°51'47.925"W	1.03	
8353.00	88.480	4.760	7463.26	1719.27	1732.64	-750.21	40°08'48.149"N	104°51'47.835"W	0.54	
8443.00	89.810	2.720	7464.60	1809.15	1822.43	-744.34	40°08'49.036"N	104°51'47.759"W	2.71	

REFERENCE WELLPATH IDENTIFICATION

Operator	KERR-MCGEE OIL & GAS ONSHORE LP (LAMBERT STATE PLANE COORD)	Slot	SLOT#12 VOLLMAR 29C-11HZ (1227'FNL & 1862'FWL, SEC.14)
Area	COLORADO	Well	VOLLMAR 29C-11HZ
Field	WELD COUNTY (KERR MCGEE)	Wellbore	VOLLMAR 29C-11HZ AWB <13082>
Facility	SEC.14-T2N-R67W		

WELLPATH DATA (145 stations)

MD [ft]	Inclination [°]	Azimuth [°]	TVD [ft]	Vert Sect [ft]	North [ft]	East [ft]	Latitude	Longitude	DLS [°/100ft]	Comments
8532.00	90.270	2.620	7464.54	1898.11	1911.34	-740.19	40°08'49.915"N	104°51'47.706"W	0.53	
8618.00	90.890	2.820	7463.67	1984.07	1997.24	-736.11	40°08'50.764"N	104°51'47.653"W	0.76	
8707.00	88.980	2.130	7463.77	2073.04	2086.15	-732.27	40°08'51.642"N	104°51'47.604"W	2.28	
8792.00	88.880	1.840	7465.36	2158.01	2171.08	-729.33	40°08'52.482"N	104°51'47.566"W	0.36	
8878.00	87.000	0.860	7468.45	2243.95	2257.00	-727.30	40°08'53.331"N	104°51'47.540"W	2.46	
8963.00	87.580	1.260	7472.47	2328.85	2341.89	-725.73	40°08'54.170"N	104°51'47.520"W	0.83	
9048.00	87.830	2.020	7475.87	2413.78	2426.78	-723.30	40°08'55.009"N	104°51'47.488"W	0.94	
9133.00	89.130	2.060	7478.13	2498.73	2511.70	-720.27	40°08'55.848"N	104°51'47.449"W	1.53	
9218.00	90.180	3.100	7478.64	2583.70	2596.61	-716.45	40°08'56.687"N	104°51'47.400"W	1.74	
9303.00	89.190	2.890	7479.11	2668.64	2681.49	-712.01	40°08'57.526"N	104°51'47.343"W	1.19	
9388.00	89.680	2.380	7479.94	2753.60	2766.39	-708.10	40°08'58.365"N	104°51'47.293"W	0.83	
9474.00	89.030	3.940	7480.91	2839.53	2852.26	-703.36	40°08'59.213"N	104°51'47.232"W	1.97	
9559.00	90.090	3.040	7481.57	2924.45	2937.09	-698.19	40°09'00.051"N	104°51'47.165"W	1.64	
9645.00	89.720	2.620	7481.71	3010.40	3022.99	-693.94	40°09'00.900"N	104°51'47.110"W	0.65	
9730.00	90.550	2.230	7481.51	3095.38	3107.91	-690.34	40°09'01.740"N	104°51'47.064"W	1.08	
9815.00	91.380	1.880	7480.08	3180.35	3192.84	-687.30	40°09'02.579"N	104°51'47.025"W	1.06	
9900.00	91.670	0.550	7477.81	3265.32	3277.79	-685.49	40°09'03.418"N	104°51'47.002"W	1.60	
9985.00	89.900	0.150	7476.65	3350.30	3362.78	-684.97	40°09'04.258"N	104°51'46.995"W	2.13	
10070.00	88.880	0.980	7477.55	3435.29	3447.77	-684.14	40°09'05.098"N	104°51'46.984"W	1.55	
10156.00	89.190	1.010	7479.00	3521.28	3533.74	-682.64	40°09'05.948"N	104°51'46.965"W	0.36	
10241.00	88.910	1.190	7480.41	3606.27	3618.72	-681.01	40°09'06.787"N	104°51'46.944"W	0.39	
10326.00	87.550	0.820	7483.04	3691.22	3703.66	-679.52	40°09'07.627"N	104°51'46.925"W	1.66	
10412.00	88.390	1.320	7486.08	3777.17	3789.59	-677.92	40°09'08.476"N	104°51'46.904"W	1.14	
10499.00	88.910	1.620	7488.13	3864.14	3876.54	-675.69	40°09'09.335"N	104°51'46.876"W	0.69	
10584.00	88.910	1.840	7489.75	3949.12	3961.48	-673.12	40°09'10.175"N	104°51'46.843"W	0.26	
10670.00	89.130	1.260	7491.22	4035.10	4047.44	-670.79	40°09'11.024"N	104°51'46.813"W	0.72	
10755.00	90.060	1.270	7491.82	4120.10	4132.41	-668.92	40°09'11.864"N	104°51'46.789"W	1.09	
10840.00	91.010	1.000	7491.03	4205.09	4217.39	-667.23	40°09'12.703"N	104°51'46.767"W	1.16	
10925.00	92.190	1.010	7488.66	4290.06	4302.34	-665.74	40°09'13.543"N	104°51'46.748"W	1.39	
11012.00	91.630	1.300	7485.76	4377.01	4389.28	-663.99	40°09'14.402"N	104°51'46.725"W	0.72	
11097.00	91.040	1.190	7483.78	4461.98	4474.23	-662.14	40°09'15.242"N	104°51'46.702"W	0.71	
11182.00	91.840	1.450	7481.64	4546.96	4559.18	-660.19	40°09'16.081"N	104°51'46.676"W	0.99	
11267.00	91.330	1.800	7479.29	4631.92	4644.12	-657.78	40°09'16.920"N	104°51'46.645"W	0.73	
11352.00	91.080	2.440	7477.50	4716.88	4729.04	-654.63	40°09'17.760"N	104°51'46.605"W	0.81	
11437.00	92.000	2.890	7475.22	4801.81	4813.92	-650.68	40°09'18.598"N	104°51'46.554"W	1.20	
11523.00	90.400	2.880	7473.42	4887.75	4899.79	-646.36	40°09'19.447"N	104°51'46.498"W	1.86	
11608.00	90.360	2.060	7472.85	4972.72	4984.70	-642.69	40°09'20.286"N	104°51'46.451"W	0.97	
11693.00	91.170	2.660	7471.72	5057.68	5069.62	-639.19	40°09'21.125"N	104°51'46.406"W	1.19	
11778.00	92.400	3.360	7469.07	5142.59	5154.46	-634.73	40°09'21.964"N	104°51'46.349"W	1.66	
11863.00	92.600	3.810	7465.36	5227.42	5239.22	-629.42	40°09'22.801"N	104°51'46.280"W	0.58	
11948.00	92.210	3.480	7461.79	5312.25	5323.97	-624.02	40°09'23.639"N	104°51'46.211"W	0.60	
12033.00	91.300	3.880	7459.19	5397.12	5408.75	-618.57	40°09'24.477"N	104°51'46.141"W	1.17	
12117.00	88.830	1.630	7459.10	5481.07	5492.64	-614.53	40°09'25.306"N	104°51'46.089"W	3.98	
12203.00	88.180	1.620	7461.34	5567.03	5578.58	-612.10	40°09'26.155"N	104°51'46.057"W	0.76	
12288.00	88.360	2.270	7463.91	5651.98	5663.49	-609.21	40°09'26.994"N	104°51'46.020"W	0.79	

REFERENCE WELLPATH IDENTIFICATION

Operator	KERR-MCGEE OIL & GAS ONSHORE LP (LAMBERT STATE PLANE COORD)	Slot	SLOT#12 VOLLMAR 29C-11HZ (1227'FNL & 1862'FWL, SEC.14)
Area	COLORADO	Well	VOLLMAR 29C-11HZ
Field	WELD COUNTY (KERR MCGEE)	Wellbore	VOLLMAR 29C-11HZ AWB <13082>
Facility	SEC.14-T2N-R67W		

WELLPATH DATA (145 stations)

MD [ft]	Inclination [°]	Azimuth [°]	TVD [ft]	Vert Sect [ft]	North [ft]	East [ft]	Latitude	Longitude	DLS [°/100ft]	Comments
12373.00	87.900	1.380	7466.68	5736.93	5748.40	-606.51	40°09'27.833"N	104°51'45.985"W	1.18	
12459.00	88.850	1.620	7469.12	5822.89	5834.34	-604.26	40°09'28.682"N	104°51'45.956"W	1.14	
12544.00	89.290	1.710	7470.50	5907.87	5919.29	-601.79	40°09'29.522"N	104°51'45.925"W	0.53	
12629.00	89.350	2.300	7471.51	5992.85	6004.23	-598.81	40°09'30.361"N	104°51'45.886"W	0.70	
12717.00	88.020	1.940	7473.53	6080.81	6092.15	-595.56	40°09'31.230"N	104°51'45.844"W	1.57	
12802.00	88.920	0.680	7475.80	6165.78	6177.09	-593.62	40°09'32.069"N	104°51'45.820"W	1.82	
12887.00	88.820	1.150	7477.47	6250.76	6262.06	-592.26	40°09'32.909"N	104°51'45.802"W	0.57	
12973.00	88.450	1.350	7479.52	6336.73	6348.02	-590.38	40°09'33.758"N	104°51'45.778"W	0.49	
13032.00	88.180	1.360	7481.26	6395.71	6406.98	-588.99	40°09'34.341"N	104°51'45.760"W	0.46	LAST BHI MWD+IFR SURVEYS
13082.00	88.180	1.360	7482.84	6445.68	6456.94	-587.80	40°09'34.835"N	104°51'45.745"W	0.00	PROJECTION TO BIT

HOLE & CASING SECTIONS - Ref Wellbore: VOLLMAR 29C-11HZ AWB <13082> Ref Wellpath: VOLLMAR 29C-11HZ AWP

String/Diameter	Start MD [ft]	End MD [ft]	Interval [ft]	Start TVD [ft]	End TVD [ft]	Start N/S [ft]	Start E/W [ft]	End N/S [ft]	End E/W [ft]
13.5in Open Hole	16.00	1220.00	1204.00	16.00	1219.97	0.00	0.00	-1.93	-1.07
9.625in Casing Surface	16.00	1211.00	1195.00	16.00	1210.97	0.00	0.00	-1.88	-1.09
8.75in Open Hole	1220.00	7933.00	6713.00	1219.97	7454.78	-1.93	-1.07	1313.65	-777.82
7in Casing Intermediate	16.00	7923.00	7907.00	16.00	7454.48	0.00	0.00	1303.67	-778.29
6.125in Open Hole	7933.00	13082.00	5149.00	7454.78	7482.84	1313.65	-777.82	6456.94	-587.80

TARGETS

Name	TVD [ft]	North [ft]	East [ft]	Grid East [US ft]	Grid North [US ft]	Latitude	Longitude	Shape
SEC.11-T2N-R67W SECTION LINES	0.00	-3.95	-29.98	3178724.76	1295196.93	40°08'30.988"N	104°51'38.560"W	polygon
SEC.14-T2N-R67W SECTION LINES	0.00	-3.95	-29.98	3178724.76	1295196.93	40°08'30.988"N	104°51'38.560"W	polygon
SEC.11-T2N-R67W HARDLINES (460' SETBACKS)	7301.00	-3.95	-29.98	3178724.76	1295196.93	40°08'30.988"N	104°51'38.560"W	polygon
SEC.14-T2N-R67W HARDLINES (460' SETBACKS)	7301.00	-3.95	-29.98	3178724.76	1295196.93	40°08'30.988"N	104°51'38.560"W	polygon
VOLLMAR 29C-11HZ BHL ON PLAT (50'FNL & 1230'FWL, SEC.11) REV-1	7461.00	6457.16	-591.47	3178116.72	1301653.53	40°09'34.837"N	104°51'45.792"W	point
VOLLMAR 29C-11HZ BHL REV-2 (50'FNL & 1180'FWL, SEC.11)	7461.00	6457.16	-641.47	3178066.73	1301653.17	40°09'34.837"N	104°51'46.436"W	point
VOLLMAR 29C-11HZ LANDBOX	7461.00	0.00	0.00	3178754.71	1295201.09	40°08'31.027"N	104°51'38.174"W	polygon

REFERENCE WELLPATH IDENTIFICATION

Operator	KERR-MCGEE OIL & GAS ONSHORE LP (LAMBERT STATE PLANE COORD)	Slot	SLOT#12 VOLLMAR 29C-11HZ (1227'FNL & 1862'FWL, SEC.14)
Area	COLORADO	Well	VOLLMAR 29C-11HZ
Field	WELD COUNTY (KERR MCGEE)	Wellbore	VOLLMAR 29C-11HZ AWB <13082>
Facility	SEC.14-T2N-R67W		

WELLPATH COMPOSITION - Ref Wellbore: VOLLMAR 29C-11HZ AWB <13082> Ref Wellpath: VOLLMAR 29C-11HZ AWP

Start MD [ft]	End MD [ft]	Positional Uncertainty Model	Log Name/Comment	Wellbore
16.00	1175.00	ISCWSA MWD, Rev. 2 (Standard)	CATHEDRAL MWD SURVEYS 13.5" <61-1175>	VOLLMAR 29C-11HZ AWB <13082>
1175.00	7886.00	NaviTrak (MAGCORR,IFR)	BHI MWD+IFR SURVEYS 8.75" <1247-7886>	VOLLMAR 29C-11HZ AWB <13082>
7886.00	13032.00	NaviTrak (MAGCORR,IFR)	BHI MWD+IFR SURVEYS 6.125" <7933-13032>	VOLLMAR 29C-11HZ AWB <13082>
13032.00	13082.00	Blind Drilling (std)	Projection to bit	VOLLMAR 29C-11HZ AWB <13082>

REFERENCE WELLPATH IDENTIFICATION

Operator	KERR-MCGEE OIL & GAS ONSHORE LP (LAMBERT STATE PLANE COORD)	Slot	SLOT#12 VOLLMAR 29C-11HZ (1227'FNL & 1862'FWL, SEC.14)
Area	COLORADO	Well	VOLLMAR 29C-11HZ
Field	WELD COUNTY (KERR MCGEE)	Wellbore	VOLLMAR 29C-11HZ AWB <13082>
Facility	SEC.14-T2N-R67W		

WELLPATH COMMENTS

MD [ft]	Inclination [°]	Azimuth [°]	TVD [ft]	Comment
61.00	0.200	310.200	61.00	BEGIN MWD SURVEYS
1175.00	0.200	145.900	1174.97	TIE-INTO MWD SURVEYS
1247.00	0.480	168.160	1246.97	BEGIN BHI MWD+IFR SURVEYS
7923.00	87.843	2.295	7454.48	7" CASING POINT
13032.00	88.180	1.360	7481.26	LAST BHI MWD+IFR SURVEYS
13082.00	88.180	1.360	7482.84	PROJECTION TO BIT