

LEGEND:

- = PROPOSED WELLHEAD.
 ○ = TARGET BOTTOM HOLE.
 ▲ = SECTION CORNERS LOCATED.

T9S, R93W, 6th P.M.

Set Marked Stone,
E-W Fenceline
Lat: 39.255381°
Long: 107.783811°

N89°21'53"W - 5261.46' (Meas.)

2007 Alum. Cap,
#17492, 0.8' High
Lat: 39.255219°
Long: 107.765239°

N00°13'42"W - 2632.94' (Meas.)

N00°27'22"W - 2617.17' (Meas.)

2011 Alum. Cap,
Flush W/Ground
Lat: 39.248153°
Long: 107.783772°

PICEANCE 28-10W

1612' FNL 1242' FWL
Fin. Pad Elev = 7556.3'
Lat: 39.250917
Long: -107.779403

Target Bottom Hole

2375' FNL 875' FWL
Lat: 39.248833
Long: -107.780689

28

N00°13'40"W - 2633.57' (Meas.)

N00°26'46"W - 1308.47' (Meas.)

2013 Alum. Cap,
0.9' High
Lat: 39.248036°
Long: 107.765164°

2013 Alum. Cap,
0.6' High
Lat: 39.244447°
Long: 107.765131°

1990 Alum. Cap,
1.0' High, Stones,
Fiberglass Marker
Lat: 39.240925°
Long: 107.783733°

S89°45'16"E - 2640.01' (Meas.)

S89°40'55"E - 2641.84' (Meas.)

1990 Alum. Cap,
1.2' High
Lat: 39.240894°
Long: 107.774417°

1990 Alum. Cap,
0.6' High
Lat: 39.240856°
Long: 107.765092°

NOTE-DISTANCE TO NEAREST:

BUILDING: N81°W 2433'
BUILDING UNIT: OVER A MILE
HOBUS: OVER A MILE
DOAA: OVER A MILE
PUBLIC ROAD: OVER A MILE
ABOVE GROUND UTILITY: N81°W 2383'
RAILROAD: OVER A MILE
PROPERTY LINE: NORTH 1613'

PDOP = 1.7

NOTE:

- 1.) All latitudes and longitudes are given in NAD 83 coordinates.
- 2.) Distances to nearest section lines are measured perpendicularly.

CERTIFICATE

THIS IS TO CERTIFY THAT THE ABOVE PLAT WAS PREPARED FROM FIELD NOTES OF ACTUAL SURVEYS MADE BY ME OR UNDER MY SUPERVISION AND THAT THE SAME ARE TRUE AND CORRECT TO THE BEST OF MY KNOWLEDGE AND BELIEF.

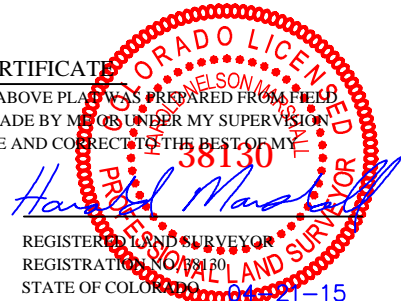

BASIS OF BEARINGS

BASIS OF BEARINGS IS A G.P.S. OBSERVATION

BASIS OF ELEVATION

BENCH MARK (19 RDS) LOCATED IN THE SE 1/4 OF SECTION 16, T9S, R93W, 6th P.M., TAKEN FROM THE SOUTH MAMM PEAK, QUADRANGLE, COLORADO, 7.5 MINUTE QUAD. (TOPOGRAPHIC MAP) PUBLISHED BY THE UNITED STATES DEPARTMENT OF THE INTERIOR, GEOLOGICAL SURVEY. SAID ELEVATION IS MARKED AS BEING 7252 FEET.



PICEANCE ENERGY, LLC

PICEANCE 28-10W
SW 1/4 NW 1/4, SECTION 28, T9S, R93W, 6th P.M.
MESA COUNTY, COLORADO

SURVEYED BY: BRIAN BAKER, N.F.	DATE: 03-11-15
DRAWN BY: M.D.	DATE DRAWN: 04-21-15
SCALE: 1" = 1000'	REVISED: 00-00-00

WELL LOCATION PLAT



UELS, LLC
Corporate Office * 85 South 200 East
Vernal, UT 84078 * (435) 789-1017