



Physical Address: 345 Comanche St.
Mail to: Box 384, Kiowa, CO 80117
Ph. 303-621-8672 - Fax 303-621-7749
www.highprairiesurvey.com

Job # 13205 CRESTED BUTTE #2-14

Inv # 3809

High Prairie Surveying of Kiowa, Colorado, in accordance with a request from **Night Hawk Production LLC.** has determined the location of **CRESTED BUTTE #2-14** to be **1003 feet FNL**, and **2115 feet FEL**, (90° off Section lines) of **SECTION 14**, Township **6s**, Range **54w** of the 6th Principal Meridian, **Lincoln County**, Colorado.

Date: Staked on 03/17/15 drawn on 03/23/15.

Re: Staked by Elijah Frane

Drawn: Drawn by Dustin Cotter

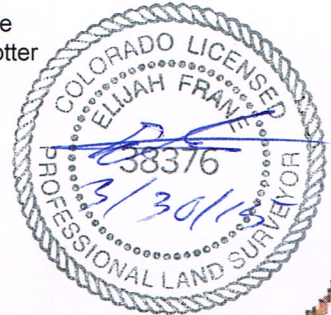

Location Drawing

