

Bayswater Exploration & Production, LLC

Well Name: **Kaiser E-10HN**

Surface Location: Kaiser 10-D Pad Sec.10-T6N-R65W
North American Datum 1983 , US State Plane 1983 , Colorado Northern Zone

Ground Elevation: 4801.0

+N/-S	+E/-W	Northing	Easting	Latitude	Longitude	Slot
0.0	0.0	1428777.65	3238777.64	40.507222	-104.641290	
RKB - 22.5 WELL @ 4823.5ft (RKB - 22.5)						

FINAL SURVEY

Projected Bottom Hole Location
11760'MD 7024'TVD 993'S & 4437'W of SHL
91.9 degree Incl @ 269.9 degree AZM

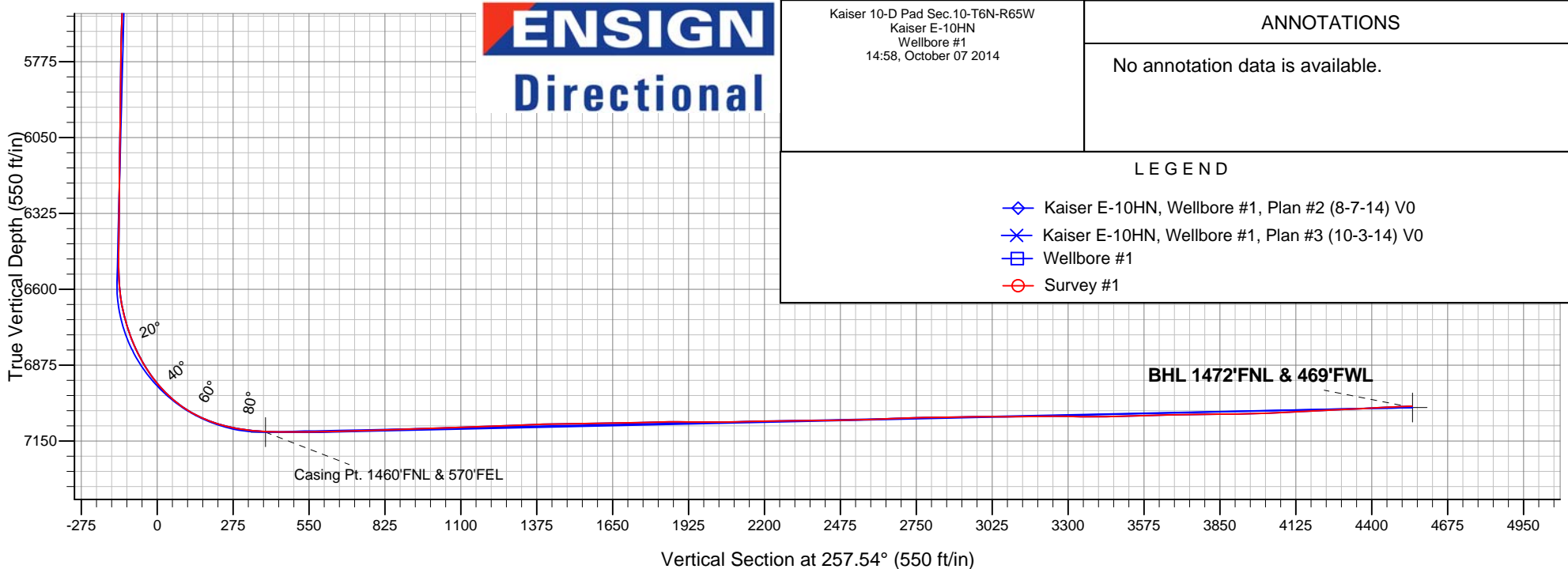
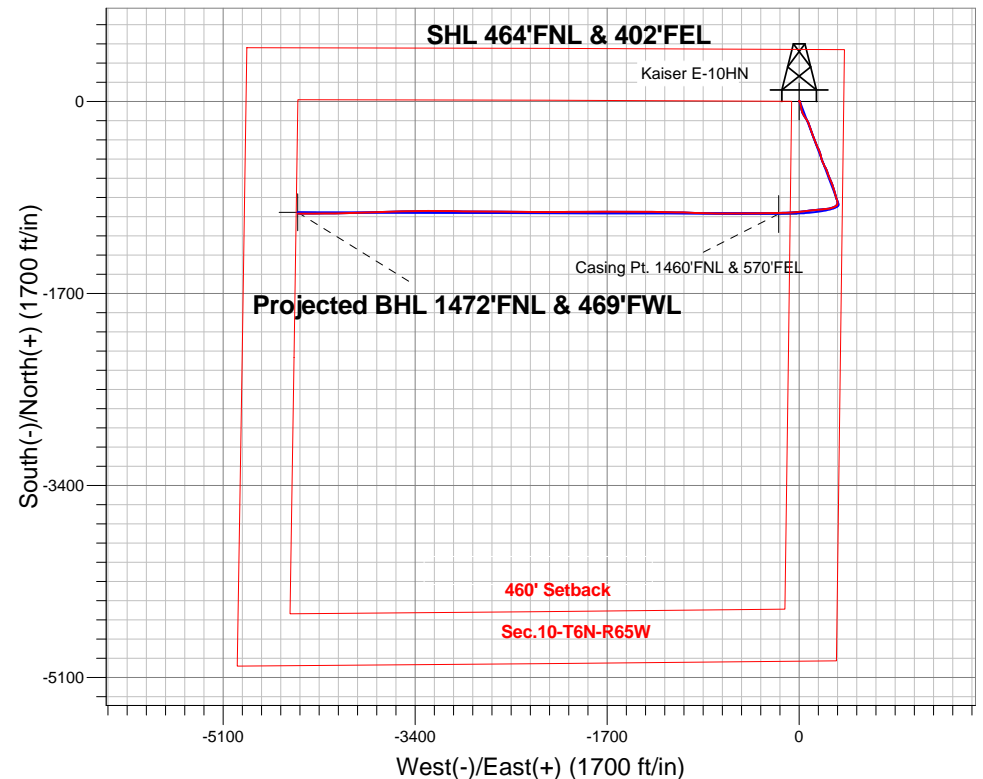

Kaiser 10-D Pad Sec.10-T6N-R65W
Kaiser E-10HN
Wellbore #1
14:58, October 07 2014

ANNOTATIONS

No annotation data is available.

LEGEND

- ◇ Kaiser E-10HN, Wellbore #1, Plan #2 (8-7-14) V0
- ✕ Kaiser E-10HN, Wellbore #1, Plan #3 (10-3-14) V0
- Wellbore #1
- Survey #1



Bayswater Exploration & Production, LLC

SEC.10-T6N-R65W

Kaiser 10-D Pad Sec.10-T6N-R65W

Kaiser E-10HN

Wellbore #1

Survey: Survey #1

Standard Survey Report

07 October, 2014



BAYSWATER
EXPLORATION & PRODUCTION, LLC

Company:	Bayswater Exploration & Production, LLC	Local Co-ordinate Reference:	Well Kaiser E-10HN
Project:	SEC.10-T6N-R65W	TVD Reference:	WELL @ 4823.5ft (RKB - 22.5)
Site:	Kaiser 10-D Pad Sec.10-T6N-R65W	MD Reference:	WELL @ 4823.5ft (RKB - 22.5)
Well:	Kaiser E-10HN	North Reference:	True
Wellbore:	Wellbore #1	Survey Calculation Method:	Minimum Curvature
Design:	Wellbore #1	Database:	Landmark

Project	SEC.10-T6N-R65W		
Map System:	US State Plane 1983	System Datum:	Mean Sea Level
Geo Datum:	North American Datum 1983		Using Well Reference Point
Map Zone:	Colorado Northern Zone		Using geodetic scale factor

Site	Kaiser 10-D Pad Sec.10-T6N-R65W		
Site Position:		Northing:	1,428,828.36ft
From:	Lat/Long	Easting:	3,238,745.72ft
Position Uncertainty:	0.0 ft	Slot Radius:	"
		Latitude:	40.507362
		Longitude:	-104.641403
		Grid Convergence:	0.55 °

Well	Kaiser E-10HN		
Well Position	+N/-S	0.0 ft	Northing:
	+E/-W	0.0 ft	Easting:
Position Uncertainty	0.0 ft	Wellhead Elevation:	ft
		Latitude:	40.507222
		Longitude:	-104.641290
		Ground Level:	4,801.0ft

Wellbore	Wellbore #1				
Magnetics	Model Name	Sample Date	Declination (°)	Dip Angle (°)	Field Strength (nT)
	IGRF2010	10/3/2014	8.36	67.04	52,852

Design	Wellbore #1				
Audit Notes:					
Version:	1.0	Phase:	ACTUAL	Tie On Depth:	0.0
Vertical Section:	Depth From (TVD) (ft)	+N/-S (ft)	+E/-W (ft)	Direction (°)	
	0.0	0.0	0.0	257.54	

Survey Program	Date	10/7/2014			
From (ft)	To (ft)	Survey (Wellbore)	Tool Name	Description	
131.0	11,760.0	Survey #1 (Wellbore #1)	MWD	MWD - Standard	

Survey										
Measured Depth (ft)	Inclination (°)	Azimuth (°)	Vertical Depth (ft)	+N/-S (ft)	+E/-W (ft)	Vertical Section (ft)	Dogleg Rate (°/100ft)	Build Rate (°/100ft)	Turn Rate (°/100ft)	
0.0	0.00	0.00	0.0	0.0	0.0	0.0	0.00	0.00	0.00	
1.0	0.00	27.20	1.0	0.0	0.0	0.0	0.46	0.46	0.00	
SHL 464'FNL & 402'FEL										
131.0	0.60	27.20	131.0	0.6	0.3	-0.4	0.46	0.46	0.00	
223.0	0.80	14.90	223.0	1.7	0.7	-1.0	0.27	0.22	-13.37	
315.0	0.80	26.90	315.0	2.9	1.2	-1.7	0.18	0.00	13.04	
407.0	1.00	17.90	407.0	4.2	1.7	-2.6	0.27	0.22	-9.78	
499.0	0.60	113.00	499.0	4.8	2.4	-3.4	1.32	-0.43	103.37	
592.0	0.50	134.10	592.0	4.3	3.1	-4.0	0.24	-0.11	22.69	
684.0	0.50	116.50	684.0	3.8	3.8	-4.5	0.17	0.00	-19.13	
708.0	0.70	117.60	708.0	3.7	4.0	-4.7	0.83	0.83	4.58	
771.0	0.60	144.10	771.0	3.3	4.5	-5.1	0.50	-0.16	42.06	
867.0	2.40	161.00	866.9	1.0	5.5	-5.6	1.91	1.88	17.60	

Company:	Bayswater Exploration & Production, LLC	Local Co-ordinate Reference:	Well Kaiser E-10HN
Project:	SEC.10-T6N-R65W	TVD Reference:	WELL @ 4823.5ft (RKB - 22.5)
Site:	Kaiser 10-D Pad Sec.10-T6N-R65W	MD Reference:	WELL @ 4823.5ft (RKB - 22.5)
Well:	Kaiser E-10HN	North Reference:	True
Wellbore:	Wellbore #1	Survey Calculation Method:	Minimum Curvature
Design:	Wellbore #1	Database:	Landmark

Survey

Measured Depth (ft)	Inclination (°)	Azimuth (°)	Vertical Depth (ft)	+N/-S (ft)	+E/-W (ft)	Vertical Section (ft)	Dogleg Rate (°/100ft)	Build Rate (°/100ft)	Turn Rate (°/100ft)
961.0	4.60	165.40	960.7	-4.5	7.1	-5.9	2.36	2.34	4.68
1,053.0	6.50	164.50	1,052.3	-13.1	9.4	-6.3	2.07	2.07	-0.98
1,238.0	9.70	169.20	1,235.4	-38.5	15.1	-6.4	1.76	1.73	2.54
1,330.0	9.80	169.60	1,326.1	-53.9	18.0	-5.9	0.13	0.11	0.43
1,422.0	9.40	168.20	1,416.8	-68.9	20.9	-5.6	0.50	-0.43	-1.52
1,514.0	9.20	161.10	1,507.6	-83.2	24.8	-6.3	1.27	-0.22	-7.72
1,606.0	9.20	159.70	1,598.4	-97.1	29.8	-8.1	0.24	0.00	-1.52
1,698.0	10.40	154.10	1,689.1	-111.4	36.0	-11.1	1.66	1.30	-6.09
1,790.0	9.10	150.80	1,779.8	-125.3	43.1	-15.1	1.54	-1.41	-3.59
1,883.0	9.20	145.50	1,871.6	-137.8	50.9	-20.0	0.91	0.11	-5.70
1,975.0	9.90	143.40	1,962.3	-150.2	59.8	-26.0	0.85	0.76	-2.28
2,067.0	11.00	146.60	2,052.8	-163.9	69.4	-32.4	1.35	1.20	3.48
2,159.0	8.90	154.50	2,143.4	-177.7	77.3	-37.1	2.72	-2.28	8.59
2,252.0	9.90	157.80	2,235.1	-191.6	83.4	-40.1	1.22	1.08	3.55
2,313.0	10.50	164.00	2,295.2	-201.7	86.9	-41.3	2.05	0.98	10.16
2,408.0	10.30	162.20	2,388.6	-218.2	91.9	-42.6	0.40	-0.21	-1.89
2,504.0	9.20	158.70	2,483.2	-233.5	97.3	-44.6	1.30	-1.15	-3.65
2,599.0	10.30	158.00	2,576.9	-248.4	103.2	-47.2	1.16	1.16	-0.74
2,694.0	9.20	157.30	2,670.5	-263.3	109.3	-50.0	1.16	-1.16	-0.74
2,790.0	10.20	161.10	2,765.1	-278.4	115.1	-52.3	1.24	1.04	3.96
2,885.0	9.10	157.60	2,858.8	-293.3	120.6	-54.5	1.31	-1.16	-3.68
2,980.0	10.60	161.80	2,952.4	-308.6	126.2	-56.7	1.75	1.58	4.42
3,076.0	10.30	162.70	3,046.8	-325.2	131.5	-58.3	0.36	-0.31	0.94
3,171.0	8.30	157.80	3,140.5	-339.6	136.7	-60.2	2.26	-2.11	-5.16
3,266.0	9.60	163.10	3,234.4	-353.6	141.6	-61.9	1.62	1.37	5.58
3,361.0	10.60	158.30	3,327.9	-369.3	147.1	-64.0	1.38	1.05	-5.05
3,457.0	7.70	151.70	3,422.7	-383.1	153.4	-67.1	3.21	-3.02	-6.88
3,552.0	8.80	155.50	3,516.7	-395.3	159.4	-70.4	1.29	1.16	4.00
3,647.0	10.20	154.30	3,610.4	-409.5	166.1	-73.8	1.49	1.47	-1.26
3,742.0	10.10	153.60	3,703.9	-424.6	173.4	-77.8	0.17	-0.11	-0.74
3,838.0	8.70	162.70	3,798.6	-439.0	179.3	-80.4	2.12	-1.46	9.48
3,933.0	9.10	161.50	3,892.4	-453.0	183.9	-81.8	0.46	0.42	-1.26
4,028.0	10.70	165.40	3,986.0	-468.7	188.5	-82.9	1.83	1.68	4.11
4,123.0	11.10	164.70	4,079.3	-486.0	193.1	-83.7	0.44	0.42	-0.74
4,218.0	11.20	164.50	4,172.5	-503.8	198.0	-84.6	0.11	0.11	-0.21
4,314.0	11.30	159.60	4,266.7	-521.6	203.8	-86.4	1.00	0.10	-5.10
4,409.0	11.30	158.30	4,359.8	-538.9	210.4	-89.2	0.27	0.00	-1.37
4,504.0	11.60	155.70	4,453.0	-556.3	217.8	-92.7	0.63	0.32	-2.74
4,599.0	9.40	150.40	4,546.4	-571.7	225.6	-96.9	2.53	-2.32	-5.58
4,695.0	10.30	150.60	4,640.9	-586.0	233.7	-101.7	0.94	0.94	0.21
4,790.0	10.20	156.40	4,734.4	-601.1	241.2	-105.8	1.09	-0.11	6.11
4,885.0	8.90	161.10	4,828.1	-615.8	247.0	-108.3	1.59	-1.37	4.95
4,981.0	8.40	162.20	4,923.0	-629.5	251.5	-109.8	0.55	-0.52	1.15
5,076.0	8.60	159.90	5,017.0	-642.8	256.1	-111.4	0.42	0.21	-2.42
5,171.0	9.30	160.30	5,110.8	-656.7	261.1	-113.3	0.74	0.74	0.42
5,266.0	11.00	159.20	5,204.3	-672.4	266.9	-115.6	1.80	1.79	-1.16
5,361.0	8.40	152.40	5,298.0	-687.0	273.3	-118.7	2.99	-2.74	-7.16
5,457.0	8.20	157.10	5,393.0	-699.5	279.2	-121.8	0.74	-0.21	4.90
5,552.0	10.20	159.20	5,486.7	-713.6	284.9	-124.2	2.13	2.11	2.21
5,647.0	10.30	157.50	5,580.2	-729.3	291.1	-126.9	0.34	0.11	-1.79
5,743.0	9.90	158.20	5,674.7	-744.9	297.5	-129.7	0.44	-0.42	0.73
5,838.0	11.10	163.60	5,768.1	-761.3	303.1	-131.7	1.63	1.26	5.68
5,933.0	11.60	165.00	5,861.3	-779.3	308.1	-132.7	0.60	0.53	1.47
6,028.0	10.40	163.80	5,954.5	-796.7	313.0	-133.7	1.29	-1.26	-1.26

Company:	Bayswater Exploration & Production, LLC	Local Co-ordinate Reference:	Well Kaiser E-10HN
Project:	SEC.10-T6N-R65W	TVD Reference:	WELL @ 4823.5ft (RKB - 22.5)
Site:	Kaiser 10-D Pad Sec.10-T6N-R65W	MD Reference:	WELL @ 4823.5ft (RKB - 22.5)
Well:	Kaiser E-10HN	North Reference:	True
Wellbore:	Wellbore #1	Survey Calculation Method:	Minimum Curvature
Design:	Wellbore #1	Database:	Landmark

Survey

Measured Depth (ft)	Inclination (°)	Azimuth (°)	Vertical Depth (ft)	+N/-S (ft)	+E/-W (ft)	Vertical Section (ft)	Dogleg Rate (°/100ft)	Build Rate (°/100ft)	Turn Rate (°/100ft)
6,123.0	10.10	163.40	6,048.0	-813.0	317.8	-134.9	0.32	-0.32	-0.42
6,218.0	10.70	164.50	6,141.5	-829.4	322.5	-136.0	0.67	0.63	1.16
6,314.0	9.80	160.80	6,235.9	-845.7	327.6	-137.4	1.16	-0.94	-3.85
6,409.0	9.00	166.60	6,329.7	-860.6	331.9	-138.5	1.30	-0.84	6.11
6,504.0	9.30	163.10	6,423.4	-875.2	335.9	-139.2	0.67	0.32	-3.68
6,552.0	9.90	164.30	6,470.8	-882.9	338.1	-139.7	1.32	1.25	2.50
6,600.0	10.60	168.20	6,518.0	-891.2	340.2	-139.9	2.05	1.46	8.13
6,647.0	10.60	184.50	6,564.2	-899.7	340.7	-138.6	6.36	0.00	34.68
6,695.0	11.80	200.00	6,611.3	-908.7	338.7	-134.7	6.73	2.50	32.29
6,742.0	12.90	219.50	6,657.2	-917.3	333.7	-127.9	9.13	2.34	41.49
6,790.0	16.10	235.90	6,703.7	-925.2	324.8	-117.5	10.78	6.67	34.17
6,837.0	18.40	243.40	6,748.6	-932.1	312.7	-104.3	6.80	4.89	15.96
6,885.0	23.10	249.00	6,793.5	-938.9	297.2	-87.6	10.62	9.79	11.67
6,980.0	31.10	261.30	6,878.1	-949.3	255.4	-44.6	10.24	8.42	12.95
7,021.0	35.80	264.30	6,912.3	-952.1	233.0	-22.1	12.15	11.46	7.32
7,076.0	41.80	265.90	6,955.1	-955.0	198.7	12.0	11.06	10.91	2.91
7,123.0	47.70	264.90	6,988.5	-957.7	165.7	44.8	12.64	12.55	-2.13
7,171.0	53.40	262.90	7,019.0	-961.7	128.9	81.6	12.30	11.88	-4.17
7,218.0	59.80	262.00	7,044.8	-966.8	90.0	120.7	13.71	13.62	-1.91
7,266.0	66.10	263.60	7,066.6	-972.2	47.6	163.2	13.46	13.13	3.33
7,313.0	71.40	264.50	7,083.7	-976.7	4.1	206.7	11.42	11.28	1.91
7,362.0	76.60	266.10	7,097.2	-980.5	-42.9	253.4	11.07	10.61	3.27
7,409.0	80.80	266.40	7,106.4	-983.6	-88.8	298.9	8.96	8.94	0.64
7,457.0	84.90	268.50	7,112.4	-985.7	-136.4	345.8	9.58	8.54	4.38
7,468.0	85.90	268.50	7,113.2	-986.0	-147.4	356.6	9.09	9.09	0.00
7,560.0	89.00	269.90	7,117.3	-987.2	-239.3	446.6	3.70	3.37	1.52
7,655.0	91.00	269.20	7,117.3	-988.0	-334.2	539.5	2.23	2.11	-0.74
7,748.0	91.50	268.50	7,115.3	-989.8	-427.2	630.7	0.92	0.54	-0.75
7,843.0	91.50	269.60	7,112.8	-991.4	-522.2	723.8	1.16	0.00	1.16
7,938.0	91.60	269.70	7,110.2	-992.0	-617.1	816.6	0.15	0.11	0.11
8,032.0	92.40	271.00	7,107.0	-991.4	-711.1	908.2	1.62	0.85	1.38
8,127.0	91.50	272.00	7,103.7	-988.9	-806.0	1,000.3	1.42	-0.95	1.05
8,221.0	92.20	272.40	7,100.7	-985.3	-899.9	1,091.2	0.86	0.74	0.43
8,315.0	91.80	272.40	7,097.4	-981.4	-993.7	1,182.0	0.43	-0.43	0.00
8,410.0	92.50	269.60	7,093.8	-979.7	-1,088.6	1,274.4	3.04	0.74	-2.95
8,504.0	92.20	271.50	7,090.0	-978.8	-1,182.5	1,365.9	2.04	-0.32	2.02
8,598.0	90.70	269.70	7,087.6	-977.9	-1,276.5	1,457.4	2.49	-1.60	-1.91
8,693.0	90.40	271.30	7,086.7	-977.0	-1,371.5	1,550.0	1.71	-0.32	1.68
8,787.0	91.50	269.90	7,085.1	-976.0	-1,465.5	1,641.5	1.89	1.17	-1.49
8,881.0	91.30	269.90	7,082.8	-976.2	-1,559.4	1,733.3	0.21	-0.21	0.00
8,975.0	91.10	270.40	7,080.9	-976.0	-1,653.4	1,825.0	0.57	-0.21	0.53
9,070.0	89.00	270.40	7,080.8	-975.3	-1,748.4	1,917.6	2.21	-2.21	0.00
9,165.0	90.10	269.60	7,081.5	-975.3	-1,843.4	2,010.4	1.43	1.16	-0.84
9,259.0	91.50	269.00	7,080.2	-976.5	-1,937.4	2,102.4	1.62	1.49	-0.64
9,353.0	91.10	269.40	7,078.1	-977.8	-2,031.3	2,194.5	0.60	-0.43	0.43
9,448.0	90.70	270.10	7,076.6	-978.2	-2,126.3	2,287.3	0.85	-0.42	0.74
9,542.0	90.20	269.40	7,075.9	-978.6	-2,220.3	2,379.2	0.92	-0.53	-0.74
9,637.0	90.90	270.40	7,075.0	-978.8	-2,315.3	2,472.0	1.28	0.74	1.05
9,731.0	92.30	270.30	7,072.3	-978.2	-2,409.3	2,563.6	1.49	1.49	-0.11
9,826.0	92.00	271.70	7,068.8	-976.5	-2,504.2	2,655.9	1.51	-0.32	1.47
9,920.0	91.80	271.50	7,065.6	-973.9	-2,598.1	2,747.0	0.30	-0.21	-0.21
10,015.0	90.30	269.70	7,063.9	-972.9	-2,693.1	2,839.6	2.47	-1.58	-1.89
10,109.0	91.30	269.20	7,062.6	-973.8	-2,787.1	2,931.5	1.19	1.06	-0.53
10,204.0	89.60	270.30	7,061.8	-974.2	-2,882.1	3,024.4	2.13	-1.79	1.16

Company:	Bayswater Exploration & Production, LLC	Local Co-ordinate Reference:	Well Kaiser E-10HN
Project:	SEC.10-T6N-R65W	TVD Reference:	WELL @ 4823.5ft (RKB - 22.5)
Site:	Kaiser 10-D Pad Sec.10-T6N-R65W	MD Reference:	WELL @ 4823.5ft (RKB - 22.5)
Well:	Kaiser E-10HN	North Reference:	True
Wellbore:	Wellbore #1	Survey Calculation Method:	Minimum Curvature
Design:	Wellbore #1	Database:	Landmark

Survey

Measured Depth (ft)	Inclination (°)	Azimuth (°)	Vertical Depth (ft)	+N/-S (ft)	+E/-W (ft)	Vertical Section (ft)	Dogleg Rate (°/100ft)	Build Rate (°/100ft)	Turn Rate (°/100ft)
10,298.0	90.70	271.70	7,061.6	-972.6	-2,976.0	3,115.8	1.89	1.17	1.49
10,392.0	90.70	271.00	7,060.5	-970.4	-3,070.0	3,207.1	0.74	0.00	-0.74
10,487.0	89.00	270.10	7,060.7	-969.5	-3,165.0	3,299.6	2.02	-1.79	-0.95
10,581.0	89.70	269.60	7,061.8	-969.7	-3,259.0	3,391.4	0.92	0.74	-0.53
10,676.0	91.30	269.00	7,060.9	-970.9	-3,354.0	3,484.4	1.80	1.68	-0.63
10,770.0	92.50	269.60	7,057.8	-972.0	-3,447.9	3,576.4	1.43	1.28	0.64
10,865.0	90.90	270.10	7,055.0	-972.3	-3,542.9	3,669.2	1.76	-1.68	0.53
10,959.0	90.70	268.00	7,053.7	-973.8	-3,636.8	3,761.3	2.24	-0.21	-2.23
11,054.0	90.70	267.50	7,052.5	-977.5	-3,731.8	3,854.8	0.53	0.00	-0.53
11,148.0	90.90	267.80	7,051.2	-981.4	-3,825.7	3,947.3	0.38	0.21	0.32
11,242.0	92.30	266.90	7,048.6	-985.7	-3,919.5	4,039.9	1.77	1.49	-0.96
11,336.0	93.40	269.00	7,043.9	-989.1	-4,013.3	4,132.2	2.52	1.17	2.23
11,431.0	92.90	269.40	7,038.7	-990.4	-4,108.2	4,225.1	0.67	-0.53	0.42
11,525.0	92.20	269.40	7,034.5	-991.4	-4,202.1	4,317.0	0.74	-0.74	0.00
11,620.0	93.60	269.40	7,029.7	-992.4	-4,297.0	4,409.9	1.47	1.47	0.00
11,705.0	91.90	269.90	7,025.6	-992.9	-4,381.9	4,492.9	2.08	-2.00	0.59
11,760.0	91.90	269.90	7,023.8	-993.0	-4,436.8	4,546.6	0.00	0.00	0.00

BHL 1460'FNL & 465'FWL

Checked By: _____ Approved By: _____ Date: _____