



- Flare pit is to be located a min. of 100' from the wellhead.
- Round corners at 35' radius or as needed.
- Construct diversion ditches as needed.
- Contours shown at 2' intervals.

**DIAMOND T SHEEP 7-92 #3-26H35  
ON EXISTING 7-92 #1-26 PAD  
SECTION 26, T7N, R92W, 6th P.M.  
NW 1/4 NW 1/4**

SWMP NOTE:  
OWNER/OPERATOR IS RESPONSIBLE FOR  
SWMP. BMP DETAILS TO BE PROVIDED BY  
OTHERS. CONTACT ENGINEER FOR ANY  
DESIGN CHANGES TO STRUCTURAL BMP'S.

1" = 40'  
X-Section  
Scale  
1" = 100'

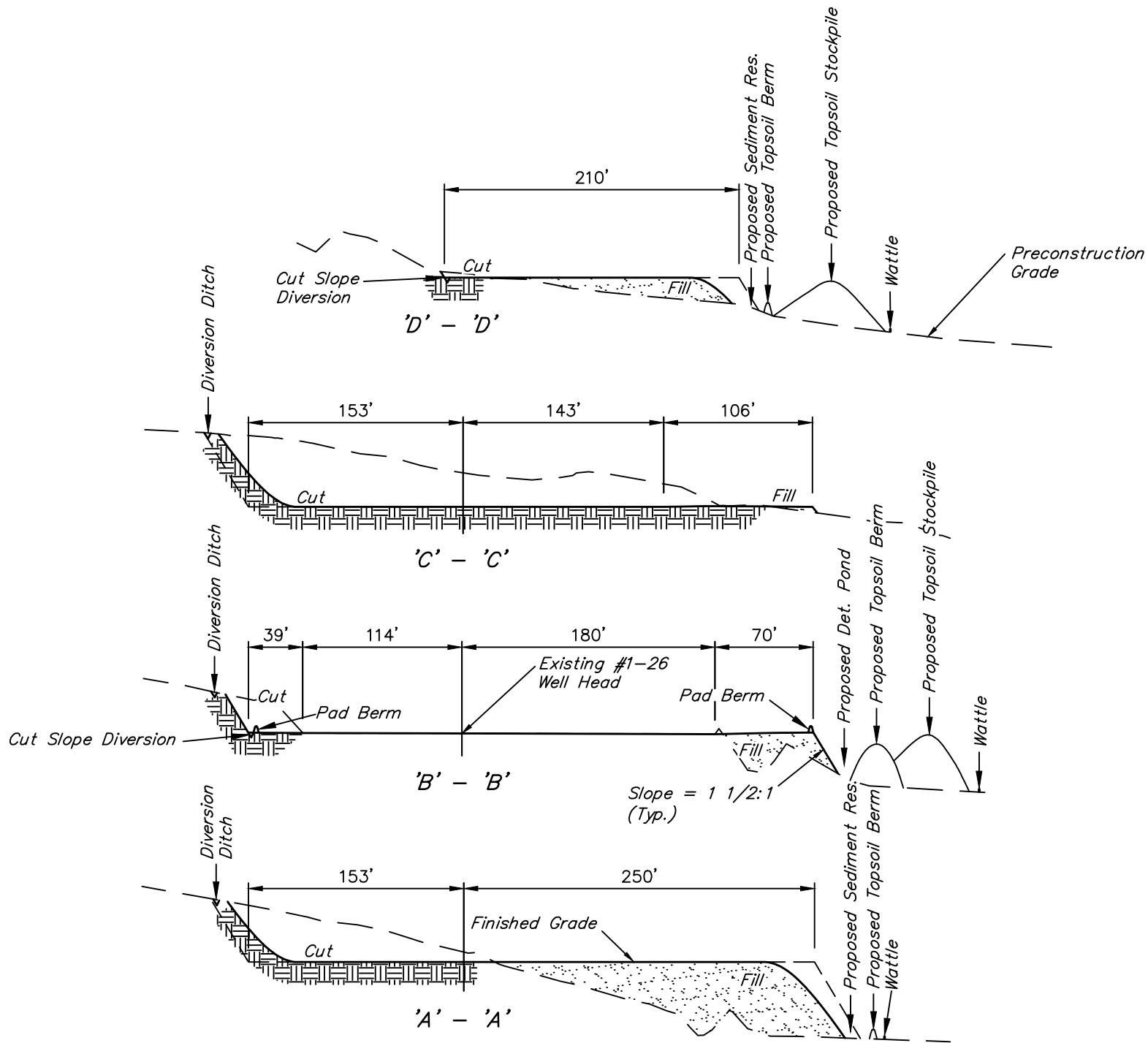

APPROXIMATE EARTHWORK QUANTITIES	
(6") TOPSOIL STRIPPING (NEW CONSTRUCTION ONLY)	2,370 Cu. Yds.
REMAINING LOCATION	15,200 Cu. Yds.
TOTAL CUT	17,570 Cu. Yds.
FILL	15,200 Cu. Yds.
EXCESS MATERIAL	2,370 Cu. Yds.
TOPSOIL	2,370 Cu. Yds.
EXCESS UNBALANCE (After Interim Rehabilitation)	0 Cu. Yds.

APPROXIMATE SURFACE DISTURBANCE AREAS		
	DISTANCE	ACRES
TOTAL DISTURBANCE	NA	±6.864
TOTAL SURFACE USE AREA		±6.864

- NOTES:
- Fill quantity includes 5% for compaction.
  - Calculations based on 6" of topsoil stripping.
  - Topsoil should not be stripped below finished grade on substructure area.

SOUTHWESTERN ENERGY PRODUCTION COMPANY  
DIAMOND T SHEEP 7-92 #3-26H35  
ON EXISTING 7-92 #1-26 PAD  
SECTION 26, T7N, R92W, 6th P.M.  
NW 1/4 NW 1/4



UELS, LLC  
Corporate Office \* 85 South 200 East  
Vernal, UT 84078 \* (435) 789-1017

DRAWN BY: M.D.	DATE DRAWN: 01-15-15
SCALE: AS SHOWN	REVISED: 03-19-15 T.B.
CONSTRUCTION LAYOUT CROSS SECTIONS	FIGURE #2

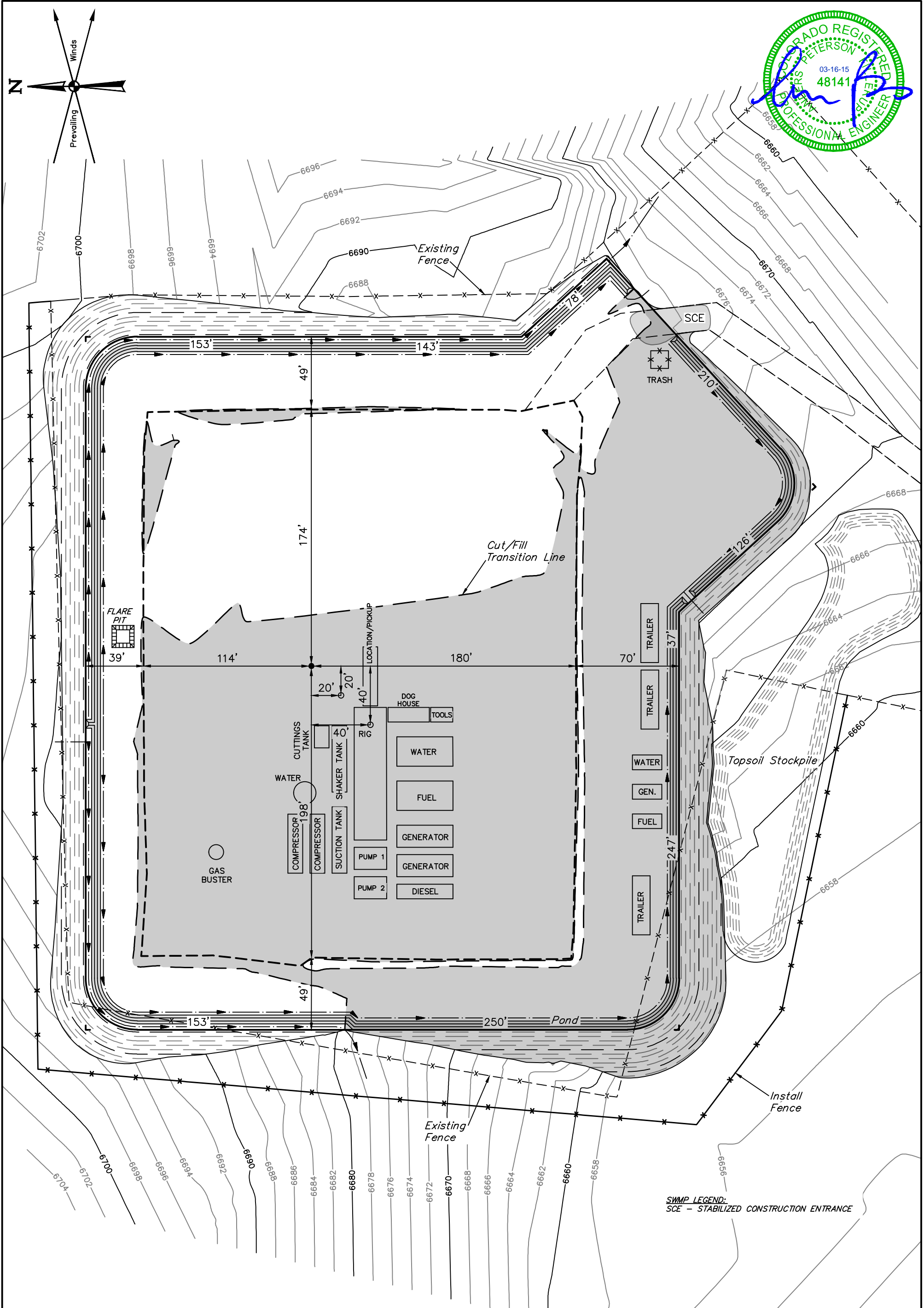

**NOTES:**

- Flare pit is to be located a min. of 100' from the wellhead.
- Contours shown at 2' intervals.

**SOUTHWESTERN ENERGY PRODUCTION COMPANY**

**DIAMOND T SHEEP 7-92 #3-26H35**  
**ON EXISTING 7-92 #1-26 PAD**  
**SECTION 26, T7N, R92W, 6th P.M.**  
**NW 1/4 NW 1/4**

DRAWN BY: C.D.L.	DATE DRAWN: 03-05-15
SCALE: 1" = 60'	REVISED: 03-16-15 C.D.L.

<b>TYPICAL RIG LAYOUT</b>	<b>FIGURE #3</b>
---------------------------	------------------

**UINTEAH**  
ENGINEERING & LAND SURVEYING

**UELS, LLC**  
Corporate Office \* 85 South 200 East  
Vernal, UT 84078 \* (435) 789-1017



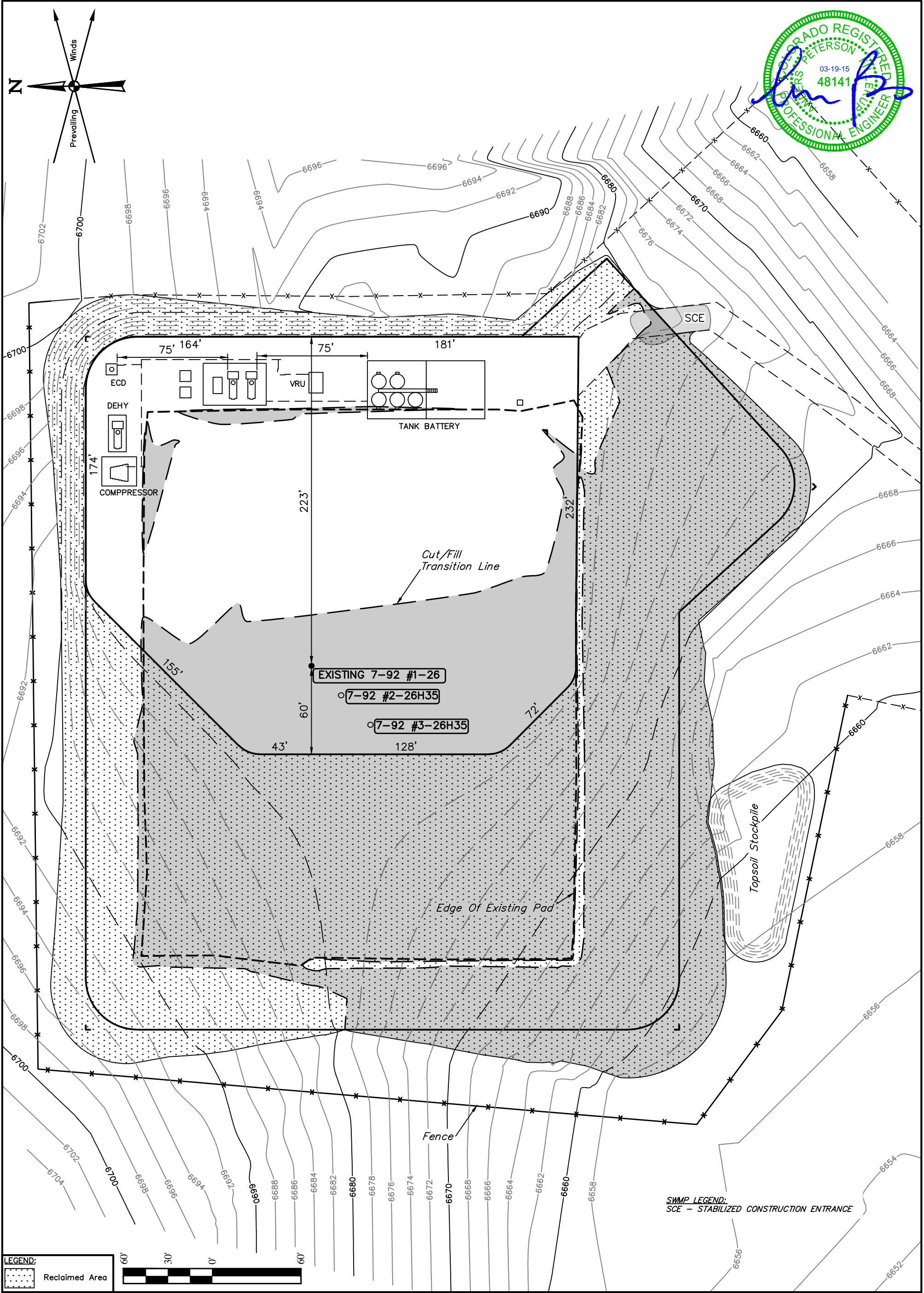

**LEGEND:**  
Reclaimed Area

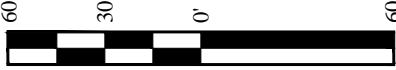

APPROXIMATE UN-RECLAIMED ACREAGE = ±1.994 ACRES

**NOTES:**  
• Contours shown at 2' intervals.

**SOUTHWESTERN ENERGY PRODUCTION COMPANY**

**DIAMOND T SHEEP 7-92 #3-26H35  
ON EXISTING 7-92 #1-26 PAD  
SECTION 26, T7N, R92W, 6th P.M.  
NW 1/4 NW 1/4**



**UELS, LLC**  
Corporate Office \* 85 South 200 East  
Vernal, UT 84078 \* (435) 789-1017

DRAWN BY: C.D.L.	DATE DRAWN: 03-05-15
SCALE: 1" = 60'	REVISED: 03-19-15 T.B.
<b>INTERIM RECLAMATION PLAN</b>	<b>FIGURE #4</b>