

KERR-MCGEE OIL & GAS ONSHORE LP

Location: COLORADO Slot: SLOT#28 GREENLEAF 2N-2HZ (452' FSL & 1765' FEL, SEC.02)
 Field: WELD COUNTY (KERR MCGEE) Well: GREENLEAF 2N-2HZ
 Facility: SEC.02-T2N-R65W Wellbore: GREENLEAF 2N-2HZ PWP

Plot reference wellpath is GREENLEAF 2N-2HZ (REV-A.0) PWP

True vertical depths are referenced to XTREME 23 (16KB) (RKB)	Grid System: NAD83 / Lambert Colorado SP, Northern Zone (501), US feet
Measured depths are referenced to XTREME 23 (16KB) (RKB)	North Reference: True north
XTREME 23 (16KB) (RKB) to Mean Sea Level: 4862 feet	Scale: True distance
Mean Sea Level to Mud line (At Slot: SLOT#28 GREENLEAF 2N-2HZ (452' FSL & 1765' FEL, SEC.02)): 0 feet	Depths are in feet
Coordinates are in feet referenced to Slot	Created by: precalin on 3/10/2015

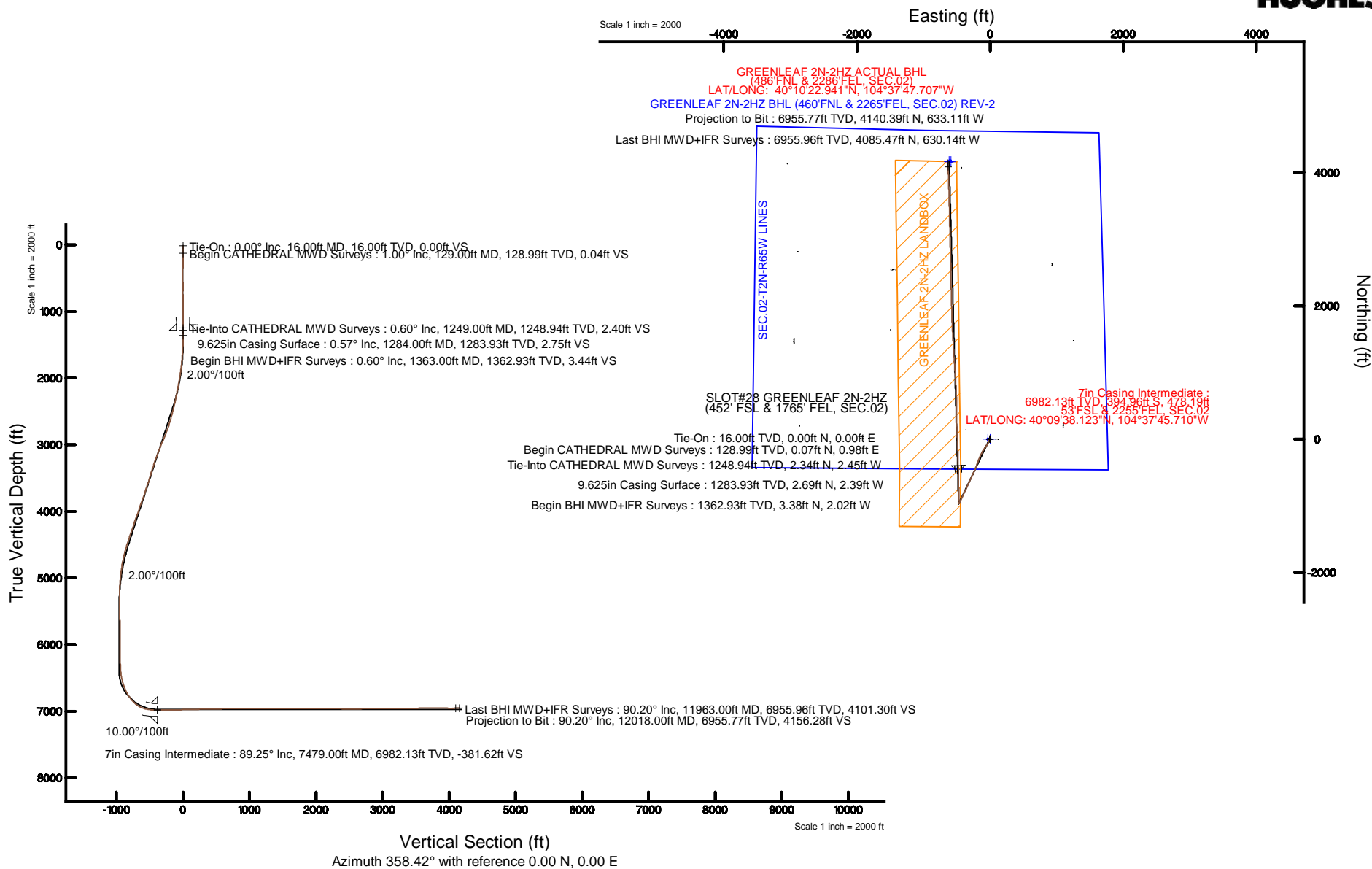

REFERENCE WELLPATH IDENTIFICATION

Operator	KERR-MCGEE OIL & GAS ONSHORE LP	Slot	SLOT#28 GREENLEAF 2N-2HZ (452' FSL & 1765' FEL, SEC.02)
Area	COLORADO	Well	GREENLEAF 2N-2HZ
Field	WELD COUNTY (KERR MCGEE)	Wellbore	GREENLEAF 2N-2HZ AWB <12018>
Facility	SEC.02-T2N-R65W		

REPORT SETUP INFORMATION

Projection System	NAD83 / Lambert Colorado SP, Northern Zone (501), US feet	Software System	WellArchitect® 4.1.1
North Reference	True	User	Precain
Scale	0.999958	Report Generated	3/10/2015 at 1:40:53 PM
Convergence at slot	0.56° East	Database/Source file	WellArchitectDB/GREENLEAF_2N-2HZ_AWB___12018_.xml

WELLPATH LOCATION

	Local coordinates		Grid coordinates		Geographic coordinates	
	North[ft]	East[ft]	Easting[US ft]	Northing[US ft]	Latitude	Longitude
Slot Location	-231.71	-1099.30	3243807.82	1302940.19	40°09'42.026"N	104°37'39.551"W
Facility Reference Pt			3244904.72	1303182.74	40°09'44.316"N	104°37'25.392"W
Field Reference Pt			3197771.84	1268891.29	40°04'09.600"N	104°47'36.000"W

WELLPATH DATUM

Calculation method	Minimum curvature	XTREME 23 (16'KB) (RKB) to Facility Vertical Datum	4862.00ft
Horizontal Reference Pt	Slot	XTREME 23 (16'KB) (RKB) to Mean Sea Level	4862.00ft
Vertical Reference Pt	XTREME 23 (16'KB) (RKB)	XTREME 23 (16'KB) (RKB) to Mud Line at Slot (SLOT#28 GREENLEAF 2N-2HZ (452' FSL & 1765' FEL, SEC.02))	4862.00ft
MD Reference Pt	XTREME 23 (16'KB) (RKB)	Section Origin	N 0.00, E 0.00 ft
Field Vertical Reference	Mean Sea Level	Section Azimuth	358.42°

REFERENCE WELLPATH IDENTIFICATION

Operator	KERR-MCGEE OIL & GAS ONSHORE LP	Slot	SLOT#28 GREENLEAF 2N-2HZ (452' FSL & 1765' FEL, SEC.02)
Area	COLORADO	Well	GREENLEAF 2N-2HZ
Field	WELD COUNTY (KERR MCGEE)	Wellbore	GREENLEAF 2N-2HZ AWB <12018>
Facility	SEC.02-T2N-R65W		

WELLPATH DATA (116 stations) † = interpolated/extrapolated station

MD [ft]	Inclination [°]	Azimuth [°]	TVD [ft]	Vert Sect [ft]	North [ft]	East [ft]	Latitude	Longitude	DLS [°/100ft]	Comments
0.00†	0.000	86.000	0.00	0.00	0.00	0.00	40°09'42.026"N	104°37'39.551"W	0.00	
16.00	0.000	86.000	16.00	0.00	0.00	0.00	40°09'42.026"N	104°37'39.551"W	0.00	Tie-On
129.00	1.000	86.000	128.99	0.04	0.07	0.98	40°09'42.027"N	104°37'39.538"W	0.88	Begin CATHEDRAL MWD Surveys
209.00	0.800	106.800	208.98	-0.11	-0.04	2.21	40°09'42.026"N	104°37'39.522"W	0.47	
288.00	0.500	104.500	287.98	-0.37	-0.29	3.08	40°09'42.023"N	104°37'39.511"W	0.38	
368.00	0.100	255.600	367.98	-0.49	-0.39	3.35	40°09'42.022"N	104°37'39.508"W	0.74	
448.00	0.100	239.700	447.98	-0.54	-0.45	3.22	40°09'42.022"N	104°37'39.510"W	0.03	
528.00	0.100	306.800	527.98	-0.53	-0.44	3.10	40°09'42.022"N	104°37'39.511"W	0.14	
608.00	0.300	278.300	607.98	-0.45	-0.37	2.84	40°09'42.022"N	104°37'39.514"W	0.27	
688.00	0.100	146.300	687.98	-0.47	-0.40	2.67	40°09'42.022"N	104°37'39.517"W	0.47	
768.00	0.800	277.200	767.98	-0.44	-0.38	2.16	40°09'42.022"N	104°37'39.523"W	1.09	
848.00	0.800	281.800	847.97	-0.23	-0.20	1.05	40°09'42.024"N	104°37'39.537"W	0.08	
928.00	0.800	285.400	927.96	0.06	0.06	-0.03	40°09'42.027"N	104°37'39.551"W	0.06	
1008.00	0.800	293.900	1007.95	0.47	0.44	-1.08	40°09'42.030"N	104°37'39.565"W	0.15	
1088.00	0.800	299.700	1087.94	1.00	0.94	-2.07	40°09'42.035"N	104°37'39.578"W	0.10	
1168.00	0.500	7.200	1167.94	1.63	1.56	-2.52	40°09'42.041"N	104°37'39.583"W	0.96	
1249.00	0.600	3.500	1248.94	2.40	2.34	-2.45	40°09'42.049"N	104°37'39.583"W	0.13	Tie-Into CATHEDRAL MWD Surveys
1363.00	0.600	41.300	1362.93	3.44	3.38	-2.02	40°09'42.059"N	104°37'39.577"W	0.34	Begin BHI MWD+IFR Surveys
1457.00	1.800	176.500	1456.92	2.32	2.28	-1.60	40°09'42.049"N	104°37'39.572"W	2.41	
1553.00	2.900	187.300	1552.83	-1.59	-1.64	-1.82	40°09'42.010"N	104°37'39.574"W	1.23	
1646.00	4.800	215.700	1645.63	-7.01	-7.13	-4.39	40°09'41.956"N	104°37'39.608"W	2.84	
1737.00	6.100	210.000	1736.22	-14.16	-14.41	-9.03	40°09'41.884"N	104°37'39.667"W	1.55	
1830.00	7.600	205.600	1828.55	-23.84	-24.24	-14.15	40°09'41.786"N	104°37'39.733"W	1.71	
1923.00	9.700	202.500	1920.49	-36.46	-37.02	-19.81	40°09'41.660"N	104°37'39.806"W	2.31	
2016.00	11.000	200.500	2011.97	-51.84	-52.57	-25.92	40°09'41.506"N	104°37'39.885"W	1.45	
2108.00	11.800	208.400	2102.16	-68.12	-69.07	-33.47	40°09'41.343"N	104°37'39.982"W	1.90	
2201.00	13.000	213.900	2192.99	-84.88	-86.12	-43.82	40°09'41.175"N	104°37'40.115"W	1.81	
2294.00	14.600	216.700	2283.31	-102.60	-104.20	-56.66	40°09'40.996"N	104°37'40.281"W	1.86	
2387.00	16.400	220.700	2372.92	-121.51	-123.55	-72.23	40°09'40.805"N	104°37'40.481"W	2.25	
2480.00	16.900	215.300	2462.03	-142.04	-144.54	-88.60	40°09'40.598"N	104°37'40.692"W	1.75	
2571.00	17.400	209.200	2548.99	-164.31	-167.21	-102.89	40°09'40.374"N	104°37'40.876"W	2.05	
2664.00	20.000	211.700	2637.08	-189.56	-192.89	-118.03	40°09'40.120"N	104°37'41.071"W	2.92	
2756.00	19.600	203.600	2723.65	-216.68	-220.42	-132.48	40°09'39.848"N	104°37'41.257"W	3.01	
2849.00	22.700	203.900	2810.38	-247.00	-251.13	-146.00	40°09'39.544"N	104°37'41.431"W	3.34	
2934.00	25.100	202.700	2888.08	-278.25	-282.76	-159.60	40°09'39.232"N	104°37'41.607"W	2.88	
3021.00	23.500	199.900	2967.38	-311.21	-316.09	-172.63	40°09'38.902"N	104°37'41.774"W	2.27	
3106.00	23.500	199.800	3045.33	-342.76	-347.97	-184.14	40°09'38.587"N	104°37'41.923"W	0.05	
3192.00	21.300	198.800	3124.83	-373.37	-378.90	-194.98	40°09'38.282"N	104°37'42.062"W	2.60	
3279.00	21.400	199.900	3205.86	-402.96	-408.78	-205.47	40°09'37.986"N	104°37'42.197"W	0.47	
3366.00	21.900	203.400	3286.73	-432.43	-438.60	-217.32	40°09'37.692"N	104°37'42.350"W	1.59	
3451.00	19.200	203.600	3366.31	-459.46	-465.96	-229.21	40°09'37.421"N	104°37'42.503"W	3.18	
3536.00	18.400	205.900	3446.78	-484.01	-490.83	-240.67	40°09'37.176"N	104°37'42.651"W	1.28	
3621.00	19.300	207.100	3527.22	-508.23	-515.41	-252.93	40°09'36.933"N	104°37'42.809"W	1.15	
3707.00	20.500	203.700	3608.08	-534.32	-541.85	-265.46	40°09'36.671"N	104°37'42.970"W	1.94	
3794.00	20.300	204.800	3689.63	-561.61	-569.50	-277.91	40°09'36.398"N	104°37'43.130"W	0.50	

REFERENCE WELLPATH IDENTIFICATION

Operator	KERR-MCGEE OIL & GAS ONSHORE LP	Slot	SLOT#28 GREENLEAF 2N-2HZ (452' FSL & 1765' FEL, SEC.02)
Area	COLORADO	Well	GREENLEAF 2N-2HZ
Field	WELD COUNTY (KERR MCGEE)	Wellbore	GREENLEAF 2N-2HZ AWB <12018>
Facility	SEC.02-T2N-R65W		

WELLPATH DATA (116 stations) † = interpolated/extrapolated station

MD [ft]	Inclination [°]	Azimuth [°]	TVD [ft]	Vert Sect [ft]	North [ft]	East [ft]	Latitude	Longitude	DLS [°/100ft]	Comments
3878.00	21.500	206.800	3768.10	-588.21	-596.47	-290.96	40°09'36.132"N	104°37'43.299"W	1.66	
3963.00	21.200	203.800	3847.27	-615.80	-624.43	-304.19	40°09'35.855"N	104°37'43.469"W	1.33	
4050.00	21.700	203.200	3928.24	-644.62	-653.61	-316.87	40°09'35.567"N	104°37'43.632"W	0.63	
4137.00	21.800	206.700	4009.05	-673.45	-682.83	-330.47	40°09'35.278"N	104°37'43.807"W	1.49	
4222.00	21.200	205.100	4088.14	-701.08	-710.85	-344.08	40°09'35.001"N	104°37'43.983"W	0.99	
4308.00	20.100	204.800	4168.61	-728.21	-738.34	-356.88	40°09'34.730"N	104°37'44.147"W	1.28	
4395.00	20.100	203.800	4250.31	-755.11	-765.59	-369.18	40°09'34.460"N	104°37'44.306"W	0.40	
4482.00	21.900	206.300	4331.53	-782.96	-793.82	-382.40	40°09'34.181"N	104°37'44.476"W	2.31	
4569.00	20.200	203.800	4412.73	-810.88	-822.11	-395.65	40°09'33.902"N	104°37'44.647"W	2.21	
4656.00	19.400	204.000	4494.58	-837.48	-849.05	-407.59	40°09'33.636"N	104°37'44.801"W	0.92	
4741.00	18.000	208.200	4575.10	-861.62	-873.52	-419.54	40°09'33.394"N	104°37'44.955"W	2.28	
4830.00	15.400	205.700	4660.34	-884.06	-896.30	-431.17	40°09'33.169"N	104°37'45.104"W	3.03	
4917.00	12.600	208.600	4744.75	-902.53	-915.04	-440.72	40°09'32.983"N	104°37'45.227"W	3.32	
5003.00	9.600	205.800	4829.13	-917.01	-929.74	-448.33	40°09'32.838"N	104°37'45.325"W	3.54	
5090.00	8.000	202.400	4915.10	-928.99	-941.87	-453.80	40°09'32.718"N	104°37'45.396"W	1.93	
5175.00	5.800	202.300	4999.48	-938.32	-951.31	-457.68	40°09'32.625"N	104°37'45.446"W	2.59	
5262.00	5.300	206.800	5086.07	-945.87	-958.96	-461.16	40°09'32.549"N	104°37'45.491"W	0.76	
5351.00	2.700	215.000	5174.85	-951.17	-964.35	-464.22	40°09'32.496"N	104°37'45.530"W	2.98	
5437.00	0.400	279.100	5260.82	-952.75	-965.96	-465.68	40°09'32.480"N	104°37'45.549"W	2.97	
5779.00	1.700	33.900	5602.77	-948.39	-961.56	-464.03	40°09'32.524"N	104°37'45.527"W	0.56	
6211.00	1.700	107.700	6034.62	-945.29	-958.19	-454.35	40°09'32.557"N	104°37'45.403"W	0.47	
6381.00	1.800	336.800	6204.59	-943.64	-956.50	-453.00	40°09'32.574"N	104°37'45.385"W	1.87	
6552.00	3.700	348.200	6375.38	-935.71	-948.63	-455.18	40°09'32.652"N	104°37'45.414"W	1.15	
6637.00	8.100	341.300	6459.91	-927.29	-940.27	-457.66	40°09'32.734"N	104°37'45.446"W	5.23	
6721.00	15.000	349.100	6542.17	-910.88	-923.97	-461.62	40°09'32.895"N	104°37'45.496"W	8.40	
6806.00	19.300	354.800	6623.37	-886.00	-899.17	-464.98	40°09'33.140"N	104°37'45.540"W	5.43	
6894.00	26.300	358.200	6704.45	-851.94	-865.16	-466.91	40°09'33.476"N	104°37'45.565"W	8.09	
6936.00	30.100	359.000	6741.46	-832.10	-845.32	-467.39	40°09'33.672"N	104°37'45.571"W	9.09	
6979.00	33.300	359.500	6778.04	-809.51	-822.73	-467.68	40°09'33.896"N	104°37'45.575"W	7.47	
7064.00	41.300	357.400	6845.60	-758.05	-771.29	-469.16	40°09'34.404"N	104°37'45.594"W	9.53	
7143.00	51.800	359.200	6899.86	-700.78	-714.04	-470.78	40°09'34.970"N	104°37'45.614"W	13.39	
7230.00	67.400	359.200	6943.75	-625.98	-639.24	-471.82	40°09'35.709"N	104°37'45.628"W	17.93	
7316.00	79.000	358.500	6968.56	-543.80	-557.07	-473.49	40°09'36.521"N	104°37'45.649"W	13.51	
7403.00	86.300	358.000	6979.69	-457.57	-470.89	-476.12	40°09'37.373"N	104°37'45.683"W	8.41	
7440.00	88.500	358.600	6981.36	-420.61	-433.94	-477.22	40°09'37.738"N	104°37'45.697"W	6.16	
7479.00†	89.255	358.537	6982.13	-381.62	-394.96	-478.19	40°09'38.123"N	104°37'45.710"W	1.94	7" Casing Point
7564.00	90.900	358.400	6982.01	-296.62	-310.00	-480.46	40°09'38.963"N	104°37'45.739"W	1.94	
7649.00	90.700	358.100	6980.83	-211.63	-225.04	-483.06	40°09'39.802"N	104°37'45.773"W	0.42	
7734.00	91.000	358.200	6979.57	-126.64	-140.10	-485.80	40°09'40.641"N	104°37'45.808"W	0.37	
7820.00	91.500	357.900	6977.69	-40.66	-54.17	-488.73	40°09'41.491"N	104°37'45.846"W	0.68	
7905.00	91.900	357.800	6975.17	44.29	30.73	-491.92	40°09'42.330"N	104°37'45.887"W	0.49	
7991.00	91.500	357.400	6972.62	130.25	116.62	-495.52	40°09'43.178"N	104°37'45.933"W	0.66	
8078.00	91.300	357.600	6970.49	217.21	203.51	-499.31	40°09'44.037"N	104°37'45.982"W	0.33	
8163.00	91.500	358.300	6968.41	302.18	288.43	-502.35	40°09'44.876"N	104°37'46.021"W	0.86	
8248.00	91.400	359.900	6966.26	387.14	373.39	-503.68	40°09'45.716"N	104°37'46.039"W	1.89	

REFERENCE WELLPATH IDENTIFICATION

Operator	KERR-MCGEE OIL & GAS ONSHORE LP	Slot	SLOT#28 GREENLEAF 2N-2HZ (452' FSL & 1765' FEL, SEC.02)
Area	COLORADO	Well	GREENLEAF 2N-2HZ
Field	WELD COUNTY (KERR MCGEE)	Wellbore	GREENLEAF 2N-2HZ AWB <12018>
Facility	SEC.02-T2N-R65W		

WELLPATH DATA (116 stations)

MD [ft]	Inclination [°]	Azimuth [°]	TVD [ft]	Vert Sect [ft]	North [ft]	East [ft]	Latitude	Longitude	DLS [°/100ft]	Comments
8333.00	90.900	359.600	6964.56	472.10	458.37	-504.05	40°09'46.556"N	104°37'46.043"W	0.69	
8420.00	90.600	359.800	6963.42	559.08	545.36	-504.51	40°09'47.415"N	104°37'46.049"W	0.41	
8505.00	91.000	358.700	6962.23	644.06	630.35	-505.62	40°09'48.255"N	104°37'46.064"W	1.38	
8591.00	90.600	357.900	6961.03	730.05	716.30	-508.17	40°09'49.104"N	104°37'46.096"W	1.04	
8676.00	90.200	357.100	6960.44	815.03	801.22	-511.88	40°09'49.944"N	104°37'46.144"W	1.05	
8761.00	89.400	356.300	6960.73	899.99	886.07	-516.77	40°09'50.782"N	104°37'46.207"W	1.33	
8933.00	90.100	355.900	6961.48	1071.85	1057.67	-528.47	40°09'52.478"N	104°37'46.358"W	0.47	
9103.00	89.800	356.200	6961.63	1241.70	1227.27	-540.18	40°09'54.154"N	104°37'46.509"W	0.25	
9278.00	90.800	356.800	6960.72	1416.60	1401.93	-550.87	40°09'55.880"N	104°37'46.647"W	0.67	
9450.00	90.000	357.100	6959.52	1588.54	1573.69	-560.02	40°09'57.577"N	104°37'46.765"W	0.50	
9622.00	90.000	357.300	6959.52	1760.50	1745.48	-568.42	40°09'59.275"N	104°37'46.873"W	0.12	
9792.00	90.400	358.700	6958.92	1930.49	1915.37	-574.35	40°10'00.954"N	104°37'46.949"W	0.86	
9963.00	89.200	358.700	6959.52	2101.48	2086.32	-578.23	40°10'02.643"N	104°37'46.999"W	0.70	
10133.00	89.400	357.900	6961.60	2271.47	2256.23	-583.27	40°10'04.322"N	104°37'47.064"W	0.49	
10306.00	89.200	359.500	6963.71	2444.45	2429.17	-587.20	40°10'06.031"N	104°37'47.115"W	0.93	
10480.00	90.800	359.200	6963.71	2618.42	2603.15	-589.17	40°10'07.750"N	104°37'47.140"W	0.94	
10654.00	90.100	357.900	6962.34	2792.41	2777.09	-593.58	40°10'09.469"N	104°37'47.197"W	0.85	
10825.00	91.100	358.200	6960.55	2963.39	2947.98	-599.39	40°10'11.158"N	104°37'47.272"W	0.61	
10997.00	89.800	359.400	6959.20	3135.38	3119.93	-603.00	40°10'12.857"N	104°37'47.319"W	1.03	
11171.00	90.300	358.800	6959.05	3309.36	3293.90	-605.73	40°10'14.576"N	104°37'47.354"W	0.45	
11342.00	91.000	358.200	6957.11	3480.35	3464.83	-610.20	40°10'16.266"N	104°37'47.412"W	0.54	
11514.00	90.600	358.700	6954.71	3652.33	3636.75	-614.86	40°10'17.964"N	104°37'47.472"W	0.37	
11686.00	89.300	358.200	6954.86	3824.33	3808.68	-619.51	40°10'19.663"N	104°37'47.532"W	0.81	
11857.00	89.900	357.900	6956.05	3995.32	3979.58	-625.33	40°10'21.352"N	104°37'47.607"W	0.39	
11963.00	90.200	356.900	6955.96	4101.30	4085.47	-630.14	40°10'22.399"N	104°37'47.669"W	0.98	Last BHI MWD+IFR Surveys
12018.00	90.200	356.900	6955.77	4156.28	4140.39	-633.11	40°10'22.941"N	104°37'47.707"W	0.00	Projection to Bit

HOLE & CASING SECTIONS - Ref Wellbore: GREENLEAF 2N-2HZ AWB <12018> Ref Wellpath: GREENLEAF 2N-2HZ AWP

String/Diameter	Start MD [ft]	End MD [ft]	Interval [ft]	Start TVD [ft]	End TVD [ft]	Start N/S [ft]	Start E/W [ft]	End N/S [ft]	End E/W [ft]
13.5in Open Hole	16.00	1294.00	1278.00	16.00	1293.93	0.00	0.00	2.78	-2.36
9.625in Casing Surface	16.00	1284.00	1268.00	16.00	1283.93	0.00	0.00	2.69	-2.39
8.75in Open Hole	1294.00	7489.00	6195.00	1293.93	6982.24	2.78	-2.36	-384.97	-478.45
7in Casing Intermediate	16.00	7479.00	7463.00	16.00	6982.13	0.00	0.00	-394.96	-478.19
6.125in Open Hole	7489.00	12018.00	4529.00	6982.24	6955.77	-384.97	-478.45	4140.39	-633.11

REFERENCE WELLPATH IDENTIFICATION

Operator	KERR-MCGEE OIL & GAS ONSHORE LP	Slot	SLOT#28 GREENLEAF 2N-2HZ (452' FSL & 1765' FEL, SEC.02)
Area	COLORADO	Well	GREENLEAF 2N-2HZ
Field	WELD COUNTY (KERR MCGEE)	Wellbore	GREENLEAF 2N-2HZ AWB <12018>
Facility	SEC.02-T2N-R65W		

TARGETS

Name	TVD [ft]	North [ft]	East [ft]	Grid East [US ft]	Grid North [US ft]	Latitude	Longitude	Shape
SEC.02-T2N-R65W LINES	0.00	0.40	-29.89	3243777.93	1302940.31	40°09'42.030"N	104°37'39.936"W	polygon
GREENLEAF 2N-2HZ BHL (460'FNL & 2265'FEL, SEC.02) REV-2	6972.00	4166.15	-614.08	3243152.81	1307099.92	40°10'23.196"N	104°37'47.462"W	point
GREENLEAF 2N-2HZ BHL ON PLAT (460'FNL & 2240'FEL, SEC.02) REV-1	6972.00	4166.15	-589.08	3243177.82	1307100.17	40°10'23.196"N	104°37'47.140"W	point
GREENLEAF 2N-2HZ LANDBOX	6972.00	0.00	0.00	3243807.82	1302940.19	40°09'42.026"N	104°37'39.551"W	polygon

WELLPATH COMPOSITION - Ref Wellbore: GREENLEAF 2N-2HZ AWB <12018> Ref Wellpath: GREENLEAF 2N-2HZ AWP

Start MD [ft]	End MD [ft]	Positional Uncertainty Model	Log Name/Comment	Wellbore
16.00	1249.00	ISWASA MWD, Rev. 3 (Standard)	CATHEDRAL ENERGY MWD SURVEYS <129-1249>	GREENLEAF 2N-2HZ AWB <12018>
1249.00	7440.00	NaviTrak (MAGCORR,IFR)	BHI MWD+IFR SURVEYS 8 3/4" HOLE <1363-7440>	GREENLEAF 2N-2HZ AWB <12018>
7440.00	11963.00	Unknown Tool (Standard)	BHI MWD+IFR SURVEYS 6 1/8" HOLE <7564-11963>	GREENLEAF 2N-2HZ AWB <12018>
11963.00	12018.00	Blind Drilling (std)	Projection to bit	GREENLEAF 2N-2HZ AWB <12018>

REFERENCE WELLPATH IDENTIFICATION

Operator	KERR-MCGEE OIL & GAS ONSHORE LP	Slot	SLOT#28 GREENLEAF 2N-2HZ (452' FSL & 1765' FEL, SEC.02)
Area	COLORADO	Well	GREENLEAF 2N-2HZ
Field	WELD COUNTY (KERR MCGEE)	Wellbore	GREENLEAF 2N-2HZ AWB <12018>
Facility	SEC.02-T2N-R65W		

WELLPATH COMMENTS

MD [ft]	Inclination [°]	Azimuth [°]	TVD [ft]	Comment
16.00	0.000	86.000	16.00	Tie-On
129.00	1.000	86.000	128.99	Begin CATHEDRAL MWD Surveys
1249.00	0.600	3.500	1248.94	Tie-Into CATHEDRAL MWD Surveys
1363.00	0.600	41.300	1362.93	Begin BHI MWD+IFR Surveys
7479.00	89.255	358.537	6982.13	7" Casing Point
11963.00	90.200	356.900	6955.96	Last BHI MWD+IFR Surveys
12018.00	90.200	356.900	6955.77	Projection to Bit