

# GRAPHIC SCALE

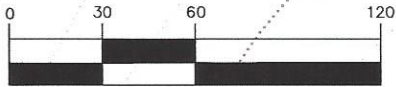

( IN FEET )

1 inch = 60 ft.

## Notes:

1. Contact utility line locators before digging. CALL 811
2. Earth work quantities are estimated and should be used at contractors own discretion.
3. Earth work is based on the removal of 6 inches of topsoil on all disturbed areas

4. ROAD SURFACES TO BE FINISHED WITH 6 INCHES OF CLASS 6 ROAD BASE AFTER INSTALLATION OF PIPELINE
5. Extra material is to be added to the fill slope of the pad.

## CUTTINGS PIT

Capacity with 2' freeboard = 2843 Bbls  
Total Pit Volume = 928 CY

DISTURBED AREA = 3.03 ACRES  
CUT SLOPES: 2:1  
FILL SLOPES: 2:1  
PAD QUANTITIES:  
TOTAL CUT = 5617 CUBIC YARDS  
TOTAL FILL = 5119 CUBIC YARDS  
SPOIL = 498 (CUT) CUBIC YARDS  
SPOIL DOES NOT INCLUDE TOP SOIL

COMPACTION SHRINKAGE NOT ACCOUNTED FOR IN VOL. CALCS. ESTIMATED AT 10%

ROAD QUANTITIES:  
TOTAL CUT: 80 CUBIC YARDS  
TOTAL FILL: 180 CUBIC YARDS  
SPOIL = 100 (FILL) CUBIC YARDS

TOP SOIL QUANTITY FOR PAD AND ROAD BASED ON 6 INCH DEPTH: 2444 CUBIC YARDS

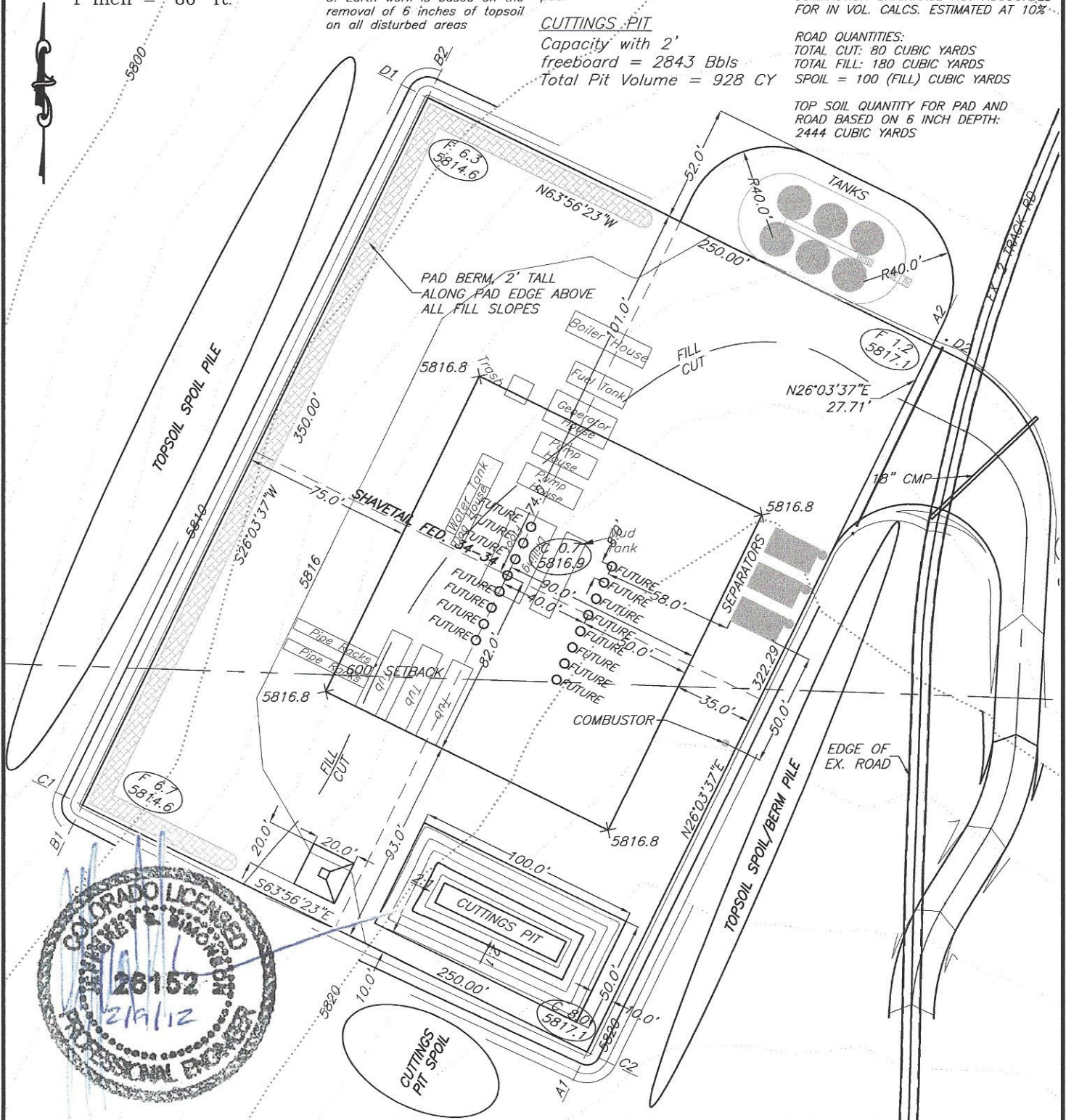

SGM INC.

118 W. 6th Street, Suite 200  
Glenwood Springs, Colorado 81601  
(970) 945-1004 (FAX 945-5948)  
Aspen, Colorado (970) 925-6727

Scale: 1" = 60'

Sheet 2A of 8

Pad 34-34

Shavetail 34 Construction Layout

Lot 3, Section 34, T.1N., R.103W, 6TH P.M.

Job# 2010-112.006

Date: 2.7.2012

By: DCS

File: 34-34BM