

NORTHWEST LININGS & GEOTEXTILE PRODUCTS, INC.

• 21000 77th Avenue South • Kent, WA 98032 •

Phone: (253) 872-0244 • Fax: (253) 872-0245

www.northwestlinings.com

LETTER OF TRANSMITTAL

TO:	Black Hills Exploration & Production	DATE: January 21, 2015	JOB #: N14152
	1515 Wynkoop, Suite 500	ATTENTION: Brett Hurlbut 303-828-7816 <brett.hurlbut@blackhillscorp.com>	
	Denver CO 80202	RE: De Beque Station Pond 1	
		- As-built Liner Submittal Package	

WE ARE SENDING YOU: ☐ Attached ☐ Under Separate Cover via _____ the following items:

☐ Shop Drawings ☐ Prints ☐ Plans ☐ Specifications ☐ Samples

☐ Copy of Letter ☐ Change Order ☐ Submittals ☐ Warranties ☐ Other

Copies	Specification #	Description
1		NWL shop drawings of As-built 60-mil HDPE MicroSpike geomembrane Secondary and Primary liner Panel Layouts.
1		As-built QC documentation for both Secondary and Primary liner layers, including: Panel Placement Forms, Trial Weld Logs, Panel Seaming Forms, Non Destructive Testing Forms, Destructive Testing Forms, and Repair Reports.

These are transmitted as checked below:

☐ For Approval ☐ Approved as submitted ☐ Resubmit ☐ Copies for Approval
☒ For your use ☐ Approved as noted ☐ Submit ☐ Copies for distribution
☐ For review and comment ☐ Returned for corrections ☐ Return ☐ Corrected Prints

☐ For bids due _____ ☐ Other _____

☐ Prints returned after loan to us

REMARKS:

COPY TO: _____ **SIGNED:** S.T. Snethen

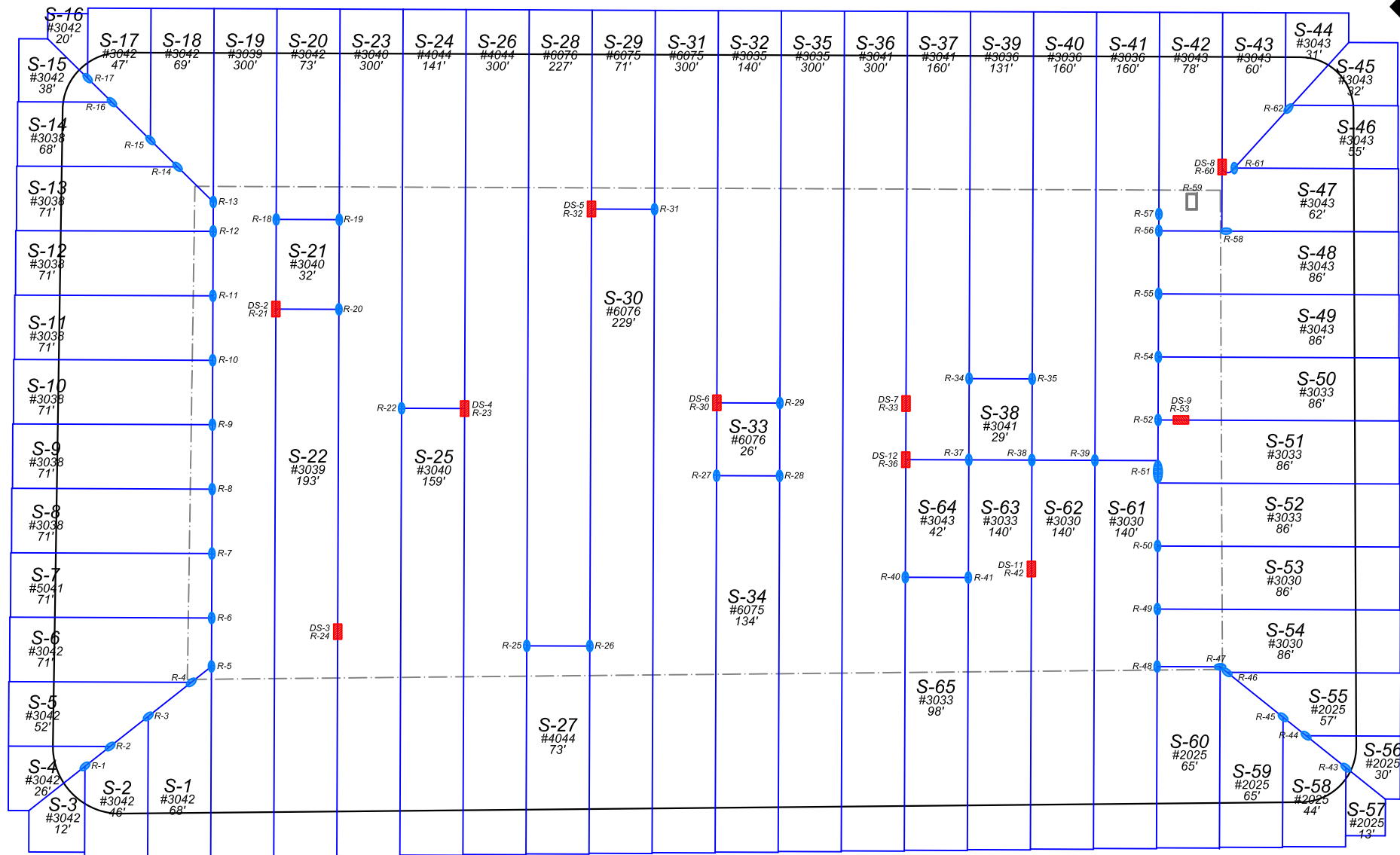

De Beque Station - Pond 1
As-built 60-mil MicroSpike HDPE Secondary liner Panel Layout

Legend:

- Destructive Test/Repair
- Patch

0' 15' 30' 60'

SHEET NO.

1 of 2

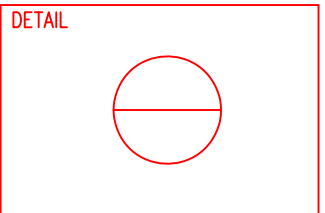

**NORTHWEST LININGS &
GEOTEXTILE PRODUCTS, Inc.**

www.northwestlinings.com
21000 77TH AVE. SOUTH
KENT, WA. 98032
(253) 872-0244 (253) 872-0245 FAX

JOB NAME:	De Beque Station Ponds		
JOB NO.	N 1 4 1 5 2		
DATE:	11 20 14	CHECKED:	KA
BY:	SG	SCALE:	AS SHOWN

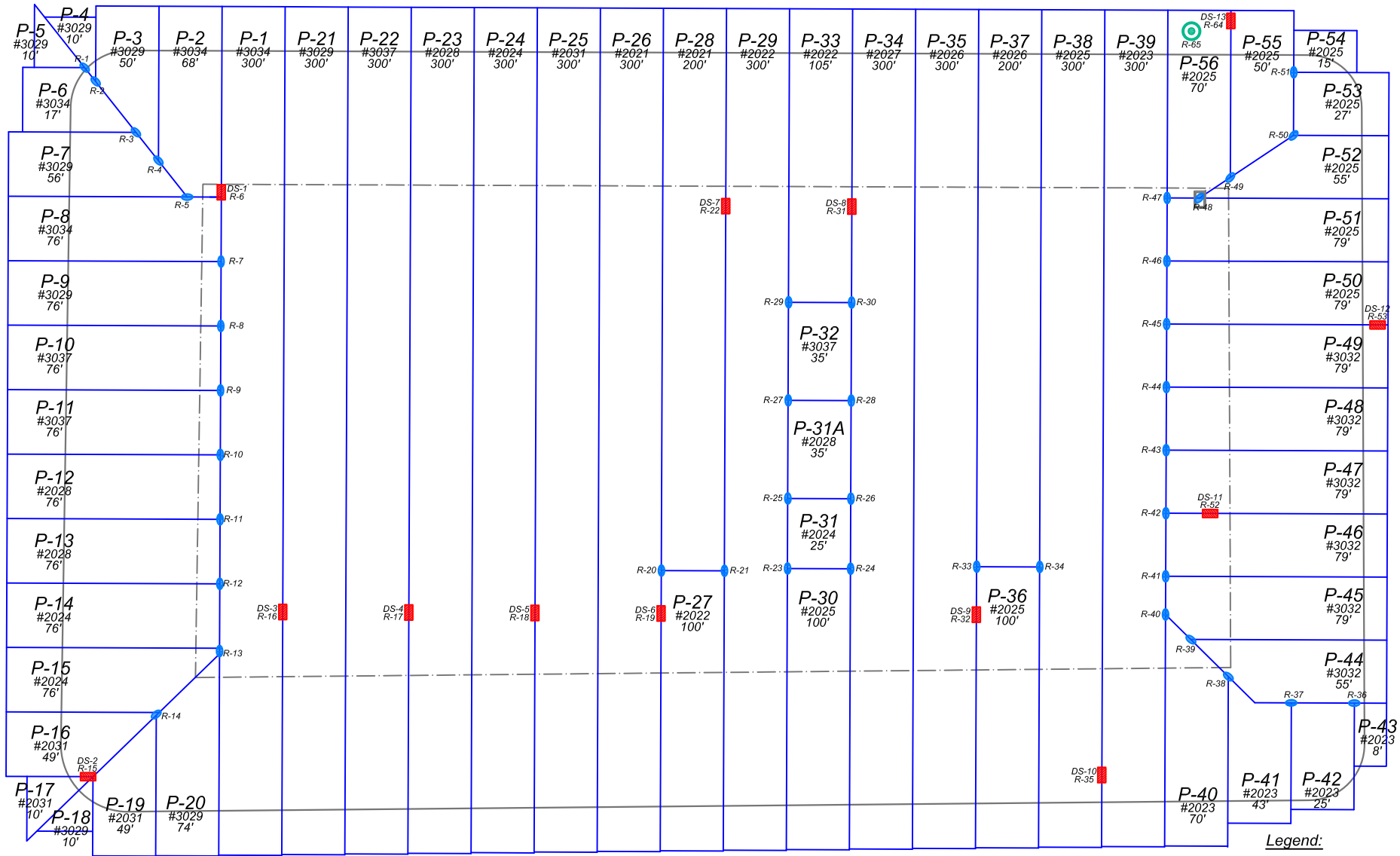

De Beque Station - Pond 1
As-built 60-mil MicroSpike HDPE Primary liner Panel Layout

Legend:

- - Destructive Test/Repair
- - Patch
- ⊗ - Pipe Boot

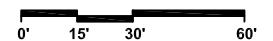

SHEET NO.

2 of 2

DETAIL

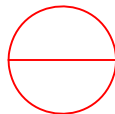

**NORTHWEST LININGS &
GEOTEXTILE PRODUCTS, Inc.**

www.northwestlinings.com
21000 77TH AVE. SOUTH
KENT, WA. 98032
(253) 872-0244 (253) 872-0245 FAX

JOB NAME:

De Beque Station Ponds

JOB NO.

N 1 4 1 5 2

DATE:

1 21 15

CHECKED:

KA

BY:

TS

SCALE:

AS SHOWN



**NORTHWEST LININGS &
GEOTEXTILE PRODUCTS, Inc.**

"Helping to Protect the Environment"

21000 77th Avenue South
Kent, WA 98032
(253) 872-0244 / (800) 729-6954
FAX: (253) 872-0245

Date: 11/5/2014
Job #: N14152

Panel Placement Form

Project Name:	De Beque Station Pond	Supervisor:	Joel Mondragon
Project Location:	De Beque, CO	Engineer:	WWC Engineering
Project Description:	Lagoons (secondary layer)	Contractor:	Black Hills Exploration & Production
Project Manager:	Kevin Allen	Contact:	Brett Hurlbut

Material: 60-mil Microspike

Date	Panel #	Length	Width	Roll Number	Panel Location / Comment
11/5/14	S-1	68'	23'	F14B353042	NW corner
11/5/14	S-2	46'	23'	F14B353042	NW corner
11/5/14	S-3	12'	12'	F14B353042	NW corner
11/5/14	S-4	26'	23'	F14B353042	NW corner
11/5/14	S-5	52'	23'	F14B353042	NW corner
11/5/14	S-6	71'	23'	F14B353042	NW corner
11/5/14	S-7	71'	23'	F14B35041	North slope
11/5/14	S-8	71'	23'	F14B353038	North slope
11/5/14	S-9	71'	23'	F14B353038	North slope
11/5/14	S-10	71'	23'	F14B353038	North slope
11/5/14	S-11	71'	23'	F14B353038	North slope
11/5/14	S-12	71'	23'	F14B353038	North slope
11/5/14	S-13	71'	23'	F14B353038	North slope
11/5/14	S-14	68'	23'	F14B353038	NE corner
11/5/14	S-15	38'	23'	F14B353042	NE corner
11/5/14	S-16	20'	13'	F14B353042	NE corner
11/5/14	S-17	47'	23'	F14B353042	NE corner
11/5/14	S-18	69'	23'	F14B353042	NE corner
11/5/14	S-19	300'	23'	F14B353039	Across pond East to West
11/5/14	S-20	73'	23'	F14B353042	East slope
11/5/14	S-21	32'	23'	F14B353040	Floor panel
11/5/14	S-22	193'	23'	F14B353039	West end across floor
11/5/14	S-23	300'	23'	F14B353040	Across pond East to West
11/6/14	S-24	141'	23'	F14B354044	East end across floor
11/6/14	S-25	159'	23'	F14B353040	West end across floor
11/6/14	S-26	300'	23'	F14B354044	Across pond East to West
11/6/14	S-27	73'	23'	F14B354044	West slope
11/6/14	S-28	227'	23'	F14B356076	East end across floor
11/6/14	S-29	71'	23'	F14B356075	East slope
11/6/14	S-30	229'	23'	F14B356076	West end across floor
11/6/14	S-31	300'	23'	F14B356075	Across pond East to West
11/6/14	S-32	140'	23'	F14B353035	East end across floor
11/6/14	S-33	26'	23'	F14B356076	Floor panel
11/6/14	S-34	134'	23'	F14B356075	West end across floor
11/6/14	S-35	300'	23'	F14B353035	Across pond East to West
11/7/14	S-36	300'	23'	F14B353041	Across pond East to West

Notes: _____

**NORTHWEST LININGS &
GEOTEXTILE PRODUCTS, Inc.**
"Helping to Protect the Environment"

21000 77th Avenue South

Kent, WA 98032

(253) 872-0244 / (800) 729-6954

FAX: (253) 872-0245

Date: 11/5/2014

Job #: N14152

Panel Placement Form

Project Name: De Beque Station Pond
 Project Location: De Beque, CO
 Project Description: Lagoons (secondary layer)
 Project Manager: Kevin Allen

Supervisor: Joel Mondragon
 Engineer: WWC Engineering
 Contractor: Black Hills Exploration & Production
 Contact: Brett Hurlbut

Material: 60-mil Microspike

Date	Panel #	Length	Width	Roll Number	Panel Location / Comment
11/7/14	S-37	160'	23'	F14B353041	East slope across the floor
11/7/14	S-38	29'	23'	F14B353041	Floor panel
11/7/14	S-39	131'	23'	F14B353036	East slope across the floor
11/7/14	S-40	160'	23'	F14B353036	East slope across the floor
11/7/14	S-41	160'	23'	F14B353036	East slope across the floor
11/7/14	S-42	78'	23'	F14B353043	East slope sump area
11/7/14	S-43	60'	23'	F14B353043	SE corner
11/7/14	S-44	31'	23'	F14B353043	SE corner
11/7/14	S-45	32'	23'	F14B353043	SE corner
11/7/14	S-46	55'	23'	F14B353043	SE corner
11/7/14	S-47	62'	23'	F14B353043	SE corner
11/7/14	S-48	86'	23'	F14B353043	South slope
11/7/14	S-49	86'	23'	F14B353043	South slope
11/7/14	S-50	86'	23'	F14B353033	South slope
11/7/14	S-51	86'	23'	F14B353033	South slope
11/7/14	S-52	86'	23'	F14B353033	South slope
11/7/14	S-53	86'	23'	F14B353030	South slope
11/7/14	S-54	86'	23'	F14B353030	South slope
11/7/14	S-55	57'	23'	F14B352025	SW corner
11/7/14	S-56	30'	23'	F14B352025	SW corner
11/7/14	S-57	13'	11'	F14B352025	SW corner
11/7/14	S-58	44'	23'	F14B352025	SW corner
11/7/14	S-59	65'	23'	F14B352025	SW corner
11/7/14	S-60	65'	23'	F14B352025	SW corner
11/7/14	S-61	140'	23'	F14B353030	West slope across floor
11/7/14	S-62	140'	23'	F14B353030	West slope across floor
11/7/14	S-63	140'	23'	F14B353033	West slope across floor
11/7/14	S-64	42'	23'	F14B353043	Floor panel
11/7/14	S-65	98'	23'	F14B353033	West slope across floor

Notes:

**NORTHWEST LININGS &
GEOTEXTILE PRODUCTS, Inc.**
"Helping to Protect the Environment"

 21000 77th Avenue South
 Kent, WA 98032
 (253) 872-0244 / (800) 729-6954
 FAX: (253) 872-0245

Date: 11/5/2014

Job #: N14152

Geomembrane Fusion Weld Trial Log

Project Name: De Beque Station Ponds
 Project Location: De Beque, CO
 Project Description: Lagoon Secondary Layer
 Project Manager: Kevin Allen

Supervisor: Joel Mondragon
 Engineer: WWC Engineering
 Contractor: Black Hills Exploration
 Contact: Brett Hurlbut

Material: 60-mil HD Microspike

Date/ Time	Seamer Initials	Machine Number	Wedge Welder		Extruder		Track Peel Values			Tensile Value		
			Wedge Temp	Nip Roller Speed	Barrel Temp	Preheat Temp	In- side	Out- side	Pass/ Fail	LBS/I nch	Rate	Pass/ Fail
11/5/2014 8:35 AM	AM	3326	800	5			166	179	Pass	224		Pass
Comments:							162	161	Pass	212		Pass
							162	159	Pass			
							Ambient Temp: 55					
11/5/2014 1:05 PM	AM	3326	800	5			139	122	Pass	215		Pass
Comments:							129	125	Pass	212		Pass
							120	126	Pass			
							Ambient Temp: 60					
11/6/2014 9:20 AM	AM	3326	800	5			135	164	Pass	226		Pass
Comments:							165	164	Pass	227		Pass
							139	144	Pass			
							Ambient Temp: 55					
11/6/2014 12:40 PM	AM	3326	800	5			127	145	Pass	206		Pass
Comments:							149	143	Pass	204		Pass
							134	146	Pass			
							Ambient Temp: 60					
11/7/2014 9:30 AM	AM	5602			500	450	131		Pass	191		Pass
Comments:							132		Pass	193		Pass
							134		Pass			
							Ambient Temp: 55					
11/7/2014 12:05 PM	AM	3326	800	5			127	145	Pass	206		Pass
Comments:							149	133	Pass	206		Pass
							139	153	Pass			
							Ambient Temp: 55					
11/8/2014 8:30 AM	AM	3326	800	5			125	145	Pass	230		Pass
Comments:							135	137	Pass	233		Pass
							132	148	Pass			
							Ambient Temp: 55					
11/8/2014 12:50 PM	AM	3326	800	5			120	122	Pass	198		Pass
Comments:							131	123	Pass	205		Pass
							129	128	Pass			
							Ambient Temp: 60					

**NORTHWEST LININGS &
GEOTEXTILE PRODUCTS, Inc.**
"Helping to Protect the Environment"

 21000 77th Avenue South
 Kent, WA 98032
 (253) 872-0244 / (800) 729-6954
 FAX: (253) 872-0245

 Date: 11/9/2014
 Job #: N14152

Geomembrane Fusion Weld Trial Log

Project Name:	De Beque Station Ponds	Supervisor:	Joel Mondragon
Project Location:	De Beque, CO	Engineer:	WWC Engineering
Project Description:	Lagoon Secondary Layer	Contractor:	Black Hills Exploration
Project Manager:	Kevin Allen	Contact:	Brett Hurlbut

Material: 60-mil HD Microspike

Date/ Time	Seamer Initials	Machine Number	Wedge Welder		Extruder		Track Peel Values			Tensile Value		
			Wedge Temp	Nip Roller Speed	Barrel Temp	Preheat Temp	In- side	Out- side	Pass/ Fail	LBS/I nch	Rate	Pass/ Fail
11/9/2014 8:45 AM	AM	5602			500	450	130		Pass	181		Pass
							121		Pass	192		Pass
Comments:							139		Pass			
Ambient Temp: 55												
11/9/2014 12:30 PM	AM	5602			500	450	133		Pass	198		Pass
							135		Pass	200		Pass
Comments:							129		Pass			
Ambient Temp: 60												
Comments:												
Ambient Temp: \												
Comments:												
Ambient Temp:												
Comments:												
Ambient Temp:												
Comments:												
Ambient Temp:												
Comments:												
Ambient Temp:												
Comments:												
Ambient Temp:												



**NORTHWEST LININGS &
GEOTEXTILE PRODUCTS, Inc.**
"Helping to Protect the Environment"
 21000 77th Avenue South
 Kent, WA 98032
 (253) 872-0244 / (800) 729-6954
 FAX: (253) 872-0245

Date: 11/5/2014
 Job #: N14152

Panel Seaming Form

Project Name: De Beque Station Ponds
 Project Location: De Beque, Co.
 Project Description: Lagoon Secondary Layer
 Project Manager: Kevin Allen

Supervisor: Joel Mondragon
 Engineer: WWC Engineering
 Contractor: Black Hills Exploration
 Contact: Brett Hurlbut

Material: 60-mil HD Microspike

Date/ Time	Seam Number	Panel Numbers	Seam Length	Seamer Initials	Machine Number	Machine Temp	Ambient Temp	Weather / Comments
11/5/14 11:30 AM	1	P1/P2	46'	AM	3326	800	55	Clear / NW corner
11/5/14 11:35 AM	2	P2/P3	12'	AM	3326	800	55	Clear / NW corner
11/5/14 11:50 AM	3	NW corner buttseam	75'	AM	3326	800	55	NW corner pnls 1,2,3/4,5,6
11/5/14 11:40 AM	4	P4/P5	26'	AM	3326	800	55	Clear / NW corner
11/5/14 11:45 AM	5	P5/P6	52'	AM	3326	800	55	Clear / NW corner
11/5/14 11:20 AM	6	P6/P7	71'	AM	3326	800	55	Clear / North slope
11/5/14 11:05 AM	7	P7/P8	71'	AM	3326	800	55	Clear / North slope
11/5/14 9:20 AM	8	P8/P9	71'	AM	3326	800	55	Clear / North slope
11/5/14 9:10 AM	9	P9/P10	71'	AM	3326	800	55	Clear / North slope
11/5/14 9:00 AM	10	P10/P11	71'	AM	3326	800	55	Clear / North slope
11/5/14 8:45 AM	11	P11/P12	71'	AM	3326	800	55	Clear / North slope
11/5/14 9:40 AM	12	P12/P13	71'	AM	3326	800	55	Clear / North slope
11/5/14 10:00 AM	13	P13/P14	68'	AM	3326	800	55	Clear / NE corner
11/5/14 10:10 AM	14	P14/P15	38'	AM	3326	800	55	Clear / NE corner
11/5/14 10:30 AM	15	NE corner buttseam	79'	AM	3326	800	55	NE corner pnls 14,15/16,17,18
11/5/14 10:15 AM	16	P16/P17	20'	AM	3326	800	55	Clear / NE corner
11/5/14 10:20 AM	17	P17/P18	47'	AM	3326	800	55	Clear / NE corner
11/5/14 1:25 PM	18	N buttseam	300'	AM	3326	800	65	Buttseam 19/1,6thru13&18
11/5/14 3:10 PM	19	P20/P21	23'	AM	3326	800	65	Clear / buttseam
11/5/14 3:15 PM	20	P21/P22	23'	AM	3326	800	65	Clear / buttseam



**NORTHWEST LININGS &
GEOTEXTILE PRODUCTS, Inc.**
"Helping to Protect the Environment"
 21000 77th Avenue South
 Kent, WA 98032
 (253) 872-0244 / (800) 729-6954
 FAX: (253) 872-0245

Date: 11/5/2014
 Job #: N14152

Panel Seaming Form

Project Name: De Beque Station Ponds
 Project Location: De Beque, Co.
 Project Description: Lagoon Secondary Layer
 Project Manager: Kevin Allen

Supervisor: Joel Mondragon
 Engineer: WWC Engineering
 Contractor: Black Hills Exploration
 Contact: Brett Hurlbut

Material: 60-mil HD Microspike

Date/ Time	Seam Number	Panel Number	Seam Length	Seamer Initials	Machine Number	Machine Temp	Ambient Temp	Weather / Comments
11/5/14 3:20 PM	21	P19/20,21,22	300'	AM	3326	800	65	Clear / Across E to W
11/5/14 3:55 PM	22	20,21,22/23	300'	AM	3326	800	65	Clear / Across E to W
11/6/14 9:30 AM	23	P24/P25	23'	AM	3326	800	55	Buttseam
11/6/14 9:50 AM	24	P23/P24,P25	300'	AM	3326	800	55	Clear / Across E to W
11/6/14 10:30 AM	25	P24,P25/P26	300'	AM	3326	800	55	Clear / Across E to W
11/6/14 11:10 AM	26	P27/P28	23'	AM	3326	800	55	Buttseam
11/6/14 11:20 AM	27	P26/P27,P28	300'	AM	3326	800	55	Clear / Across E to W
11/6/14 12:55 AM	28	P29/P30	23'	AM	3326	800	65	Buttseam
11/6/14 1:05 PM	29	27,28/29,30	300'	AM	3326	800	65	Clear / Across E to W
11/6/14 2:10 PM	30	P29/P30/P31	300'	AM	3326	800	65	Clear / Across E to W
11/6/14 3:00 PM	31	P32/P33	23'	AM	3326	800	65	Buttseam
11/6/14 3:05 PM	32	P33/P34	23'	AM	3326	800	65	Buttseam
11/6/14 3:10 PM	33	P31/32,33,34	300'	AM	3326	800	65	Clear / Across E to W
11/6/14 3:50 PM	34	32,33,34/35	300'	AM	3326	800	65	Clear / Across E to W
11/7/14 12:00 PM	35	P35/P36	300'	AM	3326	800	65	Clear / Across E to W
11/7/14 1:20 PM	36	P36/P37	160'	AM	3326	800	65	Clear / E end across floor
11/7/14 1:45 PM	37	P38/P39	23'	AM	3326	800	65	Buttseam
11/7/14 1:50 PM	38	P37/P38,P39	160'	AM	3326	800	65	Clear / E end across floor
11/7/14 2:40 PM	39	P38,P39/P40	160'	AM	3326	800	65	Clear / E end across floor
11/7/14 2:20 PM	40	P40/P41	160'	AM	3326	800	65	Clear / E end across floor



**NORTHWEST LININGS &
GEOTEXTILE PRODUCTS, Inc.**
"Helping to Protect the Environment"
 21000 77th Avenue South
 Kent, WA 98032
 (253) 872-0244 / (800) 729-6954
 FAX: (253) 872-0245

Date: 11/7/2014
 Job #: N14152

Panel Seaming Form

Project Name: De Beque Station Ponds
 Project Location: De Beque, Co.
 Project Description: Lagoon Secondary Layer
 Project Manager: Kevin Allen

Supervisor: Joel Mondragon
 Engineer: WWC Engineering
 Contractor: Black Hills Exploration
 Contact: Brett Hurlbut

Material: 60-mil HD Microspike

Date/ Time	Seam Number	Panel Number	Seam Length	Seamer Initials	Machine Number	Machine Temp	Ambient Temp	Weather / Comments
11/7/14 2:10 PM	41	P41/P42	78'	AM	3326	800	65	Clear / SE corner
11/7/14 3:10 PM	42	P42/P43	60'	AM	3326	800	65	Clear / SE corner
11/7/14 3:25 PM	43	P43/P44	31'	AM	3326	800	65	Clear / SE corner
11/7/14 3:45 PM	44	SE corner buttseam	68'	AM	3326	800	65	Buttseam 43,44/45,46,47
11/7/14 3:30 PM	45	P45/P46	27'	AM	3326	800	65	Clear / SE corner
11/7/14 3:35 PM	46	P46/P47	62'	AM	3326	800	65	Clear / SE corner
11/8/14 8:30 AM	47	42,47/P48	86'	AM	3326	800	55	Clear / South slope
11/8/14 8:55 AM	48	P48/P49	86'	AM	3326	800	55	Clear / South slope
11/8/14 9:10 AM	49	P49/P50	86'	AM	3326	800	55	Clear / South slope
11/8/14 10:45 AM	50	P50/P51	86'	AM	3326	800	55	Clear / South slope
11/8/14 2:45 PM	51	P51/P52	86'	AM	3326	800	65	Clear / South slope
11/8/14 3:45 PM	52	P52/P53	86'	AM	3326	800	65	Clear / South slope
11/8/14 4:00 PM	53	P53/P54	86'	AM	3326	800	65	Clear / South slope
11/8/14 4:10 PM	54	P54/P55	57'	AM	3326	800	65	Clear / SW corner
11/8/14 4:20 PM	55	P55/P56	30'	AM	3326	800	65	Clear / SW corner
11/8/14 4:24 PM	56	P57/P58	13'	AM	3326	800	65	Clear / SW corner
11/8/14 4:30 PM	57	P58/P59	44'	AM	3326	800	65	Clear / SW corner
11/8/14 4:35 PM	58	P59/P60	65'	AM	3326	800	65	Clear / SW corner
11/8/14 4:45 PM	59	SW corner buttseam	97'	AM	3326	800	65	SW butt 54,55,56/57,58,59,60
11/8/14 5:05 PM	60	S buttseam	222'	AM	3326	800	65	S butt 48 thru 54,60/61,41

21000 77th Avenue South
Kent, WA 98032
(253) 872-0244 / (800) 729-6954
FAX: (253) 872-0245

Date: 11/8/2014
Job #: N14152

Supervisor: Joel Mondragon
Engineer: WWC Engineering
Contractor: Black Hills Exploration
Contact: Brett Hurlbut

[illegible]



**NORTHWEST LININGS &
GEOTEXTILE PRODUCTS, Inc.**
"Helping to Protect the Environment"

21000 77th Avenue South
Kent, WA 98032
(253) 872-0244 / (800) 729-6954
FAX: (253) 872-0245

Date: 11/6/2014
Job #: N14152

Non Destructive Testing Form

Project Name: De Beque Station Ponds
Project Location: De Beque, Co.
Project Description: Lagoon (Secondary Layer)
Project Manager: Kevin Allen

Supervisor: Joel Mondragon
Engineer: WWC Engineering
Contractor: Black Hills Exploration
Contact: Brett Hurlbut

Material: 60-mil HD Microspike

			Air Pressure Testing							
Date/ Time	Panel Numbers	Seamer Initials	Start Pressure	Start Time	End Pressure	End Time	Pressure Loss	Pass/ Fail	V-Box Pass/ Fail	Comments / Location
11/6/14	P3/P4	GR	30	8:35	30	8:40	0	Pass		11' Seam NW corner
11/6/14	P2/P3	GR	30	8:36	30	8:41	0	Pass		12' Seam NW corner
11/6/14	P4/P2	GR	30	8:37	30	8:42	0	Pass		12' Seam NW corner
11/6/14	P4/P5	GR	30	8:40	30	8:45	0	Pass		26' Seam NW corner
11/6/14	P2/P5	GR	30	8:41	30	8:46	0	Pass		21' Seam NW corner
11/6/14	P5/P1	GR	30	8:44	30	8:49	0	Pass		11' Seam NW corner
11/6/14	P5/P6	GR	30	8:45	30	8:50	0	Pass		52' Seam NW corner
11/6/14	P1/P6	GR	30	8:46	30	8:51	0	Pass		20' Seam NW corner
11/6/14	P1/P19	GR	30	8:47	30	8:52	0	Pass		68' North buttseam
11/6/14	P19/P6	GR	30	8:53	30	8:58	0	Pass		11' North buttseam
11/6/14	P19/P7	GR	30	8:54	30	8:59	0	Pass		23' North buttseam
11/6/14	P6/P7	GR	30	8:55	30	9:00	0	Pass		71' Seam North slope
11/6/14	P7/P8	GR	30	8:56	30	9:01	0	Pass		71' Seam North slope
11/6/14	P19/P8	GR	30	8:57	30	9:02	0	Pass		23' North buttseam
11/6/14	P8/P9	GR	30	8:58	30	9:03	0	Pass		71' Seam North slope
11/6/14	P9/P19	GR	30	8:59	30	9:04	0	Pass		23' North buttseam
11/6/14	P9/P10	GR	30	9:01	30	9:06	0	Pass		71' Seam North slope
11/6/14	P10/P19	GR	30	9:02	30	9:07	0	Pass		23' North buttseam
11/6/14	P10/P11	GR	30	9:03	30	9:08	0	Pass		71' Seam North slope
11/6/14	P11/P19	GR	30	9:04	30	9:09	0	Pass		23' North buttseam



**NORTHWEST LININGS &
GEOTEXTILE PRODUCTS, Inc.**
"Helping to Protect the Environment"
 21000 77th Avenue South
 Kent, WA 98032
 (253) 872-0244 / (800) 729-6954
 FAX: (253) 872-0245

Date: 11/6/2014
 Job #: N14152

Non Destructive Testing Form

Project Name: De Beque Station Ponds
 Project Location: De Beque, Co.
 Project Description: Lagoon (Secondary Layer)
 Project Manager: Kevin Allen

Supervisor: Joel Mondragon
 Engineer: WWC Engineering
 Contractor: Black Hills Exploration
 Contact: Brett Hurlbut

Material: 60-mil HD Microspike

			Air Pressure Testing							
Date/ Time	Panel Numbers	Seamer Initials	Start Pressure	Start Time	Ending Pressure	End Time	Pressure Loss	Pass/ Fail	V-Box Pass/ Fail	Comments / Location
11/6/14	P11P12	GR	30	9:10	30	9:15	0	Pass		71' Seam North slope
11/6/14	P12/P19	GR	30	9:11	30	9:16	0	Pass		23' North buttseam
11/6/14	P12/P13	GR	30	9:12	30	9:17	0	Pass		71' Seam North slope
11/6/14	P13/P19	GR	30	9:13	30	9:18	0	Pass		23' North buttseam
11/6/14	P13/P14	GR	30	9:16	30	9:21	0	Pass		68' Seam NE corner
11/6/14	P14/P18	GR	30	9:15	30	9:20	0	Pass		32' Seam NE corner
11/6/14	P18/P19	GR	30	9:14	30	9:19	0	Pass		61' North Buttseam
11/6/14	P17/P18	GR	30	9:22	30	9:27	0	Pass		47' Seam NE corner
11/6/14	P17/P14	GR	30	9:23	30	9:28	0	Pass		10' Seam NE corner
11/6/14	P15/P17	GR	30	9:26	30	9:31	0	Pass		19' Seam NE corner
11/6/14	P14/P15	GR	30	9:27	30	9:32	0	Pass		38' Seam NE corner
11/6/14	P16/P17	GR	30	9:29	30	9:34	0	Pass		20' Seam NE corner
11/6/14	P15/P16	GR	30	9:30	30	9:35	0	Pass		19' Seam NE corner
11/6/14	P19/P20	GR	30	9:38	30	9:43	0	Pass		73' Seam E end to Buttseam
11/6/14	P20/P21	GR	30	9:39	30	9:44	0	Pass		23' Buttseam
11/6/14	P19/P21	GR	30	9:40	30	9:45	0	Pass		32' Seam buttseam to buttseam
11/6/14	P20/P21	GR	30	9:41	30	9:46	0	Pass		73' Seam E end to Buttseam
11/6/14	P21/P23	GR	30	9:42	30	9:47	0	Pass		32' Seam buttseam to buttseam
11/6/14	P19/P22	GR	30	9:43	30	9:48	0	Pass		193' Seam W end to buttseam
11/6/14	P22/P23	GR	30	9:47	30	9:52	0	Pass		193' Seam W end to buttseam



**NORTHWEST LININGS &
GEOTEXTILE PRODUCTS, Inc.**
"Helping to Protect the Environment"
 21000 77th Avenue South
 Kent, WA 98032
 (253) 872-0244 / (800) 729-6954
 FAX: (253) 872-0245

Date: 11/6/2014
 Job #: N14152

Non Destructive Testing Form

Project Name: De Beque Station Ponds
 Project Location: De Beque, Co.
 Project Description: Lagoon (Secondary Layer)
 Project Manager: Kevin Allen

Supervisor: Joel Mondragon
 Engineer: WWC Engineering
 Contractor: Black Hills Exploration
 Contact: Brett Hurlbut

Material: 60-mil HD Microspike

Date/ Time	Panel Numbers	Seamer Initials	Air Pressure Testing						V-Box Pass/ Fail	Comments / Location
			Start Pressure	Start Time	Ending Pressure	End Time	Pressure Loss	Pass/ Fail		
11/7/14	P23/P25	GR	30	7:34	30	7:39	0	Pass		159' Seam W end to buttseam
11/7/14	P23/P24	GR	30	7:35	30	7:40	0	Pass		141' Seam E end to buttseam
11/7/14	P24/P25	GR	30	7:36	30	7:41	0	Pass		23' Buttseam
11/7/14	P24/P26	GR	30	7:40	30	7:45	0	Pass		141' Seam E end to buttseam
11/7/14	P25/P26	GR	30	7:42	30	7:47	0	Pass		159' Seam W end to buttseam
11/7/14	P27/P28	GR	30	7:48	30	7:53	0	Pass		23' Buttseam
11/7/14	P26/P27	GR	30	7:49	30	7:54	0	Pass		73' Seam W end to buttseam
11/7/14	P26/P28	GR	30	7:50	30	7:55	0	Pass		227' Seam E end to buttseam
11/7/14	P27/P30	GR	30	7:51	30	7:56	0	Pass		73' Seam W end to buttseam
11/7/14	P28/P30	GR	30	7:52	30	7:57	0	Pass		202' Seam buttseam to buttseam
11/7/14	P28/P29	GR	30	7:55	30	8:00	0	Pass		71' Seam E end to buttseam
11/7/14	P29/P30	GR	30	7:56	30	8:01	0	Pass		23' Buttseam
11/7/14	P30/P31	GR	30	7:59	30	8:04	0	Pass		229' Seam W end to buttseam
11/7/14	P29/P31	GR	30	8:00	30	8:05	0	Pass		71' Seam E end to buttseam
11/7/14	P31/P32	GR	30	8:03	30	8:08	0	Pass		140' Seam E end to buttseam
11/7/14	P32/P35	GR	30	8:04	30	8:09	0	Pass		140' Seam E end to buttseam
11/7/14	P32/P33	GR	30	8:11	30	8:16	0	Pass		23' Buttseam
11/7/14	P33/P35	GR	30	8:12	30	8:17	0	Pass		26' Seam buttseam to buttseam
11/7/14	P31/P33	GR	30	8:14	30	8:19	0	Pass		26' Seam buttseam to buttseam
11/7/14	P31/P34	GR	30	8:16	30	8:21	0	Pass		134' Seam W end to buttseam



**NORTHWEST LININGS &
GEOTEXTILE PRODUCTS, Inc.**
"Helping to Protect the Environment"

21000 77th Avenue South
Kent, WA 98032
(253) 872-0244 / (800) 729-6954
FAX: (253) 872-0245

Date: 11/7/2014
Job #: N14152

Non Destructive Testing Form

Project Name: De Beque Station Ponds
Project Location: De Beque, Co.
Project Description: Lagoon (Secondary Layer)
Project Manager: Kevin Allen

Supervisor: Joel Mondragon
Engineer: WWC Engineering
Contractor: Black Hills Exploration
Contact: Brett Hurlbut

Material: 60-mil HD Microspike

			Air Pressure Testing							
Date/ Time	Panel Numbers	Seamer Initials	Start Pressure	Start Time	Ending Pressure	End Time	Pressure Loss	Pass/ Fail	V-Box Pass/ Fail	Comments / Location
11/7/14	P33/P34	GR	30	8:24	30	8:25	0	Pass		23' Buttseam
11/7/14	P34/P35	GR	30	8:25	30	8:30	0	Pass		134' Seam W end to buttseam
11/7/14	P35/P36	GR	30	3:50	30	3:55	0	Pass		300' Seam Across E to W
11/7/14	P36/P37	GR	30	3:51	30	3:56	0	Pass		160' Seam E end to buttseam
11/7/14	P37/P38	GR	30	3:52	30	3:57	0	Pass		29' Seam buttseam to buttseam
11/7/14	P37/P39	GR	30	3:53	30	3:58	0	Pass		131' Seam E end to buttseam
11/7/14	P38/P39	GR	30	3:54	30	3:59	0	Pass		23' Buttseam
11/7/14	P38/P40	GR	30	3:55	30	4:00	0	Pass		29' Seam buttseam to buttseam
11/7/14	P39/P40	GR	30	3:56	30	4:01	0	Pass		131' Seam E end to buttseam
11/7/14	P40/P41	GR	30	4:05	30	4:10	0	Pass		160' Seam E end to buttseam
11/7/14	P41/P42	GR	30	4:07	30	4:12	0	Pass		78' Seam e end to buttseam
11/7/14	P42/P43	GR	30	4:11	30	4:16	0	Pass		60' Seam SE corner
11/7/14	P46/P47	GR	30	4:12	30	4:17	0	Pass		55' Seam SE corner
11/7/14	P43/P46	GR	30	4:13	30	4:18	0	Pass		31' Seam SE corner
11/7/14	P43/P44	GR	30	4:17	30	4:22	0	Pass		31' Seam SE corner
11/7/14	P44/P45	GR	30	4:18	30	4:23	0	Pass		24' Seam SE corner
11/7/14	P45/P46	GR	30	4:19	30	4:24	0	Pass		27' Seam SE corner
11/8/14	P47/P48	GR	30	11:03	30	11:08	0	Pass		62' Seam S slope
11/8/14	P42/P48	GR	30	11:04	30	11:09	0	Pass		23' Buttseam
11/8/14	P48/P49	GR	30	11:05	30	11:10	0	Pass		86' Seam S slope



**NORTHWEST LININGS &
GEOTEXTILE PRODUCTS, Inc.**

"Helping to Protect the Environment"

21000 77th Avenue South
Kent, WA 98032
(253) 872-0244 / (800) 729-6954
FAX: (253) 872-0245

Date: 11/8/2014
Job #: N14152

Non Destructive Testing Form

Project Name: De Beque Station Ponds
Project Location: De Beque, Co.
Project Description: Lagoon (Secondary Layer)
Project Manager: Kevin Allen

Supervisor: Joel Mondragon
Engineer: WWC Engineering
Contractor: Black Hills Exploration
Contact: Brett Hurlbut

Material: 60-mil HD Microspike

			Air Pressure Testing							
Date/ Time	Panel Numbers	Seamer Initials	Start Pressure	Start Time	Ending Pressure	End Time	Pressure Loss	Pass/ Fail	V-Box Pass/ Fail	Comments / Location
11/8/14	P49/P50	GR	30	11:11	30	11:16	0	Pass		86' Seam S slope
11/8/14	P50/P51	GR	30	11:12	30	11:17	0	Pass		86' Seam S slope
11/8/14	P41/P51	GR	30	11:20	30	11:25	0	Pass		19' S buttseam
11/8/14	P41/P50	GR	30	11:21	30	11:26	0	Pass		23' S buttseam
11/8/14	P41/P49	GR	30	11:22	30	11:27	0	Pass		23' S buttseam
11/8/14	P41/P48	GR	30	11:23	30	11:28	0	Pass		23' S buttseam
11/8/14	P51/P52	GR	30	4:45	30	4:50	0	Pass		86' Seam S slope
11/8/14	P52/P53	GR	30	4:46	30	4:51	0	Pass		86' Seam S slope
11/8/14	P53/P54	GR	30	4:47	30	4:52	0	Pass		86' Seam S slope
11/8/14	P54/P60	GR	30	4:52	30	4:57	0	Pass		23' Seam SW corner
11/8/14	P54/P59	GR	30	4:53	30	4:58	0	Pass		12' Seam SW corner
11/8/14	P59/P60	GR	30	4:54	30	4:59	0	Pass		65' Seam SW corner
11/8/14	P54/P55	GR	30	5:00	30	5:05	0	Pass		57' Seam SW corner
11/8/14	P55/P59	GR	30	5:01	30	5:06	0	Pass		20' Seam SW corner
11/8/14	P58/P59	GR	30	5:02	30	5:07	0	Pass		44' Seam SW corner
11/8/14	P55/P58	GR	30	5:03	30	5:08	0	Pass		16' Seam SW corner
11/8/14	P55/P56	GR	30	5:04	30	5:09	0	Pass		30' Seam SW corner
11/8/14	P58/P56	GR	30	5:12	30	5:17	0	Pass		15' Seam SW corner
11/8/14	P57/P58	GR	30	5:13	30	5:18	0	Pass		13' Seam SW corner
11/8/14	P56/P57	GR	30	5:14	30	5:19	0	Pass		11' Seam SW corner

Date: 11/8/2014
Job #: N14152

Project Name:	De Beque Station Ponds
Project Location:	De Beque, Co.
Project Description:	Lagoon (Secondary Layer)
Project Manager:	Kevin Allen

Supervisor: Joel Mondragon
Engineer: WWC Engineering
Contractor: Black Hills Exploration
Contact: Brett Hurlbut

[illegible]



**NORTHWEST LININGS &
GEOTEXTILE PRODUCTS, Inc.**
"Helping to Protect the Environment"

21000 77th Avenue South
Kent, WA 98032
(253) 872-0244 / (800) 729-6954
FAX: (253) 872-0245

Date: 11/7/2014
Job #: N14152

Destructive Testing Form

Project Name: De Beque Station
Project Location: De Beque, Co.
Project Description: Lagoon (Secondary Layer)
Project Manager: Kevin Allen

Supervisor: Joel Mondragon
Engineer: WWC Engineering
Contractor: Black Hills Explorations
Contact: Brett Hurlbut

Material: 60-mil HD Microspike

Material:					Track Peel Values			Tensile Value			Lab	
Date/ Time	Panel Numbers	Sample I.D.	Tester Initials	Machine Number	In- side	Out- side	Pass/ Fail	LBS/ Inch	Rate	Pass/ Fail	Pass / Fail	Peel/ Tensile
11/7/2014 3:30 PM	11,12,19	DT#1	DA	T-059	149	145	Pass	192		Pass		
Comments:					142	146	Pass	198		Pass		
					156	145	Pass	201		Pass		
					146	139	Pass	200		Pass		
					141	140	Pass	203		Pass		
11/7/2014 3:40 PM	P19/P21	DT#2	DA	T-059	139	142	Pass	200		Pass		
Comments:					126	135	Pass	202		Pass		
					145	139	Pass	200		Pass		
					148	142	Pass	199		Pass		
					135	141	Pass	201		Pass		
11/7/2014 3:50 PM	P22/P23	DT#3	DA	T-059	143	128	Pass	198		Pass		
Comments:					131	129	Pass	200		Pass		
					137	128	Pass	204		Pass		
					135	142	Pass	202		Pass		
					140	137	Pass	205		Pass		
11/7/2014 4:00 PM	P25/P26	DT#4	DA	T-059	145	139	Pass	200		Pass		
Comments:					136	145	Pass	199		Pass		
					134	142	Pass	198		Pass		
					141	138	Pass	203		Pass		
					140	143	Pass	199		Pass		
11/7/2014 4:10 PM	P28/P30	DT#5	DA	T-059	136	142	Pass	198		Pass		
Comments:					138	135	Pass	209		Pass		
					140	134	Pass	204		Pass		
					139	145	Pass	203		Pass		
					141	140	Pass	200		Pass		
11/7/2014 4:20 PM	P33/P31	DT#6	DA	T-059	142	138	Pass	199		Pass		
Comments:					135	132	Pass	205		Pass		
					136	122	Pass	202		Pass		
					140	138	Pass	204		Pass		
					139	140	Pass	204		Pass		
11/8/2014 9:00 AM	P36/P37	DT#7	DA	T-059	141	163	Pass	202		Pass		
Comments:					167	144	Pass	205		Pass		
					160	162	Pass	201		Pass		
					158	144	Pass	203		Pass		
					142	144	Pass	200		Pass		
11/8/2014 9:10	P42/P43	DT#8	DA	T-059	162	133	Pass	204		Pass		
Comments:					153	165	Pass	208		Pass		
					161	163	Pass	202		Pass		
					135	138	Pass	205		Pass		
					139	144	Pass	206		Pass		



**NORTHWEST LININGS &
GEOTEXTILE PRODUCTS, Inc.**

"Helping to Protect the Environment"

21000 77th Avenue South
Kent, WA 98032
(253) 872-0244 / (800) 729-6954
FAX: (253) 872-0245

Date: 11/8/2014
Job #: N14152

Destructive Testing Form

Project Name: De Beque Station
Project Location: De Beque, Co.
Project Description: Lagoon (Secondary Layer)
Project Manager: Kevin Allen

Supervisor: Joel Mondragon
Engineer: WWC Engineering
Contractor: Black Hills Explorations
Contact: Brett Hurlbut

Material: 60-mil HD Microspike

Date/ Time	Panel Numbers	Sample I.D.	Tester Initials	Machine Number	Track Peel Values			Tensile Value		Lab	
					In- side	Out- side	Pass/ Fail	LBS/ Inch	Rate	Pass/ Fail	Pass / Fail
11/8/2014 9:20 AM	P50/P51	DT#9	DA	T-059	148	128	Pass	205		Pass	
					133	142	Pass	201		Pass	
					145	146	Pass	207		Pass	
					140	138	Pass	201		Pass	
					139	141	Pass	204		Pass	
Comments:											
11/8/2014 9:30 AM	P60/P61	DT#10	DA	T-059	134	141	Pass	205		Pass	
					136	139	Pass	200		Pass	
					143	138	Pass	203		Pass	
					144	140	Pass	201		Pass	
					138	143	Pass	205		Pass	
Comments:											
11/8/2014 9:40 AM	P62/P63	DT#11	DA	T-059	142	162	Pass	199		Pass	
					140	141	Pass	204		Pass	
					139	142	Pass	207		Pass	
					129	137	Pass	201		Pass	
					145	149	Pass	204		Pass	
Comments:											
11/8/2014 9:50 AM	P63/P64	DT#12	DA	T-059	139	158	Pass	208		Pass	
					131	121	Pass	204		Pass	
					138	143	Pass	200		Pass	
					142	145	Pass	204		Pass	
					138	140	Pass	202		Pass	
Comments:											
Comments:											
Comments:											
Comments:											
Comments:											



**NORTHWEST LININGS &
GEOTEXTILE PRODUCTS, Inc.**
"Helping to Protect the Environment"
 21000 77th Avenue South
 Kent, WA 98032
 (253) 872-0244 / (800) 729-6954
 FAX: (253) 872-0245

Date: 11/8/2014
 Job #: N14152

Repair Report

Project Name: De Beque Station
 Project Location: De Beque, Co.
 Project Description: Lagoon Secondary Layer
 Project Manager: Kevin Allen

Supervisor: Joel Mondragon
 Engineer: WWC Engineering
 Contractor: Black Hills Exploration
 Contact: Brett Hurlbut

Date	Repair ID#	Panel Numbers	Extruder Number	Operator Initials	Type of Repair/Detail/Location (I.E... DT Patch, Rock Hole, Burn Out, Failed Seam, ETC...)	V-Box Pass/Fail
11/7/14	R-1	P2,P3,P4	5602	AM	2'X1' Patch over A.T. holes, NW corner	Pass
11/7/14	R-2	P2,P4,P5	5602	AM	2'X1' Patch over A.T. holes, NW corner	Pass
11/7/14	R-3	P1,P2,P5	5602	AM	2'X1' Patch over A.T. holes, NW corner	Pass
11/7/14	R-4	P1,P5,P6	5602	AM	2'X1' Patch over A.T. holes, NW corner	Pass
11/7/14	R-5	19,1,6	5602	AM	2'X1' Patch over A.T. holes, North buttseam	Pass
11/7/14	R-6	19,6,7	5602	AM	2'X1' Patch over A.T. holes, North buttseam	Pass
11/7/14	R-7	19,7,8	5602	AM	2'X1' Patch over A.T. holes, North buttseam	Pass
11/7/14	R-8	19,8,9	5602	AM	2'X1' Patch over A.T. holes, North buttseam	Pass
11/7/14	R-9	19,9,10	5602	AM	2'X1' Patch over A.T. holes, North buttseam	Pass
11/7/14	R-10	19,10,11	5602	AM	2'X1' Patch over A.T. holes, North buttseam	Pass
11/7/14	R-11	19,11,12	5602	AM	5'X2' Patch over DS#1, 66' from N end	Pass
11/7/14	R-12	P19,12,13	5602	AM	2'X1' Patch over A.T. holes, North buttseam	Pass
11/7/14	R-13	13,18,19	5602	AM	2'X1' Patch over A.T. holes, North buttseam	Pass
11/7/14	R-14	13,14,18	5602	AM	2'X1' Patch over A.T. holes, NE corner	Pass
11/7/14	R-15	14,17,18	5602	AM	2'X1' Patch over A.T. holes, NE corner	Pass
11/7/14	R-16	14,15,17	5602	AM	2'X1' Patch over A.T. holes, NE corner	Pass
11/7/14	R-17	15,16,17	5602	AM	2'X1' Patch over A.T. holes, NE corner	Pass
11/7/14	R-18	19,20,21	5602	AM	2'X1' Patch over A.T. holes, 73' from E end	Pass
11/7/14	R-19	20,21,23	5602	AM	2'X1' Patch over A.T. holes, 73' from E end	Pass
11/7/14	R-20	21,22,23	5602	AM	2'X1' Patch over A.T. holes, 105' from E end	Pass



**NORTHWEST LININGS &
GEOTEXTILE PRODUCTS, Inc.**
"Helping to Protect the Environment"

21000 77th Avenue South
Kent, WA 98032
(253) 872-0244 / (800) 729-6954
FAX: (253) 872-0245

Date: 11/7/2014
Job #: N14152

Repair Report

Project Name: De Beque Station
Project Location: De Beque, Co.
Project Description: Lagoon Secondary Layer
Project Manager: Kevin Allen

Supervisor: Joel Mondragon
Engineer: WWC Engineering
Contractor: Black Hills Exploration
Contact: Brett Hurlbut

Date	Repair ID#	Panel Numbers	Extruder Number	Operator Initials	Type of Repair/Detail/Location (I.E... DT Patch, Rock Hole, Burn Out, Failed Seam, ETC...)	V-Box Pass/Fail
11/7/14	R-21	19,21,22	5602	AM	5'X2' Patch over DS#2, 105' from E end	Pass
11/7/14	R-22	23,24,25	5602	AM	2'X1' Patch over A.T. holes, 141' from E end	Pass
11/7/14	R-23	24,25,26	5602	AM	5'X2' Patch over DS#4, 141' from E end	Pass
11/7/14	R-24	P22/P23	5602	AM	5'X2' Patch over DS#3, 80' from W end	Pass
11/7/14	R-25	26,27,28	5602	AM	2'X1' Patch over A.T. holes, 73' from W end	Pass
11/7/14	R-26	27,28,30	5602	AM	2'X1' Patch over A.T. holes, 73' from W end	Pass
11/7/14	R-27	31,33,34	5602	AM	2'X1' Patch over A.T. holes, 134' from W end	Pass
11/7/14	R-28	33,34,35	5602	AM	2'X1' Patch over A.T. holes, 134' from W end	Pass
11/7/14	R-29	32,33,35	5602	AM	2'X1' Patch over A.T. holes, 160' from W end	Pass
11/7/14	R-30	31,32,33	5602	AM	5'X2' Patch over DS#6, 140' from E end	Pass
11/7/14	R-31	29,30,31	5602	AM	2'X1' Patch over A.T. holes, 71' from E end	Pass
11/8/14	R-32	28,29,30	5602	AM	5'X2' Patch over DS#5, 71' from E end	Pass
11/8/14	R-33	P36/P37	5602	AM	5'X2' Patch over DS#7, 140' from E end	Pass
11/8/14	R-34	37,38,39	5602	AM	2'X1' patch over A.T. holes, 131' from E end	Pass
11/8/14	R-35	38,39,40	5602	AM	2'X1' patch over A.T. holes, 131' from E end	Pass
11/8/14	R-36	36,37,64	5602	AM	5'x2' Patch over DS#12, 160' from E end	Pass
11/8/14	R-37	37,38,64,63	5602	AM	2'X1' patch over A.T. holes, 160' from E end	Pass
11/8/14	R-38	38,40,62,63	5602	AM	2'X1' patch over A.T. holes, 160' from E end	Pass
11/8/14	R-39	40,41,61,62	5602	AM	2'X1' patch over A.T. holes, 160' from E end	Pass
11/8/14	R-40	36,64,65	5602	AM	2'X1' patch over A.T. holes, 98' from W end	Pass



**NORTHWEST LININGS &
GEOTEXTILE PRODUCTS, Inc.**
"Helping to Protect the Environment"

21000 77th Avenue South
Kent, WA 98032
(253) 872-0244 / (800) 729-6954
FAX: (253) 872-0245

Date: 11/8/2014
Job #: N14152

Repair Report

Project Name: De Beque Station
Project Location: De Beque, Co.
Project Description: Lagoon Secondary Layer
Project Manager: Kevin Allen

Supervisor: Joel Mondragon
Engineer: WWC Engineering
Contractor: Black Hills Exploration
Contact: Brett Hurlbut

Date	Repair ID#	Panel Numbers	Extruder Number	Operator Initials	Type of Repair/Detail/Location (I.E... DT Patch, Rock Hole, Burn Out, Failed Seam, ETC...)	V-Box Pass/Fail
11/8/14	R-41	63,64,65	5602	AM	2'X1' Patch over A.T. holes, 98' from W end	Pass
11/8/14	R-42	P62/P63	5602	AM	5'X2' Patch over DS#11, 100' from W end	Pass
11/8/14	R-43	56,57,58	5602	AM	2'X1' Patch over A.T. holes, SW corner	Pass
11/8/14	R-44	55,56,58	5602	AM	2'X1' Patch over A.T. holes, SW corner	Pass
11/8/14	R-45	55,58,59	5602	AM	2'X1' Patch over A.T. holes, SW corner	Pass
11/8/14	R-46	54,55,59	5602	AM	2'X1' Patch over A.T. holes, SW corner	Pass
11/8/14	R-47	54,59,60	5602	AM	2'X1' Patch over A.T. holes, SW corner	Pass
11/8/14	R-48	54,60,61	5602	AM	5'X2' Patch over DS#10, 65' from W end	Pass
11/8/14	R-49	53,54,61	5602	AM	2'X1' Patch over A.T. holes, South buttseam	Pass
11/8/14	R-50	52,53,61	5602	AM	2'X1' Patch over A.T. holes, South buttseam	Pass
11/8/14	R-51	51,52,41,61	5602	AM	2'X4' Patch over A.T. holes, South buttseam	Pass
11/8/14	R-52	41,50,51	5602	AM	2'X1' Patch over A.T. holes, South buttseam	Pass
11/8/14	R-53	P50,P51	5602	AM	5'X2' Patch ver DS#9, 78' from S end	Pass
11/8/14	R-54	41,49,50	5602	AM	2'X1' Patch over A.T. holes, South buttseam	Pass
11/8/14	R-55	41,48,49	5602	AM	2'X1' Patch over A.T. holes, South buttseam	Pass
11/8/14	R-56	41,42,48	5602	AM	2'X1' Patch over A.T. holes, South buttseam	Pass
11/8/14	R-57	P41,P42	5602	AM	2'X1' Patch over A.T. holes, South buttseam	Pass
11/8/14	R-58	P47,P48	5602	AM	2'X1' Patch over A.T. holes, SE corner	Pass
11/8/14	R-59	P42	5602	AM	Fabrication on sump area, 63' from w end	Pass
11/8/14	R-60	42,43,47	5602	AM	5'X2' Patch over DS#8, 55' from W end	Pass



**NORTHWEST LININGS &
GEOTEXTILE PRODUCTS, Inc.**
"Helping to Protect the Environment"

21000 77th Avenue South
Kent, WA 98032
(253) 872-0244 / (800) 729-6954
FAX: (253) 872-0245

Date: 11/8/2014
Job #: N14152

Repair Report

Project Name:	De Beque Station
Project Location:	De Beque, Co.
Project Description:	Lagoon Secondary Layer
Project Manager:	Kevin Allen

Supervisor: Joel Mondragon
Engineer: WWC Engineering
Contractor: Black Hills Exploration
Contact: Brett Hurlbut

[illegible]



**NORTHWEST LININGS &
GEOTEXTILE PRODUCTS, Inc.**

"Helping to Protect the Environment"

21000 77th Avenue South
Kent, WA 98032
(253) 872-0244 / (800) 729-6954
FAX: (253) 872-0245

Date: 11/8/2014

Job #: N14152

Panel Placement Form

Project Name: DE BEQUE STATION PONDS
Project Location: DE BEQUE, CO
Project Description: Lagoon Liner - Primary
Project Manager: KEVIN ALLEN

Supervisor: Alex Santana
Engineer: _____
Contractor: _____
Contact: _____

Material: 60-mil hdpe text

Date	Panel #	Length	Width	Roll Number	Panel Location / Comment
11/8/14	1	300	22.5	3034	
11/8/14	2	68	22.5	3034	
11/8/14	3	50	22.5	3029	
11/8/14	4	10	22.5	3029	
11/8/14	5	10	22.5	3029	
11/8/14	6	17	22.5	3034	
11/8/14	7	56	22.5	3029	
11/8/14	8	76	22.5	3034	
11/8/14	9	76	22.5	3029	
11/8/14	10	76	22.5	3037	
11/8/14	11	76	22.5	3037	
11/8/14	12	76	22.5	2028	
11/8/14	13	76	22.5	2028	
11/8/14	14	76	22.5	2024	
11/8/14	15	76	22.5	2024	
11/8/14	16	49	22.5	2031	
11/8/14	17	10	22.5	2031	
11/8/14	18	10	22.5	3029	
11/8/14	19	49	22.5	2031	
11/8/14	20	74	22.5	3029	
11/8/14	21	300	22.5	3029	
11/8/14	22	300	22.5	3037	
11/8/14	23	300	22.5	2028	
11/8/14	24	300	22.5	2024	
11/8/14	25	300	22.5	2031	
11/9/14	26	300	22.5	2021	
11/9/14	27	100	22.5	2022	
11/9/14	28	200	22.5	2021	
11/9/14	29	300	22.5	2022	
11/9/14	30	100	22.5	2025	
11/9/14	31	25	22.5	2024	
11/9/14	31-A	35	22.5	2028	
11/9/14	32	35	22.5	3037	
11/9/14	33	105	22.5	2022	
11/9/14	34	300	22.5	2027	
11/9/14	35	300	22.5	2026	

Notes: 103747.5

FAX: (253) 872-0245

Job #: N14152

Supervisor: Alex Santana
 Engineer: _____
 Contractor: _____
 Contact: _____

Notes: 42097.5

145845

**NORTHWEST LININGS &
GEOTEXTILE PRODUCTS, Inc.**
"Helping to Protect the Environment"

 21000 77th Avenue South
 Kent, WA 98032
 (253) 872-0244 / (800) 729-6954
 FAX: (253) 872-0245

Date: 11/8/2014

Job #: N14152

Geomembrane Fusion Weld Trial Log

Project Name: De Beque Station Ponds
 Project Location: De Beque, CO
 Project Description: Lagoon Liner - Primary
 Project Manager: Kevin Allen

Supervisor: Alex Santana
 Engineer:
 Contractor:
 Contact:

Material: 60-mil hdpe text

Date/ Time	Seamer Initials	Machine Number	Wedge Welder		Extruder		Track Peel Values			Tensile Value		
			Wedge Temp	Nip Roller Speed	Barrel Temp	Preheat Temp	In- side	Out- side	Pass/ Fail	LBS/I nch	Rate	Pass/ Fail
11/8/2014 8:00am	PK	2537	800*	5			131	129	Pass	187		Pass
							126	132	Pass	179		Pass
Comments: _____							132	128	Pass	185		Pass
_____ Ambient Temp: _____							127	132	Pass	178		Pass
_____							130	136	Pass	185		Pass
11/8/2014 8:15am	KO	2536	800*	5			127	125	Pass	186		Pass
							134	129	Pass	178		Pass
Comments: _____							131	134	Pass	183		Pass
_____ Ambient Temp: _____							129	131	Pass	184		Pass
_____							131	127	Pass	179		Pass
11/8/2014 1:00pm	PK	2537	800*	5			126	130	Pass	185		Pass
							124	126	Pass	182		Pass
Comments: _____							135	127	Pass	178		Pass
_____ Ambient Temp: _____							136	132	Pass	185		Pass
_____							128	133	Pass	178		Pass
11/8/2014 1:15pm	KO	2536	800*	5			134	124	Pass	186		Pass
							123	232	Pass	187		Pass
Comments: _____							121	127	Pass	179		Pass
_____ Ambient Temp: _____							126	141	Pass	180		Pass
_____							129	132	Pass	181		Pass
11/9/2014 8:00am	PK	2537	800*	5			121	127	Pass	186		Pass
							125	130	Pass	183		Pass
Comments: _____							143	135	Pass	189		Pass
_____ Ambient Temp: _____							130	124	Pass	185		Pass
_____							126	124	Pass	182		Pass
11/9/2014 8:15am	KO	2536	800*	5			132	127	Pass	181		Pass
							126	135	Pass	187		Pass
Comments: _____							145	137	Pass	183		Pass
_____ Ambient Temp: _____							146	143	Pass	182		Pass
_____							134	126	Pass	179		Pass
11/9/2014 1:00pm	PK	2537	800*	5			135	143	Pass	186		Pass
							135	142	Pass	185		Pass
Comments: _____							134	143	Pass	189		Pass
_____ Ambient Temp: _____							126	134	Pass	182		Pass
_____							140	136	Pass	188		Pass
11/9/2014 1:20pm	KO	2536	800*	5			124	138	Pass	187		Pass
							128	143	Pass	189		Pass
Comments: _____							142	141	Pass	186		Pass
_____ Ambient Temp: _____							136	143	Pass	186		Pass
_____							132	138	Pass	189		Pass

**NORTHWEST LININGS &
GEOTEXTILE PRODUCTS, Inc.**
"Helping to Protect the Environment"

 21000 77th Avenue South
 Kent, WA 98032
 (253) 872-0244 / (800) 729-6954
 FAX: (253) 872-0245

Date: 11/10/2014

Job #: N14152

Geomembrane Fusion Weld Trial Log

Project Name: De Beque Station Ponds
 Project Location: De Beque, CO
 Project Description: Lagoon Liner - Primary
 Project Manager: Kevi Allen

Supervisor: Alex Santana
 Engineer:
 Contractor:
 Contact:

Material: 60-mil hdpe text

Date/ Time	Seamer Initials	Machine Number	Wedge Welder		Extruder		Track Peel Values			Tensile Value		
			Wedge Temp	Nip Roller Speed	Barrel Temp	Preheat Temp	In- side	Out- side	Pass/ Fail	LBS/I nch	Rate	Pass/ Fail
11/10/2014 8:00am	KO	2536	800*	5			144	141	Pass	190		Pass
							137	142	Pass	182		Pass
Comments: _____							133	145	Pass	184		Pass
Ambient Temp: _____							135	139	Pass	179		Pass
_____							128	133	Pass	186		Pass
11/10/2014 8:15pm	KO	2536	800*	5			142	136	Pass	190		Pass
							125	127	Pass	188		Pass
Comments: _____							116	140	Pass	187		Pass
Ambient Temp: _____							137	125	Pass	188		Pass
_____							131	127	Pass	187		Pass
11/11/2014 8:00AM	SS	663			500*	400*	134	136	Pass	182		Pass
							142	134	Pass	184		Pass
Comments: _____							138	136	Pass	186		Pass
Ambient Temp: _____							132	127	Pass	188		Pass
_____							123	118	Pass	183		Pass
11/11/2014 1:00PM	SS	663			500*	400*	121		Pass	189		Pass
							125		Pass	185		Pass
Comments: _____							123		Pass	185		Pass
Ambient Temp: _____							124		Pass	187		Pass
_____							125		Pass	189		Pass
11/12/2014 8:00am	SS	663			500*	400*	118		Pass	183		Pass
							134		Pass	190		Pass
Comments: _____							119		Pass	186		Pass
Ambient Temp: _____							122		Pass	179		Pass
_____							127		Pass	185		Pass
11/12/2014 1:00pm	KO	2536	800*	5			140	138	Pass	187		Pass
							138	139	Pass	184		Pass
Comments: _____							132	135	Pass	189		Pass
Ambient Temp: _____							139	124	Pass	190		Pass
_____							128	132	Pass	185		Pass
11/13/2014 8:00AM	SS	663			500*	400*	126		Pass	185		Pass
							126		Pass	188		Pass
Comments: _____							135		Pass	186		Pass
Ambient Temp: _____							134		Pass	183		Pass
_____							119		Pass	185		Pass
Comments: _____												
Ambient Temp: _____												



**NORTHWEST LININGS &
GEOTEXTILE PRODUCTS, Inc.**
"Helping to Protect the Environment"

21000 77th Avenue South
Kent, WA 98032
(253) 872-0244 / (800) 729-6954
FAX: (253) 872-0245

Date: 11/8/2014
Job #: N14152

Panel Seaming Form

Project Name: DE BEQUE STATION PONDS
Project Location: DE BEQUE, CO
Project Description: Lagoon Liner - Primary
Project Manager: KEVIN ALLEN

Supervisor: Alex Santana
Engineer: _____
Contractor: _____
Contact: _____

Material: 60-mil HD T

Date/ Time	Seam Number	Panel Number	Seam Length	Seamer Initials	Machine Number	Machine Temp	Ambient Temp	Weather / Comments
11/8/14	1	2>3	50'	KO	2536	800*	55*	
11/8/14	2	3>4	23'	KO	2536	800*	55*	
11/8/14	3	5>6	23'	KO	2536	800*	55*	
11/8/14	4	6>7	20'	KO	2536	800*	55*	
11/8/14	5	7>8	66'	KO	2536	800*	55*	
11/8/14	6	8>2	10'	KO	2536	800*	55*	
11/8/14	7	4>5	15'	KO	2536	800*	55*	
11/8/14	8	6>4	10'	KO	2536	800*	55*	
11/8/14	9	6>3	20'	KO	2536	800*	55*	
11/8/14	10	7>3	20'	KO	2536	800*	55*	
11/8/14	11	7>2	15'	KO	2536	800*	55*	
11/8/14	12	8>9	76'	KO	2536	800*	55*	
11/8/14	13	9>10	76'	KO	2536	800*	55*	
11/8/14	14	10>11	76'	KO	2536	800*	55*	
11/8/14	15	11<12	76'	KO	2536	800*	55*	
11/8/14	16	12>13	76'	KO	2536	800*	55*	
11/8/14	17	13>14	76'	KO	2536	800*	55*	
11/8/14	18	14>15	76'	KO	2536	800*	55*	
11/8/14	19	15>16	50'	KO	2536	800*	55*	
11/8/14	20	16>17	23'	KO	2536	800*	55*	



**NORTHWEST LININGS &
GEOTEXTILE PRODUCTS, Inc.**
"Helping to Protect the Environment"

21000 77th Avenue South
Kent, WA 98032
(253) 872-0244 / (800) 729-6954
FAX: (253) 872-0245

Date: 11/8/2014
Job #: N14152

Panel Seaming Form

Project Name: DE BEQUE STATION PONDS
Project Location: DE BEQUE, CO
Project Description: Lagoon Liner - Primary
Project Manager: KEVIN ALLEN

Supervisor: Alex Santana
Engineer:
Contractor:
Contact:

Material: 60-mil HD T

Date/ Time	Seam Number	Panel Number	Seam Length	Seamer Initials	Machine Number	Machine Temp	Ambient Temp	Weather / Comments
11/8/14	21	18>19	23'	KO	2536	800*	55*	
11/8/14	22	19>20	50'	KO	2536	800*	55*	
11/8/14	23	17>18	23'	KO	2536	800*	55*	
11/8/14	24	16>19	30'	KO	2536	800*	55*	
11/8/14	25	15>20	30'	KO	2536	800*	55*	
11/8/14	26	2>1	68'	KO	2536	800*	55*	
11/8/14	27	1>8	23'	KO	2536	800*	55*	
11/8/14	28	1>9	23'	KO	2536	800*	55*	
11/8/14	29	1>10	23'	KO	2536	800*	55*	
11/8/14	30	1>11	23'	KO	2536	800*	55*	
11/8/14	31	1>12	23'	KO	2536	800*	55*	
11/8/14	32	1>13	23'	KO	2536	800*	55*	
11/8/14	33	1>14	23'	KO	2536	800*	55*	
11/8/14	34	1>20	74'	KO	2536	800*	55*	
11/8/14	35	1>21	300'	KO	2536	800*	55*	
11/8/14	36	21>22	300'	PK	2537	800*	55*	
11/8/14	37	22>23	300'	PK	2537	800*	55*	
11/8/14	38	23>24	300'	PK	2537	800*	55*	
11/8/14	39	24>25	300'	PK	2537	800*	55*	
11/8/14	40	25>26	300'	PK	2537	800*	55*	



**NORTHWEST LININGS &
GEOTEXTILE PRODUCTS, Inc.**
"Helping to Protect the Environment"

21000 77th Avenue South
Kent, WA 98032
(253) 872-0244 / (800) 729-6954
FAX: (253) 872-0245

Date: 11/9/2014
Job #: N14152

Panel Seaming Form

Project Name: DE BEQUE STATION PONDS
Project Location: DE BEQUE, CO
Project Description: Lagoon Liner - Primary
Project Manager: KEVIN ALLEN

Supervisor: Alex Santana
Engineer:
Contractor:
Contact:

Material: 60-mil HD T

Date/ Time	Seam Number	Panel Number	Seam Length	Seamer Initials	Machine Number	Machine Temp	Ambient Temp	Weather / Comments
11/9/14	41	27>28	23'	PK	2537	800*	55*	
11/9/14	42	26>27	100'	PK	2537	800*	55*	
11/9/14	43	26>28	200'	PK	2537	800*	55*	
11/9/14	44	27>29	100'	PK	2537	800*	55*	
11/9/14	45	28>29	200'	KO	2536	800*	55*	
11/9/14	46	30>31	23'	KO	2536	800*	55*	
11/9/14	47	31>31-A	23'	PK	2537	800*	55*	
11/9/14	48	31-A>32	23'	PK	2537	800*	55*	
11/9/14	49	32>33	23'	PK	2537	800*	55*	
11/9/14	50	29>30	100'	PK	2537	800*	55*	
11/9/14	51	29>31	25'	PK	2537	800*	55*	
11/9/14	52	29>31-A	35'	PK	2537	800*	55*	
11/9/14	53	29>32	35'	PK	2537	800*	55*	
11/9/14	54	29>33	105'	PK	2537	800*	55*	
11/9/14	55	30>34	100'	PK	2537	800*	55*	
11/9/14	56	31>34	25'	PK	2537	800*	55*	
11/9/14	57	31-A>34	35'	PK	2537	800*	55*	
11/9/14	58	32>34	35'	PK	2537	800*	55*	
11/9/14	59	33>34	105'	PK	2537	800*	55*	
11/9/14	60	34>35	300'	PK	2537	800*	55*	



**NORTHWEST LININGS &
GEOTEXTILE PRODUCTS, Inc.**

"Helping to Protect the Environment"

21000 77th Avenue South
Kent, WA 98032
(253) 872-0244 / (800) 729-6954
FAX: (253) 872-0245

Date: 11/9/2014

Job #: N14152

Panel Seaming Form

Project Name: DE BEQUE STATION PONDS
Project Location: DE BEQUE, CO
Project Description: Lagoon Liner - Primary
Project Manager: KEVIN ALLEN

Supervisor: Alex Santana
Engineer:
Contractor:
Contact:

Material: 60-mil HD T

Date/ Time	Seam Number	Panel Number	Seam Length	Seamer Initials	Machine Number	Machine Temp	Ambient Temp	Weather / Comments
11/9/14	61	36>37	23'	PK	2537	800*	55*	
11/9/14	62	35>36	100'	PK	2537	800*	55*	
11/9/14	63	35>37	200'	PK	2537	800*	55*	
11/9/14	64	36>38	100'	PK	2537	800*	55*	
11/9/14	65	37>38	200'	PK	2537	800*	55*	
11/9/14	66	38>39	300'	KO	2536	800*	35*	
11/9/14	67	40>41	55'	PK	2537	800*	55*	
11/10/14	68	41>42	30'	KO	2536	800*	35*	
11/10/14	69	42>43	23'	KO	2536	800*	35*	
11/10/14	70	44>45	68'	KO	2536	800*	35*	
11/10/14	71	43>44	10'	KO	2536	800*	35*	
11/10/14	72	42>44	23'	KO	2536	800*	35*	
11/10/14	73	41>44	25'	KO	2536	800*	35*	
11/10/14	74	40>44	15'	KO	2536	800*	35*	
11/10/14	75	40>45	15'	KO	2536	800*	35*	
11/10/14	76	45>46	79'	KO	2536	800*	35*	
11/10/14	77	46>47	79'	KO	2536	800*	35*	
11/10/14	78	47>48	79'	KO	2536	800*	35*	
11/10/14	79	48>49	79'	KO	2536	800*	35*	
11/10/14	80	49>50	79'	KO	2536	800*	35*	



**NORTHWEST LININGS &
GEOTEXTILE PRODUCTS, Inc.**
"Helping to Protect the Environment"

21000 77th Avenue South
Kent, WA 98032
(253) 872-0244 / (800) 729-6954
FAX: (253) 872-0245

Date: 11/12/2014
Job #: N14152

Panel Seaming Form

Project Name: DE BEQUE STATION PONDS
Project Location: DE BEQUE, CO
Project Description: Lagoon Liner - Primary
Project Manager: KEVIN ALLEN

Supervisor: Alex Santana
Engineer: _____
Contractor: _____
Contact: _____

Material: 60-mil HD T

Date/ Time	Seam Number	Panel Number	Seam Length	Seamer Initials	Machine Number	Machine Temp	Ambient Temp	Weather / Comments
11/12/14	81	50>51	79'	KO	2536	800*	35*	
11/12/14	82	51>52	69'	KO	2536	800*	35*	
11/12/14	83	51>56	10'	KO	2536	800*	35*	
11/12/14	84	52>53	28'	KO	2536	800*	35*	
11/12/14	85	53>54	20'	KO	2536	800*	35*	
11/12/14	86	55>56	55'	KO	2536	800*	35*	
11/12/14	87	54>55	10'	KO	2536	800*	35*	
11/12/14	88	53>55	23'	KO	2536	800*	35*	
11/12/14	89	52>55	25'	KO	2536	800*	35*	
11/12/14	90	52>56	15'	KO	2536	800*	35*	
11/12/14	91	39>40	75'	KO	2536	800*	35*	
11/12/14	92	39>45	10'	KO	2536	800*	35*	
11/12/14	93	39>46	23'	KO	2536	800*	35*	
11/12/14	94	39>47	23'	KO	2536	800*	35*	
11/12/14	95	39>48	23'	KO	2536	800*	35*	
11/12/14	96	39>49	23'	KO	2536	800*	35*	
11/12/14	97	39>50	23'	KO	2536	800*	35*	
11/12/14	98	39>51	23'	KO	2536	800*	35*	
11/12/14	99	39>56	70'	KO	2536	800*	35*	



**NORTHWEST LININGS &
GEOTEXTILE PRODUCTS, Inc.**

"Helping to Protect the Environment"

21000 77th Avenue South
Kent, WA 98032
(253) 872-0244 / (800) 729-6954
FAX: (253) 872-0245

Date: 11/9/2014
Job #: N14152

Non Destructive Testing Form

Project Name: De Beque Station
Project Location: DE BEQUE, CO
Project Description: Lagoon Liner - Primary
Project Manager: KEVIN ALLEN

Supervisor: Alex Santana
Engineer:
Contractor:
Contact:

Material: 60-mil HD T

Date/ Time	Panel Number	Seamer Initials	Air Pressure Testing						V-Box Pass/ Fail	Comments / Location
			Start Pressure	Start Time	Ending Pressure	End Time	Pressure Loss	Pass/ Fail		
11/9/2014	2>3	YT	30	1:40	30	1:45	0	Pass		
11/9/2014	3>4	YT	30	1:42	30	1:47	0	Pass		
11/9/2014	5>6	YT	30	1:50	30	1:55	0	Pass		
11/9/2014	6>7	YT	30	1:53	30	1:58	0	Pass		
11/9/2014	7>8	YT	30	2:00	30	2:05	0	Pass		
11/9/2014	8>2	YT	30	2:02	30	2:07	0	Pass		
11/9/2014	4>5	YT	30	2:12	30	2:17	0	Pass		
11/9/2014	6>4	YT	30	2:15	30	2:20	0	Pass		
11/9/2014	6>3	YT	30	2:21	30	2:26	0	Pass		
11/9/2014	7>3	YT	30	2:23	30	2:28	0	Pass		
11/9/2014	7>2	YT	30	2:30	30	2:35	0	Pass		
11/9/2014	8>9	YT	30	2:31	30	2:36	0	Pass		
11/9/2014	9>10	YT	30	2:41	30	2:46	0	Pass		
11/9/2014	10>11	YT	30	2:43	30	2:48	0	Pass		
11/9/2014	11<12	YT	30	2:50	30	2:55	0	Pass		
11/9/2014	12>13	YT	30	2:56	30	3:01	0	Pass		
11/9/2014	13>14	YT	30	3:00	30	3:05	0	Pass		
11/9/2014	14>15	YT	30	3:01	30	3:06	0	Pass		
11/9/2014	15>16	YT	30	3:10	30	3:15	0	Pass		
11/9/2014	16>17	YT	30	3:11	30	3:16	0	Pass		



**NORTHWEST LININGS &
GEOTEXTILE PRODUCTS, Inc.**

"Helping to Protect the Environment"

21000 77th Avenue South
Kent, WA 98032
(253) 872-0244 / (800) 729-6954
FAX: (253) 872-0245

Date: 11/9/2014
Job #: N14152

Non Destructive Testing Form

Project Name: De Beque Station
Project Location: DE BEQUE, CO
Project Description: Lagoon Liner - Primary
Project Manager: KEVIN ALLEN

Supervisor: Alex Santana
Engineer: _____
Contractor: _____
Contact: _____

Material: 60-mil HD T

Date/ Time	Panel Number	Seamer Initials	Air Pressure Testing						V-Box Pass/ Fail	Comments / Location
			Start Pressure	Start Time	Ending Pressure	End Time	Pressure Loss	Pass/ Fail		
11/9/2014	18>19	YT	30	3:15	30	3:20	0	Pass		
11/9/2014	19>20	YT	30	3:20	30	3:25	0	Pass		
11/9/2014	17>18	YT	30	3:25	30	3:30	0	Pass		
11/9/2014	16>19	YT	30	3:40	30	3:45	0	Pass		
11/9/2014	15>20	YT	30	3:50	30	3:55	0	Pass		
11/9/2014	2>1	YT	30	3:55	30	4:00	0	Pass		
11/9/2014	1>8	YT	30	4:00	30	4:05	0	Pass		
11/9/2014	1>9	YT	30	4:05	30	4:10	0	Pass		
11/9/2014	1>10	YT	30	4:15	30	4:20	0	Pass		
11/9/2014	1>11	YT	30	4:30	30	4:35	0	Pass		
11/9/2014	1>12	YT	30	4:35	30	4:40	0	Pass		
11/9/2014	1>13	YT	30	4:40	30	4:45	0	Pass		
11/9/2014	1>14	YT	30	4:50	30	4:50	0	Pass		
11/9/2014	1>20	YT	30	4:55	30	5:00	0	Pass		
11/9/2014	1>21	YT	30	5:00	30	5:05	0	Pass		
11/9/2014	21>22	YT	30	5:02	30	5:07	0	Pass		
11/9/2014	22>23	YT	30	5:10	30	5:15	0	Pass		
11/9/2014	23>24	YT	30	5:12	30	5:17	0	Pass		
11/9/2014	24>25	YT	30	5:15	30	3:20	0	Pass		
11/9/2014	25>26	YT	30	5:23	30	5:28	0	Pass		



**NORTHWEST LININGS &
GEOTEXTILE PRODUCTS, Inc.**

"Helping to Protect the Environment"

21000 77th Avenue South
Kent, WA 98032
(253) 872-0244 / (800) 729-6954
FAX: (253) 872-0245

Date: 11/11/2014
Job #: n14152

Non Destructive Testing Form

Project Name: De Beque Station
Project Location: DE BEQUE, CO
Project Description: Lagoon Liner - Primary
Project Manager: KEVIN ALLEN

Supervisor: Alex Santana
Engineer: _____
Contractor: _____
Contact: _____

Material: 60-mil HD T

Date/ Time	Panel Number	Seamer Initials	Air Pressure Testing						V-Box Pass/ Fail	Comments / Location
			Start Pressure	Start Time	Ending Pressure	End Time	Pressure Loss	Pass/ Fail		
11/11/2014	27>28	YT	30	7:30	30	7:35	0	Pass		
11/11/2014	26>27	YT	30	7:35	30	7:40	0	Pass		
11/11/2014	26>28	YT	30	7:45	30	7:50	0	Pass		
11/11/2014	27>29	YT	30	8:05	30	8:10	0	Pass		
11/11/2014	28>29	YT	30	8:10	30	8:15	0	Pass		
11/11/2014	30>31	YT	30	8:15	30	8:20	0	Pass		
11/11/2014	31>31-A	YT	30	8:20	30	8:25	0	Pass		
11/11/2014	31-A>32	YT	30	8:25	30	8:30	0	Pass		
11/11/2014	32>33	YT	30	8:30	30	8:35	0	Pass		
11/11/2014	29>30	YT	30	8:35	30	8:40	0	Pass		
11/11/2014	29>31	YT	30	8:40	30	8:45	0	Pass		
11/11/2014	29>31-A	YT	30	8:45	30	8:50	0	Pass		
11/11/2014	29>32	YT	30	8:50	30	8:55	0	Pass		
11/11/2014	29>33	YT	30	9:10	30	9:15	0	Pass		
11/11/2014	30>34	YT	30	9:15	30	9:20	0	Pass		
11/11/2014	31>34	YT	30	9:30	30	9:35	0	Pass		
11/11/2014	31-A>34	YT	30	9:35	30	9:40	0	Pass		
11/11/2014	32>34	YT	30	9:40	30	9:45	0	Pass		
11/11/2014	33>34	YT	30	10:00	30	10:05	0	Pass		
11/11/2014	34>35	YT	30	10:04	30	10:09	0	Pass		



**NORTHWEST LININGS &
GEOTEXTILE PRODUCTS, Inc.**

"Helping to Protect the Environment"

21000 77th Avenue South
Kent, WA 98032
(253) 872-0244 / (800) 729-6954
FAX: (253) 872-0245

Date: 11/11/2014
Job #: n14152

Non Destructive Testing Form

Project Name: De Beque Station
Project Location: DE BEQUE, CO
Project Description: Lagoon Liner - Primary
Project Manager: KEVIN ALLEN

Supervisor: Alex Santana
Engineer:
Contractor:
Contact:

Material: 60-mil HD T

Date/ Time	Panel Number	Seamer Initials	Air Pressure Testing						V-Box Pass/ Fail	Comments / Location
			Start Pressure	Start Time	Ending Pressure	End Time	Pressure Loss	Pass/ Fail		
11/11/2014	36>37	YT	30	10:15	30	10:20	0	Pass		
11/11/2014	35>36	YT	30	10:20	30	10:25	0	Pass		
11/11/2014	35>37	YT	30	10:25	30	10:30	0	Pass		
11/11/2014	36>38	YT	30	10:30	30	10:35	0	Pass		
11/11/2014	37>38	YT	30	10:35	30	10:40	0	Pass		
11/11/2014	38>39	YT	30	10:40	30	10:45	0	Pass		
11/13/2014	40>41	YT	30	7:25	30	7:20	0	Pass		
11/13/2014	41>42	YT	30	7:27	30	7:33	0	Pass		
11/13/2014	42>43	YT	30	7:31	30	7:36	0	Pass		
11/13/2014	44>45	YT	30	7:37	30	7:42	0	Pass		
11/13/2014	43>44	YT	30	7:40	30	7:45	0	Pass		
11/13/2014	42>44	YT	30	7:43	30	7:48	0	Pass		
11/13/2014	41>44	YT	30	7:48	30	7:53	0	Pass		
11/13/2014	40>44	YT	30	7:57	30	8:02	0	Pass		
11/13/2014	40>45	YT	30	8:08	30	8:13	0	Pass		
11/13/2014	45>46	YT	30	8:15	30	8:20	0	Pass		
11/13/2014	46>47	YT	30	8:23	30	8:28	0	Pass		
11/13/2014	47>48	YT	30	8:37	30	8:43	0	Pass		
11/13/2014	48>49	YT	30	8:45	30	8:50	0	Pass		
11/13/2014	49>50	YT	30	8:49	30	8:54	0	Pass		



**NORTHWEST LININGS &
GEOTEXTILE PRODUCTS, Inc.**

"Helping to Protect the Environment"

21000 77th Avenue South
Kent, WA 98032
(253) 872-0244 / (800) 729-6954
FAX: (253) 872-0245

Date: 11/13/2014
Job #: N14152

Non Destructive Testing Form

Project Name: De Beque Station
Project Location: DE BEQUE, CO
Project Description: Lagoon Liner - Primary
Project Manager: KEVIN ALLEN

Supervisor: Alex Santana
Engineer: _____
Contractor: _____
Contact: _____

Material: 60-mil HD T

Date/ Time	Panel Number	Seamer Initials	Air Pressure Testing						V-Box Pass/ Fail	Comments / Location
			Start Pressure	Start Time	Ending Pressure	End Time	Pressure Loss	Pass/ Fail		
11/13/2014	50>51	YT	30	9:02	30	9:07	0	Pass		
11/13/2014	51>52	YT	30	9:05	30	9:10	0	Pass		
11/13/2014	51>56	YT	30	9:12	30	9:17	0	Pass		
11/13/2014	52>53	YT	30	9:20	30	9:25	0	Pass		
11/13/2014	53>54	YT	30	9:25	30	9:30	0	Pass		
11/13/2014	55>56	YT	30	2:30	30	9:35	0	Pass		
11/13/2014	54>55	YT	30	9:38	30	9:43	0	Pass		
11/13/2014	53>55	YT	30	9:40	30	9:45	0	Pass		
11/13/2014	52>55	YT	30	9:43	30	9:48	0	Pass		
11/13/2014	52>56	YT	30	9:50	30	9:55	0	Pass		
11/13/2014	39>40	YT	30	9:52	30	9:57	0	Pass		
11/13/2014	39>45	YT	30	10:02	30	10:07	0	Pass		
11/13/2014	39>46	YT	30	10:05	30	10:10	0	Pass		
11/13/2014	39>47	YT	30	10:13	30	10:18	0	Pass		
11/13/2014	39>48	YT	30	10:20	30	10:25	0	Pass		
11/13/2014	39>49	YT	30	10:22	30	10:27	0	Pass		
11/13/2014	39>50	YT	30	10:30	30	10:35	0	Pass		
11/13/2014	39>51	YT	30	10:33	30	10:38	0	Pass		
11/13/2014	39>56	YT	30	10:40	30	10:45	0	Pass		



**NORTHWEST LININGS &
GEOTEXTILE PRODUCTS, Inc.**
"Helping to Protect the Environment"

21000 77th Avenue South
Kent, WA 98032
(253) 872-0244 / (800) 729-6954
FAX: (253) 872-0245

Date: 11/13/2014
Job #: N14152

Destructive Testing Form

Project Name: De Beque Station Ponds
Project Location: De Beque, CO
Project Description: Ponds
Project Manager: Kevin Allen

Supervisor: Alex Santana
Engineer:
Contractor:
Contact:

Material: 60-mil HDPE text.

					Track Peel Values			Tensile Value			Lab	
Date/ Time	Seam #	Sample I.D.	Tester Initials	Machine Number	In-side	Out-side	Pass/Fail	LBS/Inch	Rate	Pass/Fail	Pass / Fail	Peel/ Tensile
11/13/2014	1>2	ds#1	YT	2536	127	129	Pass	183		Pass		
					129	125	Pass	189		Pass		
Comments:					130	129	Pass	182		Pass		
					125	128	Pass	187		Pass		
					128	134	Pass	184		Pass		
11/13/2014	16>17	ds#2	YT	2536	137	122	Pass	180		Pass		
					131	126	Pass	182		Pass		
Comments:					136	132	Pass	179		Pass		
					126	134	Pass	181		Pass		
					131	125	Pass	184		Pass		
11/13/2014	1>21	ds#3	YT	2537	124	135	Pass	187		Pass		
					233	137	Pass	187		Pass		
Comments:					125	123	Pass	183		Pass		
					137	122	Pass	189		Pass		
					140	134	Pass	190		Pass		
11/13/2014	22>23	ds#4	YT	2537	145	134	Pass	183		Pass		
					132	126	Pass	188		Pass		
Comments:					141	146	Pass	179		Pass		
					127	135	Pass	186		Pass		
					138	142	Pass	185		Pass		
11/13/2014	24>25	ds#5	YT	2536	118	136	Pass	183		Pass		
					124	129	Pass	188		Pass		
Comments:					119	126	Pass	189		Pass		
					136	134	Pass	186		Pass		
					141	137	Pass	191		Pass		
11/13/2014	26>27	ds#6	YT	2537	123	131	Pass	185		Pass		
					136	134	Pass	186		Pass		
Comments:					127	128	Pass	187		Pass		
					138	124	Pass	182		Pass		
					141	137	Pass	188		Pass		
11/13/2014	28>29	ds#7	YT	2536	115	124	Pass	183		Pass		
					133	123	Pass	189		Pass		
Comments:					126	145	Pass	184		Pass		
					119	126	Pass	183		Pass		
					123	134	Pass	186		Pass		
11/13/2014	33>34	ds#8	YT	2537	135	126	Pass	189		Pass		
					125	132	Pass	185		Pass		
Comments:					118	141	Pass	190		Pass		
					142	129	Pass	182		Pass		
					134	138	Pass	0:00		Pass		



**NORTHWEST LININGS &
GEOTEXTILE PRODUCTS, Inc.**
"Helping to Protect the Environment"

21000 77th Avenue South
Kent, WA 98032
(253) 872-0244 / (800) 729-6954
FAX: (253) 872-0245

Date: 11/13/2014
Job #: N14152

Destructive Testing Form

Project Name: De Beque Station Ponds
Project Location: De Beque, CO
Project Description: Ponds
Project Manager: Kevin Allen

Supervisor: Alex Santana
Engineer:
Contractor:
Contact:

Material: 60-mil HDPE text.

Date/ Time	Seam #	Sample I.D.	Tester Initials	Machine Number	Track Peel Values			Tensile Value		Lab	
					In-side	Out-side	Pass/Fail	LBS/Inch	Rate	Pass/Fail	Pass / Fail
11/13/2014	35>36	ds#9	YT	2537	124	142	Pass	187		Pass	
					132	131	Pass	189		Pass	
Comments:					142	140	Pass	188		Pass	
					135	132	Pass	185		Pass	
					128	137	Pass	184		Pass	
11/13/2014	38>39	ds#10	YT	2536	132	127	Pass	190		Pass	
					126	135	Pass	187		Pass	
Comments:					145	137	Pass	184		Pass	
					146	143	Pass	182		Pass	
					134	126	Pass	187		Pass	
11/13/2014	46>47	DS#10	YT	2536	119	125	Pass	189		Pass	
					132	131	Pass	184		Pass	
Comments:					136	126	Pass	187		Pass	
					127	139	Pass	186		Pass	
					142	140	Pass	183		Pass	
11/13/2014	49>50	DS#12	YT	2536	136	127	Pass	188		Pass	
					126	129	Pass	186		Pass	
Comments:					129	136	Pass	192		Pass	
					142	135	Pass	184		Pass	
					138	131	Pass	181		Pass	
11/13/2014	55>56	DS#13	YT	2536	136	142	Pass	188		Pass	
					125	132	Pass	186		Pass	
Comments:					132	136	Pass	188		Pass	
					125	127	Pass	185		Pass	
					140	121	Pass	184		Pass	
Comments:											
Comments:											
Comments:											



**NORTHWEST LININGS &
GEOTEXTILE PRODUCTS, Inc.**
"Helping to Protect the Environment"
 21000 77th Avenue South
 Kent, WA 98032
 (253) 872-0244 / (800) 729-6954
 FAX: (253) 872-0245

Date: 11/10/2014
 Job #: N14152

Repair Report

Project Name: DE BEQUE STATION PONDS
 Project Location: DE BEQUE, CO
 Project Description: POND TOP LAYER
 Project Manager: KEVIN ALLEN

Supervisor: Alex Santana
 Engineer:
 Contractor:
 Contact:

Date	Repair ID#	Panel/ Seam#	Extruder Number	Operator Initials	Type of Repair/Detail/Location (I.E., DT Patch, Rock Hole, Burn Out, Failed Seam, ETC...)	V-Box Pass/Fail
11/11/2014	1	4,5,6	663	SS	BEAD OVER T. INT. 5' FROM N.E. CORNER	Pass
11/11/2014	2	3,4,6	663	SS	BEAD OVER T. INT. 10' FROM N.E. CORNER	Pass
11/11/2014	3	3,6,7	663	SS	2'X6' P. OVER T. INT. BURN OUT, 14' FROM N. BERM	Pass
11/11/2014	4	2,3,7	663	SS	BEAD OVER T. INT. 45' FROM E.BERM	Pass
11/11/2014	5	2,7,8	663	SS	BEAD OVER T. INT. 60' FROM N.BERM	Pass
11/11/2014	6	1,2,8	663	SS	2'X6' P. OVER T. INT. AND DS#1, 44' FROM E. BERM	Pass
11/11/2014	7	1,8,9	663	SS	BEAD OVER T. INT. 70' FROM N. BERM	Pass
11/11/2014	8	1,9,10	663	SS	BEAD OVER T. INT. 70' FROM N. BERM	Pass
11/11/2014	9	1,10,11	663	SS	BEAD OVER T. INT. 70' FROM N. BERM	Pass
11/11/2014	10	1,11,12	663	SS	BEAD OVER T. INT. 70' FROM N. BERM	Pass
11/11/2014	11	1,12,13	663	SS	BEAD OVER T. INT. 70' FROM N. BERM	Pass
11/11/2014	12	1,13,14	663	SS	BEAD OVER T. INT. 70' FROM N. BERM	Pass
11/11/2014	13	1,14,15,20	663	SS	2'X4' P. OVER X. INT. 70' FROM N. BERM	Pass
11/11/2014	14	15,16,19,20	663	SS	BEAD OVER X INT. 45' FROM N. BERM	Pass
11/11/2014	15	16,17,18,19	663	SS	2'X6' P. OVER X. AND DS#2, 6' FROM N. BERM	Pass
11/11/2014	16	1,21	663	SS	2'X6' P. OVER DS#3, 70' FROM W. BERM	Pass
11/11/2014	17	22,23	663	SS	2'X6' P. OVER DS#4, 70' FROM W. BERM	Pass
11/11/2014	18	24,25	663	SS	2'X6' P. OVER DS#5, 70' FROM W. BERM	Pass
11/11/2014	19	26,27	663	SS	2'X6' P. OVER DS#6, 70' FROM W. BERM	Pass
11/11/2014	20	26,27,28	663	SS	BEAD OVER T. INT. 95' FROM W. BERM	Pass



**NORTHWEST LININGS &
GEOTEXTILE PRODUCTS, Inc.**
"Helping to Protect the Environment"
 21000 77th Avenue South
 Kent, WA 98032
 (253) 872-0244 / (800) 729-6954
 FAX: (253) 872-0245

Date: 11/11/2014
 Job #: N14152

Repair Report

Project Name: DE BEQUE STATION PONDS
 Project Location: DE BEQUE, CO
 Project Description: POND TOP LAYER
 Project Manager: KEVIN ALLEN

Supervisor: Alex Santana
 Engineer:
 Contractor:
 Contact:

Date	Repair ID#	Panel/ Seam#	Extruder Number	Operator Initials	Type of Repair/Detail/Location (I.E., DT Patch, Rock Hole, Burn Out, Failed Seam, ETC...)	V-Box Pass/Fail
11/11/2014	21	27,28,29	663	SS	BEAD OVER T. INT. 95' FROM W. BERM	Pass
11/11/2014	22	28,29	663	SS	2'X6' P. OVER DS#7, 55' FROM E. BERM	Pass
11/11/2014	23	29,30,31	663	SS	BEAD OVER T. INT. 95' FROM W. BERM	Pass
11/11/2014	24	30,31,34	663	SS	BEAD OVER T. INT. 95' FROM W. BERM	Pass
11/11/2014	25	29,31,31-A	663	SS	BEAD OVER T. INT. 95' FROM W. BERM	Pass
11/11/2014	26	34,31,31-A	663	SS	BEAD OVER T. INT. 120' FROM W. BERM	Pass
11/11/2014	27	29,31-A,32	663	SS	BEAD OVER T. INT. 150' FROM W. BERM	Pass
11/11/2014	28	34,31-A,32	663	SS	BEAD OVER T. INT. 150' FROM W. BERM	Pass
11/11/2014	29	29,32,33	663	SS	BEAD OVER T. INT. 100' FROM E. BERM	Pass
11/11/2014	30	34,32,33	663	SS	BEAD OVER T. INT. 100' FROM E. BERM	Pass
11/11/2014	31	33,34	663	SS	2'X6' P. OVER DS#8, 55' FROM E. BERM	Pass
11/11/2014	32	35,36	663	SS	2'X6' P. OVER DS#9, 70' FROM W. BERM	Pass
11/11/2014	33	35,36,37	663	SS	BEAD OVER T. INT. 95' FROM W. BERM	Pass
11/11/2014	34	36,37,38	663	SS	BEAD OVER T. INT. 95' FROM W. BERM	Pass
11/11/2014	35	38,39	663	SS	2'X6' P. OVER DS#10, 10' FROM W. BERM	Pass
11/13/2014	36	42,43,44	663	SS	BEAD OVER T. INT. 5' FROM S. BERM	Pass
11/13/2014	37	41,42,44	663	SS	BEAD OVER T. INT. 26' FROM S. BERM	Pass
11/13/2014	38	40,41,44	663	SS	BEAD OVER T. INT. 50' FROM W. BERM	Pass
11/13/2014	39	44,45,40	663	SS	BEAD OVER T. INT. 62' FROM S. BERM	Pass
11/13/2014	40	39,40,45	663	SS	2'X2' P. OVER T. 70' FROM W. BERM	Pass



**NORTHWEST LININGS &
GEOTEXTILE PRODUCTS, Inc.**
"Helping to Protect the Environment"
 21000 77th Avenue South
 Kent, WA 98032
 (253) 872-0244 / (800) 729-6954
 FAX: (253) 872-0245

Date: 11/13/2014
 Job #: N14152

Repair Report

Project Name: DE BEQUE STATION PONDS
 Project Location: DE BEQUE, CO
 Project Description: POND TOP LAYER
 Project Manager: KEVIN ALLEN

Supervisor: Alex Santana
 Engineer: _____
 Contractor: _____
 Contact: _____

Date	Repair ID#	Panel/ Seam#	Extruder Number	Operator Initials	Type of Repair/Detail/Location (I.E., DT Patch, Rock Hole, Burn Out, Failed Seam, ETC...)	V-Box Pass/Fail
11/13/2014	41	39,45,46	663	SS	BEAD OVER T. INT. 79' FROM S. BERM	Pass
11/13/2014	42	39,46,47	663	SS	BEAD OVER T. INT. 79' FROM S. BERM	Pass
11/13/2014	43	39,47,48	663	SS	BEAD OVER T. INT. 79' FROM S. BERM	Pass
11/13/2014	44	39,48,49	663	SS	BEAD OVER T. INT. 79' FROM S. BERM	Pass
11/13/2014	45	39,49,50	663	SS	BEAD OVER T. INT. 79' FROM S. BERM	Pass
11/13/2014	46	39,50,51	663	SS	BEAD OVER T. INT. 79' FROM S. BERM	Pass
11/13/2014	47	39,51,56	663	SS	BEAD OVER T. INT. 79' FROM S. BERM	Pass
11/13/2014	48	51,52,56	663	SS	BEAD OVER T. INT. 74' FROM S. BERM	Pass
11/13/2014	49	52,55,56	663	SS	BEAD OVER T. INT. 50' FROM E. BERM	Pass
11/13/2014	50	52,53,55	663	SS	BEAD OVER T. INT. 23' FROM S. BERM	Pass
11/13/2014	51	53,54,55	663	SS	BEAD OVER T. INT. 45' FROM E BERM	Pass
11/13/2014	52	46,47	663	SS	2'X6' P. OVER DS#11, 55' FROM S. BERM	Pass
11/13/2014	53	49,50	663	SS	2'X6' P. OVER DS#12, ON S. TRENCH	Pass
11/13/2014	54	55,56	663	SS	2'X6' P. OVER DS#13, ON E. TRENCH	Pass
11/13/2014	55	56	663	SS	6" DIA. PIPE, ON E. BERM	Pass