

VOC  
(10'X10')

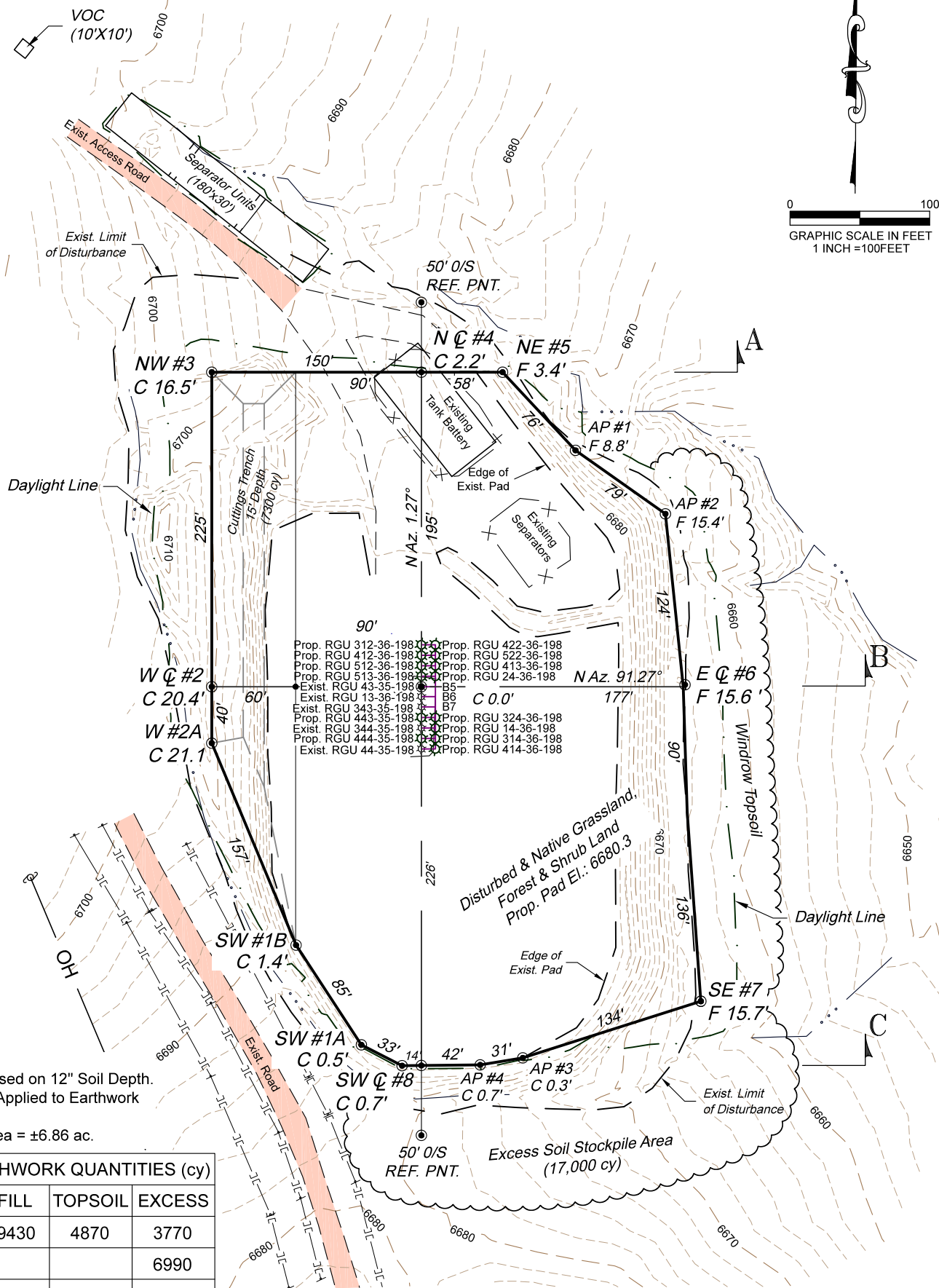

- 1.) Topsoil Volume Based on 12" Soil Depth.
- 2.) 10% Swell Factor Applied to Earthwork Cut Volume.
- 3.) Total Disturbed Area = ±6.86 ac.

| ESTIMATED EARTHWORK QUANTITIES (cy) |       |      |         |        |
|-------------------------------------|-------|------|---------|--------|
| ITEM                                | CUT   | FILL | TOPSOIL | EXCESS |
| PAD                                 | 18070 | 9430 | 4870    | 3770   |
| PIT                                 | 6990  |      |         | 6990   |
| TOTALS                              | 25060 | 9430 | 4870    | 10760  |

REVISED: 3/3/15

**Construction Plan Prepared for:**  
**WPXENERGY.** WPX Energy Rocky Mountain, LLC

RGU 13-36-198 Drill Pad - Plat 2  
CONSTRUCTION LAYOUT

136 East Third Street  
Rifle, Colorado 81650  
Ph. (970) 625-2720  
Fax (970) 625-2773



**BOOKCLIFF**  
*Survey Services, Inc.*

SCALE: 1" = 100'  
DATE: 11/11/14  
PLAT: 2 of 7  
PROJECT: Highlands  
DFT: cws

Section 36  
T. 1 S., R. 98 W.  
6th. P.M.

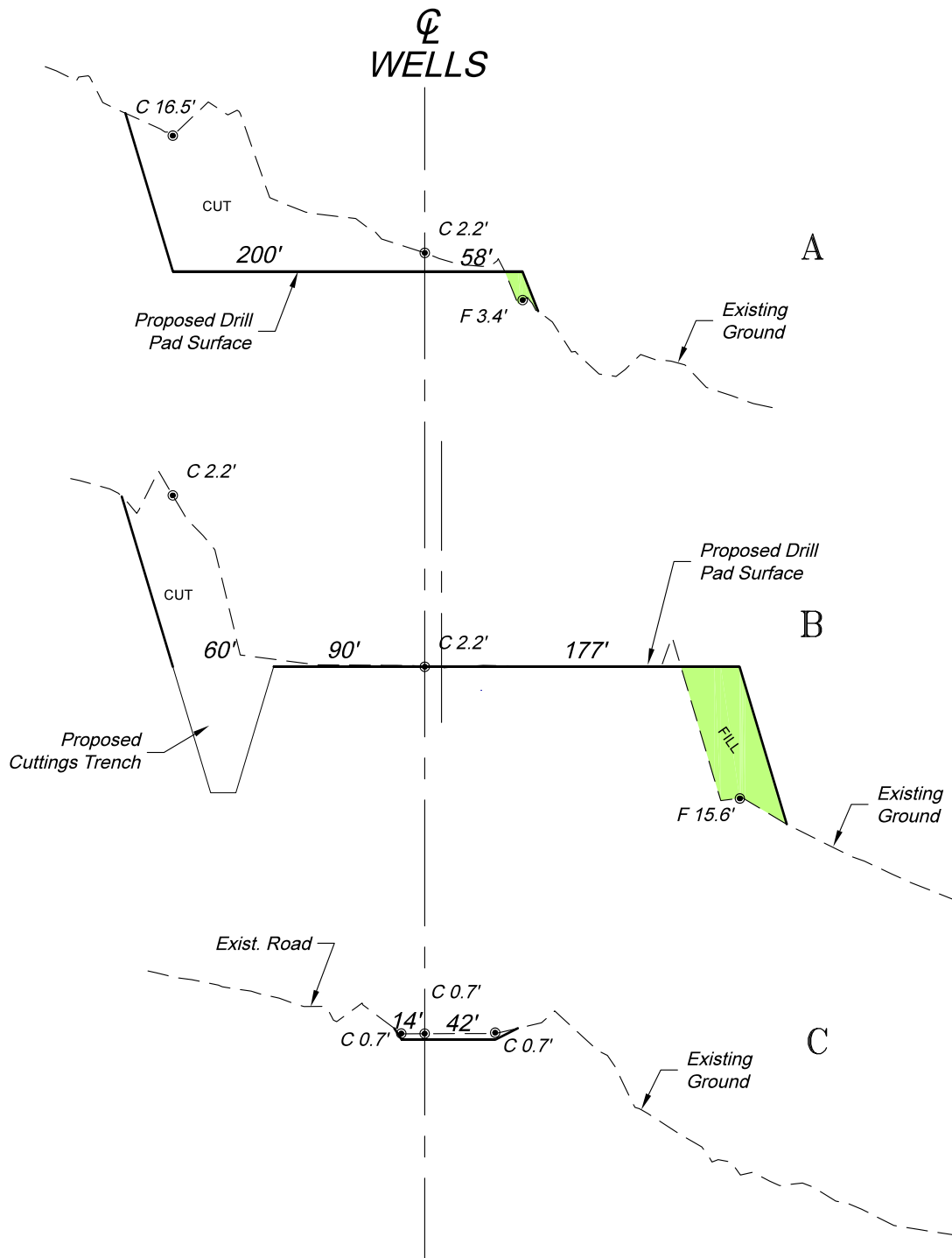

SCALE: Horiz.: 1" = 100'  
Vert.: 1" = 20'

\*NOTE:  
CUT SLOPE: 1.5:1  
FILL SLOPE: 1.5:1,  
OTHERWISE NOTED.

REVISED: 3/3/15

136 East Third Street  
Rifle, Colorado 81650  
Ph. (970) 625-2720  
Fax (970) 625-2773



SCALE: As Noted  
DATE: 11/11/14  
PLAT: 3 of 7  
PROJECT: Highlands  
DFT: cws

**Construction Plan Prepared for:**  
**WPXENERGY** WPX Energy Rocky Mountain, LLC  
**RGU 13-36-198 Drill Pad - Plat 3**  
**CONSTRUCTION LAYOUT**  
**CROSS SECTIONS**