

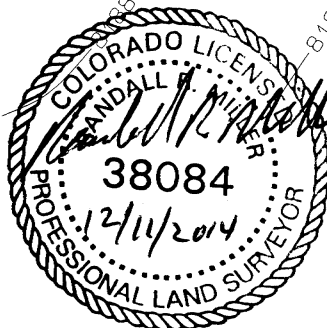

CONSTRUCTION LAYOUT
GRIZZLY 3-36H AND PETERSON RIDGE 6-36H
SECTION 36, T8N, R81W, 6th PM

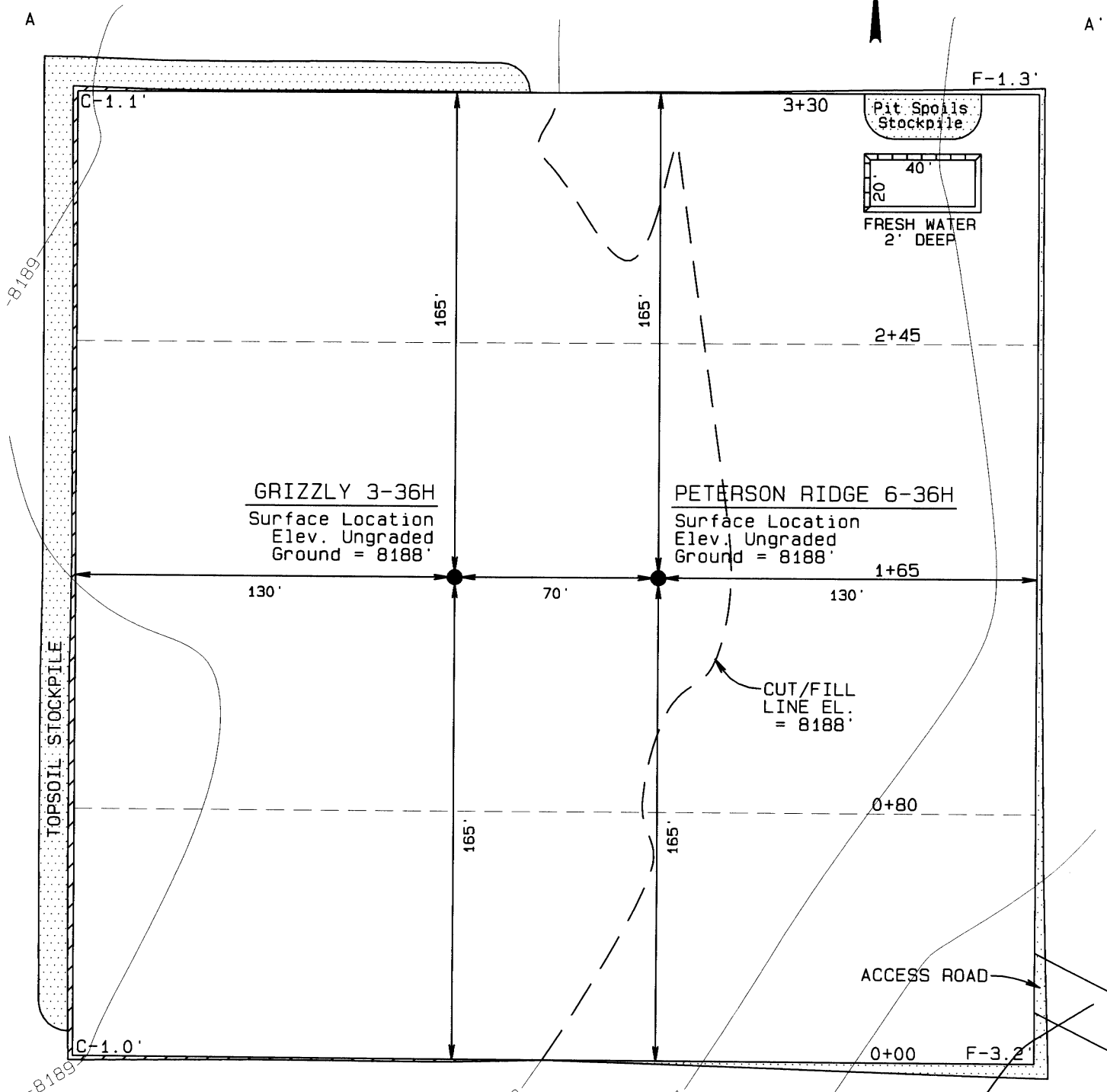

GRAPHIC SCALE 1"=50'

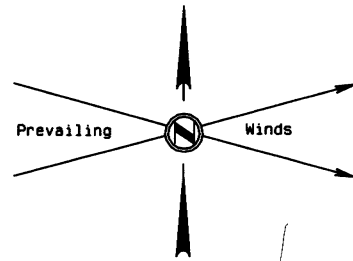

A horizontal graphic scale bar. The left end is labeled '50', the center is labeled '0', and the right end is labeled '50'. The bar is divided into segments of alternating black and white. Above the bar, the text 'GRAPHIC SCALE' is on the left and '1"=50\'' is on the right.

EE3 LLC

CONSTRUCTION LAYOUT CROSS SECTION GRIZZLY 3-36H AND PETERSON RIDGE 6-36H SECTION 36, T8N, R81W, 6th PM

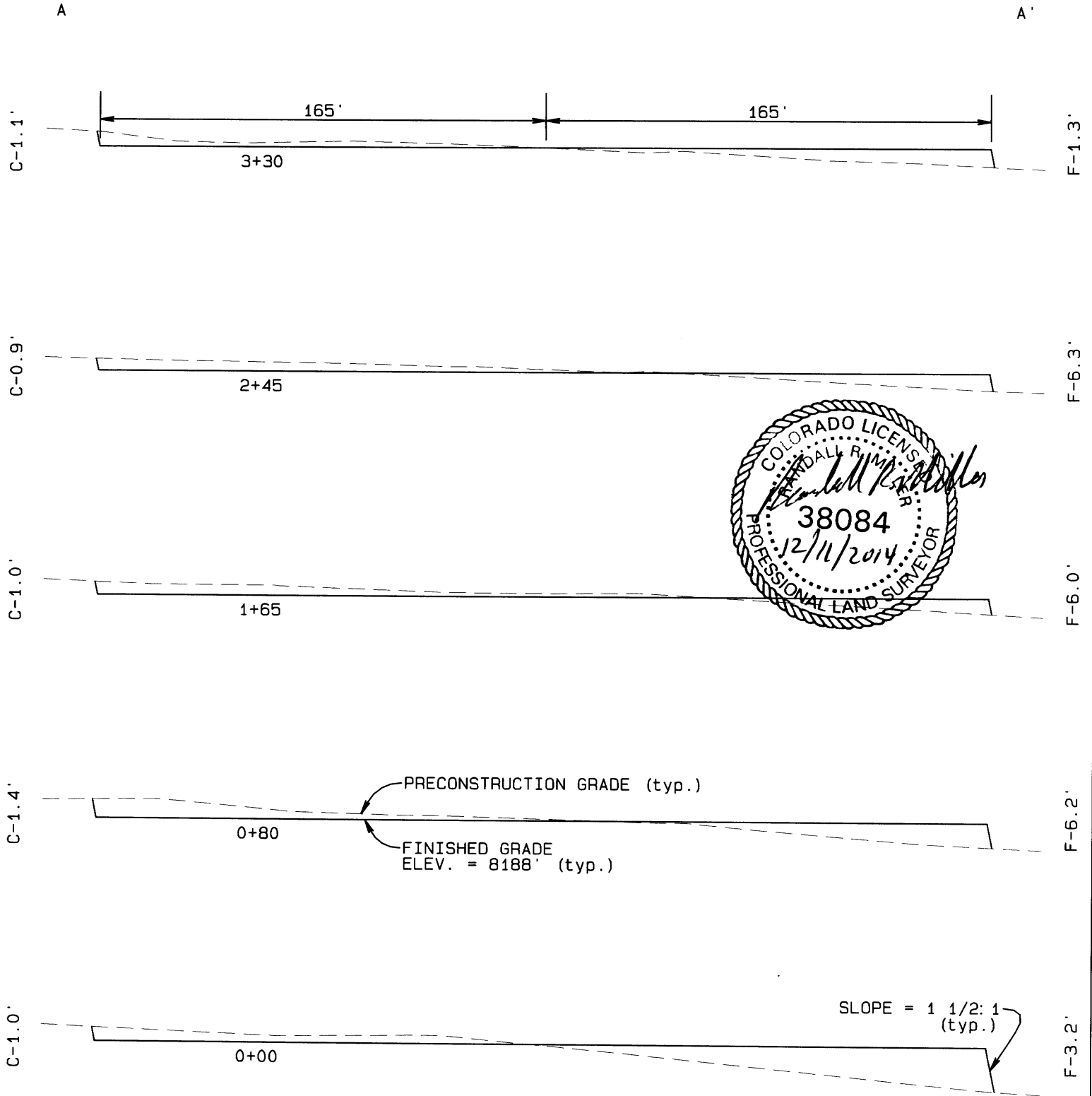

Vertical Exag = 5 Times

Final Pad Grade = 8188'

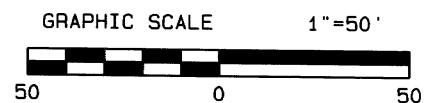

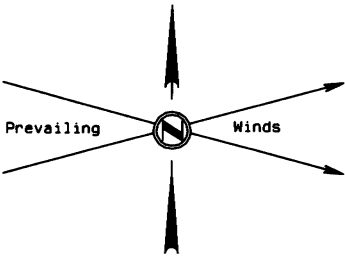

EE3 LLC
TYPICAL RIG LAYOUT
GRIZZLY 3-36H
SECTION 36, T8N, R81W, 6th PM

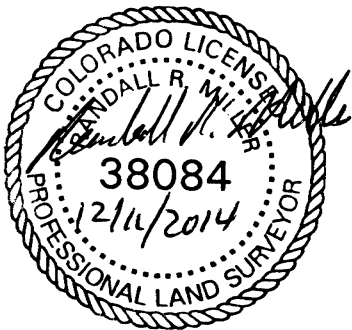
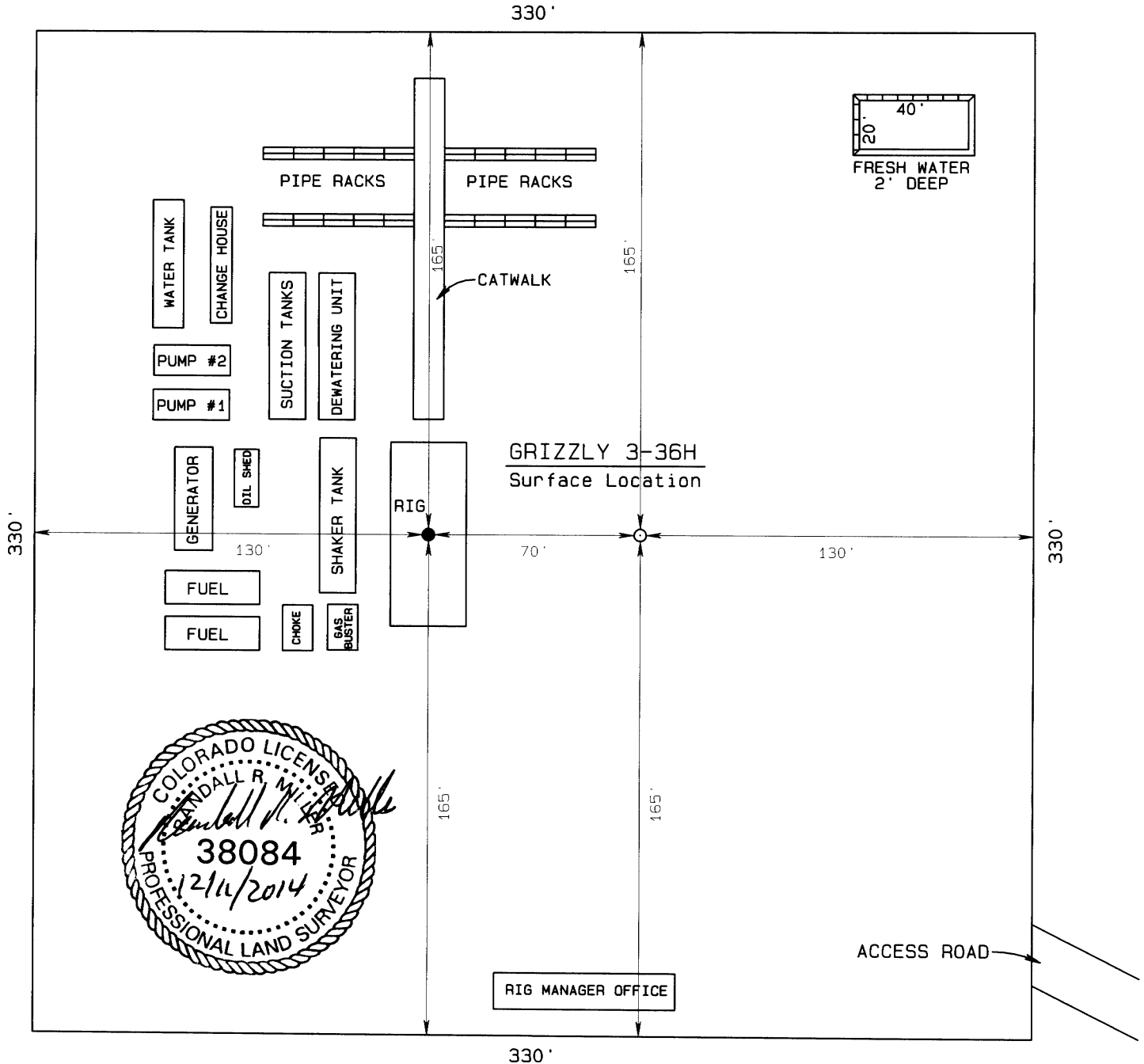

Final Pad Grade = 8188'

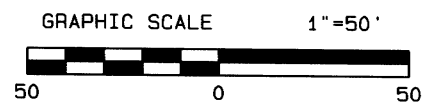

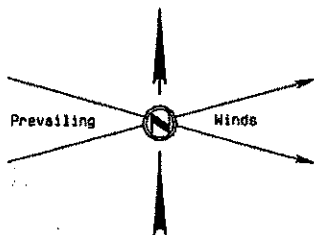

EE3 LLC
PRODUCTION FACILITY LAYOUT
GRIZZLY 3-36H AND PETERSON RIDGE 6-36H
SECTION 36, T8N, R81W, 6th PM

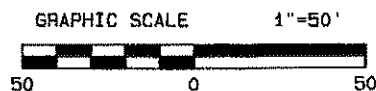
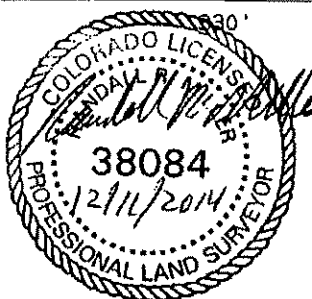
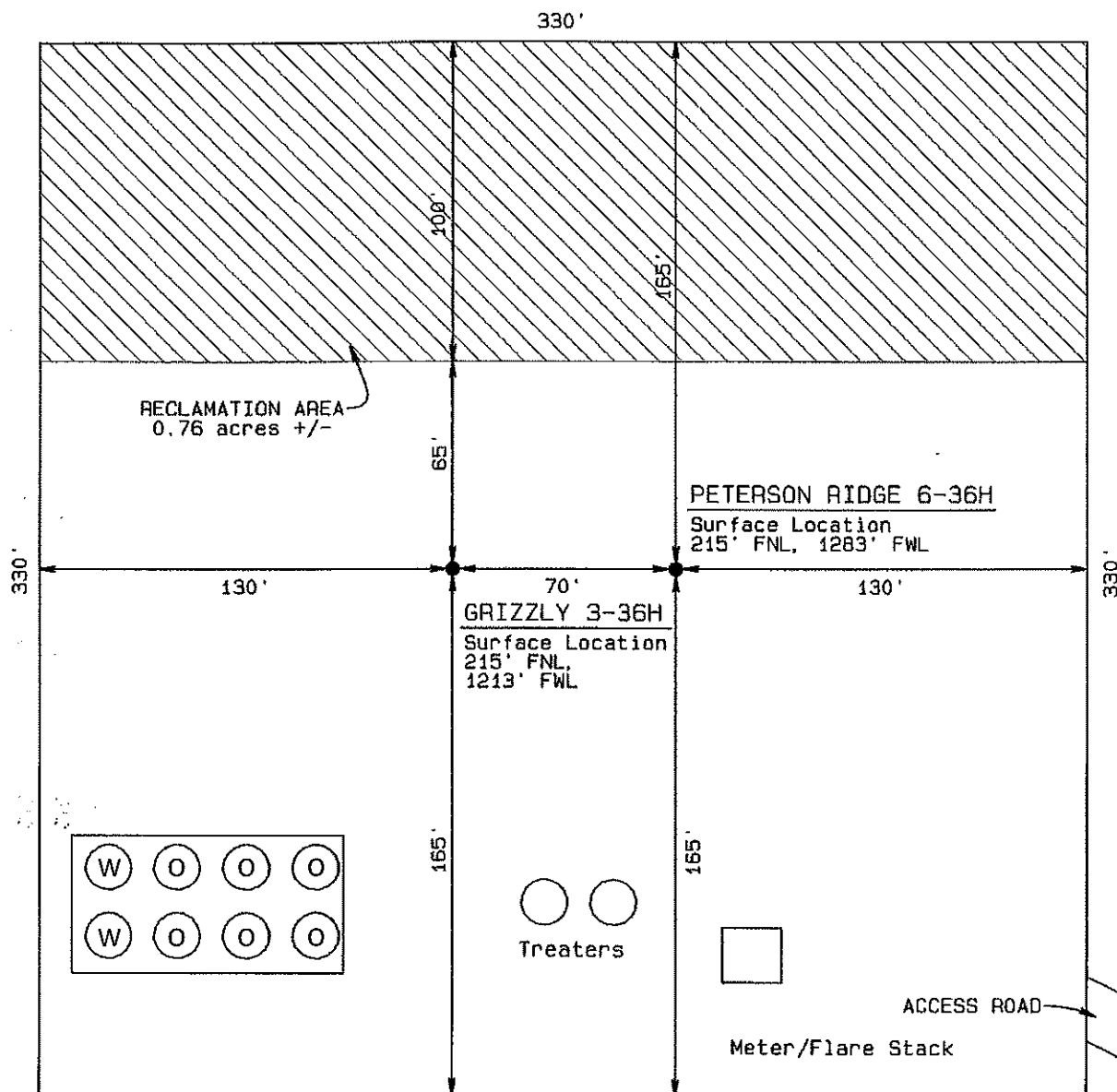

Final Pad Grade = 8188'

NORTH PARK ENGINEERING & CONSULTING, INC.
PO Box 395 Walden, CO 80480 970-723-3725