

Location:	COLORADO	Slot:	SLOT#05 KERR 14C-25HZ (576'FSL & 1966'FWL, SEC.13)
Field:	WELD COUNTY (KERR MCGEE)	Well:	KERR 14C-25HZ
Facility:	SEC.13-T2N-R67W	Wellbore:	KERR 14C-25HZ PWB

Plot reference wellpath is KERR 14C-25HZ (REV-A.0) PWP	
True vertical depths are referenced to XTREME 24 (16KB) (RKB)	Grid System: NAD83 / Lambert Colorado SP, Northern Zone (501), US feet
Measured depths are referenced to XTREME 24 (16KB) (RKB)	North Reference: True north
XTREME 24 (16KB) (RKB) to Mean Sea Level: 4899 feet	Scale: True distance
Mean Sea Level to Mud line (At Slot: SLOT#05 KERR 14C-25HZ (576FSL & 1966FWL, SEC.13)): 0 feet	Depths are in feet
Coordinates are in feet referenced to SLO	Created by: robale01 on 1/20/2015

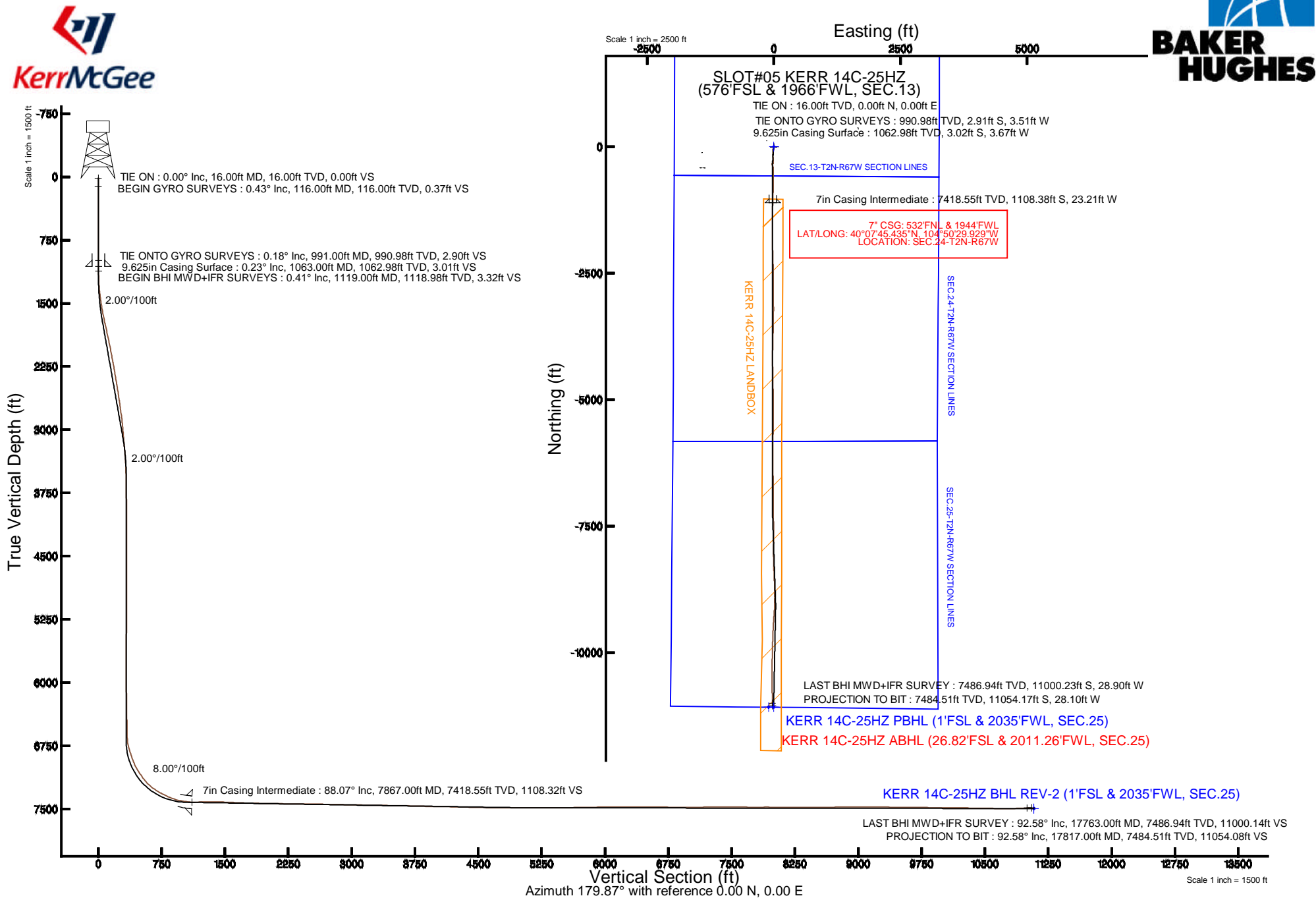

## REFERENCE WELLPATH IDENTIFICATION

Operator	KERR-MCGEE OIL & GAS ONSHORE LP (LAMBERT STATE PLANE COORD)	Slot	SLOT#05 KERR 14C-25HZ (576'FSL & 1966'FWL, SEC.13)
Area	COLORADO	Well	KERR 14C-25HZ
Field	WELD COUNTY (KERR MCGEE)	Wellbore	KERR 14C-25HZ AWB <116-17817>
Facility	SEC.13-T2N-R67W		

## REPORT SETUP INFORMATION

Projection System	NAD83 / Lambert Colorado SP, Northern Zone (501), US feet	Software System	WellArchitect® 4.0.0
North Reference	True	User	Robiale01
Scale	0.999959	Report Generated	1/20/2015 at 8:55:50 AM
Convergence at slot	n/a	Database/Source file	WellArchitectDB/KERR_14C-25HZ_AWB_116-17817_.xml

## WELLPATH LOCATION

	Local coordinates		Grid coordinates		Geographic coordinates	
	North[ft]	East[ft]	Easting[US ft]	Northing[US ft]	Latitude	Longitude
Slot Location	-375.17	-1673.23	3184103.62	1291735.06	40°07'56.388"N	104°50'29.630"W
Facility Reference Pt			3185773.91	1292122.74	40°08'00.096"N	104°50'08.088"W
Field Reference Pt			3197771.84	1268891.29	40°04'09.600"N	104°47'36.000"W

## WELLPATH DATUM

Calculation method	Minimum curvature	XTREME 24 (16'KB) (RKB) to Facility Vertical Datum	4899.00ft
Horizontal Reference Pt	Slot	XTREME 24 (16'KB) (RKB) to Mean Sea Level	4899.00ft
Vertical Reference Pt	XTREME 24 (16'KB) (RKB)	XTREME 24 (16'KB) (RKB) to Mud Line at Slot (SLOT#05 KERR 14C-25HZ (576'FSL & 1966'FWL, SEC.13))	4899.00ft
MD Reference Pt	XTREME 24 (16'KB) (RKB)	Section Origin	N 0.00, E 0.00 ft
Field Vertical Reference	Mean Sea Level	Section Azimuth	180.15°

REFERENCE WELLPATH IDENTIFICATION			
Operator	KERR-MCGEE OIL & GAS ONSHORE LP (LAMBERT STATE PLANE COORD)	Slot	SLOT#05 KERR 14C-25HZ (576'FSL & 1966'FWL, SEC.13)
Area	COLORADO	Well	KERR 14C-25HZ
Field	WELD COUNTY (KERR MCGEE)	Wellbore	KERR 14C-25HZ AWB <116-17817>
Facility	SEC.13-T2N-R67W		

WELLPATH DATA (170 stations) † = interpolated/extrapolated station										
MD [ft]	Inclination [°]	Azimuth [°]	TVD [ft]	Vert Sect [ft]	North [ft]	East [ft]	Latitude	Longitude	DLS [°/100ft]	Comments
0.00†	0.000	186.516	0.00	0.00	0.00	0.00	40°07'56.388"N	104°50'29.630"W	0.00	
16.00	0.000	186.516	16.00	0.00	0.00	0.00	40°07'56.388"N	104°50'29.630"W	0.00	TIE ON
116.00	0.428	186.516	116.00	0.37	-0.37	-0.04	40°07'56.384"N	104°50'29.631"W	0.43	BEGIN GYRO SURVEYS
216.00	0.430	199.432	216.00	1.10	-1.10	-0.21	40°07'56.377"N	104°50'29.633"W	0.10	
316.00	0.353	210.220	315.99	1.72	-1.72	-0.49	40°07'56.371"N	104°50'29.636"W	0.11	
416.00	0.270	247.421	415.99	2.07	-2.07	-0.86	40°07'56.368"N	104°50'29.641"W	0.21	
516.00	0.228	190.419	515.99	2.36	-2.36	-1.12	40°07'56.365"N	104°50'29.644"W	0.24	
616.00	0.335	262.094	615.99	2.60	-2.59	-1.44	40°07'56.362"N	104°50'29.649"W	0.34	
716.00	0.343	240.672	715.99	2.79	-2.78	-1.99	40°07'56.361"N	104°50'29.656"W	0.13	
816.00	0.294	277.734	815.99	2.90	-2.89	-2.51	40°07'56.359"N	104°50'29.662"W	0.21	
916.00	0.417	263.497	915.99	2.91	-2.90	-3.12	40°07'56.359"N	104°50'29.670"W	0.15	
991.00	0.178	281.023	990.98	2.92	-2.91	-3.51	40°07'56.359"N	104°50'29.675"W	0.34	TIE ONTO GYRO SURVEYS
1119.00	0.410	180.130	1118.98	3.34	-3.33	-3.70	40°07'56.355"N	104°50'29.678"W	0.37	BEGIN BHI MWD+IFR SURVEYS
1182.00	1.640	204.170	1181.97	4.39	-4.38	-4.07	40°07'56.345"N	104°50'29.682"W	2.03	
1276.00	3.780	202.570	1275.86	8.48	-8.47	-5.81	40°07'56.304"N	104°50'29.705"W	2.28	
1370.00	6.520	189.000	1369.48	16.62	-16.60	-7.84	40°07'56.224"N	104°50'29.731"W	3.17	
1464.00	7.930	186.750	1462.73	28.33	-28.31	-9.44	40°07'56.108"N	104°50'29.751"W	1.53	
1558.00	10.050	195.100	1555.57	42.70	-42.67	-12.34	40°07'55.966"N	104°50'29.789"W	2.64	
1652.00	11.650	191.520	1647.89	59.93	-59.89	-16.37	40°07'55.796"N	104°50'29.841"W	1.85	
1746.00	13.090	180.810	1739.72	79.88	-79.84	-18.41	40°07'55.599"N	104°50'29.867"W	2.88	
1840.00	12.070	181.110	1831.46	100.36	-100.31	-18.75	40°07'55.397"N	104°50'29.871"W	1.09	
1935.00	11.730	179.660	1924.42	119.94	-119.90	-18.89	40°07'55.203"N	104°50'29.873"W	0.48	
2030.00	11.200	178.130	2017.52	138.82	-138.77	-18.53	40°07'55.017"N	104°50'29.869"W	0.64	
2122.00	10.830	178.070	2107.83	156.39	-156.34	-17.95	40°07'54.843"N	104°50'29.861"W	0.40	
2214.00	10.500	177.630	2198.24	173.40	-173.36	-17.31	40°07'54.675"N	104°50'29.853"W	0.37	
2304.00	10.080	176.900	2286.79	189.46	-189.41	-16.55	40°07'54.516"N	104°50'29.843"W	0.49	
2395.00	9.670	176.490	2376.44	205.03	-204.99	-15.65	40°07'54.362"N	104°50'29.831"W	0.46	
2487.00	9.410	176.370	2467.17	220.25	-220.21	-14.70	40°07'54.212"N	104°50'29.819"W	0.28	
2579.00	8.740	176.480	2558.02	234.73	-234.70	-13.79	40°07'54.069"N	104°50'29.808"W	0.73	
2671.00	8.380	177.120	2648.99	248.40	-248.37	-13.03	40°07'53.934"N	104°50'29.798"W	0.40	
2763.00	7.820	175.290	2740.07	261.33	-261.30	-12.18	40°07'53.806"N	104°50'29.787"W	0.67	
2855.00	7.640	175.480	2831.24	273.66	-273.63	-11.18	40°07'53.684"N	104°50'29.774"W	0.20	
2946.00	5.530	179.630	2921.63	284.08	-284.05	-10.68	40°07'53.581"N	104°50'29.767"W	2.38	
3039.00	5.330	179.690	3014.22	292.88	-292.85	-10.62	40°07'53.494"N	104°50'29.767"W	0.22	
3130.00	4.940	180.000	3104.85	301.02	-301.00	-10.60	40°07'53.414"N	104°50'29.766"W	0.43	
3222.00	4.730	182.540	3196.52	308.77	-308.75	-10.77	40°07'53.337"N	104°50'29.769"W	0.33	
3313.00	4.690	182.070	3287.22	316.24	-316.21	-11.07	40°07'53.263"N	104°50'29.773"W	0.06	
3405.00	2.940	196.390	3379.01	322.26	-322.24	-11.87	40°07'53.204"N	104°50'29.783"W	2.15	
3497.00	2.700	194.700	3470.90	326.63	-326.59	-13.09	40°07'53.161"N	104°50'29.798"W	0.28	
3589.00	1.120	189.980	3562.84	329.61	-329.58	-13.79	40°07'53.131"N	104°50'29.808"W	1.72	
3867.00	0.800	227.460	3840.81	333.60	-333.56	-15.69	40°07'53.092"N	104°50'29.832"W	0.25	
4147.00	0.630	251.360	4120.79	335.42	-335.38	-18.59	40°07'53.074"N	104°50'29.869"W	0.12	
4426.00	0.200	241.780	4399.78	336.15	-336.10	-20.47	40°07'53.067"N	104°50'29.894"W	0.16	
4705.00	0.350	26.690	4678.78	335.62	-335.57	-20.52	40°07'53.072"N	104°50'29.894"W	0.19	
4972.00	0.130	333.040	4945.78	334.62	-334.57	-20.29	40°07'53.082"N	104°50'29.891"W	0.11	

## REFERENCE WELLPATH IDENTIFICATION

Operator	KERR-MCGEE OIL & GAS ONSHORE LP (LAMBERT STATE PLANE COORD)	Slot	SLOT#05 KERR 14C-25HZ (576'FSL & 1966'FWL, SEC.13)
Area	COLORADO	Well	KERR 14C-25HZ
Field	WELD COUNTY (KERR MCGEE)	Wellbore	KERR 14C-25HZ AWB <116-17817>
Facility	SEC.13-T2N-R67W		

## WELLPATH DATA (170 stations)

† = interpolated/extrapolated station

MD [ft]	Inclination [°]	Azimuth [°]	TVD [ft]	Vert Sect [ft]	North [ft]	East [ft]	Latitude	Longitude	DLS [°/100ft]	Comments
5239.00	0.380	73.580	5212.77	334.10	-334.05	-19.58	40°07'53.087"N	104°50'29.882"W	0.16	
5506.00	0.590	294.000	5479.77	333.29	-333.24	-19.99	40°07'53.095"N	104°50'29.887"W	0.34	
5773.00	0.770	290.540	5746.75	332.11	-332.05	-22.92	40°07'53.107"N	104°50'29.925"W	0.07	
6036.00	1.070	243.990	6009.72	332.57	-332.51	-26.78	40°07'53.102"N	104°50'29.975"W	0.30	
6291.00	1.050	213.860	6264.68	335.57	-335.49	-30.22	40°07'53.073"N	104°50'30.019"W	0.22	
6633.00	1.250	208.560	6606.61	341.46	-341.37	-33.75	40°07'53.015"N	104°50'30.065"W	0.07	
6717.00	4.660	160.590	6690.49	345.48	-345.40	-33.06	40°07'52.975"N	104°50'30.056"W	4.68	
6802.00	18.690	164.380	6773.53	361.92	-361.85	-28.22	40°07'52.812"N	104°50'29.993"W	16.52	
6886.00	17.930	161.610	6853.27	387.13	-387.08	-20.52	40°07'52.563"N	104°50'29.894"W	1.38	
6972.00	21.690	168.360	6934.18	415.26	-415.22	-13.13	40°07'52.285"N	104°50'29.799"W	5.11	
7057.00	28.820	181.840	7011.07	451.19	-451.16	-10.61	40°07'51.930"N	104°50'29.767"W	10.73	
7142.00	34.080	181.850	7083.56	495.50	-495.47	-12.04	40°07'51.492"N	104°50'29.785"W	6.19	
7227.00	38.640	178.560	7152.00	545.86	-545.83	-12.14	40°07'50.994"N	104°50'29.786"W	5.83	
7312.00	46.880	176.980	7214.35	603.47	-603.44	-9.84	40°07'50.425"N	104°50'29.757"W	9.78	
7397.00	56.610	179.840	7266.93	670.09	-670.08	-8.10	40°07'49.766"N	104°50'29.734"W	11.75	
7483.00	61.060	182.060	7311.42	743.65	-743.63	-9.35	40°07'49.039"N	104°50'29.750"W	5.63	
7568.00	65.390	181.400	7349.71	819.49	-819.46	-11.63	40°07'48.290"N	104°50'29.780"W	5.14	
7655.00	72.010	182.790	7381.29	900.45	-900.42	-14.62	40°07'47.490"N	104°50'29.818"W	7.75	
7740.00	79.400	183.030	7402.27	982.67	-982.62	-18.80	40°07'46.678"N	104°50'29.872"W	8.70	
7824.00	82.920	181.720	7415.17	1065.59	-1065.54	-22.23	40°07'45.858"N	104°50'29.916"W	4.46	
7867.00†	88.068	180.881	7418.55	1108.43	-1108.38	-23.21	40°07'45.435"N	104°50'29.929"W	12.13	7" CASING POINT
7898.00	91.780	180.280	7418.59	1139.43	-1139.37	-23.52	40°07'45.129"N	104°50'29.933"W	12.13	
7983.00	91.500	180.690	7416.16	1224.39	-1224.33	-24.24	40°07'44.289"N	104°50'29.942"W	0.58	
8068.00	90.800	180.890	7414.45	1309.37	-1309.31	-25.41	40°07'43.449"N	104°50'29.957"W	0.86	
8153.00	89.660	180.800	7414.11	1394.36	-1394.30	-26.66	40°07'42.609"N	104°50'29.973"W	1.35	
8238.00	87.260	180.540	7416.40	1479.32	-1479.25	-27.66	40°07'41.770"N	104°50'29.986"W	2.84	
8323.00	87.570	179.860	7420.23	1564.23	-1564.17	-27.95	40°07'40.931"N	104°50'29.990"W	0.88	
8408.00	87.380	180.230	7423.97	1649.15	-1649.08	-28.02	40°07'40.092"N	104°50'29.991"W	0.49	
8493.00	87.570	179.180	7427.72	1734.06	-1734.00	-27.58	40°07'39.252"N	104°50'29.985"W	1.25	
8578.00	88.710	179.490	7430.48	1819.01	-1818.95	-26.60	40°07'38.413"N	104°50'29.972"W	1.39	
8663.00	88.920	179.400	7432.24	1903.98	-1903.92	-25.77	40°07'37.573"N	104°50'29.962"W	0.27	
8749.00	89.110	179.230	7433.71	1989.96	-1989.91	-24.75	40°07'36.724"N	104°50'29.949"W	0.30	
8833.00	88.950	178.360	7435.14	2073.93	-2073.87	-22.98	40°07'35.894"N	104°50'29.926"W	1.05	
8918.00	88.860	178.250	7436.76	2158.87	-2158.82	-20.47	40°07'35.054"N	104°50'29.893"W	0.17	
9004.00	89.420	178.270	7438.05	2244.81	-2244.77	-17.86	40°07'34.205"N	104°50'29.860"W	0.65	
9089.00	89.720	178.230	7438.69	2329.76	-2329.73	-15.26	40°07'33.365"N	104°50'29.826"W	0.36	
9174.00	89.540	179.680	7439.24	2414.74	-2414.71	-13.71	40°07'32.526"N	104°50'29.806"W	1.72	
9259.00	89.850	180.000	7439.69	2499.74	-2499.71	-13.47	40°07'31.686"N	104°50'29.803"W	0.52	
9344.00	88.740	179.620	7440.74	2584.73	-2584.70	-13.19	40°07'30.846"N	104°50'29.800"W	1.38	
9429.00	88.980	179.710	7442.43	2669.71	-2669.68	-12.69	40°07'30.006"N	104°50'29.793"W	0.30	
9514.00	89.260	179.160	7443.73	2754.69	-2754.67	-11.86	40°07'29.166"N	104°50'29.783"W	0.73	
9599.00	88.400	180.010	7445.47	2839.67	-2839.65	-11.24	40°07'28.326"N	104°50'29.775"W	1.42	
9684.00	88.520	179.350	7447.75	2924.63	-2924.61	-10.77	40°07'27.487"N	104°50'29.769"W	0.79	
9770.00	88.800	179.270	7449.76	3010.60	-3010.58	-9.73	40°07'26.637"N	104°50'29.755"W	0.34	
9855.00	88.680	178.590	7451.63	3095.56	-3095.55	-8.14	40°07'25.797"N	104°50'29.735"W	0.81	

REFERENCE WELLPATH IDENTIFICATION			
Operator	KERR-MCGEE OIL & GAS ONSHORE LP (LAMBERT STATE PLANE COORD)	Slot	SLOT#05 KERR 14C-25HZ (576'FSL & 1966'FWL, SEC.13)
Area	COLORADO	Well	KERR 14C-25HZ
Field	WELD COUNTY (KERR MCGEE)	Wellbore	KERR 14C-25HZ AWB <116-17817>
Facility	SEC.13-T2N-R67W		

WELLPATH DATA (170 stations)										
MD [ft]	Inclination [°]	Azimuth [°]	TVD [ft]	Vert Sect [ft]	North [ft]	East [ft]	Latitude	Longitude	DLS [°/100ft]	Comments
9940.00	89.110	179.810	7453.27	3180.53	-3180.52	-6.96	40°07'24.958"N	104°50'29.720"W	1.52	
10025.00	88.890	180.590	7454.76	3265.52	-3265.51	-7.25	40°07'24.118"N	104°50'29.723"W	0.95	
10117.00	89.190	180.730	7456.30	3357.50	-3357.49	-8.31	40°07'23.209"N	104°50'29.737"W	0.36	
10299.00	89.010	180.830	7459.16	3539.47	-3539.45	-10.79	40°07'21.411"N	104°50'29.769"W	0.11	
10390.00	88.820	182.150	7460.88	3630.42	-3630.40	-13.16	40°07'20.512"N	104°50'29.799"W	1.47	
10574.00	88.210	181.280	7465.65	3814.29	-3814.25	-18.66	40°07'18.695"N	104°50'29.870"W	0.58	
10758.00	89.410	181.500	7469.47	3998.20	-3998.16	-23.12	40°07'16.878"N	104°50'29.928"W	0.66	
10850.00	89.010	180.610	7470.74	4090.18	-4090.13	-24.82	40°07'15.969"N	104°50'29.949"W	1.06	
11033.00	88.610	179.220	7474.54	4273.13	-4273.09	-24.55	40°07'14.161"N	104°50'29.946"W	0.79	
11217.00	88.420	179.300	7479.31	4457.05	-4457.01	-22.17	40°07'12.343"N	104°50'29.915"W	0.11	
11400.00	89.070	178.600	7483.32	4639.97	-4639.93	-18.82	40°07'10.536"N	104°50'29.872"W	0.52	
11583.00	89.380	178.880	7485.79	4822.89	-4822.87	-14.79	40°07'08.728"N	104°50'29.820"W	0.23	
11769.00	90.270	179.850	7486.36	5008.87	-5008.85	-12.73	40°07'06.890"N	104°50'29.794"W	0.71	
11955.00	90.520	180.990	7485.08	5194.86	-5194.84	-14.10	40°07'05.052"N	104°50'29.811"W	0.63	
12048.00	89.900	179.430	7484.74	5287.86	-5287.84	-14.44	40°07'04.133"N	104°50'29.816"W	1.81	
12142.00	90.060	180.580	7484.77	5381.85	-5381.84	-14.44	40°07'03.204"N	104°50'29.816"W	1.24	
12234.00	90.620	179.750	7484.22	5473.85	-5473.83	-14.71	40°07'02.295"N	104°50'29.819"W	1.09	
12327.00	90.890	179.910	7483.00	5566.84	-5566.82	-14.43	40°07'01.376"N	104°50'29.816"W	0.34	
12420.00	90.890	180.840	7481.55	5659.83	-5659.81	-15.04	40°07'00.457"N	104°50'29.824"W	1.00	
12514.00	90.590	180.030	7480.34	5753.82	-5753.80	-15.76	40°06'59.528"N	104°50'29.833"W	0.92	
12607.00	91.380	180.330	7478.74	5846.81	-5846.78	-16.05	40°06'58.609"N	104°50'29.837"W	0.91	
12700.00	91.290	181.220	7476.57	5939.77	-5939.75	-17.31	40°06'57.691"N	104°50'29.853"W	0.96	
12785.00	91.570	180.880	7474.45	6024.74	-6024.71	-18.86	40°06'56.851"N	104°50'29.873"W	0.52	
12870.00	90.400	180.830	7472.99	6109.72	-6109.68	-20.13	40°06'56.011"N	104°50'29.889"W	1.38	
12956.00	89.910	180.600	7472.76	6195.71	-6195.68	-21.20	40°06'55.162"N	104°50'29.903"W	0.63	
13040.00	89.450	179.420	7473.23	6279.71	-6279.67	-21.22	40°06'54.332"N	104°50'29.903"W	1.51	
13125.00	89.140	178.760	7474.27	6364.69	-6364.66	-19.87	40°06'53.492"N	104°50'29.886"W	0.86	
13211.00	89.420	177.610	7475.35	6450.63	-6450.60	-17.15	40°06'52.642"N	104°50'29.851"W	1.38	
13296.00	90.030	178.690	7475.76	6535.57	-6535.56	-14.40	40°06'51.803"N	104°50'29.815"W	1.46	
13381.00	89.840	179.410	7475.86	6620.56	-6620.55	-12.99	40°06'50.963"N	104°50'29.797"W	0.88	
13466.00	89.190	179.900	7476.58	6705.55	-6705.54	-12.48	40°06'50.123"N	104°50'29.791"W	0.96	
13551.00	89.350	179.110	7477.66	6790.54	-6790.53	-11.75	40°06'49.283"N	104°50'29.781"W	0.95	
13721.00	89.840	179.780	7478.86	6960.52	-6960.52	-10.10	40°06'47.603"N	104°50'29.760"W	0.49	
13891.00	90.860	179.740	7477.82	7130.51	-7130.51	-9.39	40°06'45.924"N	104°50'29.751"W	0.60	
13977.00	90.950	180.180	7476.47	7216.50	-7216.50	-9.33	40°06'45.074"N	104°50'29.750"W	0.52	
14061.00	89.470	179.520	7476.16	7300.49	-7300.49	-9.11	40°06'44.244"N	104°50'29.747"W	1.93	
14147.00	89.750	178.410	7476.74	7386.47	-7386.48	-7.55	40°06'43.394"N	104°50'29.727"W	1.33	
14317.00	90.030	179.210	7477.07	7556.42	-7556.44	-4.02	40°06'41.714"N	104°50'29.682"W	0.50	
14404.00	89.930	180.380	7477.10	7643.42	-7643.44	-3.71	40°06'40.855"N	104°50'29.678"W	1.35	
14489.00	89.440	180.940	7477.57	7728.42	-7728.43	-4.69	40°06'40.015"N	104°50'29.690"W	0.88	
14576.00	90.460	181.300	7477.64	7815.40	-7815.41	-6.39	40°06'39.155"N	104°50'29.712"W	1.24	
14661.00	90.240	181.070	7477.12	7900.39	-7900.39	-8.15	40°06'38.315"N	104°50'29.735"W	0.37	
14746.00	89.010	179.760	7477.68	7985.38	-7985.38	-8.77	40°06'37.476"N	104°50'29.743"W	2.11	
14831.00	89.380	178.950	7478.87	8070.36	-8070.37	-7.81	40°06'36.636"N	104°50'29.731"W	1.05	
14915.00	90.430	178.430	7479.01	8154.33	-8154.34	-5.89	40°06'35.806"N	104°50'29.706"W	1.39	

## REFERENCE WELLPATH IDENTIFICATION

Operator	KERR-MCGEE OIL & GAS ONSHORE LP (LAMBERT STATE PLANE COORD)	Slot	SLOT#05 KERR 14C-25HZ (576'FSL & 1966'FWL, SEC.13)
Area	COLORADO	Well	KERR 14C-25HZ
Field	WELD COUNTY (KERR MCGEE)	Wellbore	KERR 14C-25HZ AWB <116-17817>
Facility	SEC.13-T2N-R67W		

## WELLPATH DATA (170 stations)

MD [ft]	Inclination [°]	Azimuth [°]	TVD [ft]	Vert Sect [ft]	North [ft]	East [ft]	Latitude	Longitude	DLS [°/100ft]	Comments
15000.00	89.200	178.340	7479.29	8239.29	-8239.31	-3.49	40°06'34.966"N	104°50'29.675"W	1.45	
15085.00	89.690	178.400	7480.11	8324.25	-8324.27	-1.08	40°06'34.127"N	104°50'29.644"W	0.58	
15170.00	90.090	177.360	7480.27	8409.18	-8409.21	2.07	40°06'33.287"N	104°50'29.603"W	1.31	
15255.00	90.920	177.360	7479.53	8494.07	-8494.12	5.98	40°06'32.448"N	104°50'29.553"W	0.98	
15340.00	89.820	178.190	7478.98	8579.00	-8579.05	9.28	40°06'31.609"N	104°50'29.511"W	1.62	
15427.00	90.800	178.250	7478.51	8665.95	-8666.00	11.99	40°06'30.750"N	104°50'29.476"W	1.13	
15512.00	91.510	177.950	7476.79	8750.87	-8750.94	14.80	40°06'29.910"N	104°50'29.439"W	0.91	
15597.00	90.890	178.840	7475.01	8835.81	-8835.89	17.18	40°06'29.071"N	104°50'29.409"W	1.28	
15682.00	90.680	180.160	7473.85	8920.80	-8920.87	17.93	40°06'28.231"N	104°50'29.399"W	1.57	
15767.00	90.180	180.590	7473.21	9005.80	-9005.87	17.37	40°06'27.391"N	104°50'29.406"W	0.78	
15853.00	89.350	183.690	7473.56	9091.73	-9091.80	14.16	40°06'26.542"N	104°50'29.448"W	3.73	
15938.00	89.220	183.550	7474.62	9176.57	-9176.62	8.79	40°06'25.704"N	104°50'29.517"W	0.22	
16023.00	89.260	184.320	7475.75	9261.37	-9261.41	2.96	40°06'24.866"N	104°50'29.592"W	0.91	
16108.00	89.130	183.720	7476.95	9346.17	-9346.19	-3.00	40°06'24.028"N	104°50'29.669"W	0.72	
16193.00	89.500	183.440	7477.96	9431.01	-9431.02	-8.31	40°06'23.190"N	104°50'29.737"W	0.55	
16278.00	88.770	182.730	7479.24	9515.89	-9515.89	-12.88	40°06'22.351"N	104°50'29.796"W	1.20	
16363.00	89.540	182.540	7480.50	9600.80	-9600.79	-16.79	40°06'21.512"N	104°50'29.846"W	0.93	
16448.00	89.970	182.490	7480.86	9685.73	-9685.71	-20.52	40°06'20.673"N	104°50'29.894"W	0.51	
16533.00	89.480	181.640	7481.27	9770.68	-9770.65	-23.58	40°06'19.833"N	104°50'29.933"W	1.15	
16618.00	88.550	182.080	7482.73	9855.62	-9855.59	-26.34	40°06'18.994"N	104°50'29.969"W	1.21	
16703.00	88.550	180.920	7484.88	9940.57	-9940.53	-28.56	40°06'18.155"N	104°50'29.998"W	1.36	
16788.00	89.480	181.110	7486.34	10025.55	-10025.50	-30.07	40°06'17.315"N	104°50'30.017"W	1.12	
16874.00	90.800	181.260	7486.13	10111.53	-10111.48	-31.85	40°06'16.465"N	104°50'30.040"W	1.54	
16958.00	89.780	180.620	7485.71	10195.52	-10195.47	-33.22	40°06'15.635"N	104°50'30.058"W	1.43	
17043.00	88.610	180.400	7486.90	10280.51	-10280.46	-33.98	40°06'14.795"N	104°50'30.067"W	1.40	
17129.00	89.560	180.700	7488.27	10366.50	-10366.44	-34.81	40°06'13.946"N	104°50'30.078"W	1.16	
17214.00	88.520	179.830	7489.70	10451.48	-10451.43	-35.20	40°06'13.106"N	104°50'30.083"W	1.60	
17299.00	89.410	179.830	7491.23	10536.47	-10536.41	-34.95	40°06'12.266"N	104°50'30.080"W	1.05	
17384.00	88.760	179.000	7492.59	10621.45	-10621.39	-34.08	40°06'11.426"N	104°50'30.069"W	1.24	
17470.00	89.780	179.740	7493.69	10707.43	-10707.38	-33.13	40°06'10.576"N	104°50'30.056"W	1.47	
17554.00	90.550	179.060	7493.45	10791.42	-10791.37	-32.25	40°06'09.746"N	104°50'30.045"W	1.22	
17639.00	91.660	179.080	7491.81	10876.39	-10876.35	-30.88	40°06'08.907"N	104°50'30.027"W	1.31	
17724.00	92.550	179.070	7488.68	10961.32	-10961.28	-29.50	40°06'08.067"N	104°50'30.010"W	1.05	
17763.00	92.580	179.150	7486.94	11000.27	-11000.23	-28.90	40°06'07.682"N	104°50'30.002"W	0.22	LAST BHI MWD+IFR SURVEY
17817.00	92.580	179.150	7484.51	11054.21	-11054.17	-28.10	40°06'07.149"N	104°50'29.992"W	0.00	PROJECTION TO BIT

REFERENCE WELLPATH IDENTIFICATION			
Operator	KERR-MCGEE OIL & GAS ONSHORE LP (LAMBERT STATE PLANE COORD)	Slot	SLOT#05 KERR 14C-25HZ (576'FSL & 1966'FWL, SEC.13)
Area	COLORADO	Well	KERR 14C-25HZ
Field	WELD COUNTY (KERR MCGEE)	Wellbore	KERR 14C-25HZ AWB <116-17817>
Facility	SEC.13-T2N-R67W		

HOLE & CASING SECTIONS - Ref Wellbore: KERR 14C-25HZ AWB <116-17817> Ref Wellpath: KERR 14C-25HZ AWP									
String/Diameter	Start MD [ft]	End MD [ft]	Interval [ft]	Start TVD [ft]	End TVD [ft]	Start N/S [ft]	Start E/W [ft]	End N/S [ft]	End E/W [ft]
13.5in Open Hole	16.00	1063.00	1047.00	16.00	1062.98	0.00	0.00	-3.02	-3.67
9.625in Casing Surface	16.00	1063.00	1047.00	16.00	1062.98	0.00	0.00	-3.02	-3.67
8.75in Open Hole	1063.00	7880.00	6817.00	1062.98	7418.81	-3.02	-3.67	-1121.37	-23.38
7in Casing Intermediate	16.00	7867.00	7851.00	16.00	7418.55	0.00	0.00	-1108.38	-23.21
6.125in Open Hole	7880.00	17817.00	9937.00	7418.81	7484.51	-1121.37	-23.38	-11054.17	-28.10

WELLPATH COMPOSITION - Ref Wellbore: KERR 14C-25HZ AWB <116-17817> Ref Wellpath: KERR 14C-25HZ AWP				
Start MD [ft]	End MD [ft]	Positional Uncertainty Model	Log Name/Comment	Wellbore
16.00	991.00	Generic gyro - northseeking (Standard)	VES GYRO SURVEYS <116-991>	KERR 14C-25HZ AWB <116-17817>
991.00	7824.00	NaviTrak (MAGCORR,IFR)	BHI NAVITRAK MWD+IFR 8 3/4" <1119-7824>	KERR 14C-25HZ AWB <116-17817>
7824.00	17763.00	NaviTrak (MAGCORR,IFR)	BHI NAVITRAK MWD+IFR 6 1/8" <7898-17763>	KERR 14C-25HZ AWB <116-17817>
17763.00	17817.00	Blind Drilling (std)	Projection to bit	KERR 14C-25HZ AWB <116-17817>

REFERENCE WELLPATH IDENTIFICATION			
Operator	KERR-MCGEE OIL & GAS ONSHORE LP (LAMBERT STATE PLANE COORD)	Slot	SLOT#05 KERR 14C-25HZ (576'FSL & 1966'FWL, SEC.13)
Area	COLORADO	Well	KERR 14C-25HZ
Field	WELD COUNTY (KERR MCGEE)	Wellbore	KERR 14C-25HZ AWB <116-17817>
Facility	SEC.13-T2N-R67W		

WELLPATH COMMENTS					
MD [ft]	Inclination [°]	Azimuth [°]	TVD [ft]	Comment	
16.00	0.000	186.516	16.00	TIE ON	
116.00	0.428	186.516	116.00	BEGIN GYRO SURVEYS	
991.00	0.178	281.023	990.98	TIE ONTO GYRO SURVEYS	
1119.00	0.410	180.130	1118.98	BEGIN BHI MWD+IFR SURVEYS	
7867.00	88.068	180.881	7418.55	7" CASING POINT	
17763.00	92.580	179.150	7486.94	LAST BHI MWD+IFR SURVEY	
17817.00	92.580	179.150	7484.51	PROJECTION TO BIT	