

# KERR-MCGEE OIL & GAS ONSHORE LP (LAMBERT STATE PLANE COORD)

Location: COLORADO Slot: SLOT#04 KERR 29C-12HZ (576'FSL & 1936'FWL, SEC.13)  
 Field: WELD COUNTY (KERR MCGEE) Well: KERR 29C-12HZ  
 Facility: SEC.13-T2N-R67W Wellbore: KERR 29C-12HZ PWB

Plot reference wellpath is KERR 29C-12HZ (REV-B.0) PWP

True vertical depths are referenced to XTREME 24 (16KB) (RKB)	Grid System: NAD83 / Lambert Colorado SP, Northern Zone (501), US feet
Measured depths are referenced to XTREME 24 (16KB) (RKB)	North Reference: True north
XTREME 24 (16KB) (RKB) to Mean Sea Level: 4899 feet	Scale: True distance
Mean Sea Level to Mud line (At Slot: SLOT#04 KERR 29C-12HZ (576'FSL & 1936'FWL, SEC.13)): 0 feet	Depths are in feet
Coordinates are in feet referenced to Slot.	Created by: robiale01 on 1/20/2015

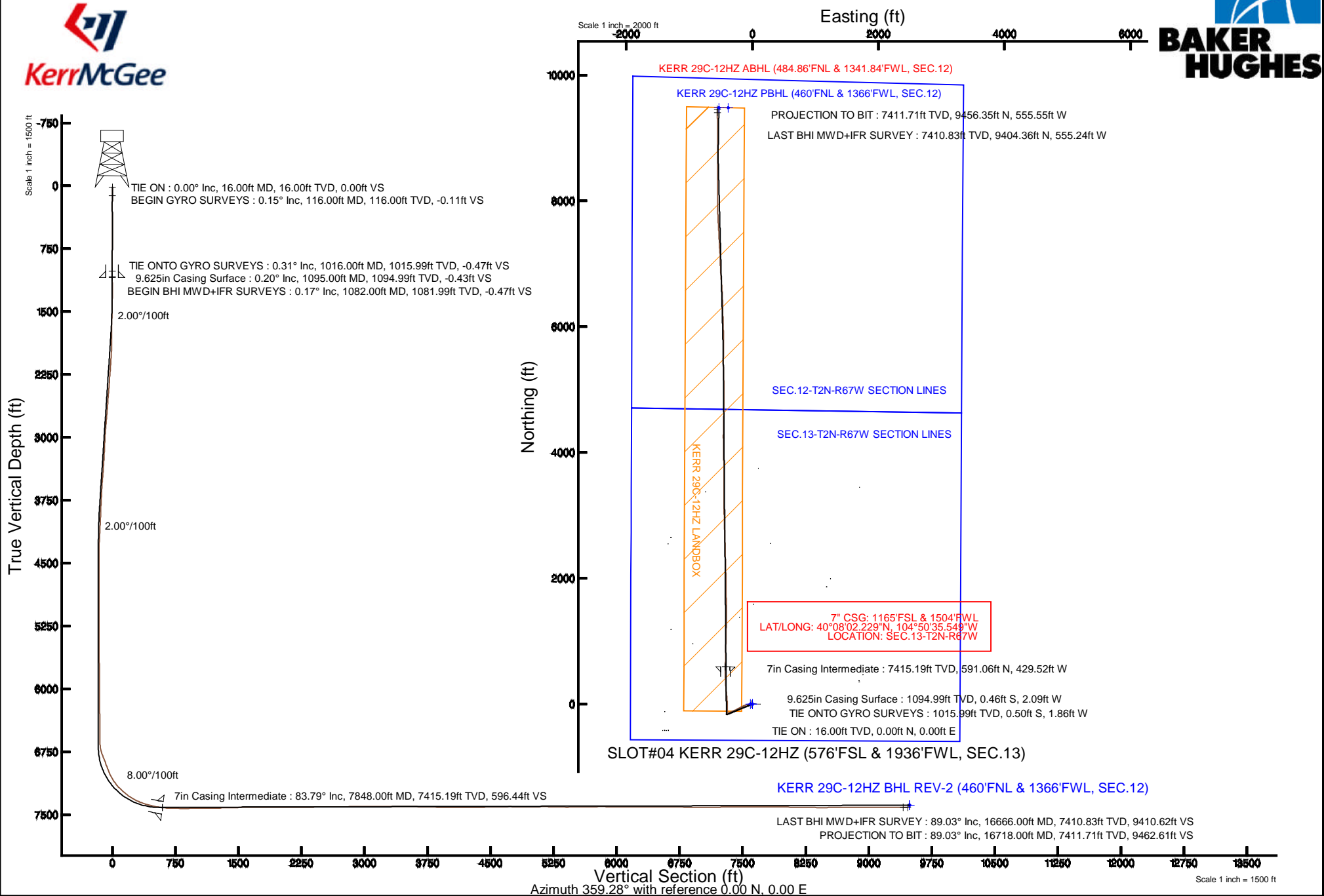

REFERENCE WELLPATH IDENTIFICATION			
Operator	KERR-MCGEE OIL & GAS ONSHORE LP (LAMBERT STATE PLANE COORD)	Slot	SLOT#04 KERR 29C-12HZ (576'FSL & 1936'FWL, SEC.13)
Area	COLORADO	Well	KERR 29C-12HZ
Field	WELD COUNTY (KERR MCGEE)	Wellbore	KERR 29C-12HZ AWB <116-16718>
Facility	SEC.13-T2N-R67W		

REPORT SETUP INFORMATION			
Projection System	NAD83 / Lambert Colorado SP, Northern Zone (501), US feet	Software System	WellArchitect® 4.0.0
North Reference	True	User	Robiale01
Scale	0.999959	Report Generated	1/20/2015 at 8:28:45 AM
Convergence at slot	n/a	Database/Source file	WellArchitectDB/KERR_29C-12HZ_AWB_116-16718_.xml

WELLPATH LOCATION						
	Local coordinates		Grid coordinates		Geographic coordinates	
	North[ft]	East[ft]	Easting[US ft]	Northing[US ft]	Latitude	Longitude
Slot Location	-375.17	-1703.44	3184073.40	1291734.83	40°07'56.388"N	104°50'30.019"W
Facility Reference Pt			3185773.91	1292122.74	40°08'00.096"N	104°50'08.088"W
Field Reference Pt			3197771.84	1268891.29	40°04'09.600"N	104°47'36.000"W

WELLPATH DATUM			
Calculation method	Minimum curvature	XTREME 24 (16'KB) (RKB) to Facility Vertical Datum	4899.00ft
Horizontal Reference Pt	Slot	XTREME 24 (16'KB) (RKB) to Mean Sea Level	4899.00ft
Vertical Reference Pt	XTREME 24 (16'KB) (RKB)	XTREME 24 (16'KB) (RKB) to Mud Line at Slot (SLOT#04 KERR 29C-12HZ (576'FSL & 1936'FWL, SEC.13))	4899.00ft
MD Reference Pt	XTREME 24 (16'KB) (RKB)	Section Origin	N 0.00, E 0.00 ft
Field Vertical Reference	Mean Sea Level	Section Azimuth	356.64°

REFERENCE WELLPATH IDENTIFICATION			
Operator	KERR-MCGEE OIL & GAS ONSHORE LP (LAMBERT STATE PLANE COORD)	Slot	SLOT#04 KERR 29C-12HZ (576'FSL & 1936'FWL, SEC.13)
Area	COLORADO	Well	KERR 29C-12HZ
Field	WELD COUNTY (KERR MCGEE)	Wellbore	KERR 29C-12HZ AWB <116-16718>
Facility	SEC.13-T2N-R67W		

WELLPATH DATA (166 stations) † = interpolated/extrapolated station										
MD [ft]	Inclination [°]	Azimuth [°]	TVD [ft]	Vert Sect [ft]	North [ft]	East [ft]	Latitude	Longitude	DLS [°/100ft]	Comments
0.00†	0.000	144.274	0.00	0.00	0.00	0.00	40°07'56.388"N	104°50'30.019"W	0.00	
16.00	0.000	144.274	16.00	0.00	0.00	0.00	40°07'56.388"N	104°50'30.019"W	0.00	TIE ON
116.00	0.154	144.274	116.00	-0.11	-0.11	0.08	40°07'56.387"N	104°50'30.018"W	0.15	BEGIN GYRO SURVEYS
216.00	0.171	96.405	216.00	-0.25	-0.23	0.31	40°07'56.386"N	104°50'30.015"W	0.13	
316.00	0.077	310.034	316.00	-0.23	-0.21	0.40	40°07'56.386"N	104°50'30.014"W	0.24	
416.00	0.352	312.437	416.00	0.03	0.04	0.12	40°07'56.388"N	104°50'30.017"W	0.28	
516.00	0.194	270.483	516.00	0.27	0.25	-0.27	40°07'56.390"N	104°50'30.023"W	0.24	
616.00	0.280	237.857	616.00	0.16	0.12	-0.65	40°07'56.389"N	104°50'30.027"W	0.16	
716.00	0.225	234.637	716.00	-0.06	-0.12	-1.02	40°07'56.387"N	104°50'30.032"W	0.06	
816.00	0.176	209.877	816.00	-0.29	-0.37	-1.25	40°07'56.384"N	104°50'30.035"W	0.10	
916.00	0.182	294.093	915.99	-0.35	-0.44	-1.47	40°07'56.384"N	104°50'30.038"W	0.24	
1016.00	0.310	242.506	1015.99	-0.39	-0.50	-1.86	40°07'56.383"N	104°50'30.043"W	0.24	TIE ONTO GYRO SURVEYS
1082.00	0.170	326.350	1081.99	-0.38	-0.50	-2.07	40°07'56.383"N	104°50'30.046"W	0.51	BEGIN BHI MWD+IFR SURVEYS
1176.00	0.420	4.310	1175.99	0.09	-0.04	-2.12	40°07'56.388"N	104°50'30.046"W	0.32	
1270.00	1.540	267.640	1269.98	0.45	0.25	-3.36	40°07'56.391"N	104°50'30.062"W	1.75	
1364.00	3.200	252.070	1363.90	-0.19	-0.61	-7.12	40°07'56.382"N	104°50'30.111"W	1.88	
1458.00	4.930	254.520	1457.66	-1.70	-2.49	-13.51	40°07'56.363"N	104°50'30.193"W	1.85	
1552.00	6.200	256.290	1551.21	-3.46	-4.77	-22.33	40°07'56.341"N	104°50'30.306"W	1.36	
1646.00	6.990	267.780	1644.59	-4.25	-6.20	-32.98	40°07'56.327"N	104°50'30.444"W	1.63	
1741.00	8.480	272.000	1738.73	-3.48	-6.18	-45.76	40°07'56.327"N	104°50'30.608"W	1.68	
1835.00	9.730	269.020	1831.54	-2.51	-6.07	-60.62	40°07'56.328"N	104°50'30.800"W	1.42	
1932.00	10.940	256.410	1926.98	-3.80	-8.37	-77.77	40°07'56.305"N	104°50'31.020"W	2.64	
2025.00	11.580	250.130	2018.19	-8.02	-13.62	-95.13	40°07'56.253"N	104°50'31.244"W	1.49	
2117.00	10.780	249.640	2108.45	-13.16	-19.75	-111.88	40°07'56.193"N	104°50'31.459"W	0.88	
2209.00	10.280	246.700	2198.90	-18.47	-25.99	-127.48	40°07'56.131"N	104°50'31.660"W	0.80	
2299.00	10.100	244.000	2287.48	-24.25	-32.63	-141.95	40°07'56.066"N	104°50'31.847"W	0.57	
2390.00	9.810	243.350	2377.11	-30.38	-39.60	-156.05	40°07'55.997"N	104°50'32.028"W	0.34	
2482.00	10.350	243.700	2467.69	-36.70	-46.78	-170.47	40°07'55.926"N	104°50'32.214"W	0.59	
2574.00	10.030	242.370	2558.24	-43.22	-54.16	-184.97	40°07'55.853"N	104°50'32.400"W	0.43	
2666.00	10.570	245.580	2648.75	-49.54	-61.36	-199.75	40°07'55.782"N	104°50'32.591"W	0.86	
2758.00	10.380	242.340	2739.22	-55.98	-68.70	-214.78	40°07'55.709"N	104°50'32.784"W	0.67	
2850.00	10.210	242.410	2829.74	-62.74	-76.32	-229.35	40°07'55.634"N	104°50'32.972"W	0.19	
2941.00	10.060	239.580	2919.32	-69.67	-84.08	-243.35	40°07'55.557"N	104°50'33.152"W	0.57	
3034.00	8.660	247.590	3011.08	-75.65	-90.87	-256.83	40°07'55.490"N	104°50'33.326"W	2.05	
3125.00	7.970	253.940	3101.13	-79.27	-95.22	-269.22	40°07'55.447"N	104°50'33.485"W	1.26	
3217.00	8.970	252.300	3192.12	-82.45	-99.17	-282.19	40°07'55.408"N	104°50'33.652"W	1.12	
3308.00	10.000	245.360	3281.88	-87.07	-104.62	-296.13	40°07'55.354"N	104°50'33.831"W	1.69	
3400.00	9.100	243.840	3372.61	-92.79	-111.16	-309.92	40°07'55.290"N	104°50'34.009"W	1.02	
3492.00	9.130	234.750	3463.45	-99.46	-118.58	-322.41	40°07'55.216"N	104°50'34.170"W	1.56	
3584.00	8.790	243.790	3554.33	-106.05	-125.89	-334.68	40°07'55.144"N	104°50'34.328"W	1.57	
3676.00	8.940	250.380	3645.23	-110.78	-131.40	-347.72	40°07'55.089"N	104°50'34.496"W	1.12	
3770.00	8.060	249.790	3738.20	-114.74	-136.13	-360.78	40°07'55.043"N	104°50'34.664"W	0.94	
3862.00	7.760	252.670	3829.33	-118.10	-140.21	-372.76	40°07'55.002"N	104°50'34.818"W	0.54	
3956.00	7.490	252.430	3922.49	-121.14	-143.95	-384.66	40°07'54.965"N	104°50'34.971"W	0.29	
4049.00	6.930	241.480	4014.76	-125.01	-148.46	-395.37	40°07'54.921"N	104°50'35.109"W	1.59	

REFERENCE WELLPATH IDENTIFICATION			
Operator	KERR-MCGEE OIL & GAS ONSHORE LP (LAMBERT STATE PLANE COORD)	Slot	SLOT#04 KERR 29C-12HZ (576'FSL & 1936'FWL, SEC.13)
Area	COLORADO	Well	KERR 29C-12HZ
Field	WELD COUNTY (KERR MCGEE)	Wellbore	KERR 29C-12HZ AWB <116-16718>
Facility	SEC.13-T2N-R67W		

WELLPATH DATA (166 stations) † = interpolated/extrapolated station										
MD [ft]	Inclination [°]	Azimuth [°]	TVD [ft]	Vert Sect [ft]	North [ft]	East [ft]	Latitude	Longitude	DLS [°/100ft]	Comments
4142.00	5.170	238.120	4107.24	-129.40	-153.35	-403.86	40°07'54.873"N	104°50'35.218"W	1.93	
4235.00	3.290	210.720	4199.99	-133.61	-157.86	-408.78	40°07'54.828"N	104°50'35.282"W	2.91	
4328.00	1.540	153.420	4292.92	-136.97	-161.27	-409.59	40°07'54.794"N	104°50'35.292"W	2.99	
4421.00	1.500	89.000	4385.89	-138.17	-162.37	-407.81	40°07'54.783"N	104°50'35.269"W	1.74	
4607.00	0.280	273.160	4571.87	-138.22	-162.30	-405.83	40°07'54.784"N	104°50'35.244"W	0.96	
4876.00	0.040	25.450	4840.87	-138.06	-162.18	-406.45	40°07'54.785"N	104°50'35.252"W	0.11	
5143.00	0.610	60.920	5107.87	-137.36	-161.40	-405.16	40°07'54.793"N	104°50'35.235"W	0.22	
5321.00	0.720	76.290	5285.85	-136.75	-160.68	-403.25	40°07'54.800"N	104°50'35.211"W	0.12	
5498.00	0.540	91.680	5462.84	-136.62	-160.44	-401.33	40°07'54.803"N	104°50'35.186"W	0.14	
5765.00	0.410	54.890	5729.84	-136.23	-159.92	-399.30	40°07'54.808"N	104°50'35.160"W	0.12	
6029.00	0.560	0.550	5993.83	-134.45	-158.09	-398.51	40°07'54.826"N	104°50'35.150"W	0.18	
6284.00	0.610	340.890	6248.81	-131.90	-155.56	-398.94	40°07'54.851"N	104°50'35.155"W	0.08	
6540.00	0.930	294.980	6504.79	-129.60	-153.40	-401.27	40°07'54.872"N	104°50'35.185"W	0.26	
6625.00	1.090	287.070	6589.78	-128.99	-152.87	-402.67	40°07'54.877"N	104°50'35.203"W	0.25	
6710.00	4.650	357.420	6674.67	-125.26	-149.19	-403.60	40°07'54.914"N	104°50'35.215"W	5.18	
6795.00	18.280	6.990	6757.79	-108.62	-132.43	-402.12	40°07'55.079"N	104°50'35.196"W	16.14	
6880.00	22.440	7.190	6837.46	-79.55	-103.09	-398.47	40°07'55.369"N	104°50'35.149"W	4.89	
6965.00	20.480	4.000	6916.57	-48.85	-72.16	-395.40	40°07'55.675"N	104°50'35.110"W	2.68	
7049.00	22.260	356.460	6994.80	-18.36	-41.61	-395.36	40°07'55.977"N	104°50'35.109"W	3.89	
7134.00	30.480	356.720	7070.89	19.37	-3.96	-397.59	40°07'56.349"N	104°50'35.138"W	9.67	
7219.00	39.320	356.610	7140.54	67.95	44.54	-400.42	40°07'56.828"N	104°50'35.174"W	10.40	
7304.00	46.980	355.320	7202.50	126.03	102.48	-404.56	40°07'57.401"N	104°50'35.227"W	9.07	
7389.00	51.790	353.440	7257.82	190.48	166.67	-410.91	40°07'58.035"N	104°50'35.309"W	5.90	
7474.00	59.010	355.140	7306.06	260.34	236.24	-417.82	40°07'58.723"N	104°50'35.398"W	8.65	
7559.00	67.510	356.340	7344.27	336.17	311.87	-423.43	40°07'59.470"N	104°50'35.470"W	10.08	
7645.00	73.050	358.630	7373.28	417.08	392.71	-426.95	40°08'00.269"N	104°50'35.516"W	6.91	
7730.00	77.440	359.210	7394.92	499.19	474.88	-428.49	40°08'01.081"N	104°50'35.536"W	5.21	
7801.00	80.250	359.240	7408.66	568.77	544.52	-429.43	40°08'01.769"N	104°50'35.548"W	3.96	
7848.00†	83.785	0.548	7415.19	615.23	591.06	-429.52	40°08'02.229"N	104°50'35.549"W	8.01	7" CASING POINT
7898.00	87.550	1.920	7418.96	664.92	640.89	-428.44	40°08'02.721"N	104°50'35.535"W	8.01	
7983.00	88.360	1.010	7422.00	749.56	725.81	-426.27	40°08'03.560"N	104°50'35.507"W	1.43	
8068.00	89.250	1.270	7423.77	834.28	810.77	-424.58	40°08'04.400"N	104°50'35.485"W	1.09	
8153.00	90.980	1.630	7423.60	918.98	895.74	-422.43	40°08'05.240"N	104°50'35.458"W	2.08	
8238.00	90.460	2.380	7422.53	1003.59	980.68	-419.46	40°08'06.079"N	104°50'35.420"W	1.07	
8323.00	90.770	0.890	7421.62	1088.26	1065.64	-417.03	40°08'06.919"N	104°50'35.388"W	1.79	
8408.00	90.520	1.400	7420.66	1173.00	1150.62	-415.33	40°08'07.758"N	104°50'35.366"W	0.67	
8494.00	91.260	0.640	7419.32	1258.73	1236.59	-413.80	40°08'08.608"N	104°50'35.347"W	1.23	
8579.00	91.850	359.900	7417.02	1343.53	1321.56	-413.40	40°08'09.448"N	104°50'35.342"W	1.11	
8664.00	91.110	359.810	7414.82	1428.37	1406.53	-413.62	40°08'10.287"N	104°50'35.344"W	0.88	
8749.00	90.950	0.930	7413.29	1513.17	1491.51	-413.07	40°08'11.127"N	104°50'35.337"W	1.33	
8834.00	90.620	359.620	7412.13	1597.99	1576.50	-412.66	40°08'11.967"N	104°50'35.332"W	1.59	
8919.00	89.930	359.060	7411.72	1682.89	1661.50	-413.64	40°08'12.807"N	104°50'35.345"W	1.05	
9004.00	89.250	358.790	7412.33	1767.82	1746.48	-415.23	40°08'13.647"N	104°50'35.365"W	0.86	
9096.00	89.880	359.720	7413.03	1859.72	1838.47	-416.43	40°08'14.556"N	104°50'35.381"W	1.22	
9188.00	90.990	358.830	7412.33	1951.62	1930.45	-417.59	40°08'15.465"N	104°50'35.396"W	1.55	

REFERENCE WELLPATH IDENTIFICATION			
Operator	KERR-MCGEE OIL & GAS ONSHORE LP (LAMBERT STATE PLANE COORD)	Slot	SLOT#04 KERR 29C-12HZ (576'FSL & 1936'FWL, SEC.13)
Area	COLORADO	Well	KERR 29C-12HZ
Field	WELD COUNTY (KERR MCGEE)	Wellbore	KERR 29C-12HZ AWB <116-16718>
Facility	SEC.13-T2N-R67W		

WELLPATH DATA (166 stations)										
MD [ft]	Inclination [°]	Azimuth [°]	TVD [ft]	Vert Sect [ft]	North [ft]	East [ft]	Latitude	Longitude	DLS [°/100ft]	Comments
9279.00	90.560	359.000	7411.10	2042.54	2021.43	-419.32	40°08'16.364"N	104°50'35.418"W	0.51	
9462.00	90.400	357.950	7409.57	2225.44	2204.35	-424.19	40°08'18.172"N	104°50'35.481"W	0.58	
9645.00	90.410	358.860	7408.27	2408.34	2387.28	-429.28	40°08'19.979"N	104°50'35.546"W	0.50	
9829.00	90.650	357.950	7406.57	2592.25	2571.20	-434.40	40°08'21.797"N	104°50'35.612"W	0.51	
10013.00	90.930	358.150	7404.03	2776.17	2755.07	-440.66	40°08'23.614"N	104°50'35.693"W	0.19	
10196.00	90.340	358.500	7402.01	2959.08	2937.98	-446.01	40°08'25.421"N	104°50'35.762"W	0.37	
10379.00	89.600	359.140	7402.10	3141.95	3120.94	-449.78	40°08'27.229"N	104°50'35.810"W	0.53	
10563.00	90.000	0.380	7402.74	3325.67	3304.93	-450.55	40°08'29.048"N	104°50'35.820"W	0.71	
10749.00	89.970	359.890	7402.79	3511.32	3490.93	-450.11	40°08'30.886"N	104°50'35.815"W	0.26	
10935.00	89.480	0.180	7403.68	3696.99	3676.93	-450.00	40°08'32.724"N	104°50'35.813"W	0.31	
11121.00	87.390	357.250	7408.77	3882.77	3862.78	-454.17	40°08'34.560"N	104°50'35.867"W	1.93	
11214.00	88.670	358.090	7411.96	3975.70	3955.65	-457.94	40°08'35.478"N	104°50'35.916"W	1.65	
11307.00	90.000	359.760	7413.04	4068.61	4048.62	-459.69	40°08'36.397"N	104°50'35.938"W	2.30	
11400.00	90.680	359.710	7412.49	4161.47	4141.62	-460.12	40°08'37.316"N	104°50'35.944"W	0.73	
11493.00	91.040	359.420	7411.09	4254.34	4234.60	-460.82	40°08'38.235"N	104°50'35.953"W	0.50	
11586.00	90.730	1.300	7409.66	4347.13	4327.59	-460.24	40°08'39.154"N	104°50'35.945"W	2.05	
11680.00	90.830	1.480	7408.38	4440.80	4421.55	-457.96	40°08'40.082"N	104°50'35.916"W	0.22	
11764.00	90.370	1.060	7407.50	4524.52	4505.52	-456.10	40°08'40.912"N	104°50'35.892"W	0.74	
11849.00	91.640	1.630	7406.01	4609.22	4590.49	-454.10	40°08'41.752"N	104°50'35.866"W	1.64	
11934.00	91.390	1.270	7403.76	4693.89	4675.43	-451.95	40°08'42.591"N	104°50'35.839"W	0.52	
12019.00	89.100	359.730	7403.40	4778.68	4760.42	-451.21	40°08'43.431"N	104°50'35.829"W	3.25	
12104.00	89.060	359.570	7404.76	4863.56	4845.40	-451.73	40°08'44.271"N	104°50'35.836"W	0.19	
12189.00	90.370	0.210	7405.18	4948.42	4930.40	-451.89	40°08'45.111"N	104°50'35.838"W	1.72	
12274.00	90.800	359.880	7404.32	5033.26	5015.40	-451.83	40°08'45.951"N	104°50'35.837"W	0.64	
12359.00	91.210	358.610	7402.83	5118.16	5100.37	-452.95	40°08'46.790"N	104°50'35.852"W	1.57	
12445.00	88.160	357.640	7403.30	5204.12	5186.31	-455.76	40°08'47.640"N	104°50'35.888"W	3.72	
12530.00	88.270	358.330	7405.95	5289.05	5271.22	-458.75	40°08'48.479"N	104°50'35.926"W	0.82	
12615.00	89.070	358.910	7407.92	5373.98	5356.17	-460.79	40°08'49.318"N	104°50'35.953"W	1.16	
12700.00	90.730	0.200	7408.07	5458.86	5441.16	-461.45	40°08'50.158"N	104°50'35.961"W	2.47	
12786.00	91.170	1.120	7406.64	5544.64	5527.15	-460.46	40°08'51.008"N	104°50'35.949"W	1.19	
12871.00	90.770	0.600	7405.20	5629.39	5612.12	-459.19	40°08'51.847"N	104°50'35.932"W	0.77	
12956.00	90.740	0.800	7404.08	5714.17	5697.11	-458.15	40°08'52.687"N	104°50'35.919"W	0.24	
13041.00	90.490	0.130	7403.17	5798.98	5782.10	-457.46	40°08'53.527"N	104°50'35.910"W	0.84	
13126.00	89.260	358.460	7403.36	5883.88	5867.09	-458.51	40°08'54.367"N	104°50'35.923"W	2.44	
13211.00	89.010	357.590	7404.64	5968.85	5952.03	-461.43	40°08'55.206"N	104°50'35.961"W	1.06	
13296.00	90.090	358.700	7405.31	6053.81	6036.98	-464.19	40°08'56.046"N	104°50'35.997"W	1.82	
13381.00	89.910	358.230	7405.31	6138.77	6121.95	-466.46	40°08'56.886"N	104°50'36.026"W	0.59	
13466.00	90.310	358.810	7405.14	6223.72	6206.92	-468.66	40°08'57.725"N	104°50'36.054"W	0.83	
13552.00	90.650	358.930	7404.42	6309.65	6292.90	-470.35	40°08'58.575"N	104°50'36.076"W	0.42	
13637.00	90.030	357.980	7403.92	6394.61	6377.87	-472.65	40°08'59.415"N	104°50'36.106"W	1.33	
13722.00	89.720	357.330	7404.10	6479.59	6462.79	-476.12	40°09'00.254"N	104°50'36.150"W	0.85	
13808.00	90.280	357.670	7404.10	6565.58	6548.71	-479.87	40°09'01.103"N	104°50'36.199"W	0.76	
13892.00	89.220	355.790	7404.47	6649.58	6632.57	-484.67	40°09'01.932"N	104°50'36.261"W	2.57	
13977.00	88.240	355.490	7406.35	6734.54	6717.30	-491.13	40°09'02.769"N	104°50'36.344"W	1.21	
14063.00	88.330	355.380	7408.93	6820.48	6802.99	-497.97	40°09'03.616"N	104°50'36.432"W	0.17	

## REFERENCE WELLPATH IDENTIFICATION

Operator	KERR-MCGEE OIL & GAS ONSHORE LP (LAMBERT STATE PLANE COORD)	Slot	SLOT#04 KERR 29C-12HZ (576'FSL & 1936'FWL, SEC.13)
Area	COLORADO	Well	KERR 29C-12HZ
Field	WELD COUNTY (KERR MCGEE)	Wellbore	KERR 29C-12HZ AWB <116-16718>
Facility	SEC.13-T2N-R67W		

## WELLPATH DATA (166 stations)

MD [ft]	Inclination [°]	Azimuth [°]	TVD [ft]	Vert Sect [ft]	North [ft]	East [ft]	Latitude	Longitude	DLS [°/100ft]	Comments
14148.00	88.880	356.810	7411.00	6905.45	6887.76	-503.75	40°09'04.453"N	104°50'36.506"W	1.80	
14233.00	89.930	358.300	7411.88	6990.43	6972.68	-507.38	40°09'05.293"N	104°50'36.553"W	2.14	
14318.00	91.390	358.780	7410.90	7075.38	7057.64	-509.55	40°09'06.132"N	104°50'36.581"W	1.81	
14403.00	90.860	356.240	7409.23	7160.35	7142.54	-513.24	40°09'06.971"N	104°50'36.629"W	3.05	
14488.00	90.430	355.810	7408.27	7245.33	7227.33	-519.13	40°09'07.809"N	104°50'36.704"W	0.72	
14573.00	90.640	357.400	7407.48	7330.33	7312.17	-524.16	40°09'08.647"N	104°50'36.769"W	1.89	
14659.00	90.710	357.050	7406.47	7416.32	7398.07	-528.33	40°09'09.496"N	104°50'36.823"W	0.42	
14744.00	91.350	357.320	7404.94	7501.30	7482.95	-532.50	40°09'10.335"N	104°50'36.877"W	0.82	
14829.00	89.500	356.930	7404.31	7586.29	7567.84	-536.76	40°09'11.174"N	104°50'36.932"W	2.22	
14914.00	89.690	356.830	7404.91	7671.29	7652.71	-541.39	40°09'12.013"N	104°50'36.991"W	0.25	
14999.00	89.250	357.700	7405.70	7756.28	7737.61	-545.45	40°09'12.852"N	104°50'37.044"W	1.15	
15085.00	89.620	357.590	7406.54	7842.26	7823.53	-548.98	40°09'13.701"N	104°50'37.089"W	0.45	
15170.00	89.160	359.380	7407.45	7927.21	7908.49	-551.23	40°09'14.540"N	104°50'37.118"W	2.17	
15254.00	90.190	359.840	7407.93	8011.09	7992.49	-551.80	40°09'15.370"N	104°50'37.125"W	1.34	
15339.00	88.700	359.780	7408.75	8095.95	8077.48	-552.08	40°09'16.210"N	104°50'37.129"W	1.75	
15424.00	89.100	0.380	7410.38	8180.79	8162.46	-551.96	40°09'17.050"N	104°50'37.128"W	0.85	
15509.00	89.350	0.600	7411.53	8265.59	8247.45	-551.23	40°09'17.890"N	104°50'37.118"W	0.39	
15594.00	88.980	0.600	7412.77	8350.37	8332.44	-550.34	40°09'18.730"N	104°50'37.107"W	0.44	
15677.00	89.720	0.300	7413.71	8433.18	8415.43	-549.69	40°09'19.550"N	104°50'37.098"W	0.96	
15761.00	90.800	0.490	7413.33	8517.00	8499.43	-549.11	40°09'20.380"N	104°50'37.091"W	1.31	
15846.00	91.210	0.340	7411.84	8601.80	8584.41	-548.50	40°09'21.220"N	104°50'37.083"W	0.51	
15931.00	90.120	359.590	7410.85	8686.65	8669.40	-548.55	40°09'22.060"N	104°50'37.084"W	1.56	
16016.00	90.220	359.840	7410.60	8771.53	8754.40	-548.97	40°09'22.900"N	104°50'37.089"W	0.32	
16106.00	90.120	359.250	7410.33	8861.41	8844.40	-549.69	40°09'23.789"N	104°50'37.098"W	0.66	
16191.00	90.090	359.120	7410.18	8946.33	8929.39	-550.90	40°09'24.629"N	104°50'37.114"W	0.16	
16276.00	89.720	359.090	7410.32	9031.25	9014.38	-552.22	40°09'25.469"N	104°50'37.131"W	0.44	
16361.00	90.000	359.600	7410.53	9116.15	9099.37	-553.20	40°09'26.309"N	104°50'37.144"W	0.68	
16446.00	90.340	359.970	7410.27	9201.02	9184.37	-553.51	40°09'27.149"N	104°50'37.148"W	0.59	
16617.00	89.660	359.200	7410.27	9371.80	9355.36	-554.75	40°09'28.838"N	104°50'37.164"W	0.60	
16666.00	89.030	359.660	7410.83	9420.73	9404.36	-555.24	40°09'29.323"N	104°50'37.170"W	1.59	LAST BHI MWD+IFR SURVEY
16718.00	89.030	359.660	7411.71	9472.65	9456.35	-555.55	40°09'29.836"N	104°50'37.174"W	0.00	PROJECTION TO BIT

REFERENCE WELLPATH IDENTIFICATION			
Operator	KERR-MCGEE OIL & GAS ONSHORE LP (LAMBERT STATE PLANE COORD)	Slot	SLOT#04 KERR 29C-12HZ (576'FSL & 1936'FWL, SEC.13)
Area	COLORADO	Well	KERR 29C-12HZ
Field	WELD COUNTY (KERR MCGEE)	Wellbore	KERR 29C-12HZ AWB <116-16718>
Facility	SEC.13-T2N-R67W		

HOLE & CASING SECTIONS - Ref Wellbore: KERR 29C-12HZ AWB <116-16718> Ref Wellpath: KERR 29C-12HZ AWP									
String/Diameter	Start MD [ft]	End MD [ft]	Interval [ft]	Start TVD [ft]	End TVD [ft]	Start N/S [ft]	Start E/W [ft]	End N/S [ft]	End E/W [ft]
13.5in Open Hole	16.00	1095.00	1079.00	16.00	1094.99	0.00	0.00	-0.46	-2.09
9.625in Casing Surface	16.00	1095.00	1079.00	16.00	1094.99	0.00	0.00	-0.46	-2.09
8.75in Open Hole	1095.00	7859.00	6764.00	1094.99	7416.30	-0.46	-2.09	602.00	-429.38
7in Casing Intermediate	16.00	7848.00	7832.00	16.00	7415.19	0.00	0.00	591.06	-429.52
6.125in Open Hole	7859.00	16718.00	8859.00	7416.30	7411.71	602.00	-429.38	9456.35	-555.55

WELLPATH COMPOSITION - Ref Wellbore: KERR 29C-12HZ AWB <116-16718> Ref Wellpath: KERR 29C-12HZ AWP				
Start MD [ft]	End MD [ft]	Positional Uncertainty Model	Log Name/Comment	Wellbore
16.00	1016.00	Generic gyro - northseeking (Standard)	VES GYRO SURVEYS <116-1016>	KERR 29C-12HZ AWB <116-16718>
1016.00	7801.00	NaviTrak (MAGCORR,IFR)	BHI NAVITRAK MWD+IFR 8 3/4" <1082-7801>	KERR 29C-12HZ AWB <116-16718>
7801.00	16666.00	NaviTrak (MAGCORR,IFR)	BHI NAVITRAK MWD+IFR 6 1/8" <7898-16666>	KERR 29C-12HZ AWB <116-16718>
16666.00	16718.00	Blind Drilling (std)	Projection to bit	KERR 29C-12HZ AWB <116-16718>

REFERENCE WELLPATH IDENTIFICATION			
Operator	KERR-MCGEE OIL & GAS ONSHORE LP (LAMBERT STATE PLANE COORD)	Slot	SLOT#04 KERR 29C-12HZ (576'FSL & 1936'FWL, SEC.13)
Area	COLORADO	Well	KERR 29C-12HZ
Field	WELD COUNTY (KERR MCGEE)	Wellbore	KERR 29C-12HZ AWB <116-16718>
Facility	SEC.13-T2N-R67W		

WELLPATH COMMENTS				
MD [ft]	Inclination [°]	Azimuth [°]	TVD [ft]	Comment
16.00	0.000	144.274	16.00	TIE ON
116.00	0.154	144.274	116.00	BEGIN GYRO SURVEYS
1016.00	0.310	242.506	1015.99	TIE ONTO GYRO SURVEYS
1082.00	0.170	326.350	1081.99	BEGIN BHI MWD+IFR SURVEYS
7848.00	83.785	0.548	7415.19	7" CASING POINT
16666.00	89.030	359.660	7410.83	LAST BHI MWD+IFR SURVEY
16718.00	89.030	359.660	7411.71	PROJECTION TO BIT