

# T10N, R58W, 6th P.M.

## LEGEND:

- └─ = 90° SYMBOL
- = PROPOSED WELLHEAD.
- = TARGET BOTTOM HOLE.
- ▲ = SECTION CORNERS LOCATED.

2011 Alum. Cap, #28285  
0.2' High.  
Lat: 40.816467°  
Long: 103.899111°

S89°15'42"W - 2645.69' (Meas.)

S89°15'42"W - 2645.69' (Meas.)

2012 Alum. Cap, #28285  
Flush W/Ground,  
Lat: 40.816565°  
Long: 103.889556°

2010 Alum. Cap, #17492  
Flush W/Ground  
Lat: 40.816664°  
Long: 103.880000°

N00°40'59"W - 2628.66' (Meas.)

N00°39'30"W - 2650.44' (Meas.)

2011 Alum. Cap, #28285  
0.3' High,  
Lat: 40.809255°  
Long: 103.898992°

NOTE:  
THE PROPOSED TARGET BOTTOM HOLE FOR  
THIS WELL IS LOCATED IN THE SW 1/4 SW  
1/4 OF SECTION 32, T10N, R58W, 6th P.M.  
AT 600' FSL 495' FWL. IT BEARS S00°12'44"E  
6973.63' FROM THE PROPOSED WELLHEAD.

2012 Alum. Cap, #28285  
0.1' High,  
Lat: 40.809390°  
Long: 103.879887°

29

690'

**RAZOR FED #29L-3202**

Elev. Ungraded Ground = 4828.1'

N00°40'59"W - 2628.66' (Meas.)

N00°39'30"W - 2650.44' (Meas.)

S00°12'44"E  
6973.63'

2301'

2010 Alum. Cap, #17492  
0.2' High,  
Lat: 40.802042°  
Long: 103.898872°

S89°44'00"W - 2644.61' (Meas.)

S89°44'00"W - 2644.61' (Meas.)

2012 Alum. Cap, #28285  
Flush W/Ground,  
Lat: 40.802080°  
Long: 103.889322°

2010 Alum. Cap,  
0.3' High  
Lat: 40.802117°  
Long: 103.879772°

Target Bottom Hole ○

PDOP = 1.4

NAD 83 (SURFACE LOCATION)	
LATITUDE = 40°48'30.12" (40.808366)	
LONGITUDE = 103°53'47.34" (103.896485)	
NAD 27 (SURFACE LOCATION)	
LATITUDE = 40°48'30.17" (40.808380)	
LONGITUDE = 103°53'45.53" (103.895982)	



### CERTIFICATE

THIS IS TO CERTIFY THAT THE ABOVE PLAT WAS PREPARED FROM FIELD NOTES OF ACTUAL SURVEYS MADE BY ME OR UNDER MY SUPERVISION AND THAT THE SAME ARE TRUE AND CORRECT TO THE BEST OF MY KNOWLEDGE AND BELIEF.

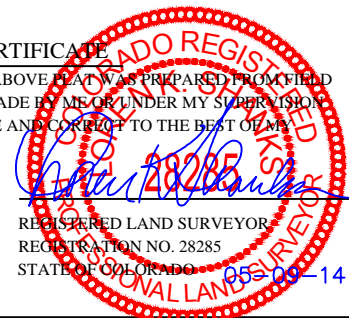

**BASIS OF BEARINGS**  
BASIS OF BEARINGS IS A G.P.S. OBSERVATION

### BASIS OF ELEVATION

SPOT ELEVATION LOCATED AT THE NORTHEAST CORNER OF SECTION 15, T9N, R58W, 6th P.M. TAKEN FROM THE GATEHOOK SPRING, QUADRANGLE, COLORADO, WELD COUNTY, 7.5 MINUTE QUAD (TOPOGRAPHIC MAP) PUBLISHED BY THE UNITED STATES DEPARTMENT OF THE INTERIOR, GEOLOGICAL SURVEY. SAID ELEVATION IS MARKED AS BEING 4679 FEET.

## WHITING OIL & GAS CORP.

**RAZOR FED #29L-3202 (SURFACE LOCATION)**  
NW 1/4 SW 1/4, SECTION 29, T10N, R58W, 6th P.M.  
WELD COUNTY, COLORADO

SURVEYED BY: DARREN SHANKS, D.S.	DATE: 04-21-14
DRAWN BY: J.S.	DATE DRAWN: 05-05-14
SCALE: 1" = 1000'	REVISION: 00-00-00
<b>WELL LOCATION PLAT</b>	



**UELS, LLC**  
Corporate Office \* 85 South 200 East  
Vernal, UT 84078 \* (435) 789-1017



**LEGEND:**

- └─ = 90° SYMBOL
- = PROPOSED WELLHEAD.
- = TARGET BOTTOM HOLE.
- ▲ = SECTION CORNERS LOCATED.

# T10N, R58W, 6th P.M.

● Surface Location

2010 Alum. Cap, #17492  
0.2' High,  
Lat: 40.802042°  
Long: 103.898872°

S89°44'00"W - 2644.61' (Meas.)

S89°44'00"W - 2644.61' (Meas.)

2012 Alum. Cap, #28285  
Flush W/Ground,  
Lat: 40.802080°  
Long: 103.889322°

2010 Alum. Cap,  
0.3' High  
Lat: 40.802117°  
Long: 103.879772°

N02°22'06"W - 2637.62' (Meas.)

S00°12'44"E  
6973.63'

N01°32'07"W - 2640.93' (Meas.)

NOTE:  
THE PROPOSED TARGET BOTTOM HOLE  
BEARS S00°12'44"E 6973.63' FROM THE  
PROPOSED WELLHEAD WHICH IS LOCATED IN  
THE NW 1/4 SW 1/4 OF SECTION 29, T10N,  
R58W, 6th P.M. AT 2301' FSL 690' FWL.

2012 Alum. Cap, #28285  
0.8' Below Ground,  
Lat: 40.794810°  
Long: 103.898473°

32

2012 Alum. Cap, #28285  
0.1' High,  
Lat: 40.794873°  
Long: 103.879513°

N02°22'06"W - 2637.62' (Meas.)

N01°32'07"W - 2640.93' (Meas.)

495'  
600'  
**RAZOR FED #29L-3202**  
Target Bottom Hole

2012 Alum. Cap, #28285  
0.6' High,  
Lat: 40.787604°  
Long: 103.888663°

2010 Alum. Cap,  
0.3' Below Ground  
Lat: 40.787628°  
Long: 103.879253°

2010 Alum. Cap,  
0.5' Below Ground  
Lat: 40.787578°  
Long: 103.898072°

S89°49'52"W - 2606.35' (Meas.)

S89°49'52"W - 2606.35' (Meas.)

**T10N**  
**T9N**

<b>NAD 83 (TARGET BOTTOM HOLE)</b>
LATITUDE = 40°47'21.23" (40.789230)
LONGITUDE = 103°53'46.95" (103.896375)
<b>NAD 27 (TARGET BOTTOM HOLE)</b>
LATITUDE = 40°47'21.28" (40.789243)
LONGITUDE = 103°53'45.14" (103.895872)



CERTIFICATE  
THIS IS TO CERTIFY THAT THE ABOVE PLAT WAS PREPARED FROM FIELD  
NOTES OF ACTUAL SURVEYS MADE BY ME OR UNDER MY SUPERVISION  
AND THAT THE SAME ARE TRUE AND CORRECT TO THE BEST OF MY  
KNOWLEDGE AND BELIEF.

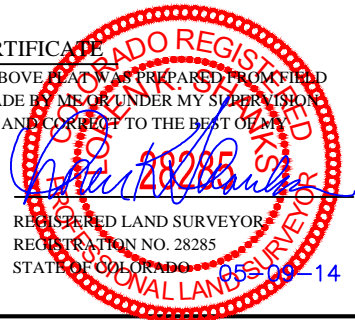

**BASIS OF BEARINGS**  
BASIS OF BEARINGS IS A G.P.S. OBSERVATION  
**BASIS OF ELEVATION**

SPOT ELEVATION LOCATED AT THE NORTHEAST CORNER OF SECTION 15, T9N, R58W, 6th P.M. TAKEN FROM THE GATEHOOK SPRING, QUADRANGLE, COLORADO, WELD COUNTY, 7.5 MINUTE QUAD (TOPOGRAPHIC MAP) PUBLISHED BY THE UNITED STATES DEPARTMENT OF THE INTERIOR, GEOLOGICAL SURVEY. SAID ELEVATION IS MARKED AS BEING 4679 FEET.



## WHITING OIL & GAS CORP.

**RAZOR FED #29L-3202 (TARGET BOTTOM HOLE)**  
**SW 1/4 SW 1/4, SECTION 32, T10N, R58W, 6th P.M.**  
**WELD COUNTY, COLORADO**

SURVEYED BY: DARREN SHANKS, D.S.	DATE: 04-21-14
DRAWN BY: J.S.	DATE DRAWN: 05-05-14
SCALE: 1" = 1000'	REVISION: 00-00-00

## WELL LOCATION PLAT



**UELS, LLC**  
Corporate Office \* 85 South 200 East  
Vernal, UT 84078 \* (435) 789-1017