

# **EXTRACTION OIL & GAS**

**WELD COUNTY, COLORADO (NAD 83)**

**NW SW SEC. 5 T2N R68W 6th P.M.**

**FAIRVIEW 1 - Slot FAIRVIEW 1**

**ORIGINAL WELLBORE**

**09 November, 2014**

**Plan: PROPOSAL #2**





Project: WELD COUNTY, COLORADO (NAD 83)  
Site: NW SW SEC. 5 T2N R68W 6th P.M.  
Well: FAIRVIEW 1  
Wellbore: ORIGINAL WELLBORE  
Design: PROPOSAL #2

ANNOTATIONS									
TVD	MD	Inc	Azi	+N/-S	+E/-W	VSect	Dep	Annotation	
950.0	950.0	0.00	0.00	0.0	0.0	0.0	0.0	START NUDGE (2°/100ft BUR)	
1670.7	1678.5	14.57	171.93	-91.2	12.9	30.7	92.1	EOB TO 14.57° INC	
6226.3	6385.5	14.57	171.93	-1263.7	179.1	425.5	1276.3	END OF TANGENT	
6947.0	7114.0	0.00	171.93	-1354.9	192.0	456.2	1368.4	EOD TO VERTICAL	
6977.0	7144.0	0.00	0.00	-1354.9	192.0	456.2	1368.4	KOP (10°/100ft BUR)	
7550.0	8044.1	90.00	90.46	-1359.5	765.0	1018.8	1941.4	7" ICP - FAIRVIEW 1 (P2)	
7550.0	14264.6	90.00	90.46	-1409.6	6985.3	7126.1	8161.9	BHL - FAIRVIEW 1 (P2)	

WELLBORE TARGET DETAILS (LAT/LONG)					
Name	TVD	+N/-S	+E/-W	Latitude	Longitude
KOP - FAIRVIEW 1 (P2)	6977.0	-1354.9	192.0	40.162037	-105.033980
7" ICP - FAIRVIEW 1 (P2)	7550.0	-1359.5	765.0	40.162024	-105.031930
BHL - FAIRVIEW 1 (P2)	7550.0	-1409.6	6985.3	40.161884	-105.009675

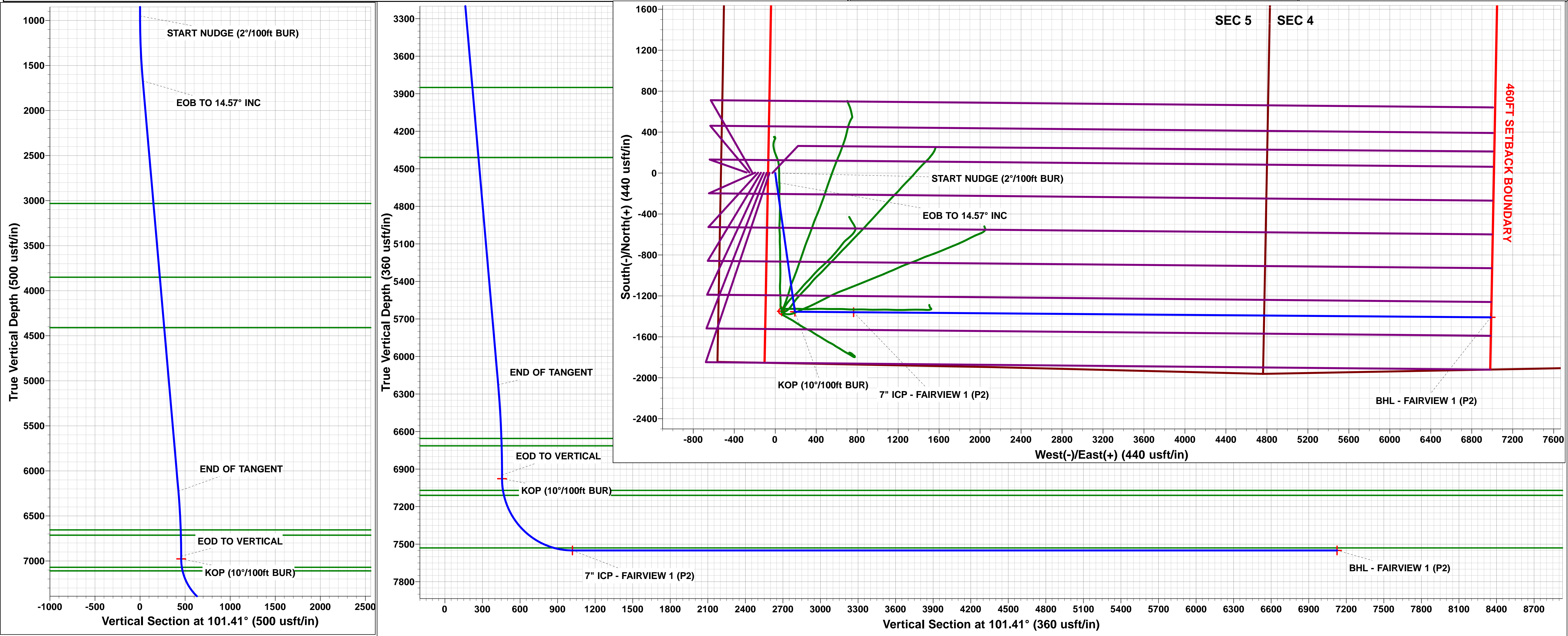
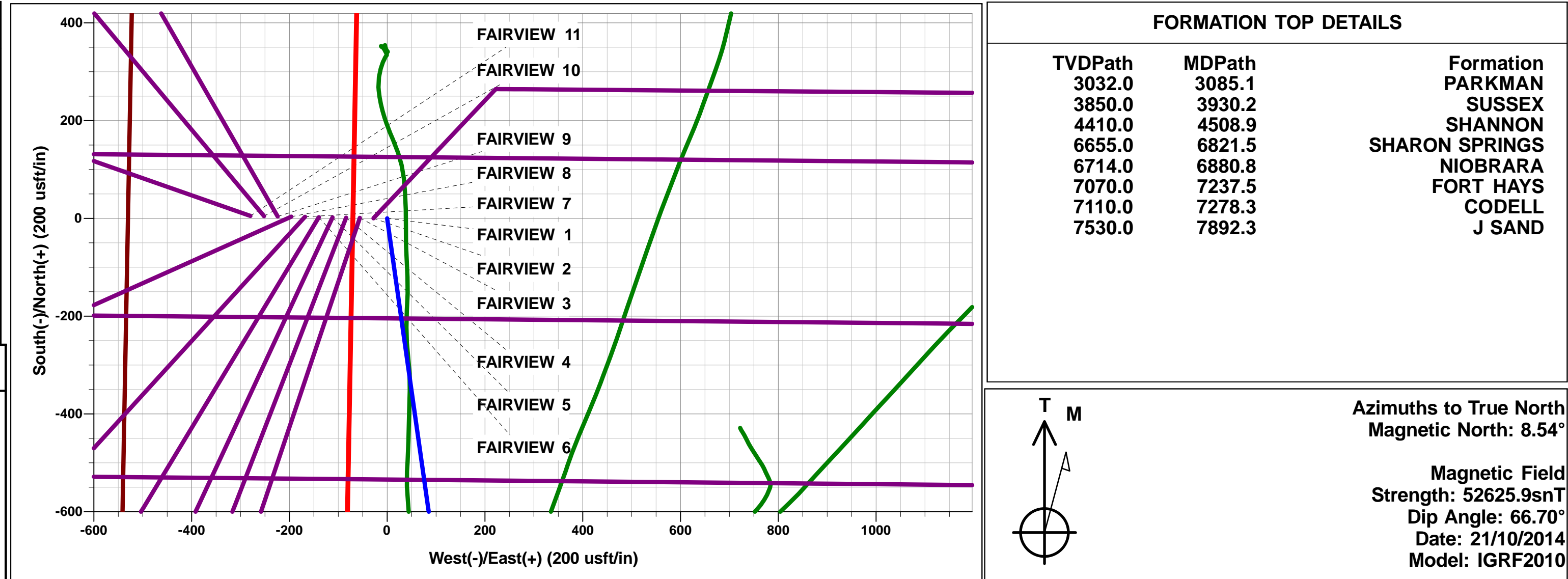

# Planning Report



<b>Database:</b>	EDM 5000.1 Single User Db	<b>Local Co-ordinate Reference:</b>	Well FAIRVIEW 1 - Slot FAIRVIEW 1
<b>Company:</b>	EXTRACTION OIL & GAS	<b>TVD Reference:</b>	KB-EST @ 4965.0usft (Original Well Elev)
<b>Project:</b>	WELD COUNTY, COLORADO (NAD 83)	<b>MD Reference:</b>	KB-EST @ 4965.0usft (Original Well Elev)
<b>Site:</b>	NW SW SEC. 5 T2N R68W 6th P.M.	<b>North Reference:</b>	True
<b>Well:</b>	FAIRVIEW 1	<b>Survey Calculation Method:</b>	Minimum Curvature
<b>Wellbore:</b>	ORIGINAL WELLBORE		
<b>Design:</b>	PROPOSAL #2		

<b>Project</b>	WELD COUNTY, COLORADO (NAD 83)		
<b>Map System:</b>	US State Plane 1983	<b>System Datum:</b>	Mean Sea Level
<b>Geo Datum:</b>	North American Datum 1983		
<b>Map Zone:</b>	Colorado Northern Zone		Using geodetic scale factor

<b>Site</b>	NW SW SEC. 5 T2N R68W 6th P.M.		
<b>Site Position:</b>		<b>Northing:</b>	1,303,569.20 usft
<b>From:</b>	Lat/Long	<b>Easting:</b>	3,130,047.26 usft
<b>Position Uncertainty:</b>	0.0 usft	<b>Slot Radius:</b>	1.10000ft
		<b>Latitude:</b>	40.165756
		<b>Longitude:</b>	-105.034667
		<b>Grid Convergence:</b>	0.30 °

<b>Well</b>	FAIRVIEW 1 - Slot FAIRVIEW 1		
<b>Well Position</b>	<b>+N/-S</b>	0.0 usft	<b>Northing:</b> 1,303,569.20 usfi
	<b>+E/-W</b>	0.0 usft	<b>Easting:</b> 3,130,047.26 usfi
<b>Position Uncertainty</b>	0.0 usft	<b>Wellhead Elevation:</b>	usfi
		<b>Latitude:</b>	40.165756
		<b>Longitude:</b>	-105.034667
		<b>Ground Level:</b>	4,941.0 usft

<b>Wellbore</b>	ORIGINAL WELLBORE				
<b>Magnetics</b>	<b>Model Name</b>	<b>Sample Date</b>	<b>Declination (°)</b>	<b>Dip Angle (°)</b>	<b>Field Strength (nT)</b>
	IGRF2010	21/10/2014	8.54	66.70	52,626

<b>Design</b>	PROPOSAL #2			
<b>Audit Notes:</b>				
<b>Version:</b>	<b>Phase:</b>	PROTOTYPE	<b>Tie On Depth:</b>	0.0
<b>Vertical Section:</b>	<b>Depth From (TVD) (usft)</b>	<b>+N/-S (usft)</b>	<b>+E/-W (usft)</b>	<b>Direction (°)</b>
	0.0	0.0	0.0	101.41

<b>Plan Sections</b>											
MD (usft)	Inc (°)	Azi (°)	Vertical Depth	SS (usft)	+N/-S (usft)	+E/-W (usft)	Dogleg Rate (°/100usf)	Build Rate (°/100usf)	Turn Rate (°/100usf)	TFO (°)	Target
0.0	0.00	0.00	0.0	-4,965.0	0.0	0.0	0.00	0.00	0.00	0.00	
950.0	0.00	0.00	950.0	-4,015.0	0.0	0.0	0.00	0.00	0.00	0.00	
1,678.5	14.57	171.93	1,670.7	-3,294.3	-91.2	12.9	2.00	2.00	0.00	171.93	
6,385.5	14.57	171.93	6,226.3	1,261.3	-1,263.7	179.1	0.00	0.00	0.00	0.00	
7,114.0	0.00	0.00	6,947.0	1,982.0	-1,354.9	192.0	2.00	-2.00	0.00	180.00	
7,144.0	0.00	0.00	6,977.0	2,012.0	-1,354.9	192.0	0.00	0.00	0.00	0.00	KOP - FAIRVIEW 1
8,044.1	90.00	90.46	7,550.0	2,585.0	-1,359.5	765.0	10.00	10.00	10.05	90.46	7" ICP - FAIRVIEW
14,264.6	90.00	90.46	7,550.0	2,585.0	-1,409.6	6,985.3	0.00	0.00	0.00	-79.00	BHL - FAIRVIEW 1

<b>Database:</b>	EDM 5000.1 Single User Db	<b>Local Co-ordinate Reference:</b>	Well FAIRVIEW 1 - Slot FAIRVIEW 1
<b>Company:</b>	EXTRACTION OIL & GAS	<b>TVD Reference:</b>	KB-EST @ 4965.0usft (Original Well Elev)
<b>Project:</b>	WELD COUNTY, COLORADO (NAD 83)	<b>MD Reference:</b>	KB-EST @ 4965.0usft (Original Well Elev)
<b>Site:</b>	NW SW SEC. 5 T2N R68W 6th P.M.	<b>North Reference:</b>	True
<b>Well:</b>	FAIRVIEW 1	<b>Survey Calculation Method:</b>	Minimum Curvature
<b>Wellbore:</b>	ORIGINAL WELLBORE		
<b>Design:</b>	PROPOSAL #2		

## Planned Survey

MD (usft)	Inc (°)	Azi (°)	TVD (usft)	SS (usft)	+N/-S (usft)	+E/-W (usft)	Vertical Section (usft)	Dogleg Rate (°/100usft)	Build Rate (°/100usft)	Turn Rate (°/100usft)
0.0	0.00	0.00	0.0	4,965.00	0.0	0.0	0.0	0.00	0.00	0.00
100.0	0.00	0.00	100.0	4,865.00	0.0	0.0	0.0	0.00	0.00	0.00
200.0	0.00	0.00	200.0	4,765.00	0.0	0.0	0.0	0.00	0.00	0.00
300.0	0.00	0.00	300.0	4,665.00	0.0	0.0	0.0	0.00	0.00	0.00
400.0	0.00	0.00	400.0	4,565.00	0.0	0.0	0.0	0.00	0.00	0.00
500.0	0.00	0.00	500.0	4,465.00	0.0	0.0	0.0	0.00	0.00	0.00
600.0	0.00	0.00	600.0	4,365.00	0.0	0.0	0.0	0.00	0.00	0.00
700.0	0.00	0.00	700.0	4,265.00	0.0	0.0	0.0	0.00	0.00	0.00
800.0	0.00	0.00	800.0	4,165.00	0.0	0.0	0.0	0.00	0.00	0.00
900.0	0.00	0.00	900.0	4,065.00	0.0	0.0	0.0	0.00	0.00	0.00
<b>START NUDGE (2°/100ft BUR)</b>										
<b>950.0</b>	<b>0.00</b>	<b>0.00</b>	<b>950.0</b>	<b>4,015.00</b>	<b>0.0</b>	<b>0.0</b>	<b>0.0</b>	<b>0.00</b>	<b>0.00</b>	<b>0.00</b>
1,000.0	1.00	171.93	1,000.0	3,965.00	-0.4	0.1	0.1	2.00	2.00	0.00
1,100.0	3.00	171.93	1,099.9	3,865.07	-3.9	0.6	1.3	2.00	2.00	0.00
1,200.0	5.00	171.93	1,199.7	3,765.32	-10.8	1.5	3.6	2.00	2.00	0.00
1,300.0	7.00	171.93	1,299.1	3,665.87	-21.1	3.0	7.1	2.00	2.00	0.00
1,400.0	9.00	171.93	1,398.2	3,566.85	-34.9	4.9	11.8	2.00	2.00	0.00
1,500.0	11.00	171.93	1,496.6	3,468.37	-52.1	7.4	17.5	2.00	2.00	0.00
1,600.0	13.00	171.93	1,594.4	3,370.56	-72.7	10.3	24.5	2.00	2.00	0.00
<b>EOB TO 14.57° INC</b>										
<b>1,678.5</b>	<b>14.57</b>	<b>171.93</b>	<b>1,670.7</b>	<b>3,294.33</b>	<b>-91.2</b>	<b>12.9</b>	<b>30.7</b>	<b>2.00</b>	<b>2.00</b>	<b>0.00</b>
1,700.0	14.57	171.93	1,691.5	3,273.52	-96.6	13.7	32.5	0.00	0.00	0.00
1,800.0	14.57	171.93	1,788.3	3,176.73	-121.5	17.2	40.9	0.00	0.00	0.00
1,900.0	14.57	171.93	1,885.0	3,079.95	-146.4	20.7	49.3	0.00	0.00	0.00
2,000.0	14.57	171.93	1,981.8	2,983.17	-171.3	24.3	57.7	0.00	0.00	0.00
2,100.0	14.57	171.93	2,078.6	2,886.38	-196.2	27.8	66.1	0.00	0.00	0.00
2,200.0	14.57	171.93	2,175.4	2,789.60	-221.1	31.3	74.5	0.00	0.00	0.00
2,300.0	14.57	171.93	2,272.2	2,692.82	-246.0	34.9	82.8	0.00	0.00	0.00
2,400.0	14.57	171.93	2,369.0	2,596.03	-270.9	38.4	91.2	0.00	0.00	0.00
2,500.0	14.57	171.93	2,465.8	2,499.25	-295.8	41.9	99.6	0.00	0.00	0.00
2,600.0	14.57	171.93	2,562.5	2,402.46	-320.8	45.5	108.0	0.00	0.00	0.00
2,700.0	14.57	171.93	2,659.3	2,305.68	-345.7	49.0	116.4	0.00	0.00	0.00
2,800.0	14.57	171.93	2,756.1	2,208.90	-370.6	52.5	124.8	0.00	0.00	0.00
2,900.0	14.57	171.93	2,852.9	2,112.11	-395.5	56.0	133.2	0.00	0.00	0.00
3,000.0	14.57	171.93	2,949.7	2,015.33	-420.4	59.6	141.6	0.00	0.00	0.00
<b>PARKMAN</b>										
<b>3,085.1</b>	<b>14.57</b>	<b>171.93</b>	<b>3,032.0</b>	<b>1,933.00</b>	<b>-441.6</b>	<b>62.6</b>	<b>148.7</b>	<b>0.00</b>	<b>0.00</b>	<b>0.00</b>
3,100.0	14.57	171.93	3,046.5	1,918.55	-445.3	63.1	149.9	0.00	0.00	0.00
3,200.0	14.57	171.93	3,143.2	1,821.76	-470.2	66.6	158.3	0.00	0.00	0.00
3,300.0	14.57	171.93	3,240.0	1,724.98	-495.1	70.2	166.7	0.00	0.00	0.00
3,400.0	14.57	171.93	3,336.8	1,628.19	-520.0	73.7	175.1	0.00	0.00	0.00
3,500.0	14.57	171.93	3,433.6	1,531.41	-544.9	77.2	183.5	0.00	0.00	0.00
3,600.0	14.57	171.93	3,530.4	1,434.63	-569.8	80.8	191.9	0.00	0.00	0.00
3,700.0	14.57	171.93	3,627.2	1,337.84	-594.7	84.3	200.3	0.00	0.00	0.00
3,800.0	14.57	171.93	3,723.9	1,241.06	-619.7	87.8	208.7	0.00	0.00	0.00
3,900.0	14.57	171.93	3,820.7	1,144.28	-644.6	91.3	217.0	0.00	0.00	0.00
<b>SUSSEX</b>										
<b>3,930.2</b>	<b>14.57</b>	<b>171.93</b>	<b>3,850.0</b>	<b>1,115.00</b>	<b>-652.1</b>	<b>92.4</b>	<b>219.6</b>	<b>0.00</b>	<b>0.00</b>	<b>0.00</b>
4,000.0	14.57	171.93	3,917.5	1,047.49	-669.5	94.9	225.4	0.00	0.00	0.00
4,100.0	14.57	171.93	4,014.3	950.71	-694.4	98.4	233.8	0.00	0.00	0.00
4,200.0	14.57	171.93	4,111.1	853.92	-719.3	101.9	242.2	0.00	0.00	0.00
4,300.0	14.57	171.93	4,207.9	757.14	-744.2	105.5	250.6	0.00	0.00	0.00
4,400.0	14.57	171.93	4,304.6	660.36	-769.1	109.0	259.0	0.00	0.00	0.00
4,500.0	14.57	171.93	4,401.4	563.57	-794.0	112.5	267.4	0.00	0.00	0.00

<b>Database:</b>	EDM 5000.1 Single User Db	<b>Local Co-ordinate Reference:</b>	Well FAIRVIEW 1 - Slot FAIRVIEW 1
<b>Company:</b>	EXTRACTION OIL & GAS	<b>TVD Reference:</b>	KB-EST @ 4965.0usft (Original Well Elev)
<b>Project:</b>	WELD COUNTY, COLORADO (NAD 83)	<b>MD Reference:</b>	KB-EST @ 4965.0usft (Original Well Elev)
<b>Site:</b>	NW SW SEC. 5 T2N R68W 6th P.M.	<b>North Reference:</b>	True
<b>Well:</b>	FAIRVIEW 1	<b>Survey Calculation Method:</b>	Minimum Curvature
<b>Wellbore:</b>	ORIGINAL WELLBORE		
<b>Design:</b>	PROPOSAL #2		

## Planned Survey

MD (usft)	Inc (°)	Azi (°)	TVD (usft)	SS (usft)	+N/-S (usft)	+E/-W (usft)	Vertical Section (usft)	Dogleg Rate (°/100usft)	Build Rate (°/100usft)	Turn Rate (°/100usft)
<b>SHANNON</b>										
4,508.9	14.57	171.93	4,410.0	555.00	-796.2	112.8	268.1	0.00	0.00	0.00
4,600.0	14.57	171.93	4,498.2	466.79	-818.9	116.1	275.8	0.00	0.00	0.00
4,700.0	14.57	171.93	4,595.0	370.01	-843.8	119.6	284.1	0.00	0.00	0.00
4,800.0	14.57	171.93	4,691.8	273.22	-868.7	123.1	292.5	0.00	0.00	0.00
4,900.0	14.57	171.93	4,788.6	176.44	-893.7	126.6	300.9	0.00	0.00	0.00
5,000.0	14.57	171.93	4,885.3	79.65	-918.6	130.2	309.3	0.00	0.00	0.00
5,100.0	14.57	171.93	4,982.1	-17.13	-943.5	133.7	317.7	0.00	0.00	0.00
5,200.0	14.57	171.93	5,078.9	-113.91	-968.4	137.2	326.1	0.00	0.00	0.00
5,300.0	14.57	171.93	5,175.7	-210.70	-993.3	140.8	334.5	0.00	0.00	0.00
5,400.0	14.57	171.93	5,272.5	-307.48	-1,018.2	144.3	342.9	0.00	0.00	0.00
5,500.0	14.57	171.93	5,369.3	-404.26	-1,043.1	147.8	351.2	0.00	0.00	0.00
5,600.0	14.57	171.93	5,466.0	-501.05	-1,068.0	151.4	359.6	0.00	0.00	0.00
5,700.0	14.57	171.93	5,562.8	-597.83	-1,092.9	154.9	368.0	0.00	0.00	0.00
5,800.0	14.57	171.93	5,659.6	-694.62	-1,117.8	158.4	376.4	0.00	0.00	0.00
5,900.0	14.57	171.93	5,756.4	-791.40	-1,142.7	161.9	384.8	0.00	0.00	0.00
6,000.0	14.57	171.93	5,853.2	-888.18	-1,167.6	165.5	393.2	0.00	0.00	0.00
6,100.0	14.57	171.93	5,950.0	-984.97	-1,192.6	169.0	401.6	0.00	0.00	0.00
6,200.0	14.57	171.93	6,046.8	-1,081.75	-1,217.5	172.5	410.0	0.00	0.00	0.00
6,300.0	14.57	171.93	6,143.5	-1,178.53	-1,242.4	176.1	418.3	0.00	0.00	0.00
<b>END OF TANGENT</b>										
6,385.5	14.57	171.93	6,226.3	-1,261.28	-1,263.7	179.1	425.5	0.00	0.00	0.00
6,400.0	14.28	171.93	6,240.3	-1,275.33	-1,267.2	179.6	426.7	2.00	-2.00	0.00
6,500.0	12.28	171.93	6,337.6	-1,372.65	-1,290.0	182.8	434.4	2.00	-2.00	0.00
6,600.0	10.28	171.93	6,435.7	-1,470.71	-1,309.4	185.6	440.9	2.00	-2.00	0.00
6,700.0	8.28	171.93	6,534.4	-1,569.40	-1,325.3	187.8	446.3	2.00	-2.00	0.00
6,800.0	6.28	171.93	6,633.6	-1,668.59	-1,337.9	189.6	450.5	2.00	-2.00	0.00
<b>SHARON SPRINGS</b>										
6,821.5	5.85	171.93	6,655.0	-1,690.00	-1,340.1	189.9	451.3	2.00	-2.00	0.00
<b>NIOBRARA</b>										
6,880.8	4.67	171.93	6,714.0	-1,749.00	-1,345.5	190.7	453.1	2.00	-2.00	0.00
6,900.0	4.28	171.93	6,733.2	-1,768.16	-1,347.0	190.9	453.6	2.00	-2.00	0.00
7,000.0	2.28	171.93	6,833.0	-1,867.99	-1,352.7	191.7	455.5	2.00	-2.00	0.00
7,100.0	0.28	171.93	6,933.0	-1,967.96	-1,354.9	192.0	456.2	2.00	-2.00	0.00
<b>EOD TO VERTICAL</b>										
7,114.0	0.00	171.93	6,947.0	-1,981.96	-1,354.9	192.0	456.2	2.00	-2.00	0.00
<b>KOP (10°/100ft BUR)</b>										
7,144.0	0.00	0.00	6,977.0	-2,011.96	-1,354.9	192.0	456.2	0.00	0.00	0.00
7,200.0	5.60	90.46	7,032.9	-2,067.87	-1,354.9	194.7	458.9	9.99	9.99	0.00
<b>FORT HAYS</b>										
7,237.5	9.34	90.46	7,070.0	-2,105.00	-1,355.0	199.6	463.7	10.00	10.00	0.00
<b>CODELL</b>										
7,278.3	13.42	90.46	7,110.0	-2,145.00	-1,355.0	207.7	471.6	10.00	10.00	0.00
7,300.0	15.59	90.46	7,131.0	-2,166.04	-1,355.1	213.1	476.9	10.00	10.00	0.00
7,400.0	25.59	90.46	7,224.5	-2,259.53	-1,355.4	248.2	511.4	10.00	10.00	0.00
7,500.0	35.59	90.46	7,310.5	-2,345.50	-1,355.8	299.1	561.3	10.00	10.00	0.00
7,600.0	45.59	90.46	7,386.3	-2,421.34	-1,356.3	364.0	625.1	10.00	10.00	0.00
7,700.0	55.59	90.46	7,449.7	-2,484.74	-1,356.9	441.2	700.9	10.00	10.00	0.00
7,800.0	65.59	90.46	7,498.8	-2,533.78	-1,357.6	528.2	786.3	10.00	10.00	0.00
<b>J SAND</b>										
7,892.3	74.82	90.46	7,530.0	-2,565.00	-1,358.3	614.9	871.5	10.00	10.00	0.00
7,900.0	75.59	90.46	7,532.0	-2,566.97	-1,358.4	622.4	878.8	10.00	10.00	0.00
8,000.0	85.59	90.46	7,548.3	-2,583.30	-1,359.2	720.9	975.5	10.00	10.00	0.00



# Planning Report



<b>Database:</b>	EDM 5000.1 Single User Db	<b>Local Co-ordinate Reference:</b>	Well FAIRVIEW 1 - Slot FAIRVIEW 1
<b>Company:</b>	EXTRACTION OIL & GAS	<b>TVD Reference:</b>	KB-EST @ 4965.0usft (Original Well Elev)
<b>Project:</b>	WELD COUNTY, COLORADO (NAD 83)	<b>MD Reference:</b>	KB-EST @ 4965.0usft (Original Well Elev)
<b>Site:</b>	NW SW SEC. 5 T2N R68W 6th P.M.	<b>North Reference:</b>	True
<b>Well:</b>	FAIRVIEW 1	<b>Survey Calculation Method:</b>	Minimum Curvature
<b>Wellbore:</b>	ORIGINAL WELLBORE		
<b>Design:</b>	PROPOSAL #2		

Planned Survey										
MD (usft)	Inc (°)	Azi (°)	TVD (usft)	SS (usft)	+N/-S (usft)	+E/-W (usft)	Vertical Section (usft)	Dogleg Rate (°/100usft)	Build Rate (°/100usft)	Turn Rate (°/100usft)
<b>7" ICP - FAIRVIEW 1 (P2)</b>										
8,044.1	90.00	90.46	7,550.0	-2,585.00	-1,359.5	765.0	1,018.8	10.00	10.00	0.00
8,100.0	90.00	90.46	7,550.0	-2,585.00	-1,360.0	820.9	1,073.7	0.00	0.00	0.00
8,200.0	90.00	90.46	7,550.0	-2,585.00	-1,360.8	920.9	1,171.9	0.00	0.00	0.00
8,300.0	90.00	90.46	7,550.0	-2,585.00	-1,361.6	1,020.9	1,270.0	0.00	0.00	0.00
8,400.0	90.00	90.46	7,550.0	-2,585.00	-1,362.4	1,120.9	1,368.2	0.00	0.00	0.00
8,500.0	90.00	90.46	7,550.0	-2,585.00	-1,363.2	1,220.9	1,466.4	0.00	0.00	0.00
8,600.0	90.00	90.46	7,550.0	-2,585.01	-1,364.0	1,320.9	1,564.6	0.00	0.00	0.00
8,700.0	90.00	90.46	7,550.0	-2,585.01	-1,364.9	1,420.9	1,662.8	0.00	0.00	0.00
8,800.0	90.00	90.46	7,550.0	-2,585.01	-1,365.7	1,520.9	1,760.9	0.00	0.00	0.00
8,900.0	90.00	90.46	7,550.0	-2,585.01	-1,366.5	1,620.9	1,859.1	0.00	0.00	0.00
9,000.0	90.00	90.46	7,550.0	-2,585.01	-1,367.3	1,720.9	1,957.3	0.00	0.00	0.00
9,100.0	90.00	90.46	7,550.0	-2,585.01	-1,368.1	1,820.9	2,055.5	0.00	0.00	0.00
9,200.0	90.00	90.46	7,550.0	-2,585.01	-1,368.9	1,920.9	2,153.7	0.00	0.00	0.00
9,300.0	90.00	90.46	7,550.0	-2,585.01	-1,369.7	2,020.8	2,251.9	0.00	0.00	0.00
9,400.0	90.00	90.46	7,550.0	-2,585.01	-1,370.5	2,120.8	2,350.0	0.00	0.00	0.00
9,500.0	90.00	90.46	7,550.0	-2,585.01	-1,371.3	2,220.8	2,448.2	0.00	0.00	0.00
9,600.0	90.00	90.46	7,550.0	-2,585.01	-1,372.1	2,320.8	2,546.4	0.00	0.00	0.00
9,700.0	90.00	90.46	7,550.0	-2,585.01	-1,372.9	2,420.8	2,644.6	0.00	0.00	0.00
9,800.0	90.00	90.46	7,550.0	-2,585.01	-1,373.7	2,520.8	2,742.8	0.00	0.00	0.00
9,900.0	90.00	90.46	7,550.0	-2,585.02	-1,374.5	2,620.8	2,840.9	0.00	0.00	0.00
10,000.0	90.00	90.46	7,550.0	-2,585.02	-1,375.4	2,720.8	2,939.1	0.00	0.00	0.00
10,100.0	90.00	90.46	7,550.0	-2,585.02	-1,376.2	2,820.8	3,037.3	0.00	0.00	0.00
10,200.0	90.00	90.46	7,550.0	-2,585.02	-1,377.0	2,920.8	3,135.5	0.00	0.00	0.00
10,300.0	90.00	90.46	7,550.0	-2,585.02	-1,377.8	3,020.8	3,233.7	0.00	0.00	0.00
10,400.0	90.00	90.46	7,550.0	-2,585.02	-1,378.6	3,120.8	3,331.8	0.00	0.00	0.00
10,500.0	90.00	90.46	7,550.0	-2,585.02	-1,379.4	3,220.8	3,430.0	0.00	0.00	0.00
10,600.0	90.00	90.46	7,550.0	-2,585.02	-1,380.2	3,320.8	3,528.2	0.00	0.00	0.00
10,700.0	90.00	90.46	7,550.0	-2,585.02	-1,381.0	3,420.8	3,626.4	0.00	0.00	0.00
10,800.0	90.00	90.46	7,550.0	-2,585.02	-1,381.8	3,520.8	3,724.6	0.00	0.00	0.00
10,900.0	90.00	90.46	7,550.0	-2,585.02	-1,382.6	3,620.8	3,822.7	0.00	0.00	0.00
11,000.0	90.00	90.46	7,550.0	-2,585.02	-1,383.4	3,720.8	3,920.9	0.00	0.00	0.00
11,100.0	90.00	90.46	7,550.0	-2,585.02	-1,384.2	3,820.8	4,019.1	0.00	0.00	0.00
11,200.0	90.00	90.46	7,550.0	-2,585.02	-1,385.0	3,920.8	4,117.3	0.00	0.00	0.00
11,300.0	90.00	90.46	7,550.0	-2,585.02	-1,385.8	4,020.8	4,215.5	0.00	0.00	0.00
11,400.0	90.00	90.46	7,550.0	-2,585.02	-1,386.6	4,120.8	4,313.6	0.00	0.00	0.00
11,500.0	90.00	90.46	7,550.0	-2,585.02	-1,387.4	4,220.8	4,411.8	0.00	0.00	0.00
11,600.0	90.00	90.46	7,550.0	-2,585.02	-1,388.2	4,320.8	4,510.0	0.00	0.00	0.00
11,700.0	90.00	90.46	7,550.0	-2,585.02	-1,389.0	4,420.8	4,608.2	0.00	0.00	0.00
11,800.0	90.00	90.46	7,550.0	-2,585.02	-1,389.8	4,520.8	4,706.4	0.00	0.00	0.00
11,900.0	90.00	90.46	7,550.0	-2,585.02	-1,390.6	4,620.8	4,804.5	0.00	0.00	0.00
12,000.0	90.00	90.46	7,550.0	-2,585.02	-1,391.4	4,720.8	4,902.7	0.00	0.00	0.00
12,100.0	90.00	90.46	7,550.0	-2,585.02	-1,392.2	4,820.8	5,000.9	0.00	0.00	0.00
12,200.0	90.00	90.46	7,550.0	-2,585.02	-1,393.0	4,920.8	5,099.1	0.00	0.00	0.00
12,300.0	90.00	90.46	7,550.0	-2,585.02	-1,393.9	5,020.7	5,197.3	0.00	0.00	0.00
12,400.0	90.00	90.46	7,550.0	-2,585.02	-1,394.7	5,120.7	5,295.4	0.00	0.00	0.00
12,500.0	90.00	90.46	7,550.0	-2,585.01	-1,395.5	5,220.7	5,393.6	0.00	0.00	0.00
12,600.0	90.00	90.46	7,550.0	-2,585.01	-1,396.3	5,320.7	5,491.8	0.00	0.00	0.00
12,700.0	90.00	90.46	7,550.0	-2,585.01	-1,397.1	5,420.7	5,590.0	0.00	0.00	0.00
12,800.0	90.00	90.46	7,550.0	-2,585.01	-1,397.9	5,520.7	5,688.2	0.00	0.00	0.00
12,900.0	90.00	90.46	7,550.0	-2,585.01	-1,398.7	5,620.7	5,786.3	0.00	0.00	0.00
13,000.0	90.00	90.46	7,550.0	-2,585.01	-1,399.5	5,720.7	5,884.5	0.00	0.00	0.00
13,100.0	90.00	90.46	7,550.0	-2,585.01	-1,400.3	5,820.7	5,982.7	0.00	0.00	0.00

<b>Database:</b>	EDM 5000.1 Single User Db	<b>Local Co-ordinate Reference:</b>	Well FAIRVIEW 1 - Slot FAIRVIEW 1
<b>Company:</b>	EXTRACTION OIL & GAS	<b>TVD Reference:</b>	KB-EST @ 4965.0usft (Original Well Elev)
<b>Project:</b>	WELD COUNTY, COLORADO (NAD 83)	<b>MD Reference:</b>	KB-EST @ 4965.0usft (Original Well Elev)
<b>Site:</b>	NW SW SEC. 5 T2N R68W 6th P.M.	<b>North Reference:</b>	True
<b>Well:</b>	FAIRVIEW 1	<b>Survey Calculation Method:</b>	Minimum Curvature
<b>Wellbore:</b>	ORIGINAL WELLBORE		
<b>Design:</b>	PROPOSAL #2		

## Planned Survey

MD (usft)	Inc (°)	Azi (°)	TVD (usft)	SS (usft)	+N/-S (usft)	+E/-W (usft)	Vertical Section (usft)	Dogleg Rate (°/100usft)	Build Rate (°/100usft)	Turn Rate (°/100usft)
13,200.0	90.00	90.46	7,550.0	-2,585.01	-1,401.1	5,920.7	6,080.9	0.00	0.00	0.00
13,300.0	90.00	90.46	7,550.0	-2,585.01	-1,401.9	6,020.7	6,179.1	0.00	0.00	0.00
13,400.0	90.00	90.46	7,550.0	-2,585.01	-1,402.7	6,120.7	6,277.2	0.00	0.00	0.00
13,500.0	90.00	90.46	7,550.0	-2,585.01	-1,403.5	6,220.7	6,375.4	0.00	0.00	0.00
13,600.0	90.00	90.46	7,550.0	-2,585.01	-1,404.3	6,320.7	6,473.6	0.00	0.00	0.00
13,700.0	90.00	90.46	7,550.0	-2,585.01	-1,405.1	6,420.7	6,571.8	0.00	0.00	0.00
13,800.0	90.00	90.46	7,550.0	-2,585.01	-1,405.9	6,520.7	6,669.9	0.00	0.00	0.00
13,900.0	90.00	90.46	7,550.0	-2,585.00	-1,406.7	6,620.7	6,768.1	0.00	0.00	0.00
14,000.0	90.00	90.46	7,550.0	-2,585.00	-1,407.5	6,720.7	6,866.3	0.00	0.00	0.00
14,100.0	90.00	90.46	7,550.0	-2,585.00	-1,408.3	6,820.7	6,964.5	0.00	0.00	0.00
14,200.0	90.00	90.46	7,550.0	-2,585.00	-1,409.1	6,920.7	7,062.7	0.00	0.00	0.00
<b>BHL - FAIRVIEW 1 (P2)</b>										
<b>14,264.6</b>	<b>90.00</b>	<b>90.46</b>	<b>7,550.0</b>	<b>-2,585.00</b>	<b>-1,409.6</b>	<b>6,985.3</b>	<b>7,126.1</b>	<b>0.00</b>	<b>0.00</b>	<b>0.00</b>

## Formations

MD (usft)	TVD (usft)	Name	Lithology	Dip (°)	Dip Direction (°)
3,085.1	3,032.0	PARKMAN		0.00	
3,930.2	3,850.0	SUSSEX		0.00	
4,508.9	4,410.0	SHANNON		0.00	
6,821.5	6,655.0	SHARON SPRINGS		0.00	
6,880.8	6,714.0	NIOBRARA		0.00	
7,237.5	7,070.0	FORT HAYS		0.00	
7,278.3	7,110.0	CODELL		0.00	
7,892.3	7,530.0	J SAND			

## Plan Annotations

MD (usft)	TVD (usft)	Local Coordinates		Comment
		+N/-S (usft)	+E/-W (usft)	
950.0	950.0	0.0	0.0	START NUDGE (2°/100ft BUR)
1,678.5	1,670.7	-91.2	12.9	EOB TO 14.57° INC
6,385.5	6,226.3	-1,263.7	179.1	END OF TANGENT
7,114.0	6,947.0	-1,354.9	192.0	EOD TO VERTICAL
7,144.0	6,977.0	-1,354.9	192.0	KOP (10°/100ft BUR)
8,044.1	7,550.0	-1,359.5	765.0	7" ICP - FAIRVIEW 1 (P2)
14,264.6	7,550.0	-1,409.6	6,985.3	BHL - FAIRVIEW 1 (P2)