

CERVI 03N-63W-34-1N PAD PAD LAYOUT

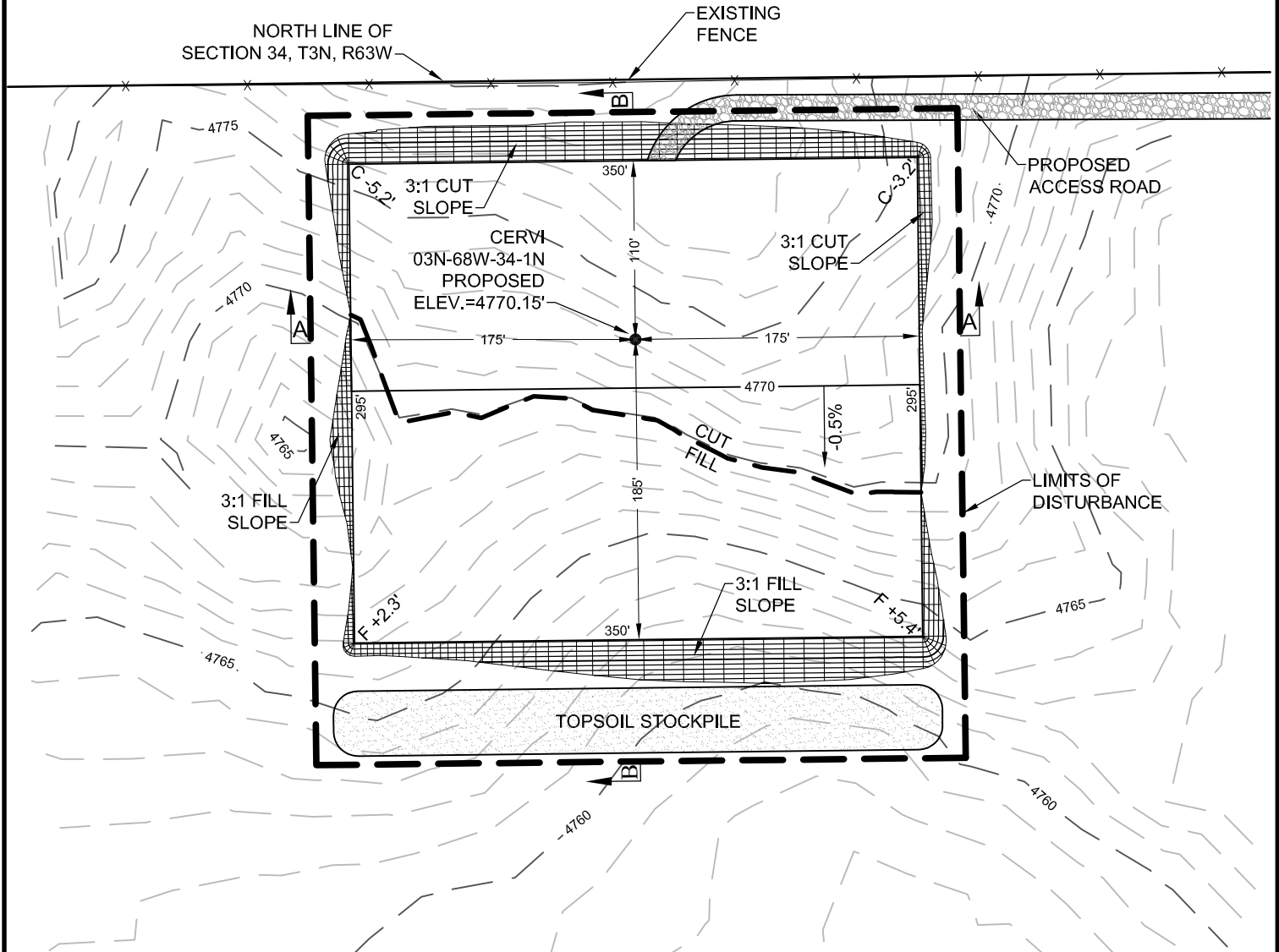

NOTES:

1. A COMPLETE UTILITIES LOCATION IS RECOMMENDED BEFORE CONSTRUCTION.
2. GEOGRAPHIC POSITIONS/COORDINATES SHOWN HEREON ARE IN NAD83 DATUM.
3. EARTHWORK QUANTITIES ARE APPROXIMATE & FOR INFORMATION ONLY. 6" OF TOPSOIL HAS BEEN SUBTRACTED FROM EXISTING SURFACE PRIOR TO PERFORMING EARTHWORK CALCULATIONS.
4. STOCKPILES ARE ASSUMED TO BE 10' IN HEIGHT WITH 2:1 SIDE SLOPES.

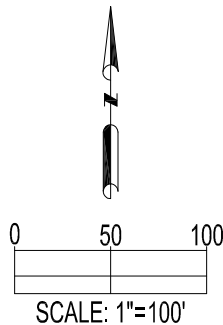

SITE QUANTITIES

FINISHED GRADE ELEVATION AT WELL	4770.15'
TOTAL CUT FOR WELL PAD	7,545 CY
FILL FOR WELL PAD	6,859 CY
10% FILL FACTOR	686 CY
TOTAL FILL	7,545 CY
NET EXCESS MATERIAL	0 CY
TOPSOIL FROM GRADED AREA	2,254 CY
TOTAL DISTURBANCE AREA	3.7 ACRES

PREPARED BY:



FIELD DATE:
11-15-14

DRAWING DATE:
12-15-14

BY:
KAD

CHECKED BY:
WDW

SITE NAME:

CERVI 03N-63W-34-1N PAD

SURFACE LOCATION:

NW 1/4, SEC. 34, T3N, R63W, 6TH P.M.
WELD COUNTY, COLORADO

PREPARED FOR:



CERVI 03N-63W-34-1N PAD CROSS SECTIONS

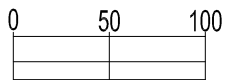
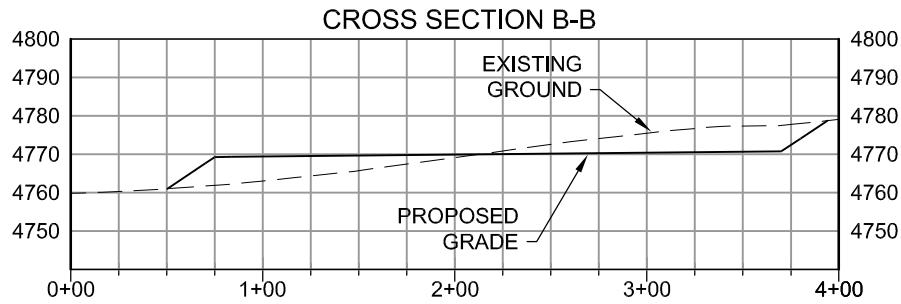
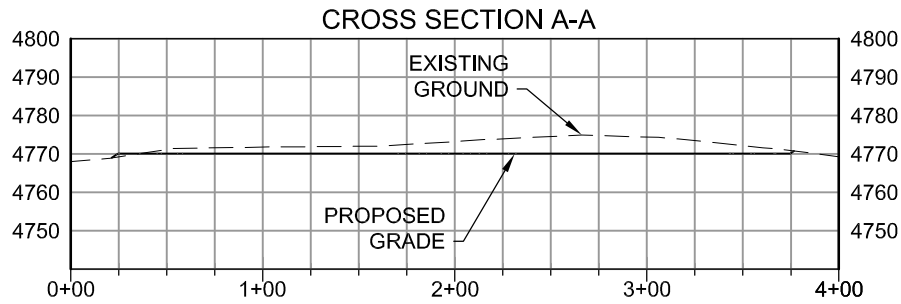

SCALE: 1"=100'
VERT SCALE: 1"=50'

NOTE:

1. A COMPLETE UTILITIES LOCATION IS RECOMMENDED BEFORE CONSTRUCTION.
2. GEOGRAPHIC POSITIONS/COORDINATES SHOWN HEREON ARE IN NAD83 DATUM.

PREPARED BY:



FIELD DATE:

11-15-14

DRAWING DATE:

12-15-14

BY:

KAD

CHECKED BY:

WDW

SITE NAME:

CERVI 03N-63W-34-1N PAD

SURFACE LOCATION:

NW 1/4, SEC. 34, T3N, R63W, 6TH P.M.
WELD COUNTY, COLORADO

PREPARED FOR:

