

SECTION 32
SECTION 33

Section Line

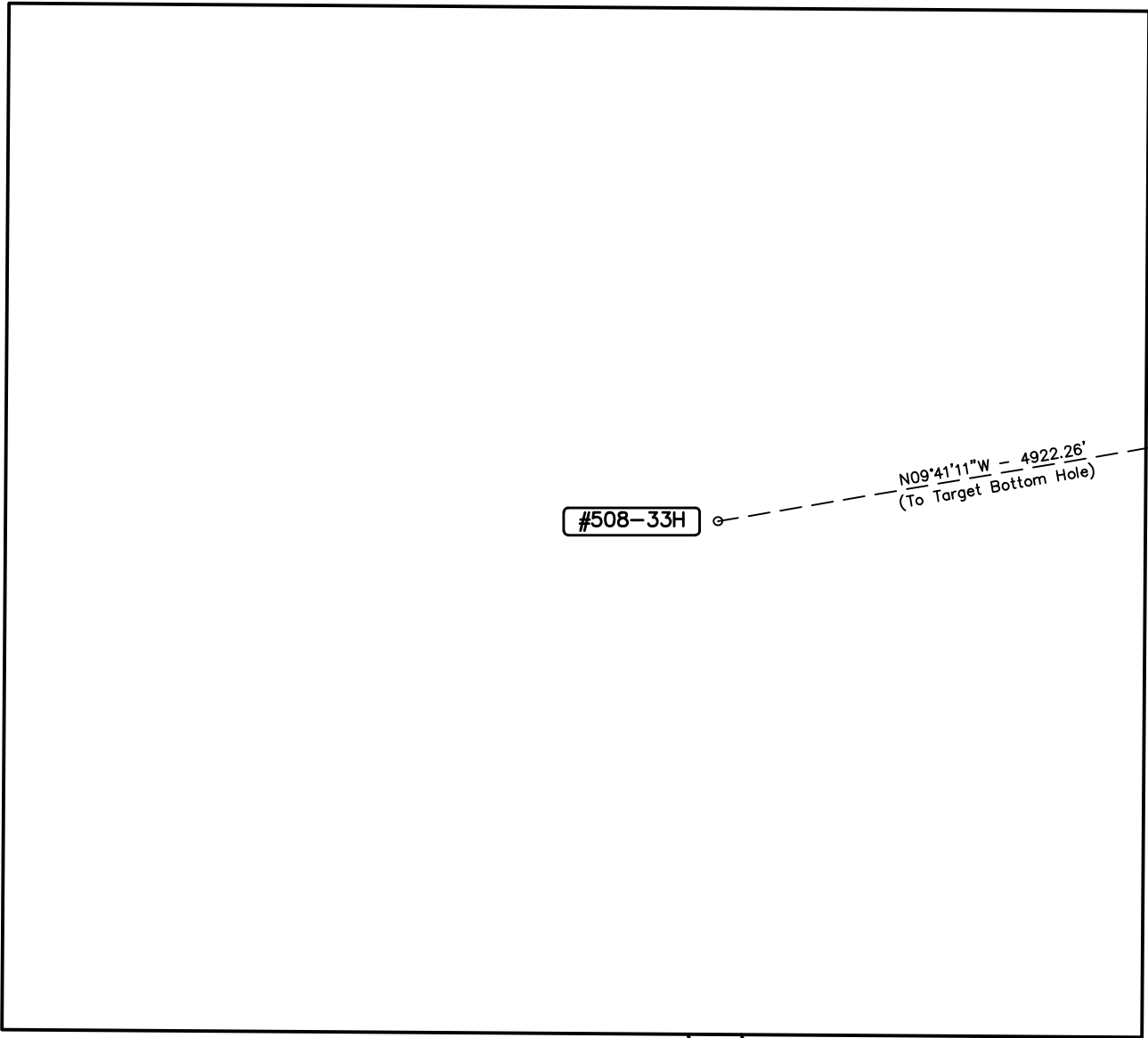

#508-33H

N09°41'11"W - 4922.26'
(To Target Bottom Hole)

Proposed
Access Road

EOG RESOURCES, INC.

FOX CREEK 33 NWNW 1
SECTION 33, T12N, R63W, 6th P.M.
280' FNL 285' FWL



UELS, LLC
Corporate Office * 85 South 200 East
Vernal, UT 84078 * (435) 789-1017

DRAWN BY: T.B.	DATE DRAWN: 02-19-15
SCALE: 1" = 60'	REVISED: 00-00-00
MULTI-WELL PLAN	FIGURE #6