

T12N, R65W

WELL BORE CONTINUES
INTO SECTION 20

MATCH LINE
SEE SHEET 2

NW. COR.
SEC. 29, T12N, R65W
SET ALUM. CAP
L.S. NO. 38305

NE. COR.
SEC. 29, T12N, R65W
FOUND STONE

SURFACE LOCATION
GROUND ELEVATION= 5955.4'
NAD 83
LATITUDE= 40.971886°
LONGITUDE= -104.687450°

BOTTOM HOLE LOCATION
NAD 83
LATITUDE= 40.999176°
LONGITUDE= -104.685424°

LATITUDE= 40°59'57.034"
LONGITUDE= -104°41'07.527"

N 02°41'36" E 9959' GRID
N 03°13'05" E TRUE
N 05°15'24" W MAGNETIC

N 00°11'22" E
2660.33' (C)

29

N 89°44'45" W
2621.22' (C)

N 89°44'45" W
2621.22' (C)

SURFACE LOCATION
NAD 27
LATITUDE= 40.971904°
LONGITUDE= -104.686928°

BOTTOM HOLE LOCATION
NAD 27
LATITUDE= 40.999194°
LONGITUDE= -104.684903°

LATITUDE= 40°59'57.097"
LONGITUDE= -104°41'05.651"

N 00°11'22" E
2660.33' (C)

**RESOLUTION FED
12-65-29-20-4NH**
SURFACE LOCATION

SW. COR.
SEC. 29, T12N, R65W
SET ALUM. CAP
L.S. NO. 38305

SE. COR.
SEC. 29, T12N, R65W
SET ALUM. CAP
L.S. NO. 38305

S 89°43'08" W 5259.69' (M)

NOTES:

- ▲ INDICATES FOUND SECTION CORNER
- INDICATES CALCULATED CORNER
- ELEVATION BASED ON NAVD88 (GEOID09)
- BASIS OF BEARING DERIVED FROM COLORADO COORDINATE SYSTEM 1983 NORTH ZONE UNLESS OTHERWISE NOTED.
- ALL MEASURED DISTANCES ARE GRID.
COMBINED SCALE FACTOR: .99975846
- OPERATOR: CHRIS KASCHMITTER / PDOP = 1.1
- SEE ADDENDUM TO WELL LOCATION CERTIFICATE FOR EXISTING IMPROVEMENTS WITHIN 500' OF THE WELL PAD.
- WELL FOOTAGES ARE MEASURED AT RIGHT ANGLES TO THE SECTION LINES.
- THE BOTTOM OF HOLE BEARS N02°41'36"E 9959' FROM THE SURFACE LOCATION.

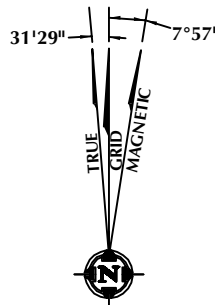

NOTE:
MAGNETIC NORTH IS CURRENT AS OF 1/15/2015.
MAGNETIC NORTH CHANGES WEST 0°06' PER YEAR.



CERTIFICATE OF SURVEYOR:

THIS IS TO CERTIFY THAT THE ABOVE PLAT WAS PREPARED FROM FIELD NOTES OF ACTUAL SURVEY MADE BY ME OR UNDER MY SUPERVISION AND THAT THE SAME ARE TRUE AND CORRECT TO THE BEST OF MY KNOWLEDGE AND BELIEF. THIS CERTIFICATE DOES NOT REPRESENT A LAND SURVEY PLAT OR IMPROVEMENT SURVEY PLAT AS DEFINED BY C.S. 38-51-102 AND CANNOT BE RELIED UPON TO DETERMINE OWNERSHIP.

Benjamin J. Reenders
BENJAMIN J. REENDERS
PROFESSIONAL LAND SURVEYOR
COLORADO REGISTRATION NUMBER 4836

NOTICE:
ACCORDING TO COLORADO STATE LAW YOU MUST COMMENCE ANY LEGAL ACTION BASED UPON ANY DEFECT IN THIS SURVEY WITHIN THREE YEARS AFTER YOU FIRST DISCOVER SUCH DEFECT. IN NO EVENT MAY ANY ACTION BASED UPON ANY DEFECT IN THIS SURVEY BE COMMENCED MORE THAN TEN YEARS FROM THE DATE ON THE CERTIFICATION SHOWN HEREON.

WELL PAD - RESOLUTION FED 12-65-29-20-4NH

RESOLUTION FED 12-65-29-20-4NH
WELL LOCATION CERTIFICATE
380' FSL & 2165' FWL SESW (SURFACE)
LOCATED IN SECTION 29
266' FNL & 2618' FWL NENW (BOTTOM)
LOCATED IN SECTION 20
T12N, R65W, 6TH P.M.
WELD COUNTY, COLORADO

**Anadarko E&P
Onshore LLC**
1099 18th Street
Denver, Colorado 80202



CONSULTING, LLC

SHERIDAN OFFICE
1095 Saberton Avenue
Sheridan, Wyoming 82801
Phone 307-674-0609

LOVELAND OFFICE
1635 Foxtrail Drive, Suite 204
Loveland, Colorado 80538
Phone 970-776-4331

DRAFTED BY:	MDZ	CHECKED BY:	BJR	SHEET NO:
DATE DRAFTED:	1/26/15	DATE SURVEYED:	12/10/14	1
REVISED:	2/3/15	FILE NAME:	14-52	1 OF 2

N. 1/4 COR.
SEC. 20, T12N, R65W
FOUND STONE
N 89°28'30" W 2570.64' (M)



THIS IS TO CERTIFY THAT THE ABOVE PLAT WAS PREPARED FROM FIELD NOTES OF ACTUAL SURVEY MADE BY ME OR UNDER MY SUPERVISION AND THAT THE SAME ARE TRUE AND CORRECT TO THE BEST OF MY KNOWLEDGE AND BELIEF. THIS CERTIFICATE DOES NOT REPRESENT A LAND SURVEY PLAT OR IMPROVEMENT SURVEY PLAT AS DEFINED BY G.S. 38-51.02 AND CANNOT BE RELIED UPON TO DETERMINE OWNERSHIP.

Benjamin J. Reenders
BENJAMIN J. REENDERS
PROFESSIONAL LAND SURVEYOR
COLORADO REGISTRATION NUMBER 48305
2/3/15

NOTICE: ACCORDING TO COLORADO STATE LAW YOU MUST COMMENCE ANY LEGAL ACTION BASED UPON ANY DEFECT IN THIS SURVEY WITHIN THREE YEARS AFTER YOU FIRST DISCOVER SUCH DEFECT. IN NO EVENT MAY ANY ACTION BASED UPON ANY DEFECT IN THIS SURVEY BE COMMENCED MORE THAN TEN YEARS FROM THE DATE ON THE CERTIFICATION SHOWN HEREON.

NOTE:
MAGNETIC NORTH IS CURRENT AS OF 1/15/2015.
MAGNETIC NORTH CHANGES WEST 0°06' PER YEAR.

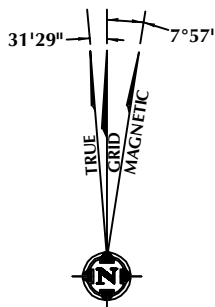

1. ▲ INDICATES FOUND SECTION CORNER
2. ● INDICATES CALCULATED CORNER
3. ELEVATION BASED ON NAVD88 (GEOID09)
4. BASIS OF BEARING DERIVED FROM COLORADO COORDINATE SYSTEM 1983 NORTH ZONE UNLESS OTHERWISE NOTED.
5. ALL MEASURED DISTANCES ARE GRID.
COMBINED SCALE FACTOR: .99975846
6. OPERATOR: CHRIS KASCHMITTER / PDOP = 1.1
7. SEE ADDENDUM TO WELL LOCATION CERTIFICATE FOR EXISTING IMPROVEMENTS WITHIN 500' OF THE WELL PAD.
8. WELL FOOTAGES ARE MEASURED AT RIGHT ANGLES TO THE SECTION LINES.
9. THE BOTTOM OF HOLE BEARS N02°41'36"E 9959' FROM THE SURFACE LOCATION.

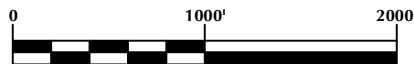

RESOLUTION FED 12-65-29-20-4NH
WELL LOCATION CERTIFICATE
380' FSL & 2165' FWL SESW (SURFACE)
LOCATED IN SECTION 29
266' FNL & 2618' FWL NENW (BOTTOM)
LOCATED IN SECTION 20
T12N, R65W, 6TH P.M.
WELD COUNTY, COLORADO

**Anadarko E&P
Onshore LLC
1099 18th Street
Denver, Colorado 80202**



SHERIDAN OFFICE
1095 Saberton Avenue
Sheridan, Wyoming 82801
Phone 307-674-0609

DRAFTED BY: MDZ	CHECKED BY: BJR	SHEET NO: 2 2 OF 2
DATE DRAFTED: 1/26/15	DATE SURVEYED: 12/10/14	
REVISED: 2/3/15	FILE NAME: 14-52	

K:\ANADARKO\2014\2014_02_RESOLUTION_PROSPECT_WELLS_COIGISMaps_ABCD\ResolutionFed 12-65-29-20\4NH\ResolutionFed 12-65-29-20-4NH.mxd 2/3/2015 1:50:36 PM

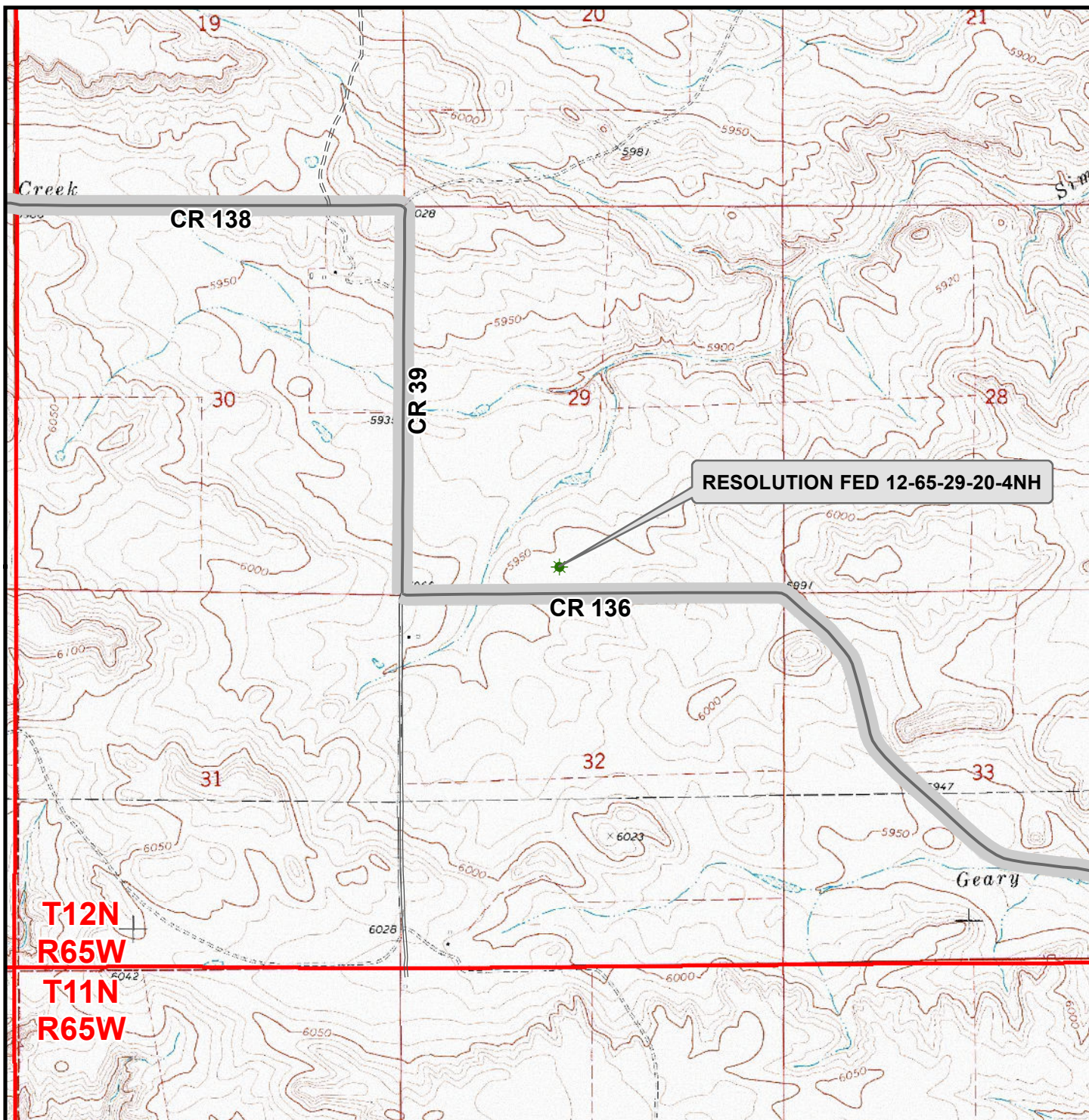

Legend

- ★ Well - Fed - Proposed === Road - Primitive - Existing — Road - County - Existing
—— Road - Improved - Existing — Road - Highway - Existing

WELL PAD - RESOLUTION FED 12-65-29-20-4NH

GENERAL LOCATION MAP
RESOLUTION FED 12-65-29-20-4NH
LOCATED IN SECTION 29
T12N, R65W, 6th P.M.
WELD COUNTY, COLORADO

**Anadarko E&P
Onshore LLC**

1099 18th Street
Denver, CO 80202



CONSULTING, LLC

SHERIDAN OFFICE
2155 North Main Street
Sheridan, Wyoming 82801
Phone 307-674-0609

LOVELAND OFFICE
1635 Foxtail Drive, Suite 204
Loveland, Colorado 80538
Phone 970-776-4331



SCALE: 1" = 2,000ft

NAD83 CO-Nft

DRAWN: JELO

DATE: 26 Jan 2015

REVISED: TL

DATE: 3 Feb 2015