

K:\ANADARKO\2014\2014\_52\_RESOLUTION\_PROSPECT\_WELLS\_COIGISMaps\_ABCDIResolution 11-64-3-34\Resolution 11-64-3-34-5CH Access.mxd 2/6/2015 4:47:47 PM

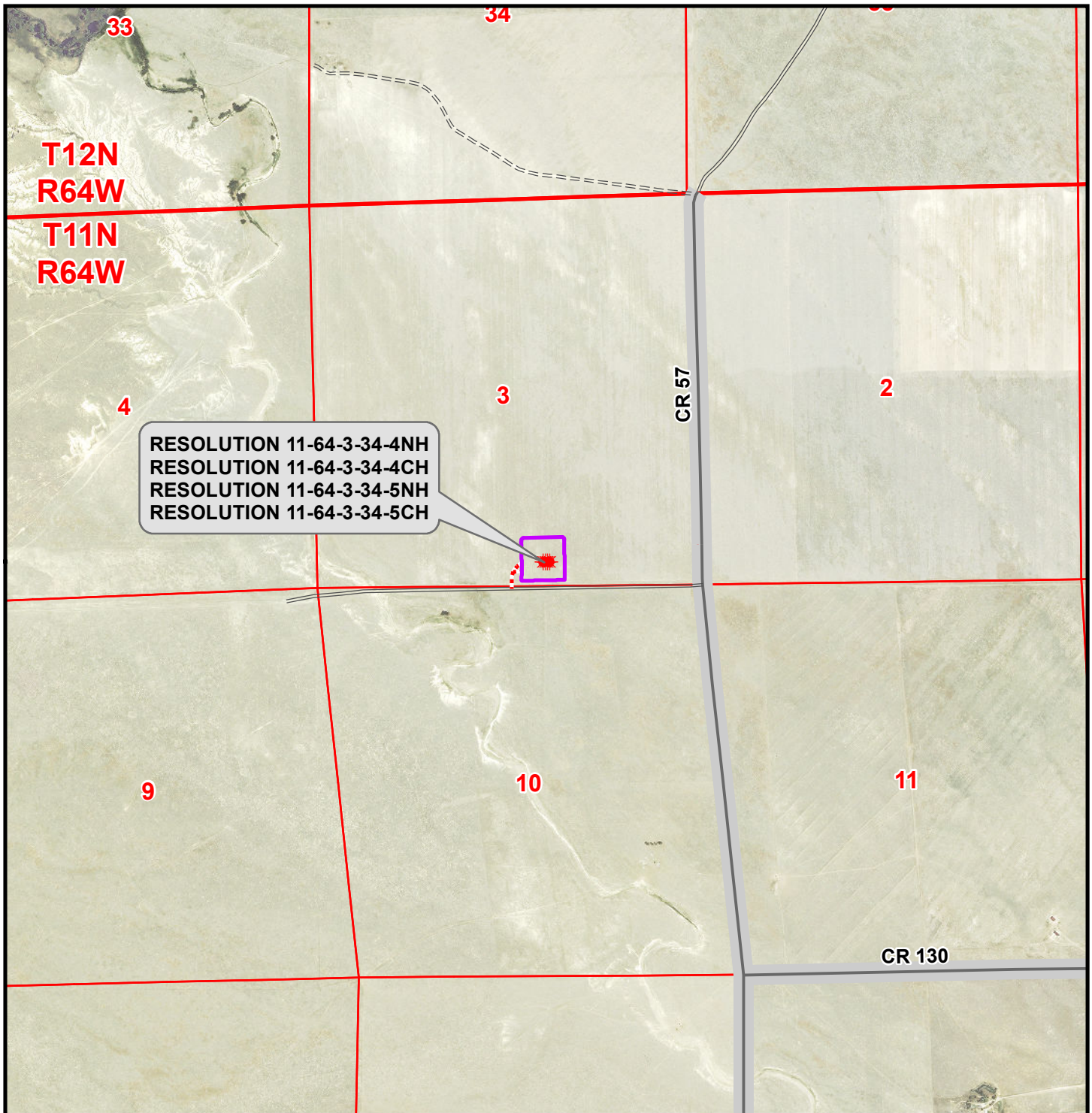

### Legend

-  Well - Fee - Proposed     Access Road - Proposed     Road - Improved - Existing     Road - Highway - Existing  
 Disturbance Area     Road - Primitive - Existing     Road - County - Existing

#### WELL PAD - RESOLUTION 11-64-3-34-5CH

ACCESS ROAD MAP  
RESOLUTION 11-64-3-34-4NH,  
RESOLUTION 11-64-3-34-4CH,  
RESOLUTION 11-64-3-34-5NH &  
RESOLUTION 11-64-3-34-5CH  
LOCATED IN SECTION 3  
T11N, R64W, 6th P.M.  
WELD COUNTY, COLORADO

## Anadarko E&P Onshore LLC

1099 18th Street  
Denver, CO 80202



### CONSULTING, LLC

**SHERIDAN OFFICE**  
1095 Saberton Avenue  
Sheridan, Wyoming 82801  
Phone 307-674-0609

**LOVELAND OFFICE**  
1635 Foxtail Drive, Suite 204  
Loveland, Colorado 80538  
Phone 970-776-4331



SCALE: 1" = 2,000ft

NAD83 CO-Nft

DRAWN: JELO

DATE: 6 Feb 2015

REVISED:

DATE: