

# Selected Items Report

## Oil and Gas Wells Selected

Filter Results by Formation

Include

Filter

WELL DESCRIPTION

LOCATION ID

LOCATION

WELL INFORMATION

## Water Wells Selected From Map

Filter Results by Depth

Greater than

Filter

WELL DESCRIPTION

LOCATION

WELL INFORMATION

Depth

Top Perf

Bottom Perf

Aquifer

[Receipt=0107837D, Permit=0108225--](#)  
PINNECOOSE ERNEST

NESE 21  
33 N-7W

160

29

151

GW

[Receipt=9123777, Permit=0096192--](#)  
SAGE COLLEEN

SESE 21  
33 N-7W

100

0

0

GW

[Receipt=1504877, Permit=0069604-F-](#)  
SAMSON RESOURCES COMPANY

SENE 22  
33 N-7W

0

0

0

GW

[Receipt=1504878, Permit=0069605-F-](#)  
SAMSON RESOURCES COMPANY

SENE 22  
33 N-7W

0

0

0

GW

[Receipt=0383232, Permit=0185387--](#)  
JOHNSTON RALPH

SENE 22  
33 N-7W

0

0

0

GW

[Receipt=0431178, Permit=0209566--](#)  
SHEEHAN CHRISTOPHER

SENE 22  
33 N-7W

0

0

0

GW

[Receipt=1504876, Permit=0069603-F-](#)  
SAMSON RESOURCES COMPANY

SENE 22  
33 N-7W

0

0

0

GW

[Receipt=1505385, Permit=0076118-F-](#)  
SAMSON RESOURCES COMPANY

SENE 22  
33 N-7W

0

0

0

GW

[Receipt=1504903, Permit=0069630-F-](#)  
SAMSON RESOURCES COMPANY

SENE 22  
33 N-7W

0

0

0

GW

[Receipt=1504905, Permit=0069632-F-](#)

SENE 22

0

0

0

GW

|   |                            |            |           |            |                                 |
|---|----------------------------|------------|-----------|------------|---------------------------------|
| SAMSON RESOURCES COMPANY  | 33 N-7W                    |            |           |            |                                 |
| <a href="#">Receipt=1504904, Permit=0069631-F-</a><br>SAMSON RESOURCES COMPANY      | NESW 22<br>33 N-7W         | 0          | 0         | 0          | GW                              |
| <a href="#">Receipt=0088225D, Permit=0096177--</a><br>MILLER C                      | NESW 22<br>33 N-7W         | 300        | 48        | 180        | GW                              |
| <a href="#">Receipt=0037932, Permit=0052882-F-</a><br>SOUTHERN UTE INDIAN TRIBE     | NWSW 22<br>33 N-7W         | 0          | 0         | 0          | GW                              |
| <a href="#">Receipt=9700567, Permit=0052882-F-</a><br>SOUTHERN UTE INDIAN TRIBE     | NWSW 22<br>33 N-7W         | 0          | 0         | 0          | GW                              |
| <a href="#">Receipt=1504821, Permit=0069547-F-</a><br>SAMSON RESOURCES COMPANY      | NENW 23<br>33 N-7W         | 0          | 0         | 0          | GW                              |
| <a href="#">Receipt=1504822, Permit=0069548-F-</a><br>SAMSON RESOURCES COMPANY      | SESW 23<br>33 N-7W         | 0          | 0         | 0          | GW                              |
| <a href="#">Receipt=1504823, Permit=0069549-F-</a><br>SAMSON RESOURCES COMPANY      | SESW 23<br>33 N-7W         | 0          | 0         | 0          | GW                              |
| <a href="#">Receipt=C340067, Permit=0000067-WCB-</a><br>CLOUD JULIUS                | 26<br>33 N-7W              | 210        | 0         | 0          | GW                              |
| <a href="#">Receipt=2000000V, Permit=0068533-F-</a><br>BP AMERICA PRODUCTION CO     | SWNW 26<br>33 N-7W         | 2,983      | 2,675     | 2,876      | KFL                             |
| <a href="#">Receipt=1505185, Permit=0075269-F-</a><br>BP AMERICA PRODUCTION COMPANY | SWNW 26<br>33 N-7W         | 0          | 0         | 0          | GW                              |
| <a href="#">Receipt=9700884, Permit=0241915--</a><br>FOX FIRE FARMS LLP#1           | NWSW 26<br>33 N-7W         | 160        | 60        | 140        | GW                              |
| <a href="#">Receipt=3641256, Permit=0068722-F-</a><br>FOX FIRE FARMS LLLP ONE       | NWSW 26<br>33 N-7W         | 160        | 60        | 140        | GW                              |
| <a href="#">Receipt=9701722, Permit=0258008--</a><br>FOX FIRE FARMS LLP #1          | NWSW 26<br>33 N-7W         | 160        | 0         | 0          | GW                              |
| <a href="#">Receipt=9701527, Permit=0252045--</a><br>FRAZIER LAND LLC               | NENE 27<br>33 N-7W         | 150        | 0         | 0          | GW                              |
| <a href="#">Receipt=0258881A, Permit=0141635--</a><br>PARRY R.                      | SENE 27<br>33 N-7W         | 0          | 0         | 0          | GW                              |
| <a href="#">Receipt=0258881B, Permit=0141635--A</a><br>PARRY R.                     | SENE 27<br>33 N-7W         | 0          | 0         | 0          | GW                              |
| <a href="#">Receipt=0398576, Permit=0193572--</a><br><b>PARRY RICHARD E</b>         | <b>SENE 27<br/>33 N-7W</b> | <b>275</b> | <b>40</b> | <b>275</b> | <b>GW<br/>WW elev-50'=6195'</b> |
| <a href="#">Receipt=0421458, Permit=0204906--</a>                                   | SENE 27                    | 275        | 40        | 275        | GW                              |

|   |                    |       |       |       |     |
|---|--------------------|-------|-------|-------|-----|
| FOX FIRE FARM LTD PARN #1   | 33 N-7W            |       |       |       |     |
| <a href="#">Receipt=1505209, Permit=0075302-F-</a><br>BP AMERICA PRODUCTION COMPANY | SWNE 27<br>33 N-7W | 0     | 0     | 0     | GW  |
| <a href="#">Receipt=1505210, Permit=0075303-F-</a><br>BP AMERICA PRODUCTION COMPANY | SWNE 27<br>33 N-7W | 0     | 0     | 0     | GW  |
| <a href="#">Receipt=1505257, Permit=0075340-F-</a><br>BP AMERICA PRODUCTION COMPANY | NWNW 27<br>33 N-7W | 0     | 0     | 0     | GW  |
| <a href="#">Receipt=3639566O, Permit=0068506-F-</a><br>BP America Production Co     | NWNW 27<br>33 N-7W | 3,030 | 275   | 2,500 | KFL |
| <a href="#">Receipt=2000001D, Permit=0068540-F-</a><br>BP AMERICA PRODUCTION CO     | SWSE 27<br>33 N-7W | 3,101 | 2,936 | 8,050 | KFL |
| <a href="#">Receipt=0915645, Permit=0096193--</a><br>SAGE JR RAY                    | NWSW 27<br>33 N-7W | 0     | 0     | 0     | GW  |
| <a href="#">Receipt=9701661, Permit=0057885-F-</a><br>SOUTHERN UTE INDIAN TRIBE     | SESW 27<br>33 N-7W | 200   | 0     | 0     | GW  |
| <a href="#">Receipt=1505256, Permit=0075339-F-</a><br>BP AMERICA PRODUCTION COMPANY | SWSW 27<br>33 N-7W | 0     | 0     | 0     | GW  |
| <a href="#">Receipt=1505215, Permit=0075305-F-</a><br>BP AMERICA PRODUCTION COMPANY | NWNE 28<br>33 N-7W | 0     | 0     | 0     | GW  |
| <a href="#">Receipt=3639566J, Permit=0068502-F-</a><br>BP AMERICA PRODUCTION CO     | SESE 28<br>33 N-7W | 2,550 | 2,700 | 2,950 | KFL |

- ☒ Points
- ☒ Buffer 1
- ☒ DEM\_10m
- ☒ O&G Facilities
  - ☒ Wells
    - ☐ Well Name
    - ☐ Well API#
  - ☐ Misc Facilities
  - ☐ Pits
  - ☐ Active
  - ☐ Closed
  - ☐ Unknown
  - ☐ Permits
    - ☒ Pending Permits
    - ☐ Pending2As (Diamond)
  - ☐ Well Status
    - ☐ Spud Notice
    - ☐ UIC Active
    - ☐ SC
    - ☐ Anomalies
  - ☐ Surface Casing
- ☒ COGCC Data
  - ☒ COGCCAlert\_v4
  - ☒ COGCCAlert
  - ☒ COGCCOnsite
  - ☐ Samples
  - ☐ Remediation
- ☐ O&G Locations
- ☐ Directionals
- ☐ COGCC Rules
- ☐ O&G Fields
- ☐ Field Insp Unit
- ☐ SeismicPermits
- ☐ Historic Wells
- ☐ Roads & RRs
- ☐ Water Resources
- ☐ Environmental\_Sites
- ☐ SecTwpRng
- ☐ IGDS

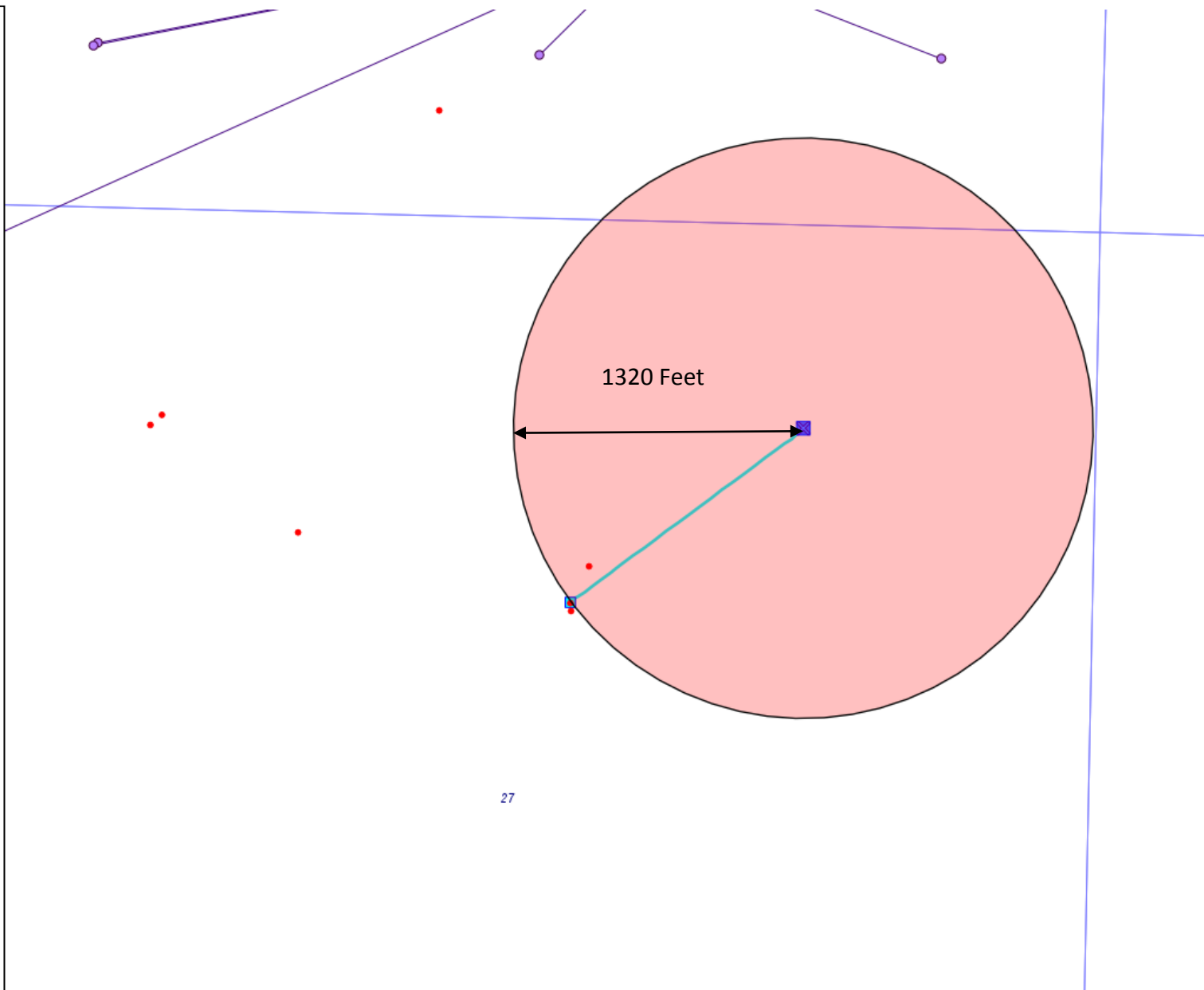

## Selected Items Report

### Oil and Gas Wells Selected

Filter Results by Formation

Include



MVRD

Filter

#### WELL DESCRIPTION

#### LOCATION ID

#### LOCATION

#### WELL INFORMATION

[05-067-08135, IGNACIO 33-7 31](#)  
WPX ENERGY PRODUCTION LLC

[326456](#)

SWNE 27  
33N -7W (N)

| Sidetrack | TD   | Formation | Status |
|-----------|------|-----------|--------|
| 00        | 5930 | MVRD      | PR     |

# WPX IGNACIO 33-7 #31

## CASING, LINER and CEMENT

21. Submit contractor's cement job summary for each string cemented.

| String       | Hole Size | Csg/Liner Size | Csg/Liner Wt (Lbs.) | Csg/Liner Top | Csg/Tool Setting Depth | No. of sacks | Cement Interval |       | Identify Method |      |
|--------------|-----------|----------------|---------------------|---------------|------------------------|--------------|-----------------|-------|-----------------|------|
|              |           |                |                     |               |                        |              | Top             | Btm   | CBL             | Calc |
| Surface      | 12-1/4"   | 9-5/8"         | 36#                 | Surface       | 340'                   | 185 sx       | Surface         | 340'  |                 | Circ |
| 1st          | 8-3/4"    | 7"             | 20#                 | Surface       | 3345'                  | 530 sx       | Surface         | 3345' |                 | Circ |
| Stage Cement |           |                |                     |               |                        |              |                 |       |                 |      |
|              |           |                |                     |               |                        |              |                 |       |                 |      |
| 2nd          |           |                |                     |               |                        |              |                 |       |                 |      |
| Stage Cement |           |                |                     |               |                        |              |                 |       |                 |      |
|              |           |                |                     |               |                        |              |                 |       |                 |      |
| 3rd          |           |                |                     |               |                        |              |                 |       |                 |      |
| Stage Cement |           |                |                     |               |                        |              |                 |       |                 |      |
|              |           |                |                     |               | ✓                      |              |                 |       |                 |      |
| 1st Liner    | 6-1/4"    | 4-1/2"         | 10.5#               | 3244'         | 5930'                  | 325 sx       | 3244'           | 5930' | TOL             |      |
| 2nd Liner    |           |                |                     |               |                        |              |                 |       |                 |      |