

EXISTING CONTOURS

WARD RIVERDALE 15-2-5HC WELL PAD

SECTION 14, TOWNSHIP 1 SOUTH, RANGE 67 WEST OF THE 6TH PRINCIPAL MERIDIAN

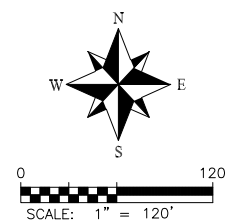
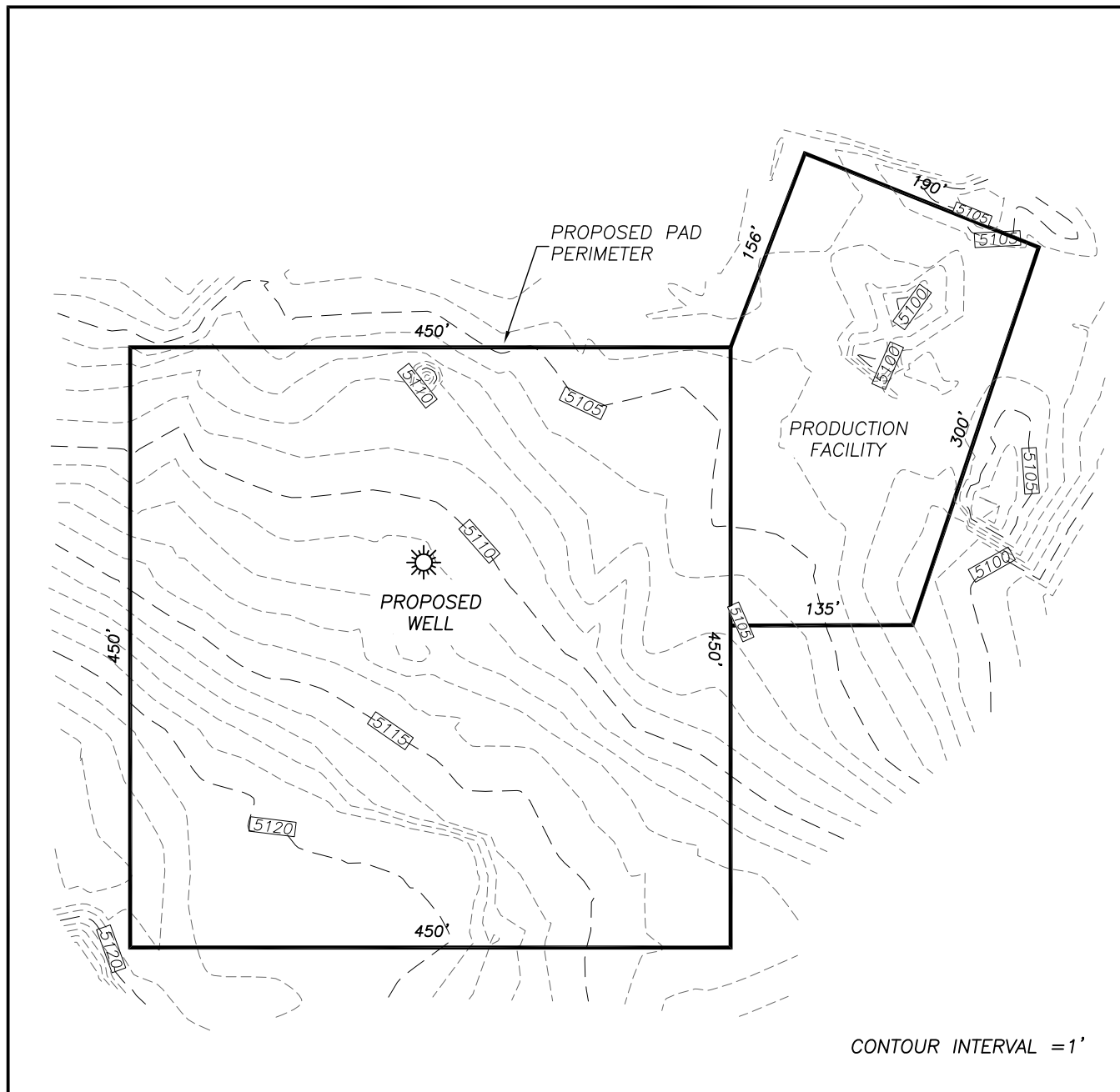

PROPOSED WELL PAD CONTOURS

WARD RIVERDALE 15-2-5HC WELL PAD

SECTION 14, TOWNSHIP 1 SOUTH, RANGE 67 WEST OF THE 6TH PRINCIPAL MERIDIAN

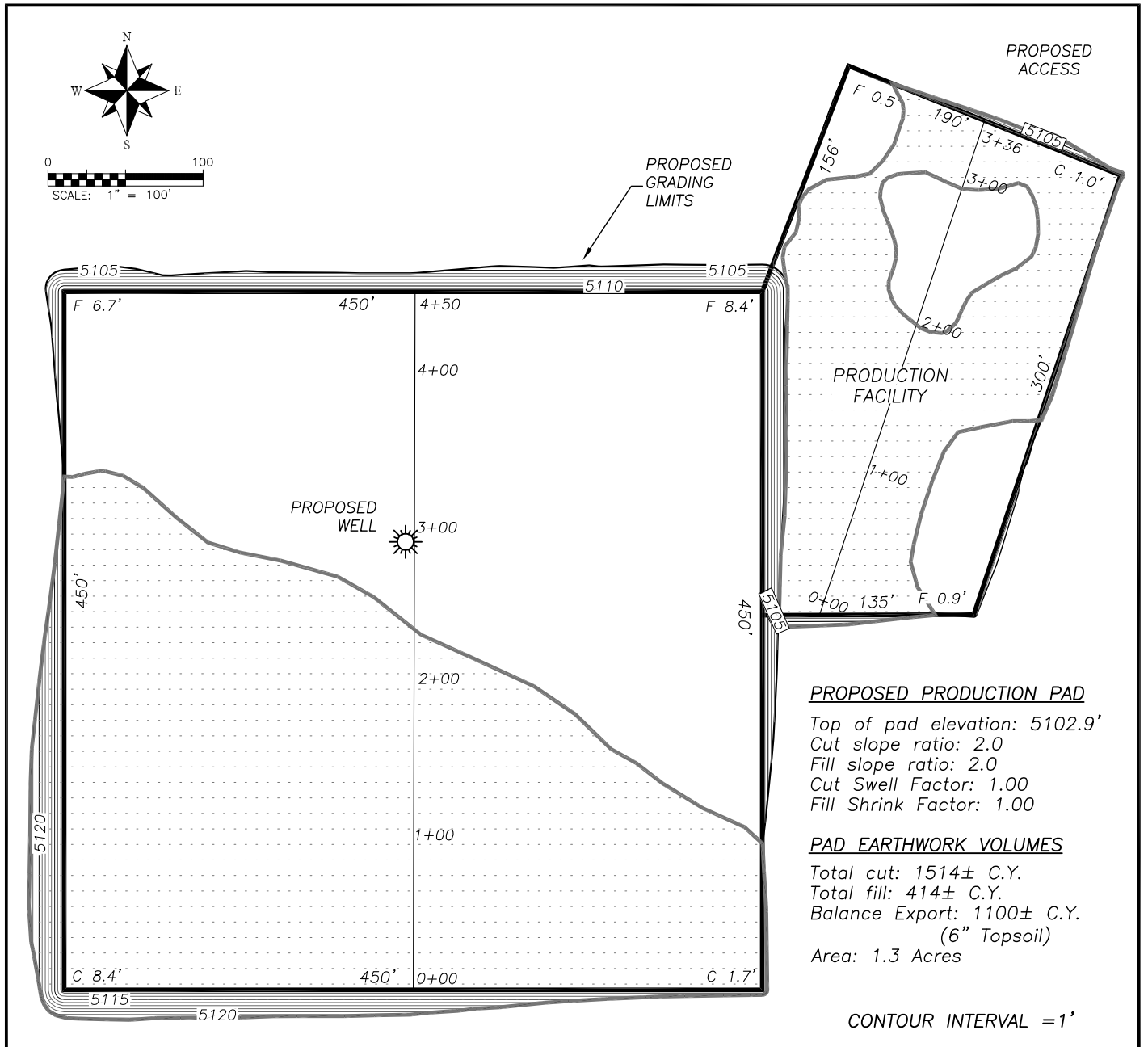
**PROPOSED WELL PAD**

Top of pad elevation: 5111.9'
 Cut slope ratio: 2.0
 Fill slope ratio: 2.0
 Cut Swell Factor: 1.00
 Fill Shrink Factor: 1.00

PAD EARTHWORK VOLUMES

Total cut: 18885± C.Y.
 Total fill: 14584± C.Y.
 Balance Export: 4300± C.Y.
 (6" Topsoil)
 Area: 5.2 Acres

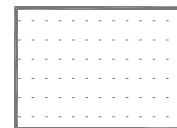

AREA OF
PROPOSED CUT

PROPOSED PAD CROSS SECTIONS WARD RIVERDALE 15-2-5HC WELL PAD

SECTION 14, TOWNSHIP 1 SOUTH, RANGE 67 WEST OF THE 6TH PRINCIPAL MERIDIAN

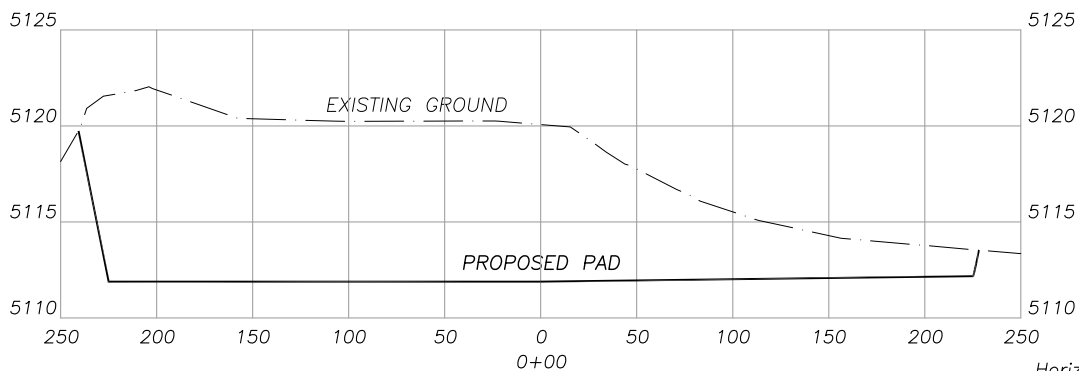
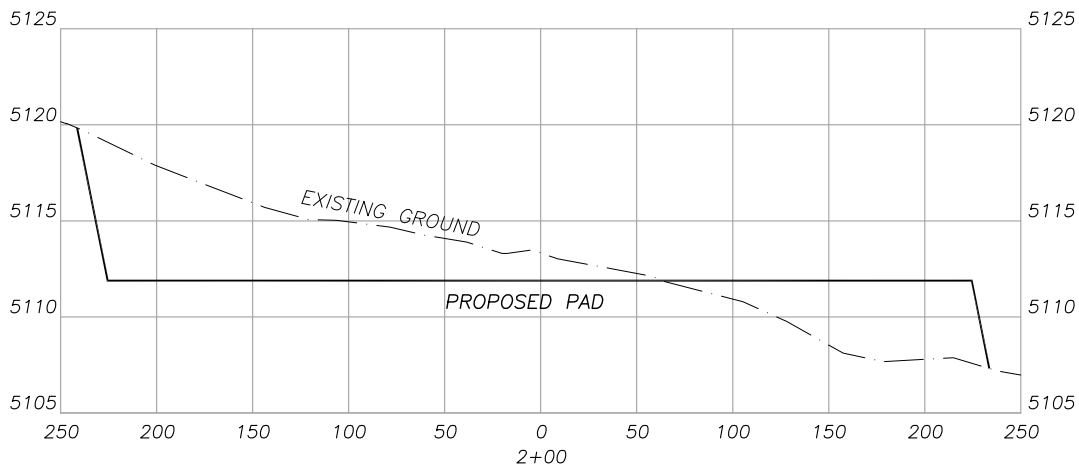
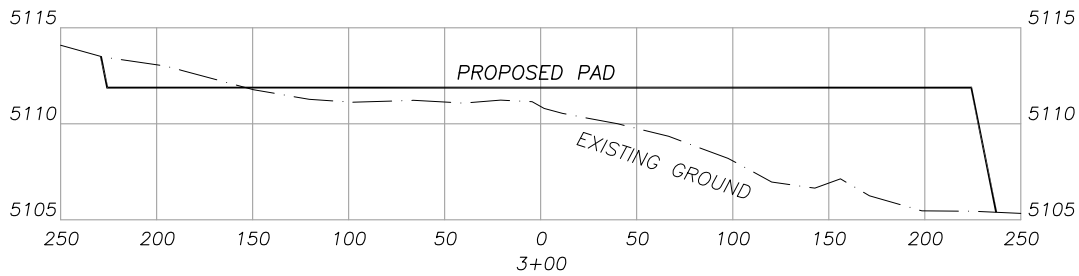
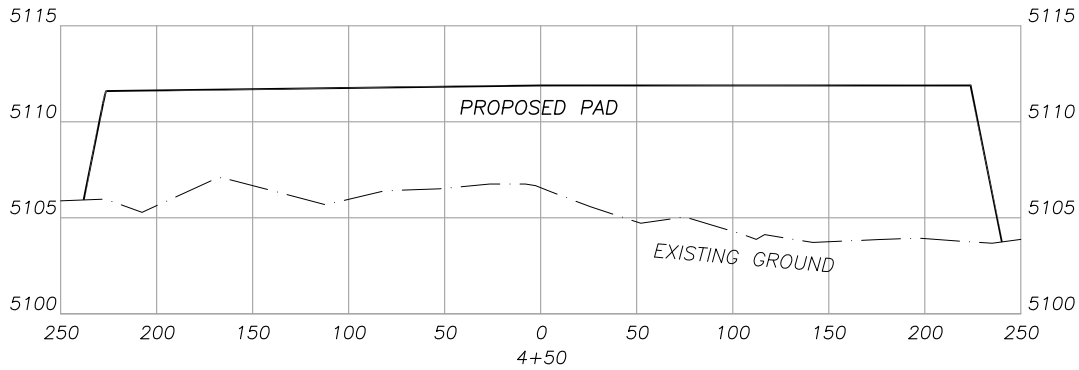

Horizontal Scale 50
Vertical Scale 5

PROPOSED PRODUCTION PAD CROSS SECTIONS WARD RIVERDALE 15-2-5HC WELL PAD

SECTION 14, TOWNSHIP 1 SOUTH, RANGE 67 WEST OF THE 6TH PRINCIPAL MERIDIAN

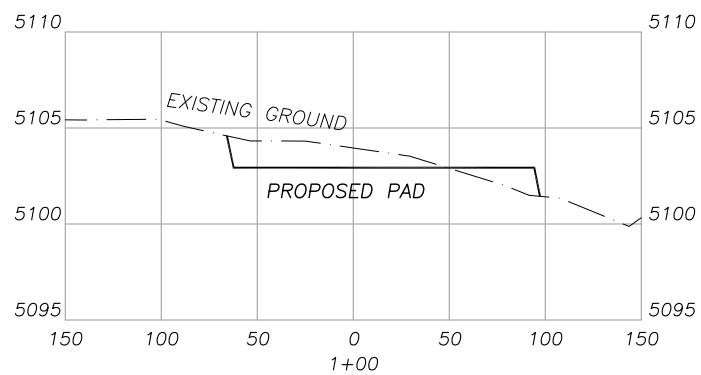
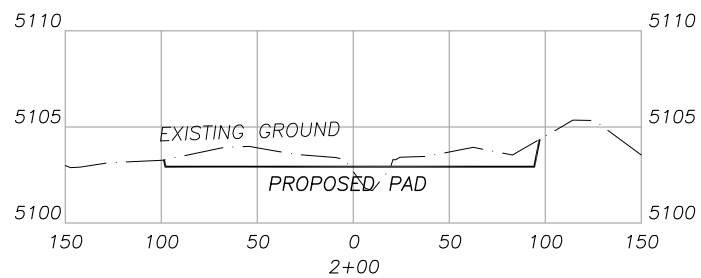
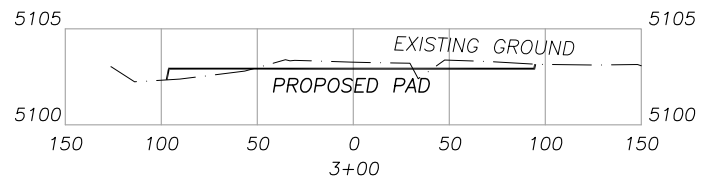
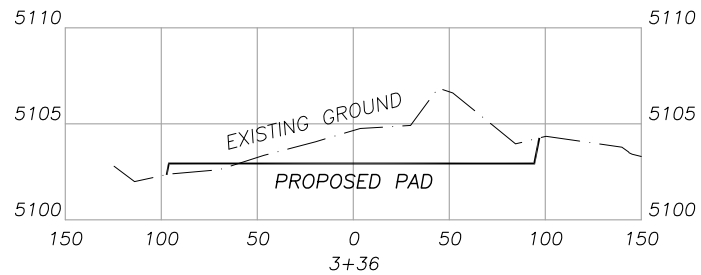

Horizontal Scale 50
Vertical Scale 5

PROPOSED RIG LAYOUT

WARD RIVERDALE 15-2-5HC WELL PAD

SECTION 14, TOWNSHIP 1 SOUTH, RANGE 67 WEST OF THE 6TH PRINCIPAL MERIDIAN

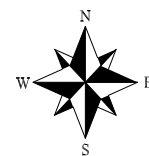
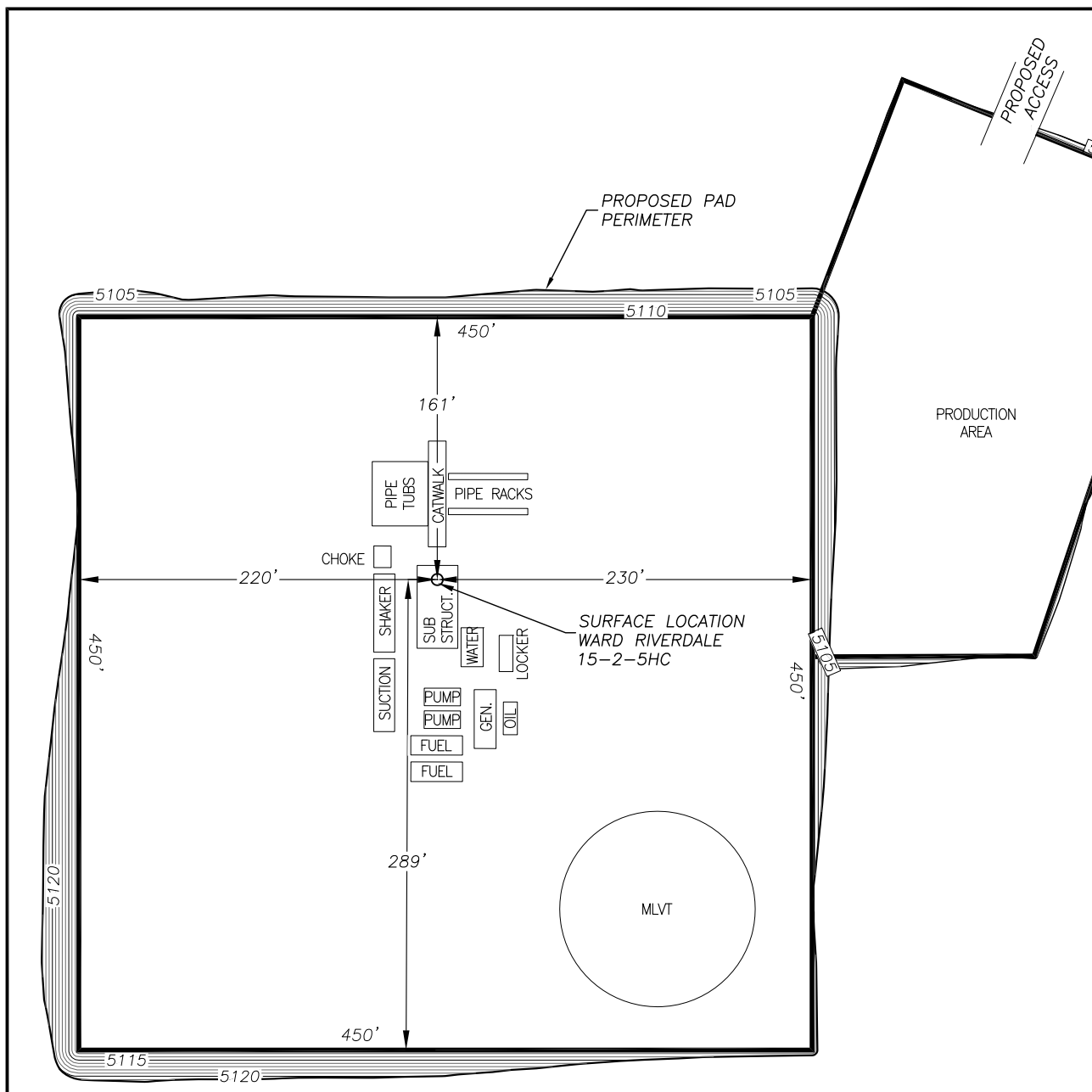

0 100
SCALE: 1" = 100'

DALEY LAND SURVEYING, INC.

PARKER, CO. 80134

303 953 9841

PROPOSED PRODUCTION FACILITY WARD RIVERDALE 15-2-5HC WELL PAD

SECTION 14, TOWNSHIP 1 SOUTH, RANGE 67 WEST OF THE 6TH PRINCIPAL MERIDIAN

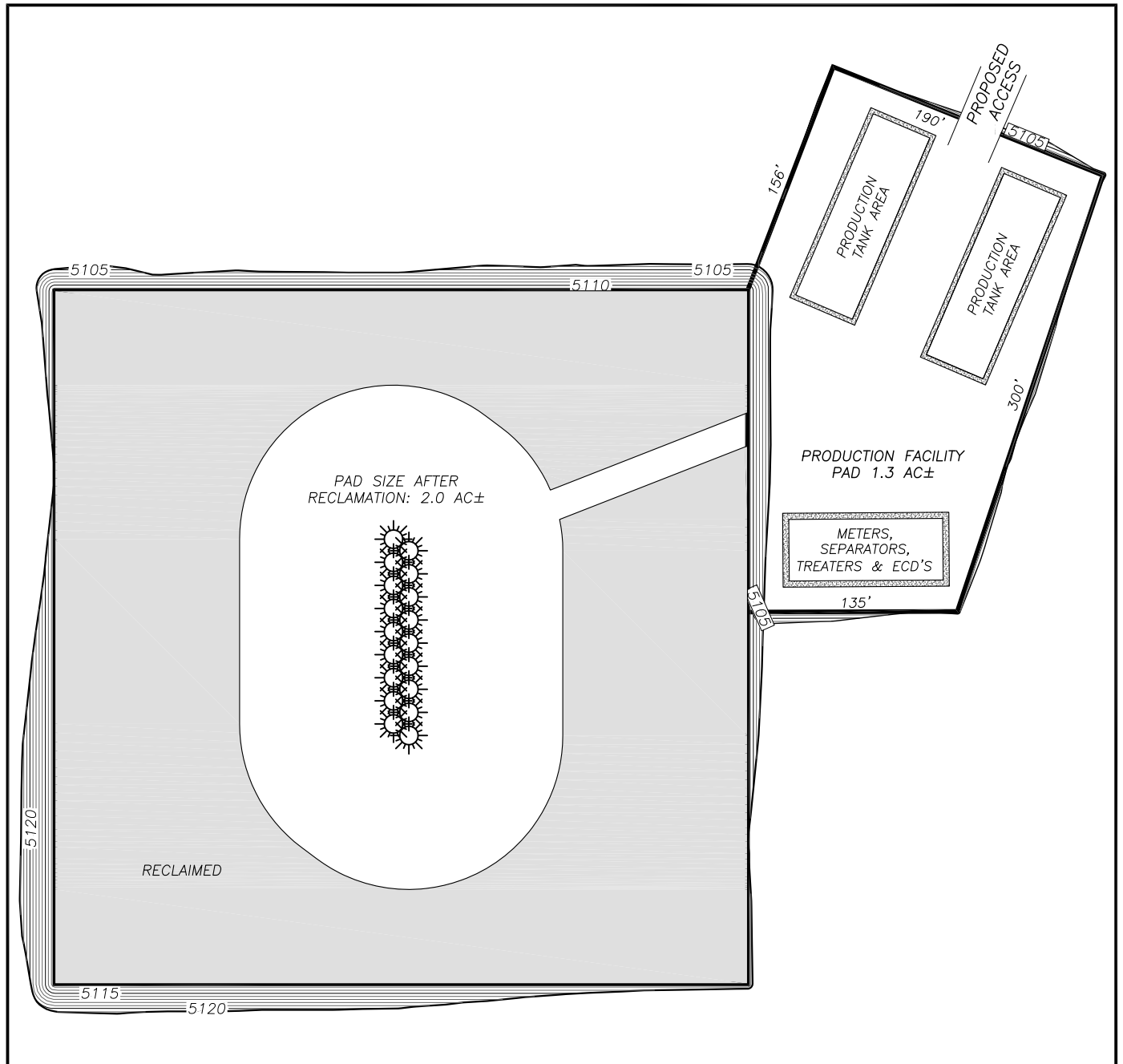

0 100
SCALE: 1" = 100'