



February 10, 2015

Mr. Matt Lepore, Director
Colorado Oil and Gas Conservation Commission
1120 Lincoln Street, Suite 801
Denver, Colorado 80203

7535 Hilltop Circle
Denver, CO 80221
www.petro-fs.com

**RE: COGCC Rule 318A.e.: Proposed Spacing Unit
Roberts 12-12NHZ Well: SENE Section 12, Township 7 North, Range 67 West
Weld County, Colorado**

Dear Mr. Lepore:

Synergy Resources Corporation (Synergy) is planning to drill the above referenced well in accordance with the provisions set out in Colorado Oil and Gas Conservation Commission (COGCC) Rule 318A.e. Synergy's Proposed Spacing Unit consists of:

N½ of Section 12, Township 7 North, Range 67 West
Containing 320.00 acres more or less

Synergy is not the only owner within the Proposed Spacing Unit and has provided notice to the remaining owners, as required by COGCC Rule 318A.e.(5). Copies of the required notification letters are on file at Synergy's office. The required thirty (30) day notice period has elapsed absent the receipt by Synergy of any objection to their proposal by the owners within the Proposed Spacing Unit for the subject well.

Enclosed is the Proposed Spacing Unit Exhibit to assist in your review and approval of Synergy's proposed Application for Permit to Drill for the Roberts 12-12NHZ Well. Many thanks for your attention to this matter.

Respectfully,

Jeff Annable
Regulatory Technician
Agent for Synergy Resources Corporation

:ja

Enclosure: Proposed Spacing Unit Exhibit

We are what we repeatedly do. Excellence, then, is not an act, but a habit.

-Aristotle

PROPOSED 318A.e. SPACING UNIT

SECTION 12, TOWNSHIP 7 NORTH, RANGE 67 WEST, 6TH P.M.

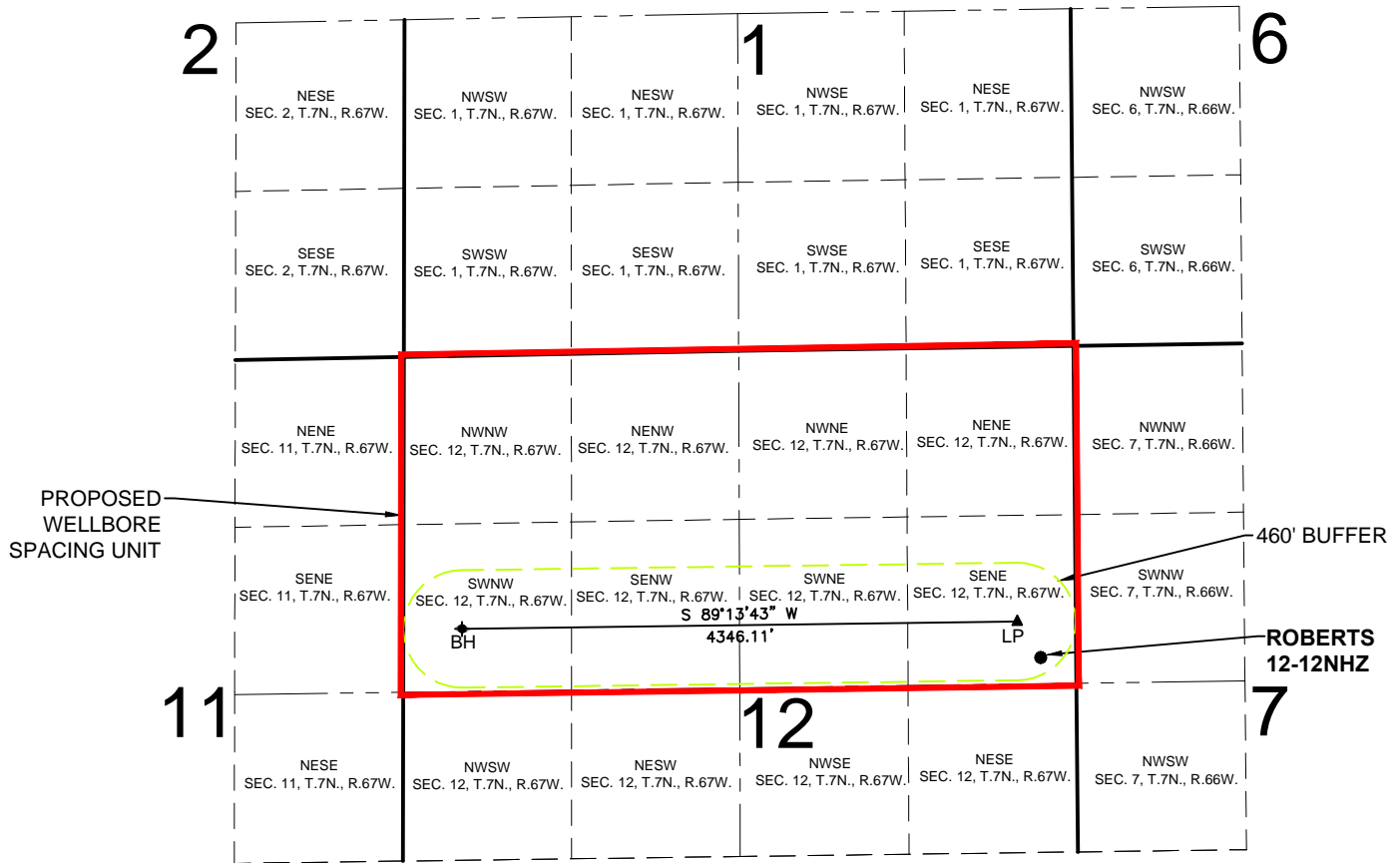

WELL **ROBERTS 12-12NHZ** TO BE LOCATED 2437' FNL AND 277' FEL, SEC. 12, T7N, R67W

LEGEND

- = PROPOSED WELL
- ▲ = LANDING POINT
- ◆ = BOTTOM HOLE
- LP = LANDING POINT
- BH = BOTTOM HOLE

SURFACE LOCATION

NAD83
 LATITUDE= 40.589374°
 LONGITUDE= 104.832810°

LANDING POINT LOCATION

NAD83
 LATITUDE= 40.590152°
 LONGITUDE= 104.833468°

BOTTOM HOLE LOCATION

NAD83
 LATITUDE= 40.590081°
 LONGITUDE= 104.849117°

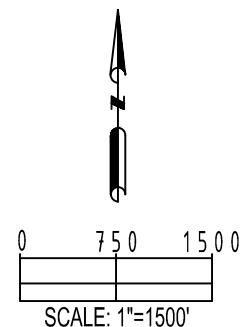

PREPARED BY: PFS Petroleum Field Services, LLC 7535 Hilltop Circle Denver, CO 80221	FIELD DATE: 07-29-14	SURFACE LOCATION: SE 1/4 NE 1/4, SEC. 12, T7N, R67W, 6TH P.M. WELD COUNTY, COLORADO
	DRAWING DATE: 10-30-14	
BY: SMF	CHECKED: TJN	