

# LONG 22-B PAD HYDROLOGY MAP

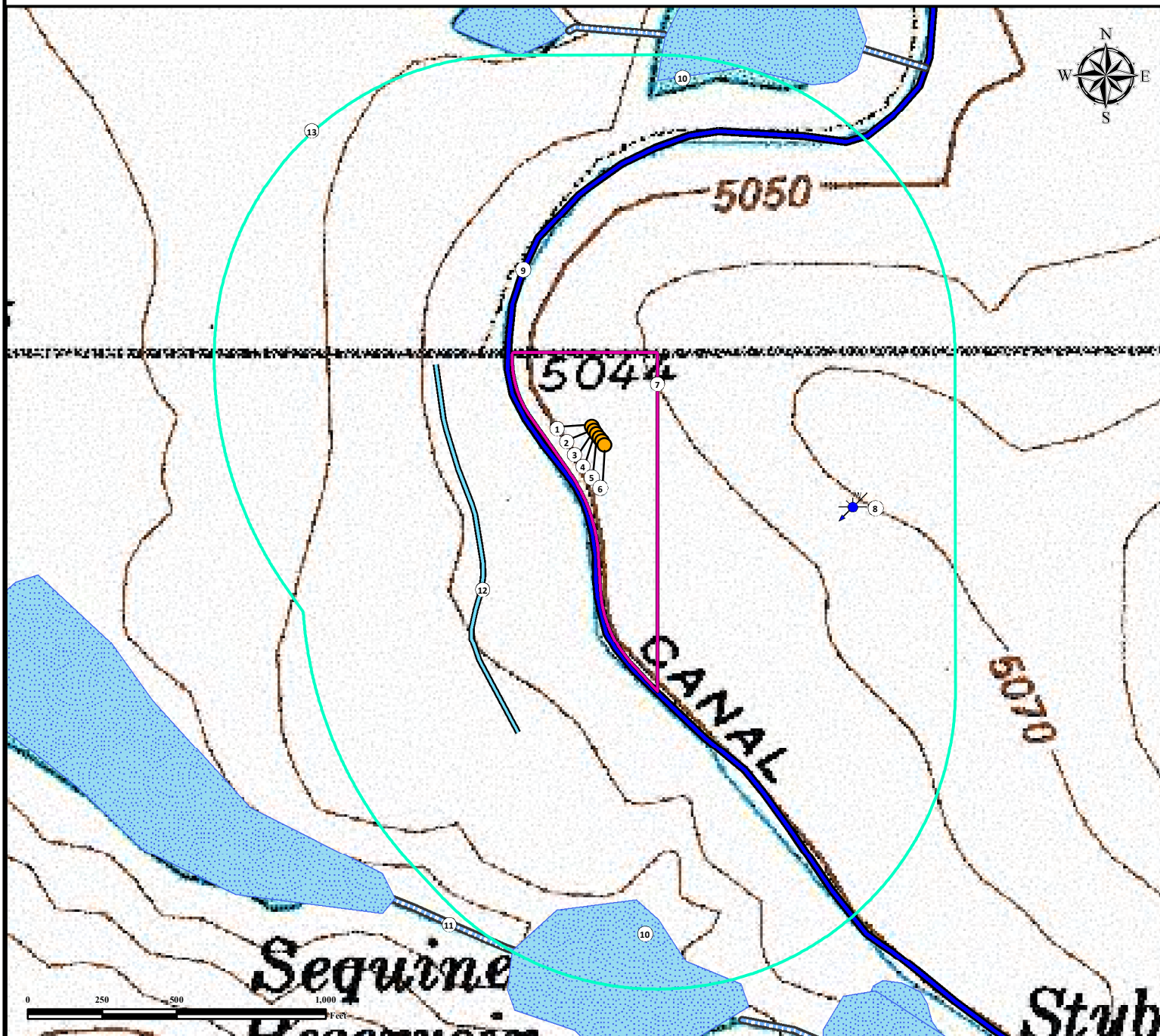

1. Proposed Well LONG 22-15-6NCH.
2. Proposed Well LONG 22-15-5CH.
3. Proposed Well LONG 22-15-4NBH.
4. Proposed Well LONG 22-15-3NCH.
5. Proposed Well LONG 22-15-2NBH.
6. Proposed Well LONG 22-15-1CH.
7. Operational Disturbance Area.

8. Water Well (Permit #245545) is  $\pm 890'$  SE.
9. Canal is  $\pm 163'$  SW.
10. Ponds are  $\pm 1206'$  NE and  $\pm 1566'$  S.
11. Stream is  $\pm 1753'$  SW.
12. Ditch is  $\pm 476'$  W.
13. 1000' Radius.

## Legend

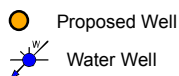

Proposed Well



Water Well



Disturbance Area



1000' Radius



Pond



Canal



Stream



Ditch

## Reference Location

\*\* LONG 22-15-4NBH \*\*

Lat: 40.043384° Long: -104.650857° (NAD83)  
Elevation: 5052 Feet



FIELD DATE:

12-09-14

DRAWING DATE:

02-03-15

BY:

DRF

CHECKED BY:

CSG

SITE NAME:

LONG 22-B PAD

SURFACE LOCATION:

NE1/4 NW 1/4, SEC. 22, T1N, R65W, 6TH P.M.

WELD COUNTY, COLORADO

PREPARED FOR:

**Edge Energy**