

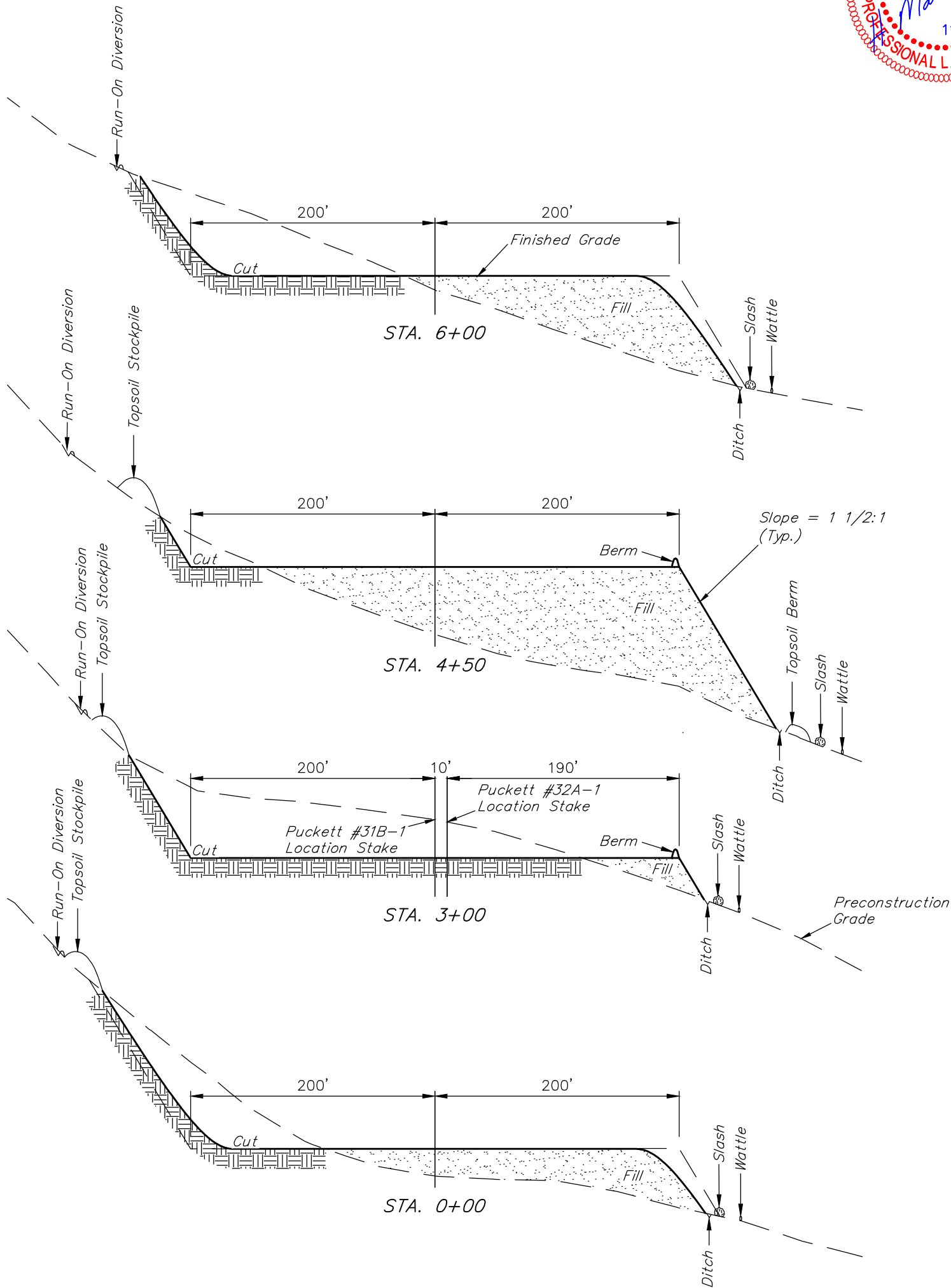

1" = 40'  
X-Section  
Scale  
1" = 100'

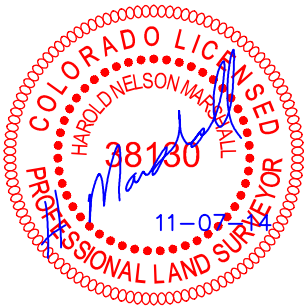

APPROXIMATE EARTHWORK QUANTITIES	
(6") TOPSOIL STRIPPING	6,050 Cu. Yds.
REMAINING LOCATION	79,470 Cu. Yds.
TOTAL CUT	85,520 Cu. Yds.
FILL	79,470 Cu. Yds.
EXCESS MATERIAL	6,050 Cu. Yds.
TOPSOIL	6,050 Cu. Yds.
EXCESS UNBALANCE (After Interim Rehabilitation)	0 Cu. Yds.

APPROXIMATE SURFACE DISTURBANCE AREAS		
	DISTANCE	ACRES
WELL SITE DISTURBANCE	NA	±9.738
30' WIDE ACCESS ROAD R-O-W DISTURBANCE	±530'	±0.365
TOTAL SURFACE USE AREA		±10.103

- NOTES:
- Fill quantity includes 5% for compaction.
  - Calculations based on 6" of topsoil stripping.
  - Topsoil should not be stripped below finished grade on substructure area.

Caerus Oil & Gas LLC

MESA E1-797  
TRACT 63, SECTION 1, T7S, R97W, 6th P.M.  
S 1/2 NW 1/4



UELS, LLC  
Corporate Office \* 85 South 200 East  
Vernal, UT 84078 \* (435) 789-1017

DRAWN BY: A.R.	DATE DRAWN: 09-18-14
SCALE: AS SHOWN	REVISED: 11-03-14
CONSTRUCTION LAYOUT CROSS SECTIONS	FIGURE #2