

# **BONANZA CREEK ENERGY INC.**

**WELD COUNTY, COLORADO (NAD 83)**

**SE SE SEC.32 T5N R61W 6th P.M.**

**STATE PRONGHORN X44-32-31MRLNC**

**ORIGINAL WELLBORE**

**18 December, 2014**

**Plan: PROPOSAL #1**





Project: WELD COUNTY, COLORADO (NAD 83)  
Site: SE SE SEC.32 T5N R61W 6th P.M.  
Well: STATE PRONGHORN X44-32-31MRLNC  
Wellbore: ORIGINAL WELLBORE  
Design: PROPOSAL #1

ANNOTATIONS									
TVD	MD	Inc	Azi	+N/-S	+E/-W	VSect	Dep	Annotation	
900.0	900.0	0.00	0.00	0.0	0.0	0.0	0.0	START NUDGE (2°/100ft BUR)	
1812.2	1828.4	18.57	61.75	70.6	131.4	-122.5	149.1	EOB TO 18.57° INC	
4702.6	4877.5	18.57	61.75	530.0	986.6	-920.1	1120.0	END OF TANGENT	
5614.8	5805.8	0.00	0.00	600.6	1118.0	-1042.6	1269.1	EOD TO VERTICAL	
5644.8	5835.8	0.00	0.00	600.6	1118.0	-1042.6	1269.1	KOP (12°/100ft BUR)	
6106.0	6460.8	75.00	269.67	598.6	764.1	-691.2	1623.0	START OF TANGENT	
6131.9	6560.8	75.00	269.67	598.0	667.5	-595.3	1719.6	END OF TANGENT	
6148.1	6685.8	90.00	269.67	597.3	544.0	-472.6	1843.2	7" ICP *NEW* - STATE PRONGHORN X44-32-31MRLNC	
6148.1	12177.1	90.00	269.66	565.2	-4947.2	4979.4	7334.4	BHL - STATE PRONGHORN X44-32-31MRLNC	

WELLBORE TARGET DETAILS (LAT/LONG)					
Name	TVD	+N/-S	+E/-W	Latitude	Longitude
KOP - STATE PRONGHORN X44-32-31MRLNC	5644.8	600.6	1118.0	40.352699	-104.223419
BHL - STATE PRONGHORN X44-32-31MRLNC	6148.1	565.2	-4947.2	40.352600	-104.245180
7" ICP *NEW* - STATE PRONGHORN X44-32-31MRLNC	6148.1	597.3	544.0	40.352689	-104.225478

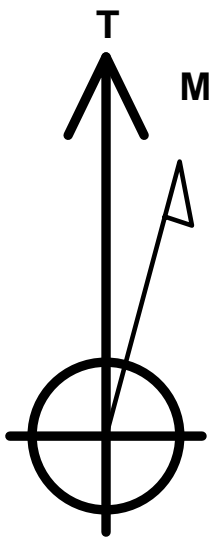
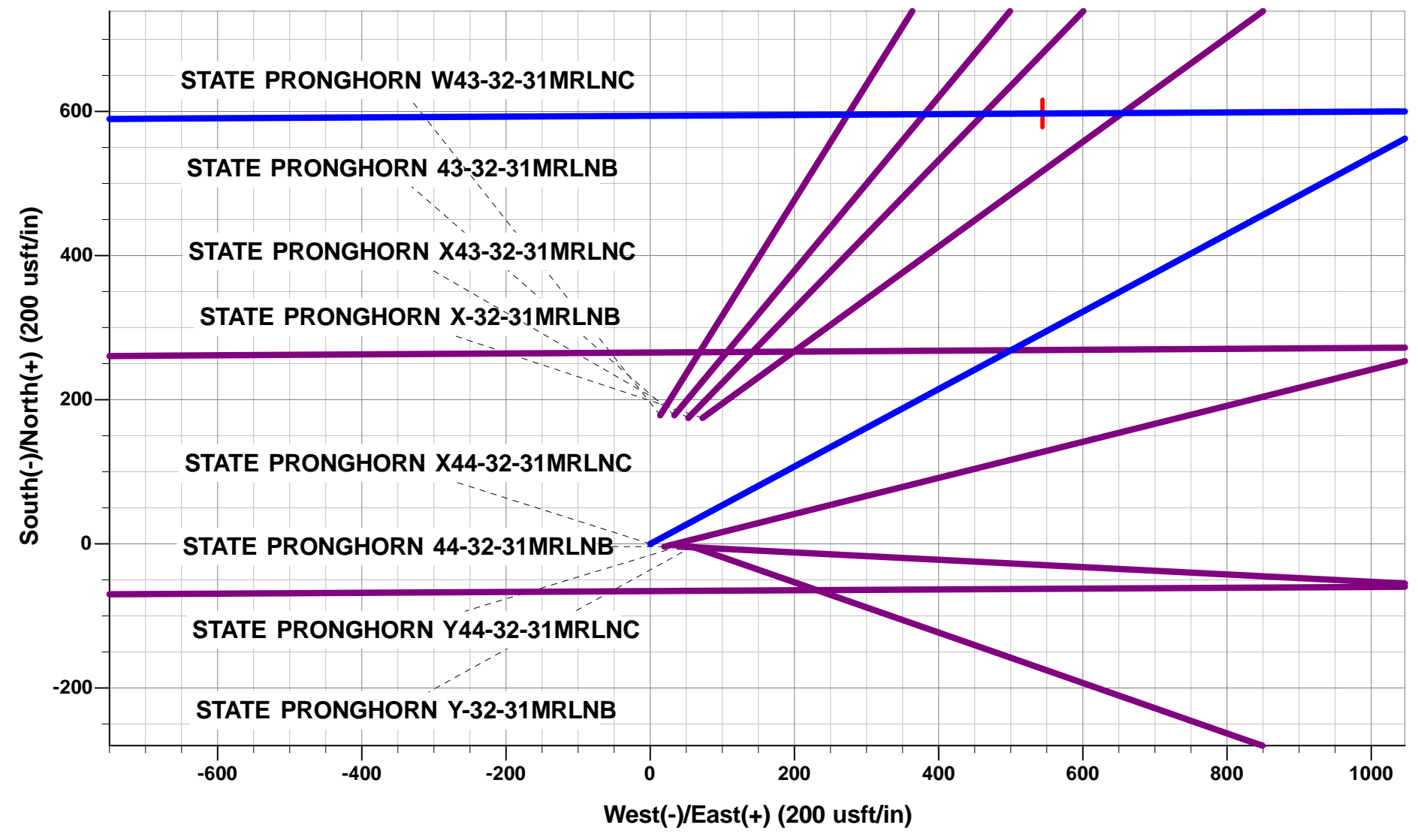

Azimuths to True North  
Magnetic North: 8.10°  
  
Magnetic Field  
Strength: 52793.3snT  
Dip Angle: 66.97°  
Date: 18/12/2014  
Model: IGRF2010

PROPOSED LOCAL COORDINATES  
  
SHL: 393ft FSL & 1143ft FWL of Sec 32  
  
7" ICP \*NEW\*: 990ft FSL & 589ft FWL of Sec 32  
  
BHL: 990ft FSL & 860ft FEL of Sec 31

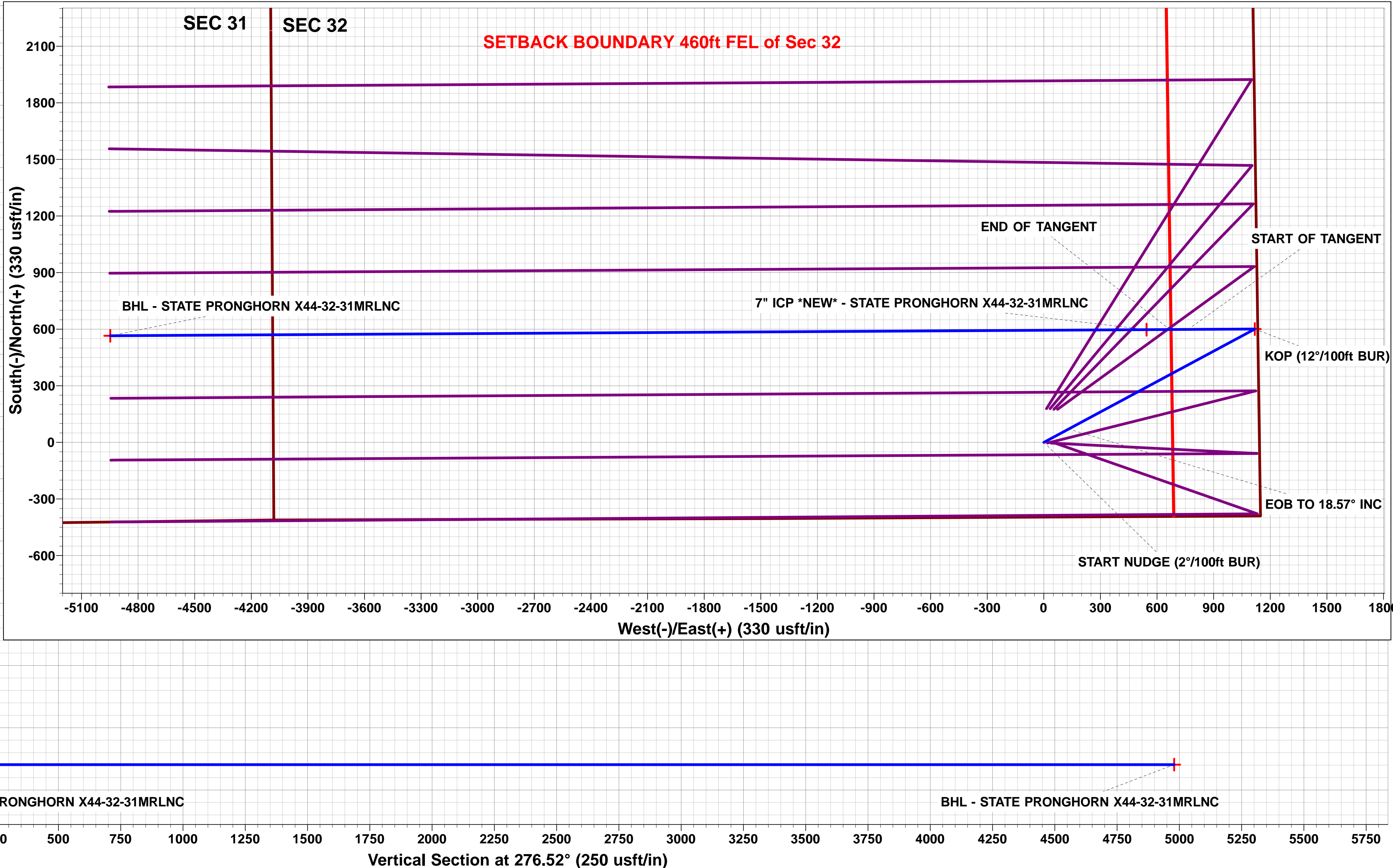
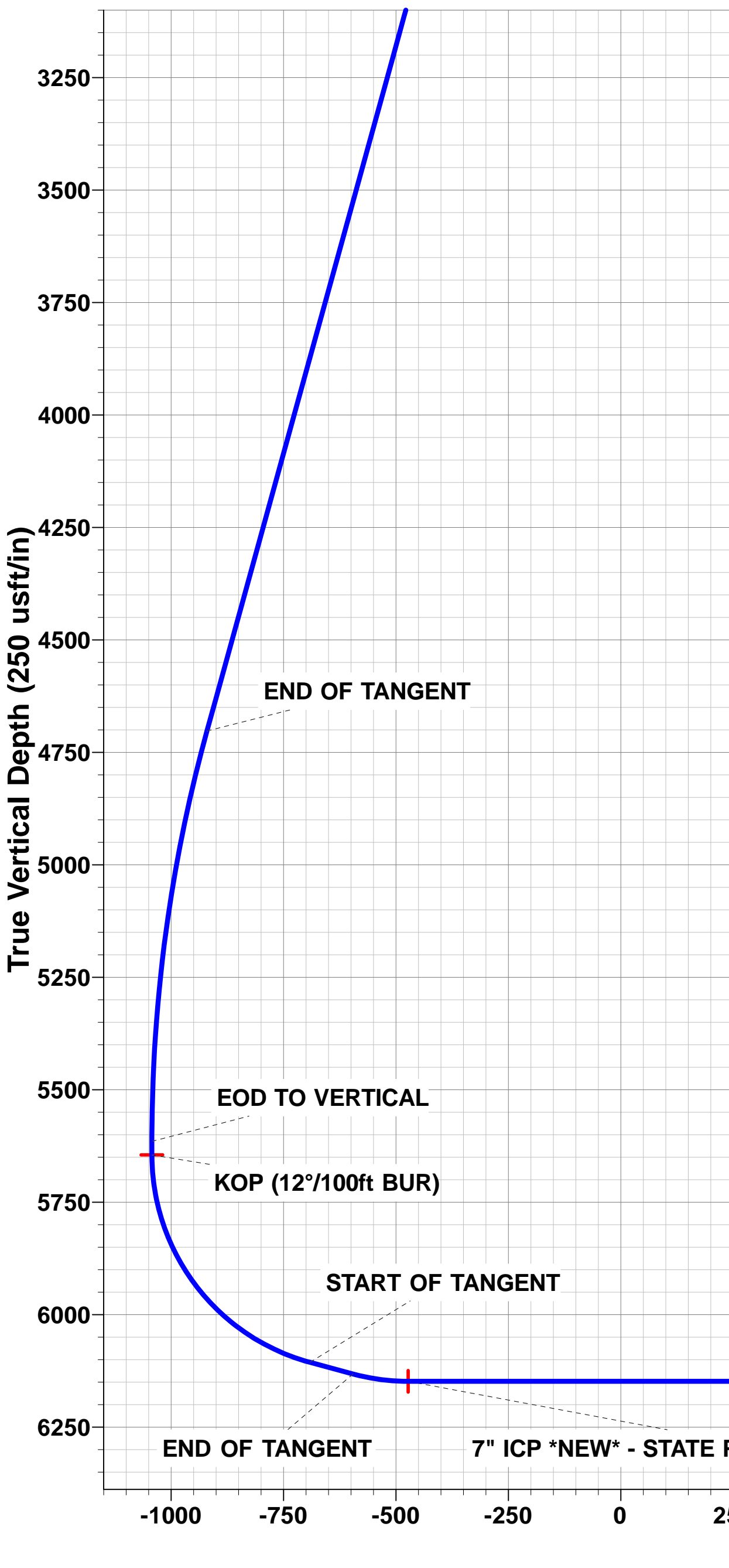
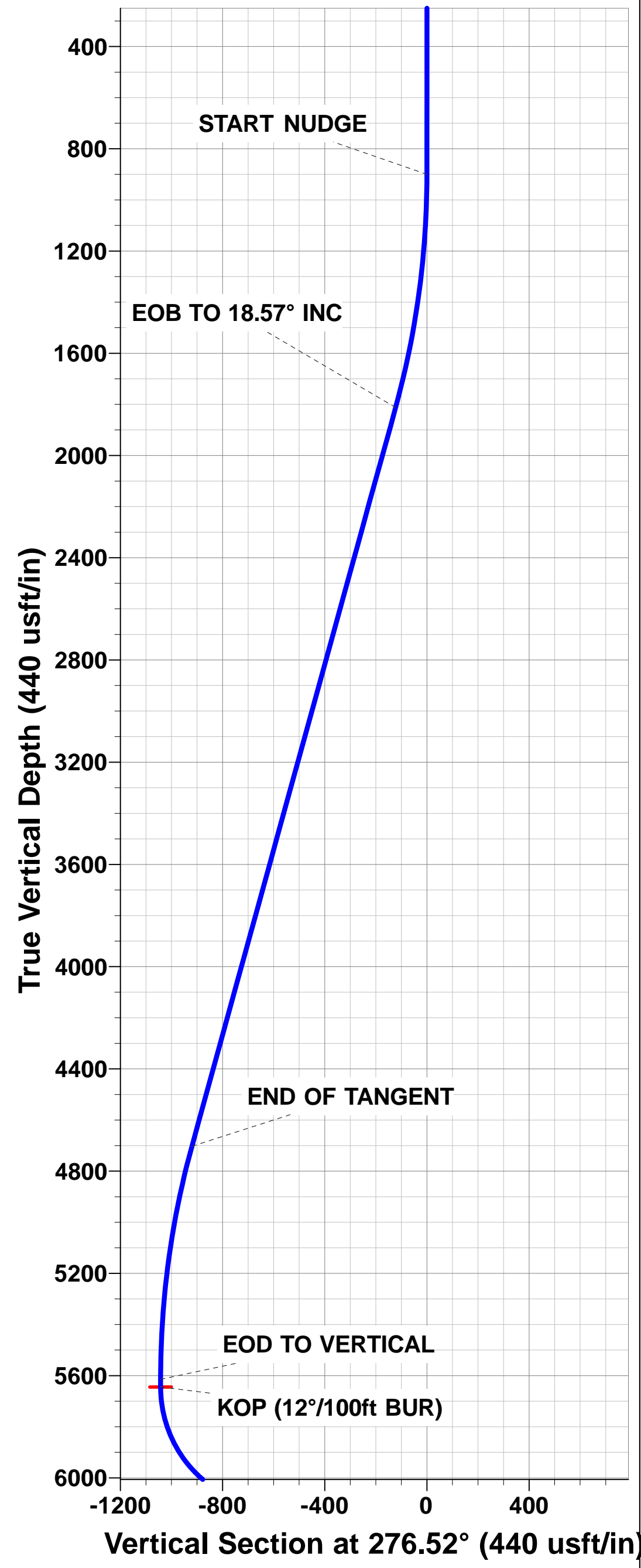

# Planning Report



<b>Database:</b>	EDM 5000.1 Single User Db	<b>Local Co-ordinate Reference:</b>	Well STATE PRONGHORN X44-32-31MRLNC
<b>Company:</b>	BONANZA CREEK ENERGY INC.	<b>TVD Reference:</b>	KB-EST @ 4548.1usft (Original Well Elev)
<b>Project:</b>	WELD COUNTY, COLORADO (NAD 83)	<b>MD Reference:</b>	KB-EST @ 4548.1usft (Original Well Elev)
<b>Site:</b>	SE SE SEC.32 T5N R61W 6th P.M.	<b>North Reference:</b>	True
<b>Well:</b>	STATE PRONGHORN X44-32-31MRLNC	<b>Survey Calculation Method:</b>	Minimum Curvature
<b>Wellbore:</b>	ORIGINAL WELLBORE		
<b>Design:</b>	PROPOSAL #1		

<b>Project</b>	WELD COUNTY, COLORADO (NAD 83)		
<b>Map System:</b>	US State Plane 1983	<b>System Datum:</b>	Mean Sea Level
<b>Geo Datum:</b>	North American Datum 1983		
<b>Map Zone:</b>	Colorado Northern Zone		Using geodetic scale factor

<b>Site</b>	SE SE SEC.32 T5N R61W 6th P.M.		
<b>Site Position:</b>		<b>Northing:</b>	1,373,448.99 usft
<b>From:</b>	Lat/Long	<b>Easting:</b>	3,354,737.61 usft
<b>Position Uncertainty:</b>	0.0 usft	<b>Slot Radius:</b>	1.10000ft
		<b>Latitude:</b>	40.351530
		<b>Longitude:</b>	-104.227170
		<b>Grid Convergence:</b>	0.82 °

<b>Well</b>	STATE PRONGHORN X44-32-31MRLNC		
<b>Well Position</b>	<b>+N/-S</b>	-174.9 usft	<b>Northing:</b>
	<b>+E/-W</b>	-72.5 usft	<b>Easting:</b>
<b>Position Uncertainty</b>		0.0 usft	<b>Wellhead Elevation:</b>
			usft
			<b>Latitude:</b>
			<b>Longitude:</b>
			<b>Ground Level:</b>

<b>Wellbore</b>	ORIGINAL WELLBORE				
<b>Magnetics</b>	<b>Model Name</b>	<b>Sample Date</b>	<b>Declination (°)</b>	<b>Dip Angle (°)</b>	<b>Field Strength (nT)</b>
	IGRF2010	18/12/2014	8.09	66.97	52,793

<b>Design</b>	PROPOSAL #1				
<b>Audit Notes:</b>					
<b>Version:</b>	<b>Phase:</b>	PROTOTYPE	<b>Tie On Depth:</b>	0.0	
<b>Vertical Section:</b>	<b>Depth From (TVD) (usft)</b>	<b>+N/-S (usft)</b>	<b>+E/-W (usft)</b>	<b>Direction (°)</b>	
	6,148.1	0.0	0.0	276.52	

<b>Plan Sections</b>											
MD (usft)	Inc (°)	Azi (°)	Vertical Depth	SS (usft)	+N/-S (usft)	+E/-W (usft)	Dogleg Rate (°/100usf)	Build Rate (°/100usf)	Turn Rate (°/100usf)	TFO (°)	Target
0.0	0.00	0.00	0.0	-4,548.1	0.0	0.0	0.00	0.00	0.00	0.00	
900.0	0.00	0.00	900.0	-3,648.1	0.0	0.0	0.00	0.00	0.00	0.00	
1,828.4	18.57	61.75	1,812.2	-2,735.9	70.6	131.4	2.00	2.00	0.00	61.75	
4,877.5	18.57	61.75	4,702.6	154.5	530.0	986.6	0.00	0.00	0.00	0.00	
5,805.8	0.00	0.00	5,614.8	1,066.7	600.6	1,118.0	2.00	-2.00	0.00	180.00	
5,835.8	0.00	0.00	5,644.8	1,096.7	600.6	1,118.0	0.00	0.00	0.00	0.00	KOP - STATE PRO
6,460.8	75.00	269.67	6,106.0	1,557.9	598.6	764.1	12.00	12.00	0.00	269.67	
6,560.8	75.00	269.67	6,131.9	1,583.8	598.0	667.5	0.00	0.00	0.00	0.00	
6,685.8	90.00	269.67	6,148.1	1,600.0	597.3	544.0	12.00	12.00	0.00	0.00	
12,177.1	90.00	269.66	6,148.1	1,600.0	565.2	-4,947.2	0.00	0.00	0.00	-84.50	BHL - STATE PROI

# Planning Report



<b>Database:</b>	EDM 5000.1 Single User Db	<b>Local Co-ordinate Reference:</b>	Well STATE PRONGHORN X44-32-31MRLNC
<b>Company:</b>	BONANZA CREEK ENERGY INC.	<b>TVD Reference:</b>	KB-EST @ 4548.1usft (Original Well Elev)
<b>Project:</b>	WELD COUNTY, COLORADO (NAD 83)	<b>MD Reference:</b>	KB-EST @ 4548.1usft (Original Well Elev)
<b>Site:</b>	SE SE SEC.32 T5N R61W 6th P.M.	<b>North Reference:</b>	True
<b>Well:</b>	STATE PRONGHORN X44-32-31MRLNC	<b>Survey Calculation Method:</b>	Minimum Curvature
<b>Wellbore:</b>	ORIGINAL WELLBORE		
<b>Design:</b>	PROPOSAL #1		

Planned Survey										
MD (usft)	Inc (°)	Azi (°)	TVD (usft)	SS (usft)	+N/-S (usft)	+E/-W (usft)	Vertical Section (usft)	Dogleg Rate (°/100usft)	Build Rate (°/100usft)	Turn Rate (°/100usft)
0.0	0.00	0.00	0.0	4,548.10	0.0	0.0	0.0	0.00	0.00	0.00
100.0	0.00	0.00	100.0	4,448.10	0.0	0.0	0.0	0.00	0.00	0.00
200.0	0.00	0.00	200.0	4,348.10	0.0	0.0	0.0	0.00	0.00	0.00
300.0	0.00	0.00	300.0	4,248.10	0.0	0.0	0.0	0.00	0.00	0.00
400.0	0.00	0.00	400.0	4,148.10	0.0	0.0	0.0	0.00	0.00	0.00
500.0	0.00	0.00	500.0	4,048.10	0.0	0.0	0.0	0.00	0.00	0.00
600.0	0.00	0.00	600.0	3,948.10	0.0	0.0	0.0	0.00	0.00	0.00
700.0	0.00	0.00	700.0	3,848.10	0.0	0.0	0.0	0.00	0.00	0.00
800.0	0.00	0.00	800.0	3,748.10	0.0	0.0	0.0	0.00	0.00	0.00
START NUDGE (2°/100ft BUR)										
900.0	0.00	0.00	900.0	3,648.10	0.0	0.0	0.0	0.00	0.00	0.00
1,000.0	2.00	61.75	1,000.0	3,548.12	0.8	1.5	-1.4	2.00	2.00	0.00
1,100.0	4.00	61.75	1,099.8	3,448.26	3.3	6.1	-5.7	2.00	2.00	0.00
1,200.0	6.00	61.75	1,199.5	3,348.65	7.4	13.8	-12.9	2.00	2.00	0.00
1,300.0	8.00	61.75	1,298.7	3,249.40	13.2	24.6	-22.9	2.00	2.00	0.00
1,400.0	10.00	61.75	1,397.5	3,150.63	20.6	38.3	-35.8	2.00	2.00	0.00
1,500.0	12.00	61.75	1,495.6	3,052.48	29.6	55.1	-51.4	2.00	2.00	0.00
1,600.0	14.00	61.75	1,593.1	2,955.04	40.3	75.0	-69.9	2.00	2.00	0.00
1,700.0	16.00	61.75	1,689.6	2,858.46	52.5	97.8	-91.2	2.00	2.00	0.00
1,800.0	18.00	61.75	1,785.3	2,762.83	66.4	123.5	-115.2	2.00	2.00	0.00
EOB TO 18.57° INC										
1,828.4	18.57	61.75	1,812.2	2,735.90	70.6	131.4	-122.5	2.00	2.00	0.00
1,900.0	18.57	61.75	1,880.1	2,667.99	81.4	151.5	-141.2	0.00	0.00	0.00
2,000.0	18.57	61.75	1,974.9	2,573.20	96.4	179.5	-167.4	0.00	0.00	0.00
2,100.0	18.57	61.75	2,069.7	2,478.40	111.5	207.6	-193.6	0.00	0.00	0.00
2,200.0	18.57	61.75	2,164.5	2,383.61	126.6	235.6	-219.7	0.00	0.00	0.00
2,300.0	18.57	61.75	2,259.3	2,288.81	141.6	263.7	-245.9	0.00	0.00	0.00
2,400.0	18.57	61.75	2,354.1	2,194.02	156.7	291.7	-272.0	0.00	0.00	0.00
2,500.0	18.57	61.75	2,448.9	2,099.22	171.8	319.8	-298.2	0.00	0.00	0.00
2,600.0	18.57	61.75	2,543.7	2,004.43	186.8	347.8	-324.3	0.00	0.00	0.00
2,700.0	18.57	61.75	2,638.5	1,909.63	201.9	375.9	-350.5	0.00	0.00	0.00
2,800.0	18.57	61.75	2,733.3	1,814.84	217.0	403.9	-376.7	0.00	0.00	0.00
2,900.0	18.57	61.75	2,828.1	1,720.04	232.1	432.0	-402.8	0.00	0.00	0.00
3,000.0	18.57	61.75	2,922.9	1,625.25	247.1	460.0	-429.0	0.00	0.00	0.00
3,100.0	18.57	61.75	3,017.6	1,530.45	262.2	488.1	-455.1	0.00	0.00	0.00
3,200.0	18.57	61.75	3,112.4	1,435.66	277.3	516.1	-481.3	0.00	0.00	0.00
3,300.0	18.57	61.75	3,207.2	1,340.86	292.3	544.2	-507.5	0.00	0.00	0.00
3,400.0	18.57	61.75	3,302.0	1,246.07	307.4	572.2	-533.6	0.00	0.00	0.00
3,500.0	18.57	61.75	3,396.8	1,151.27	322.5	600.3	-559.8	0.00	0.00	0.00
3,600.0	18.57	61.75	3,491.6	1,056.48	337.5	628.3	-585.9	0.00	0.00	0.00
3,700.0	18.57	61.75	3,586.4	961.68	352.6	656.4	-612.1	0.00	0.00	0.00
3,800.0	18.57	61.75	3,681.2	866.89	367.7	684.4	-638.3	0.00	0.00	0.00
3,900.0	18.57	61.75	3,776.0	772.09	382.7	712.5	-664.4	0.00	0.00	0.00
4,000.0	18.57	61.75	3,870.8	677.30	397.8	740.5	-690.6	0.00	0.00	0.00
4,100.0	18.57	61.75	3,965.6	582.50	412.9	768.6	-716.7	0.00	0.00	0.00
4,200.0	18.57	61.75	4,060.4	487.71	427.9	796.6	-742.9	0.00	0.00	0.00
4,300.0	18.57	61.75	4,155.2	392.91	443.0	824.7	-769.0	0.00	0.00	0.00
4,400.0	18.57	61.75	4,250.0	298.12	458.1	852.7	-795.2	0.00	0.00	0.00
4,500.0	18.57	61.75	4,344.8	203.32	473.2	880.8	-821.4	0.00	0.00	0.00
4,600.0	18.57	61.75	4,439.6	108.53	488.2	908.8	-847.5	0.00	0.00	0.00
4,700.0	18.57	61.75	4,534.4	13.73	503.3	936.9	-873.7	0.00	0.00	0.00
4,800.0	18.57	61.75	4,629.2	-81.06	518.4	964.9	-899.8	0.00	0.00	0.00

# Planning Report



<b>Database:</b>	EDM 5000.1 Single User Db	<b>Local Co-ordinate Reference:</b>	Well STATE PRONGHORN X44-32-31MRLNC
<b>Company:</b>	BONANZA CREEK ENERGY INC.	<b>TVD Reference:</b>	KB-EST @ 4548.1usft (Original Well Elev)
<b>Project:</b>	WELD COUNTY, COLORADO (NAD 83)	<b>MD Reference:</b>	KB-EST @ 4548.1usft (Original Well Elev)
<b>Site:</b>	SE SE SEC.32 T5N R61W 6th P.M.	<b>North Reference:</b>	True
<b>Well:</b>	STATE PRONGHORN X44-32-31MRLNC	<b>Survey Calculation Method:</b>	Minimum Curvature
<b>Wellbore:</b>	ORIGINAL WELLBORE		
<b>Design:</b>	PROPOSAL #1		

## Planned Survey

MD (usft)	Inc (°)	Azi (°)	TVD (usft)	SS (usft)	+N/-S (usft)	+E/-W (usft)	Vertical Section (usft)	Dogleg Rate (°/100usft)	Build Rate (°/100usft)	Turn Rate (°/100usft)
<b>END OF TANGENT</b>										
4,877.5	18.57	61.75	4,702.6	-154.50	530.0	986.6	-920.1	0.00	0.00	0.00
4,900.0	18.12	61.75	4,724.0	-175.89	533.4	992.9	-925.9	2.00	-2.00	0.00
5,000.0	16.12	61.75	4,819.6	-271.45	547.3	1,018.8	-950.1	2.00	-2.00	0.00
5,100.0	14.12	61.75	4,916.1	-367.99	559.7	1,041.8	-971.5	2.00	-2.00	0.00
5,200.0	12.12	61.75	5,013.5	-465.37	570.4	1,061.8	-990.2	2.00	-2.00	0.00
5,300.0	10.12	61.75	5,111.6	-563.49	579.5	1,078.8	-1,006.0	2.00	-2.00	0.00
5,400.0	8.12	61.75	5,210.3	-662.22	587.0	1,092.7	-1,019.0	2.00	-2.00	0.00
5,500.0	6.12	61.75	5,309.5	-761.45	592.9	1,103.6	-1,029.2	2.00	-2.00	0.00
5,600.0	4.12	61.75	5,409.1	-861.05	597.1	1,111.5	-1,036.5	2.00	-2.00	0.00
5,700.0	2.12	61.75	5,509.0	-960.89	599.7	1,116.3	-1,041.0	2.00	-2.00	0.00
5,800.0	0.12	61.75	5,609.0	-1,060.87	600.6	1,118.0	-1,042.6	2.00	-2.00	0.00
<b>EOD TO VERTICAL</b>										
5,805.8	0.00	0.00	5,614.8	-1,066.70	600.6	1,118.0	-1,042.6	2.00	-2.00	0.00
<b>KOP (12°/100ft BUR)</b>										
5,835.8	0.00	0.00	5,644.8	-1,096.70	600.6	1,118.0	-1,042.6	0.00	0.00	0.00
5,900.0	7.70	269.67	5,708.8	-1,160.68	600.6	1,113.7	-1,038.3	12.00	12.00	0.00
6,000.0	19.70	269.67	5,805.8	-1,257.65	600.4	1,090.1	-1,014.9	12.00	12.00	0.00
6,100.0	31.70	269.67	5,895.7	-1,347.60	600.2	1,046.8	-971.9	12.00	12.00	0.00
6,200.0	43.70	269.67	5,974.7	-1,426.57	599.8	985.7	-911.3	12.00	12.00	0.00
6,300.0	55.70	269.67	6,039.2	-1,491.13	599.4	909.6	-835.7	12.00	12.00	0.00
6,400.0	67.70	269.67	6,086.6	-1,538.46	598.9	821.7	-748.4	12.00	12.00	0.00
<b>START OF TANGENT</b>										
6,460.8	75.00	269.67	6,106.0	-1,557.90	598.6	764.1	-691.2	12.00	12.00	0.00
6,500.0	75.00	269.67	6,116.1	-1,568.03	598.3	726.3	-653.7	0.00	0.00	0.00
<b>END OF TANGENT</b>										
6,560.8	75.00	269.67	6,131.9	-1,583.78	598.0	667.5	-595.3	0.00	0.00	0.00
6,600.0	79.70	269.67	6,140.5	-1,592.35	597.8	629.3	-557.4	12.00	12.00	0.00
<b>7" ICP *NEW* - STATE PRONGHORN X44-32-31MRLNC</b>										
6,685.8	90.00	269.67	6,148.1	-1,600.05	597.3	544.0	-472.6	12.00	12.00	0.00
6,700.0	90.00	269.67	6,148.1	-1,600.05	597.2	529.8	-458.6	0.00	0.00	0.00
6,800.0	90.00	269.67	6,148.1	-1,600.05	596.6	429.8	-359.3	0.00	0.00	0.00
6,900.0	90.00	269.67	6,148.1	-1,600.05	596.1	329.8	-260.0	0.00	0.00	0.00
7,000.0	90.00	269.67	6,148.1	-1,600.05	595.5	229.8	-160.7	0.00	0.00	0.00
7,100.0	90.00	269.67	6,148.1	-1,600.05	594.9	129.8	-61.4	0.00	0.00	0.00
7,200.0	90.00	269.67	6,148.1	-1,600.05	594.3	29.8	37.9	0.00	0.00	0.00
7,300.0	90.00	269.67	6,148.1	-1,600.05	593.8	-70.2	137.1	0.00	0.00	0.00
7,400.0	90.00	269.67	6,148.1	-1,600.05	593.2	-170.2	236.4	0.00	0.00	0.00
7,500.0	90.00	269.67	6,148.1	-1,600.05	592.6	-270.2	335.7	0.00	0.00	0.00
7,600.0	90.00	269.67	6,148.1	-1,600.05	592.0	-370.2	435.0	0.00	0.00	0.00
7,700.0	90.00	269.67	6,148.1	-1,600.05	591.4	-470.2	534.3	0.00	0.00	0.00
7,800.0	90.00	269.67	6,148.1	-1,600.04	590.9	-570.2	633.6	0.00	0.00	0.00
7,900.0	90.00	269.67	6,148.1	-1,600.04	590.3	-670.2	732.9	0.00	0.00	0.00
8,000.0	90.00	269.67	6,148.1	-1,600.04	589.7	-770.2	832.1	0.00	0.00	0.00
8,100.0	90.00	269.67	6,148.1	-1,600.04	589.1	-870.2	931.4	0.00	0.00	0.00
8,200.0	90.00	269.67	6,148.1	-1,600.04	588.5	-970.2	1,030.7	0.00	0.00	0.00
8,300.0	90.00	269.67	6,148.1	-1,600.04	588.0	-1,070.2	1,130.0	0.00	0.00	0.00
8,400.0	90.00	269.67	6,148.1	-1,600.04	587.4	-1,170.2	1,229.3	0.00	0.00	0.00
8,500.0	90.00	269.67	6,148.1	-1,600.04	586.8	-1,270.2	1,328.6	0.00	0.00	0.00
8,600.0	90.00	269.67	6,148.1	-1,600.04	586.2	-1,370.2	1,427.9	0.00	0.00	0.00
8,700.0	90.00	269.67	6,148.1	-1,600.04	585.6	-1,470.2	1,527.2	0.00	0.00	0.00
8,800.0	90.00	269.67	6,148.1	-1,600.04	585.0	-1,570.2	1,626.4	0.00	0.00	0.00



# Planning Report



<b>Database:</b>	EDM 5000.1 Single User Db	<b>Local Co-ordinate Reference:</b>	Well STATE PRONGHORN X44-32-31MRLNC
<b>Company:</b>	BONANZA CREEK ENERGY INC.	<b>TVD Reference:</b>	KB-EST @ 4548.1usft (Original Well Elev)
<b>Project:</b>	WELD COUNTY, COLORADO (NAD 83)	<b>MD Reference:</b>	KB-EST @ 4548.1usft (Original Well Elev)
<b>Site:</b>	SE SE SEC.32 T5N R61W 6th P.M.	<b>North Reference:</b>	True
<b>Well:</b>	STATE PRONGHORN X44-32-31MRLNC	<b>Survey Calculation Method:</b>	Minimum Curvature
<b>Wellbore:</b>	ORIGINAL WELLBORE		
<b>Design:</b>	PROPOSAL #1		

## Planned Survey

MD (usft)	Inc (°)	Azi (°)	TVD (usft)	SS (usft)	+N/-S (usft)	+E/-W (usft)	Vertical Section (usft)	Dogleg Rate (°/100usft)	Build Rate (°/100usft)	Turn Rate (°/100usft)
8,900.0	90.00	269.67	6,148.1	-1,600.04	584.5	-1,670.2	1,725.7	0.00	0.00	0.00
9,000.0	90.00	269.67	6,148.1	-1,600.04	583.9	-1,770.2	1,825.0	0.00	0.00	0.00
9,100.0	90.00	269.67	6,148.1	-1,600.04	583.3	-1,870.2	1,924.3	0.00	0.00	0.00
9,200.0	90.00	269.67	6,148.1	-1,600.04	582.7	-1,970.2	2,023.6	0.00	0.00	0.00
9,300.0	90.00	269.67	6,148.1	-1,600.04	582.1	-2,070.2	2,122.9	0.00	0.00	0.00
9,400.0	90.00	269.66	6,148.1	-1,600.04	581.5	-2,170.2	2,222.2	0.00	0.00	0.00
9,500.0	90.00	269.66	6,148.1	-1,600.03	581.0	-2,270.2	2,321.4	0.00	0.00	0.00
9,600.0	90.00	269.66	6,148.1	-1,600.03	580.4	-2,370.2	2,420.7	0.00	0.00	0.00
9,700.0	90.00	269.66	6,148.1	-1,600.03	579.8	-2,470.2	2,520.0	0.00	0.00	0.00
9,800.0	90.00	269.66	6,148.1	-1,600.03	579.2	-2,570.2	2,619.3	0.00	0.00	0.00
9,900.0	90.00	269.66	6,148.1	-1,600.03	578.6	-2,670.2	2,718.6	0.00	0.00	0.00
10,000.0	90.00	269.66	6,148.1	-1,600.03	578.0	-2,770.2	2,817.9	0.00	0.00	0.00
10,100.0	90.00	269.66	6,148.1	-1,600.03	577.4	-2,870.2	2,917.2	0.00	0.00	0.00
10,200.0	90.00	269.66	6,148.1	-1,600.03	576.9	-2,970.2	3,016.4	0.00	0.00	0.00
10,300.0	90.00	269.66	6,148.1	-1,600.03	576.3	-3,070.2	3,115.7	0.00	0.00	0.00
10,400.0	90.00	269.66	6,148.1	-1,600.03	575.7	-3,170.2	3,215.0	0.00	0.00	0.00
10,500.0	90.00	269.66	6,148.1	-1,600.02	575.1	-3,270.2	3,314.3	0.00	0.00	0.00
10,600.0	90.00	269.66	6,148.1	-1,600.02	574.5	-3,370.1	3,413.6	0.00	0.00	0.00
10,700.0	90.00	269.66	6,148.1	-1,600.02	573.9	-3,470.1	3,512.9	0.00	0.00	0.00
10,800.0	90.00	269.66	6,148.1	-1,600.02	573.3	-3,570.1	3,612.1	0.00	0.00	0.00
10,900.0	90.00	269.66	6,148.1	-1,600.02	572.7	-3,670.1	3,711.4	0.00	0.00	0.00
11,000.0	90.00	269.66	6,148.1	-1,600.02	572.1	-3,770.1	3,810.7	0.00	0.00	0.00
11,100.0	90.00	269.66	6,148.1	-1,600.02	571.6	-3,870.1	3,910.0	0.00	0.00	0.00
11,200.0	90.00	269.66	6,148.1	-1,600.02	571.0	-3,970.1	4,009.3	0.00	0.00	0.00
11,300.0	90.00	269.66	6,148.1	-1,600.01	570.4	-4,070.1	4,108.6	0.00	0.00	0.00
11,400.0	90.00	269.66	6,148.1	-1,600.01	569.8	-4,170.1	4,207.9	0.00	0.00	0.00
11,500.0	90.00	269.66	6,148.1	-1,600.01	569.2	-4,270.1	4,307.1	0.00	0.00	0.00
11,600.0	90.00	269.66	6,148.1	-1,600.01	568.6	-4,370.1	4,406.4	0.00	0.00	0.00
11,700.0	90.00	269.66	6,148.1	-1,600.01	568.0	-4,470.1	4,505.7	0.00	0.00	0.00
11,800.0	90.00	269.66	6,148.1	-1,600.01	567.4	-4,570.1	4,605.0	0.00	0.00	0.00
11,900.0	90.00	269.66	6,148.1	-1,600.00	566.8	-4,670.1	4,704.3	0.00	0.00	0.00
12,000.0	90.00	269.66	6,148.1	-1,600.00	566.2	-4,770.1	4,803.6	0.00	0.00	0.00
12,100.0	90.00	269.66	6,148.1	-1,600.00	565.6	-4,870.1	4,902.9	0.00	0.00	0.00
<b>BHL - STATE PRONGHORN X44-32-31MRLNC</b>										
<b>12,177.1</b>	<b>90.00</b>	<b>269.66</b>	<b>6,148.1</b>	<b>-1,600.00</b>	<b>565.2</b>	<b>-4,947.2</b>	<b>4,979.4</b>	<b>0.00</b>	<b>0.00</b>	<b>0.00</b>

## Plan Annotations

MD (usft)	TVD (usft)	Local Coordinates		Comment
		+N/-S (usft)	+E/-W (usft)	
900.0	900.0	0.0	0.0	START NUDGE (2°/100ft BUR)
1,828.4	1,812.2	70.6	131.4	EOB TO 18.57° INC
4,877.5	4,702.6	530.0	986.6	END OF TANGENT
5,805.8	5,614.8	600.6	1,118.0	EOD TO VERTICAL
5,835.8	5,644.8	600.6	1,118.0	KOP (12°/100ft BUR)
6,460.8	6,106.0	598.6	764.1	START OF TANGENT
6,560.8	6,131.9	598.0	667.5	END OF TANGENT
6,685.8	6,148.1	597.3	544.0	7" ICP *NEW* - STATE PRONGHORN X44-32-31MRLNC
12,177.1	6,148.1	565.2	-4,947.2	BHL - STATE PRONGHORN X44-32-31MRLNC