

Section 1
T. 2 S., R. 98 W.
6th. P.M.

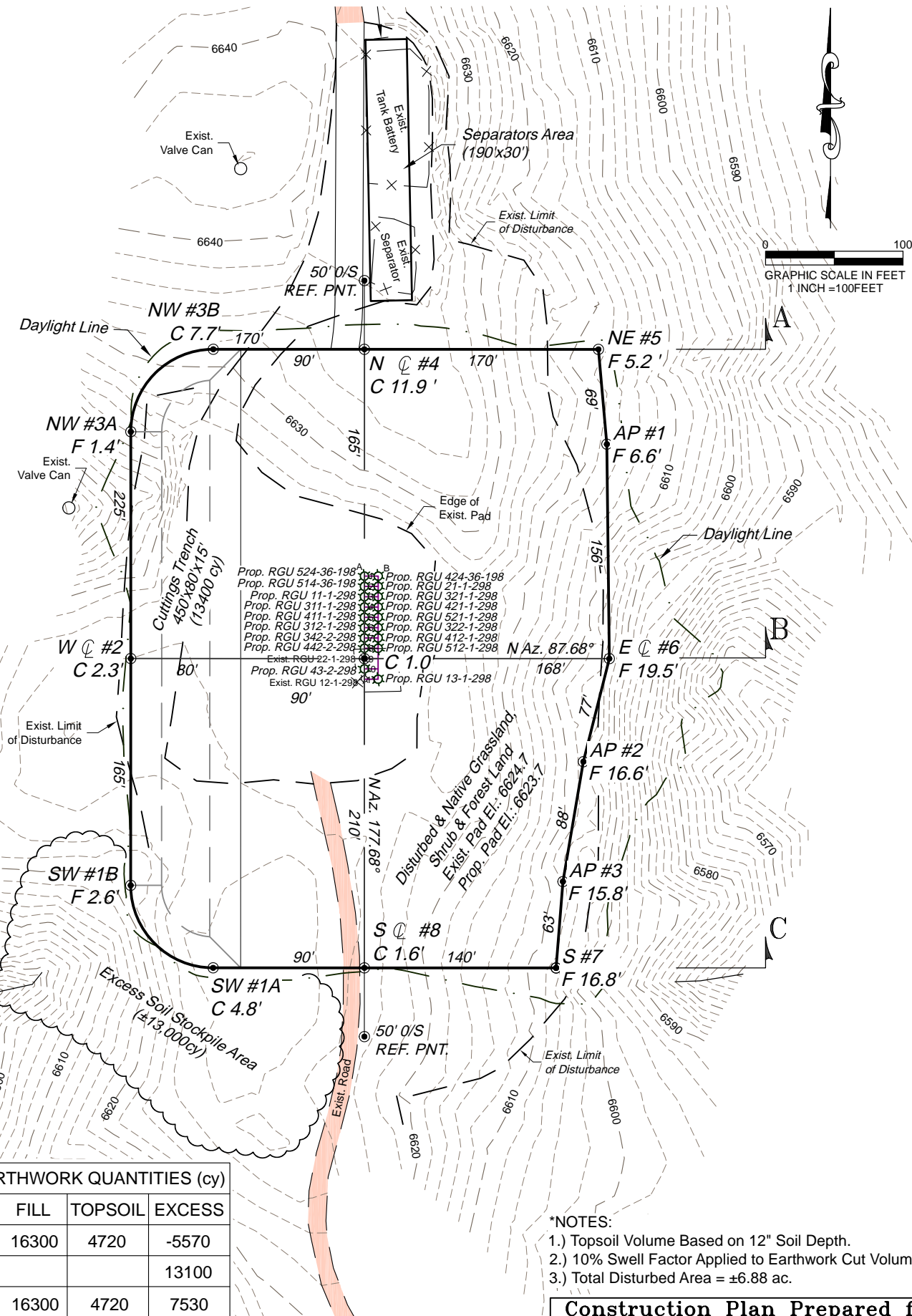

ESTIMATED EARTHWORK QUANTITIES (cy)

ITEM	CUT	FILL	TOPSOIL	EXCESS
PAD	15450	16300	4720	-5570
PIT	13100			13100
TOTALS	28550	16300	4720	7530

- *NOTES:
- 1.) Topsoil Volume Based on 12" Soil Depth.
 - 2.) 10% Swell Factor Applied to Earthwork Cut Volume.
 - 3.) Total Disturbed Area = ±6.88 ac.

136 East Third Street
Rifle, Colorado 81650
Ph. (970) 625-2720
Fax (970) 625-2773

BOOKCLIFF
Survey Services, Inc.

SCALE: 1" = 100'
DATE: 11/6/14
PLAT: 2 of 7
PROJECT: Highlands
DFT: cws

Construction Plan Prepared for:
WPXENERGY WPX Energy Rocky Mountain, LLC

RGU 12-1-298 Drill Pad - Plat 2
CONSTRUCTION LAYOUT

Section 1
T. 2 S., R. 98 W.
6th. P.M.

VOC Unit
(10'x10')

0 100
GRAPHIC SCALE IN FEET
1 INCH = 100 FEET

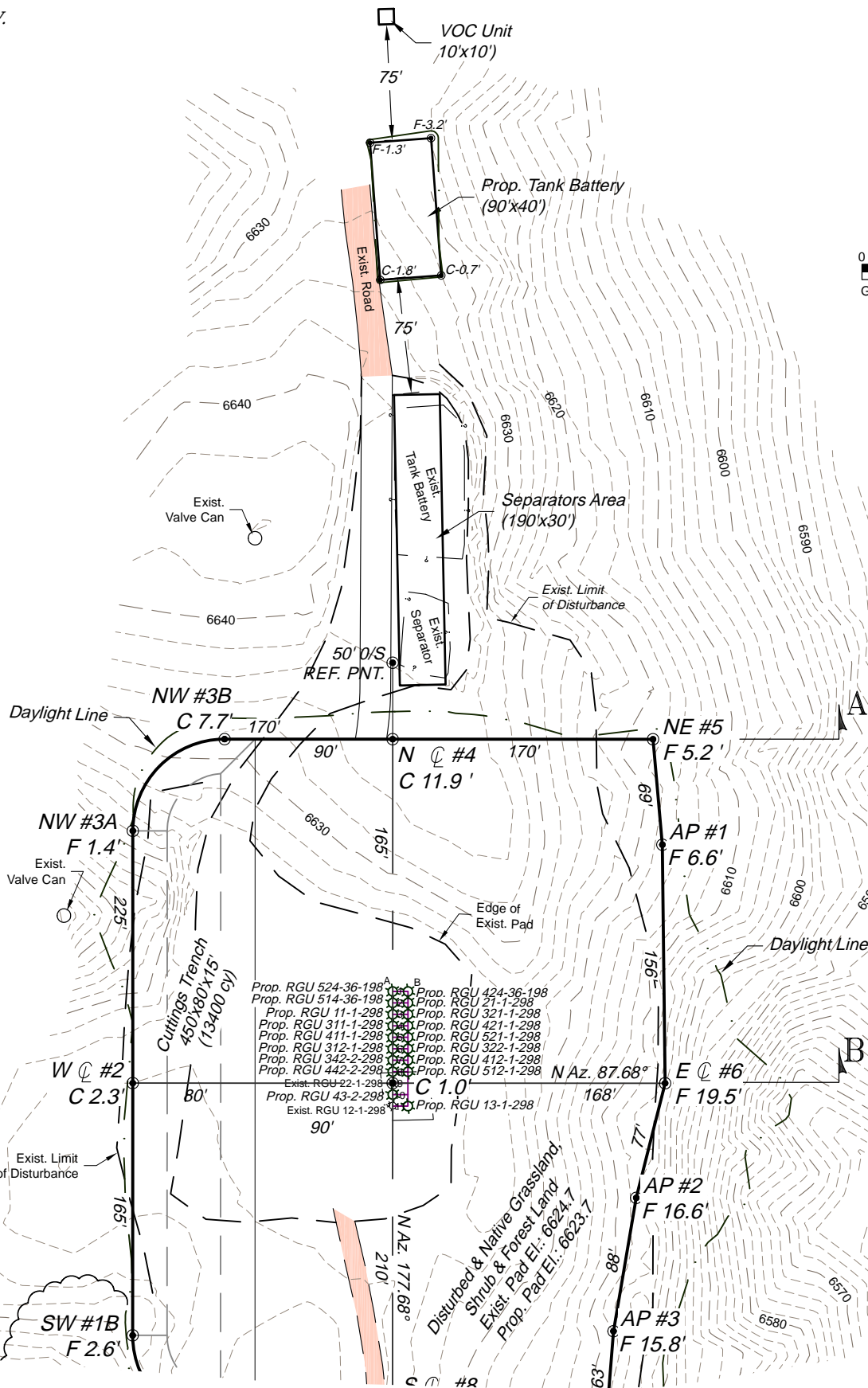

REVISED: 11/25/14

Construction Plan Prepared for:
WPXENERGY

WPX Energy Rocky Mountain, LLC

RGU 12-1-298 Drill Pad - Plat 2A
CONSTRUCTION LAYOUT

136 East Third Street
Rifle, Colorado 81650
Ph. (970) 625-2720
Fax (970) 625-2773



BOOKCLIFF
Survey Services, Inc.

SCALE: 1" = 100'
DATE: 11/6/14
PLAT: 2A of 7
PROJECT: Highlands
DFT: cws