

BRIAN CONRAD 1-C PAD HYDROLOGY MAP

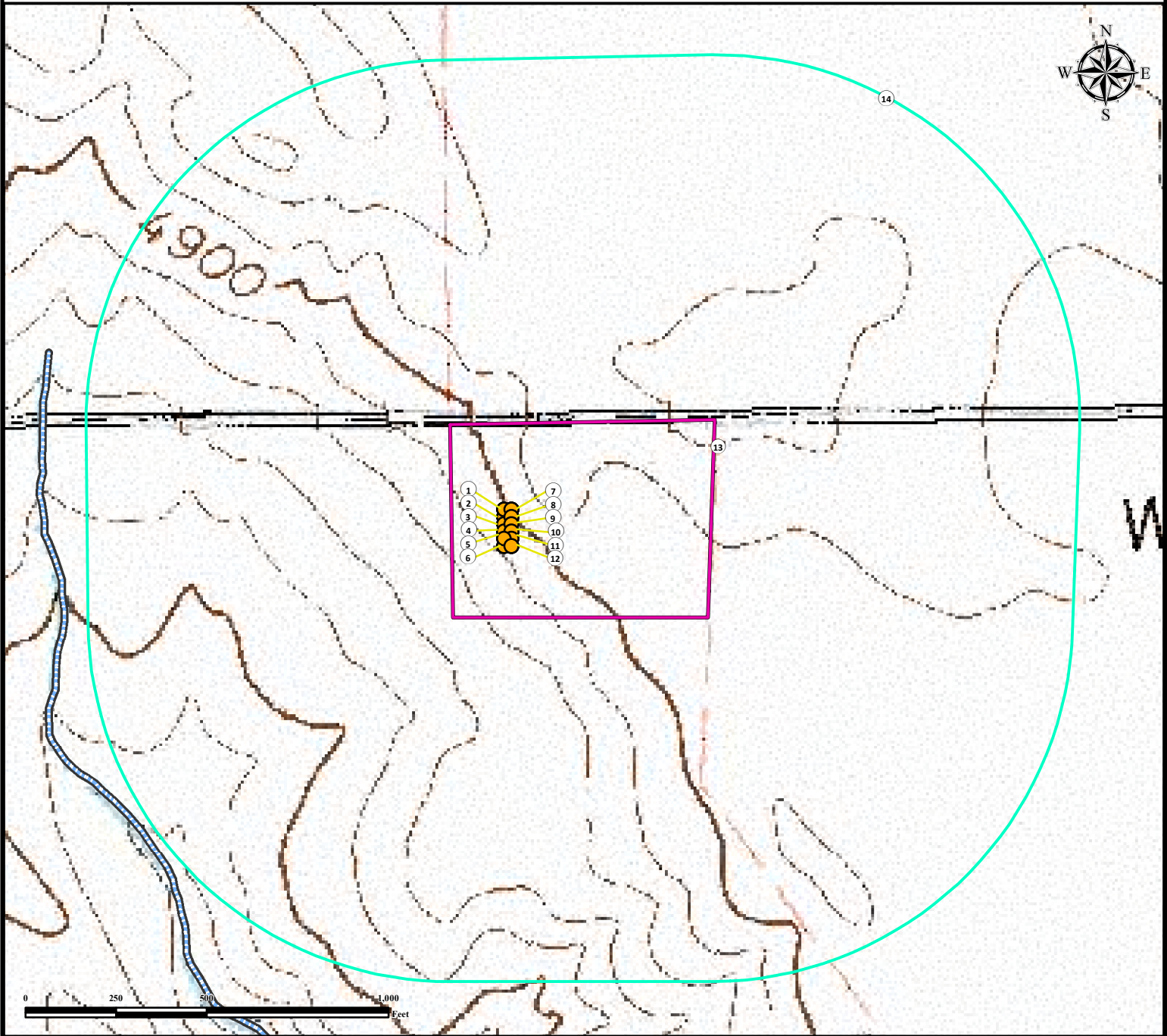

- 1. Proposed Well BRIAN C-1-36GHZ.
- 2. Proposed Well CONRAD D-1GHZ.
- 3. Proposed Well BRIAN 31-1-36GHZ.
- 4. Proposed Well CONRAD 34-1GHZ.
- 5. Proposed Well BRIAN M-1-36GHZ.
- 6. Proposed Well CONRAD Q-1GHZ.
- 7. Proposed Well BRIAN U-1-36GHZ.

- 8. Proposed Well CONRAD Y-1GHZ.
- 9. Proposed Well BRIAN 41-1-36GHZ.
- 10. Proposed Well CONRAD 44-1GHZ.
- 11. Proposed Well BRIAN R-1-36GHZ.
- 12. Proposed Well CONRAD T-1GHZ.
- 13. Operational Disturbance Area.
- 14. 1000' Radius.

Legend

- Proposed Well
- Disturbance Area
- Stream
- 1000' Radius

Reference Location

** BRIAN 31-1-36HZ **
 Lat: 40.522915° Long: -103.926816° (NAD83)
 Elevation: 4901 Feet



FIELD DATE:
11-25-14
 DRAWING DATE:
01-28-15
 BY: DRF
 CHECKED BY: SRD

SITE NAME:
BRIAN CONRAD 1-C PAD
 SURFACE LOCATION:
LOT 2 NE1/4, SEC. 1, T6N, R59W, 6TH P.M.
 MORGAN COUNTY, COLORADO

PREPARED FOR:

