

# FACILITY 5

LOCATED IN THE SOUTHEAST QUARTER OF SECTION 4, TOWNSHIP 1 NORTH,  
RANGE 67 WEST OF THE 6TH PRINCIPAL MERIDIAN,  
COUNTY OF WELD, STATE OF COLORADO

SHEET 2 OF 2

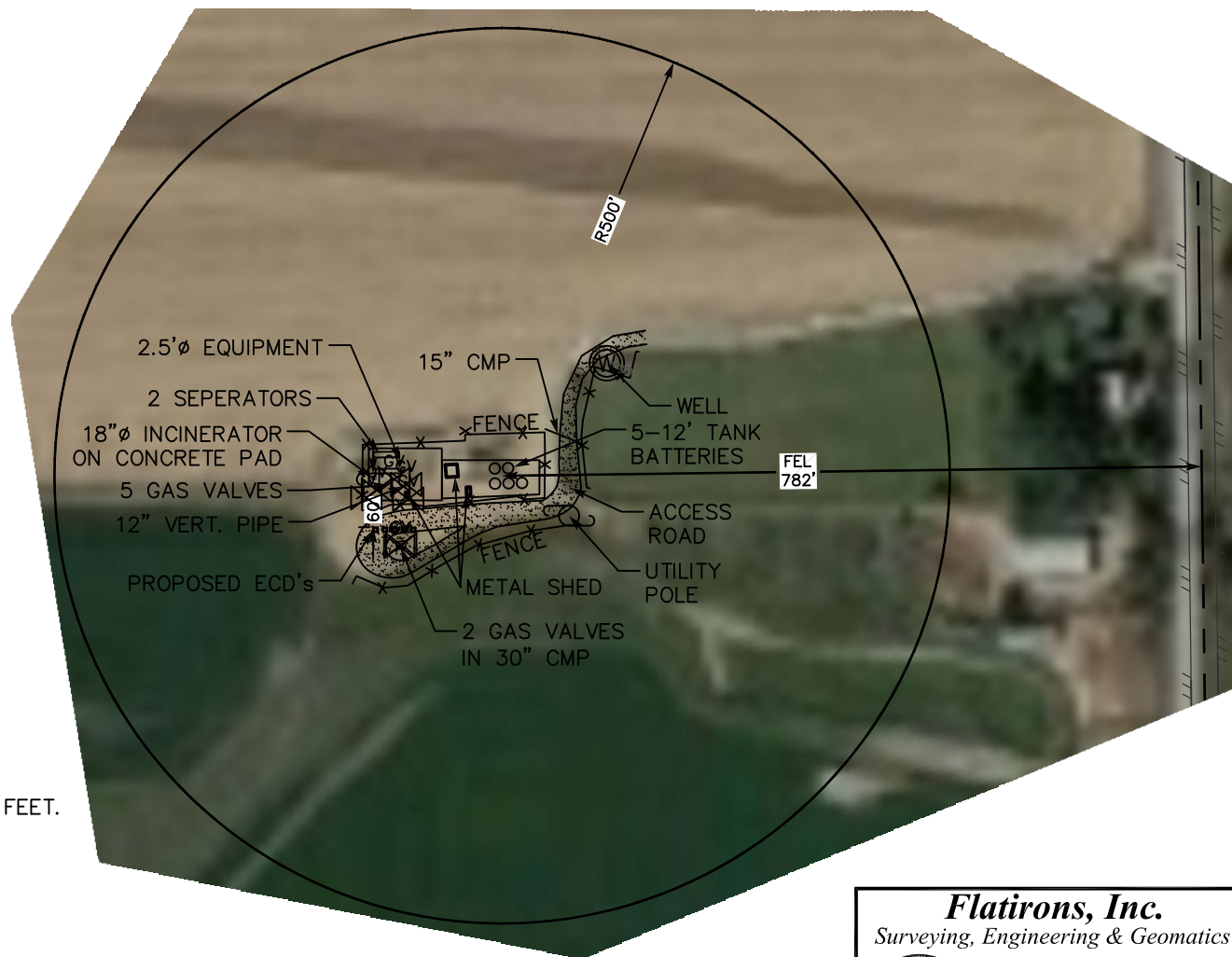
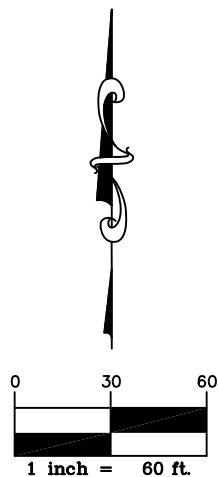

NOTES:

1-NO BUILDINGS WITHIN 500 FEET.

JOB NUMBER: 14-64,547  
DRAWN BY: E. DAVIS  
DATE: OCTOBER 20, 2014  
REV: OCT. 29, 2014  
REV: JAN. 15, 2015

THIS IS NOT A "LAND SURVEY PLAT" OR "IMPROVEMENT SURVEY PLAT" AND THIS EXHIBIT IS NOT INTENDED FOR PURPOSES OF TRANSFER OF TITLE OR SUBDIVISIONS OF LAND. RECORD INFORMATION SHOWN HEREON IS BASED ON INFORMATION PROVIDED BY CLIENT.

**Flatirons, Inc.**  
Surveying, Engineering & Geomatics



655 FOURTH AVE  
LONGMONT, CO 80501  
PH: (303) 776-1733  
FAX: (303) 776-4355

[www.FlatironsInc.com](http://www.FlatironsInc.com)