

NOTE: Under Colorado law, you must commence any legal action based upon any defect in this certificate within three years after defect is discovered. In no event, may any action based upon any defect in this survey be commenced more than ten years after date of this certificate shown hereon. (13-80105 C.R.S.)

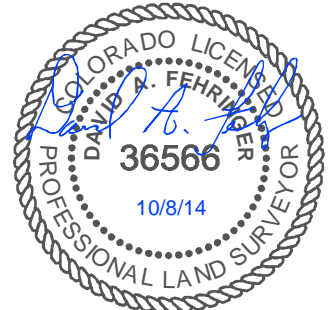

CERTIFICATE OF SURVEYOR

I, David A. Fehring of Lander, Wyoming hereby certify that this well location certificate was prepared from notes taken during an actual survey on SEPTEMBER 21, 2014; and that it correctly shows the drilling location of BONANZA CREEK ENERGY, INC., STATE ANTELOPE 44-1-36XRLNB as staked during said survey. This map does not represent a boundary survey or an improvement location plat and should not be used for the establishment of boundary lines.

WELL COORDINATES

	NAD 83		COLORADO NORTH NAD83	
	LATITUDE	LONGITUDE	NORTHING	EASTING
44-1-36XRLNB	40.42382	104.26622	1399628	3343488
SURFACE	40.42431	104.26446	1399814	3343977
TARGET 1	40.45046	104.26454	1409338	3343820
BOTTOM HOLE				

NOTES:

- All bearings are GRID based upon the Colorado State Plane Coordinate System, North Zone, NAD83(2011) derived from post-processed static GPS observations.
- Distances are at GROUND
- Vertical Datum is NAVD88 based upon GPS observations
- PDOP value equals 1.4.
- GPS operator: John Stoddard.
- Undisturbed ground elevation at wellhead = 4658.6'
- (M) Measured distance; (R) Record distance
- Nearest Cultural Distances
 - Buildings: 5280+
 - Building Unit: 5280+
 - High Occupancy Building Unit: 5280+
 - Designated Outside Activity Area: 5280+
 - Public Road: 5280+
 - Above Ground Utility: 4784'+/-
 - Railroad: 5280+
 - Property Line: 1210' +/-

SHEET NO:

1 of 2



Drawn By: DAF
Checked By: MAM
Date: 10/8/14
Revision:
Date:
Explanation:

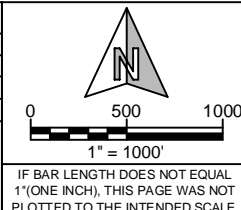

WELL LOCATION CERTIFICATE

STATE ANTELOPE 44-1-36XRLNB
358' FSL, 1210' FEL
SE $\frac{1}{4}$ SE $\frac{1}{4}$, SECTION 1,
T.5N., R.62W., 6th PM
WELD COUNTY, COLORADO



2.5" AC LS28657
LAT 40.45128°N
LONG 104.28140°W

2.5" AC LS38019
LAT 40.45182°N
LONG 104.26199°W

N87°03'57"E - 5309.34' (M)

470'

705'

BOTTOM HOLE LOCATION

NOTE: Under Colorado law,
you must commence any legal
action based upon any defect
in this certificate within three
years after defect is
discovered. In no event, may
any action based upon any
defect in this survey be
commenced more than ten
years after date of this
certificate shown hereon.
(13-80105 C.R.S.)

N01°11'40"W - 5101.38' (M)

T6W R62W
36

N00°56'30"W - 9525.23'

S00°04'58"E - 5254.26' (M)

2.5" AC LS32828
LAT 40.43728°N
LONG 104.28092°W

N88°42'12"E - 5204.98' (M)

3.25" AC LS7242
LAT 40.43740°N
LONG 104.28222°W

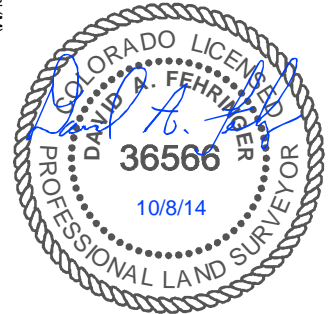

CERTIFICATE OF SURVEYOR

I, David A. Fehringer of Lander, Wyoming hereby certify that this well location certificate was prepared from notes taken during an actual survey on SEPTEMBER 21, 2014; and that it correctly shows the drilling location of BONANZA CREEK ENERGY, INC., STATE ANTELOPE 44-1-36XRLNB as staked during said survey. This map does not represent a boundary survey or an improvement location plat and should not be used for the establishment of boundary lines.

WELL COORDINATES

	NAD 83		COLORADO NORTH NAD83	
	LATITUDE	LONGITUDE	NORTHING	EASTING
44-1-36XRLNB	40.42382	104.26622	1399628	3343488
SURFACE	40.42431	104.26446	1399814	3343977
TARGET 1	40.45046	104.26454	1409338	3343820
BOTTOM HOLE				

NOTES:

- All bearings are GRID based upon the Colorado State Plane Coordinate System, North Zone, NAD83(2011) derived from post-processed static GPS observations.
- Distances are at GROUND
- Vertical Datum is NAVD88 based upon GPS observations
- PDOP value equals 1.4.
- GPS operator: John Stoddard.
- Undisturbed ground elevation at wellhead = 4658.6'
- (M) Measured distance; (R) Record distance
- Nearest Cultural Distances
 - Buildings: 5280+
 - Building Unit: 5280+
 - High Occupancy Building Unit: 5280'+
 - Designated Outside Activity Area: 5280'+
 - Public Road: 5280+
 - Above Ground Utility: 4784'+/-
 - Railroad: 5280'+
 - Property Line: 1210' +/-

SHEET NO:

2 of 2

Fremont
ENGINEERING & SURVEYING
64 COAL MINE RD.
LANDER, WY 82520
307-349-0840
fes@wyoming.com

Drawn By: DAF
Checked By: MAM
Date: 10/8/14
Revision:
Date:
Explanation:

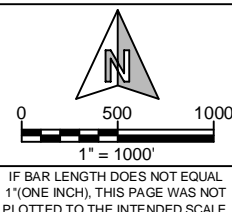

WELL LOCATION CERTIFICATE
STATE ANTELOPE 44-1-36XRLNB
BOTTOM HOLE LOCATION
470' FNL, 705' FEL
NE 1/4, SECTION 36,
T.6N., R.62W., 6th PM
WELD COUNTY, COLORADO

BONANZA CREEK
410 17th Street
Denver, CO 80202
(720) 440-6100