

NOTE: UNDER COLORADO LAW, YOU MUST COMMENCE ANY LEGAL ACTION BASED ON ANY DEFECT IN THIS CERTIFICATE WITHIN THREE YEARS AFTER DEFECT IS DISCOVERED. IN NO EVENT MAY ANY ACTION BASED UPON ANY DEFECT IN THIS SURVEY BE COMMENCED MORE THAN TEN YEARS AFTER DATE OF THIS CERTIFICATE SHOWN HEREON. (13-80105 C.R.S)

- NOTES:
- ALL BEARINGS ARE GRID BASED UPON THE COLORADO STATE PLANE COORDINATE SYSTEM, NORTH ZONE, NAD83(2011) DERIVED FROM POST-PROCESSED STATIC GPS OBSERVATIONS.
  - DISTANCES ARE ON GRID
  - VERTICAL DATUM IS NAVD88 BASED UPON GPS OBSERVATIONS
  - PDOP VALUE EQUALS 1.3.
  - GPS OPERATOR: JOHN STODDARD.
  - UNDISTURBED GROUND ELEVATION AT WELLHEAD = 4595.2'
  - ALL SECTION LENGTHS ARE MEASURED DISTANCES UNLESS NOTED BY (R), RECORD BEARING AND DISTANCE.
  - NEAREST CULTURAL DISTANCES  
 BUILDINGS: 3453'+/-  
 BUILDING UNIT: 3453'+/-  
 HIGH OCCUPANCY BUILDING UNIT: 5280'+  
 DESIGNATED OUTSIDE ACTIVITY AREA: 5280'+  
 PUBLIC ROAD: 445' +/- WEST (WCR 89)  
 ABOVE GROUND UTILITY: 5280'+  
 RAILROAD: 5280'+  
 PROPERTY LINE: 459' WEST

CERTIFICATE OF SURVEYOR:  
 I, DAVID A. FEHRINGER OF LANDER, WYOMING HEREBY CERTIFY THAT THIS WELL LOCATION CERTIFICATE WAS PREPARED FROM NOTES TAKEN DURING AN ACTUAL SURVEY ON OCTOBER 9, 2014; AND THAT IT CORRECTLY SHOWS THE DRILLING LOCATION OF BONANZA CREEK ENERGY, INC., PRONGHORN D14-X44-28HNB AS STAKED DURING SAID SURVEY. THIS MAP DOES NOT REPRESENT A BOUNDARY SURVEY OR AN IMPROVEMENT LOCATION PLAT AND SHOULD NOT BE USED FOR THE ESTABLISHMENT OF BOUNDARY LINES.

<u>SURFACE LOCATION: (NAD83)</u> GEODETIC COORDINATES LAT = N40.36779° LONG = W104.22194°	<u>TARGET #1: (NAD83)</u> GEODETIC COORDINATES LAT = N40.36730° LONG = W104.22168°	<u>BOTTOM HOLE LOCATION:</u> GEODETIC COORDINATES LAT = N40.36736° LONG = W104.20621°
STATE PLANE (CO-N NAD83) N= 1,379,391.71' E= 3,356,109.34'	STATE PLANE (CO-N NAD83) N= 1,379,213.64' E= 3,356,184.01'	STATE PLANE (CO-N NAD83) N= 1,379,298.58 E= 3,360,495.81'

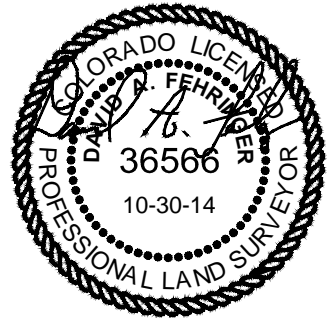

Z:\Projects\1319-01\_BONANZA\51\WIDOW\G\PRONGHORN D-28\Pronghorn.D-28\_WELL\_CERTS\_MODIFIED\_10282014.dwg SAVED DATE 2014-10-30 16:23



Drawn By: KDWK  
 Checked By: DAF  
 Date: 10-13-2014  
 Revision: Well location  
 Date: 10-28-2014  
 Explanation:  
 Well locations were modified by Bonanza.

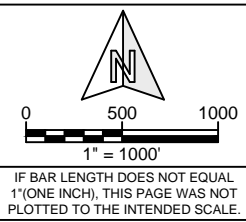

WELL LOCATION CERTIFICATE  
 PRONGHORN D14-X44-28HNB  
 SW¼SW¼, SECTION 28,  
 T.5N., R.61W., 6th PM  
 WELD COUNTY, COLORADO



SHEET	1
OF	1