

NOTES:

- ALL BEARINGS ARE GRID BASED UPON THE COLORADO STATE PLANE COORDINATE SYSTEM, NORTH ZONE, NAD83(2011) DERIVED FROM POST-PROCESSED STATIC GPS OBSERVATIONS.
- DISTANCES ARE ON GRID
- VERTICAL DATUM IS NAVD88 BASED UPON GPS OBSERVATIONS
- PDOP VALUE EQUALS 1.3.
- GPS OPERATOR: JOHN STODDARD.
- UNDISTURBED GROUND ELEVATION AT WELLHEAD = 4597.6'
- ALL SECTION LENGTHS ARE MEASURED DISTANCES UNLESS NOTED BY (R), RECORD BEARING AND DISTANCE.
- NEAREST CULTURAL DISTANCES
BUILDINGS: 3350' +/-
BUILDING UNIT: 3350' +/-
HIGH OCCUPANCY BUILDING UNIT: 5280' +/-
DESIGNATED OUTSIDE ACTIVITY AREA: 5280' +/-
PUBLIC ROAD: 375' +/- WEST (WCR 89)
ABOVE GROUND UTILITY: 5280' +/-
RAILROAD: 5280' +/-
PROPERTY LINE: 389' WEST

SURFACE LOCATION: (NAD83)

GEODETIC COORDINATES
LAT = N40.36801°
LONG = W104.22219°

STATE PLANE (CO-N NAD83)

N = 1,379,470.27'
E = 3,356,037.85'

TARGET #1: (NAD83)

GEODETIC COORDINATES
LAT = N40.37183°
LONG = W104.22170°

STATE PLANE (CO-N NAD83)

N = 1,380,863.40'
E = 3,356,155.52'

BOTTOM HOLE LOCATION:

GEODETIC COORDINATES
LAT = N40.37189°
LONG = W104.20623°

STATE PLANE (CO-N NAD83)

N = 1,380,948.28'
E = 3,360,464.71'

CERTIFICATE OF SURVEYOR:

I, DAVID A. FEHRINGER OF LANDER, WYOMING HEREBY CERTIFY THAT THIS WELL LOCATION CERTIFICATE WAS PREPARED FROM NOTES TAKEN DURING AN ACTUAL SURVEY ON OCTOBER 9, 2014; AND THAT IT CORRECTLY SHOWS THE DRILLING LOCATION OF BONANZA CREEK ENERGY, INC., PRONGHORN C-W- 28HNC AS STAKED DURING SAID SURVEY. THIS MAP DOES NOT REPRESENT A BOUNDARY SURVEY OR AN IMPROVEMENT LOCATION PLAT AND SHOULD NOT BE USED FOR THE ESTABLISHMENT OF BOUNDARY LINES.

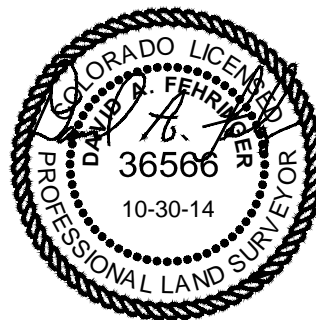

Drawn By: KDWK
Checked By: DAF
Date: 10-13-2014
Revision: Well location
Date: 10-28-2014
Explanation:
Well locations were
modified by Bonanza.

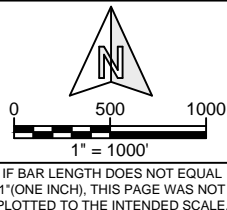

WELL LOCATION CERTIFICATE

PRONGHORN C-W-28HNC
SW 1/4, SECTION 28,
T.5N., R.61W., 6th PM
WELD COUNTY, COLORADO



410 17TH STREET
DENVER, CO 80202
(720) 440-6100

SHEET

1

OF

1