

Notes:

1. LATITUDE AND LONGITUDE COORDINATES ARE DIFFERENTIALLY CORRECTED AND BASED ON PUBLISHED NGS CONTROL STATION "WDP-5". SYSTEM: UTM ZONE: 13 NORTH DATUM: NAD 1983 (CONUS)
2. ELEVATIONS ARE BASED ON NAVD OF 1929.
3. ALL BOTTOM AND TOP HOLE LOCATIONS ARE MEASURED 90 DEGREES FROM SECTION LINE.
4. USGS QUADRANGLE MAP "GIBSON GULCH".
5. CURRENT SURFACE LAND USE: WELL PAD.
6. PDOP AT THE TIME OF LOCATION OF SURFACE WELL = 1.8

Legend

- ◆ - Field Surveyed Section Corner
- ◆ - Field Surveyed Quarter Corner
- ⊙ - Calculated Section Corner Location
- ⊕ - Field Surveyed 1/16 Corner

SURVEYOR'S CERTIFICATE

I, SCOTT E. AIBNER, A REGISTERED LAND SURVEYOR, LICENSED UNDER THE LAWS OF THE STATE OF COLORADO DO HEREBY CERTIFY THAT THE SURVEY SHOWN HEREON WAS PREPARED BY RIVER VALLEY SURVEY, INC., FOR URSA OPERATING COMPANY, LLC, BY ME OR UNDER MY DIRECT SUPERVISION AND HAS BEEN STAKED ON THE GROUND AS SHOWN ON THE PLAT AND THAT THIS PLAT IS A TRUE REPRESENTATION THEREOF.

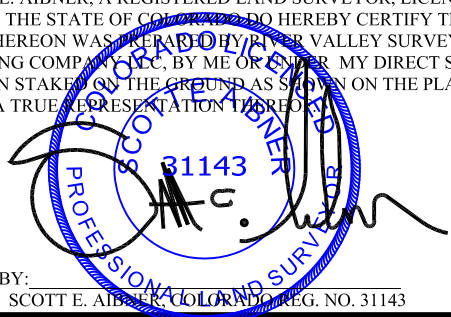

BY: SCOTT E. AIBNER, COLORADO REG. NO. 31143

Prepared For: Ursa Operating Company LLC
Proposed Castle Springs Federal 23C-09-07-91 Well
Surface Situate in The SW 1/4 Section 9, Township 7 South,
Range 91 West of the 6 th. Principal Meridian, County of
Garfield, State of Colorado.



River Valley Survey, Inc.
 110 East 3rd. Street, Suite 213
 Rifle, Colorado 81650
 Ph: 970-379-7846

| | |
|------------------------|------------------|
| Project: RVS 06001-41E | |
| Field Date: 08-12-14 | Scale: 1"= 1000' |
| Date: 12-03-14 | Sheet: 1 of 1 |

303.a Form 2
Castle Springs Federal E Pad
Well CSF 23C-09-07-91
Section 9, Township 7 South, Range 91 West